



Department of  
Design and  
Construction



NYC Parks

# NEW RECREATION CENTER AT ROY WILKINS PARK

Queens \_ Community Board 12  
April 15th, 2026

**TRITON**  
CONSTRUCTION

**ELITE**  
CONSTRUCTION OF NY

**BEYER  
BLINDER  
BELLE**

# AGENDA

- Partner Agencies Introductions
- Ongoing Developments in Roy Wilkins Park
- Project Timeline
- Overview of the Design Build Team
- New Recreation Center at Roy Wilkins Park Overview

**NEW RECREATION CENTER  
AT ROY WILKINS PARK**

## PROJECT CITY AGENCIES



- **Andrew Murjas** | Deputy Director,  
Alternative Delivery, Office of the Commissioner
- **Abraham Gonzalez** | Project Manager,  
Alternative Delivery, Office of the Commissioner



**NYC Parks**

- **Rachel Rosenberg, RA** | Architect,  
NYC Parks Capital Projects
- **Meira Berkower** | Chief of Staff to the  
Queens Borough Commissioner
- **Christopher Davis** | Chief  
Queens Recreation

**NEW RECREATION CENTER  
AT ROY WILKINS PARK**

# ONGOING DEVELOPMENTS IN ROY WILKINS PARK

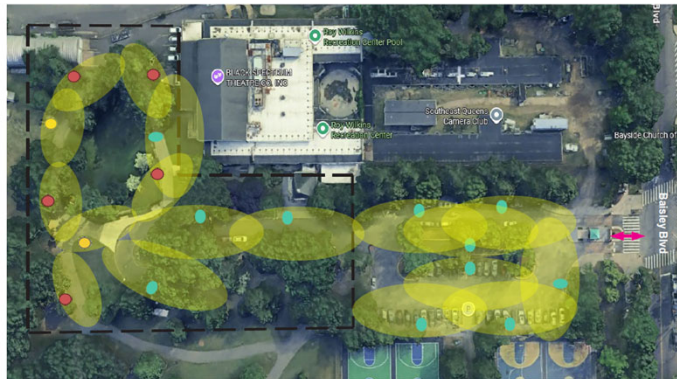

## NEW RECREATION CENTER AT ROY WILKINS PARK

## COMMUNITY ENGAGEMENT

NYC Parks collected input from the community on potential program spaces for the new recreation center during the virtual public input meeting on January 25, 2022

NYC Parks and DDC provided an update to the community at the Queens CB 12 Parks Committee meeting at Eagle Academy on May 1, 2024



**NEW RECREATION CENTER  
AT ROY WILKINS PARK**

# PROJECT TIMELINE

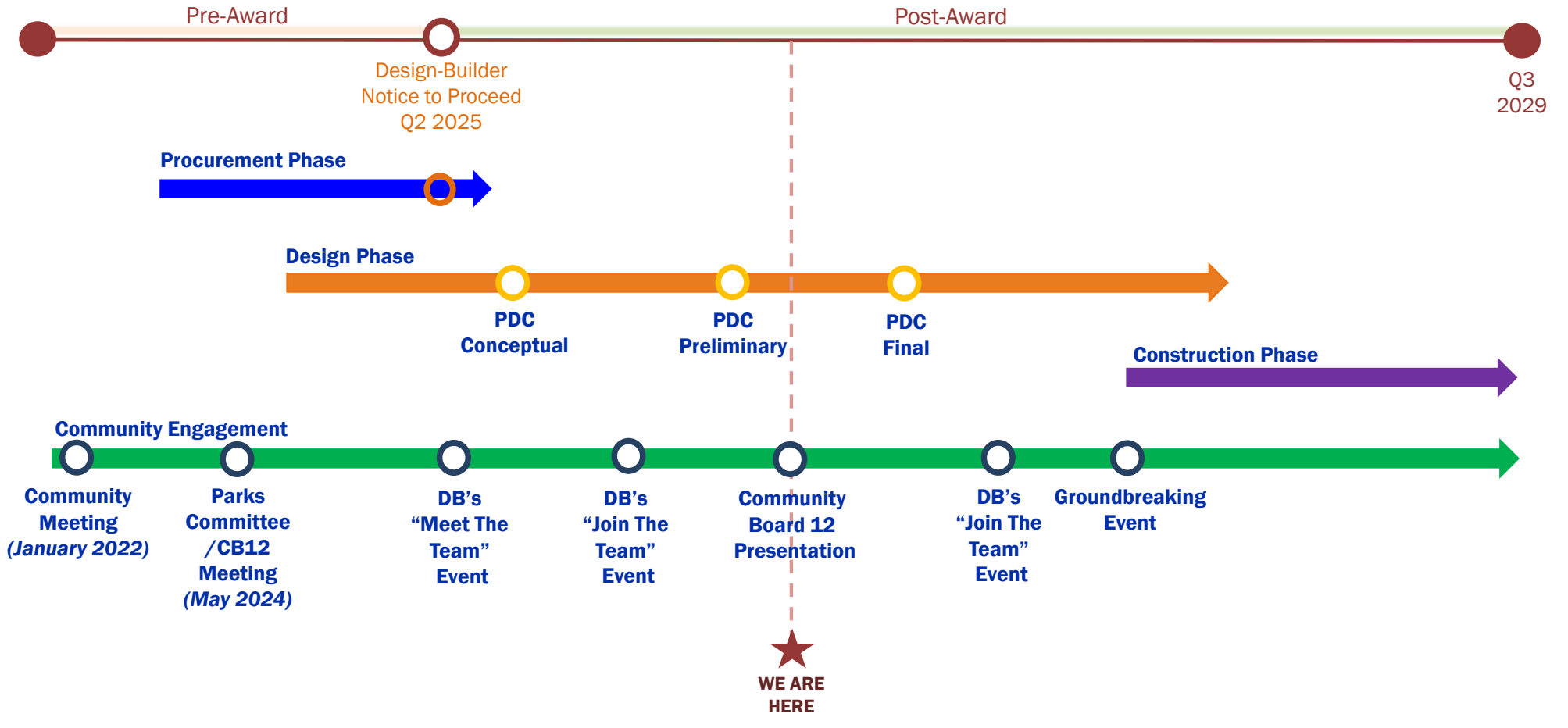

**NEW RECREATION CENTER  
AT ROY WILKINS PARK**

# INCITU

## Recreation Center Development

The new recreation center project proposes the construction of a new 67,000-square-foot recreation center within Roy Wilkins Park. Designed to function as a year-round hub for sports, fitness, education, and the arts, the facility will include amenities such as a gymnasium, indoor track, swimming pool, fitness rooms, and multipurpose spaces serving all age groups.

The facility will be constructed on an existing open field within the park, fronting Merrick Boulevard. The site is strategically positioned adjacent to a surface parking lot to the west and a public bus stop serving three transit lines along the southeastern edge, ensuring convenient and equitable transit access. The recreation center will serve as a safe, inclusive, and pedestrian-friendly public amenity, strengthening the bond between Roy Wilkins Park and the St. Albans community.

For more information visit the Department of Design and Construction website [www.nyc.gov/site/ddc/index.page](http://www.nyc.gov/site/ddc/index.page) or [www.rwrc-info.com](http://www.rwrc-info.com)

## Desarrollo del Centro Recreativo

El proyecto propone la construcción de un centro recreativo de 67,000 pies cuadrados dentro del Parque Roy Wilkins. Diseñado para funcionar como un centro activo durante todo el año para deportes, acondicionamiento físico, educación y las artes, el edificio incluirá instalaciones como un gimnasio, pista interior para caminar, piscina, salas de ejercicio y espacios multifuncionales destinados a personas de todas las edades.

La instalación se construirá en un campo abierto existente dentro del parque, con frente hacia Merrick Boulevard. El sitio está estratégicamente ubicado junto a un estacionamiento en superficie al oeste y una parada de autobús público que atiende tres líneas de transporte a lo largo del borde sureste, lo que garantiza un acceso al transporte público conveniente y equitativo. El centro recreativo funcionará como un equipamiento público seguro, inclusivo y amigable para peatones, fortaleciendo el vínculo entre el Parque Roy Wilkins y la comunidad de St. Albans.

Para más información, visite: Department of Design and Construction website [www.nyc.gov/site/ddc/index.page](http://www.nyc.gov/site/ddc/index.page) or [www.rwrc-info.com](http://www.rwrc-info.com)

Scan nearby QR codes to see in 3D

Escanea los códigos QR cercanos para verlos en 3D



### Augmented Reality Visualization

The future site is available as a smartphone-based Augmented Reality (AR) experience. No app download is required, simply scan the QR code and raise your phone towards the site to see the future of this site.

El sitio futuro está disponible como una experiencia de realidad aumentada (AR) basada en smartphones. No se requiere descarga de aplicaciones, simplemente escanee el código QR y levante su teléfono hacia el sitio para ver el futuro de este sitio.



## NEW RECREATION CENTER AT ROY WILKINS PARK

## DESIGN BUILD TEAM



### **Triton construction:**

- **Frank Reich** | CO-CEO, Design-Build Project Executive  
[freich@tritonconstruction.net](mailto:freich@tritonconstruction.net)
- **Matt Sarton** | Vice President, Design-Build Project Manager  
[msarton@tritonconstruction.net](mailto:msarton@tritonconstruction.net)

### **Elite construction:**

- **Michael Reed** | CCM, CEO/managing member, Construction Project Manager  
[mreed@eliteccny.com](mailto:mreed@eliteccny.com)

**BEYER  
BLINDER  
BELLE**

### **BBB architects:**

- **Carlos J. Cardoso** | AIA, Partner, Project Designer of Record  
[ccardoso@bbbarch.com](mailto:ccardoso@bbbarch.com)
- **Miguel Angel Maldonado** | AIA, principal, Design Manager  
[mmaldonado@bbbarch.com](mailto:mmaldonado@bbbarch.com)



### **Crescent consulting (MBE):**

- **Robert Nesmith** | M/WBE and Community Engagement, Executive Project Executive  
[rnesmith@crescentconsult.com](mailto:rnesmith@crescentconsult.com)

**NEW RECREATION CENTER  
AT ROY WILKINS PARK**

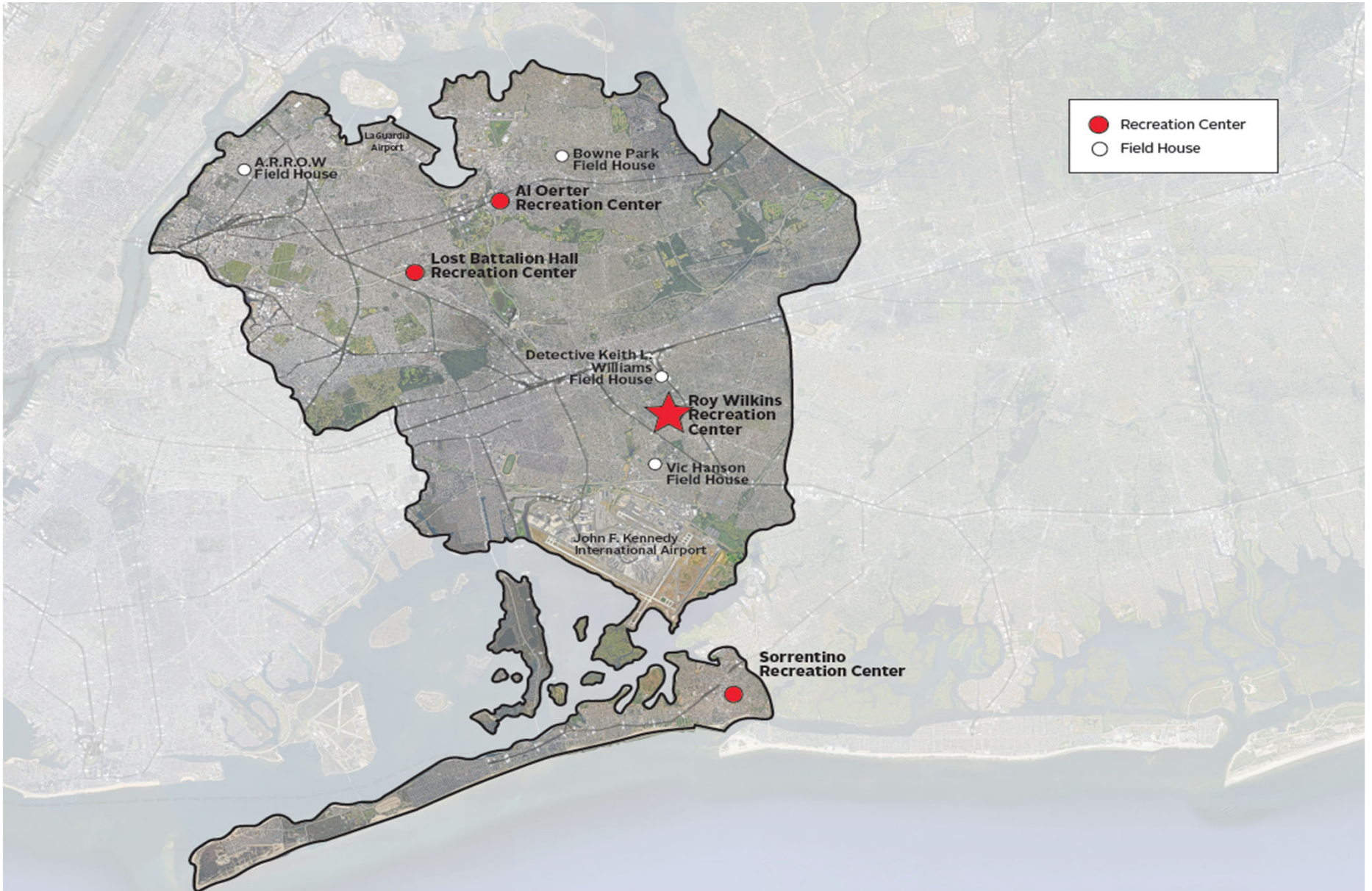

**NEW RECREATION CENTER  
AT ROY WILKINS PARK**

Recreation Center Location Plan  
BOROUGH SCALE



**NEW RECREATION CENTER  
AT ROY WILKINS PARK**

Recreation Center Location Plan  
NEIGHBORHOOD SCALE



**NEW RECREATION CENTER  
AT ROY WILKINS PARK**

Site Plan—Existing



A



B



**NEW RECREATION CENTER  
AT ROY WILKINS PARK**

KEY PLAN

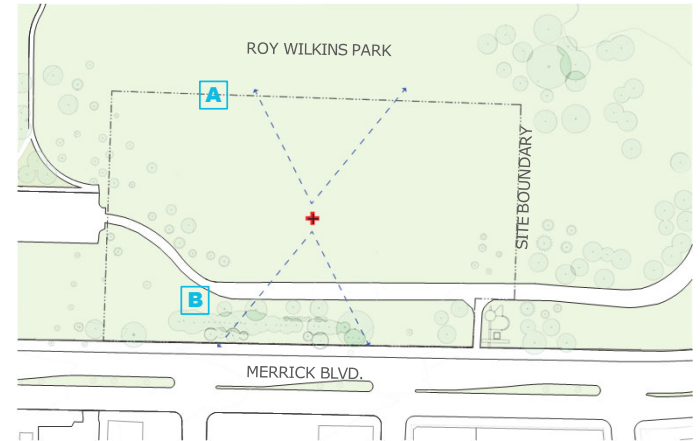

Site Photographs  
NO SCALE

C



D



**NEW RECREATION CENTER  
AT ROY WILKINS PARK**

KEY PLAN

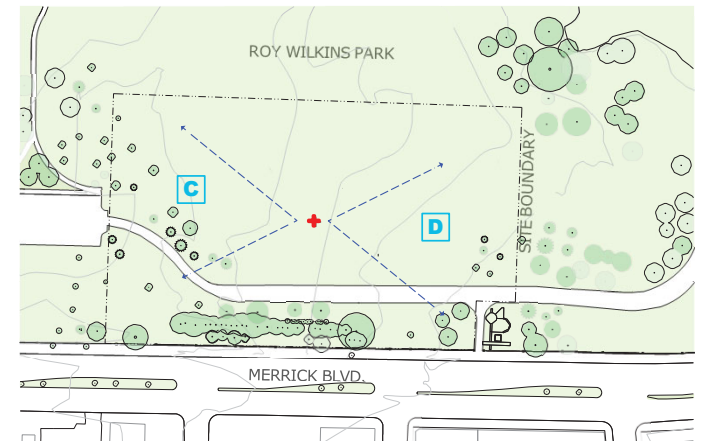

Site Photographs  
NO SCALE

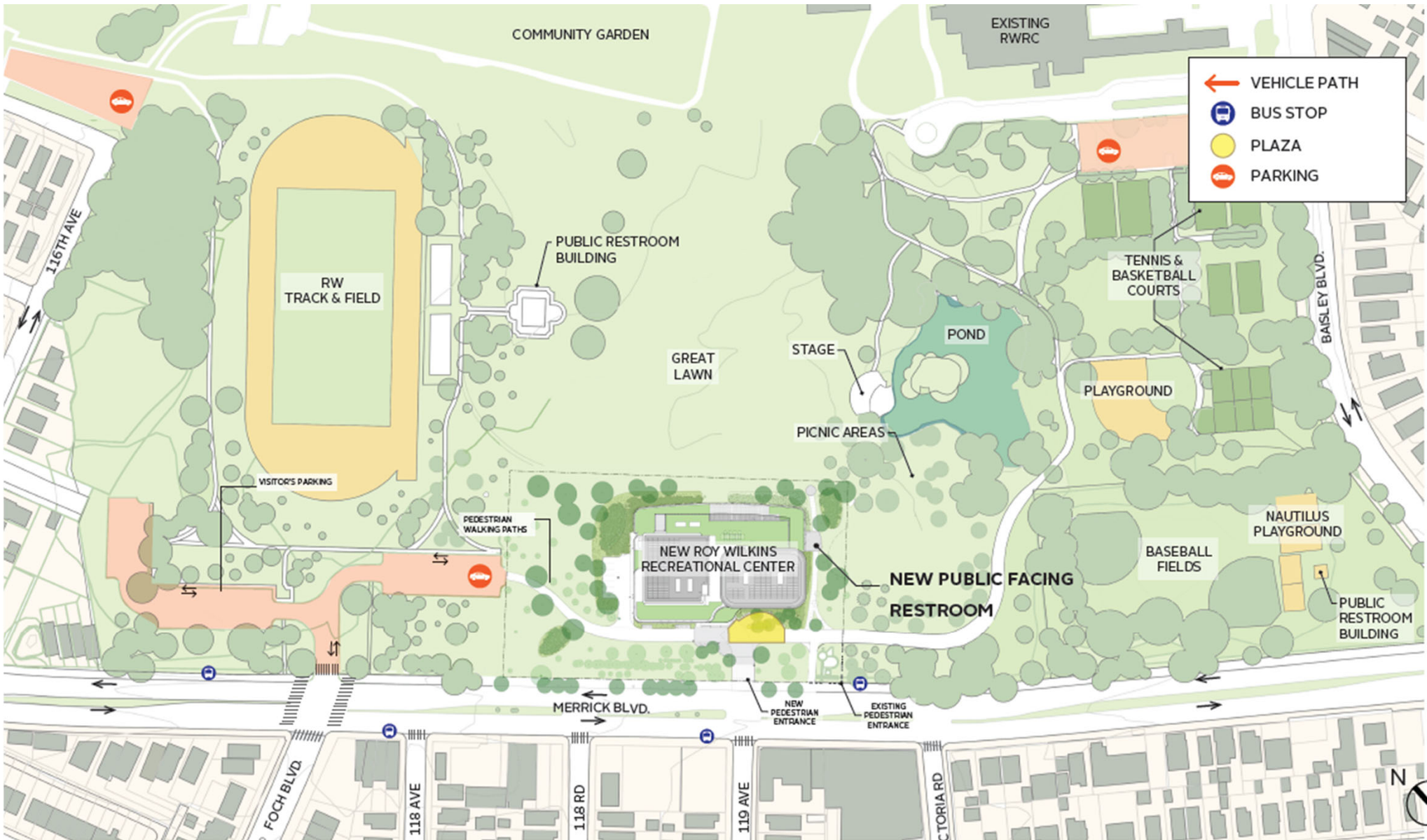

**NEW RECREATION CENTER  
AT ROY WILKINS PARK**

Site Plan - Context & Circulation



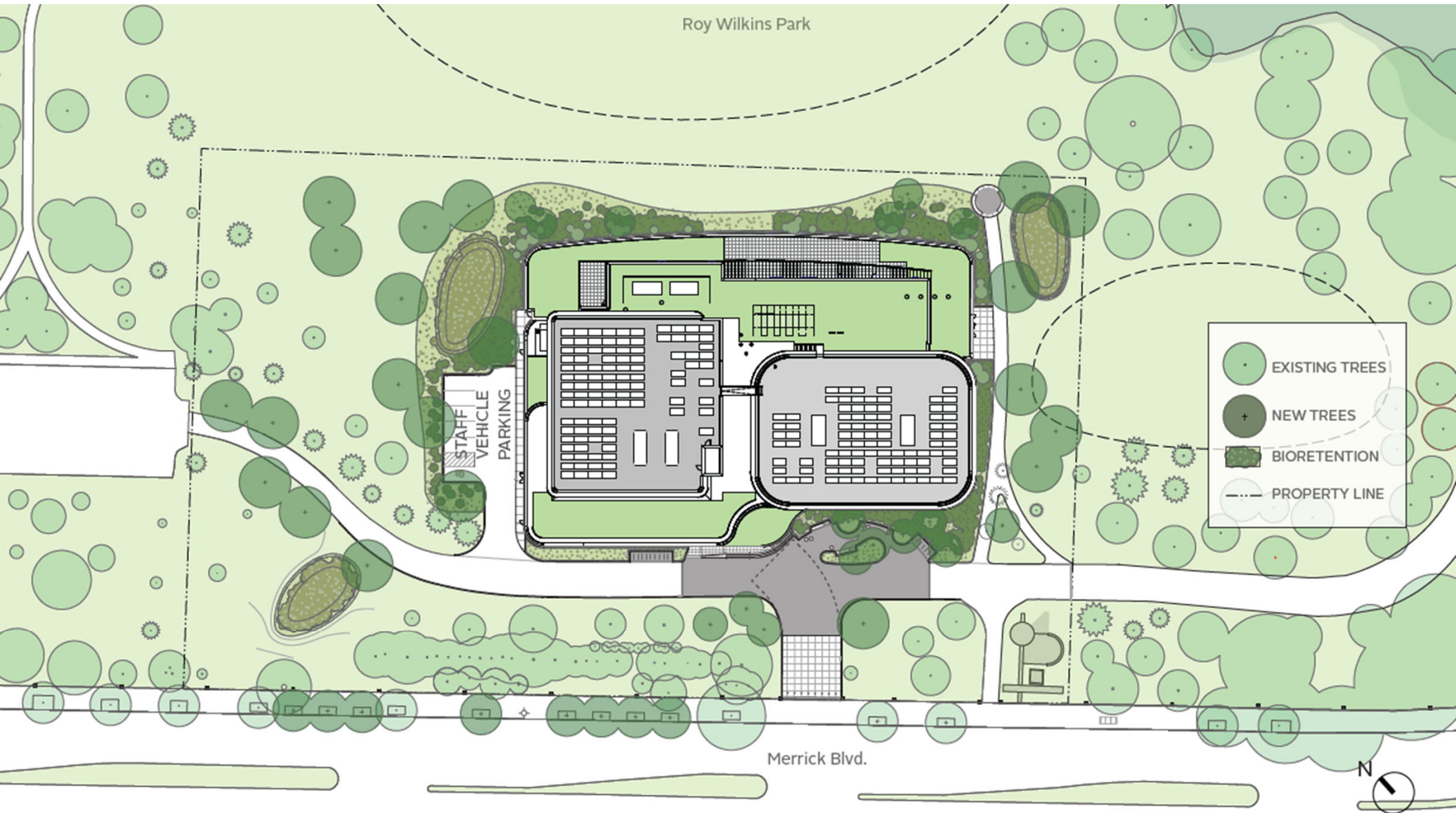

**NEW RECREATION CENTER  
AT ROY WILKINS PARK**

Site Plan

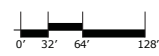

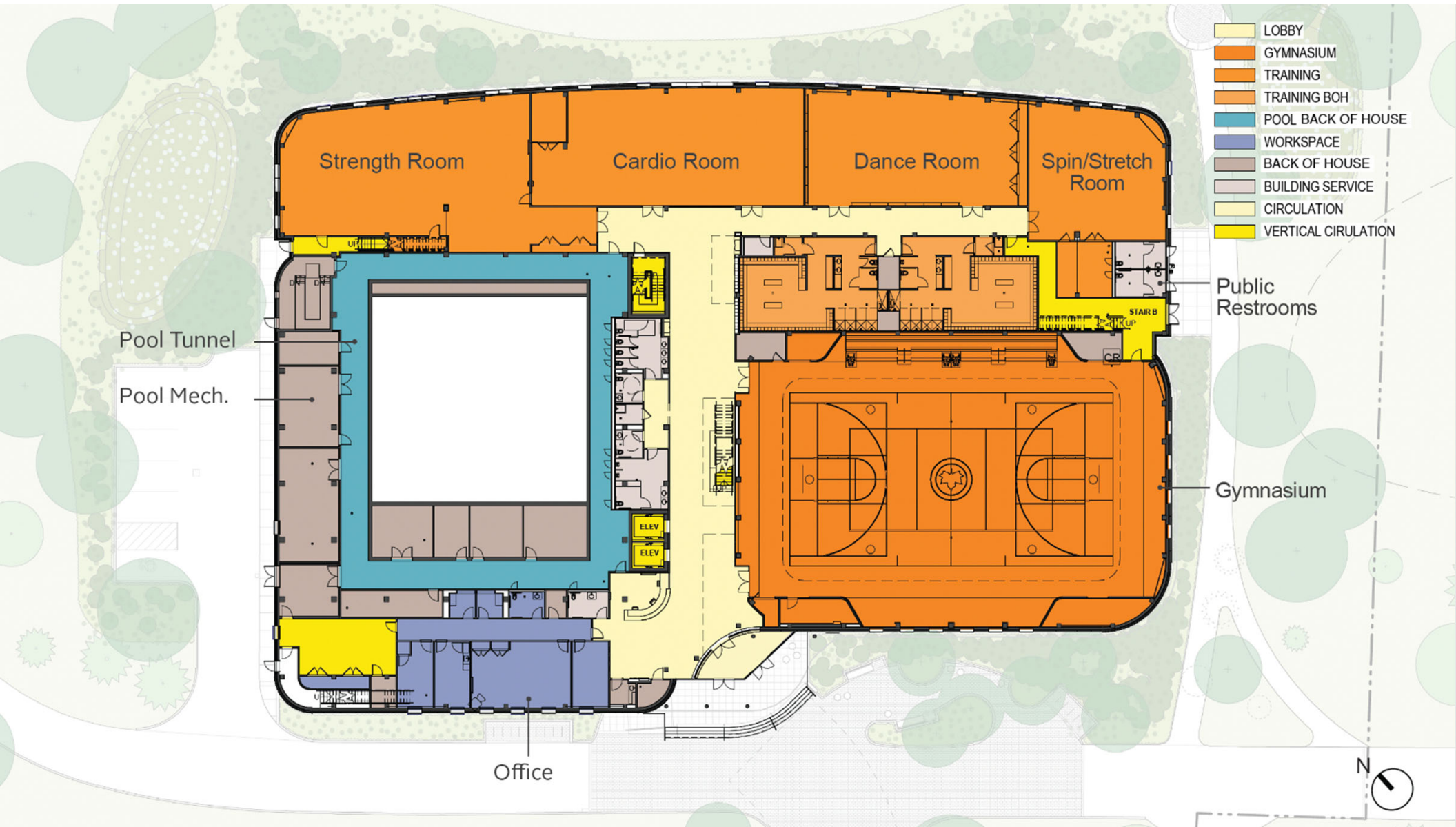

- LOBBY
- GYMNASIUM
- TRAINING
- TRAINING BOH
- POOL BACK OF HOUSE
- WORKSPACE
- BACK OF HOUSE
- BUILDING SERVICE
- CIRCULATION
- VERTICAL CIRCULATION

**NEW RECREATION CENTER  
AT ROY WILKINS PARK**

First Floor Plan

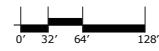

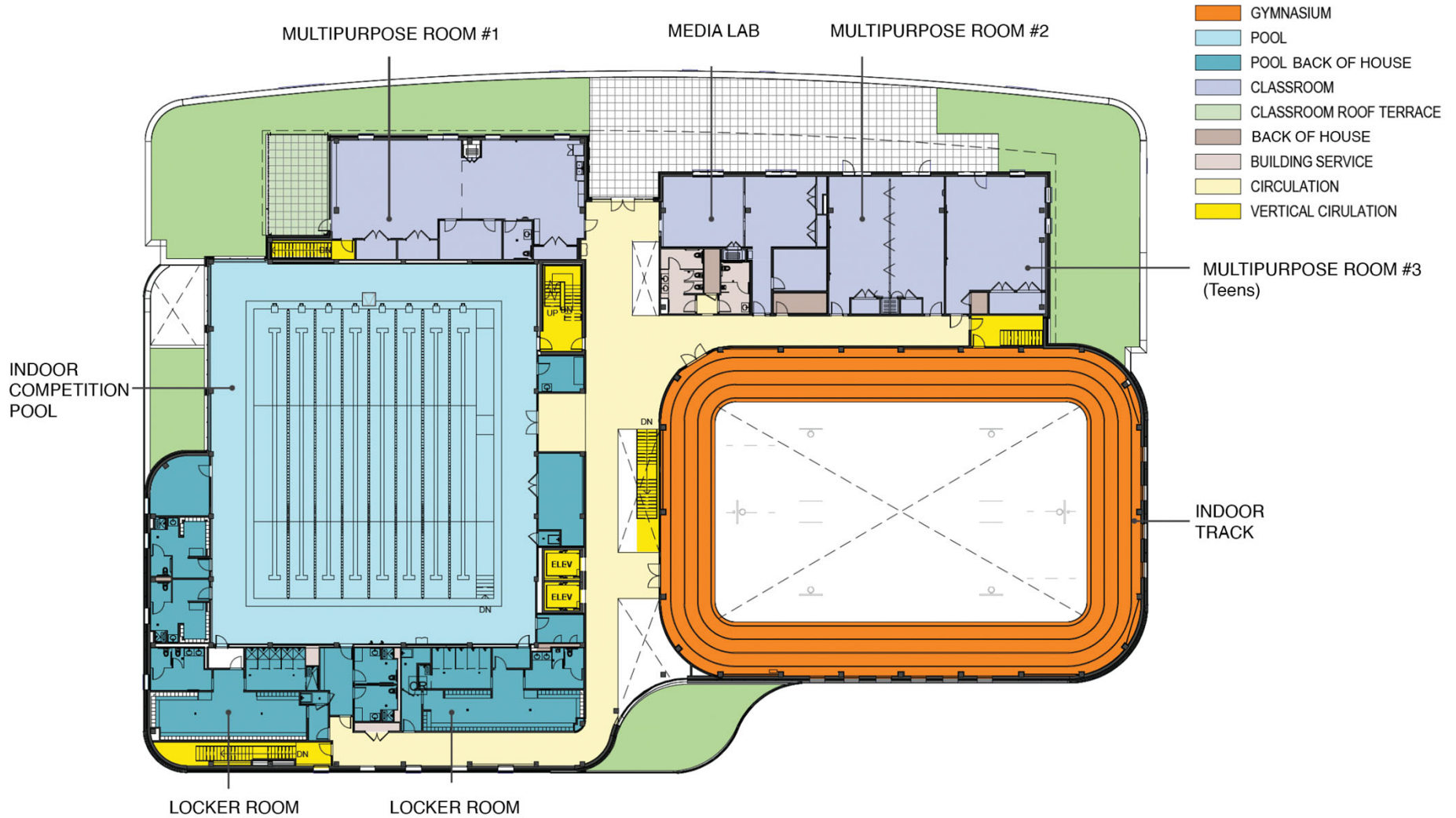

**NEW RECREATION CENTER  
AT ROY WILKINS PARK**

Second Floor Plan

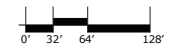

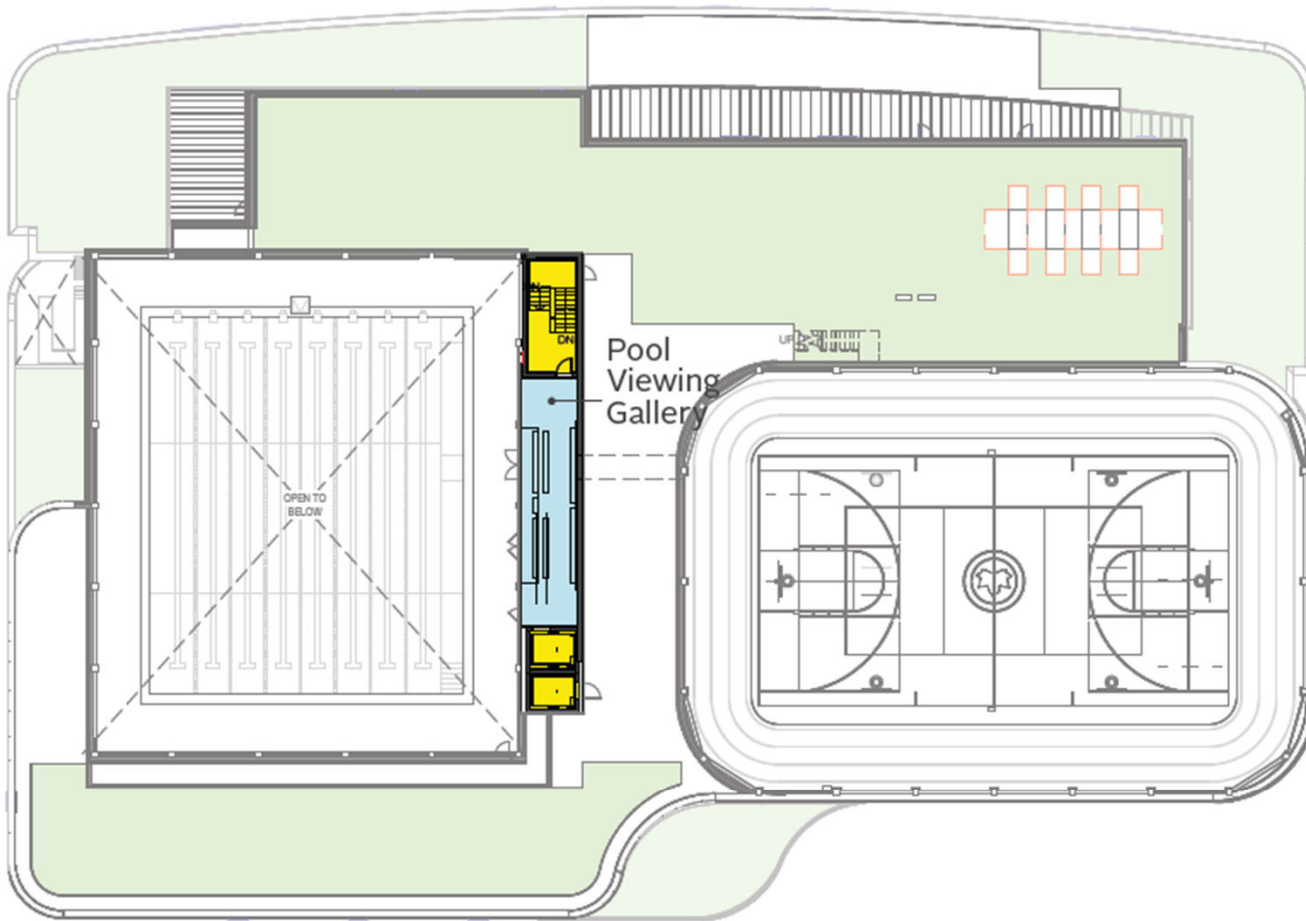

**NEW RECREATION CENTER  
AT ROY WILKINS PARK**

Mezzanine Floor Plan

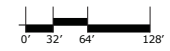

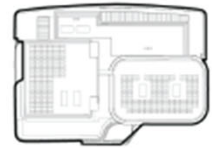

- 04 UPPER ROOF 38' - 0"
- 03 LOWER ROOF 28' - 0"
- 02M POOL GALLERY LEVEL 24' - 11"
- 02 SECOND FLOOR 14' - 0"
- 01 FIRST FLOOR 0' - 0"

West Elevation

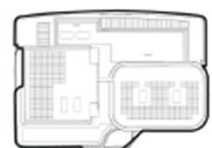

- 04 UPPER ROOF 38' - 0"
- 03 LOWER ROOF 28' - 0"
- 02M POOL GALLERY LEVEL 24' - 11"
- 02 SECOND FLOOR 14' - 0"
- 01 FIRST FLOOR 0' - 0"

South Elevation

**NEW RECREATION CENTER  
AT ROY WILKINS PARK**

Building Elevations

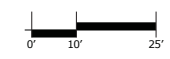



East Elevation



MERRICK BOULEVARD

North Elevation

**NEW RECREATION CENTER  
AT ROY WILKINS PARK**

Building Elevations

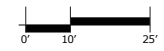

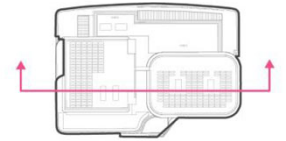

Pool

Pool Tunnel

Pool Bleachers

Entry Gallery

Track

Gymnasium

Track

North-South Section

**NEW RECREATION CENTER  
AT ROY WILKINS PARK**

Section Perspective  
NO SCALE

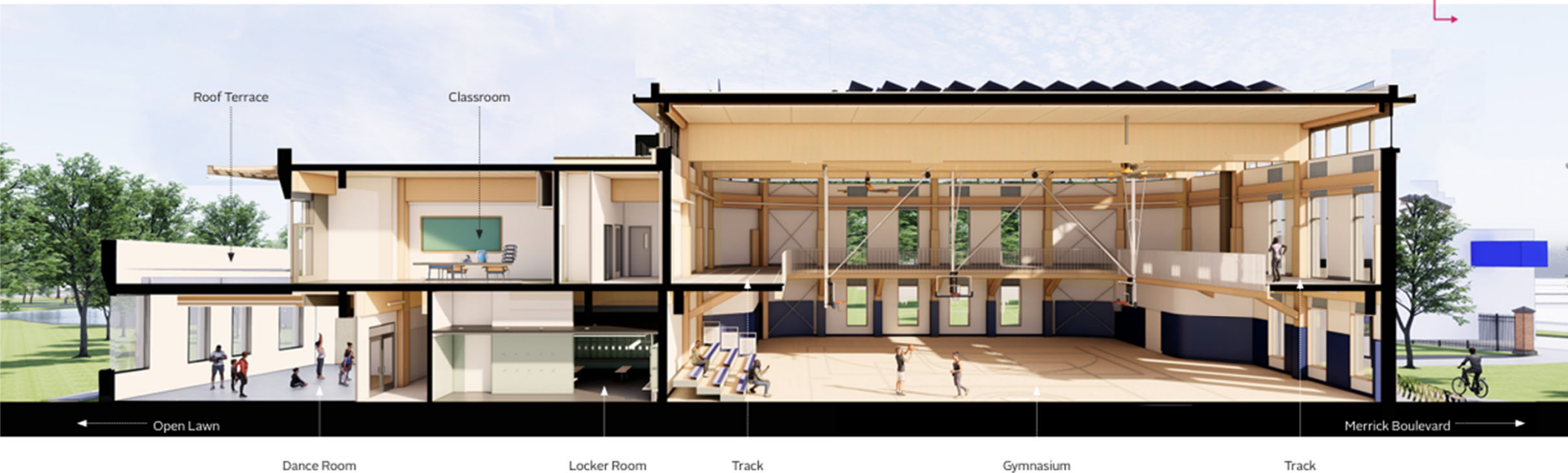
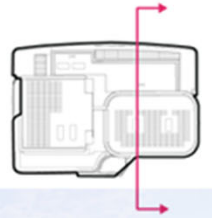

West-East Section

**NEW RECREATION CENTER  
AT ROY WILKINS PARK**

Section Perspective  
NO SCALE



**NEW RECREATION CENTER  
AT ROY WILKINS PARK**

Exterior/Merrick Blvd.  
NO SCALE



**NEW RECREATION CENTER  
AT ROY WILKINS PARK**

Exterior/Entrance  
NO SCALE



**NEW RECREATION CENTER  
AT ROY WILKINS PARK**

Exterior/Entry Plaza  
NO SCALE



**NEW RECREATION CENTER  
AT ROY WILKINS PARK**

Exterior/Park View  
NO SCALE



**NEW RECREATION CENTER  
AT ROY WILKINS PARK**

Exterior/North West Facade  
NO SCALE



**NEW RECREATION CENTER  
AT ROY WILKINS PARK**

Exterior/North Facade  
NO SCALE



**NEW RECREATION CENTER  
AT ROY WILKINS PARK**

Interior View/Pool  
NO SCALE



**NEW RECREATION CENTER  
AT ROY WILKINS PARK**

Interior Gym / Walking Track  
NO SCALE

## PROJECT CONTACT INFORMATION



- **Norberto Acevedo** | Director,  
Communication & Policy  
AcevedoNo@ddc.nyc.gov
- **Anna Killion** | Outreach Coordinator,  
Communication & Policy  
KillionAn@ddc.nyc.gov



Scan to explore the  
**Project Website**

[www.rwrc-info.com](http://www.rwrc-info.com)

**NEW RECREATION CENTER  
AT ROY WILKINS PARK**



Department of  
Design and  
Construction



NYC Parks

# Q & A

**TRITON**  
CONSTRUCTION

**ELITE**  
CONSTRUCTION OF NY

**BEYER  
BLINDER  
BELLE**