



Percent *for* Art Program

Information Session

New Recreation Center at Roy Wilkins Park

September 4, 2025

Mary Temple
Double Sun, 2016

McCarren Park Recreation Center, Brooklyn

What is Public Art ?

Percent for Art

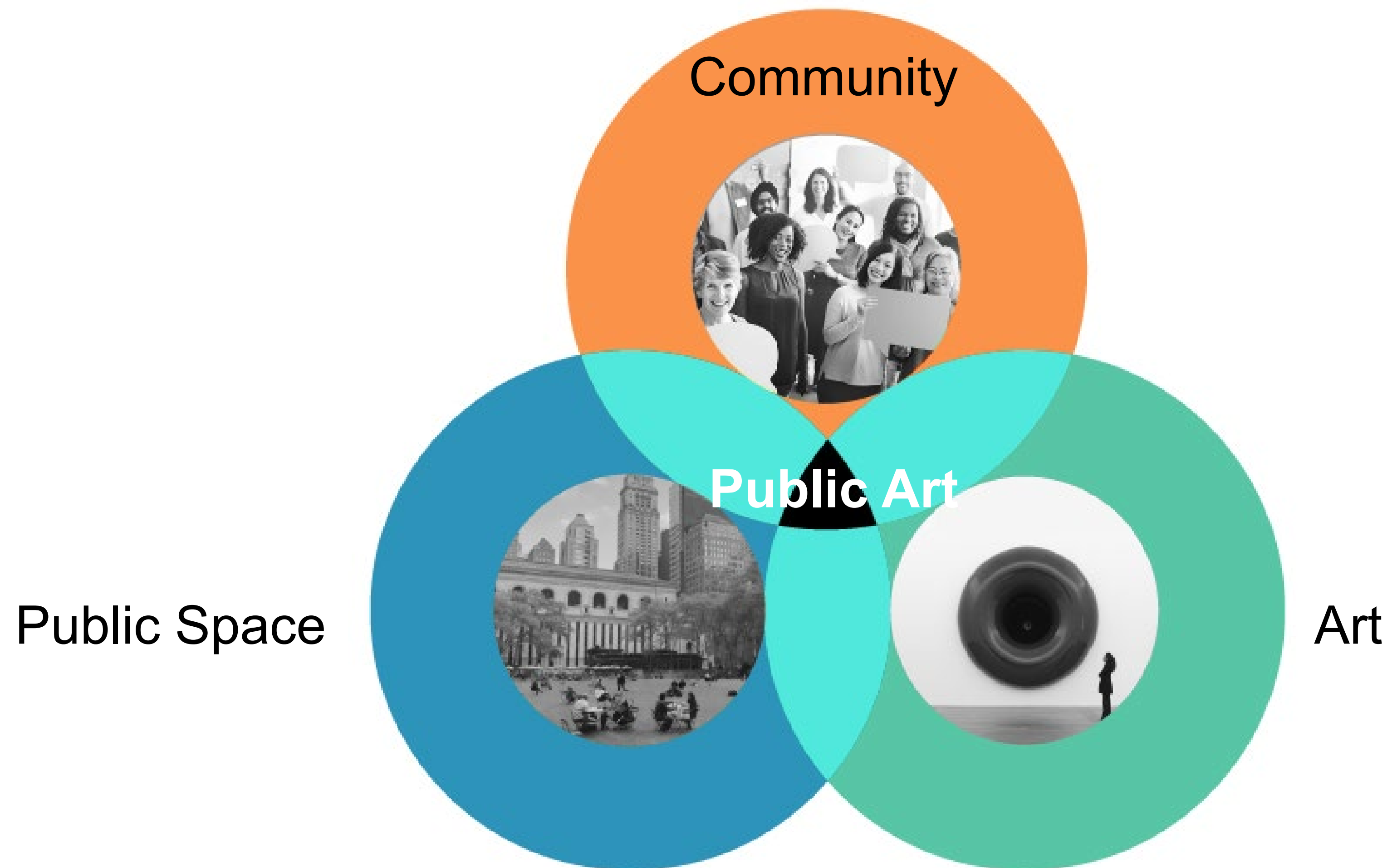

Program History

NYC Percent for Art

In 1982, Local Law 65, the Percent for Art Law was passed, which states that 1% of the capital funds appropriated for newly constructed or reconstructed City-owned buildings or sites must be allocated for works of art.



Dedication of *Growth*, the first Percent for Art commission, 1985



Growth by Jorge Luis Rodrigues at East Harlem Art Park, 2021

New Legislation

NYC Percent for Art



In 2017 new legislation was passed to further update the Percent for Art Law.

Local Law 22

Increases the amount the City of NY can spend on public art. One percent of the first **\$50 million** allocated for eligible capital projects must fund public art, replacing the existing rule of one percent of the first **\$20 million**. It also increases the annual project cap per project **to \$900k**, and total project cap **to \$4M**.

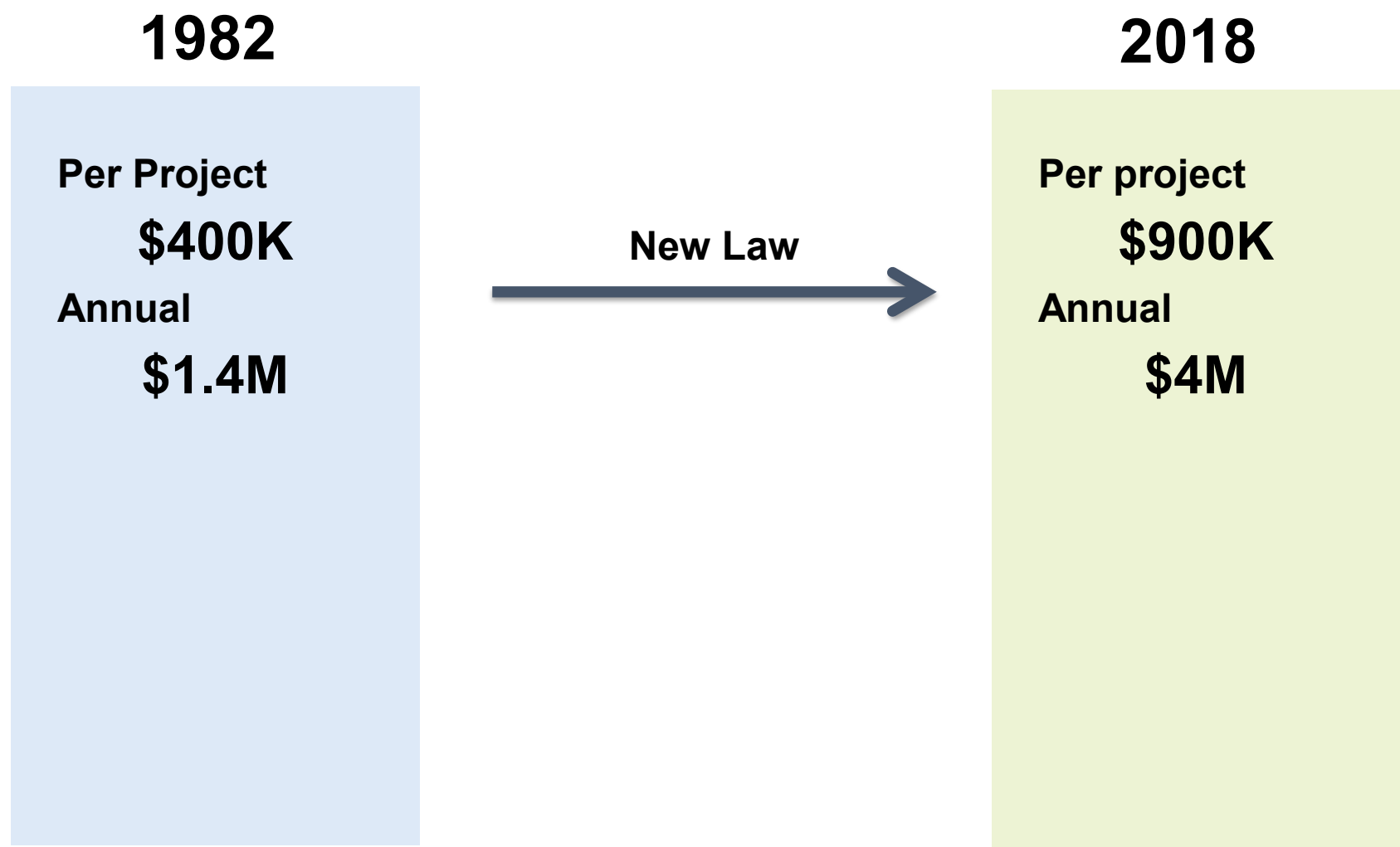

Percent for Art Eligibility Criteria

NYC Percent for Art



Ursula von Rydingsvard
katul katul, 2003

Queens County Family Court, Jamaica, NY

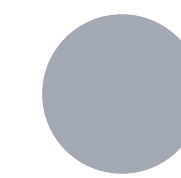

Commissions are installed in new or reconstructed City-owned buildings and structures.

**COURTHOUSES · PARKS · HEALTH CENTERS
CULTURAL INSTITUTIONS · ESPLANADES
POLICE PRECINCTS · CHILDRENS SERVICES
STREETSCAPES PLAZAS · LIBRARIES ·
FERRIES SCHOOLS · MEMORIALS · FIRE
STATIONS DETENTION CENTERS · ANIMAL
CARE CENTERS · EMERGENCY ASSISTANCE
CENTERS**

Goals and Distinctive Competency

NYC Percent for Art

1

PERMANENCE

Projects last for
+40 years

2

ACCESSIBILITY

All located in
spaces open to the
public

3

COMMUNITY PARTICIPATION

Active in all
phases of Percent
for Art process

4

LOCAL AGENCIES

Partnership with all
city agencies

5

ARTISTIC DIVERSITY

Commission artists
worldwide

“My perspective on public art is that it needs to be site specific – it needs to fit its site and community”

Patrick Dougherty

Percent for Art In Numbers

Percent for Art Projects

Since 1983: 385 projects, \$92M

Today: 125 projects in progress, \$30M

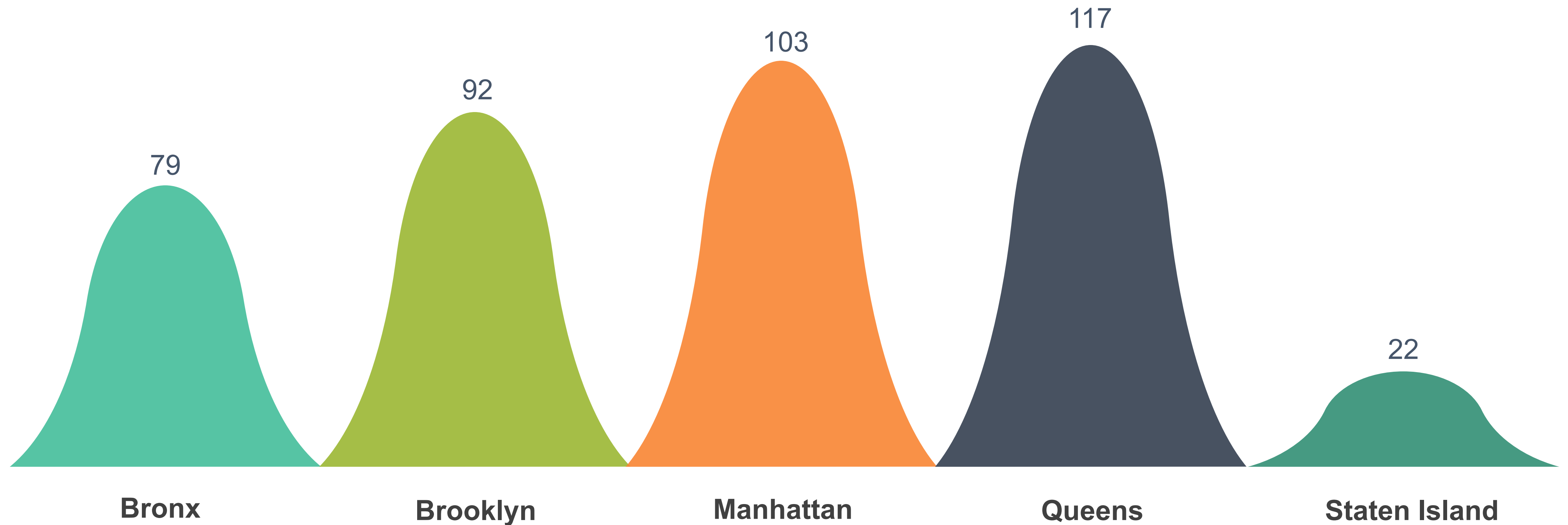

WHAT IS THE PROCESS FOR COMMISSIONING A NEW WORK OF ART?



Bill and Mary Buchen
Sound Playground, 1992
2151 Washington Avenue, Bronx

Timeline

NYC Percent for Art

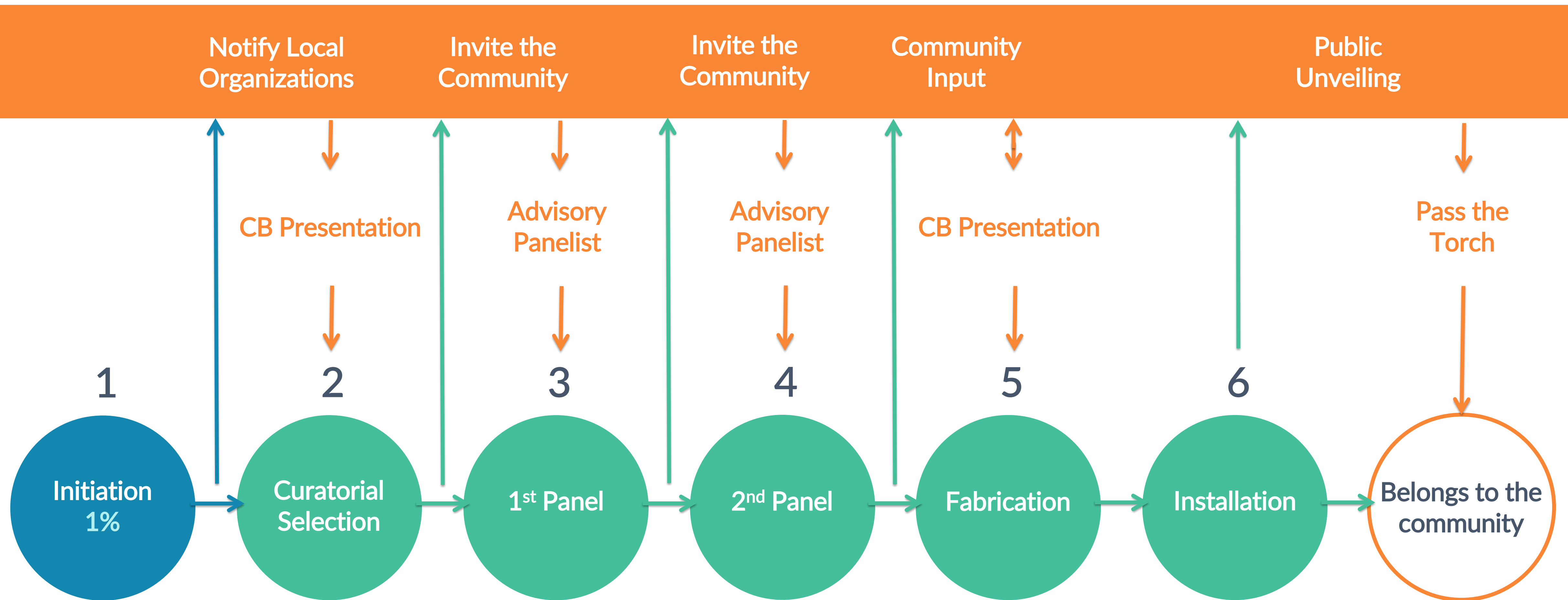

Artist Selection Process

New Recreation Center at Roy Wilkins Park

NYC Percent for Art

First Panel Meeting

Early October 2025

- Introduction to Percent for Art
- Design Team presents the project, **highlighting potential artwork locations**
- **Community context and insights are shared by stakeholders**
- **Review past work of artists** under consideration presented by DCLA
- **Voting and Advisory panel members narrow the list to identify finalists** and alternates to invite to create a site-specific proposal.

Artist Orientation

Mid October 2025

- Finalists are **briefed on project** specifics including potential artwork locations
- Finalists **receive documents** to assist with proposal development: site drawings / plans / renderings, fabricator resources, draft contract agreement
- **During proposal development, Finalists meet with Percent for Art staff multiple times** to check-in on progress, answer questions, prep for the presentation at Second Panel Meeting.
- Finalists are given a **\$500 honorarium from DCLA for the proposal development phase.**

Second Panel Meeting

Mid December 2025

- Each finalist presents a **site-specific proposal**, followed by Q&A from the panel
- Discussion among Voting and Advisory Panel Members
- Final selection determined by Voting Panel members
- Selected artist is awarded the commission and notified by DCLA.
- Finalist proceeds to contract with Design Team

Artist Selection Panel Composition

NYC Percent for Art

Chaired by DCLA Assistant Commissioner for Public Art or designee

Voting Panelists

- Representative of Percent for Art (DCLA)
- Representative of Design Agency (DDC)
- Representative of Sponsor Agency (Parks)
- Three representatives of the public who are arts professionals - knowledgeable about public art, the project, and the community in which the project will be located

Advisory Panelists

- Architect / Design Team
- Program Staff (DCLA, DDC, NYC Parks)
- Public Design Commission (PDC)
- Local Borough President, Council Member and Community Board Representatives
- Local organizations and community groups
- General public

Artist Selection Panel Considerations

NYC Percent for Art

- Commission artwork of the highest caliber possible
- Set a national example for public art commissioning, while reflecting contemporary art practices.

- **Appropriateness** to the site's architecture, function and users
- **Skilled craftsmanship**
- **Clarity of artistic vision**
- Consideration of the **costs and durability**
- That the artist's public commission is **true to their sensibility**



Jane Benson

"Mirror Globe (Mapping the New World)" 2012

IS HS 585, Queens

Budget

NYC Percent for Art

Art budget must be at least \$100,000

New Recreation Center at Roy Wilkins Park Budget: Approx \$730,000

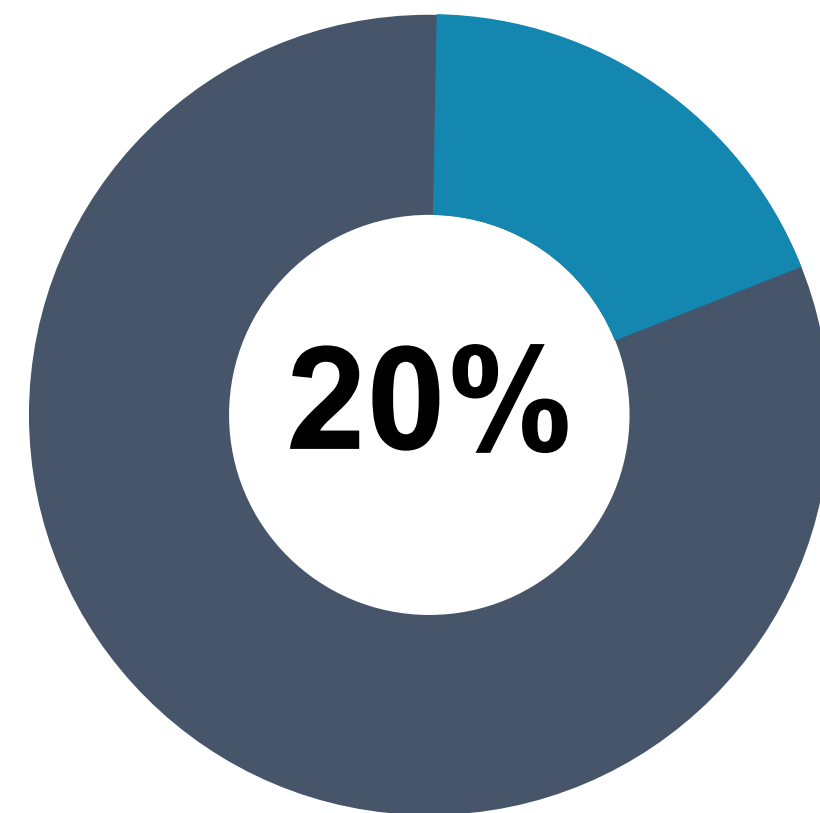

Artist's Fee

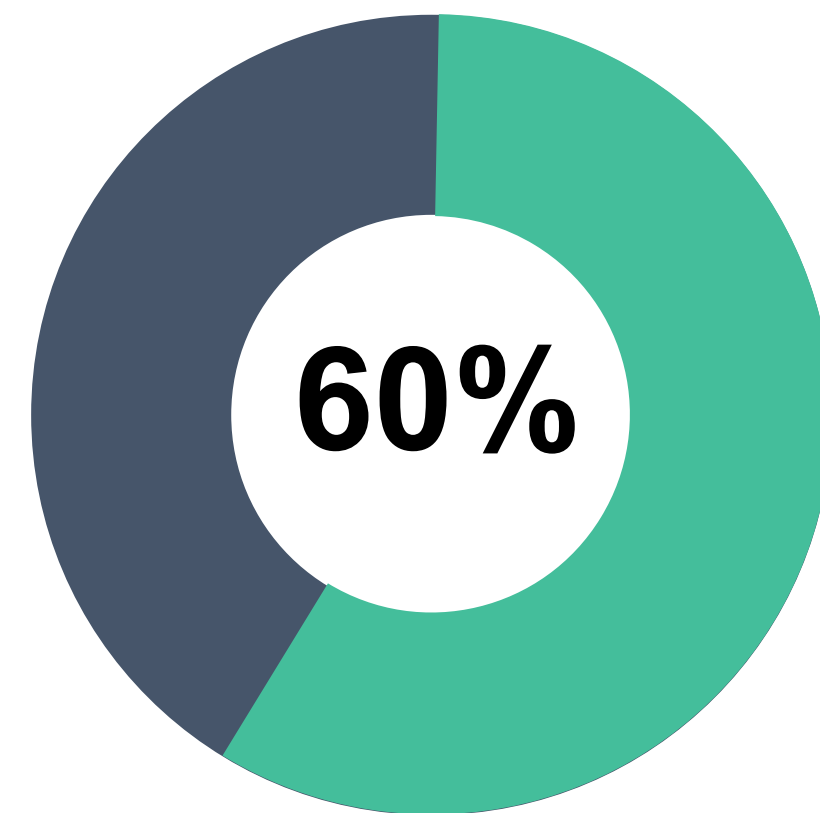

**Fabrication &
Installation**

Material and Tools
Labor (Fabrication/Installation)

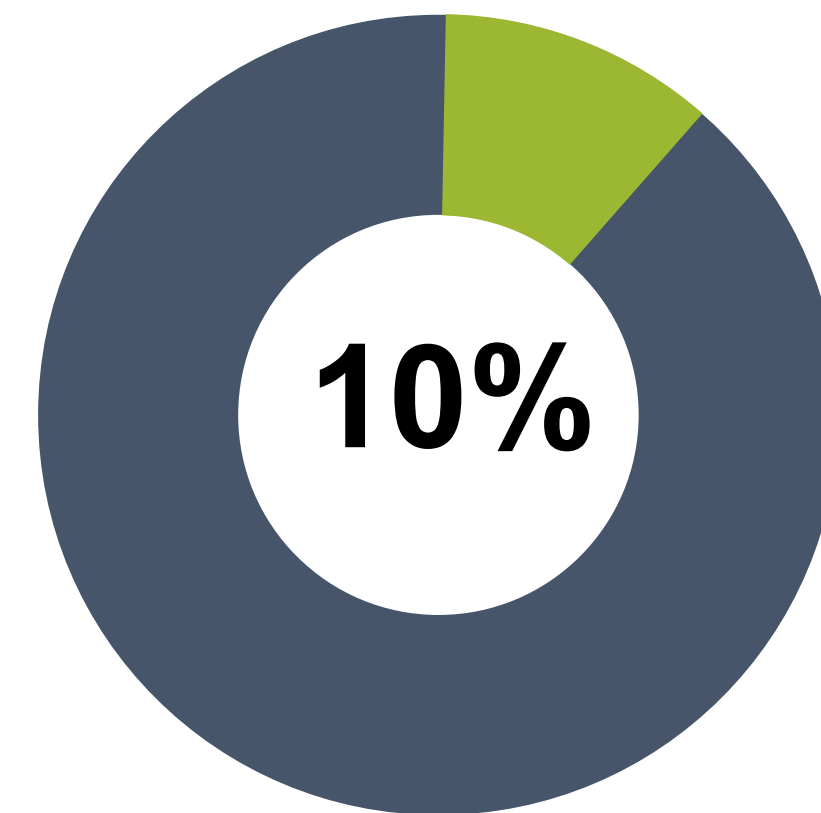

**General
Expenses**

Professional Fees
Documentation

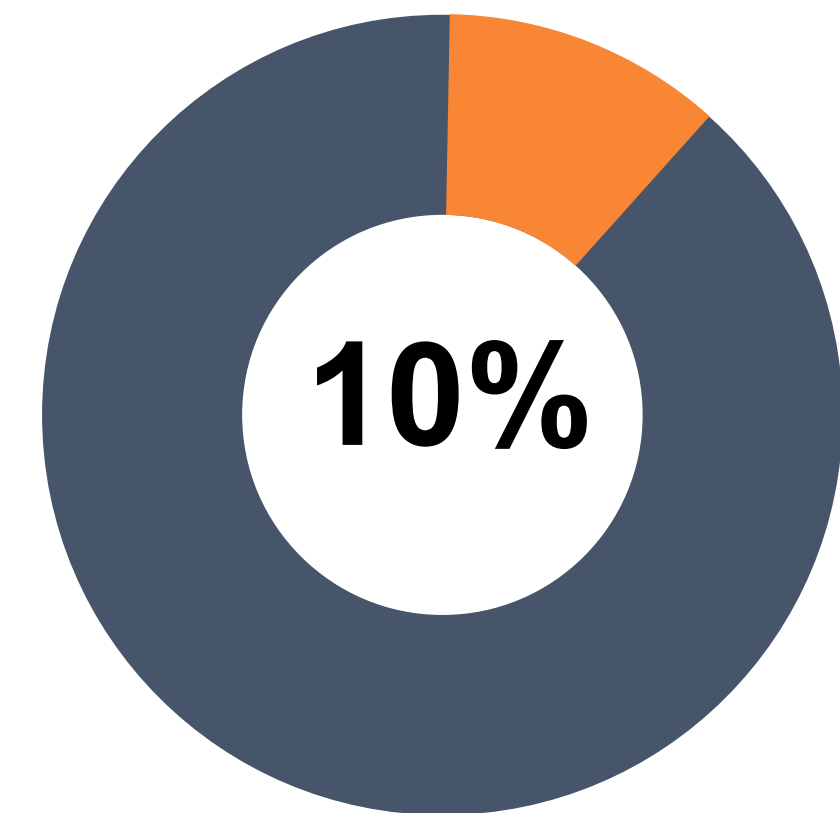

Contingency

Artist Criteria

NYC Percent for Art

WHO IS ELIGIBLE

- Professional visual artists or artist teams, working in any and all media
- At least 18 years of age and authorized to work within the U.S.

OPEN CALL FOR ARTISTS

- Artists may express interest by sharing materials to the **Artist Directory**
- Submissions are accepted on an ongoing basis.
- Artists may express interest in specific projects by sharing materials before a posted deadline
- Once on file, artists are eligible to be considered for all upcoming Percent for Art opportunities
- The artist call is one of the methods DCLA uses to develop the artist pool for the first artist selection panel meeting



Misha Kahn

QPL Douglaston-Little Neck Library
In situ rendering, PDC Preliminary Design,
2023

Artist Directory

NYC Percent for Art

How To Join Percent for Art Directory:

1. Artist Form (download and complete)
2. Images of Work (shared via a link to folder)
3. Email Form and Link to: PercentInfo@culture.nyc.gov
4. Confirmation reply sent by DCLA

**Join Directory by September 19, 2025
for New Recreation Center at Roy Wilkins Park**



Nobuho Nagasawa
Luminescence, 2018

Hunter's Point South Park, Long Island City 11101

Artist Directory

NYC Percent for Art

Artist Directory Form

- **General Information**
 - Contact Information
 - Link to website or professional social media account
 - Gallery Information (If relevant)
- **Artist Statement**
- **Artist Bio**
- **Image list**



Allan McCollum

Collection of Nine Hundred and Fifty-Five Shapes, 2022

Elmhurst Library

86-07 Broadway, Elmhurst, NY 11373

Artist Directory

NYC Percent for Art

ARTIST STATEMENT (max. 550 characters)

Explain your creative process, including your motivations, inspirations behind, mission, and methods. Include your choice of mediums and use of tools and techniques. The artist statement should cover the “why” you do things and not the “who you are”

Helpful tips:

- **Use plain and simple language.** Avoid over complicated art-speak. (write for a general audience)
- Write in the 3rd person (as if statement will be read by a narrator)
- **Focus on the uniqueness of your practice** – intentions / themes, intended impact, aesthetic choices, artistic process and approach to community and collaboration, materials
- Read the statement aloud. Is it easy to understand? **Does the Artist Statement connect with what is expressed by the visuals?** Imagine the statement being read by someone else while looking at your work.
- Do not include biographical information (*only unless directly relevant to your work). Do not list training, residencies, exhibitions, awards, etc.

Artist Directory

NYC Percent for Art

ARTIST BIO (max. 550 characters)

A brief description of your life, “who you are” and artistic career.

Helpful tips:

- This section is where you can summarize your life story - **personal and professional background and accomplishments.**
- **Highlights from your resume and artistic career.**



Mark Dion

The Threshold of Knowledge, 2022

PS131 Abigail Adams

170-45 84th Avenue, Queens NY 11432

Artist Directory

NYC Percent for Art

ARTWORK IMAGE FILES

- Share 10 - 15 images which represent your body of work
- Save each file individually as [LAST NAME] _[Firstname]_[Image#]
- Save each file in jpeg format, minimum 1024 x 768 px.
- Use a file sharing platform of your choice, such as WeTransfer, Google Drive, OneDrive
- Include the file sharing link in the body of the email sent when submitting the form
- Use the fields in the form to provide details for each of the corresponding 15 images you share

Helpful tips:

- Select examples that best represent your practice and potential approach to public art.
- Share a variety of image types: In situ, detail, with public interaction, etc. You may provide more than one image of the same work.
- Performance-based or video works can be represented by a still image. (include a video link on the form)
- Sharing a rendering from another proposal is acceptable. (max 2)
- Check expiration date of file transfer
- DO NOT share a pre-conceived proposal for a Percent for Art project

Artist Directory

NYC Percent for Art

Important Links:

DCLA Artist Directory:

<https://www.nyc.gov/site/dclapercentforart/registry/registry-about.page>

DCLA Current Opportunities:

<https://www.nyc.gov/site/dcla/publicart/opportunities.page>

Questions or to Share Materials:

PercentInfo@culture.nyc.gov

Paul Villinski
Skycycles, 2015

Ocean Breeze Athletic Complex
625 Father Capodanno Blvd, Staten Island, NY 10305



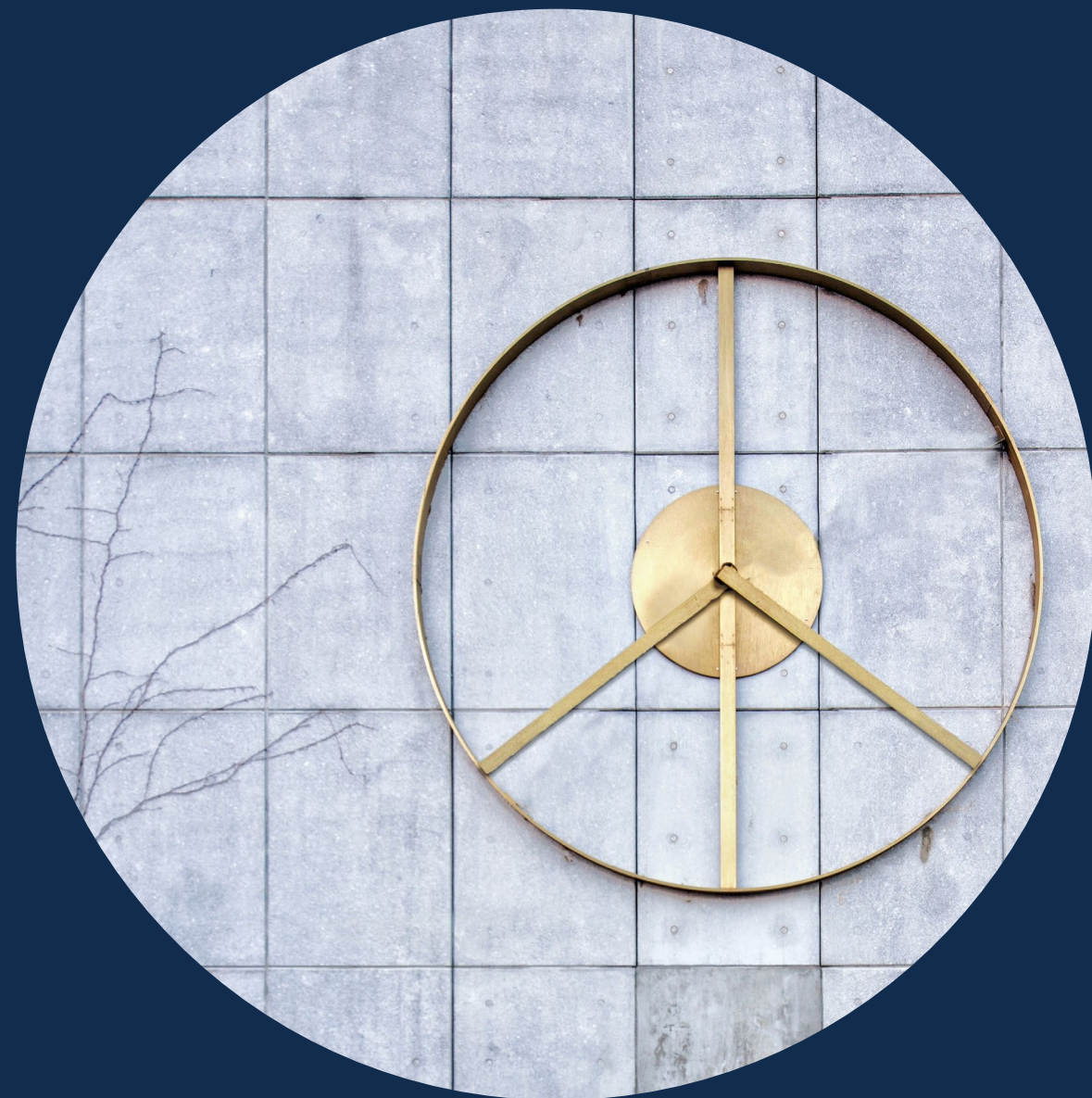

NYC Cultural
Affairs
Percent *for* Art

Thank you

NEW RECREATION CENTER AT ROY WILKINS PARK

NYC Percent for Art Program — Information Session

September 4, 2025

New Recreation Center at Roy Wilkins Park – Project Scope

The project aims to construct a new 67,000 SF recreation center in Roy Wilkins Park, located in the St. Albans neighborhood of Queens. Intended to serve as a year-round hub for sports, fitness, education, and the arts, the facility will offer amenities such as a gymnasium, indoor track, swimming pool, fitness rooms, and multipurpose spaces for all age groups. This project reflects New York City's commitment to sustainable design, equity, and high-quality public infrastructure. The recreation center will serve as a safe, inclusive, and pedestrian-friendly public amenity, reinforcing the bond between Roy Wilkins Park and the broader St. Albans community.

Borough Map - Queens

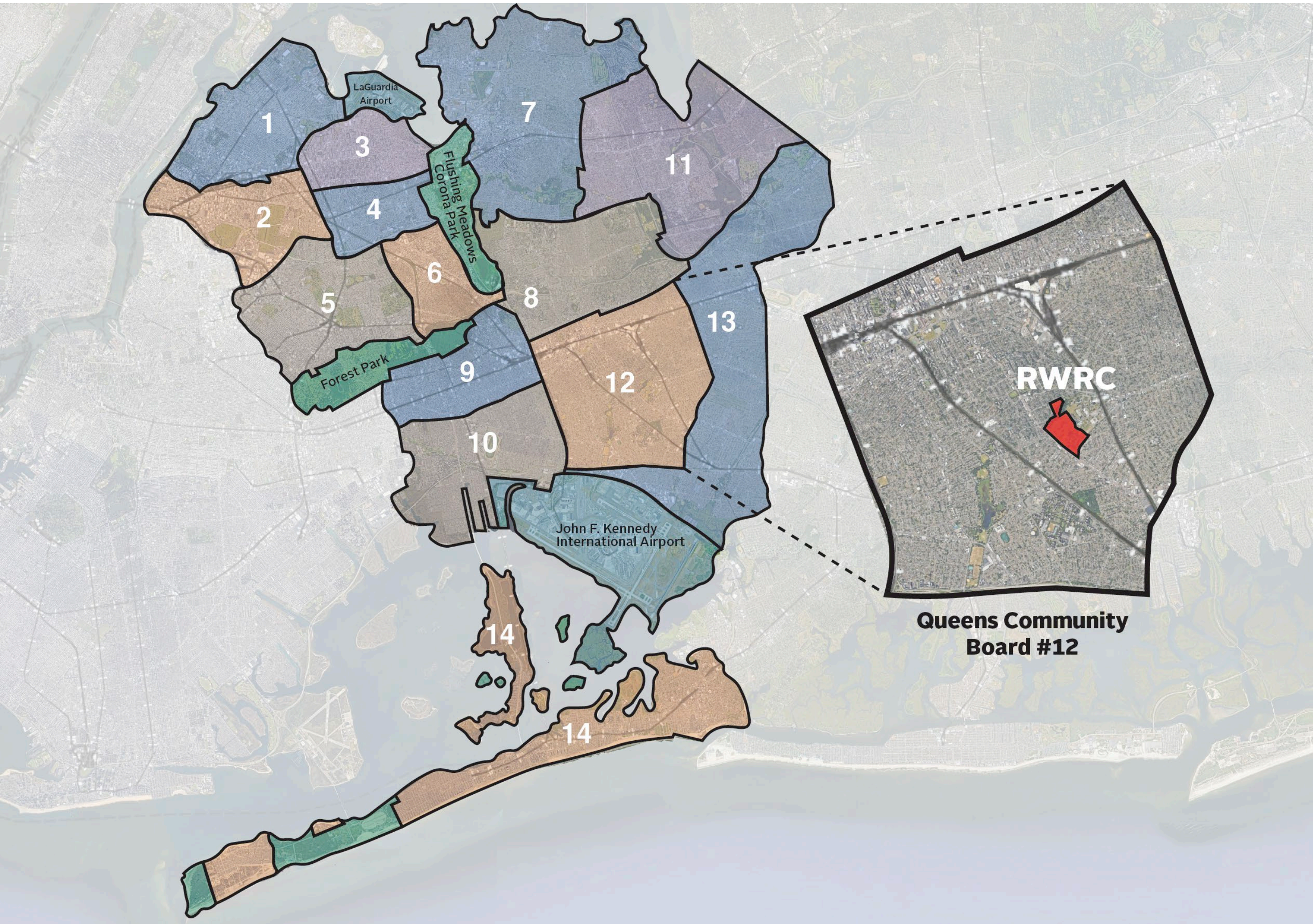

Community Board Districts

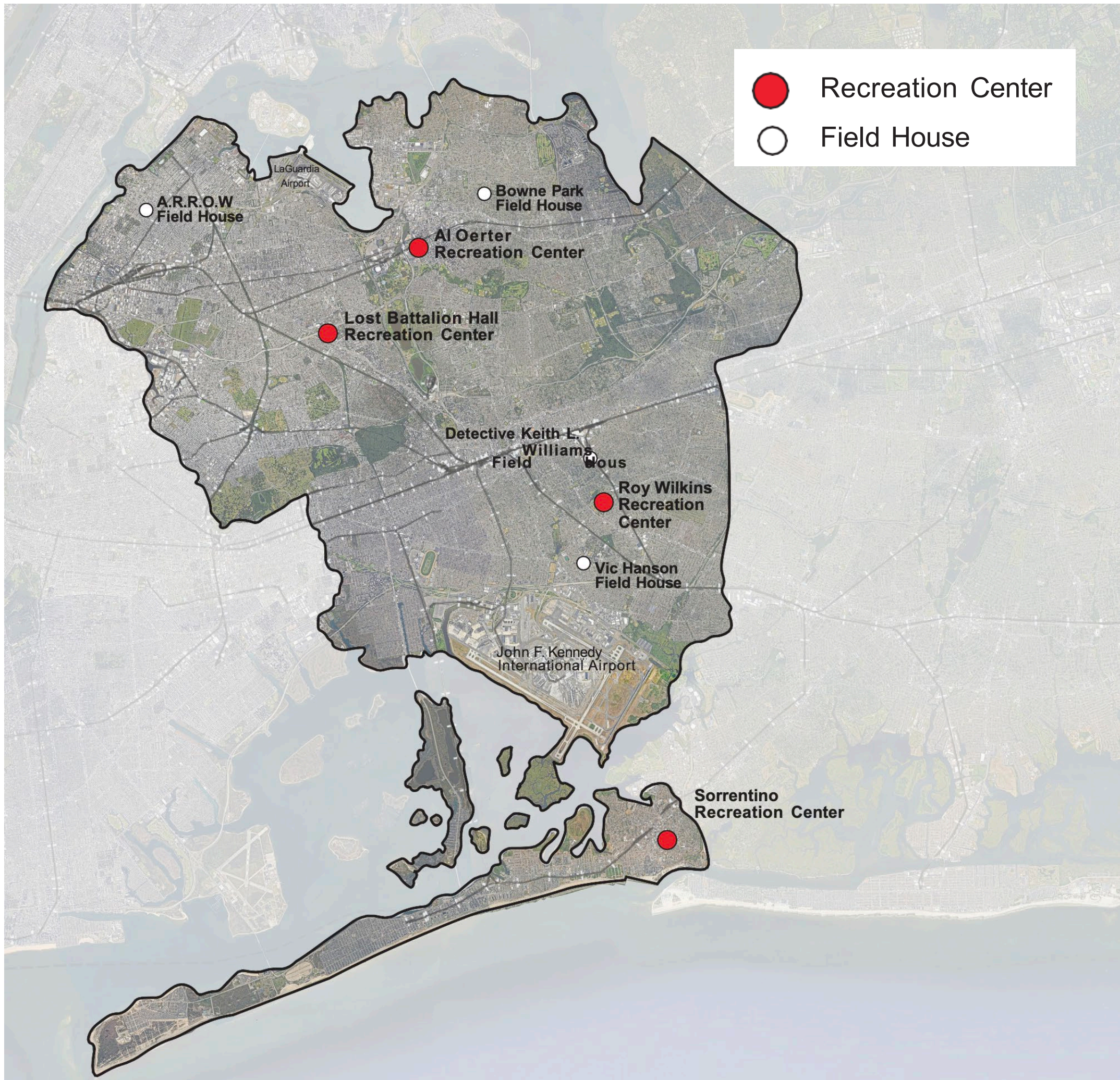

Recreation Center Location Plan



St. Albans VA
Medical Center

St. Albans
Veterans Home

Roy Wilkins Park

400 Ft Radius

Baisley Blvd

Merrick Boulevard

Marsden Street

Babylon Branch
Rail Route

Montauk Branch
Rail Route

- Commercial Area
- Parks
- Train (MTA, LIRR, and AirTran)
- Trails / Bicycle-friendly Roads
- Bus Routes
- Bus Route Symbols
- Bus Stops

RWRC Percent for Art Schedule (subject to change)

	Task	Projected Date	Art Milestone
Percent for Art	DCLA QN-CB invitation	October 2024	
Capital Project	Design Kickoff	6/3/25	
Percent for Art	Art Agreement	January 2026	Milestone A
Percent for Art	Community Board	Spring 2026	
Percent for Art	PDC Art Conceptual Review	Spring 2026	Milestone B
Capital Project	Design Completion (100% CDs)	Spring 2026	
Percent for Art	PDC Art Preliminary Review	Fall 2026	Milestone C
Capital Project	Construction commences	Late 2026	
Percent for Art	Notice to Fabricate	Early 2027	Milestone D
Percent for Art	Art Fabrication (100% Completion)	Late 2028	Milestone F
Percent for Art	Art Installation	Summer 2029	Milestone G
Capital Project	Construction Substantial Completion	Summer 2029	
Percent for Art	Final Acceptance	Fall 2029	Milestone H

DESIGN, FABRICATION AND INSTALLATION OF NYC PERCENT FOR ART PROJECTS

OVERVIEW



ABOUT DDC'S PUBLIC ART PROGRAM

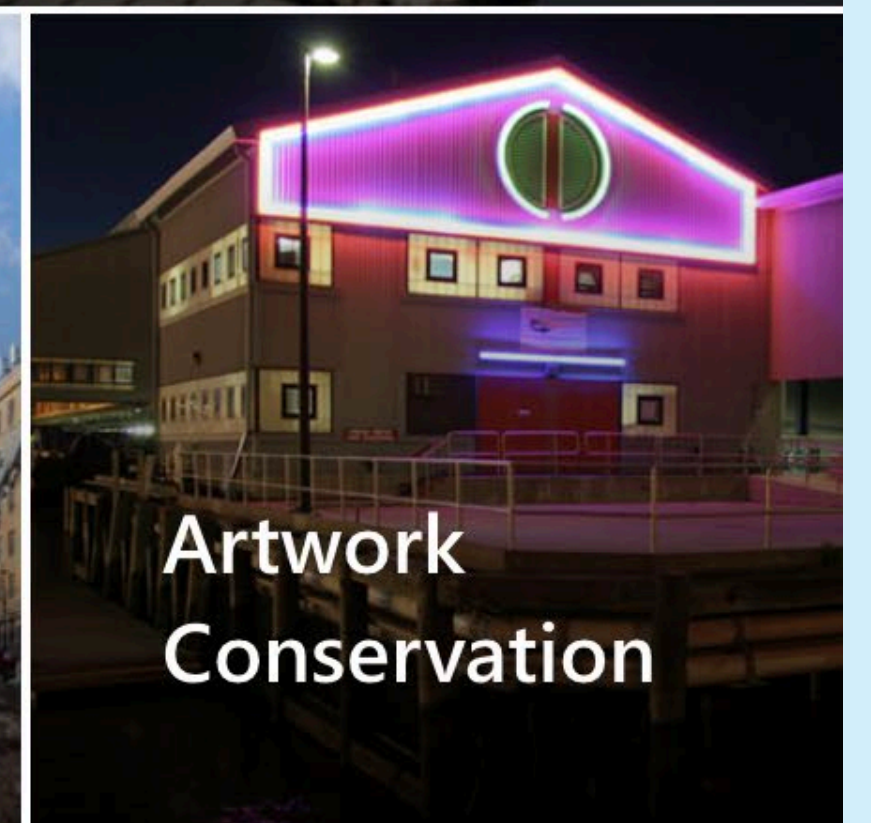
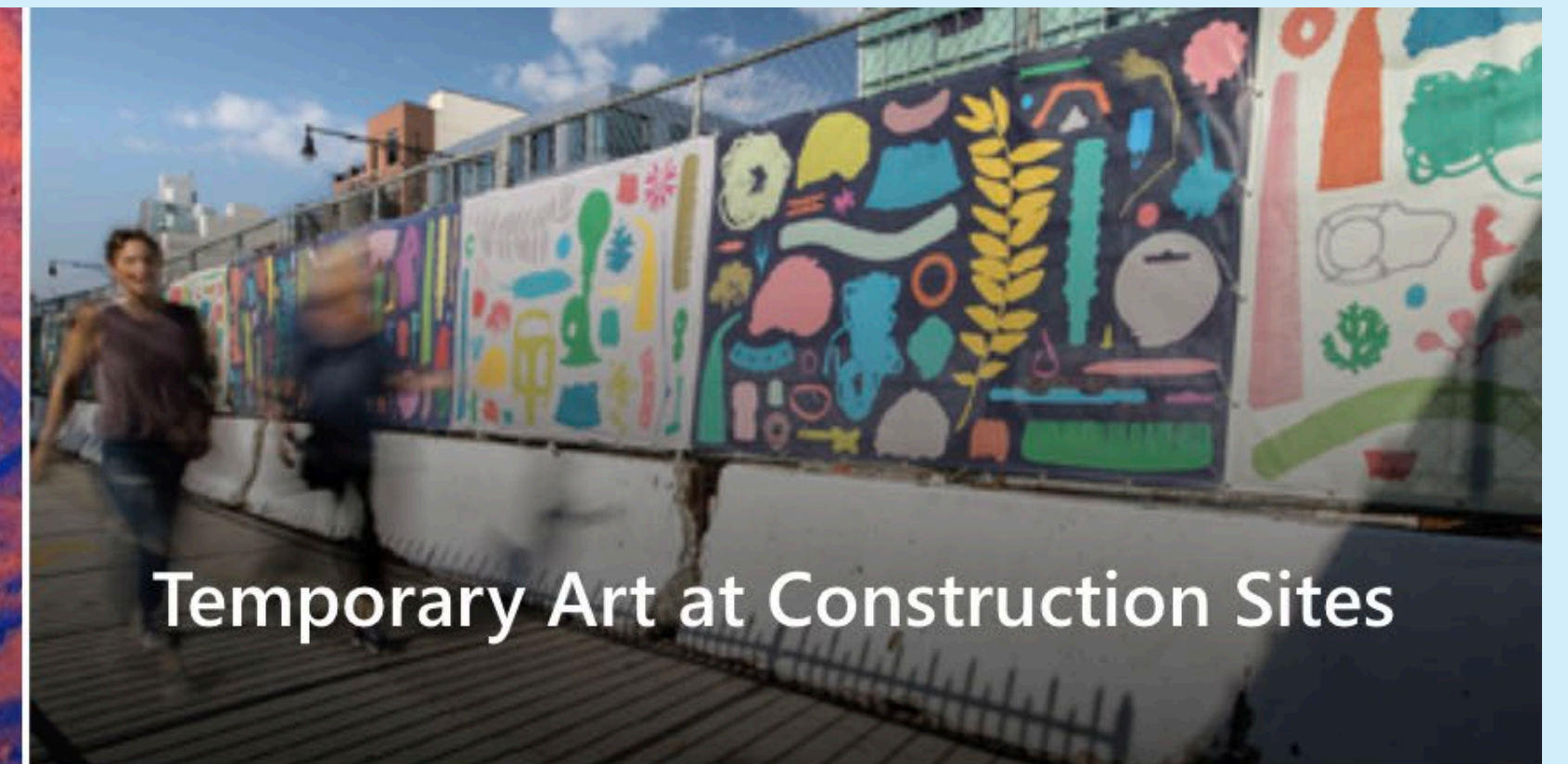

Percent for Art At DDC

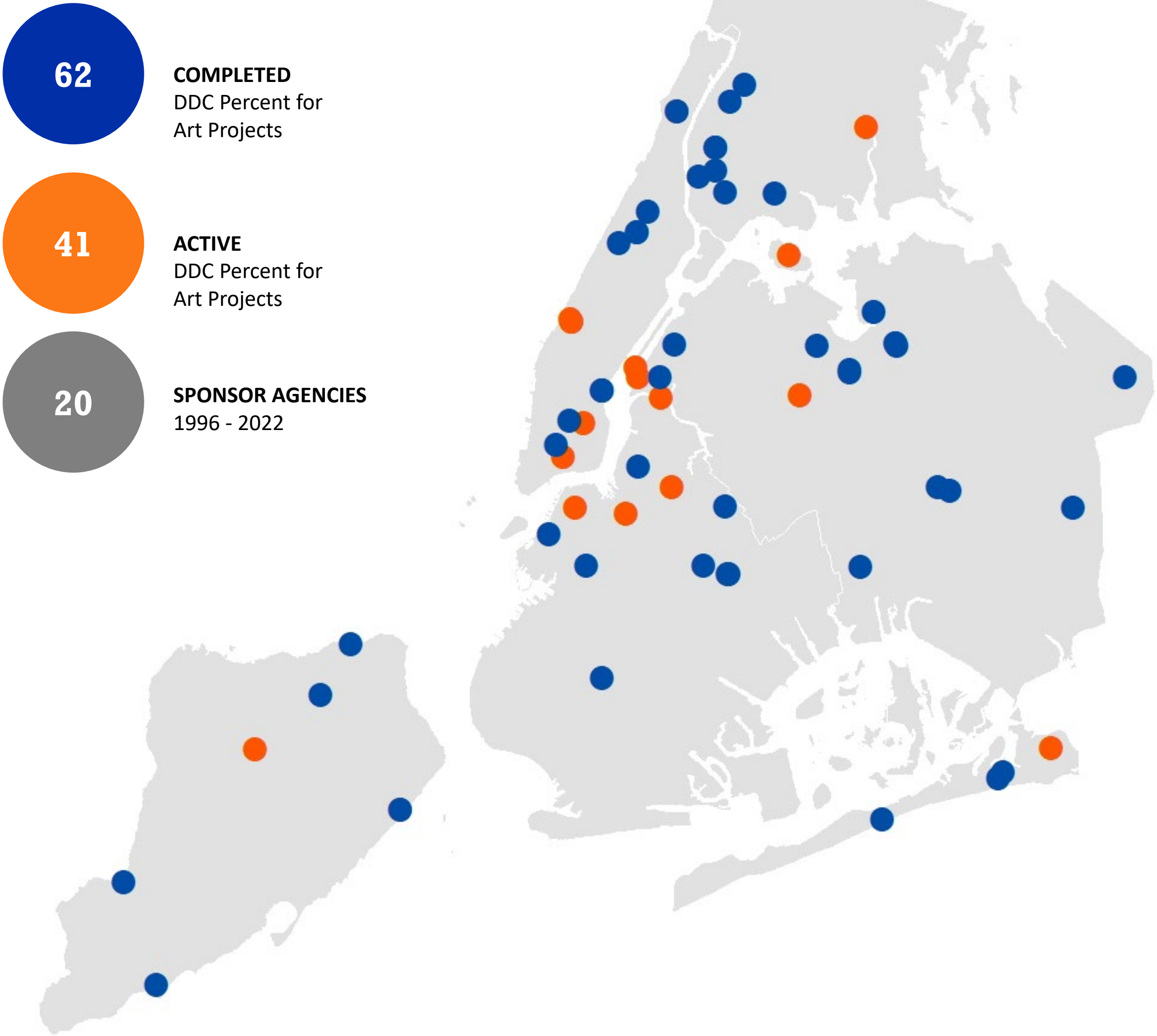



DDC PERCENT FOR ART PROJECT MANAGEMENT



NYC PERCENT FOR ART

DDC Art Milestones

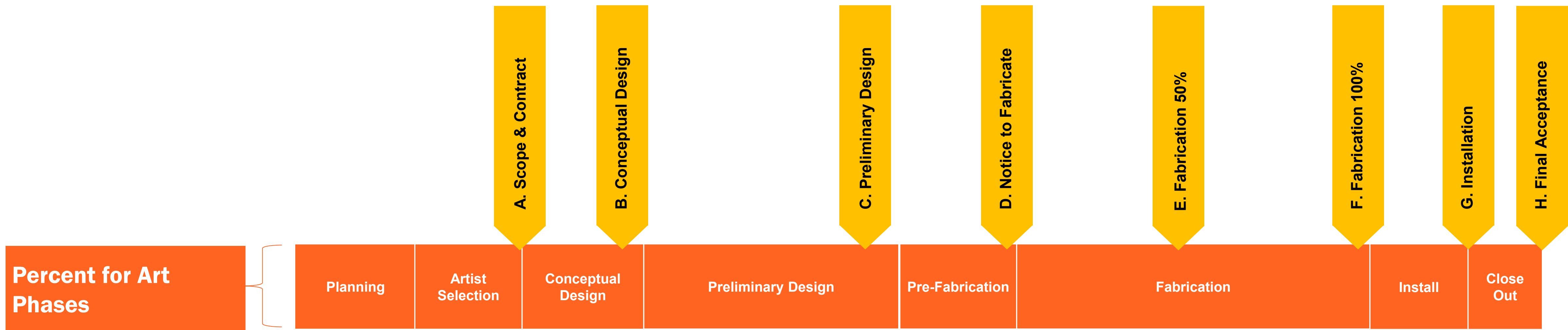

Core Review Group

Percent for Art projects are developed through a collaborative process that is composed of representatives of the project stakeholders. The team works together throughout the course of the project lifecycle from planning to artist selection, design through installation.

DEPARTMENT OF CULTURAL AFFAIRS	PROJECT SPONSOR	DEPARTMENT OF DESIGN AND CONSTRUCTION	PRIME CONSULTANT
The program established at the Department of Cultural Affairs to implement the “Percent for Art” law citywide.	The city agency whose capital construction funds are being expended for the eligible project, usually the agency operating and using the facility.	The City’s primary capital construction project manager.	The architecture or engineering firm that holds the primary contract with the City, with whom the artist usually enters into a contract.

CONTRACT

A percent for art contract is a legally binding agreement that details the commission and installation of public artwork. The Percent for Art contract covers details such as:

- Scope of services
- Payment structure
- Rights & responsibilities
- Insurance

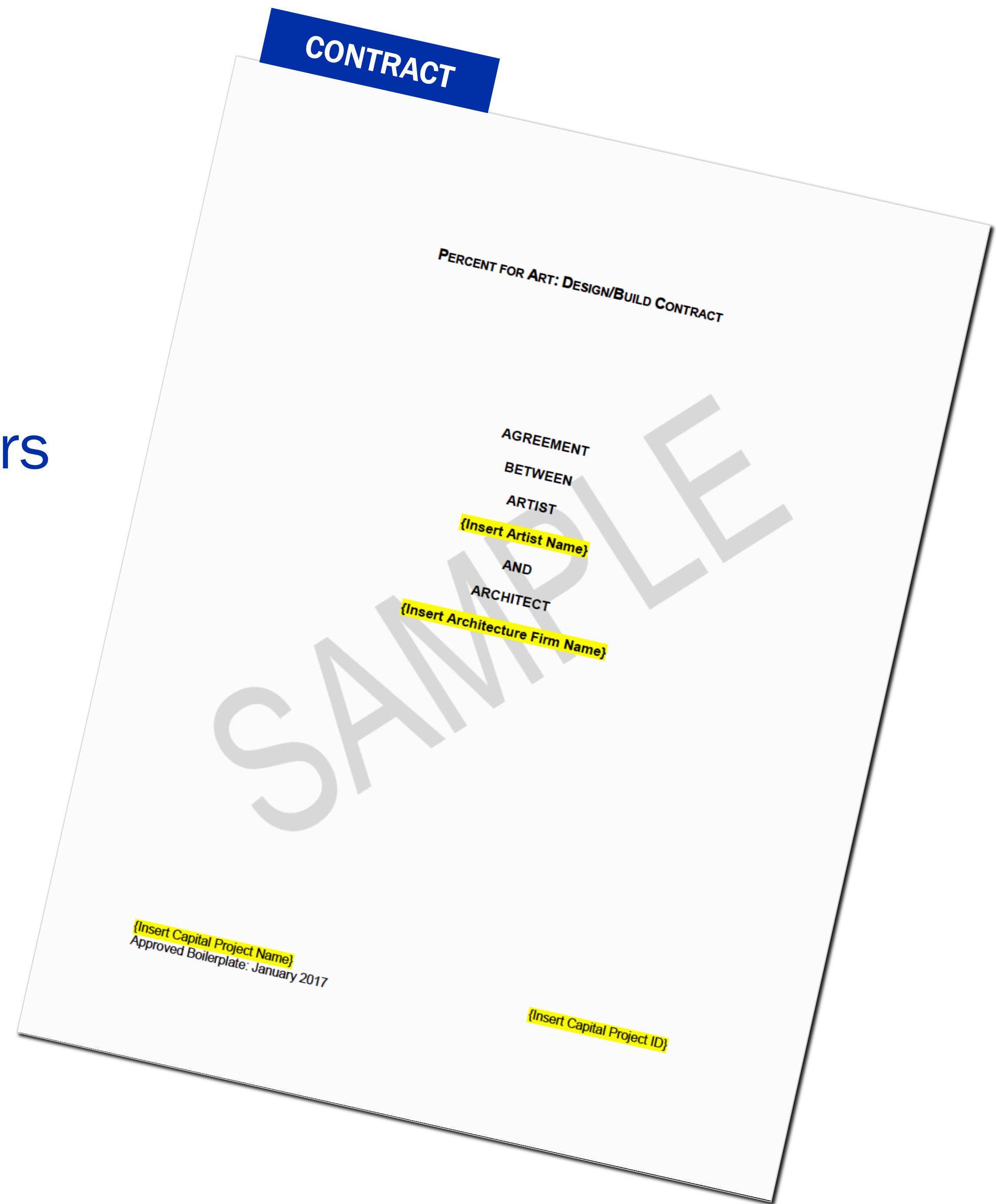

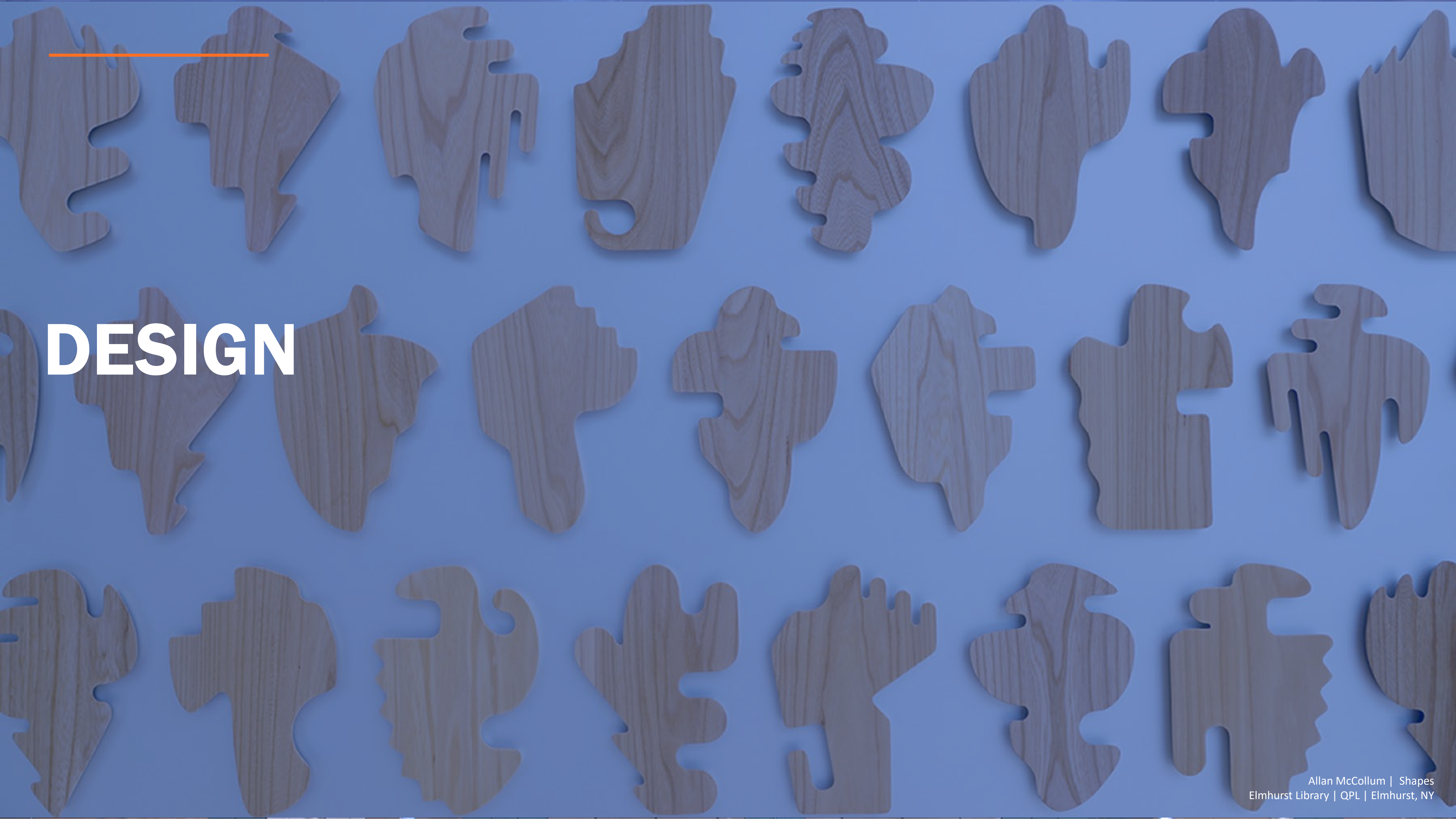

DESIGN

DDC Design Build Phases & Art Milestones

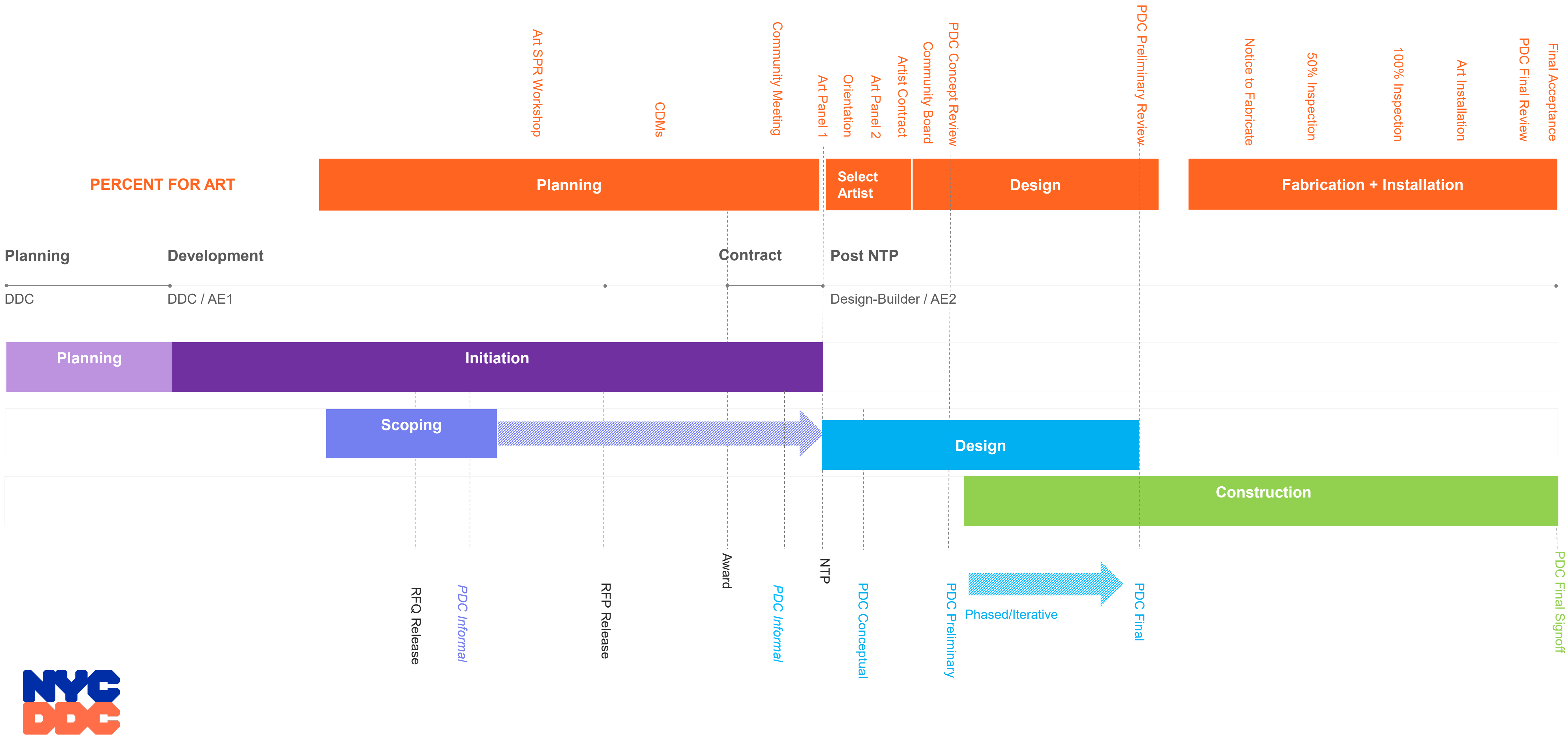

CONCEPTUAL DESIGN

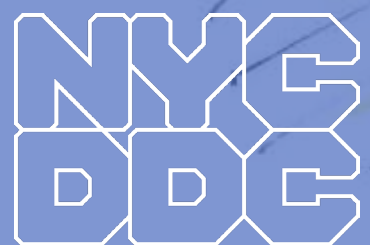



ARTIST MEETING WITH PROJECT TEAM

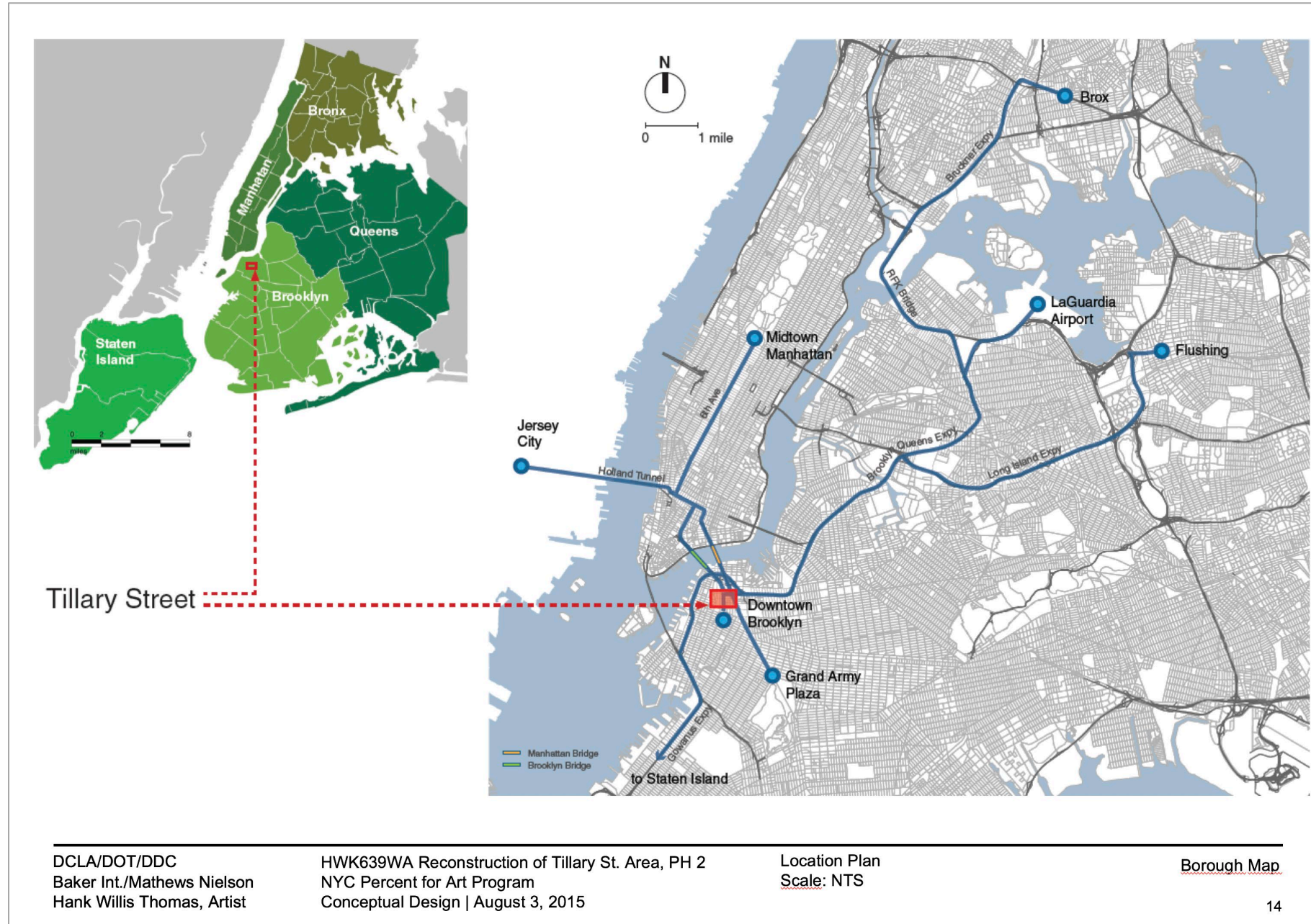
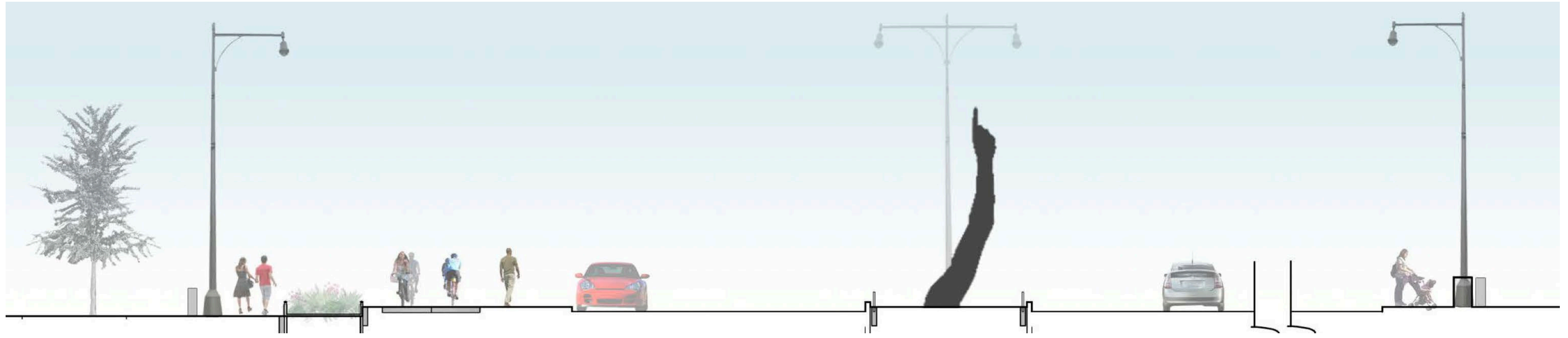
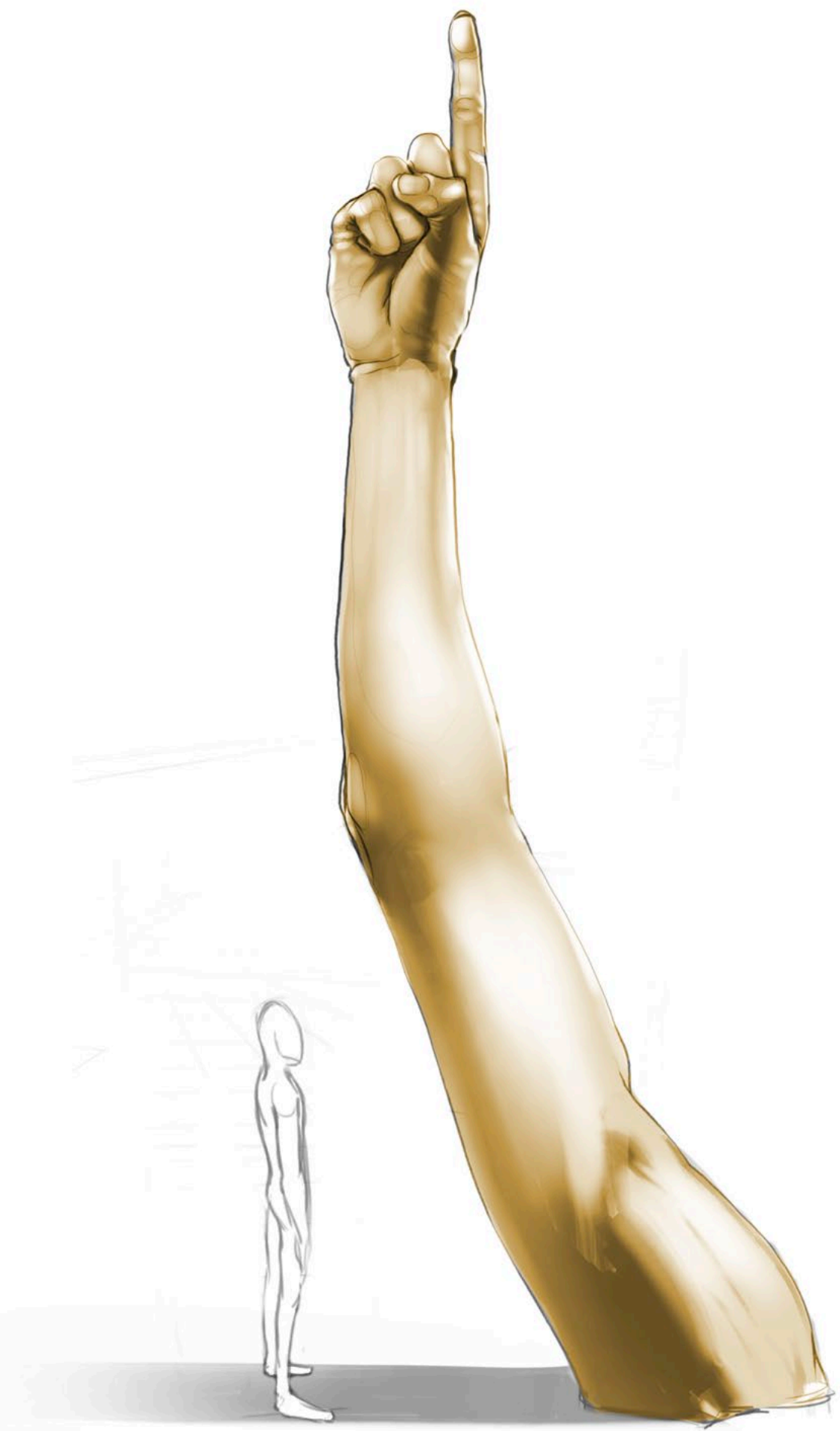

ARTIST DEVELOPS CONCEPT DRAWINGS



ARTIST PRESENTS AT COMMUNITY BOARD



ARTIST PRESENTS AT PUBLIC DESIGN COMMISSION

Shellyne Rodriguez
Grand Concourse Ph4 | DOT | Bronx

PRELIMINARY DESIGN



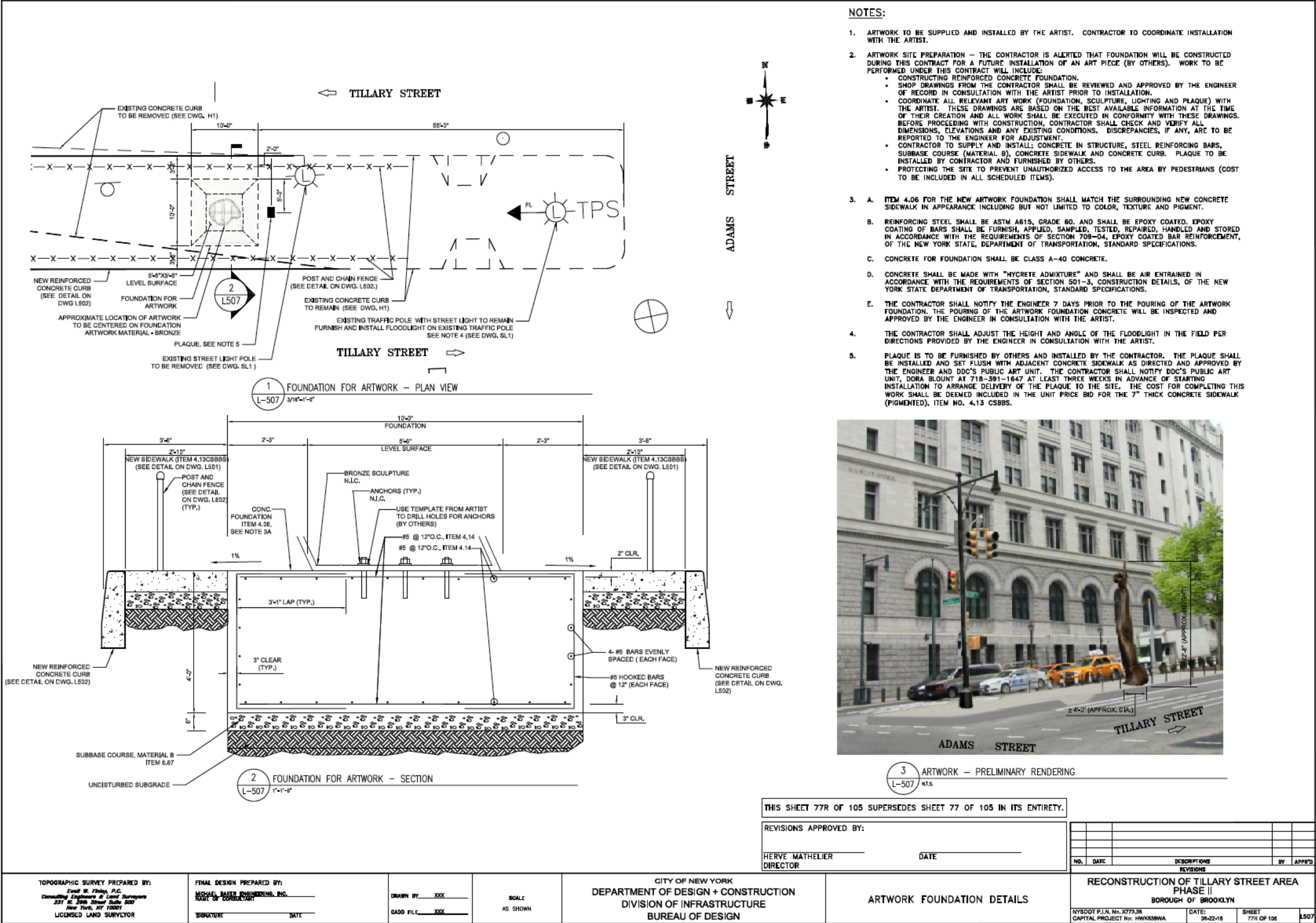
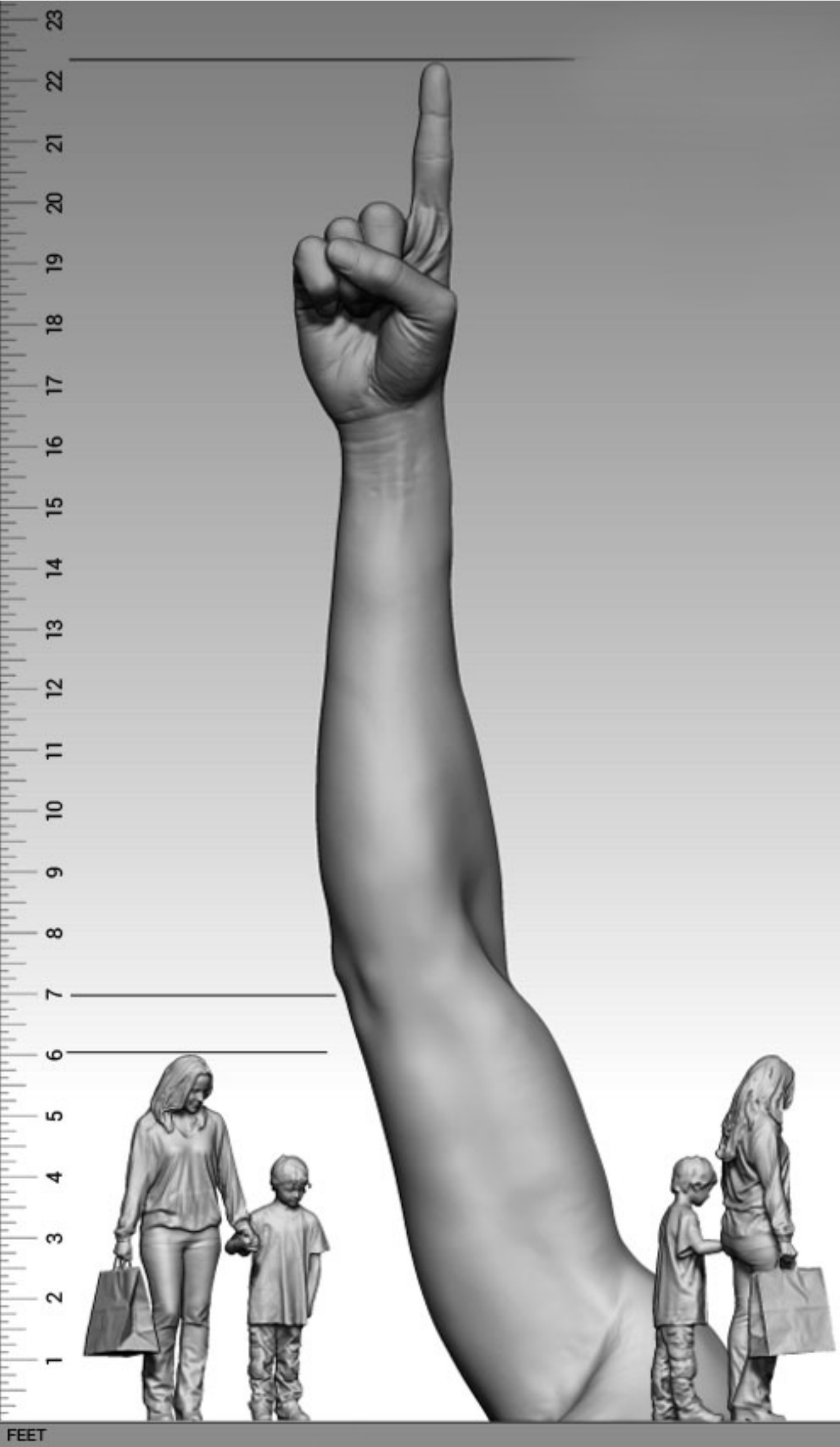

ARTIST DEVELOPS PRELIMINARY DESIGN

Hank Willis Thomas | *Unity*
Tillary Street ph2 | DOT | Brooklyn

THOMAS' "ONE"
BROOKLYN, NY

JENNINGS
8 SEP 17

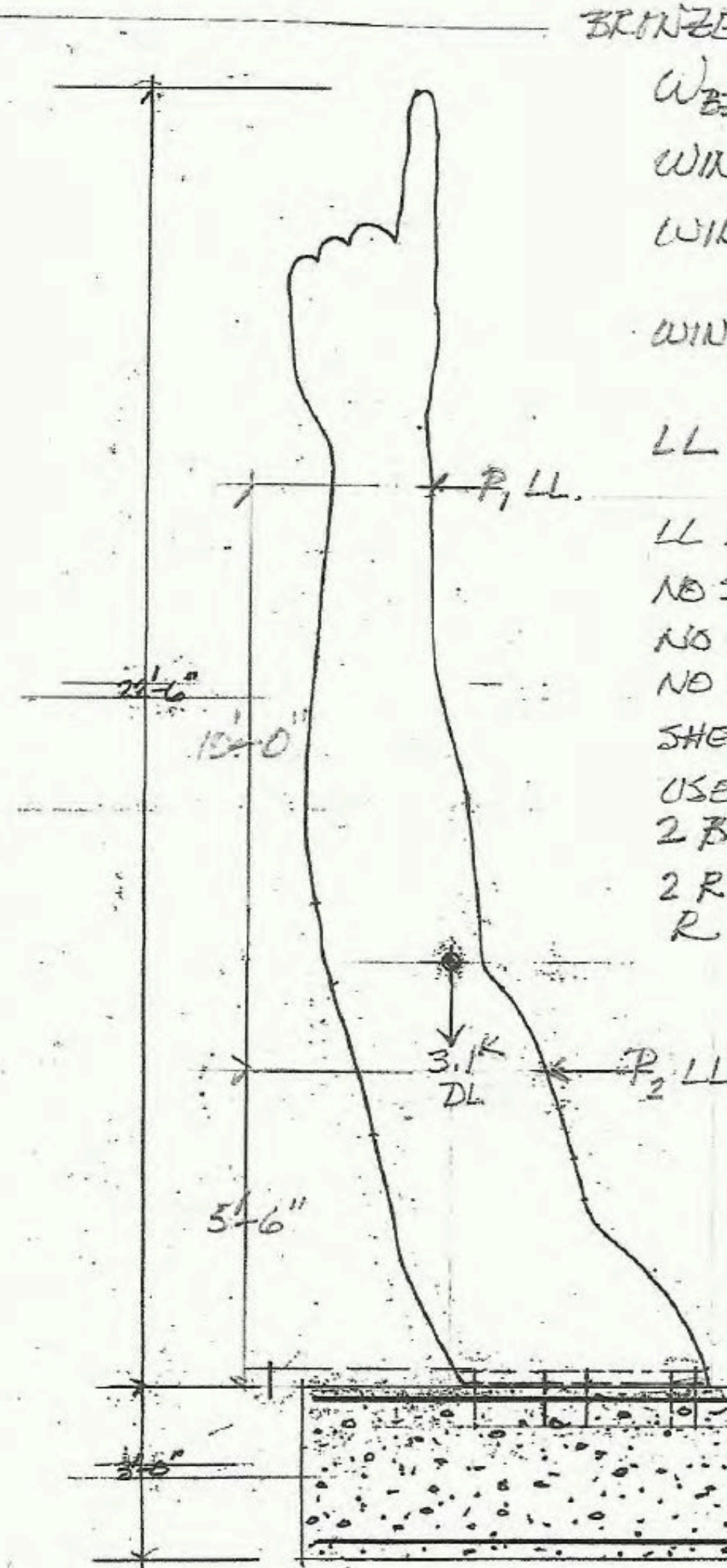

BRONZE CASTING: 192 SF @ 16 PSF.

$$W_{BZ} = 16(192) = 3072 \text{ LB} = 3.1 \text{ K}$$

WIND LL: 30 PSF

$$\text{WIND AREA: } A_1 = (9)(2) = 18 \text{ SF.}$$

$$A_2 = 11(5) = 55 \text{ SF.}$$

$$\text{WIND LOAD: } P_1 = 30(18) = 540 \text{ LB}$$

$$P_2 = 30(55) = 1650 \text{ LB}$$

$$\text{LL } M_o = 0.54(15.5) + (0.99)(5.5)$$

$$= 8.37 + 5.45$$

$$\text{LL } M_o = 13.8 \text{ K-FT} = 166 \text{ IN-K}$$

NO SHAPE FACTOR ASSUMED (CONSERVATIVE)

NO IMPACT LOAD ASSUMED.

NO INTERNAL FRAMING EXCEPT AT BASE

SHEAR AT BASE: 1.53 K

USE 8 BOLT LOCATIONS & ASSUME

2 BOLT @ 3'-6" TO RESIST M_o LL

2 R(3.5) = 13.8 K-FT (CONSERVATIVE)

$$R = 2.0 \text{ K} \pm$$

USE 3/8" SS THRD ϕ @ 18" OC \pm

DETAIL (2) $F_u = 70 \text{ KSI}$



1 ELEVATION 1/2" = 1'-0"

3 of 3

THOMAS' "ONE"
BROOKLYN, NY

JENNINGS
8 SEP 17

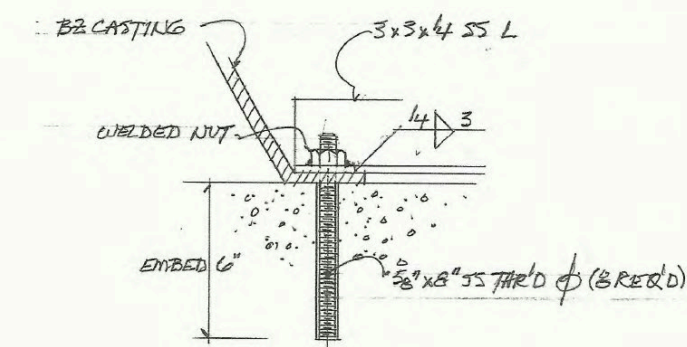

NOTES

- 1) ALL CAST BRONZE (BZ) ALLOY C.89300
- 2) ALL STAINLESS STEEL (SS) AISI 304
- 3) ANCHORS (AS FORD) TO BE 3/8" x 3/4" SS THRD ϕ : $F_u = 70 \text{ KSI}$
SET IN ALTI HIT-MIX 200-A INJECTABLE MORTAR
ONLY IN ACCORD WITH ALTI SPECS. SET INTO 3/4" HOLES
DRILLED ONLY WITH TEMPLATE BY PTX.
- 4) BZ TO SS FILLER METAL TO BE ERCUAL-A2: $F_u = 23 \text{ KSI}$

2 of 3

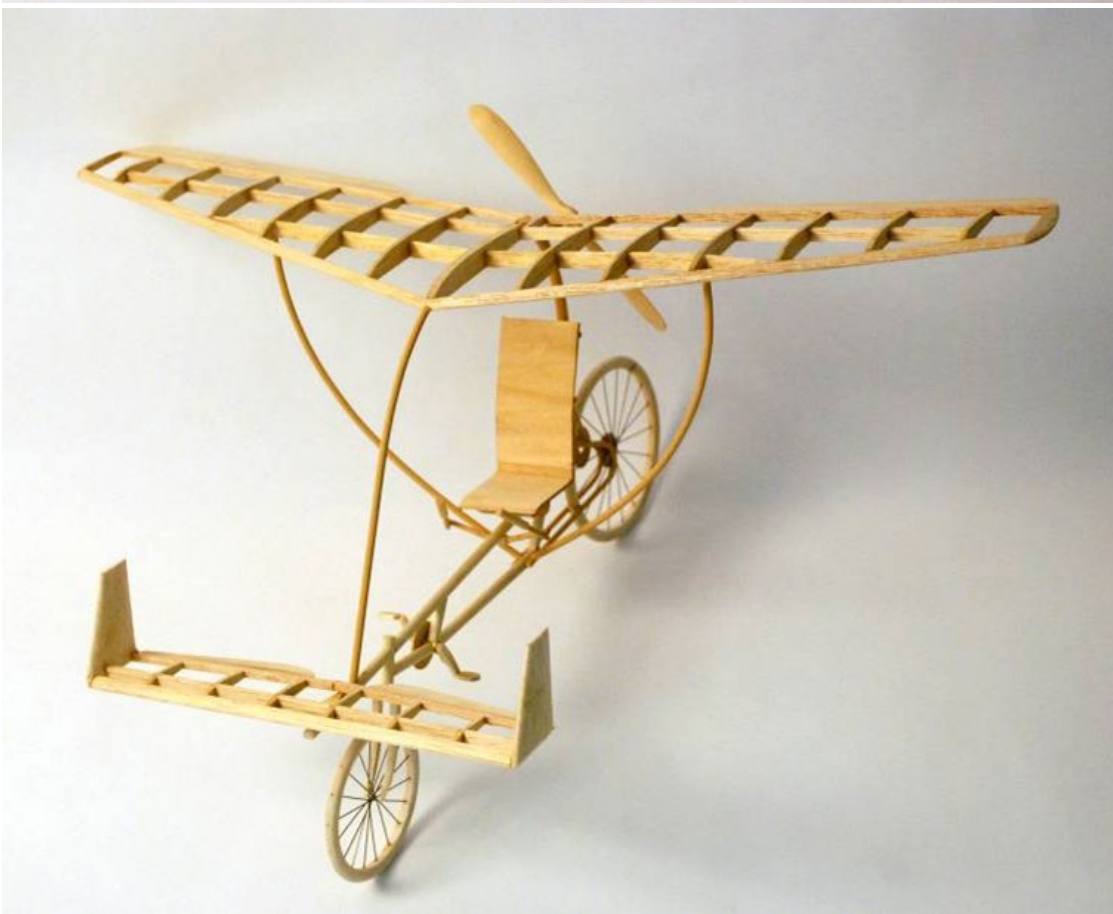

ARTIST MODELS

Paul Villinski | *Sky Cycles*
Ocean Breeze Athletic Center | DPR | Staten Island



ARTIST DEVELOPS PRELIMINARY DESIGN

Olalekan Jeyifous | *Colorful Companions*
Brooklyn Animal Care Center | DOHMH | Brooklyn

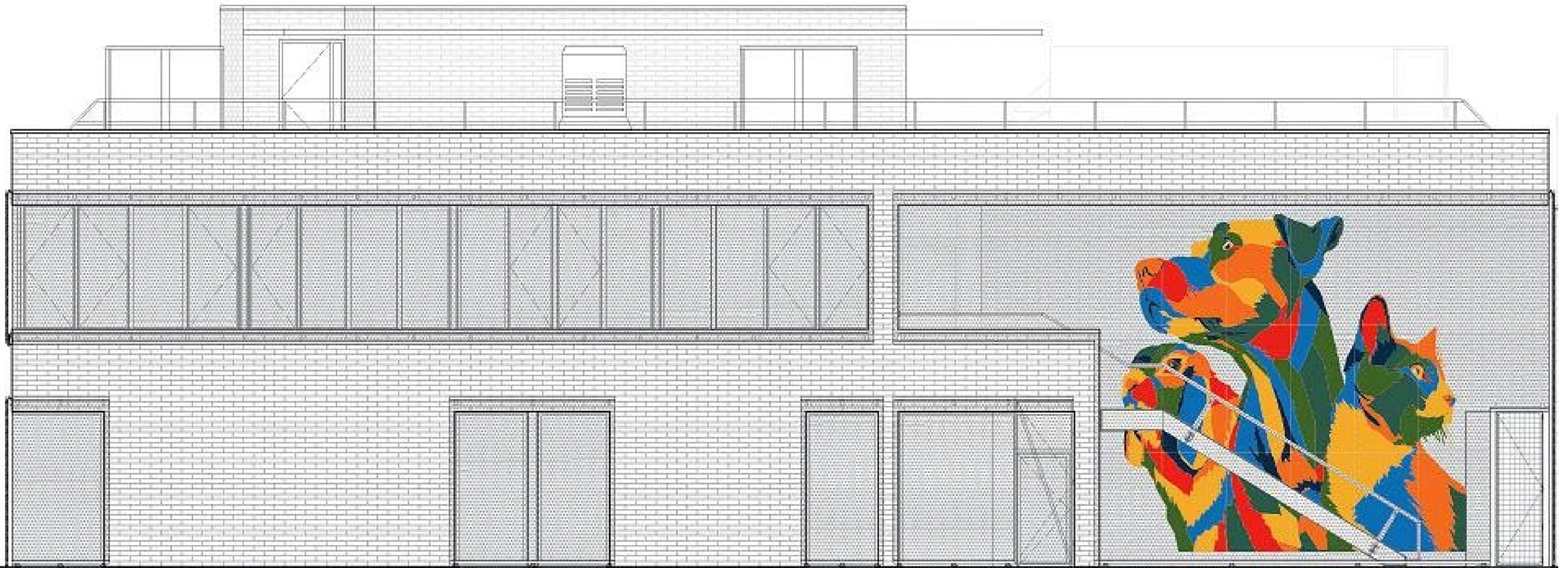

ARTIST DEVELOPS PRELIMINARY DESIGN

Olalekan Jeyifous | *Colorful Companions*
Brooklyn Animal Care Center | DOHMH | Brooklyn

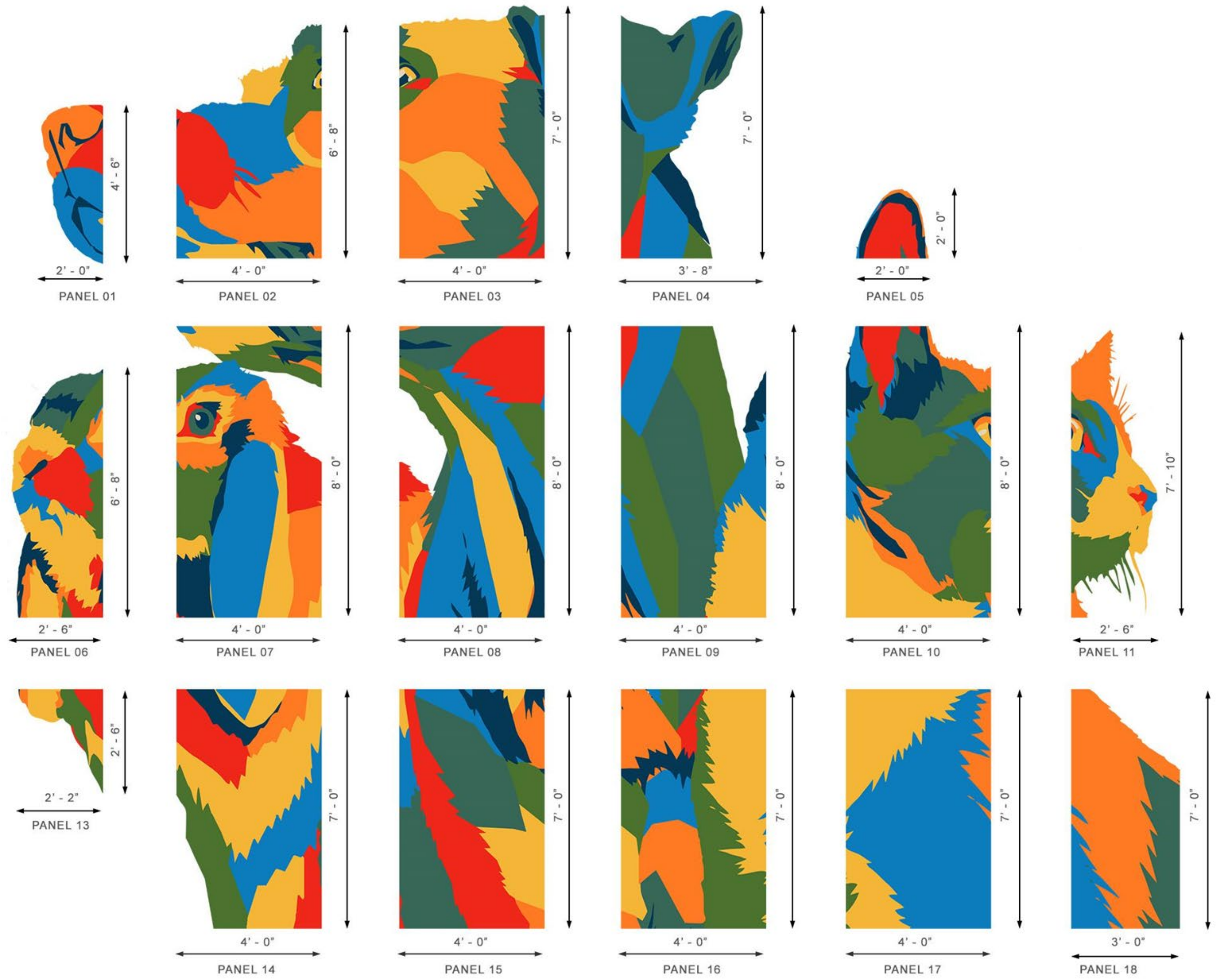

ARTIST DEVELOPS PRELIMINARY DESIGN

CONSTRUCTION



FABRICATION





ARTIST FABRICATION – 50% INSPECTION

Samm Kuncie | *Cross-Section*
Sunrise Yard | DOT | Queens



ARTIST FABRICATION – 50% INSPECTION



ARTIST FABRICATION – 50% INSPECTION

Julian LaVerdiere | *Sentinel Lanterns*
Engine Company 277 Ladder 112 | FDNY | Brooklyn



ARTIST FABRICATION – 100% INSPECTION

Lane Twitchell | City Windows
PATH Center | DHS | Bronx



ART SITE PREPARATION

Julianne Swartz | *Four Directions from Hunters Point*
Hunters Point Library | QPL | Queens

INSTALLATION





ARTWORK INSTALLATION

Hank Willis Thomas | Unity
Tillary Street ph2 | DOT | Brooklyn

PROJECT CLOSE OUT



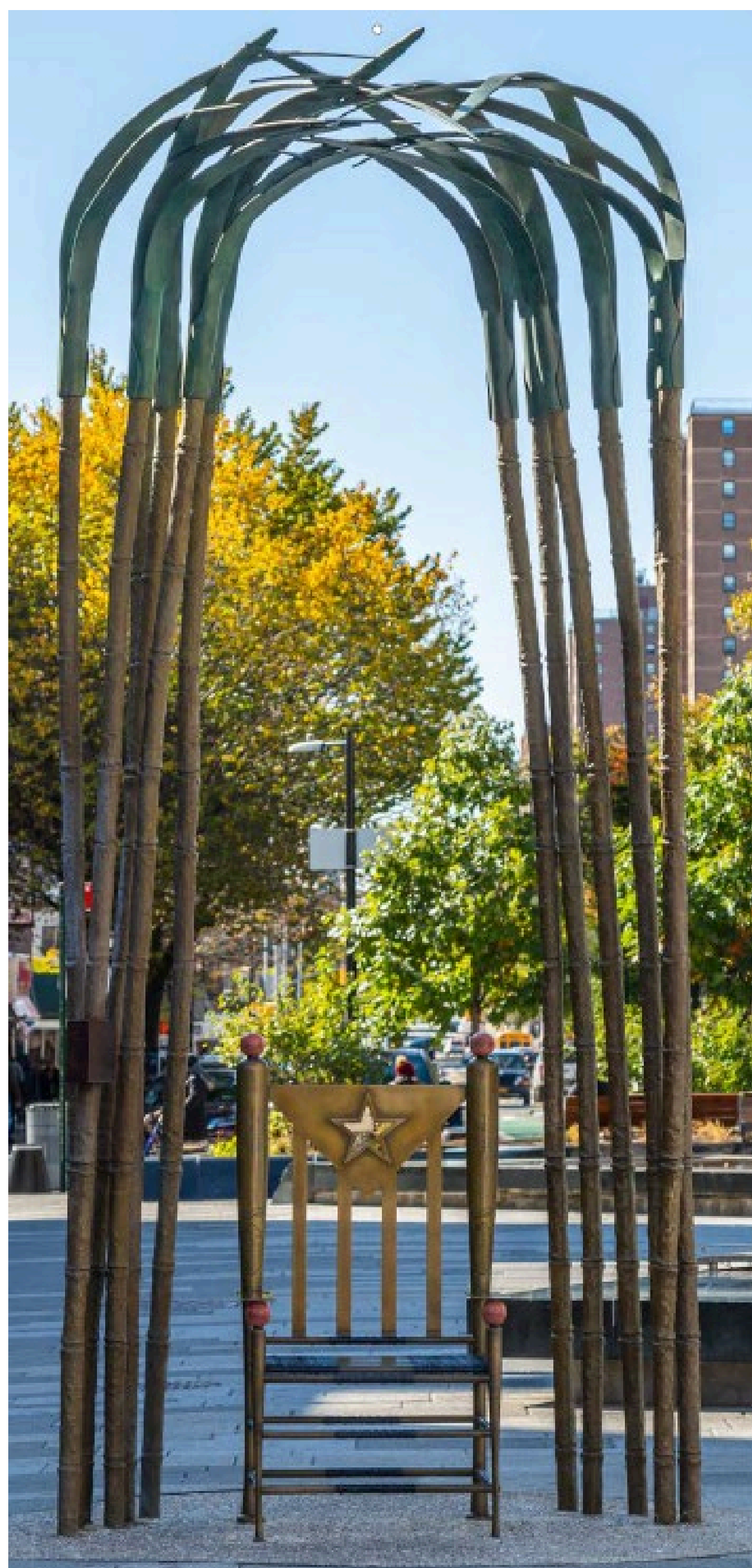

ARTWORK POST-INSTALLATION



Q & A

Thank you!

Xenia Diente

Public Art Deputy Director
(718) 391-1504
dientex@ddc.nyc.gov