

# PROJECT ID. NDF-IBZ

# VAN SINDEREN AVENUE

# STREETSCAPE IMPROVEMENTS

BOROUGH OF BROOKLYN

Bill de Blasio  
Mayor

Jamie Torres - Springer  
Commissioner

**COMMUNITY BOARD NO.5**



Van Sinderen Avenue Streetscape Improvements,  
Borough of Brooklyn

October 18, 2021

# INTRODUCTION

The main objective of this project is to address safety and accessibility concerns along Van Sinderen Avenue in the East New York Industrial Business Zone.

Project Limits:

- Van Sinderen Avenue from East New York Avenue to Riverdale Avenue.
- Sutter Avenue from Van Sinderen Avenue to Hinsdale Street.

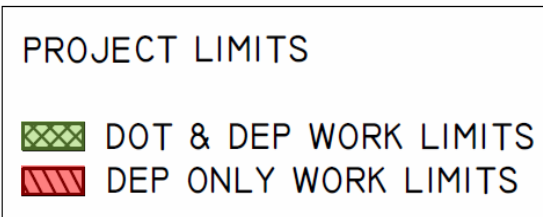
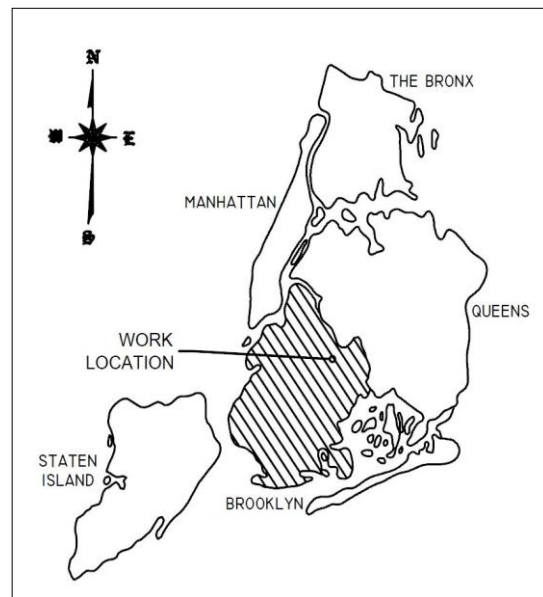

# EAST NEW YORK IBZ ZONE

- The Industrial Business Zone was established in 2006 to provide financial support, investment and zoning protection for new and existing businesses within the boundary area.
- A goal of the East New York Neighborhood Plan is to promote and strengthen industrial business growth in the Industrial Business Zone through capital improvements.
  - The Van Sinderen elevated L train segment was repainted by the MTA.
- Project Funding - The project is funded from the Neighborhood Development Fund in the NYC Economic Development Corporations budget.

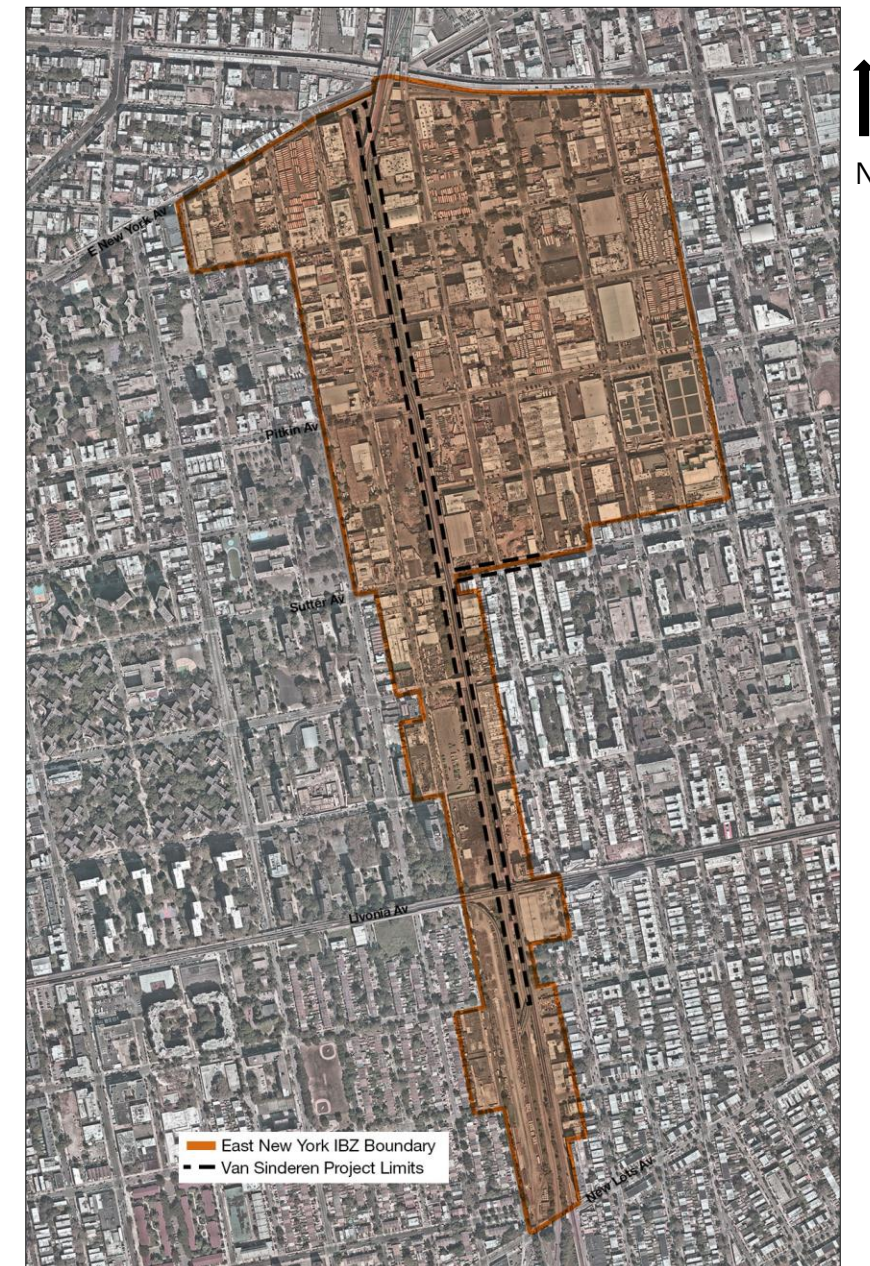

# EXISTING CONDITIONS

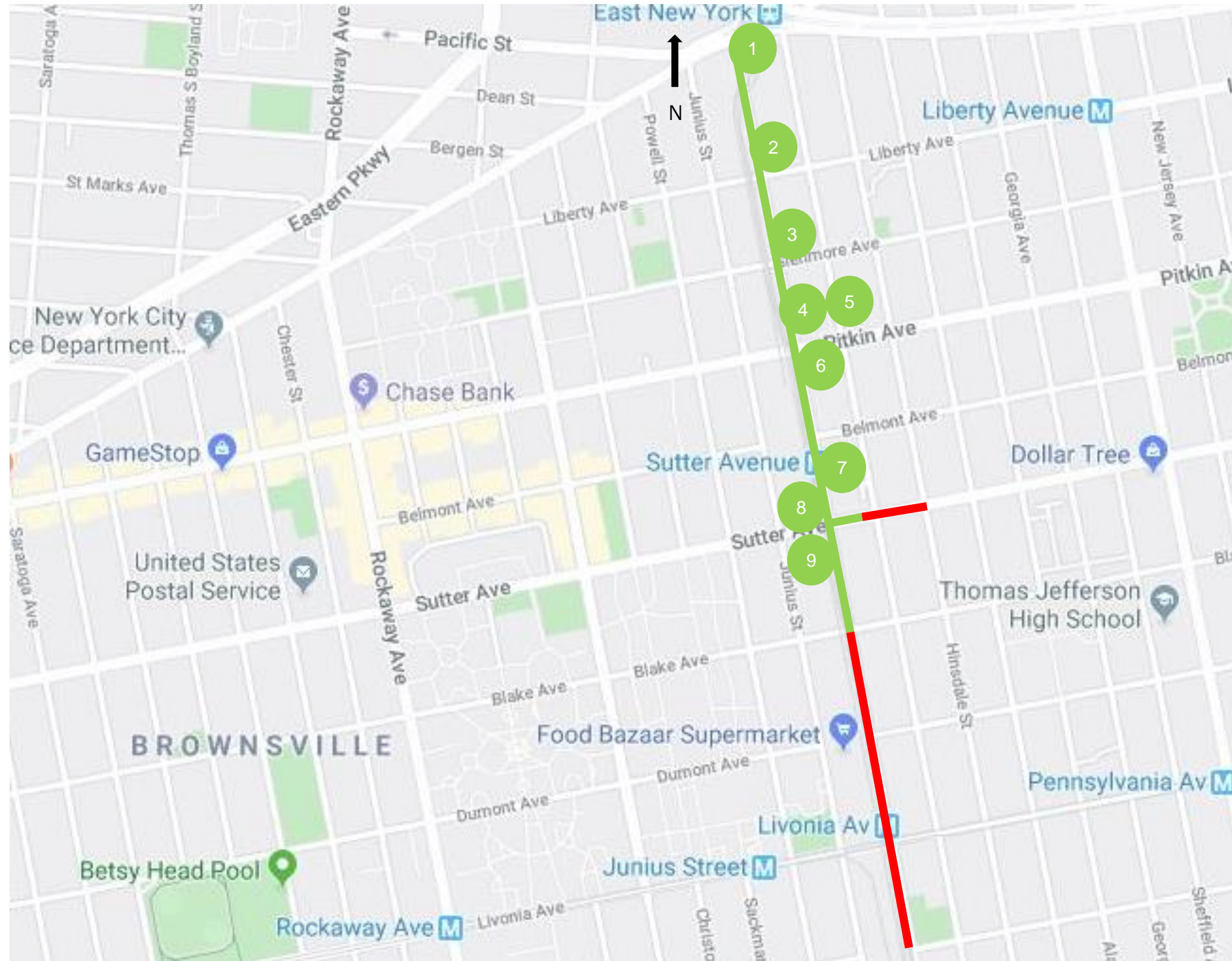

## Key Map for Photos of Existing Conditions

- 1 Van Sinderen Ave at East New York Ave
- 2 Van Sinderen Ave under the elevated station at Liberty Ave
- 3 Van Sinderen Ave near Glenmore Ave
- 4 5 Van Sinderen Ave at Pitkin Ave
- 6 Van Sinderen Ave at Pitkin Ave looking South
- 7 Van Sinderen Ave between Belmont Ave and Sutter Ave
- 8 Van Sinderen Ave and Sutter Ave, NW Corner
- 9 Van Sinderen Ave and Sutter Ave, SW Corner

— DOT & DEP Work Location

— DEP Only Work Location

# EXISTING CONDITIONS (Cont.)



**#1 Van Sinderen Avenue at East New York Avenue.**



**#2 Van Sinderen Avenue under the Elevated L line between Liberty Avenue and Pitkin Avenue.**

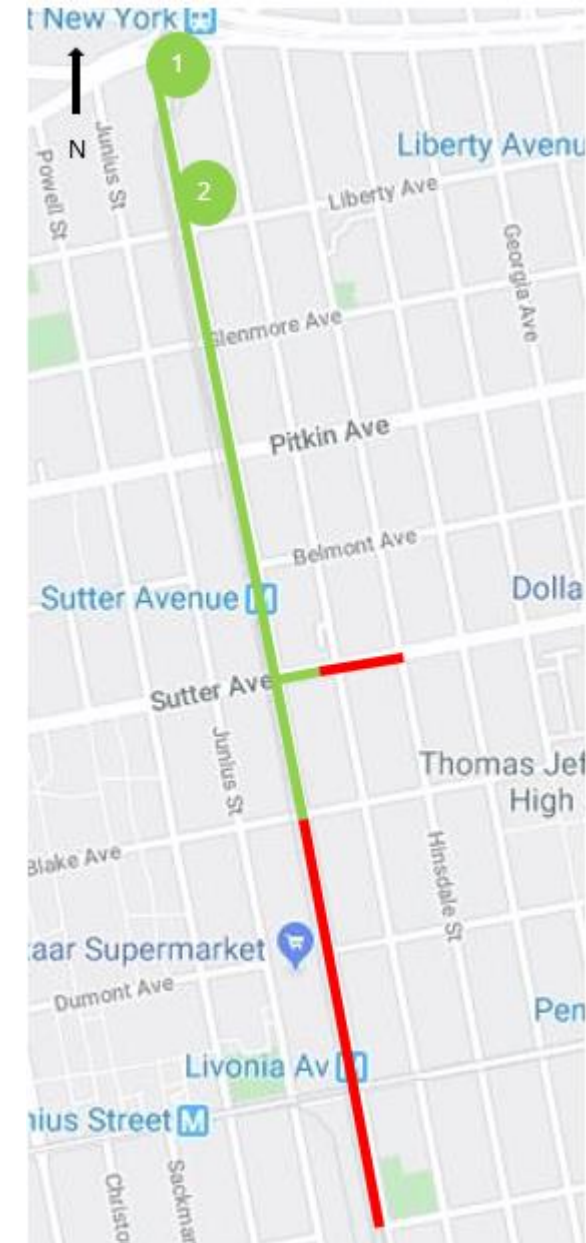

# EXISTING CONDITIONS (Cont.)



**#3 Existing MTA fence, roadway condition, non-standard concrete sidewalk, and metal posts along Van Sinderen Avenue near Glenmore Avenue.**



**#4 Ponding and deterioration of sidewalk in front of the school bus parking lot near Pitkin Avenue Intersection.**

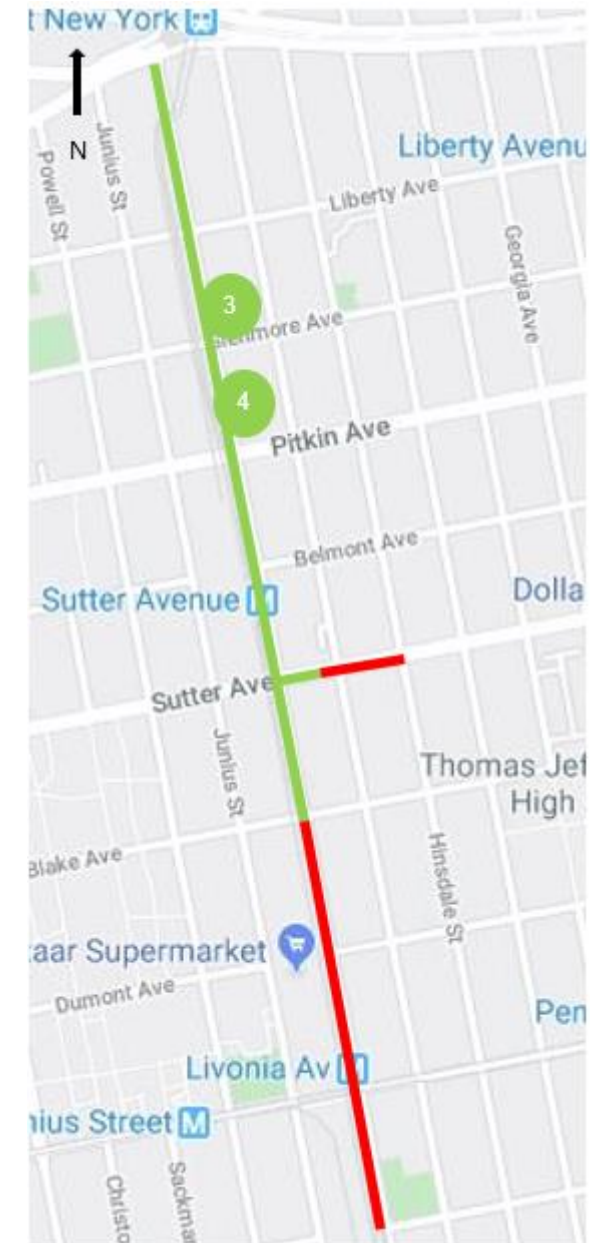

# EXISTING CONDITIONS (Cont.)



**#5 Pitkin Avenue & Van Sinderen Avenue Intersection, NE corner.**



**#6 Undesirable vegetation and broken sidewalk along Van Sinderen Avenue between Pitkin Avenue and Belmont Avenue.**

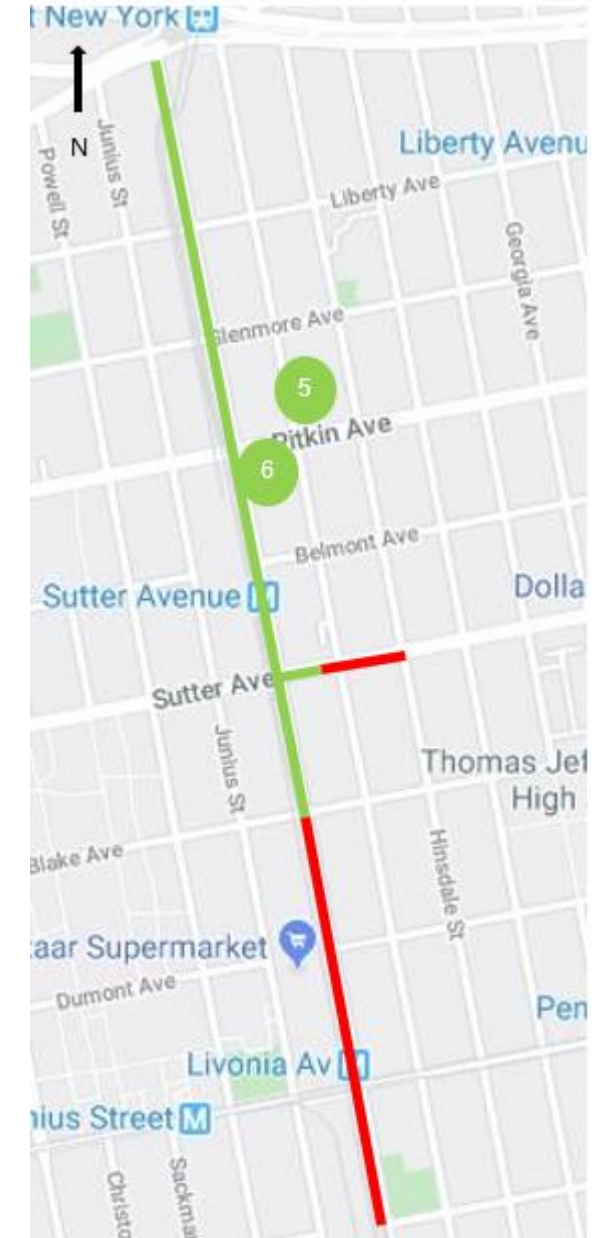

# EXISTING CONDITIONS (Cont.)



**#7 Existing tree pit located along Van Sinderen Avenue near Sutter Avenue intersection.**



**#8 View of NW Corner at Sutter Avenue and Van Sinderen Avenue, entrance to Sutter Avenue L Station.**

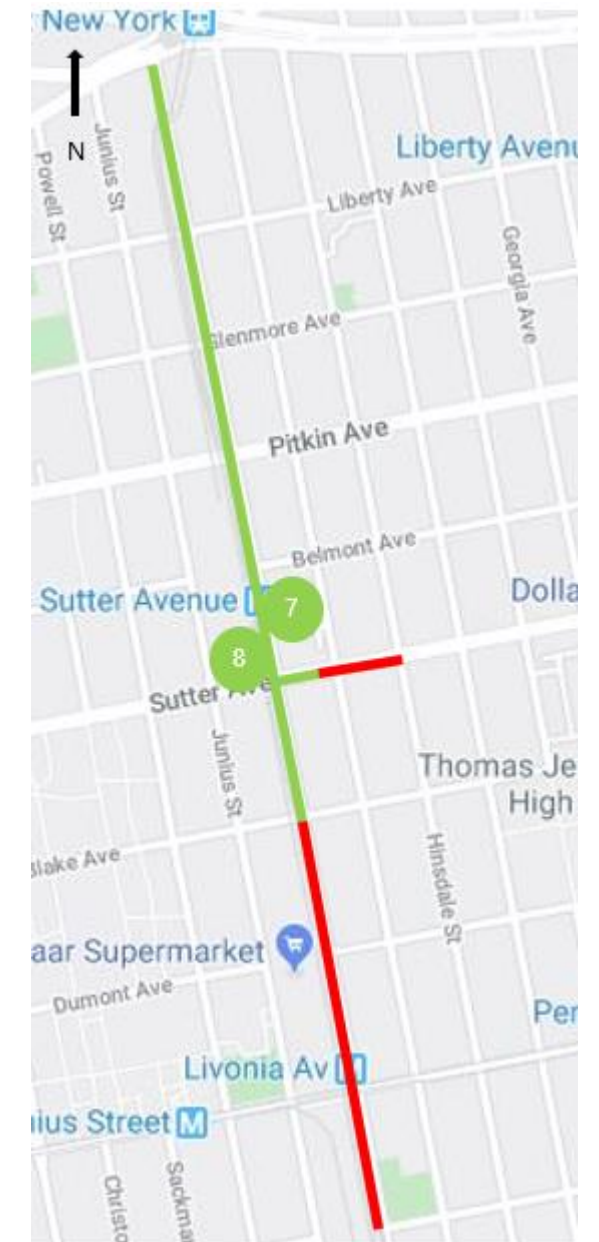



# EXISTING CONDITIONS (Cont.)

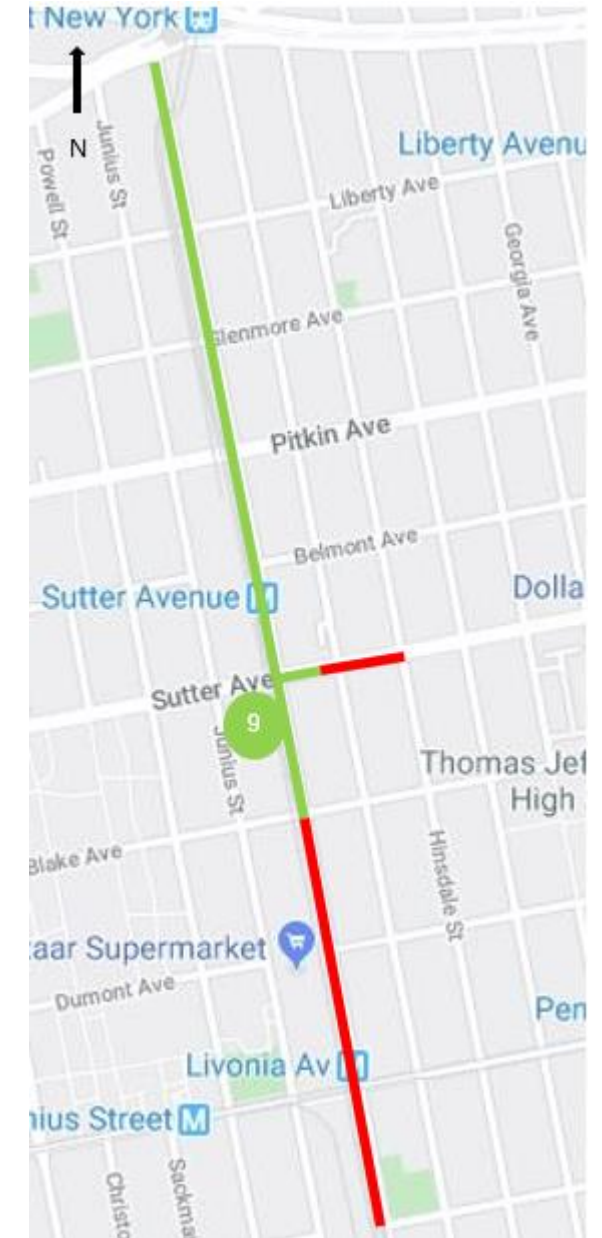

**#9 View of SW Corner at Sutter Avenue and Van Sinderen Avenue intersection looking West.**

# DESIGN CHALLENGES

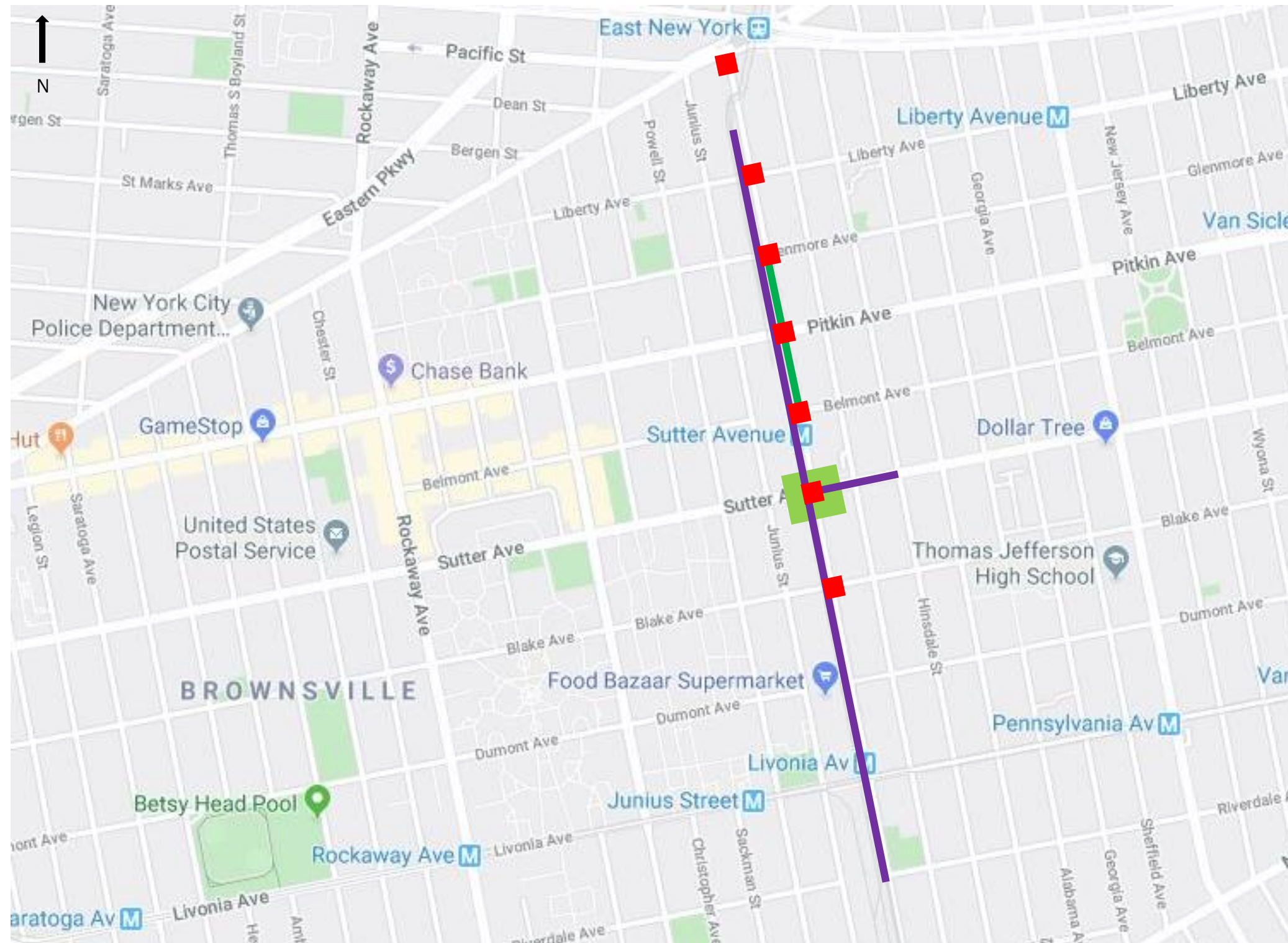

-  Narrow/Broken Sidewalks
-  Corners with Non-ADA Complaint Ramps
-  Significant Grade Change at Pedestrian Crossing
-  DEP Sewer and Watermain Work

# PROPOSED WORK

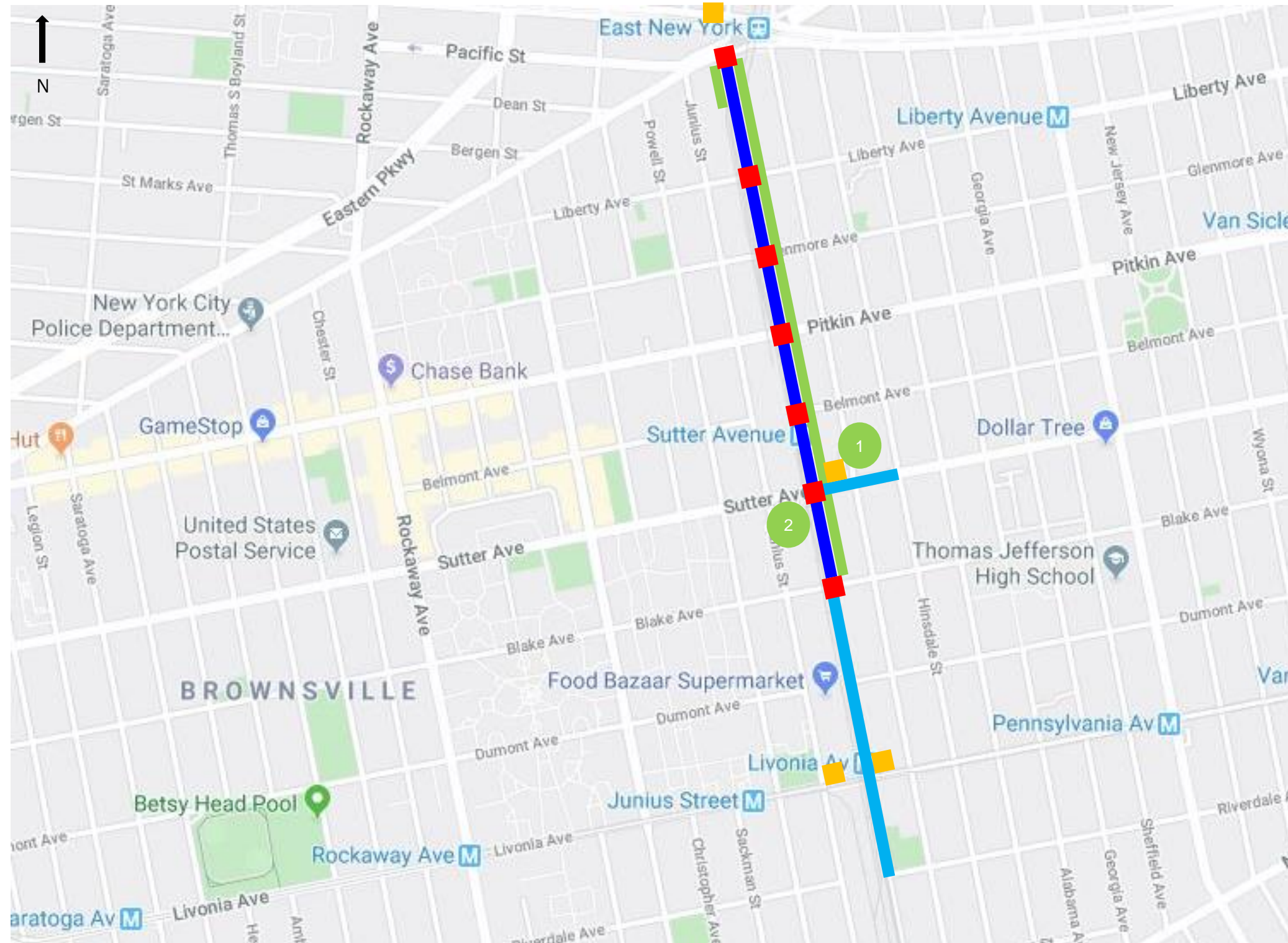

- Proposed Wayfinding Sign
- Roadway Reconstruction
- Trench Restoration
- Sidewalk Reconstruction
- Proposed ADA Ramps
- 1 Proposed Wayfinding Sign Within project limits, NE Corner of Sutter Avenue Intersection
- 2 Proposed El-Fence, SW Corner Of Sutter Avenue Intersection

# NYCDEP PROPOSED WORK

## Sewers

- Constructing new sewers ranging in size from 18-inches to 42-inches in diameter within 6 blocks along Van Sinderen Avenue from East New York Avenue to Blake Avenue and 2 blocks along Sutter Avenue from Van Sinderen Avenue to Hinsdale Street

## Watermains

- 6-inch to 12-inch watermain replacement within 8 blocks along Van Sinderen Avenue between East New York Avenue and Riverdale Avenue and 2 blocks along Sutter Avenue from Van Sinderen Avenue to Hinsdale Street

# MAINTENANCE AND PROTECTION OF TRAFFIC – DETOURS

- Proposed along Van Sinderen Avenue
  - Proposed curb to curb roadway width is 16 feet with an overall Right-of-Way width of 25 feet
  - Vehicles require a minimum travel lane of 11 feet
  - Sewer trench widths vary from 5'-10" to 8'-3"
  - Allows for a safe and efficient installation of proposed sewers and watermains
  - Only **1 block** would be closed at a time
  - Proper detour signage and advanced warnings would be located along the route
  - Construction team would regularly coordinate with DDC and local community on detour schedule

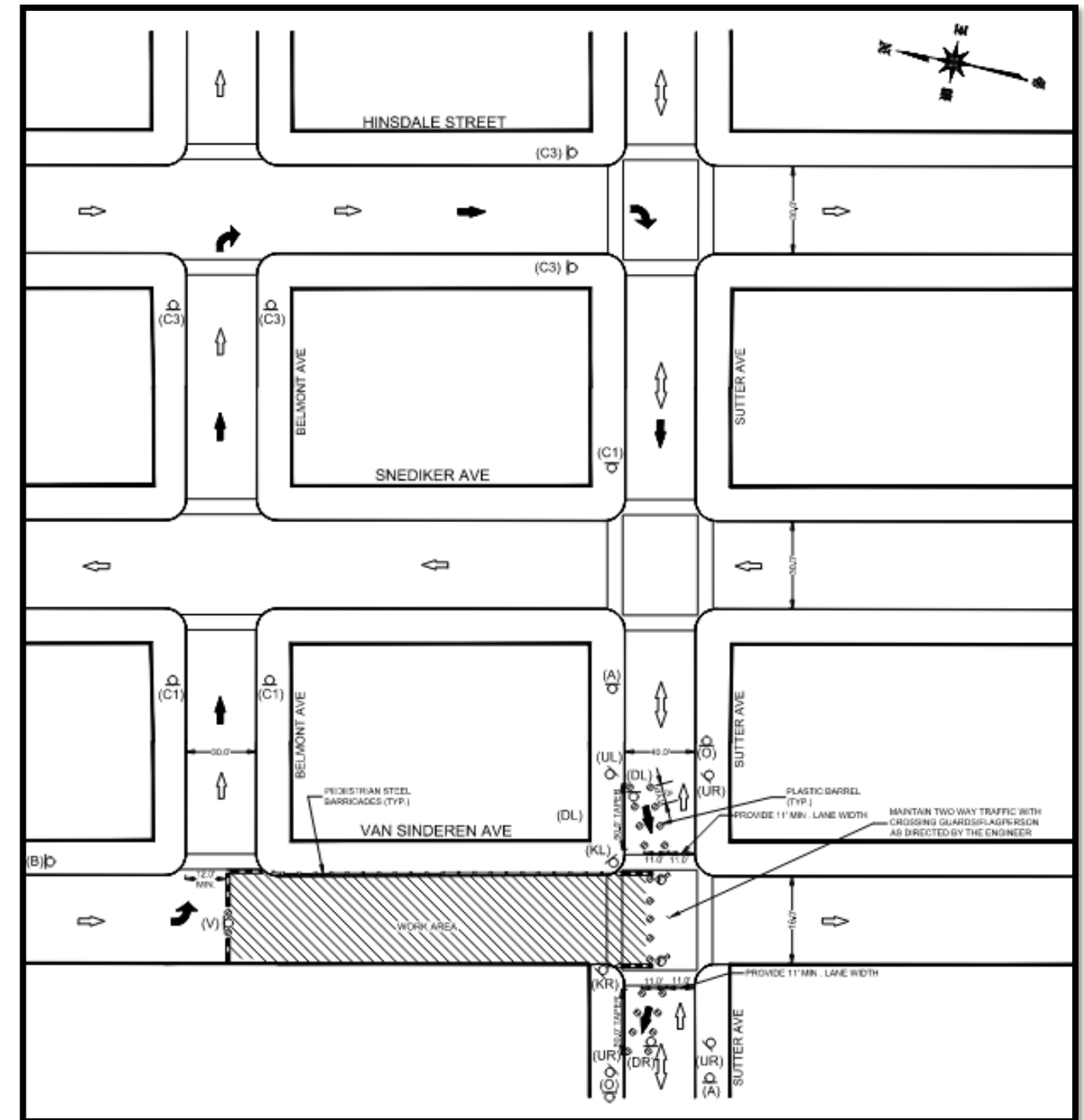

# PLAN VIEW OF SUTTER AVENUE INTERSECTION

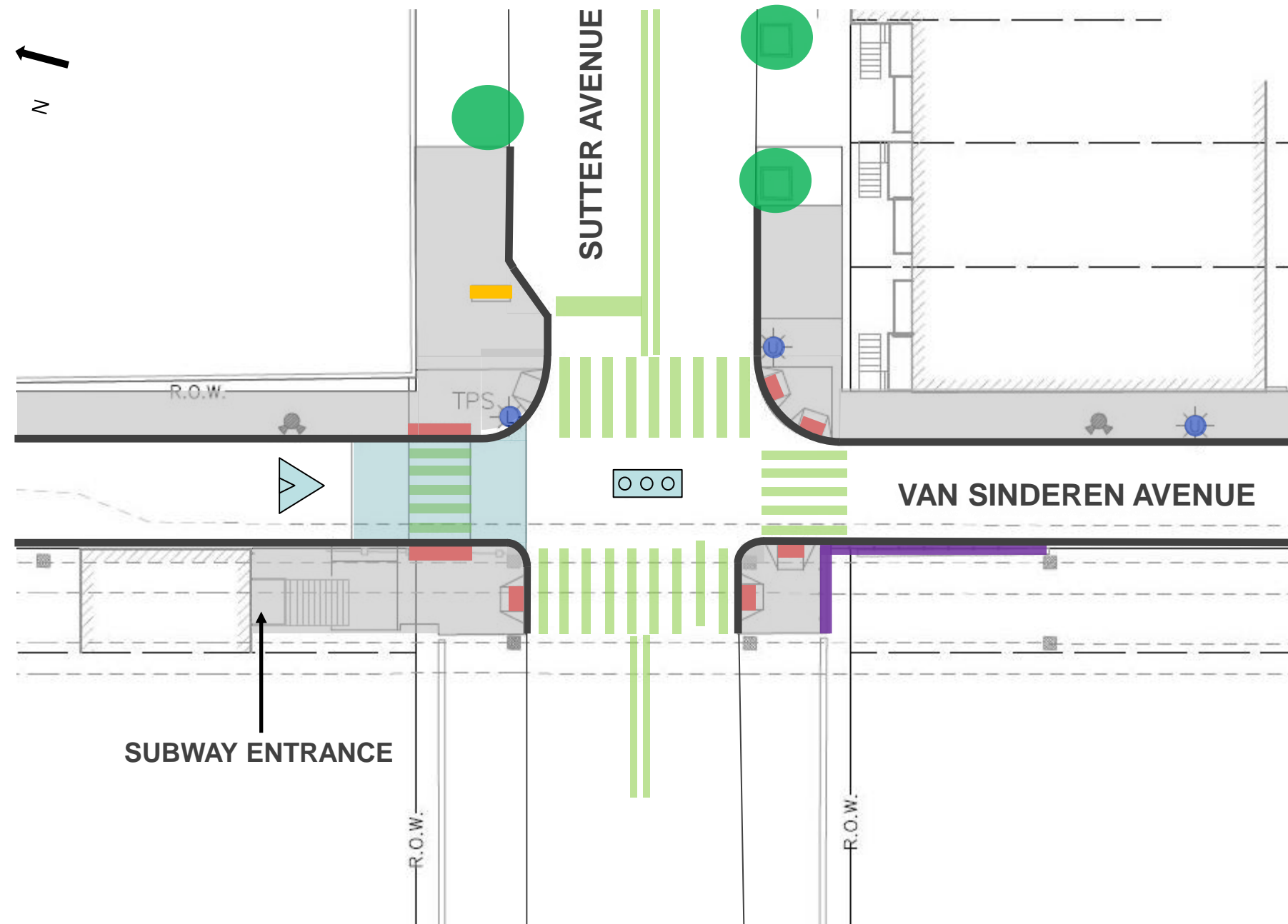

-  Raised Crosswalk
-  Steel Faced Curb
-  Concrete Sidewalk (Unpigmented)
-  Relocate Street Lights / Utility Pole
-  Proposed ADA Ramps with Detectable Warning paver
-  Pavement Markings
-  Proposed EI-Fence
-  Proposed Wayfinding Type 'B' Sign
-  Existing Trees to Remain
-  Signalized Intersection
-  Speed Bump Symbol

Scale: 1:30

# 3D RENDERING OF SUTTER AVENUE INTERSECTION



# WAYFINDING SIGN

- Proposed Type 'B' sign  
Northeast corner of Van Sinderen Avenue and Sutter Avenue
- Additional locations:
  - East side of Junius Street (north of Livonia Avenue)
  - North side of Livonia Avenue (east of Van Sinderen Avenue)
  - West side of Van Sinderen Avenue (north of Atlantic Avenue)

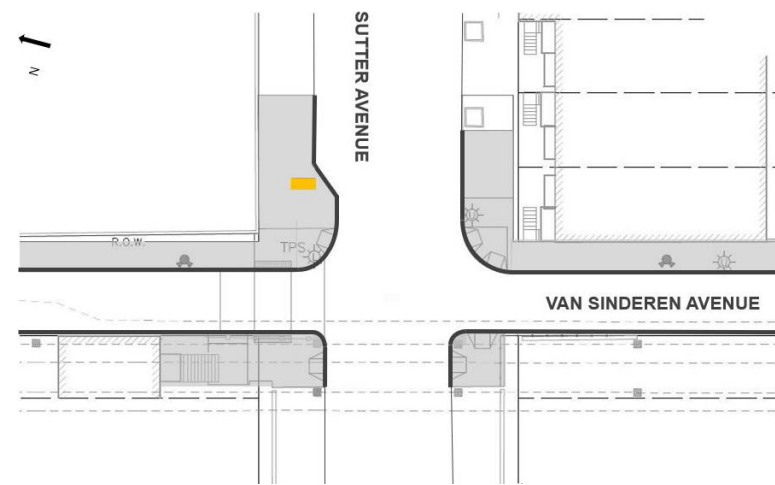

■ Proposed Wayfinding Sign

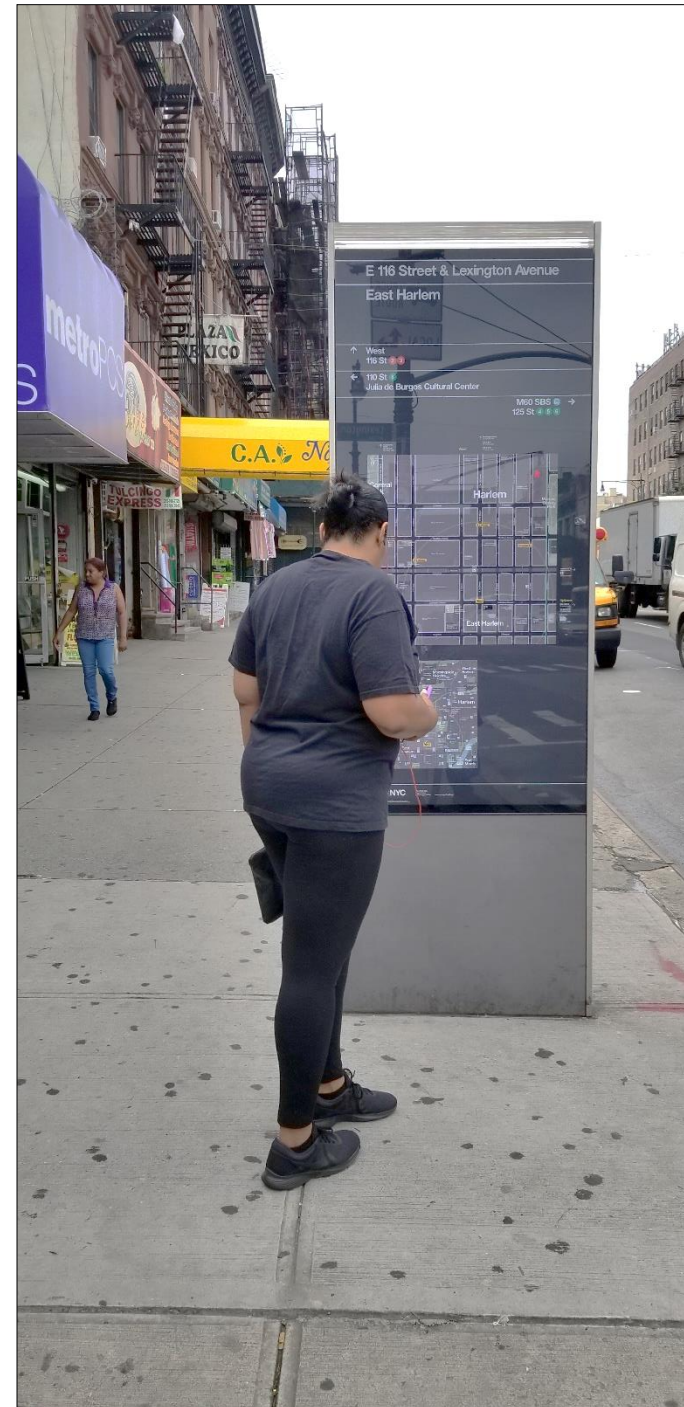



# EL-FENCE

- The El-fence is a modular fence that is used in streetscape enhancement projects under elevated infrastructure. The panels of the El-Fence are flexible and can be easily modified to display art, graphics, and pops of color, or incorporate text and logos.

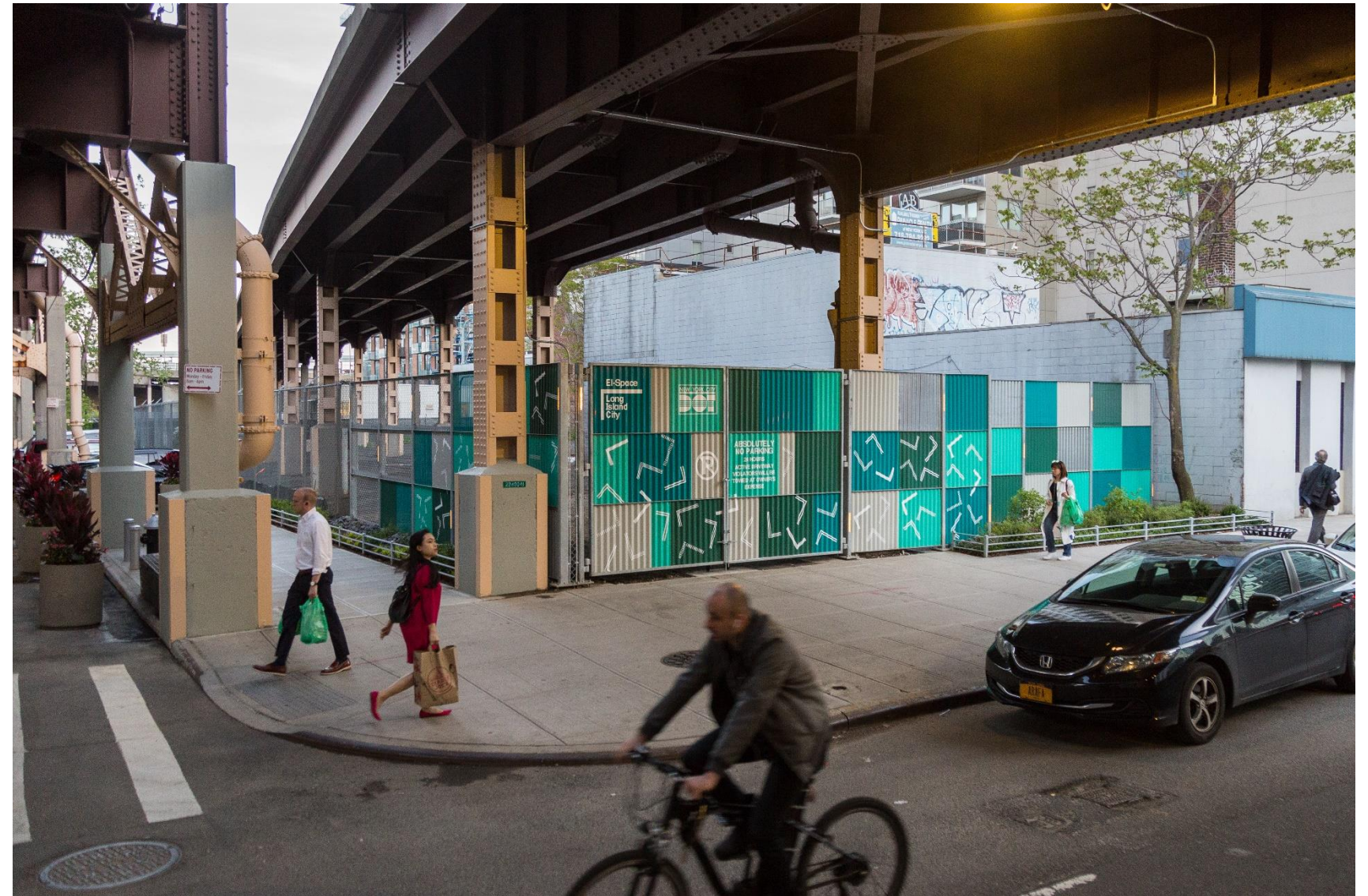

# PROJECT SCHEDULE

- Design Start– June 8, 2018
- 40% Final Design (Plans mailed to Community Board) – March 5, 2020
- Project was on hold during COVID-19 Emergency from March 2020 to December 2020
- 75% Final Design (Plans emailed to Community Board) – 08/23/2021
- Prepare and Coordinate PDC application – November 2021
- Final Design Completion for Bid – Spring 2022
- Projected Construction – Summer 2023 to 2025

# THANK YOU



Van Sinderen Avenue Streetscape Improvements,  
Borough of Brooklyn

October 18, 2021