

PROJECT ID. NDF-IBZ

VAN SINDEREN AVENUE

STREETSCAPE IMPROVEMENTS

BOROUGH OF BROOKLYN

Bill de Blasio
Mayor

Jamie Torres - Springer
Commissioner

COMMUNITY BOARD NO.16



Van Sinderen Avenue Streetscape Improvements,
Borough of Brooklyn

October 26, 2021

INTRODUCTION

The main objective of this project is to address safety and accessibility concerns along Van Sinderen Avenue in the East New York Industrial Business Zone.

Project Limits:

- Van Sinderen Avenue from East New York Avenue to Riverdale Avenue.
- Sutter Avenue from Van Sinderen Avenue to Hinsdale Street.

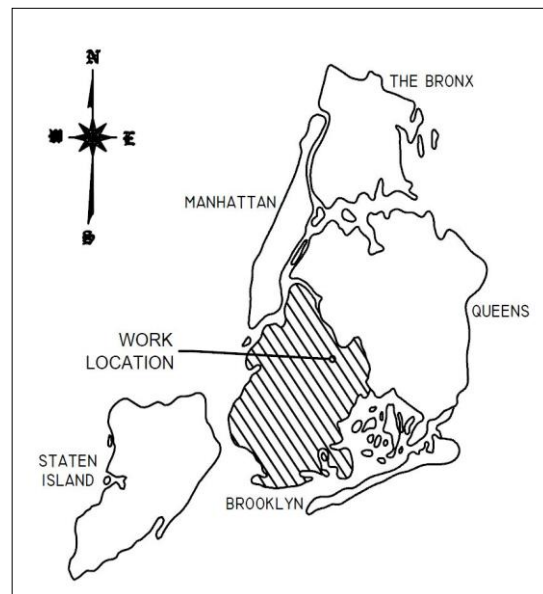

PROJECT LIMITS

 DOT & DEP WORK LIMITS

 DEP ONLY WORK LIMITS

EAST NEW YORK IBZ ZONE

- The Industrial Business Zone was established in 2006 to provide financial support, investment and zoning protection for new and existing businesses within the boundary area.
- A goal of the East New York Neighborhood Plan is to promote and strengthen industrial business growth in the Industrial Business Zone through capital improvements.
 - The Van Sinderen elevated L train segment was repainted by the MTA.
- Project Funding - The project is funded from the Neighborhood Development Fund in the NYC Economic Development Corporations budget.

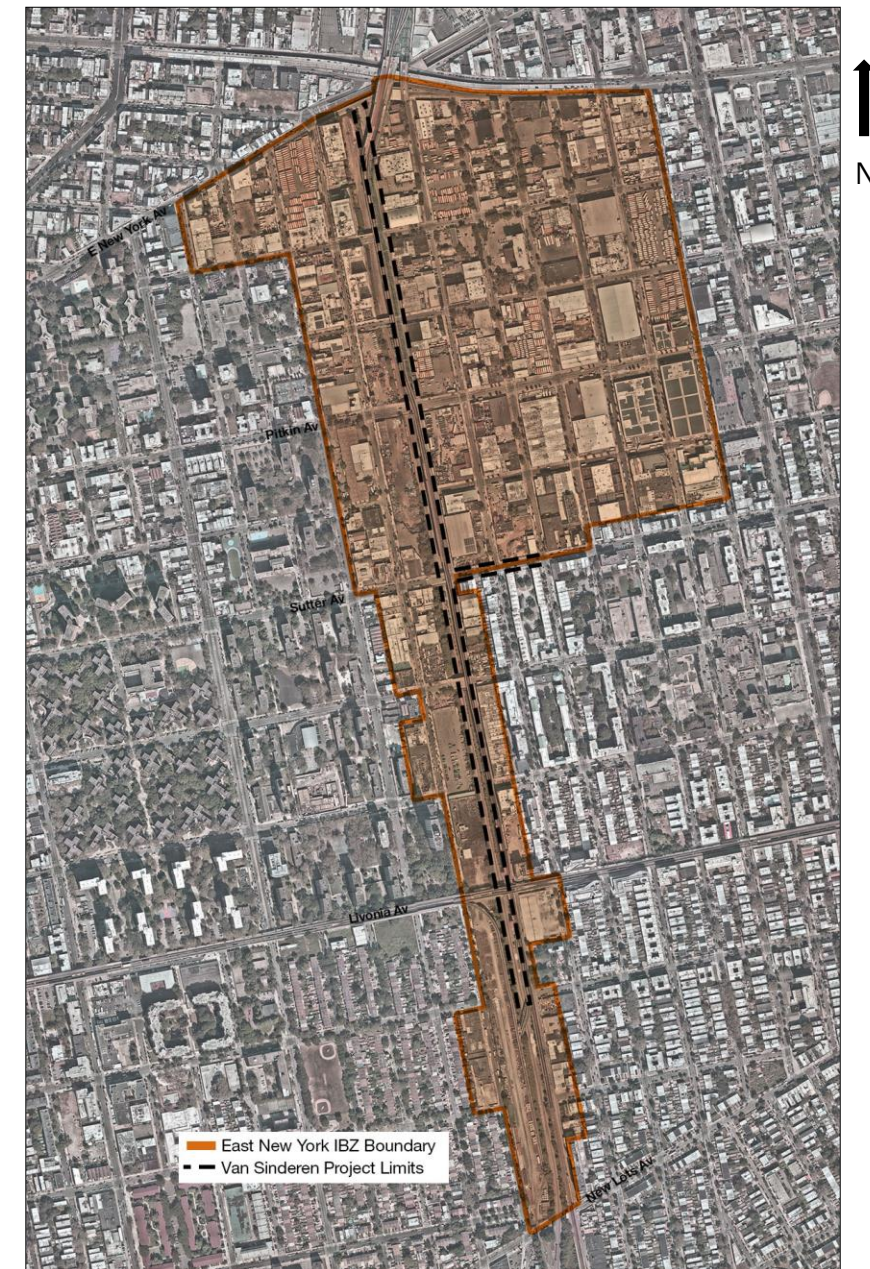

EXISTING CONDITIONS

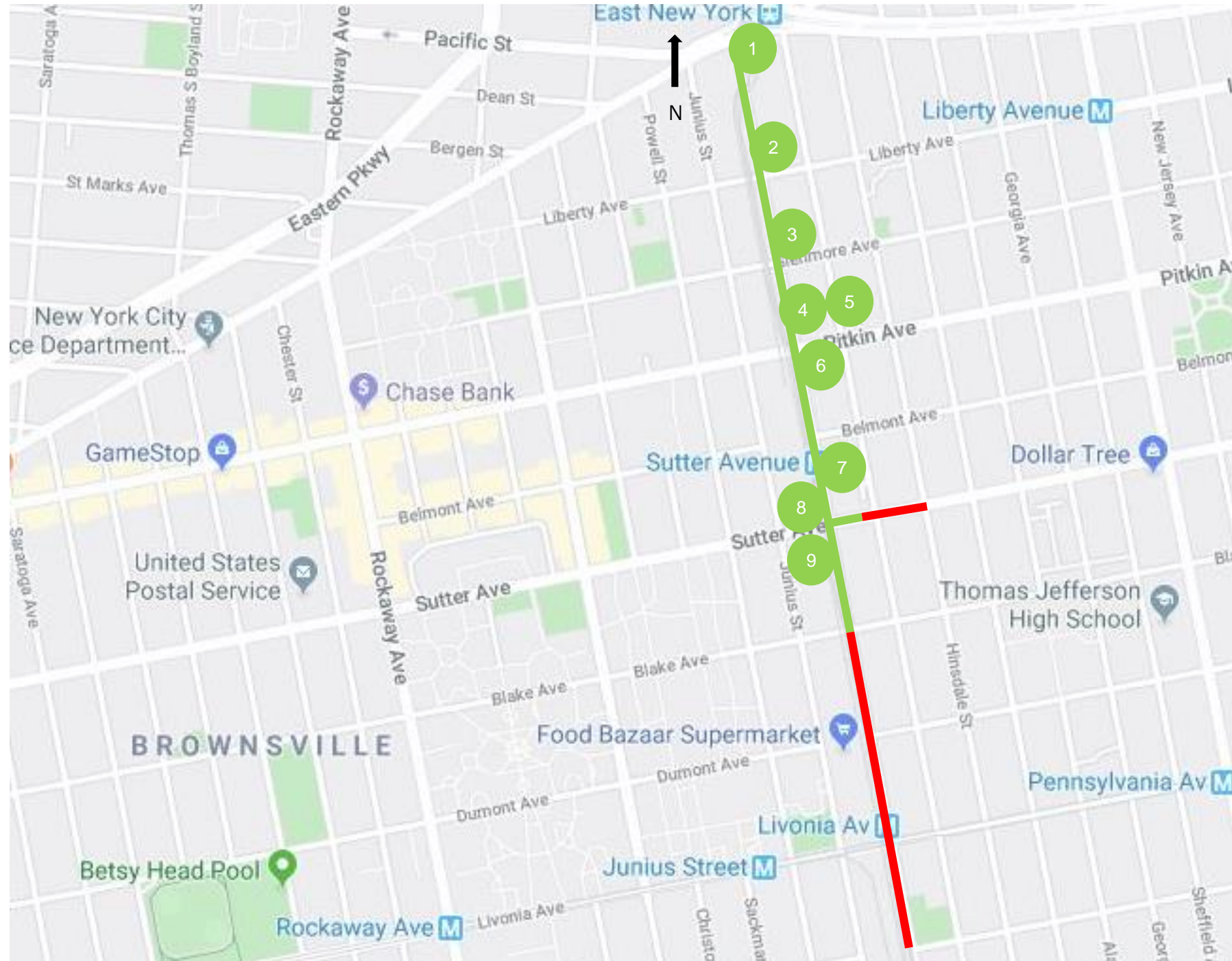

Key Map for Photos of Existing Conditions

- 1 Van Sinderen Ave at East New York Ave
- 2 Van Sinderen Ave under the elevated station at Liberty Ave
- 3 Van Sinderen Ave near Glenmore Ave
- 4 5 Van Sinderen Ave at Pitkin Ave
- 6 Van Sinderen Ave at Pitkin Ave looking South
- 7 Van Sinderen Ave between Belmont Ave and Sutter Ave
- 8 Van Sinderen Ave and Sutter Ave, NW Corner
- 9 Van Sinderen Ave and Sutter Ave, SW Corner

— DOT & DEP Work Location

— DEP Only Work Location

EXISTING CONDITIONS (Cont.)



#1 Van Sinderen Avenue at East New York Avenue.



#2 Van Sinderen Avenue under the Elevated L line between Liberty Avenue and Pitkin Avenue.

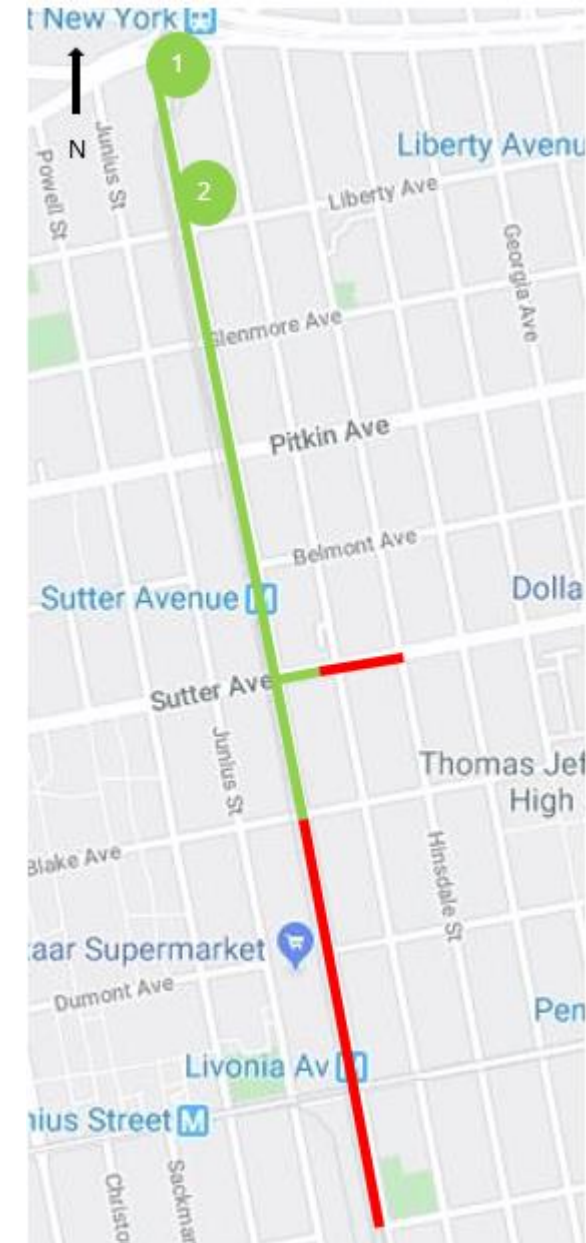

EXISTING CONDITIONS (Cont.)



#3 Existing MTA fence, roadway condition, non-standard concrete sidewalk, and metal posts along Van Sinderen Avenue near Glenmore Avenue.



#4 Ponding and deterioration of sidewalk in front of the school bus parking lot near Pitkin Avenue Intersection.

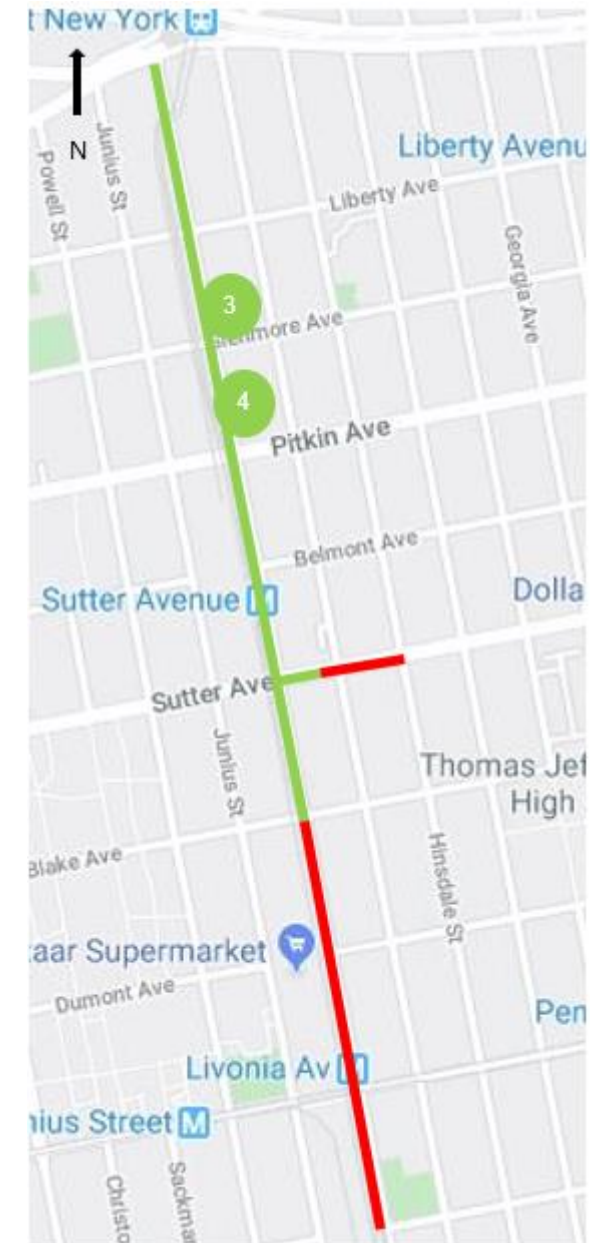

EXISTING CONDITIONS (Cont.)



#5 Pitkin Avenue & Van Sinderen Avenue Intersection, NE corner.



#6 Undesirable vegetation and broken sidewalk along Van Sinderen Avenue between Pitkin Avenue and Belmont Avenue.

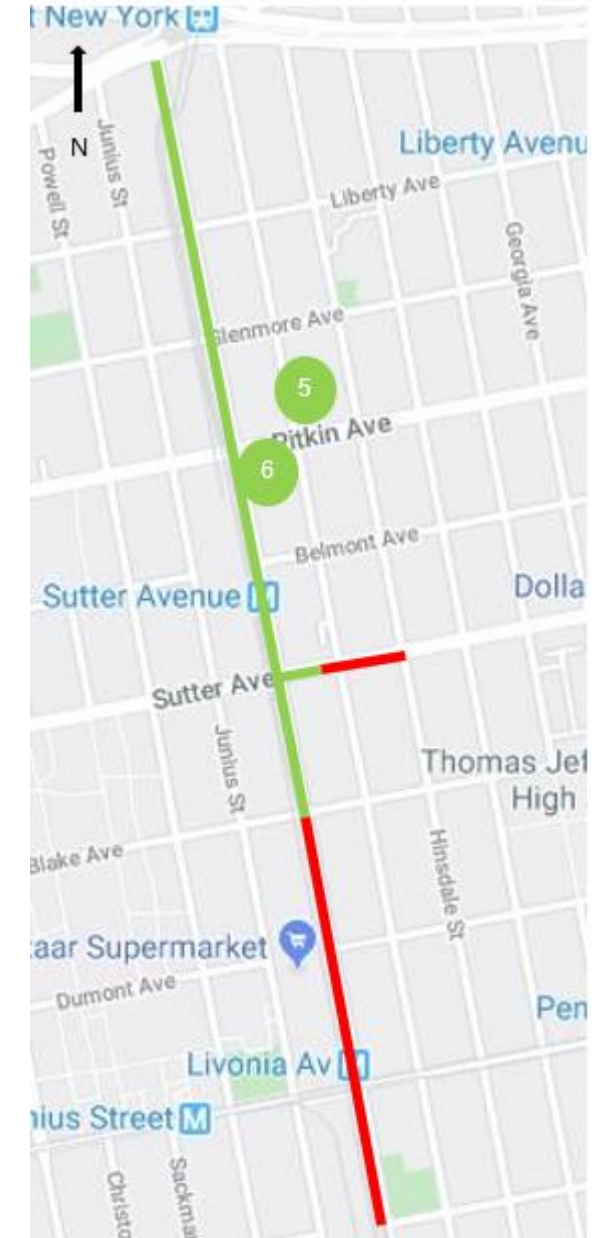

EXISTING CONDITIONS (Cont.)



#7 Existing tree pit located along Van Sinderen Avenue near Sutter Avenue intersection.



#8 View of NW Corner at Sutter Avenue and Van Sinderen Avenue, entrance to Sutter Avenue L Station.

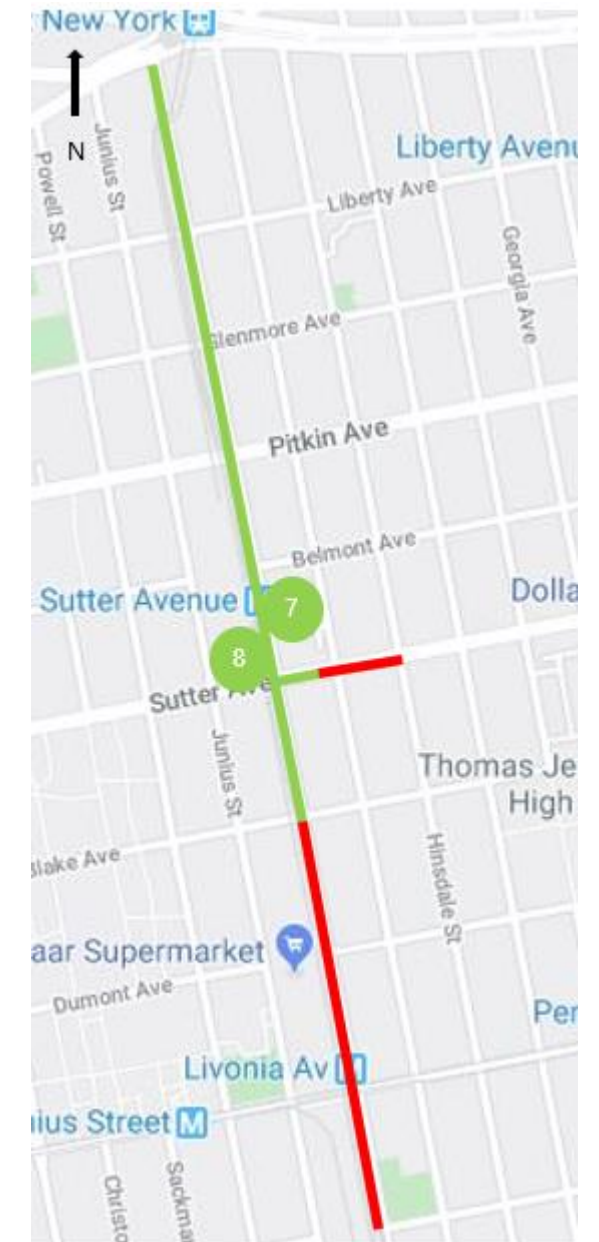

EXISTING CONDITIONS (Cont.)

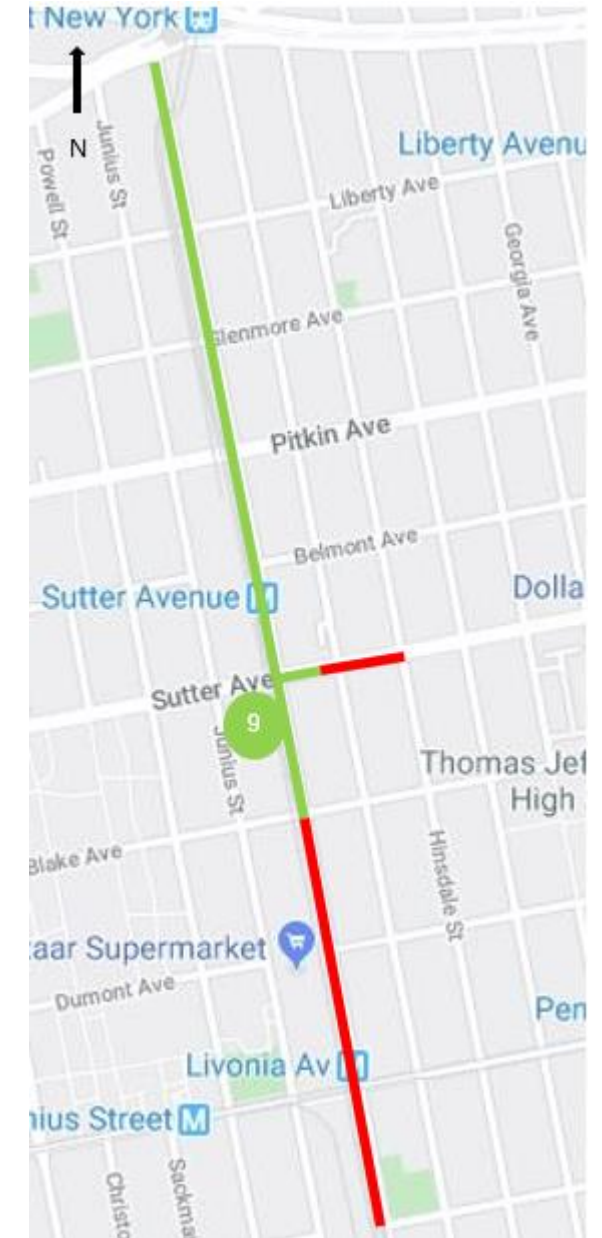

#9 View of SW Corner at Sutter Avenue and Van Sinderen Avenue intersection looking West.

DESIGN CHALLENGES

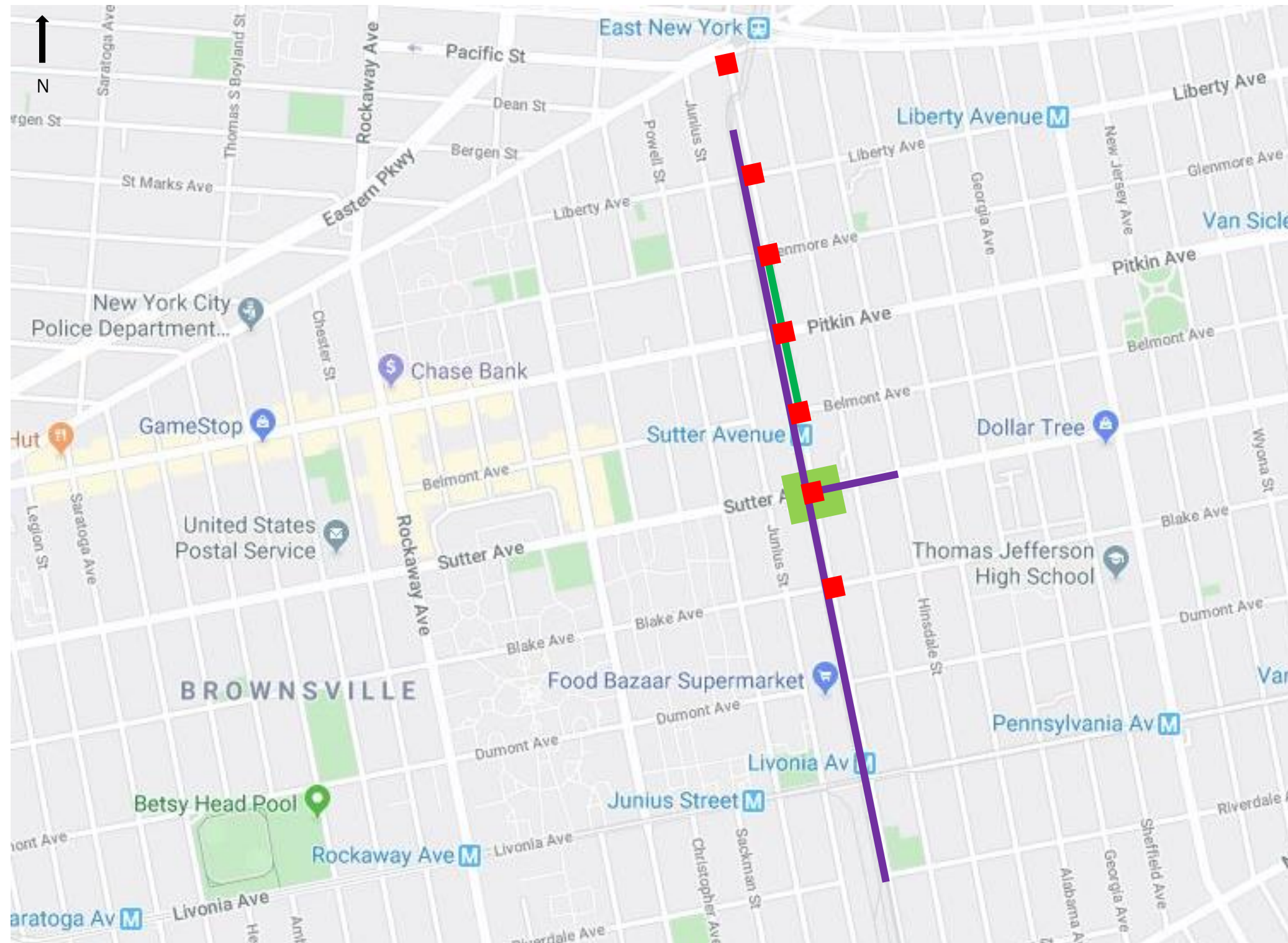

-  Narrow/Broken Sidewalks
-  Corners with Non-ADA Complaint Ramps
-  Significant Grade Change at Pedestrian Crossing
-  DEP Sewer and Watermain Work

PROPOSED WORK

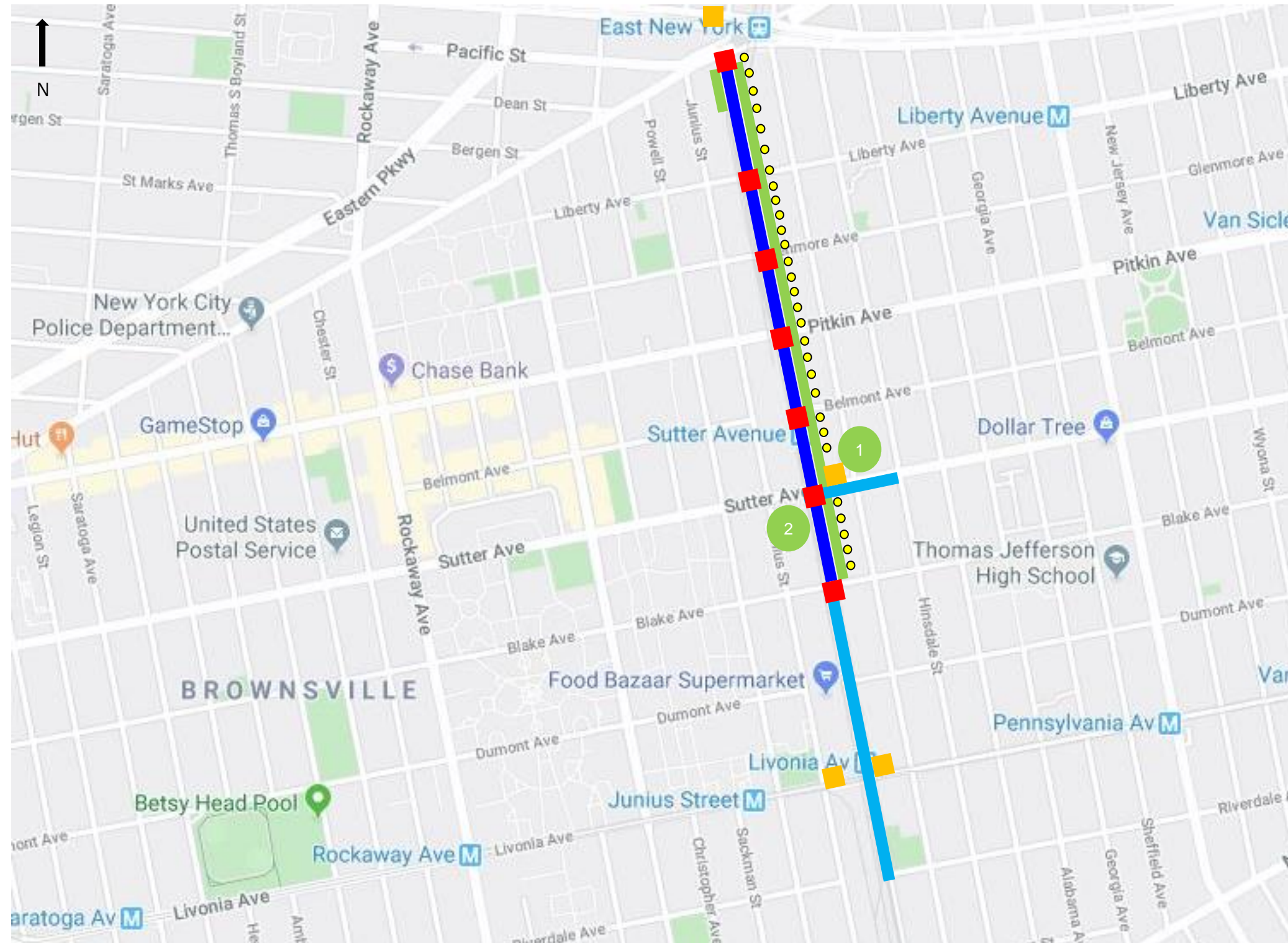

- Proposed 62 Street Lights
- Proposed Wayfinding Sign
- ▬ Roadway Reconstruction
- ▬ Trench Restoration
- ▬ Sidewalk Reconstruction
- ▬ Proposed ADA Ramps
- 1 Proposed Wayfinding Sign Within project limits, NE Corner of Sutter Avenue Intersection
- 2 Proposed EI-Fence, SW Corner Of Sutter Avenue Intersection

NYCDEP PROPOSED WORK

Sewers

- Constructing new sewers ranging in size from 18-inches to 42-inches in diameter within 6 blocks along Van Sinderen Avenue from East New York Avenue to Blake Avenue and 2 blocks along Sutter Avenue from Van Sinderen Avenue to Hinsdale Street

Watermains

- 6-inch to 12-inch watermain replacement within 8 blocks along Van Sinderen Avenue between East New York Avenue and Riverdale Avenue and 2 blocks along Sutter Avenue from Van Sinderen Avenue to Hinsdale Street

MAINTENANCE AND PROTECTION OF TRAFFIC – DETOURS

- Proposed along Van Sinderen Avenue
 - Proposed curb to curb roadway width is 16 feet with an overall Right-of-Way width of 25 feet
 - Vehicles require a minimum travel lane of 11 feet
 - Sewer trench widths vary from 5'-10" to 8'-3"
 - Allows for a safe and efficient installation of proposed sewers and watermains
 - Only **1 block** would be closed at a time
 - Proper detour signage and advanced warnings would be located along the route
 - Construction team would regularly coordinate with DDC and local community on detour schedule

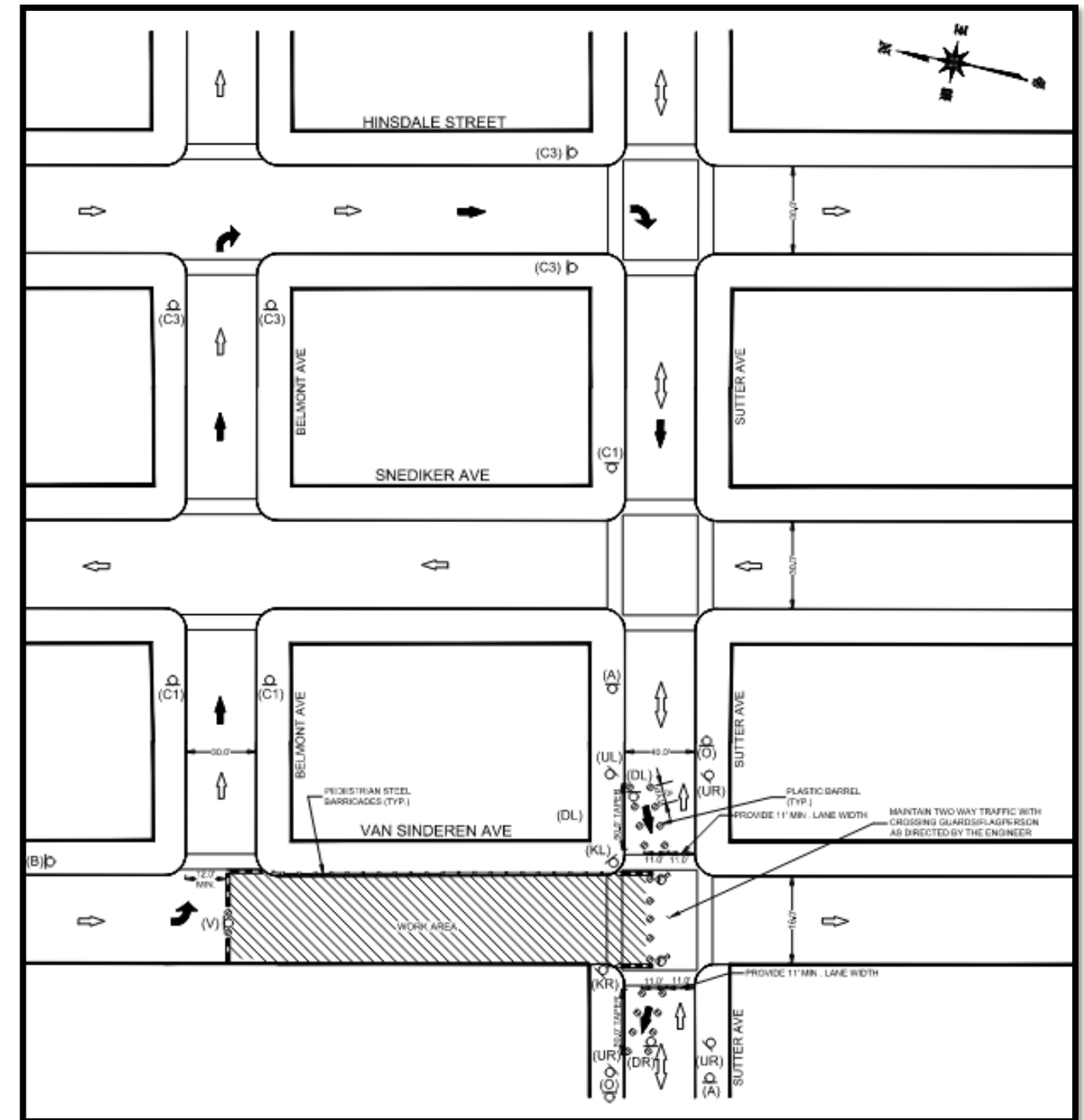

PLAN VIEW OF SUTTER AVENUE INTERSECTION

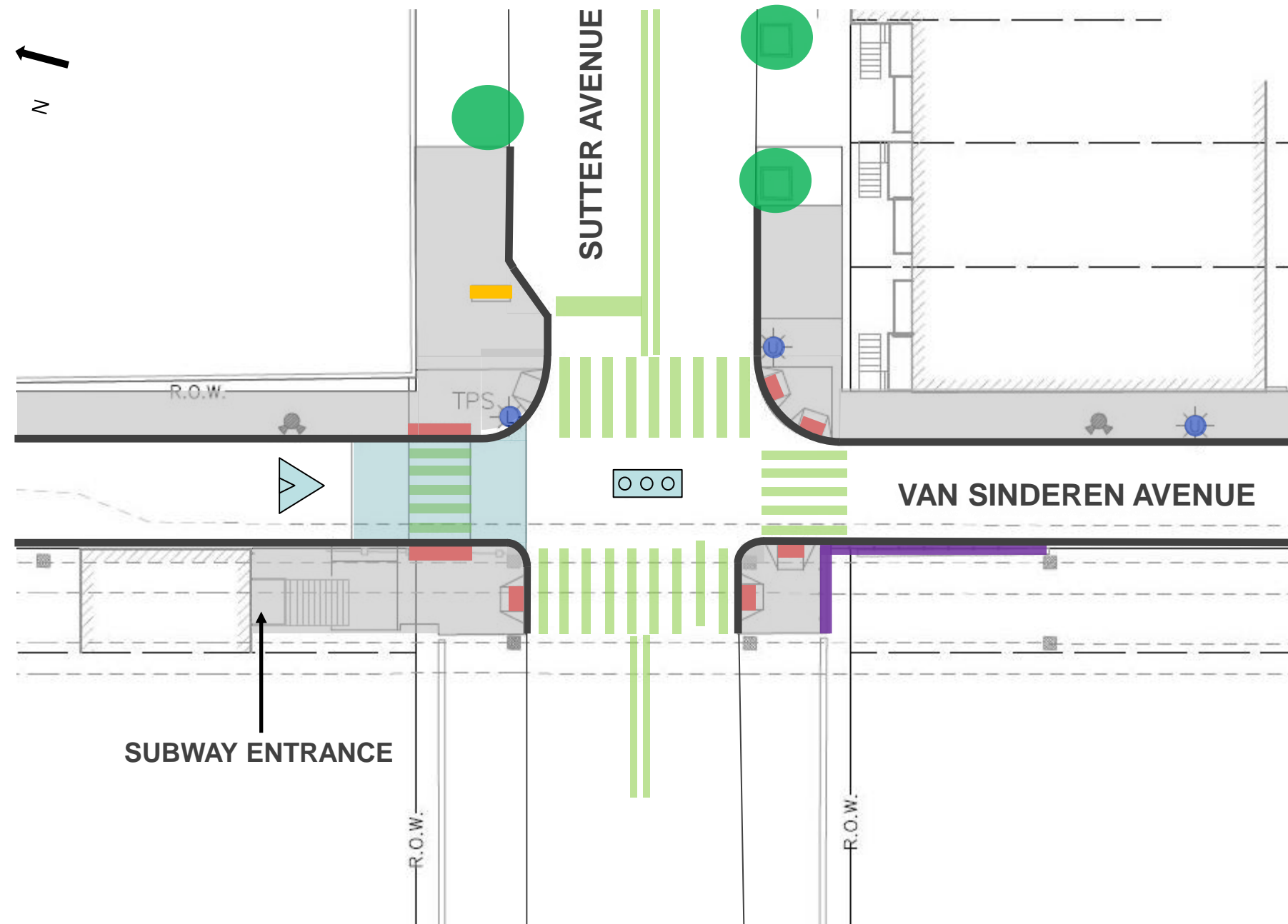

-  Raised Crosswalk
-  Steel Faced Curb
-  Concrete Sidewalk (Unpigmented)
-  Relocate Street Lights / Utility Pole
-  Proposed ADA Ramps with Detectable Warning paver
-  Pavement Markings
-  Proposed EI-Fence
-  Proposed Wayfinding Type 'B' Sign
-  Existing Trees to Remain
-  Signalized Intersection
-  Speed Bump Symbol

Scale: 1:30

3D RENDERING OF SUTTER AVENUE INTERSECTION



WAYFINDING SIGN

- Proposed Type 'B' sign
Northeast corner of Van Sinderen Avenue and Sutter Avenue
- Additional locations:
 - East side of Junius Street (north of Livonia Avenue)
 - North side of Livonia Avenue (east of Van Sinderen Avenue)
 - West side of Van Sinderen Avenue (north of Atlantic Avenue)

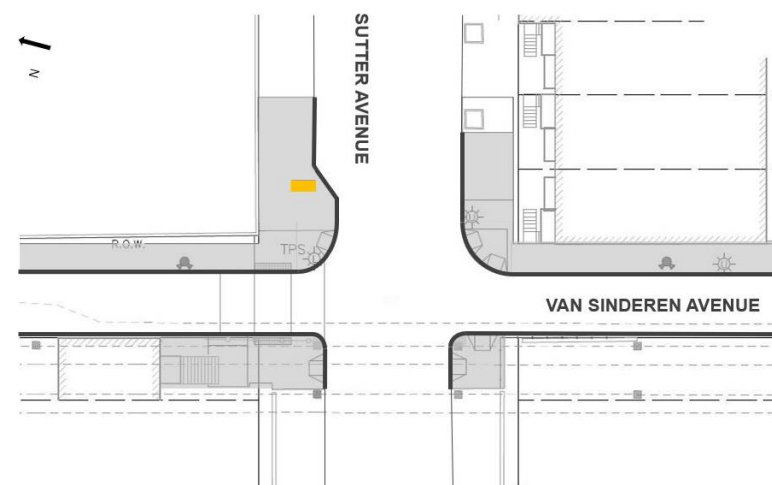

 Proposed Wayfinding Sign



EL-FENCE

- The El-fence is a modular fence that is used in streetscape enhancement projects under elevated infrastructure. The panels of the El-Fence are flexible and can be easily modified to display art, graphics, and pops of color, or incorporate text and logos.

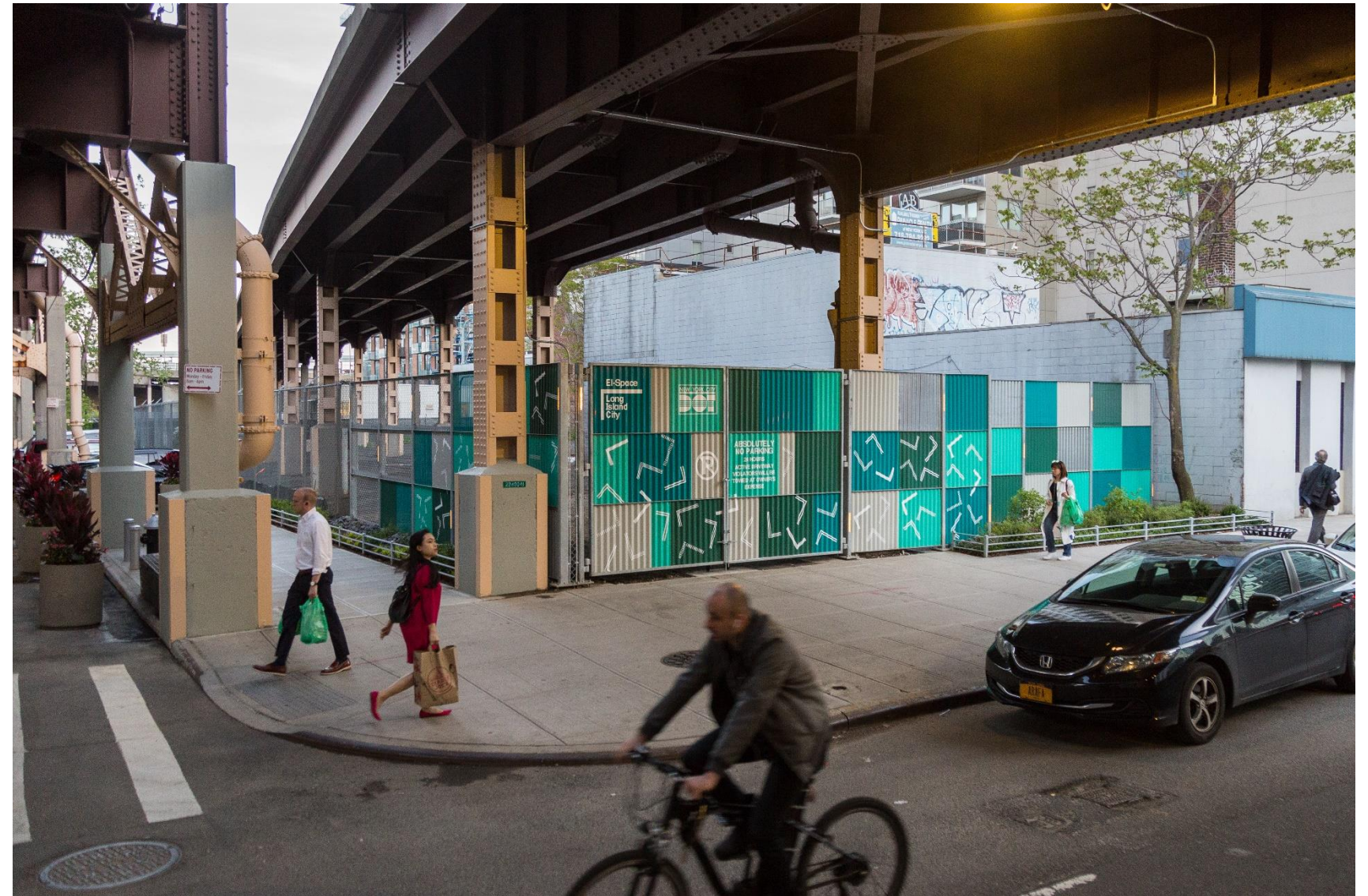

PROJECT SCHEDULE

- Design Start– June 8, 2018
- 40% Final Design (Plans mailed to Community Board) – March 5, 2020
- Project was on hold during COVID-19 Emergency from March 2020 to December 2020
- 75% Final Design (Plans emailed to Community Board) – 08/23/2021
- Prepare and Coordinate PDC application – November 2021
- Final Design Completion for Bid – Spring 2022
- Projected Construction – Summer 2023 to 2025

THANK YOU



Van Sinderen Avenue Streetscape Improvements,
Borough of Brooklyn

October 26, 2021