

# Community Board Presentation for the Reconstruction of Summit Place Step Street

**Project ID: HWXS911**

**Borough of the Bronx**

Presentation to The Bronx Community Board #8

Prepared by Dewberry Engineers and Marvel

May 15, 2025

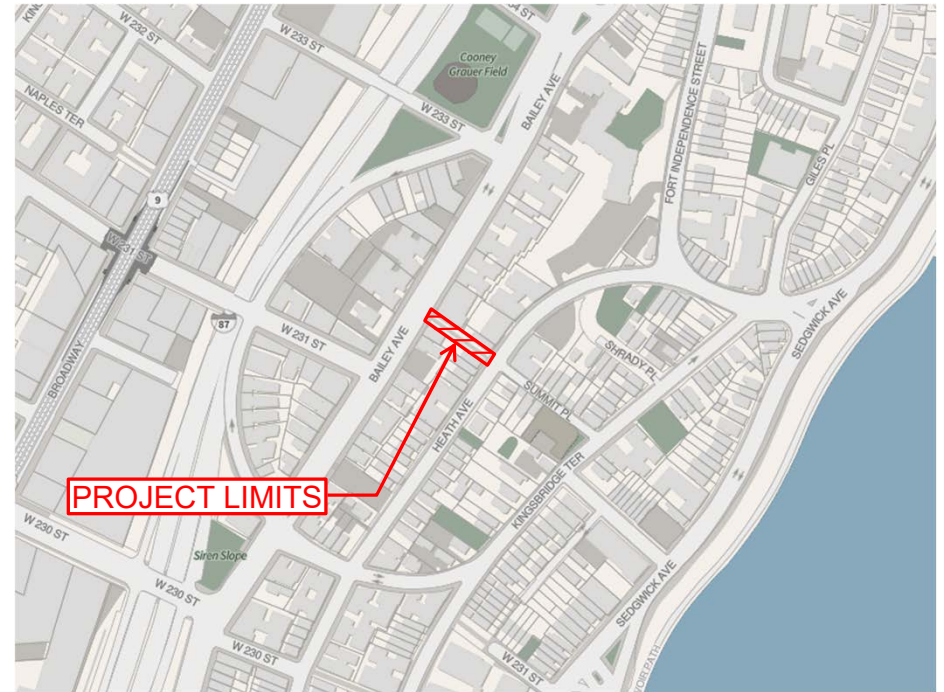
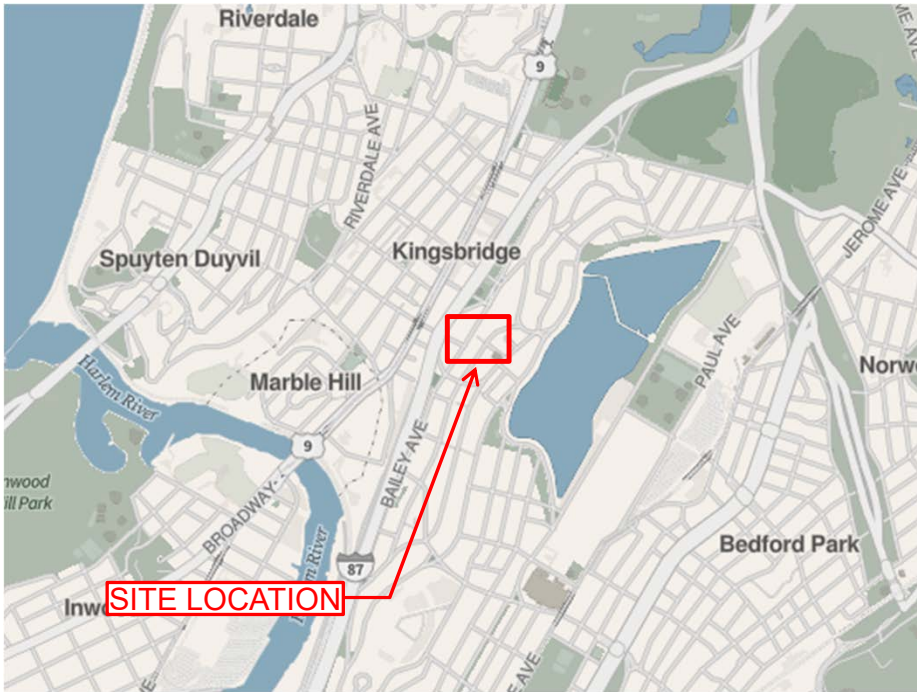









1 – Heath Avenue Facing West



2 – Middle of Step Street Facing East

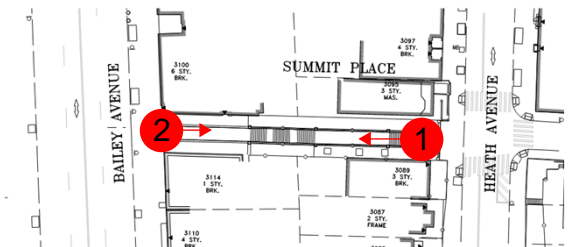



3 – Middle of Step Street Facing West

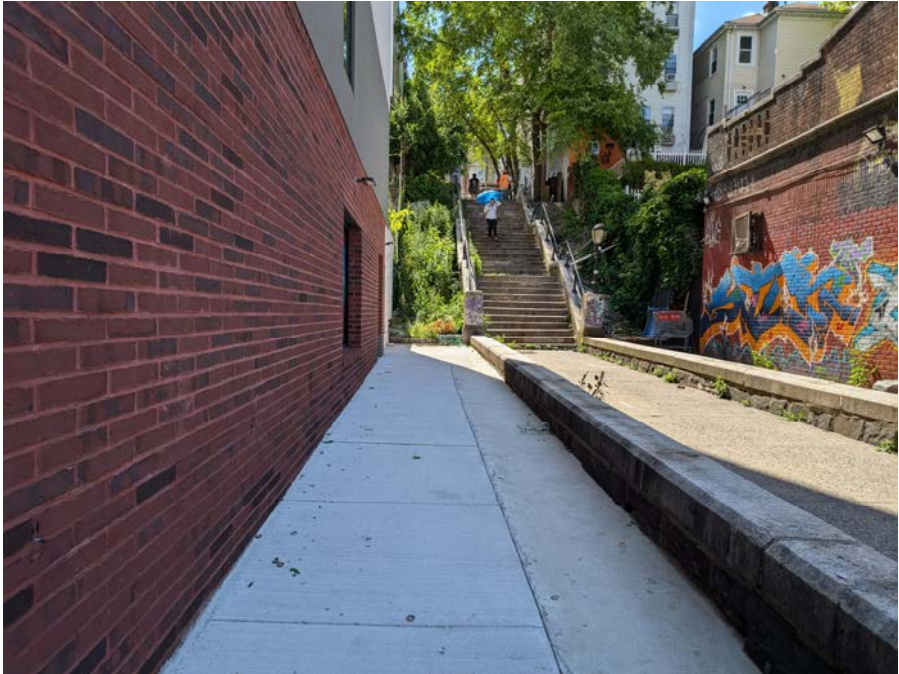

4 – Bailey Avenue Facing East

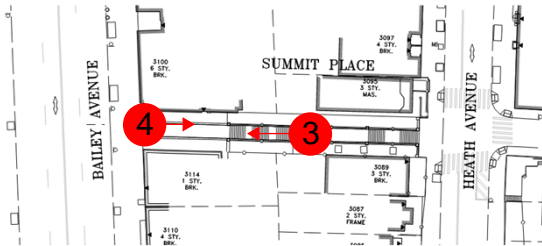





5 – Bailey Avenue Facing East



6 – West Side of Bailey Avenue Facing East

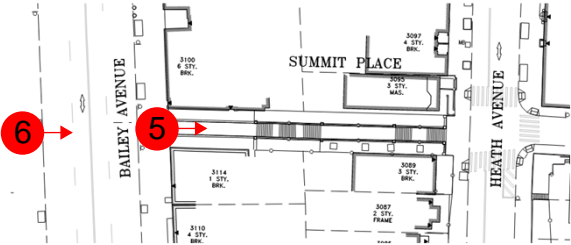

## Scope of Work

- Address substandard conditions through full reconstruction of the Step Street to make it a safe travel path/route.
- Maximize accessibility, public space, functionality, and streetscape amenities.
- Provide universal accessibility with ADA ramp.
- Install a bicycle channel adjacent to the stairs to maximize usage.
- Provide new energy efficient LED light poles to improve safety.
- Improve drainage system - connection to the nearby sewer through a network of drains.
- Introduce new plantings to provide greenery and mitigate climate change.
- Remove existing trees within the step street and propose new street trees where appropriate.
- Upgrade pedestrian ramps at the intersection of Summit Place and Heath Avenue.

## RENDERED PLAN

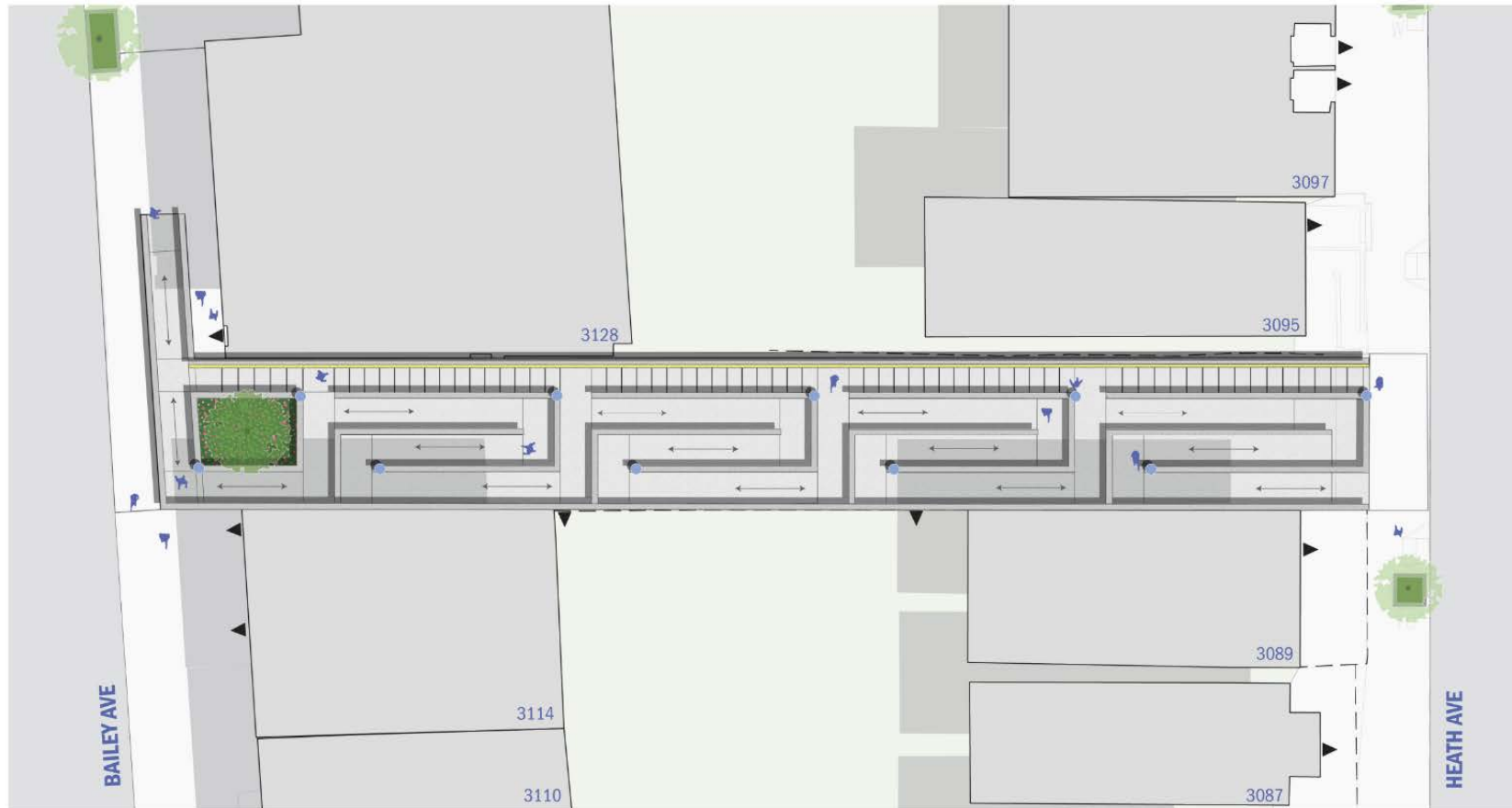

● LAMP POST  
▲ INGRESS/EGRESS





## RENDERED PLAN | DESIGN CHALLENGES

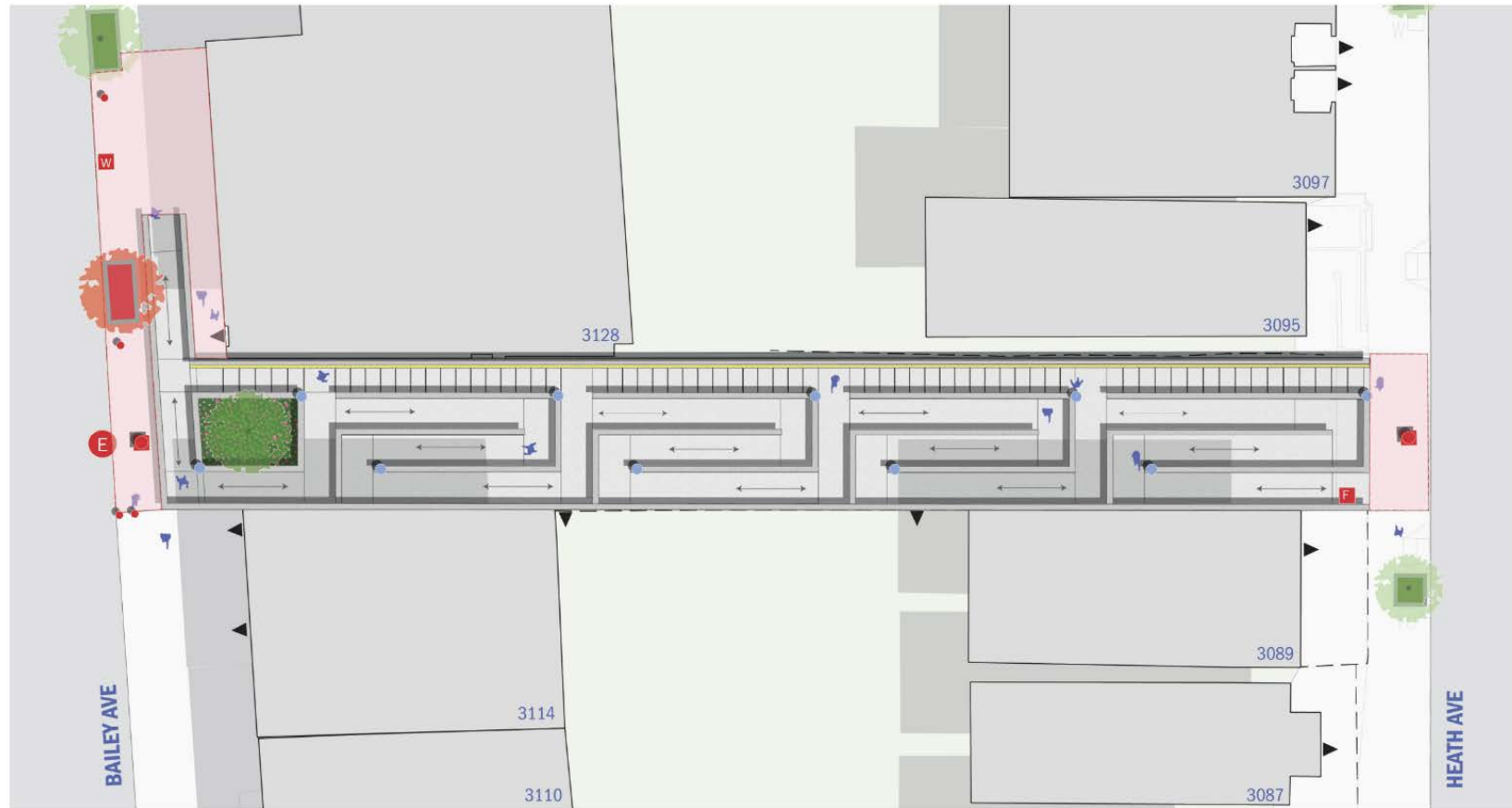



 TREE REMOVAL

 FIRE ALARM  
POST REMOVAL  
 POTENTIAL CONFLICT WITH  
ELECTRICAL MANHOLE

 SIGN REMOVAL  
 SIDEWALK REQUIRED  
TO BE RECONSTRUCTED

 WATER VALVE  
BOX REMOVAL  
 LAMP POST REMOVAL

 LAMP POST  
 INGRESS/EGRESS



3128 BAILEY AVE. | GROUND FLOOR WINDOWS CONCEALED & FIRST FLOOR WINDOWS PARTIALLY OBSTRUCTED



3095 HEATH AVE. | FENCE OBSTRUCTED



3095 HEATH AVE. | GROUND FLOOR WINDOWS CONCEALED & FIRST FLOOR WINDOWS PARTIALLY OBSTRUCTED

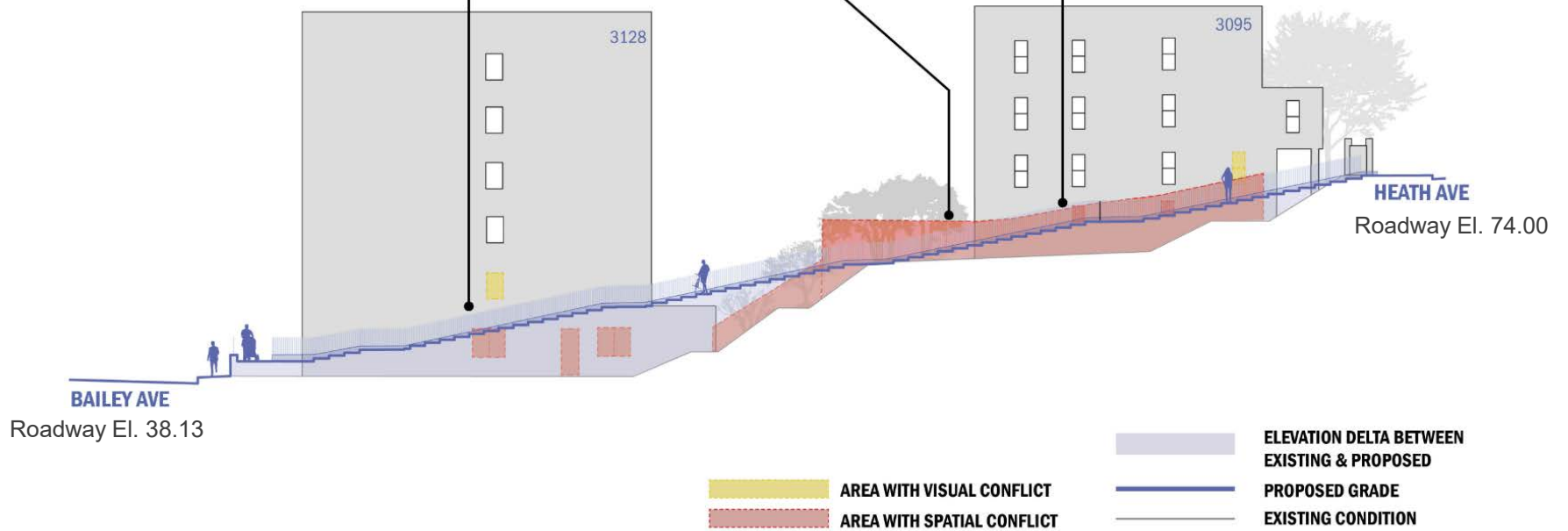



**3114 BAILEY AVE. | TWO EXHAUST VENTS OBSTRUCTED**



**3114 BAILEY AVE. | EGRESS OBSTRUCTED**



**3089 HEATH AVE. | EGRESS OBSTRUCTED AND FENCE PARTIALLY OBSTRUCTED**



**3089 HEATH AVE. | GROUND FLOOR WINDOW PARTIALLY OBSTRUCTED**

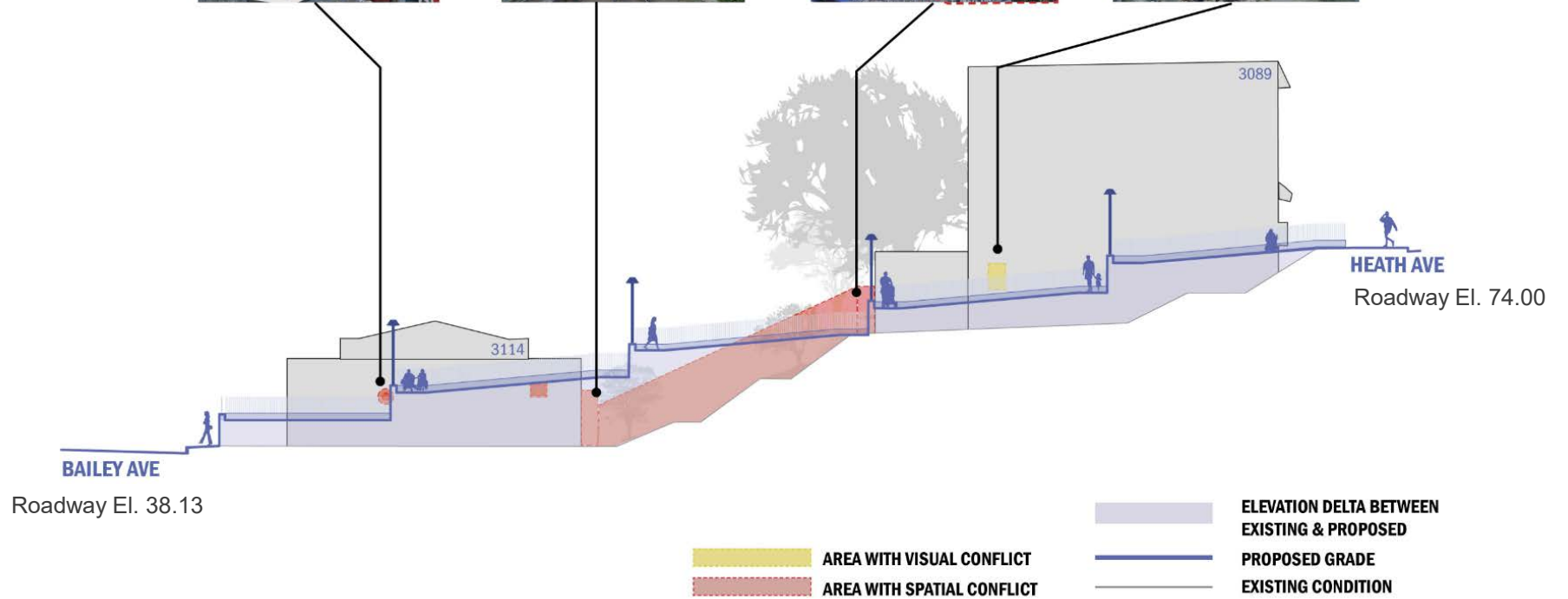

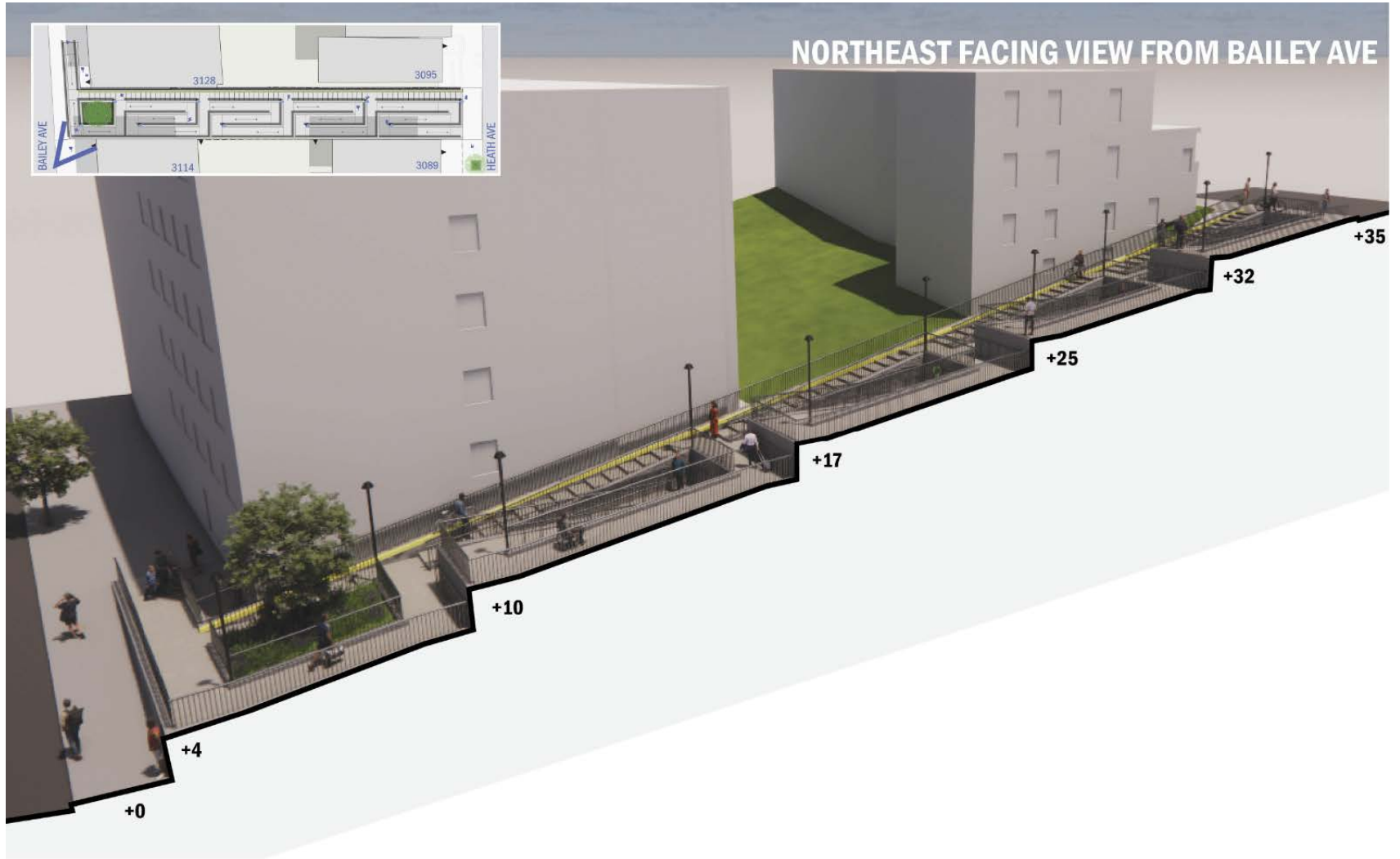





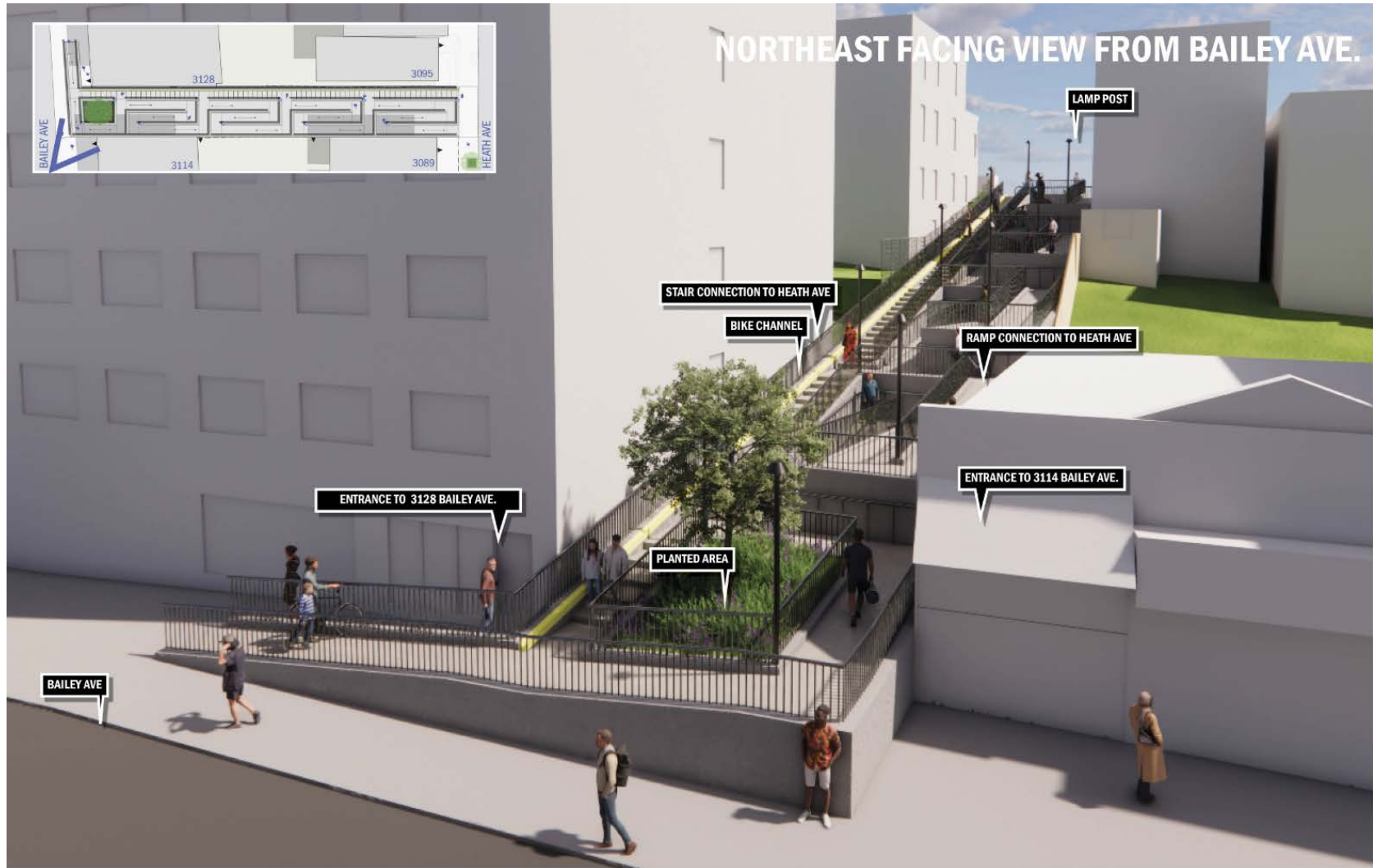







ENTRANCE TO SUMMIT PLACE



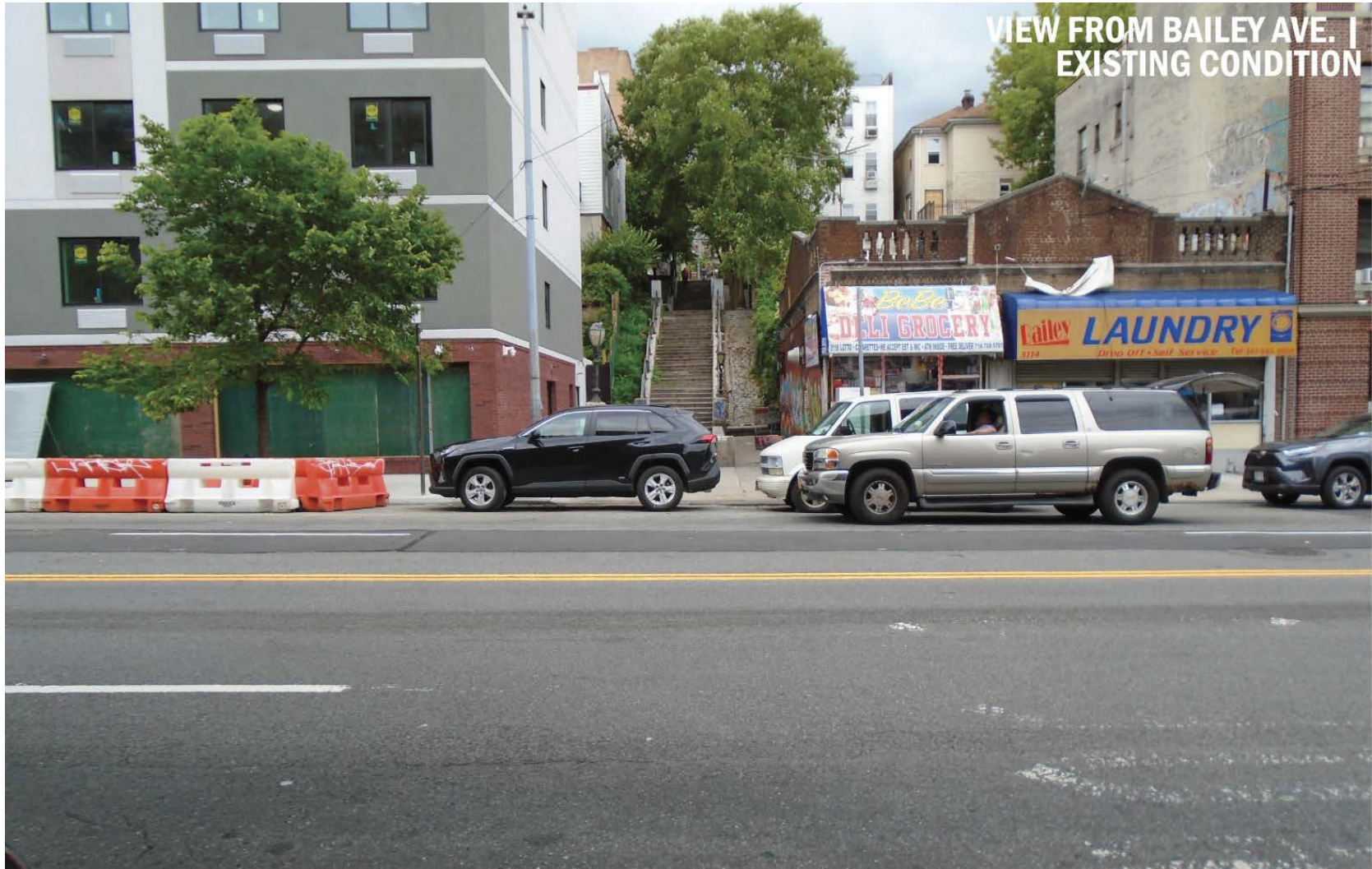







**VIEW FROM BAILEY AVE. |  
EXISTING CONDITION**



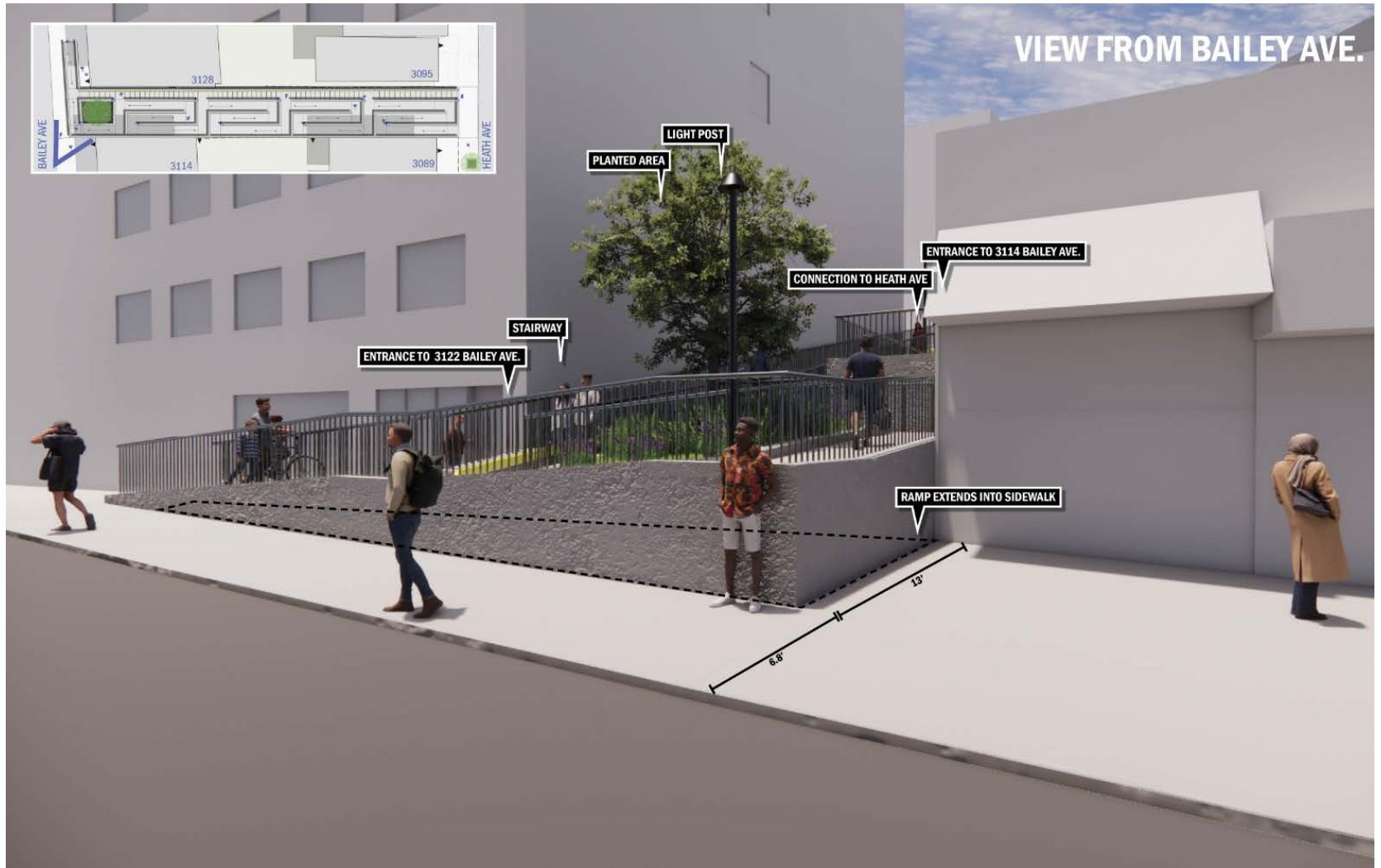

## SITE MATERIALS & PLANTING PALETTE



**FLUSHING MEADOWS LUMINAIRE AND POLE**



**BLACK GUM TREE**  
*NYSSA SYLVATICA*



**ALUMINUM GUARDRAIL & HANDRAIL**

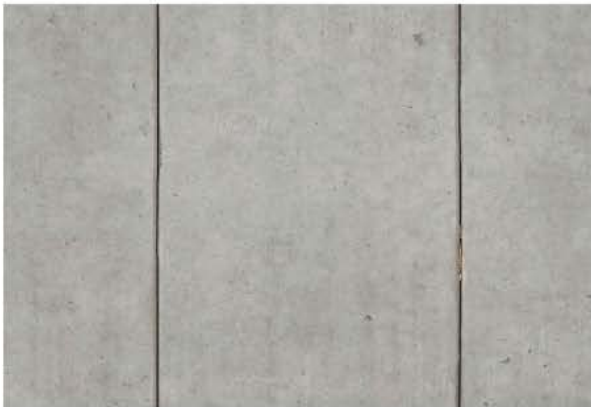

**UNPIGMENTED CONCRETE**



**DWARF FOTHERGILLA**  
*FOTHERGILLA GARDENII*



**CREeping PHLOX**  
*PHLOX SUBULATA*

## Maintenance and Protection of Traffic

- Pedestrian access will be closed on the Summit Place Step Street during construction. Alternate route will be proposed.
- Building access adjacent to Step Street will be maintained at all times during construction.
- During construction, approximately three (3) parking spaces will be impacted on Heath Avenue and approximately three (3) parking spaces will be impacted on Bailey Avenue.
- Construction equipment will be maintained within the Step Street corridor for as much of construction as possible, until moving to the east side of Bailey Avenue.
- Pedestrian walkways will be maintained at the sidewalks of Summit Place on Heath Avenue and Bailey Avenue.
- Construction Staging will be provided to mitigate impact to local traffic and the community.





3 Parking Spots on Bailey Avenue will be temporarily closed during construction.

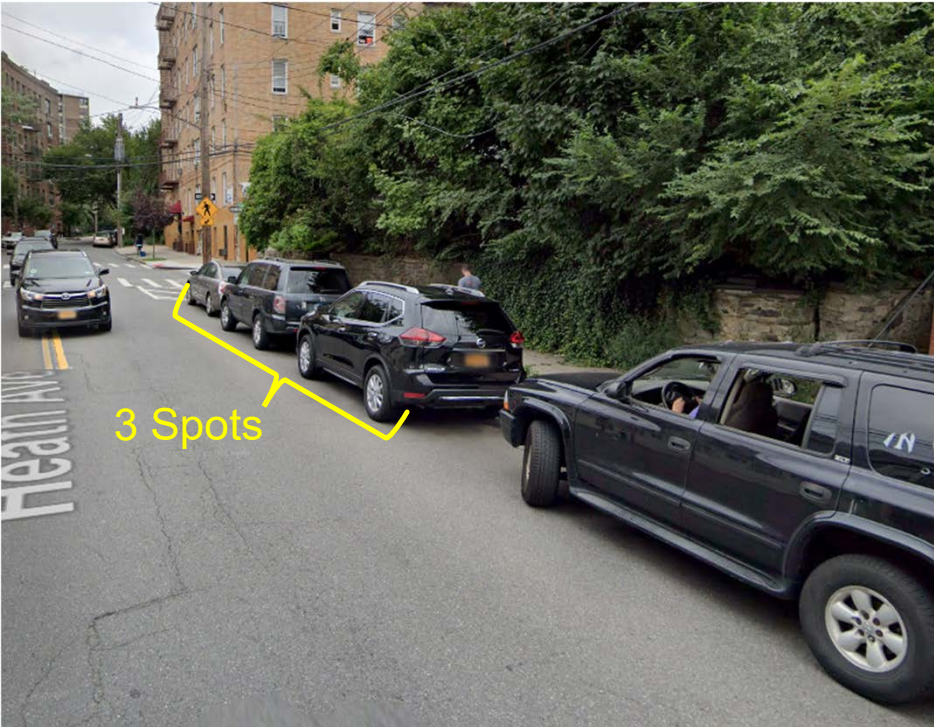

3 Parking Spots on Heath Avenue will be temporarily closed during construction.

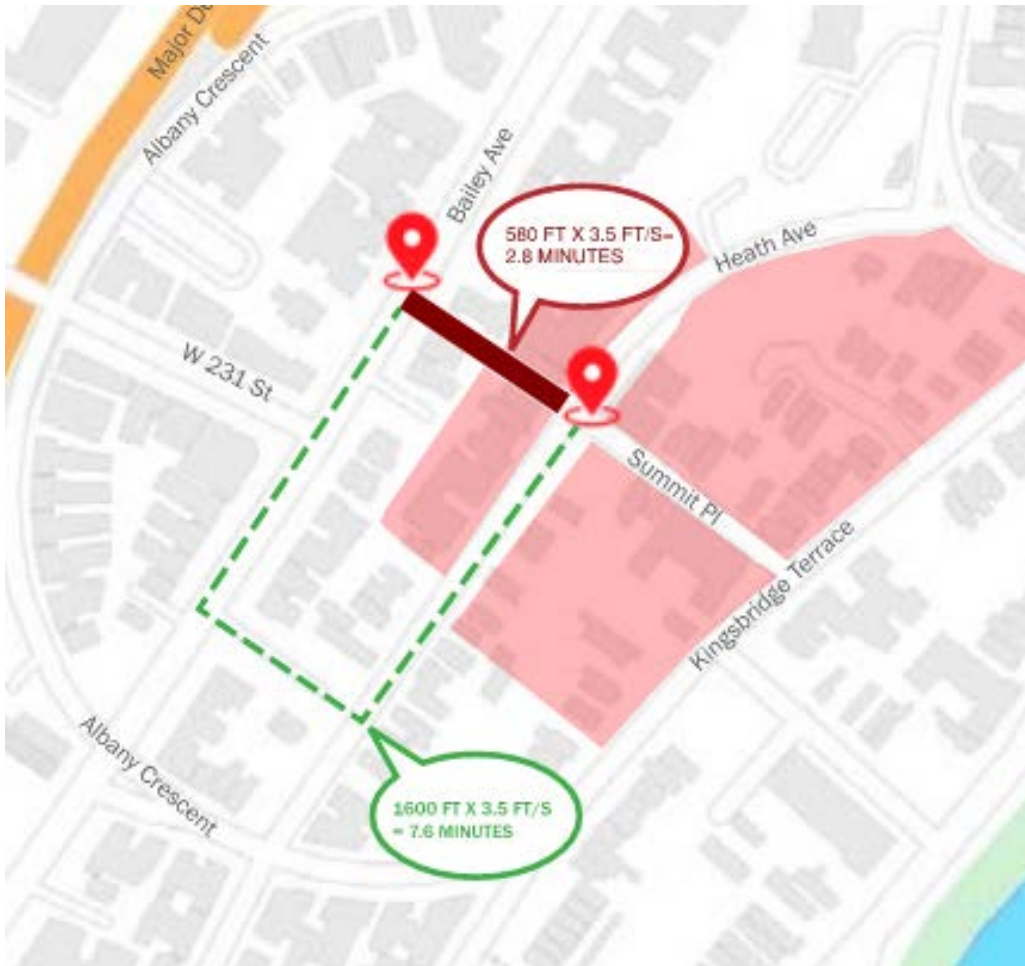

## WALKING DISTANCE DIAGRAM

- Proposed Walking Route (Hybrid Option)
- - - Alternative Pedestrian Detour
- Area Adjacent to Summit Place Street Construction

---

## COMMUNITY OUTREACH

- **DDC's Office of Community Outreach + Notification (OCON)** works with CB's, BID's, local businesses, and other community stakeholders impacted by construction.
- DDC will assigned a dedicated on-site Community Construction Liaison (CCL). The CCL information will be provided at the pre-Construction phase:

Email: TBD

Phone: TBD

Field Office Location: TBD

Field Office Hours: 7AM to 3:30PM



DDC Project Lead: Kristen Cawthorn, [cawthorkr@ddc.nyc.gov](mailto:cawthorkr@ddc.nyc.gov) 929.206.1334



---

## COMMUNITY OUTREACH (continued)

**Community Construction Liaison (CCL)** responsibilities are as follows:

- First point of contact, maintain on-site presence and communications.
- Identify, resolve, and/or proactively address issues and inquiries.
- Distribute advisories and weekly construction activities newsletter.
- Provide 72-hour and 24-hour (confirmation or cancellation) advisories for work impacts by email and door to door.
- Attend community board monthly DSC meetings and other community meetings as necessary, to keep the community informed of the project schedule and impacts.

# COMMUNITY CONSTRUCTION LIAISON INVOLVEMENT

## Keeping You Informed.

The on-site CCL works directly with the project team. CCL will address community concerns, respond to inquiries, attend meetings, as needed, as well as distribute project related materials to keep the community informed and notified.

### PROJECT INFORMATION CARD (PIC)



### ADVISORIES



### WEEKLY LOOK AHEAD BULLETIN

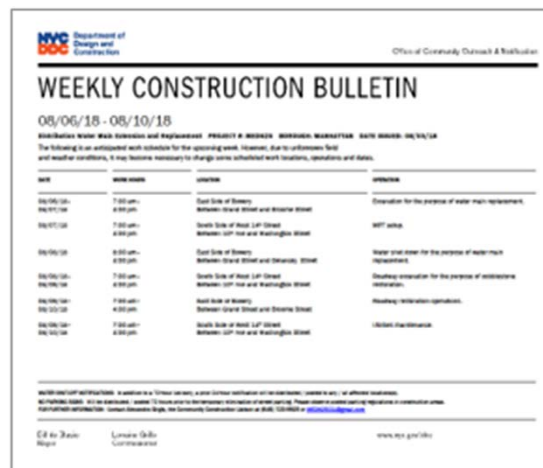

### QUARTERLY NEWSLETTERS



**Estimated Cost: \$12.3 Million**

**Projected Design Completion: 2<sup>nd</sup> Quarter 2026**

**Projected Start of Construction: 1<sup>st</sup> Quarter 2027**

**Projected Construction Duration: 30 months**

**Projected Construction Completion: 4<sup>th</sup> Quarter 2029**



# THANK YOU!

## Q & A

### More to say?

Please Contact

Bronx Borough Commissioner's Office

**Anthony Perez, Bronx Borough Commissioner**

**New York City Department of Transportation**

**[aperez@dot.nyc.gov](mailto:aperez@dot.nyc.gov)**

**212-748-6680**

# Appendix

## SECTION ELEVATION | FRONT FACING

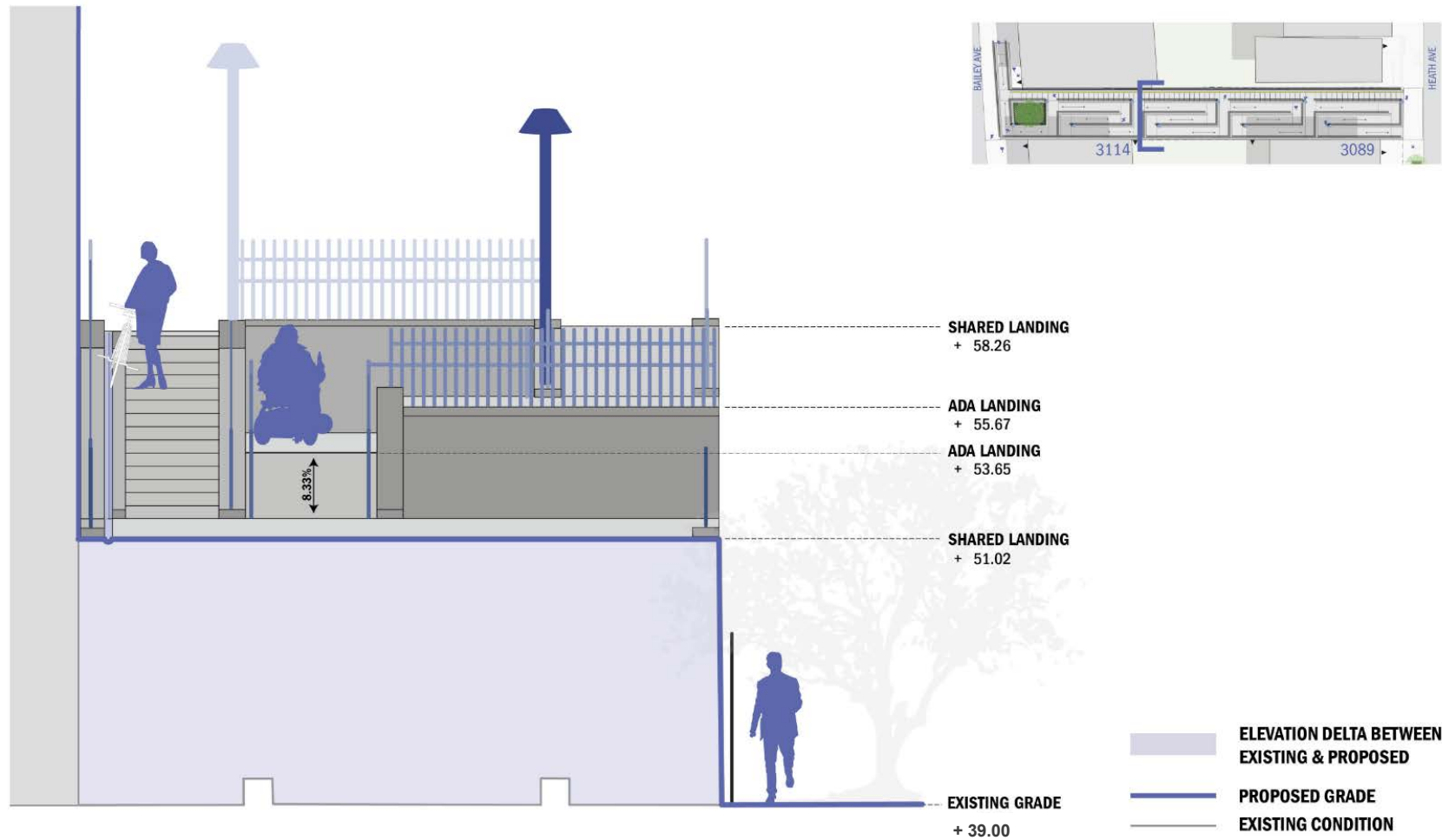



## SECTION | FRONT FACING

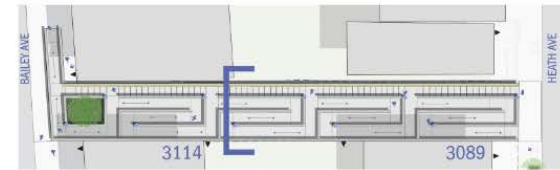
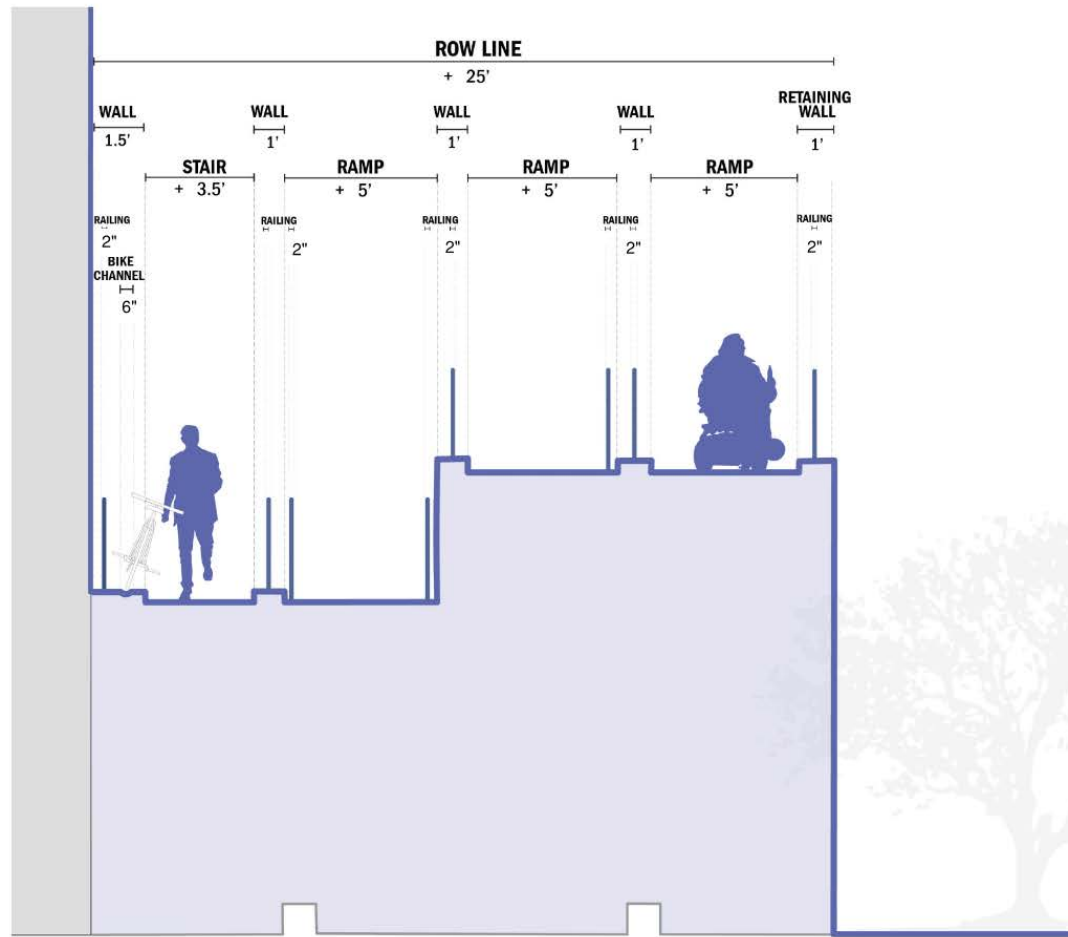

- ELEVATION DELTA BETWEEN EXISTING & PROPOSED
- PROPOSED GRADE
- EXISTING CONDITION



