



Department of
Design and
Construction



NYC Parks

NEW RECREATION CENTER AT ROY WILKINS PARK

CB Parks Committee

April 1st, 2026

TRITON
CONSTRUCTION

ELITE
CONSTRUCTION OF NY

**BEYER
BLINDER
BELLE**

AGENDA

- Partner Agencies Introductions
- Ongoing Developments in Roy Wilkins Park
- Project Timeline
- Overview of the Design Build Team
- New Recreation Center at Roy Wilkins Park Overview

**NEW RECREATION CENTER
AT ROY WILKINS**

PROJECT CITY AGENCIES



- **Jade Bailey, PE** | Director,
Alternative Delivery, Office of the Commissioner
- **Andrew Murjas** | Deputy Director,
Alternative Delivery, Office of the Commissioner
- **Abraham Gonzalez** | Project Manager,
Alternative Delivery, Office of the Commissioner



NYC Parks

- **Rachel Rosenberg, RA** | Architect,
NYC Parks Capital Projects
- **Meira Berkower** | Chief of Staff to the
Queens Borough Commissioner
- **Christopher Davis** | Chief
Queens Recreation

**NEW RECREATION CENTER
AT ROY WILKINS**

ONGOING DEVELOPMENTS IN ROY WILKINS PARK



NEW RECREATION CENTER AT ROY WILKINS

COMMUNITY ENGAGEMENT

NYC Parks collected input from the community on potential program spaces for the new recreation center during the virtual public input meeting on January 25, 2022

NYC Parks and DDC provided an update to the community at the Queens CB 12 Parks Committee meeting at Eagle Academy on May 1, 2024



**NEW RECREATION CENTER
AT ROY WILKINS**

PROJECT TIMELINE

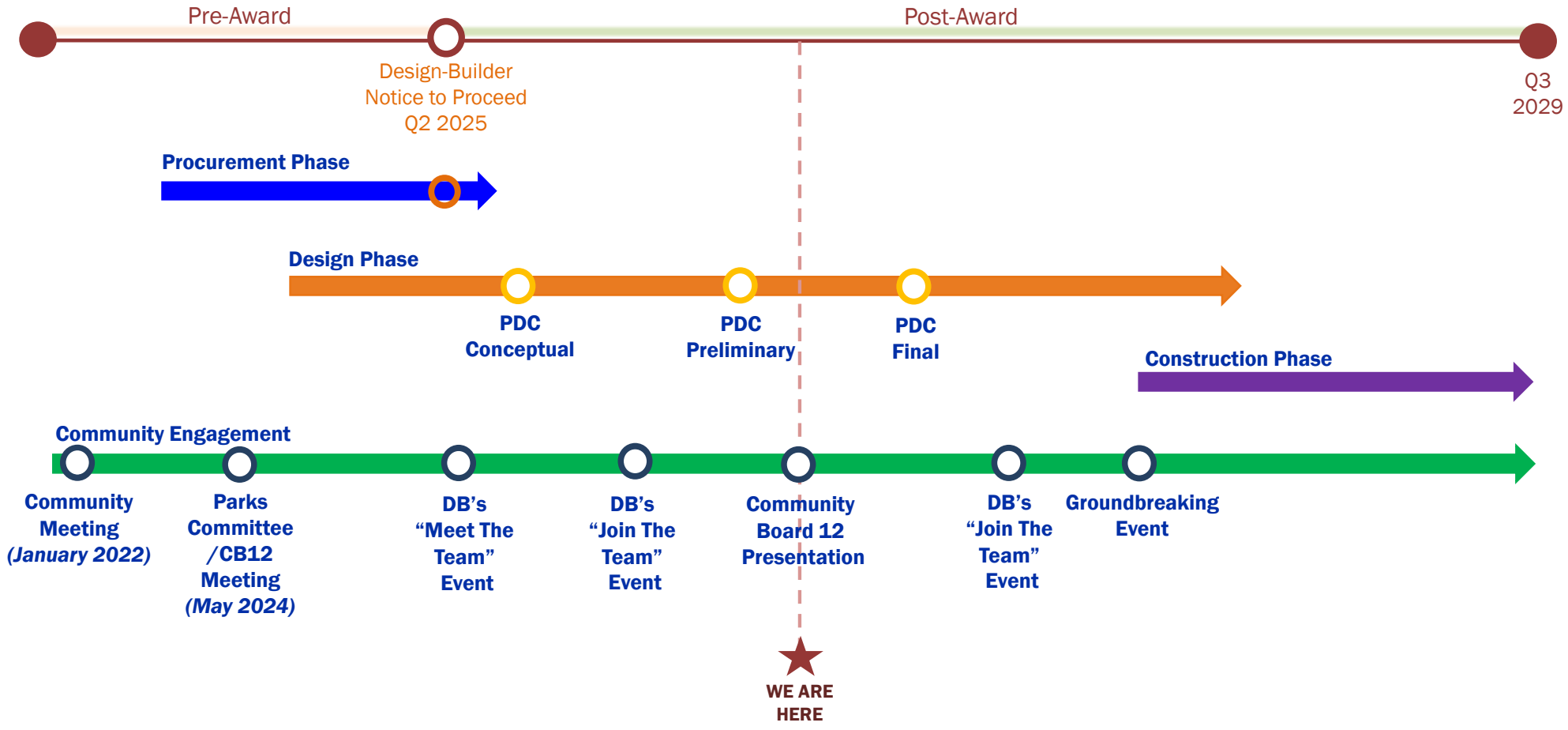

**NEW RECREATION CENTER
AT ROY WILKINS**

INCITU

Recreation Center Development

The new recreation center project proposes the construction of a new 67,000-square-foot recreation center within Roy Wilkins Park. Designed to function as a year-round hub for sports, fitness, education, and the arts, the facility will include amenities such as a gymnasium, indoor track, swimming pool, fitness rooms, and multipurpose spaces serving all age groups.

The facility will be constructed on an existing open field within the park, fronting Merrick Boulevard. The site is strategically positioned adjacent to a surface parking lot to the west and a public bus stop serving three transit lines along the southeastern edge, ensuring convenient and equitable transit access. The recreation center will serve as a safe, inclusive, and pedestrian-friendly public amenity, strengthening the bond between Roy Wilkins Park and the St. Albans community.

For more information visit the Department of Design and Construction website www.nyc.gov/site/ddc/index.page or www.rwrc-info.com

Desarrollo del Centro Recreativo

El proyecto propone la construcción de un centro recreativo de 67,000 pies cuadrados dentro del Parque Roy Wilkins. Diseñado para funcionar como un centro activo durante todo el año para deportes, acondicionamiento físico, educación y las artes, el edificio incluirá instalaciones como un gimnasio, pista interior para caminar, piscina, salas de ejercicio y espacios multifuncionales destinados a personas de todas las edades.

La instalación se construirá en un campo abierto existente dentro del parque, con frente hacia Merrick Boulevard. El sitio está estratégicamente ubicado junto a un estacionamiento en superficie al oeste y una parada de autobús público que atiende tres líneas de transporte a lo largo del borde sureste, lo que garantiza un acceso al transporte público conveniente y equitativo. El centro recreativo funcionará como un equipamiento público seguro, inclusivo y amigable para peatones, fortaleciendo el vínculo entre el Parque Roy Wilkins y la comunidad de St. Albans.

Para más información, visite: [Department of Design and Construction website](http://www.nyc.gov/site/ddc/index.page) www.nyc.gov/site/ddc/index.page or www.rwrc-info.com

Scan nearby QR codes to see in 3D

Escanea los códigos QR cercanos para verlos en 3D



Augmented Reality Visualization

The future site is available as a smartphone-based Augmented Reality (AR) experience. No app download is required, simply scan the QR code and raise your phone towards the site to see the future of this site.

El sitio futuro está disponible como una experiencia de realidad aumentada (AR) basada en smartphones. No se requiere descarga de aplicaciones, simplemente escanee el código QR y levante su teléfono hacia el sitio para ver el futuro de este sitio.



NYCOTI

powered by
inCitu



**NEW RECREATION CENTER
AT ROY WILKINS**

DESIGN BUILD TEAM



Triton construction:

- **Frank Reich** | CO-CEO, Design-Build Project Executive
freich@tritonconstruction.net
- **Matt Sarton** | Vice President, Design-Build Project Manager
msarton@tritonconstruction.net

Elite construction:

- **Michael Reed** | CCM, CEO/managing member, Construction Project Manager
mreed@eliteccny.com

**BEYER
BLINDER
BELLE**

BBB architects:

- **Carlos J. Cardoso** | AIA, Partner, Project Designer of Record
ccardoso@bbbarch.com
- **Miguel Angel Maldonado** | AIA, principal, Design Manager
mmaldonado@bbbarch.com



Crescent consulting (MBE):

- **Robert Nesmith** | M/WBE and Community Engagement, Executive Project Executive
rnesmith@crescentconsult.com

**NEW RECREATION CENTER
AT ROY WILKINS**

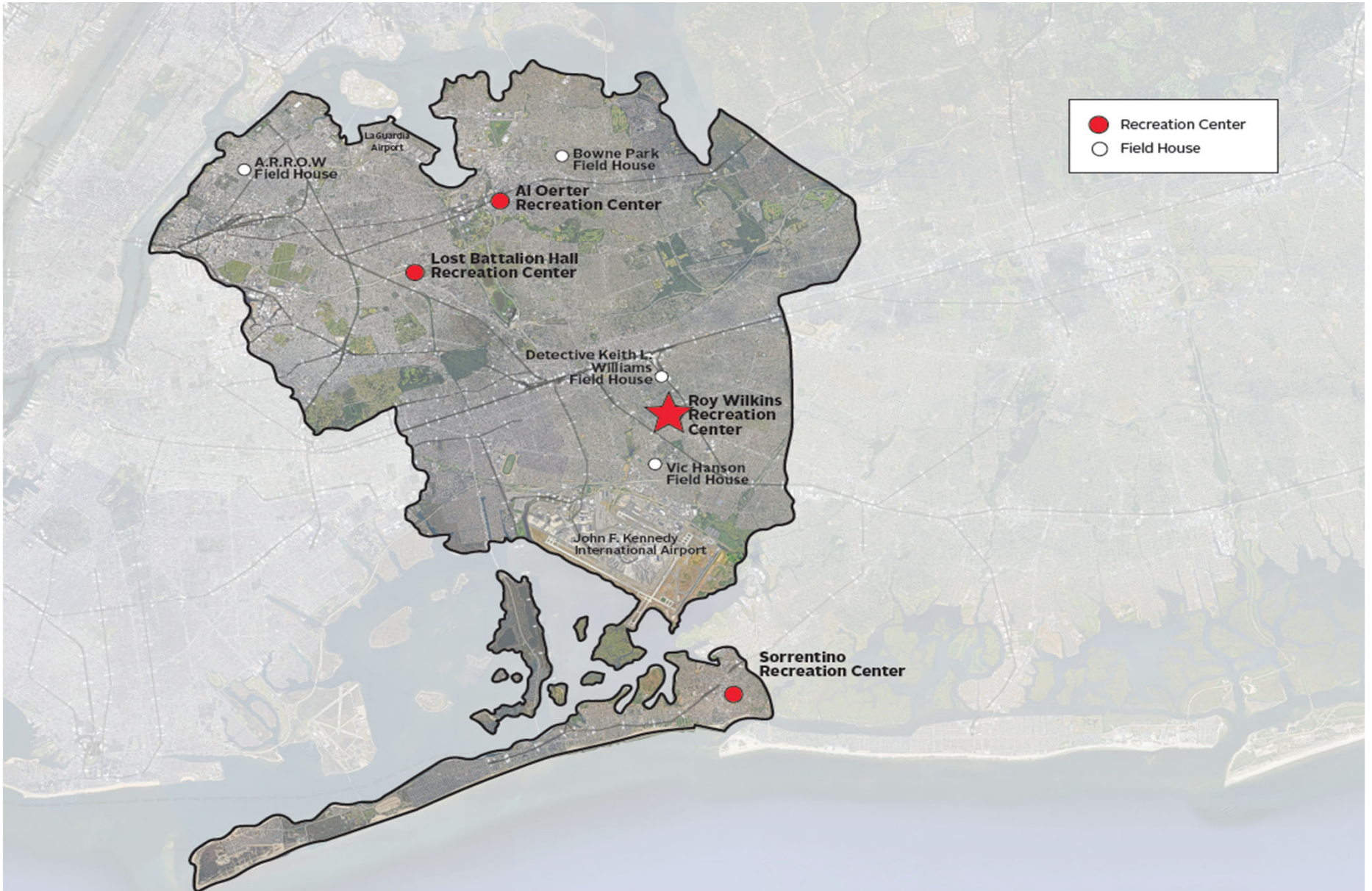

**NEW RECREATION CENTER
AT ROY WILKINS**

Recreation Center Location Plan
BOROUGH SCALE



**NEW RECREATION CENTER
AT ROY WILKINS**

Recreation Center Location Plan
NEIGHBORHOOD SCALE



**NEW RECREATION CENTER
AT ROY WILKINS**

Site Plan—Existing



A



B



**NEW RECREATION CENTER
AT ROY WILKINS**

KEY PLAN

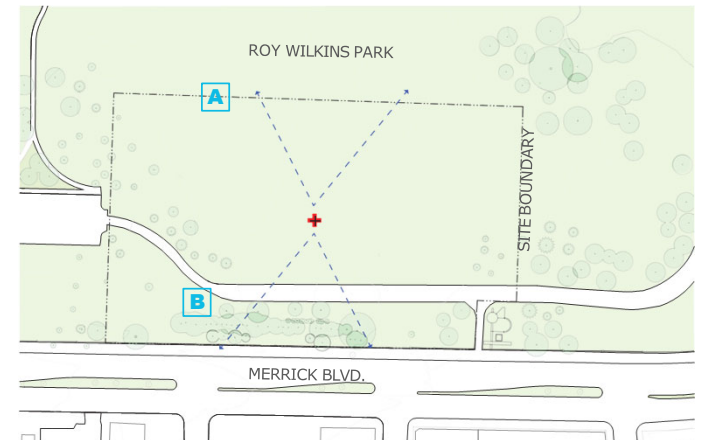

Site Photographs
NO SCALE

C



D



**NEW RECREATION CENTER
AT ROY WILKINS**

KEY PLAN

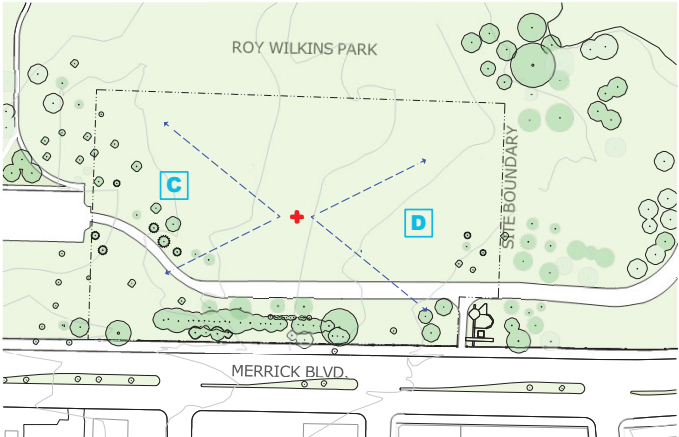

Site Photographs
NO SCALE

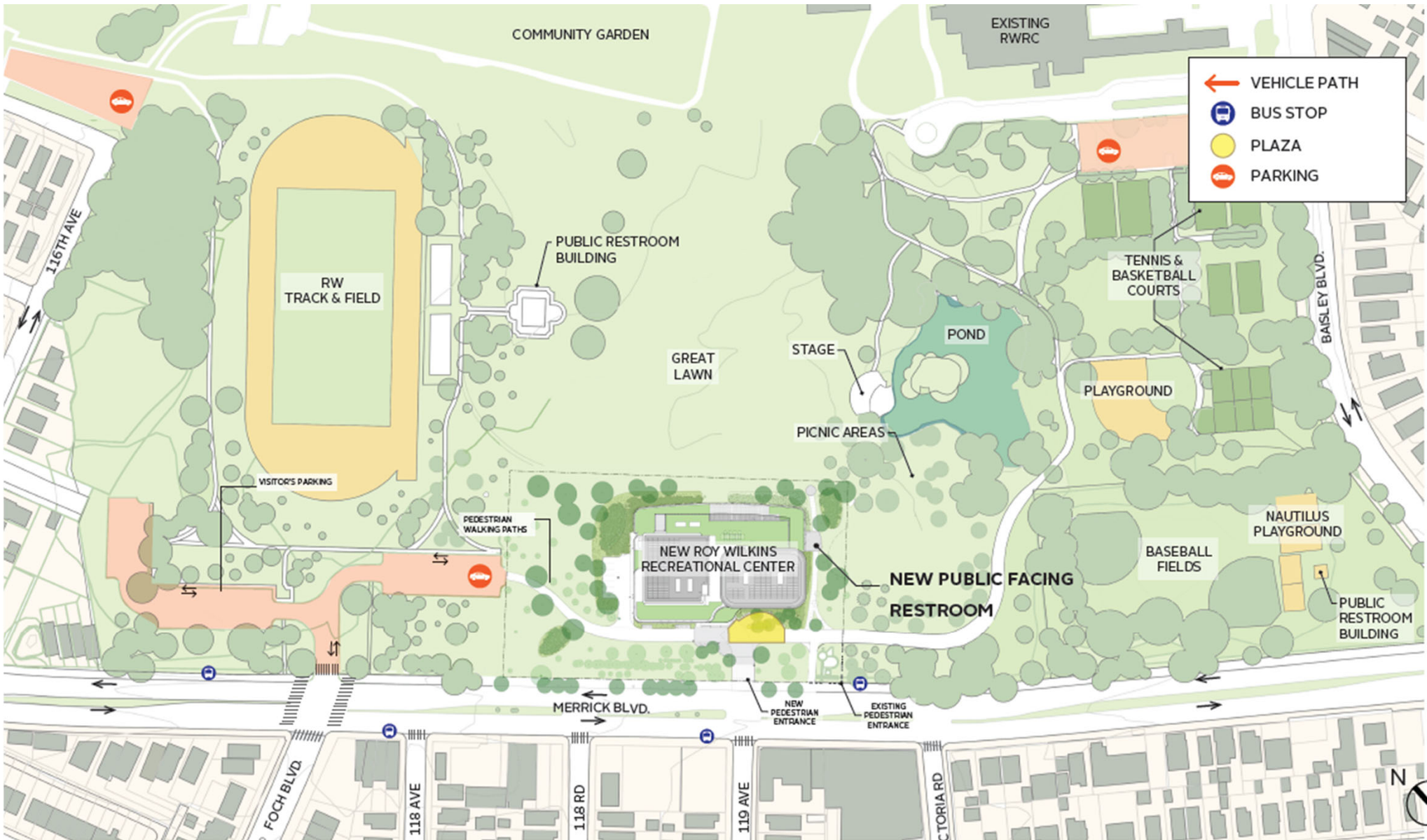

**NEW RECREATION CENTER
AT ROY WILKINS**

Site Plan - Context & Circulation



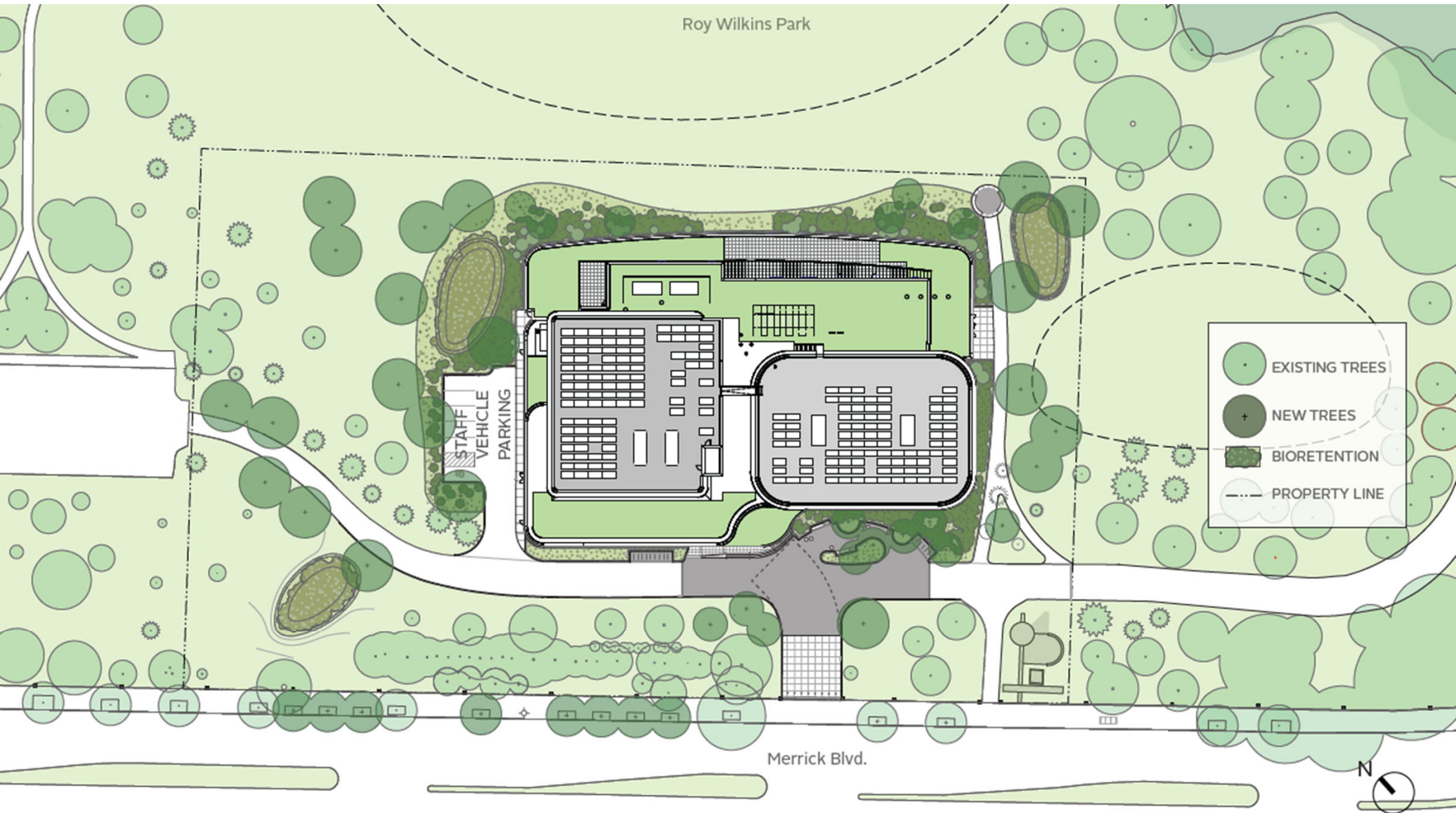

Roy Wilkins Park

STAFF
VEHICLE
PARKING

Merrick Blvd.

	EXISTING TREES
	NEW TREES
	BIORETENTION
	PROPERTY LINE

**NEW RECREATION CENTER
AT ROY WILKINS**

Site Plan

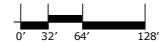

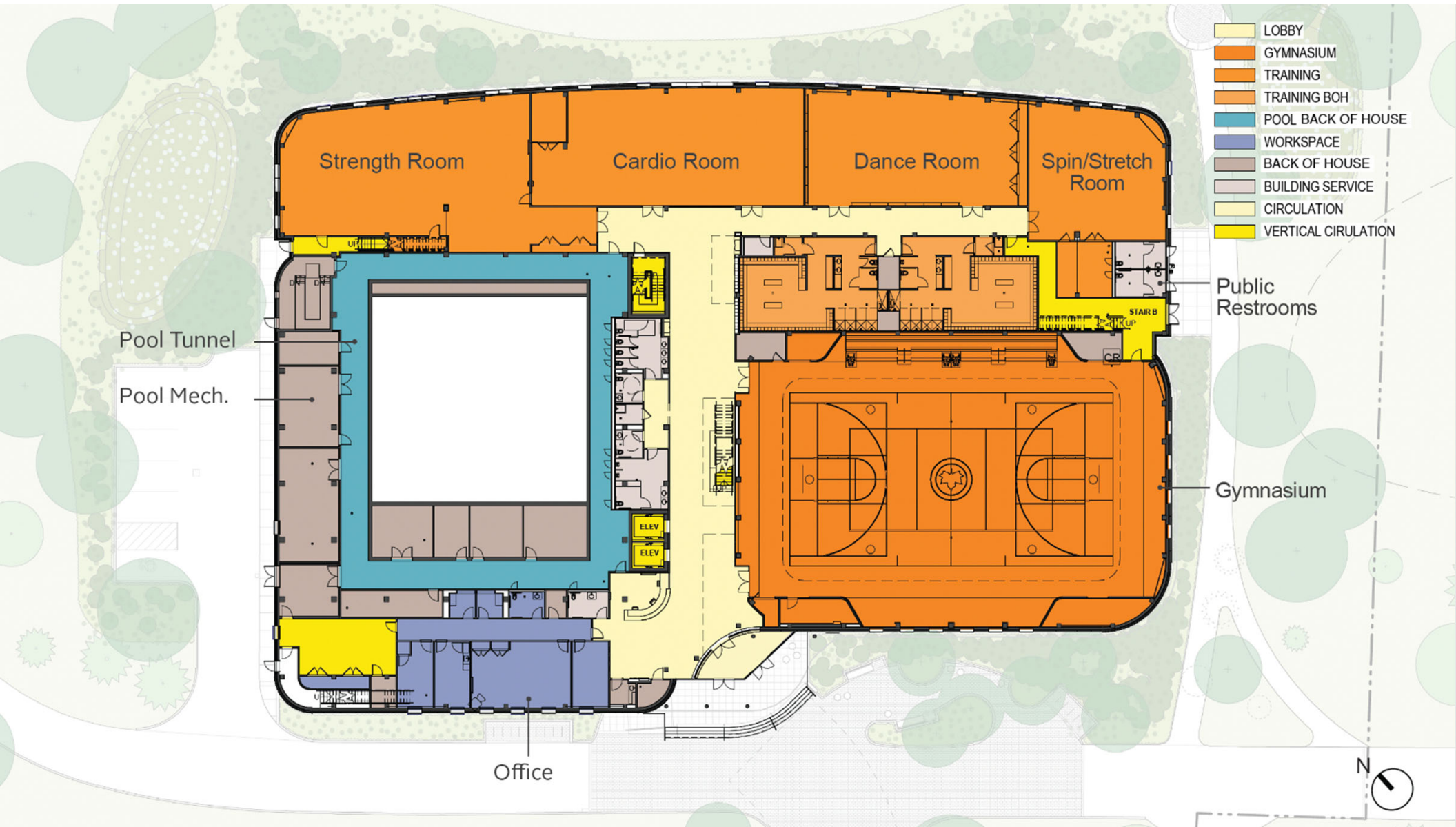

**NEW RECREATION CENTER
AT ROY WILKINS**

First Floor Plan

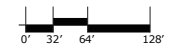

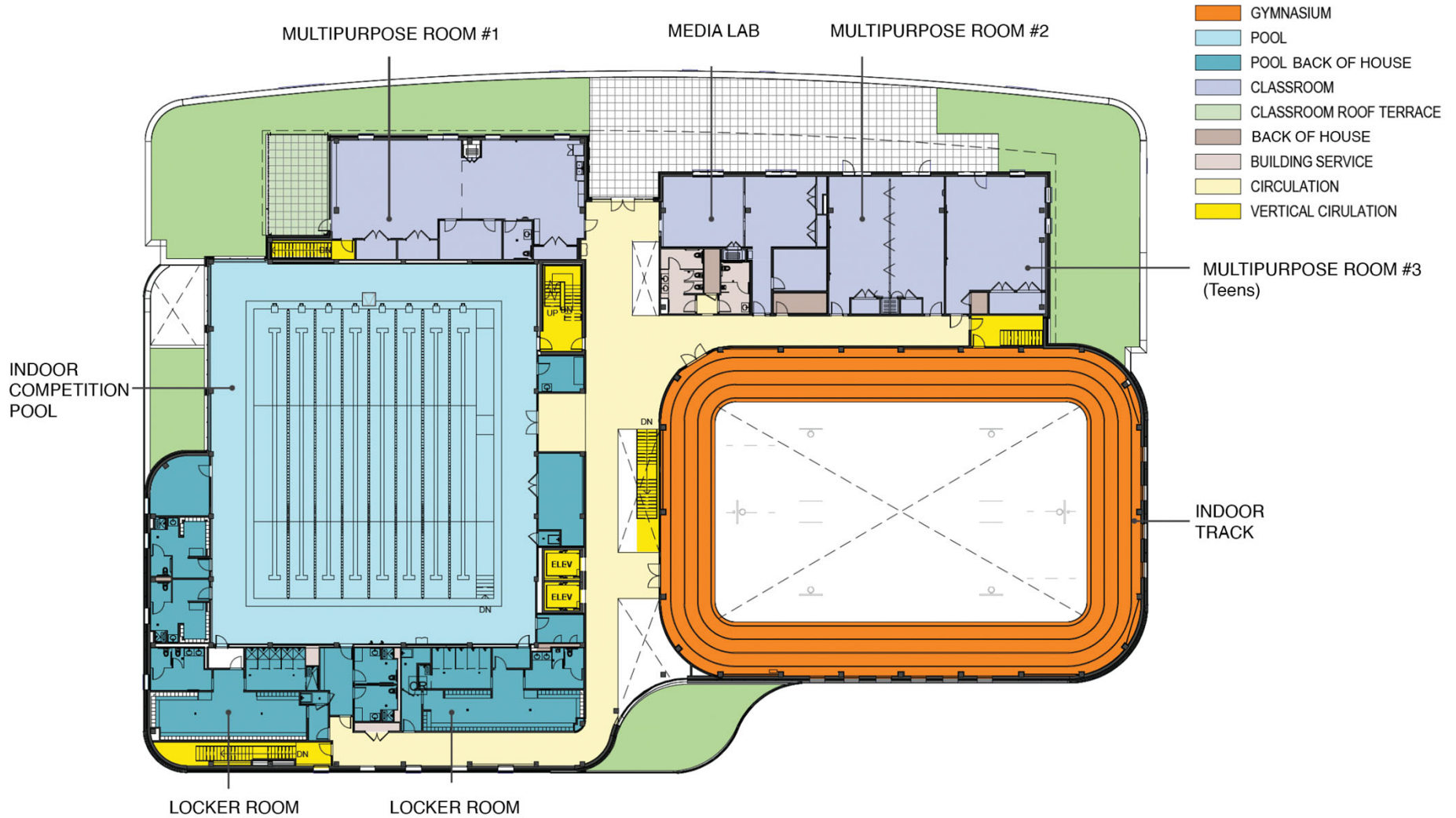

**NEW RECREATION CENTER
AT ROY WILKINS**

Second Floor Plan

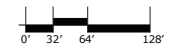

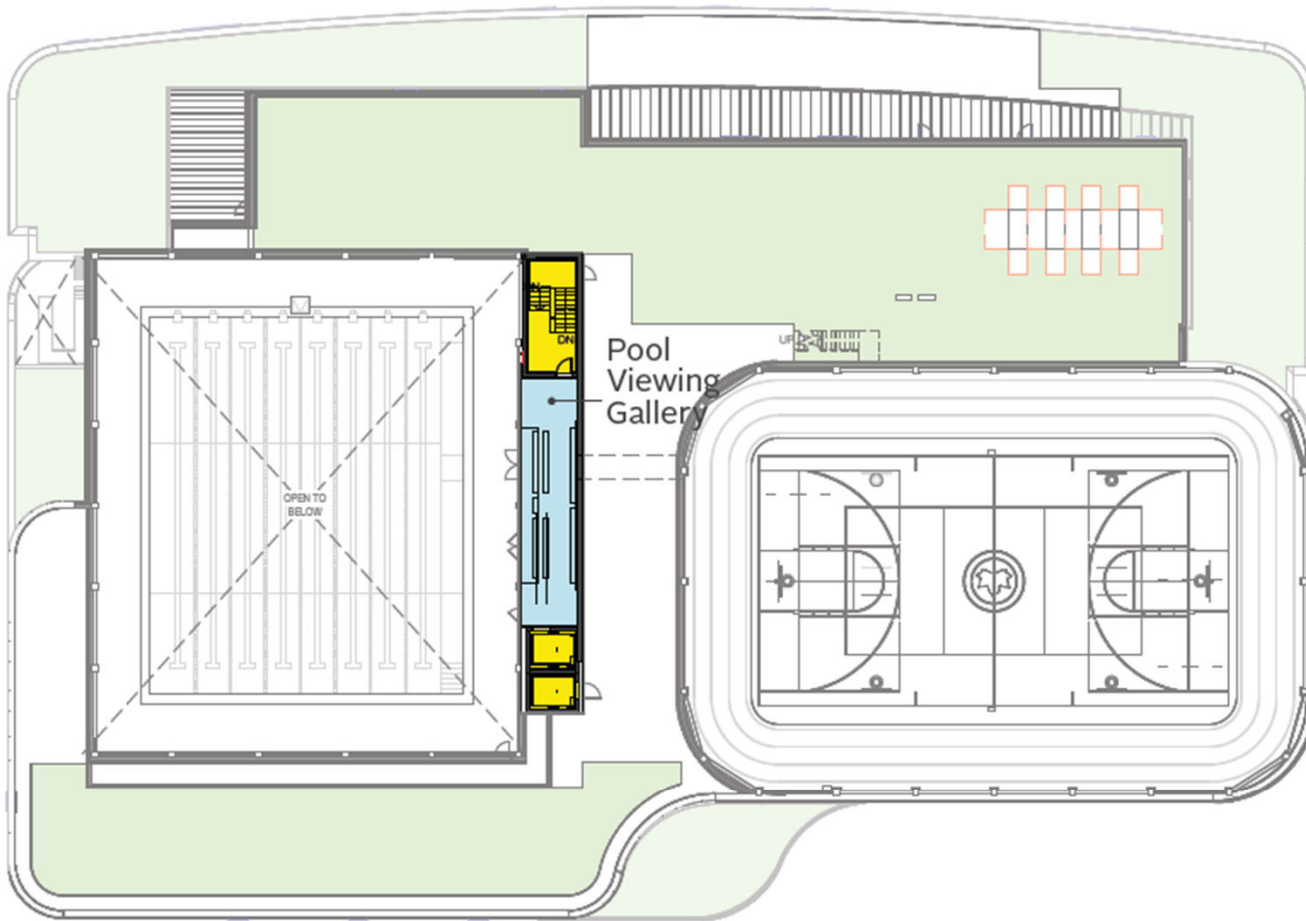

**NEW RECREATION CENTER
AT ROY WILKINS**

Mezzanine Floor Plan

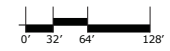

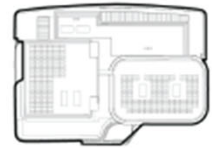

- 04 UPPER ROOF 38' - 0"
- 03 LOWER ROOF 28' - 0"
- 02M POOL GALLERY LEVEL 24' - 11"
- 02 SECOND FLOOR 14' - 0"
- 01 FIRST FLOOR 0' - 0"

West Elevation

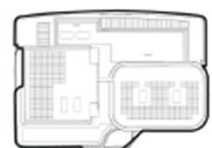

- 04 UPPER ROOF 38' - 0"
- 03 LOWER ROOF 28' - 0"
- 02M POOL GALLERY LEVEL 24' - 11"
- 02 SECOND FLOOR 14' - 0"
- 01 FIRST FLOOR 0' - 0"

South Elevation

**NEW RECREATION CENTER
AT ROY WILKINS**

Building Elevations

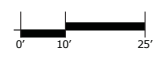



East Elevation



MERRICK BOULEVARD

North Elevation

**NEW RECREATION CENTER
AT ROY WILKINS**

Building Elevations

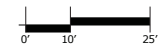

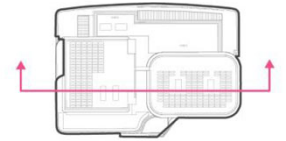

Pool

Pool Tunnel

Pool Bleachers

Entry Gallery

Track

Gymnasium

Track

North-South Section

**NEW RECREATION CENTER
AT ROY WILKINS**

Section Perspective
NO SCALE

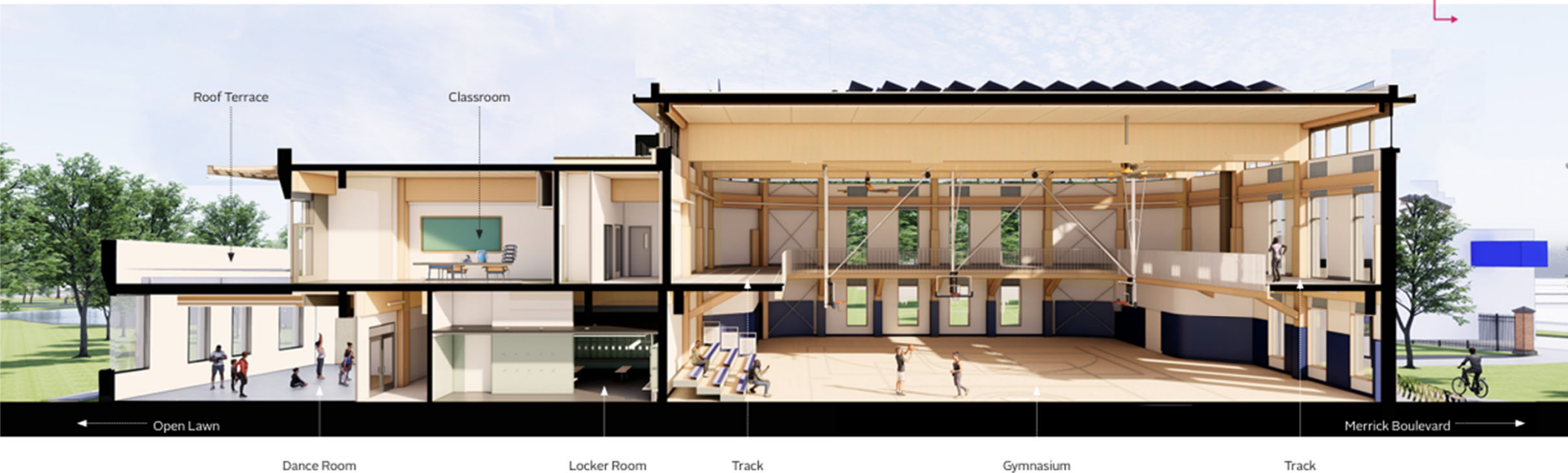
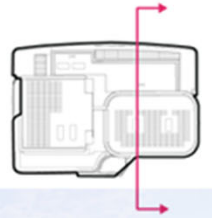

West-East Section

**NEW RECREATION CENTER
AT ROY WILKINS**

Section Perspective
NO SCALE



**NEW RECREATION CENTER
AT ROY WILKINS**

Exterior/Merrick Blvd.
NO SCALE



**NEW RECREATION CENTER
AT ROY WILKINS**

Exterior/Entrance
NO SCALE



**NEW RECREATION CENTER
AT ROY WILKINS**

Exterior/Entry Plaza
NO SCALE



**NEW RECREATION CENTER
AT ROY WILKINS**

Exterior/Park View
NO SCALE



**NEW RECREATION CENTER
AT ROY WILKINS**

Exterior/North West Facade
NO SCALE



**NEW RECREATION CENTER
AT ROY WILKINS**

Exterior/North Facade
NO SCALE



**NEW RECREATION CENTER
AT ROY WILKINS**

Interior View/Pool
NO SCALE



**NEW RECREATION CENTER
AT ROY WILKINS**

Interior Gym / Walking Track
NO SCALE

PROJECT CONTACT INFORMATION



- **Norberto Acevedo** | Director,
Communication & Policy
AcevedoNo@ddc.nyc.gov
- **Anna Killion** | Outreach Coordinator,
Communication & Policy
KillionAn@ddc.nyc.gov



Scan to explore the
Project Website

www.rwrc-info.com

**NEW RECREATION CENTER
AT ROY WILKINS**



Department of
Design and
Construction



NYC Parks

Q & A

TRITON
CONSTRUCTION

ELITE
CONSTRUCTION OF NY

**BEYER
BLINDER
BELLE**