



THE CITY RECORD

Official Journal of The City of New York

THE CITY RECORD
U.S.P.S. 0114-660

Printed on paper containing
40% post-consumer material

VOLUME CXXXVIII NUMBER 19

FRIDAY, JANUARY 28, 2011

PRICE \$4.00

TABLE OF CONTENTS	PROPERTY DISPOSITION	Health and Hospitals Corporation192	Small Business Services193
PUBLIC HEARINGS & MEETINGS	Citywide Administrative Services191	Health and Mental Hygiene192	Procurement193
Queens Borough President185	Municipal Supply Services191	Agency Chief Contracting Officer192	Transportation194
Staten Island Borough President185	Auction191	Homeless Services192	Triborough Bridge and Tunnel Authority 194
City Council185	Police191	Office of Contracts and Procurement192	AGENCY PUBLIC HEARINGS
City University185	PROCUREMENT	Human Resources Administration192	Human Resources Administration194
Community Boards185	City University191	Contracts193	SPECIAL MATERIALS
Consumer Affairs185	Citywide Administrative Services191	Juvenile Justice193	Citywide Administrative Services195
Landmarks Preservation Commission . . .186	Municipal Supply Services191	Parks and Recreation193	Comptroller196
Transportation187	Vendor Lists191	Contract Administration193	Changes in Personnel196
COURT NOTICE	Correction192	Revenue and Concessions193	LATE NOTICE
Supreme Court187	Central Office of Procurement192	School Construction Authority193	Transportation197
Richmond County187	Economic Development Corporation . . .192	Contract Administration193	READERS GUIDE200
See Court Notice Maps197-199	Contracts192		

THE CITY RECORD MICHAEL R. BLOOMBERG, Mayor

EDNA WELLS HANDY, Commissioner, Department of Citywide Administrative Services.
ELI BLACHMAN, Editor of The City Record.

Published Monday through Friday, except legal holidays by the Department of Citywide Administrative Services of the City of New York under Authority of Section 1066 of the New York City Charter.

Subscription—\$500 a year; daily, \$4.00 a copy (\$5.00 by mail) Periodicals Postage Paid at New York, N.Y.
POSTMASTER: Send address changes to THE CITY RECORD, 1 Centre Street, Room 2208, New York, N.Y. 10007 - 1602

Editorial Office
1 Centre Street, Room 2208
New York N.Y. 10007-1602
Telephone (212) 669-8252

Subscription Changes/Information
1 Centre Street, Room 2208
New York N.Y. 10007-1602
Telephone (212) 669-8252

The City of New York Home Page
provides Internet access via the **WORLD WIDE WEB** to solicitations and awards
<http://www.nyc.gov/cityrecord>

PUBLIC HEARINGS AND MEETINGS

See Also: Procurement; Agency Rules

QUEENS BOROUGH PRESIDENT

■ PUBLIC HEARINGS

Notice is hereby given that a Public Hearing will be held by the Borough President of Queens, Helen Marshall, on **Thursday, February 3, 2011** at 10:30 A.M., in the Borough Presidents Conference Room located at 120-55 Queens Boulevard, Kew Gardens, New York 11424, on the following items:

NOTE: Individuals requesting Sign Language Interpreters should contact the Borough President's Office, (718) 286-2860, TDD users should call (718) 286-2656, no later than FIVE BUSINESS DAYS PRIOR TO THE PUBLIC HEARING.

CD06 - BSA #164-60 BZ — IN THE MATTER of an application submitted by Carl A. Sulfaro, Esq. on behalf of Steven Scott, Inc., pursuant to Section 11-411 of the NYC Zoning Resolution, to extend the term of a previously granted variance for an additional period of ten years beyond April 10, 2009 for an existing gasoline service station with accessory uses and to waive the rules of procedure in a C1-3/R3-2 district located at **100-20 Metropolitan Avenue**, Block 3895, Lot 32, Zoning Map 14b, Forest Hills, Borough of Queens.

CD11 - BSA #259-08 BZ — IN THE MATTER of an application submitted by Jeffrey A. Chester/Einbinder & Dunn on behalf of AAC Douglaston Plaza LLC, pursuant to Section 11-413 of the NYC Zoning Resolution, to reopen and amend an existing variance allowing the expansion of a non-conforming Use Group 6 supermarket use removing the C1 zoning district parameters on signs and replacing it with C4 zoning regulations in an R4 district located at **242-02 61st Avenue**, Block 8286, Lot 185, Zoning Map 11b, Douglaston, Borough of Queens.

CD11 - BSA #201-08 BZ — IN THE MATTER of an application submitted by Rothkrug, Rothkrug & Spector LLP on behalf of For Our Children, Inc., pursuant to Section 72-21 of the NYC Zoning Resolution, to permit the development a one story office building (U.G. 6) in an R3X district located at **40-38 216th Street**, Block 6290, Lot 70, Zoning Map 11a, Bayside, Borough of Queens.

CD07 - BSA #192-10 BZ — IN THE MATTER of an application submitted by Vincent L. Petraro, PLLC on behalf of Jia Ye Realty, LLC, pursuant to Section 73-66 of the NYC Zoning Resolution, for a waiver of the height restriction within the Flight Obstruction Area to facilitate the construction of a 12-story hotel building in a C4-3 district located at **36-27 Prince Street**, Block 4971, Lot 8, Zoning Map 10a, Flushing, Borough of Queens.

CD07 - BSA #193-10 BZ — IN THE MATTER of an application submitted by Vincent L. Petraro, PLLC on behalf of The Leavitt Street, LLC, pursuant to Section 73-66 of the

NYC Zoning Resolution, for a waiver of the height restriction within the Flight Obstruction Area to facilitate the construction of a 12-story hotel building in a C4-3 district located at **36-16 Prince Street**, Block 4962, Lot 4, Zoning Map 10a, Flushing, Borough of Queens.

☛ j28-f3

STATEN ISLAND BOROUGH PRESIDENT

■ PUBLIC MEETING

Notice of Public Meeting, Wednesday, February 2, 2011, Staten Island Borough Board, Conference Room 122 at 5:30 P.M., Staten Island Borough Hall, Stuyvesant Place, Staten Island, New York 10301.

j27-f2

CITY COUNCIL

■ HEARINGS

HEARING BY THE COMMITTEE ON RULES, PRIVILEGES AND ELECTIONS

THE COMMITTEE ON RULES, PRIVILEGES AND ELECTIONS WILL HOLD A HEARING ON WEDNESDAY, FEBRUARY 2, AT 10:30 A.M. IN THE 16TH FLOOR COMMITTEE ROOM AT 250 BROADWAY, NEW YORK, NY 10007 ON THE FOLLOWING MATTERS:

Designation

- **Pre-considered-M, Diane Lacey**, Council candidate for re-designation and subsequent re-appointment by the Mayor to the **New York City Health and Hospitals Corporation** Board of Directors to serve for the remainder of a five-year term that will expire on March 20, 2014.
- **Pre-considered-M, Josephine Bolus**, Council candidate for re-designation and subsequent re-appointment by the Mayor to the **New York City Health and Hospitals Corporation** Board of Directors to serve for the remainder of a five-year term that will expire on March 20, 2013.
- **Pre-considered-M, Robert F. Nolan**, Council candidate for designation and subsequent appointment by the Mayor to the **New York City Health and Hospitals Corporation** Board of Directors to serve for the remainder of a five-year term that will expire on March 20, 2012.

AND SUCH OTHER BUSINESS AS MAY BE NECESSARY

A Calendar of speakers will be established in advance. Persons interested in being heard should write to the Honorable Christine C. Quinn, Speaker of the City Council, City Hall, New York, New York 10007, setting forth their name, representation and viewpoints.

Michael M. McSweeney
City Clerk, Clerk of the Council

j26-f2

CITY UNIVERSITY

■ PUBLIC HEARINGS

BOARD OF TRUSTEES

The Annual Brooklyn Borough Hearing will take place on Tuesday, February 8, 2011, 5:00 P.M. at Brooklyn Borough Hall, The Courtroom, 209 Joralemon Street, Brooklyn, New York 11201.

☛ j28

COMMUNITY BOARDS

■ PUBLIC HEARINGS

PUBLIC NOTICE IS HEREBY GIVEN THAT the following matters have been scheduled for public hearing by Community Boards:

BOROUGH OF STATEN ISLAND

COMMUNITY BOARD NO. 02 - Tuesday, February 1, 2011, 7:30 P.M., 460 Brielle Avenue (Lou Caravone Bldg.), Staten Island, NY

BSA# 289-99-BZ

Premises: 265 Hull Avenue
Special Order Calendar (SOC) application to request an extension of term of variance for a parking lot in an R3-1 zoning district, accessory to a permitted commercial use building in a commercial zoning district. Application was previously granted by the Board of Standards and Appeals on December 12, 2000.

j26-f1

CONSUMER AFFAIRS

■ PUBLIC HEARINGS

NOTICE IS HEREBY GIVEN, PURSUANT TO LAW, that the New York City Department of Consumer Affairs will hold a Public Hearing on Wednesday, February 2, 2011, at 2:00 P.M., at 66 John Street, 11th floor, in the Borough of Manhattan, on the following petitions for sidewalk café revocable consent:

- 1) 135 Studio N ADR, Inc.
135 North 5th Street, in the Borough of Brooklyn (To continue to, maintain, and operate an unenclosed sidewalk café for a term of two years.)
- 2) 14th Street Bella Pizza Corp.
400 East 14th Street, in the Borough of Manhattan (To continue to, maintain, and operate an unenclosed sidewalk café for a term of two years.)
- 3) 174 Grand Street Corp.
174 Grand Street, in the Borough of Manhattan (To continue to, maintain, and operate an unenclosed sidewalk café for a term of two years.)
- 4) 201 Rest. 95th St. Corp.
201 West 95th Street, in the Borough of Manhattan (To continue to, maintain, and operate an unenclosed sidewalk café for a term of two years.)
- 5) 3 In 1 Kitchen Corp.
4092 Fort Hamilton Parkway, in the Borough of Brooklyn (To construct, maintain, and operate an enclosed sidewalk café for a term of two years.)
- 6) 316 Bowery, LLC
316 Bowery, in the Borough of Manhattan (To continue to, maintain, and operate an unenclosed sidewalk café for a term of two years.)
- 7) 352 East 86th Street Restaurant Inc.
352 East 86th Street, in the Borough of Manhattan (To continue to, maintain, and operate an enclosed sidewalk café for a term of two years.)
- 8) 394 City Island Ave., Inc.
394 City Island Avenue, in the Borough of Bronx (To continue to, maintain, and operate an unenclosed sidewalk café for a term of two years.)

- 9) 425 Amsterdam Café Inc.
425 Amsterdam Avenue, in the Borough of Manhattan
(To continue to, maintain, and operate an unenclosed sidewalk café for a term of two years.)
- 10) 520 Columbus Ave. LTD
520 Columbus Avenue, in the Borough of Manhattan
(To continue to, maintain, and operate an unenclosed sidewalk café for a term of two years.)
- 11) 600 West 169th Rest. Inc.
4015 Broadway, in the Borough of Manhattan
(To continue to, maintain, and operate an unenclosed sidewalk café for a term of two years.)
- 12) Applejack Coffee Shop, Inc.
230 West 55th Street, in the Borough of Manhattan
(To continue to, maintain, and operate an unenclosed sidewalk café for a term of two years.)
- 13) BSWR Corp.
423 Amsterdam Avenue, in the Borough of Manhattan
(To continue to, maintain, and operate an unenclosed sidewalk café for a term of two years.)
- 14) Belstar Ice Cream Co. LLC
34-20 Broadway, in the Borough of Queens
(To continue to, maintain, and operate an unenclosed sidewalk café for a term of two years.)
- 15) Burke's Beal Bocht Corp.
445 West 238th Street, in the Borough of Bronx
(To continue to, maintain, and operate an unenclosed sidewalk café for a term of two years.)
- 16) Cien Fuegos LLC
95 Avenue A, in the Borough of Manhattan
(To establish, maintain, and operate an unenclosed sidewalk café for a term of two years.)
- 17) East Side DD 101 LLC
601 Second Avenue, in the Borough of Manhattan
(To establish, maintain, and operate an unenclosed sidewalk café for a term of two years.)
- 18) Emilio's Italian Eatery, Inc.
413 Amsterdam Avenue, in the Borough of Manhattan
(To continue to, maintain, and operate an unenclosed sidewalk café for a term of two years.)
- 19) Facosull Corp.
165 West 4th Street, in the Borough of Manhattan
(To continue to, maintain, and operate an unenclosed sidewalk café for a term of two years.)
- 20) First Avenue Brother Jimmy's, LLC
1485 Second Avenue, in the Borough of Manhattan
(To continue to, maintain, and operate an enclosed sidewalk café for a term of two years.)
- 21) Fushia 58 Inc.
1065 First Avenue, in the Borough of Manhattan
(To establish, maintain, and operate an unenclosed sidewalk café for a term of two years.)
- 22) Genino Inc.
1302 Madison Avenue, in the Borough of Manhattan
(To continue to, maintain, and operate an unenclosed sidewalk café for a term of two years.)
- 23) Greenwich Hotel Restaurant LLC
377 Greenwich Street, in the Borough of Manhattan
(To continue to, maintain, and operate an unenclosed sidewalk café for a term of two years.)
- 24) Gyro King Foods Corp.
50 East Fordham Road, in the Borough of Bronx
(To continue to, maintain, and operate an unenclosed sidewalk café for a term of two years.)
- 25) Iridium Restaurant Corp.
20 Spring Street, in the Borough of Manhattan
(To continue to, maintain, and operate an unenclosed sidewalk café for a term of two years.)
- 26) Jec II, LLC
1-3 Little West 12th Street, in the Borough of Manhattan
(To continue to, maintain, and operate an unenclosed sidewalk café for a term of two years.)
- 27) K & L Court Food, Inc.
223 Smith Street, in the Borough of Brooklyn
(To continue to, maintain, and operate an unenclosed sidewalk café for a term of two years.)
- 28) King Luke Inc.
81 Broadway, in the Borough of Brooklyn
(To establish, maintain, and operate an unenclosed sidewalk café for a term of two years.)
- 29) Little Siam Corp.
658 Ninth Avenue, in the Borough of Manhattan
(To continue to, maintain, and operate an unenclosed sidewalk café for a term of two years.)
- 30) M.B.R.P. REST. INC.
1454 Second Avenue, in the Borough of Manhattan
(To continue to, maintain, and operate an unenclosed sidewalk café for a term of two years.)
- 31) Mo & Yeo Corp.
9324 Third Avenue, in the Borough of Brooklyn
(To continue to, maintain, and operate an unenclosed sidewalk café for a term of two years.)
- 32) Mulberry Street Bar LLC
172 1/2 Mulberry Street, in the Borough of Manhattan
(To continue to, maintain, and operate an unenclosed sidewalk café for a term of two years.)
- 33) Nectar Restaurant Corp.
1090 Madison Avenue, in the Borough of Manhattan
(To continue to, maintain, and operate an enclosed sidewalk café for a term of two years.)

- 34) PQ Upper West, Inc.
2463 Broadway, in the Borough of Manhattan
(To continue to, maintain, and operate an unenclosed sidewalk café for a term of two years.)
- 35) PQ West 84th, Inc.
494 Amsterdam Avenue, in the Borough of Manhattan
(To continue to, maintain, and operate an unenclosed sidewalk café for a term of two years.)
- 36) Pan Asian Bistro Les, Inc.
172 Orchard Street, in the Borough of Manhattan
(To continue to, maintain, and operate an unenclosed sidewalk café for a term of two years.)
- 37) Pearlstone Burger Corporation
77 Pearl Street, in the Borough of Manhattan
(To continue to, maintain, and operate an unenclosed sidewalk café for a term of two years.)
- 38) Peckslip Restaurant Corp.
22 Peck Slip, in the Borough of Manhattan
(To continue to, maintain, and operate an unenclosed sidewalk café for a term of two years.)
- 39) Phillipos Restaurant Inc.
1678 Third Avenue, in the Borough of Manhattan
(To continue to, maintain, and operate an unenclosed sidewalk café for a term of two years.)
- 40) Pollos Mario Woodhaven Corp.
63-20 Woodhaven Boulevard, in the Borough of Queens
(To continue to, maintain, and operate an enclosed sidewalk café for a term of two years.)
- 41) Progetto, Inc.
352 West 44th Street, in the Borough of Manhattan
(To continue to, maintain, and operate an unenclosed sidewalk café for a term of two years.)
- 42) Roll-N-Roaster Corp.
2901 Emmons Avenue, in the Borough of Brooklyn
(To continue to, maintain, and operate an enclosed sidewalk café for a term of two years.)
- 43) Sengupta Food Services LLC
62 Prince Street, in the Borough of Manhattan
(To continue to, maintain, and operate an unenclosed sidewalk café for a term of two years.)
- 44) Settebello, LLC
647 East 11th Street, in the Borough of Manhattan
(To continue to, maintain, and operate an unenclosed sidewalk café for a term of two years.)
- 45) Shannon Café LLC
951 Second Avenue, in the Borough of Manhattan
(To continue to, maintain, and operate an unenclosed sidewalk café for a term of two years.)
- 46) So-Taun Enterprises, LLC
21-37 31st Street, in the Borough of Queens
(To continue to, maintain, and operate an unenclosed sidewalk café for a term of two years.)
- 47) Sol Y Sombre LTD
462 Amsterdam Avenue, in the Borough of Manhattan
(To continue to, maintain, and operate an unenclosed sidewalk café for a term of two years.)
- 48) St. James Associates, L.P.
201 E. 49th Street, in the Borough of Manhattan
(To continue to, maintain, and operate an unenclosed sidewalk café for a term of two years.)
- 49) Steven Jay, LLC
1600 Third Avenue, in the Borough of Manhattan
(To continue to, maintain, and operate an unenclosed sidewalk café for a term of two years.)
- 50) Sunflower Restaurant Associates, Inc.
361 Greenwich Street, in the Borough of Manhattan
(To continue to, maintain, and operate an unenclosed sidewalk café for a term of two years.)
- 51) Surtic, Inc.
320 Amsterdam Avenue, in the Borough of Manhattan
(To continue to, maintain, and operate an unenclosed sidewalk café for a term of two years.)
- 52) T.C. of O., LLC
290 Metropolitan Avenue, in the Borough of Brooklyn
(To establish, maintain, and operate an unenclosed sidewalk café for a term of two years.)
- 53) Taro Rest, Inc.
1396 Third Avenue, in the Borough of Manhattan
(To continue to, maintain, and operate an unenclosed sidewalk café for a term of two years.)
- 54) Terra Mia Enterprises, Inc.
190 Seventh Avenue, in the Borough of Manhattan
(To establish, maintain, and operate an unenclosed sidewalk café for a term of two years.)
- 55) The Attic Corporation of Douglaston
33-02 34th Avenue, in the Borough of Queens
(To continue to, maintain, and operate an unenclosed sidewalk café for a term of two years.)
- 56) Union Square Facility Inc.
29 Union Square West, in the Borough of Manhattan
(To continue to, maintain, and operate an unenclosed sidewalk café for a term of two years.)
- 57) Upper West Rest. Corp.
476 Amsterdam Avenue, in the Borough of Manhattan
(To continue to, maintain, and operate an unenclosed sidewalk café for a term of two years.)
- 58) Zonor Rest. Corp.
225 West 4th Street, in the Borough of Manhattan
(To continue to, maintain, and operate an enclosed sidewalk café for a term of two years.)

Individuals requesting Sign Language Interpreters should contact the Department of Consumer Affairs, Licensing division, 42 Broadway, 5th Floor, New York, NY 10004, (212) 487-4379, no later than five (5) business days before the hearing.

☛ j28

LANDMARKS PRESERVATION COMMISSION

■ PUBLIC HEARINGS

NOTICE IS HEREBY GIVEN THAT PURSUANT to the provisions of 3020 of the New York City Charter and Chapter 3 of Title 24 of the Administrative Code of the City of New York (Sections 25-303 and 25-313) that on **Tuesday, February 1, 2011 at 9:30 A.M.**, at the Landmarks Preservation Commission will conduct a *public hearing* in the Public Meeting Room of the Landmarks Preservation Commission, located at The Municipal Building, 1 Centre Street, 9th Floor North, City of New York with respect to the following proposed Landmark and Landmark Site. Any person requiring reasonable accommodation in order to participate in the hearing should call or write the Landmarks Preservation Commission, [Municipal Building, 1 Centre Street, 9th Floor North, New York, NY 10007, (212) 669-7700] no later than five (5) business days before the hearing. There will also be a public meeting on that day.

ITEM TO BE HEARD BOROUGH OF MANHATTAN

LP-2467
MANUFACTURERS TRUST COMPANY BUILDING, FIRST AND SECOND FLOOR INTERIORS, 510 Fifth Avenue, (aka 508-514 Fifth Avenue; 2 West 43rd Street), Borough of Manhattan, consisting of the entrance vestibule and lobby at the Fifth Avenue corner, the banking room, the 43rd Street entrance lobby, the corridor in front of the bank vault, and the escalators leading from the first floor to the second floor; second floor interior consisting of the banking room; and the fixtures and interior components of these spaces, including but not limited to, wall surfaces; ceiling surfaces; floor surfaces; columns; teller counters; planters, Mosler safe door; and sculptured metal screen; 508-514 Fifth Avenue, Manhattan.

Landmark Site: Borough of Manhattan Tax Map Block 1258, Lot 40

j18-31

NOTICE IS HEREBY GIVEN that pursuant to the provisions of Title 25, chapter 3 of the Administrative Code of the City of New York (Sections 25-307, 25-308, 25-309, 25-313, 25-318, 25-320) (formerly Chapter 8-A, Sections 207-6.0, 207-7.0, 207-12.0, 207-17.0, and 207-19.0), on Tuesday, **February 1, 2011 at 9:30 A.M.** in the morning of that day, a public hearing will be held in the Conference Room at 1 Centre Street, 9th Floor, Borough of Manhattan with respect to the following properties and then followed by a public meeting. Any person requiring reasonable accommodation in order to participate in the hearing or attend the meeting should call or write the Landmarks Commission no later than five (5) business days before the hearing or meeting.

CERTIFICATE OF APPROPRIATENESS
BOROUGH OF MANHATTAN 11-4330 - Block 178, lot 19-227 West Broadway - Tribeca East Historic District
Two dwellings originally built circa 1810, subsequently combined, and highly altered in the twentieth century. Application is to alter the ground floor, and install an awning. Community District 1.

BINDING REPORT
BOROUGH OF MANHATTAN 11-5566 - Block 134, lot 7501-253-256 Broadway - (former) Home Life Insurance Company Building-Individual Landmark
A neo-Renaissance style office Building designed by George Edward Harding & Gooch in 1892-94, and altered in 1936 by Ely Jacques Kahn and in 1963-69 by Sapolsky & Slobodie. Application is to modify window openings and install windows. Community District 1.

CERTIFICATE OF APPROPRIATENESS
BOROUGH OF MANHATTAN 09-2330 - Block 552, lot 63-69 Washington Place - Greenwich Village Historic District
A Greek revival style house built in 1842. Application is to construct a rear yard addition and replace a window. Zoned R7-2. Community District 2.

CERTIFICATE OF APPROPRIATENESS
BOROUGH OF MANHATTAN 11-5240 - Block 615, lot 73-8 Jane Street - Greenwich Village Historic District
A Greek Revival style rowhouse built in 1843. Application is to excavate the cellar and construct a rooftop addition. Zoned R6/C1-6. Community District 2.

CERTIFICATE OF APPROPRIATENESS
BOROUGH OF MANHATTAN 07-7200 - Block 624, lot 56-57 Bank Street - Greenwich Village Historic District
A Greek Revival style rowhouse built in 1842. Application is to legalize the replacement of ironwork at the areaway and stoop without Landmarks Preservation Commission permits. Community District 2.

CERTIFICATE OF APPROPRIATENESS
BOROUGH OF MANHATTAN 11-5079 - Block 553, lot 6-388 6th Avenue - Greenwich Village Historic District
A Modern style bank building built in 1941 and altered in 1955 and 1969. Application is to install illuminated signage. Community District 2.

CERTIFICATE OF APPROPRIATENESS
BOROUGH OF MANHATTAN 11-5524 - Block 574, lot 1-442 6th Avenue, aka 71 West 10th Street - Greenwich Village Historic District
A house built in 1834-35. Application is to alter the ground floor and install rooftop mechanical equipment, storefront infill and signage. Community District 2.

CERTIFICATE OF APPROPRIATENESS

BOROUGH OF MANHATTAN 11-5054 - Block 515, lot 25-155 Wooster Street - SoHo-Cast Iron Historic District
A Classical Revival style store and loft building designed by George F. Pelham and built in 1897-1898. Application is to establish a Master Plan governing the future installation of painted wall signs. Zoned M1-5A. Community District 2.

CERTIFICATE OF APPROPRIATENESS

BOROUGH OF MANHATTAN 11-4284 - Block 823, lot 76-62 West 22nd Street - Ladies' Mile Historic District
A converted dwelling, built in 1849. Application is to install storefront infill and signage. Community District 5.

CERTIFICATE OF APPROPRIATENESS

BOROUGH OF MANHATTAN 09-8008 - Block 1168, lot 56-250 West 77th Street - Hotel Belleclaire - Individual Landmark

An Art Nouveau/Secessionist style hotel designed by Emery Roth and built in 1901-03. Application is to install an entrance marquee. Community District 7.

CERTIFICATE OF APPROPRIATENESS

BOROUGH OF MANHATTAN 11-4892 - Block 1211, lot 63-180 West 81st Street - Upper West Side/Central Park West Historic District

A Renaissance/Romanesque Revival style apartment building built in 1889-90 designed by A.B. Ogden & Son. Application is to legalize painting limestone without Landmarks Preservation Commission permits. Community District 7.

CERTIFICATE OF APPROPRIATENESS

BOROUGH OF MANHATTAN 11-5447 - Block 1128, lot 1-329 Columbus Avenue - Upper West Side/Central Park West Historic District

A Renaissance Revival style apartment building designed by Lamb & Rich built in 1895-98. Application is to install signage. Community District 7.

CERTIFICATE OF APPROPRIATENESS

BOROUGH OF MANHATTAN 11-4240 - Block 1185, lot 25-333 West End Avenue - West End-Collegiate Historic District
A neo-Venetian Gothic style apartment building designed by Emery Roth and built in 1925. Application is to legalize the installation of AC condensers without Landmarks Preservation Commission permits. Community District 7.

CERTIFICATE OF APPROPRIATENESS

BOROUGH OF MANHATTAN 11-1047 - Block 1416, lot 8-215 East 61st Street - Treadwall Farm Historic District
A rowhouse designed by A. & S. Bussell and built in 1875 and later altered. Application is to construct a rear yard addition, replace windows and alter the facade. Zoned R8B. Community District 8.

CERTIFICATE OF APPROPRIATENESS

BOROUGH OF MANHATTAN 10-8688 - Block 1388, lot 7501-923 Fifth Avenue - Upper East Side Historic District
An apartment building designed by Sylvan Bien and built in 1949-51. Application is to alter window openings and construct terrace trellises. Community District 8.

BINDING REPORT

BOROUGH OF MANHATTAN 11-5145 - Block 1609, lot 1-1220 Fifth Avenue - Museum of the City of New York - Individual Landmark

A late Georgian style museum building designed by Joseph H. Freedlander and built in 1928-30. Application is to install signage in the courtyard. Community District 11.

CERTIFICATE OF APPROPRIATENESS

BOROUGH OF BROOKLYN 11-2279 - Block 1965, lot 9-51 Cambridge Place - Clinton Hill Historic District
An Italianate style rowhouse built c.1856. Application is to excavate a portion of the rear yard. Zoned R-6. Community District 2.

CERTIFICATE OF APPROPRIATENESS

BOROUGH OF BROOKLYN 11-0403 - Block 1062, lot 8-29 8th Avenue - Park Slope Historic District
A Romanesque Revival style rowhouse designed by Charles Werner and built in 1888. Application is to legalize a roof deck constructed in non-compliance with Certificate of No Effect 10-1268. Community District 6.

CERTIFICATE OF APPROPRIATENESS

BOROUGH OF BROOKLYN 11-5094 - Block 1103, lot 12-446 14th Street - Park Slope Historic District
A late Romanesque Revival style rowhouse built in 1894-95. Application is to legalize painting the facade and the installation of a lamppost without Landmarks Preservation Commission permits. Community District 6.

j19-fl

TRANSPORTATION

PUBLIC HEARINGS

NOTICE IS HEREBY GIVEN, pursuant to law, that the following proposed revocable consents, have been scheduled for a public hearing by the New York City Department of Transportation. The hearing will be held at 55 Water Street, 7th Floor, Room 707 commencing at 2:00 P.M. on Wednesday, February 2, 2011. Interested parties can obtain copies of proposed agreements or request sign-language interpreters (with at least seven days prior notice) at 55 Water Street, 9th Floor SW, New York, NY 10041, or by calling (212) 839-6550.

#1 In the matter of a proposed revocable consent authorizing Ben Hansen and Christina Hansen to construct, maintain and use a stoop, stair and planted area on the south sidewalk of State Street, between Bond and Nevins Streets, in the Borough of Brooklyn. The proposed revocable consent is for a term of ten years from the date of approval by the Mayor to June 30, 2021 and provides among other terms and conditions for compensation payable to the city according to the following schedule:

From the date Approval by the Mayor to June 30, 2011 - \$543/annum

For the period July 1, 2011 to June 30, 2012 - \$560
For the period July 1, 2012 to June 30, 2013 - \$577
For the period July 1, 2013 to June 30, 2014 - \$594
For the period July 1, 2014 to June 30, 2015 - \$611
For the period July 1, 2015 to June 30, 2016 - \$628
For the period July 1, 2016 to June 30, 2017 - \$645
For the period July 1, 2017 to June 30, 2018 - \$662
For the period July 1, 2018 to June 30, 2019 - \$679
For the period July 1, 2019 to June 30, 2020 - \$696
For the period July 1, 2010 to June 30, 2011 - \$713

The maintenance of a security deposit in the sum of \$5,000 and the filing of an insurance policy in the minimum amount of \$250,000/\$1,000,000 for bodily injury and property damage for each occurrence in the aggregate amount of \$100,000.

#2 In the matter of a proposed revocable consent authorizing Joseph LoMaglio to continue to maintain and use a fenced-in area on the north sidewalk of Charles Street, west of Seventh Avenue South, in the Borough of Manhattan. The proposed revocable consent is for a term of ten years from the date of approval by the Mayor to June 30, 2021 and provides among other terms and condition for compensation payable to the city according to the following schedule:

For the period from July 1, 2011 to June 30, 2021 - \$25/ annum.

The maintenance of a security deposit in the sum of \$250 and the filing of filing of an insurance policy in the minimum amount of \$250,000/\$1,000,000 for bodily injury and property damage for each occurrence in the aggregate amount of \$100,000.

#3 In the matter of a proposed revocable consent authorizing Century 21 Department Stores, LLC, to continue to maintain and use two conduits under and across 87th Street, east of Forth Avenue, in the Borough of Brooklyn. The proposed revocable consent is for a term of ten years from July 1, 2011 to June 30, 2021 and provides among other terms and conditions for compensation payable to the following schedule:

For the period July 1, 2011 to June 30, 2012 - \$4,765
For the period July 1, 2012 to June 30, 2013 - \$4,897
For the period July 1, 2013 to June 30, 2014 - \$5,038
For the period July 1, 2014 to June 30, 2015 - \$5,179
For the period July 1, 2015 to June 30, 2016 - \$5,320
For the period July 1, 2016 to June 30, 2017 - \$5,461
For the period July 1, 2017 to June 30, 2018 - \$5,602
For the period July 1, 2018 to June 30, 2019 - \$5,743
For the period July 1, 2019 to June 30, 2020 - \$5,884
For the period July 1, 2020 to June 30, 2021 - \$6,025

the maintenance of a security deposit in the sum of \$6,000 and the filing of an insurance policy in the minimum amount of \$250,000/\$1,000,000 for bodily injury and property damage for each occurrence in the aggregate amount of \$100,000.

#4 In the matter of a proposed revocable consent authorizing Bolivar Apartment Corp. to continue to maintain and use planted areas on the west sidewalk of Central Park West, north of West 83rd Street, and on the north sidewalk of West 83rd Street, west of Central Park West, in the Borough of Manhattan. The proposed revocable consent is for a term of ten years from July 1, 2011 to June 30, 2021 and provides among other terms and condition for compensation payable to the city according to the following schedule:

For the period from July 1, 2011 to June 30, 2021 - \$775/annum.

the maintenance of a security deposit in the sum of \$4,000 and the filing of an insurance policy in the minimum amount of \$250,000/\$1,000,000 for bodily injury and property damage for each occurrence in the aggregate amount of \$100,000.

#5 In the matter of a proposed revocable consent authorizing Consolidated Edison Company of New York, Inc. to maintain and use security fences, barriers, bollards and a guard booth at East River Generating Station, located between Avenue C and FDR Drive and East 13th and East 15th Streets, in the Borough of Manhattan. The proposed revocable consent is for a term of ten years from the date of approval by the Mayor to June 30, 2021.

There shall be no compensation required for this revocable consent

the maintenance of a security deposit in the sum of \$20,000 and the filing of an insurance policy in the minimum amount of \$250,000/\$1,000,000 for bodily injury and property damage for each occurrence in the aggregate amount of \$100,000.

j12-f2

COURT NOTICE

SUPREME COURT

NOTICE

RICHMOND COUNTY
A PART 74
NOTICE OF PETITION
INDEX NUMBER (CY) 4002/11

In the Matter of the Application of the CITY OF NEW YORK, relative to acquire title in fee simple to all or parts of,

ALBEE AVENUE

from Amboy Road to approximately 155 feet north of Amboy Road,

AMBOY ROAD

from Alvine Avenue to approximately 20 feet east of Poillon Avenue,

ANNADALE ROAD

from Amboy Road to Approximately 104 feet northeast of Furman Street,

COMMUNITY LANE

from Amboy Road to approximately 10 feet south of Amboy Road,

FURMAN STREET

from Annadale Road to approximately 18 feet southeast of Annadale Road,

PHILIP AVENUE

from Amboy Road to approximately 10 feet south of Amboy Road,

POILLON AVENUE

from Annadale Road to approximately 97 feet southeast of Annadale Road,

POILLON AVENUE

from Amboy Road to approximately 8 feet south of Amboy Road,

in the Borough of Staten Island, City of State of New York

PLEASE TAKE NOTICE that the Corporation Counsel of the City of New York intends to make application to the Supreme Court of the State of New York, Richmond County, IA Part 74, for certain relief.

The application will be made at the following time and place: At 360 Adams Street, 5th Floor, Room 538 in the Borough of Brooklyn, City and State of New York, on February 24, 2011 at 2:30 P.M., or as soon thereafter as counsel can be heard.

The application is for an order:

- 1) authorizing the City to file an acquisition map in the Office of the Clerk of Richmond County;
- 2) directing that upon the filing of said map, title to the property sought to be acquired shall vest in the City;
- 3) providing that just compensation therefor be ascertained and determined by the Supreme Court without a jury; and
- 4) providing that notices of claim must be served and filed within one calendar year from the vesting date.

The City of New York, in this proceeding, intends to acquire title in fee simple to all or parts of certain real property, where not heretofore acquired for the reconstruction of roadways, including the installation of traffic lights, sidewalks, and pedestrian ramps, in the Borough of Staten Island, City and State of New York.

The description of the real property to be acquired is as follows:

In the matter of describing the metes and bounds of certain parcels of land located in the bed of Amboy Road (80 feet wide) between Alvine Avenue (80 feet wide) and Pillon Avenue (80 feet wide) and Annadale Road (80 feet wide) between Amboy Road (80 feet wide) and Pine Terrace (80 feet wide), in which all streets mentioned are as laid out on the "City Map" of the City of New York, Borough of Staten Island, follows:

DAMAGE PARCEL 1

PART OF LOT 111 IN BLOCK 6511

Beginning at the northeastern corner of Lot 111, Block 6511;

1. Running thence southeasterly, for 5.05 feet to an angle point;
2. Thence continuing southwesterly, forming an interior angle of 82 degrees 11 minutes 42 seconds with the last mentioned course, for 112.22 feet to an angle point;
3. Thence continuing northerly, forming an interior angle of 90 degrees 31 minutes 13 seconds with the last mentioned course, for 5.00 feet to an angle point;
4. Thence continuing northeasterly, forming an interior angle of 89 degrees 28 minutes 47 seconds with the last mentioned course, for 111.58 feet to the point of place of beginning.

This damage parcel consists of a portion of tax lot 111 in Staten Island tax block 6511 as shown on the "tax map" of the City of New York, Borough of Staten Island, as said "tax map" existed on December 7, 2008, and comprises an area of 559.5 square feet or 0.0128 acres.

DAMAGE PARCEL 2

PART OF LOT 30 IN BLOCK 6469

Beginning at the northwestern corner of Lot 30, Block 6469;

1. Running thence southeasterly, for 132.42 feet to an angle point;
2. Thence continuing southerly, forming an interior angle of 108 degrees 18 minutes 54 seconds with the last mentioned course, for 7.92 feet to an angle point;
3. Thence continuing northwesterly, forming an interior angle of 71 degrees 16 minutes 02 seconds with the last mentioned course, for 53.34 feet to a point of curvature;
4. Thence continuing westerly, on the arc of a circle, curving to the left, the radius of which is 300.00 feet, for 67.02 feet to a point.

5. Thence continuing northwesterly, forming an interior angle of 124 degrees 30 minutes 31 seconds with the tangent of the last mentioned course, for 20.63 feet to the point or place of beginning.

This damage parcel consists of a portion of tax lot 30 in Staten Island tax block 6469 as shown on the "tax map" of the City of New York, Borough of Staten Island, as said "tax map" existed on December 7, 2008, and comprises an area of 1,109.6 square feet or 0.0255 acres.

DAMAGE PARCEL 3
PART OF LOT 37 IN BLOCK 6469

Beginning at the northwestern corner of Lot 37, Block 6469;

- Running thence southeasterly, for 29.50 feet to an angle point;
- Thence continuing southerly, forming an interior angle of 127 degrees 45 minutes 13 seconds with the last mentioned course, for 10.71 feet to an angle point;
- Thence continuing northwesterly, forming an interior angle of 50 degrees 36 minutes 56 seconds with the last mentioned course, for 33.58 feet to an angle point;
- Thence continuing northerly, forming an interior angle of 109 degrees 56 minutes 46 seconds with the last mentioned course, for 7.92 feet to the point or place of beginning.

This damage parcel consists of a portion of tax lot 37 in Staten Island tax block 6469 as shown on the "tax map" of the City of New York, Borough of Staten Island, as said "tax map" existed on December 7, 2008, and comprises an area of 249.8 square feet or 0.0057 acres.

DAMAGE PARCEL 4
PART OF LOT 39 IN BLOCK 6469

Beginning at the northwestern corner of Lot 39, Block 6469;

- Running thence easterly, for 43.00 feet to an angle point;
- Thence continuing southerly, forming an interior angle of 127 degrees 45 minutes 13 seconds with the last mentioned course, for 13.84 feet to an angle point;
- Thence continuing westerly, forming an interior angle of 48 degrees 27 minutes 27 seconds with the last mentioned course, for 31.69 feet to an angle point;
- Thence continuing westerly, forming an interior angle of 182 degrees 09 minutes 28 seconds with the last mentioned course, for 13.30 feet to an angle point;
- Thence continuing northerly, forming an interior angle of 129 degrees 23 minutes 05 seconds with the last mentioned course, for 10.71 feet to the point or place of beginning.

This damage parcel consists of a portion of tax lot 39 in Staten Island tax block 6469 as shown on the "tax map" of the City of New York, Borough of Staten Island, as said "tax map" existed on December 7, 2008, and comprises an area of 409.5 square feet or 0.0094 acres.

DAMAGE PARCEL 5
PART OF LOT 43 IN BLOCK 6469

Beginning at the northwestern corner of Lot 43, Block 6469;

- Running thence southeasterly, for 115.10 feet to an angle point;
- Thence continuing southerly, forming an interior angle of 127 degrees 45 minutes 15 seconds with the last mentioned course, for 24.00 feet to an angle point;
- Thence continuing northwesterly, forming an interior angle of 48 degrees 27 minutes 25 seconds with the last mentioned course, for 121.59 feet to an angle point;
- Thence continuing northerly, forming an interior angle of 131 degrees 32 minutes 33 seconds with the last mentioned course, for 13.84 feet to the point or place of beginning.

This damage parcel consists of a portion of tax lot 43 in Staten Island tax block 6469 as shown on the "tax map" of the City of New York, Borough of Staten Island, as said "tax map" existed on December 7, 2008, and comprises an area of 1,722.0 square feet or 0.0395 acres.

DAMAGE PARCEL 6
PART OF LOT 46 IN BLOCK 6469

Beginning at the northwestern corner of Lot 46, Block 6469;

- Running thence southeasterly, for 171.79 feet to an angle point;
- Thence continuing southerly, forming an interior angle of 128 degrees 32 minutes 03 seconds with the last mentioned course, for 19.01 feet to an angle point;
- Thence continuing westerly, forming an interior angle of 74 degrees 04 minutes 27 seconds with the last mentioned course, for 26.99 feet to an angle point;
- Thence continuing northerly, forming an interior angle of 105 degrees 23 minutes 34 seconds with the last mentioned course, for 12.20 feet to an angle point;
- Thence continuing westerly, forming an interior angle of 240 degrees 02 minutes 18 seconds with the last mentioned course, for 12.94 feet to an angle point;
- Thence continuing westerly, forming an interior angle of 177 degrees 45 minutes 41 seconds with the last mentioned course, for 53.71 feet to an angle point;
- Thence continuing westerly, forming an interior angle of 172 degrees 29 minutes 48 seconds with the last mentioned course, for 44.12 feet to an angle point;
- Thence continuing westerly, forming an interior angle of 179 degrees 27 minutes 03 seconds with

the last mentioned course, for 26.65 feet to an angle point;

- Thence continuing westerly, forming an interior angle of 173 degrees 00 minutes 50 seconds with the last mentioned course, for 1.42 feet to an angle point;
- Thence continuing northerly, forming an interior angle of 131 degrees 32 minutes 35 seconds with the last mentioned course, for 24.00 feet to the point or place of beginning.

This damage parcel consists of a portion of tax lot 46 in Staten Island tax block 6469 as shown on the "tax map" of the City of New York, Borough of Staten Island, as said "tax map" existed on December 7, 2008, and comprises an area of 3,553.2 square feet or 0.0816 acres.

DAMAGE PARCEL 7
PART OF LOT 1 IN BLOCK 6247

Beginning at the southeastern corner of Lot 1, Block 6247;

- Running thence westerly, for 20.37 feet to an angle point;
- Thence continuing westerly, forming an interior angle of 174 degrees 33 minutes 06 seconds with the last mentioned course, for 39.67 feet to an angle point;
- Thence continuing northwesterly, forming an interior angle of 176 degrees 45 minutes 56 seconds with the last mentioned course, for 50.25 feet to an angle point;
- Thence continuing northwesterly, forming an interior angle of 179 degrees 11 minutes 07 seconds with the last mentioned course, for 45.34 feet to an angle point;
- Thence continuing northerly, forming an interior angle of 132 degrees 00 minutes 20 seconds with the last mentioned course, for 6.16 feet to an angle point;
- Thence continuing southeasterly, forming an interior angle of 47 degrees 59 minutes 00 seconds with the last mentioned course, for 61.27 feet to an angle point;
- Thence continuing southeasterly, forming an interior angle of 176 degrees 59 minutes 38 seconds with the last mentioned course, for 53.86 feet to an angle point;
- Thence continuing easterly, forming an interior angle of 176 degrees 21 minutes 06 seconds with the last mentioned course, for 10.64 feet to an angle point;
- Thence continuing easterly, forming an interior angle of 181 degrees 01 minutes 09 seconds with the last mentioned course, for 1.58 feet to an angle point;
- Thence continuing easterly, forming an interior angle of 175 degrees 23 minutes 43 seconds with the last mentioned course, for 26.65 feet to an angle point;
- Thence continuing southeasterly, forming an interior angle of 121 degrees 46 minutes 36 seconds with the last mentioned course, for 8.91 feet to the point or place of beginning.

This damage parcel consists of a portion of tax lot 1 in Staten Island tax block 6247 as shown on the "tax map" of the City of New York, Borough of Staten Island, as said "tax map" existed on December 7, 2008, and comprises an area of 837.1 square feet or 0.0192 acres.

DAMAGE PARCEL 8
PART OF LOT 10 IN BLOCK 6247

Beginning at the southeastern corner of Lot 1, Block 6247;

- Running thence westerly, for 205.99 feet to an angle point;
- Thence continuing northerly, forming an interior angle of 54 degrees 22 minutes 03 seconds with the last mentioned course, for 5.68 feet to an angle point;
- Thence continuing easterly, forming an interior angle of 125 degrees 37 minutes 17 seconds with the last mentioned course, for 198.56 feet to an angle point;
- Thence continuing southeasterly, forming an interior angle of 132 degrees 01 minutes 00 seconds with the last mentioned course, for 6.16 feet to the point or place of beginning.

This damage parcel consists of a portion of tax lot 10 in Staten Island tax block 6247 as shown on the "tax map" of the City of New York, Borough of Staten Island, as said "tax map" existed on December 7, 2008, and comprises an area of 930.4 square feet or 0.0214 acres.

DAMAGE PARCEL 9
PART OF LOT 20 IN BLOCK 6247

Beginning at the southeastern corner of Lot 20, Block 6247;

- Running thence northwesterly, for 114.36 feet to an angle point;
- Thence continuing northerly, forming an interior angle of 67 degrees 30 minutes 11 seconds with the last mentioned course, for 183.61 feet to an angle point;
- Thence continuing easterly, forming an interior angle of 88 degrees 52 minutes 41 seconds with the last mentioned course, for 13.54 feet to an angle point;
- Thence continuing southerly, forming an interior angle of 56 degrees 50 minutes 14 seconds with the last mentioned course, for 16.85 feet to an angle point;
- Thence continuing southerly, forming an interior angle of 215 degrees 56 minutes 55 seconds with the last mentioned course, for 125.92 feet to a point of curvature;
- Thence continuing southerly, on the arc of a circle, curving to the right, the radius of which is 28.26 feet, for 32.14 feet to a point of compound curvature;

- Thence continuing southerly, on the arc of a circle, curving to the right, the radius of which is 10.00 feet, for 8.49 feet to a point tangency;
- Thence continuing southeasterly, for 83.10 feet to an angle point;
- Thence continuing southwesterly, forming an interior angle of 51 degrees 25 minutes 09 seconds with the last mentioned course, for 10.79 feet to the point or place of beginning.

This damage parcel consists of a portion of lot 20 in Staten Island tax block 6247 as shown on the "tax map" of the City of New York, Borough of Staten Island, as said "tax map" existed on December 7, 2008, and comprises an area of 2,087.3 square feet or 0.0479 acres.

DAMAGE PARCEL 10
PART OF LOT 29 IN BLOCK 6247

Beginning at the northeastern corner of Lot 29, Block 6247;

- Running thence southeasterly, for 14.67 feet to an angle point;
- Thence continuing southwesterly, forming an interior angle of 92 degrees 30 minutes 09 seconds with the last mentioned course, for 87.04 feet to an angle point;
- Thence continuing northwesterly, forming an interior angle of 87 degrees 29 minutes 41 seconds with the last mentioned course, for 13.54 feet to an angle point;
- Thence continuing northeasterly, forming an interior angle of 93 degrees 14 minutes 50 seconds with the last mentioned course, for 87.10 feet to the point or place of beginning;

This damage parcel consists of a portion of tax lot 29 in Staten Island tax block 6247 as shown on the "tax map" of the City of New York, Borough of Staten Island, as said "tax map" existed on December 7, 2008, and comprises an area of 1,226.9 square feet or 0.0282 acres.

DAMAGE PARCEL 11
PART OF LOT 34 IN BLOCK 6247

Beginning at the northeastern corner of Lot 34, Block 6247;

- Running thence southeasterly, for 15.32 feet to an angle point;
- Thence continuing southwesterly, forming an interior angle of 92 degrees 30 minutes 22 seconds with the last mentioned course, for 50.04 feet to an angle point;
- Thence continuing westerly, forming an interior angle of 87 degrees 29 minutes 51 seconds with the last mentioned course, for 14.67 feet to an angle point;
- Thence continuing northeasterly, forming an interior angle of 93 degrees 14 minutes 40 seconds with the last mentioned course, for 50.07 feet to the point or place of beginning.

This damage parcel consists of a portion of tax lot 34 in Staten Island tax block 6247 as shown on the "tax map" of the City of New York, Borough of Staten Island, as said "tax map" existed on December 7, 2008, and comprises an area of 749.8 square feet or 0.0172 acres.

DAMAGE PARCEL 12
PART OF LOT 37 IN BLOCK 6247

Beginning at the northeastern corner of Lot 37, Block 6247;

- Running thence southeasterly, for 15.97 feet to an angle point;
- Thence continuing southeasterly, forming an interior angle of 92 degrees 30 minutes 19 seconds with the last mentioned course, for 50.04 feet to an angle point;
- Thence continuing westerly, forming an interior angle of 87 degrees 29 minutes 40 seconds with the last mentioned course, for 15.32 feet to an angle point;
- Thence continuing northerly, forming an interior angle of 93 degrees 14 minutes 51 seconds with the last mentioned course, for 50.07 feet to the point or place of beginning.

This damage parcel consists of a portion of tax lot 37 in Staten Island tax block 6247 as shown on the "tax map" of the City of New York, Borough of Staten Island, as said "tax map" existed on December 7, 2008, and comprises an area of 782.2 square feet or 0.0180 acres.

DAMAGE PARCEL 13
PART OF LOT 40 IN BLOCK 6247

Beginning at the northeastern corner of Lot 40, Block 6247;

- Running thence southeasterly, for 18.32 feet to an angle point;
- Thence continuing southwesterly, forming an interior angle of 116 degrees 52 minutes 48 seconds with the last mentioned course, for 22.19 feet to an angle point;
- Thence continuing northwesterly, forming an interior angle of 87 degrees 29 minutes 41 seconds with the last mentioned course, for 15.97 feet to an angle point;
- Thence continuing northeasterly, forming an interior angle of 93 degrees 14 minutes 51 seconds with the last mentioned course, for 29.77 feet to the point or place of beginning.

This damage parcel consists of a portion of tax lot 40 in Staten Island tax block 6247 as shown on the "tax map" of the City of New York, Borough of Staten Island, as said "tax map" existed on December 7, 2008, and comprises an area of 418.7 square feet or 0.0096 acres.

DAMAGE PARCEL 14
PART OF LOT 37 IN BLOCK 6247

Beginning at the southeastern corner of Lot 37, Block 6247;

- Running thence southwesterly, for 19.86 feet to an angle point;

2. Thence continuing northwesterly, forming an interior angle of 64 degrees 30 minutes 10 seconds with the last mentioned course, for 48.10 feet to an angle point;
3. Thence continuing southeasterly, forming an interior angle of 24 degrees 22 minutes 31 seconds with the last mentioned course, for 43.43 feet to the point or place of beginning.

This damage parcel consists of a portion of tax lot 37 in Staten Island tax block 6247 as shown on the "tax map" of the City of New York, Borough of Staten Island, as said "tax map" existed on December 7, 2008, and comprises an area of 431.1 square feet or 0.0099 acres.

DAMAGE PARCEL 15
PART OF LOT 21 IN BLOCK 6246

Beginning at the southeastern intersection of Annadale Road and Poillon Avenue;

1. Running thence northwesterly, for 24.85 feet to an angle point;
2. Thence continuing northeasterly, forming an interior angle of 117 degrees 37 minutes 22 seconds with the last mentioned course, for 48.06 feet to an angle point;
3. Thence continuing southeasterly, forming an interior angle of 89 degrees 58 minutes 41 seconds with the last mentioned course, for 22.09 feet to an angle point;
4. Thence continuing southwesterly, forming an interior angle of 89 degrees 57 minutes 03 seconds with the last mentioned course, for 59.57 feet to the point or place of beginning.

This damage parcel consists of a portion of tax lot 21 in Staten Island tax block 6246 as shown on the "tax map" of the City of New York, Borough of Staten Island, as said "tax map" existed on December 7, 2008, and comprises an area of 1,187.1 square feet or 0.0273 acres.

DAMAGE PARCEL 16
PART OF LOT 30 IN BLOCK 6246

Beginning at the southwestern intersection of Annadale Road and Furman Street;

1. Running thence southwesterly, for 115.43 feet to an angle point;
2. Thence continuing northwesterly, forming an interior angle of 90 degrees 02 minutes 57 seconds with the last mentioned course, for 22.09 feet to an angle point;
3. Thence continuing northeasterly, forming an interior angle of 90 degrees 01 minutes 19 seconds with the last mentioned course, for 128.05 feet to an angle point;
4. Thence continuing southeasterly, forming an interior angle of 75 degrees 39 minutes 47 seconds with the last mentioned course, for 27.77 feet to an angle point.
5. Thence continuing southwesterly, forming an interior angle of 89 degrees 24 minutes 29 seconds with the last mentioned course, for 6.74 feet to an angle point;
6. Thence continuing northwesterly, forming an interior angle of 90 degrees 29 minutes 48 seconds with the last mentioned course, for 3.03 feet to an the point or place of beginning.

This damage parcel consists of a portion of tax lot 30 in Staten Island tax block 6246 as shown on the "tax map" of the City of New York, Borough of Staten Island, as said "tax map" existed on December 7, 2008, and comprises an area of 2,802.3 square feet or 0.0643 acres.

DAMAGE PARCEL 17
PART OF LOT 108 IN BLOCK 6245

Beginning at the southeastern intersection of Annadale Road and Furman Street;

1. Running thence northwesterly, for 8.54 feet to an angle point;
2. Thence continuing northeasterly, forming an interior angle of 105 degrees 58 minutes 23 seconds with the last mentioned course, for 104.02 feet to an angle point;
3. Thence continuing southeasterly, forming an interior angle of 74 degrees 01 minutes 37 seconds with the last mentioned course, for 8.73 feet to an angle point;
4. Thence continuing southwesterly, forming an interior angle of 105 degrees 52 minutes 27 seconds with the last mentioned course, for 103.97 feet to the point or place of beginning.

This damage parcel consists of a portion of tax lot 108 in Staten Island tax block 6245 as shown on the "tax map" of the City of New York, Borough of Staten Island, as said "tax map" existed on December 7, 2008, and comprises an area of 863.8 square feet or 0.0198 acres.

DAMAGE PARCEL 18
PART OF LOT 222 IN BLOCK 6249

Beginning at the southeastern corner of Lot 222, Block 6249;

1. Running thence southwesterly, for 4.71 feet to an angle point;
2. Thence continuing southwesterly, forming an interior angle of 179 degrees 09 minutes 57 seconds with the last mentioned course, for 103.81 feet to an angle point;
3. Thence continuing northwesterly, forming an interior angle of 72 degrees 21 minutes 17 seconds with the last mentioned course, for 22.36 feet to an angle point;
4. Thence continuing northeasterly, forming an interior angle of 107 degrees 35 minutes 30 seconds with the last mentioned course, for 9.67 feet to an angle point.
5. Thence continuing southeasterly, forming an interior angle of 89 degrees 56 minutes 17 seconds with the last mentioned course, for 3.43 feet to an

- angle point;
6. Thence continuing northeasterly, forming an interior angle of 270 degrees 00 minutes 00 seconds with the last mentioned course, for 97.50 feet to an angle point;
7. Thence continuing southeasterly, forming an interior angle of 72 degrees 58 minutes 43 seconds with the last mentioned course, for 18.42 feet to the point or place of beginning.

This damage parcel consists of a portion of tax lot 222 in Staten Island tax block 6249 as shown on the "tax map" of the City of New York, Borough of Staten Island, as said "tax map" existed on August 17, 2009, and comprises an area of 1,962.7 square feet or 0.0451 acres.

DAMAGE PARCEL 19
PART OF LOT 174 IN BLOCK 6249

Beginning at the eastern most corner of Lot 174, Block 6249;

1. Running thence southwesterly, for 31.50 feet to an angle point;
2. Thence continuing northwesterly, forming an interior angle of 72 degrees 21 minutes 15 seconds with the last mentioned course, for 22.39 feet to an angle point;
3. Thence continuing northeasterly, forming an interior angle of 107 degrees 35 minutes 42 seconds with the last mentioned course, for 31.49 feet to an angle point;
4. Thence continuing southeasterly, forming an interior angle of 72 degrees 24 minutes 30 seconds with the last mentioned course, for 22.36 feet to the point or place of beginning.

This damage parcel consists of a portion of tax lot 174 in Staten Island tax block 6249 as shown on the "tax map" of the City of New York, Borough of Staten Island, as said "tax map" existed on August 17, 2009, and comprises an area of 671.6 square feet or 0.0154 acres.

DAMAGE PARCEL 20
PART OF LOT 214 IN BLOCK 6249

Beginning at the southeastern corner of Lot 214, Block 6249;

1. Running thence southwesterly, for 158.96 feet to an angle point;
2. Thence continuing northwesterly, forming an interior angle of 72 degrees 21 minutes 09 seconds with the last mentioned course, for 18.05 feet to a point;
3. Thence continuing northeasterly on the arc of a circle curving to the left, the radius of which is 2,634.48 feet, the tangent of which forms an interior angle of 106 degrees 03 minutes 54 seconds with the last mentioned course, for 91.28 feet to a point;
4. Thence continuing northeasterly, forming an interior angle of 179 degrees 34 minutes 26 seconds with the tangent of the last mentioned course, for 55.65 feet to an angle point;
5. Thence continuing northwesterly, forming an interior angle of 271 degrees 08 minutes 14 seconds with the last mentioned course, for 5.48 feet to an angle point;
6. Thence continuing northeasterly, forming an interior angle of 87 degrees 13 minutes 18 seconds with the last mentioned course, for 12.96 feet to an angle point;
7. Thence continuing northeasterly, forming an interior angle of 181 degrees 36 minutes 45 seconds with the last mentioned course, for 0.50 feet to an angle point;
8. Thence continuing southeasterly, forming an interior angle of 72 degrees 25 minutes 46 seconds with the last mentioned course, for 22.39 feet to a the point or place of beginning.

This damage parcel consists of a portion of tax lot 214 in Staten Island tax block 6249 as shown on the "tax map" of the City of New York, Borough of Staten Island, as said "tax map" existed on August 17, 2009, and comprises an area of 2,668.6 square feet or 0.0613 acres.

DAMAGE PARCEL 21
PART OF LOT 207 IN BLOCK 6249

Beginning at the southwestern corner of Lot 207, Block 6249;

1. Running thence northwesterly, for 19.09 feet to an angle point;
2. Thence continuing northeasterly, forming an interior angle of 105 degrees 28 minutes 16 seconds with the last mentioned course, for 138.22 feet to an angle point;
3. Thence continuing southeasterly, forming an interior angle of 74 degrees 31 minutes 18 seconds with the last mentioned course, for 18.05 feet to an angle point;
4. Thence continuing southwesterly, forming an interior angle of 105 degrees 53 minutes 41 seconds with the last mentioned course, for 138.50 feet to the point or place of beginning.

This damage parcel consists of a portion of tax lot 207 in Staten Island tax block 6249 as shown on the "tax map" of the City of New York, Borough of Staten Island, as said "tax map" existed on August 17, 2009, and comprises an area of 2,473.6 square feet or 0.0568 acres.

DAMAGE PARCEL 22
PART OF LOT 200 IN BLOCK 6249

Beginning at the northeastern intersection of Hoda Place and Annadale Road;

1. Running thence northeasterly, for 2.51 feet to an angle point;
2. Thence continuing southeasterly, forming an interior angle of 92 degrees 53 minutes 12 seconds with the last mentioned course, for 7.07 feet to an angle point;
3. Thence continuing northeasterly, forming an interior angle of 266 degrees 26 minutes 32 seconds

- with the last mentioned course, for 42.87 feet to an angle point;
4. Thence continuing southeasterly, forming an interior angle of 74 degrees 41 minutes 19 seconds with the last mentioned course, for 19.09 feet to an angle point.
5. Thence continuing southwesterly, forming an interior angle of 105 degrees 53 minutes 40 seconds with the last mentioned course, for 54.20 feet to an angle point;
6. Thence continuing northwesterly, forming an interior angle of 92 degrees 58 minutes 29 seconds with the last mentioned course, for 35.29 feet to an angle point;
7. Thence continuing northeasterly, forming an interior angle of 90 degrees 00 minutes 00 seconds with the last mentioned course, for 15.03 feet to an angle point.
8. Thence continuing southeasterly, forming an interior angle of 89 degrees 49 minutes 51 seconds with the last mentioned course, for 10.18 feet to the point or place of beginning.

This damage parcel consists of a portion of tax lot 200 in Staten Island tax block 6249 as shown on the "tax map" of the City of New York, Borough of Staten Island, as said "tax map" existed on August 17, 2009, and comprises an area of 1,339.5 square feet or 0.0308 acres.

DAMAGE PARCEL 23
PART OF LOT 200 IN BLOCK 6249

Beginning at the southern intersection of Hoda Place and Annadale Road;

1. Running thence northeasterly, for 1.07 feet to an angle point;
2. Thence continuing northwesterly, forming an interior angle of 272 degrees 53 minutes 12 seconds with the last mentioned course, for 7.15 feet to an angle point;
3. Thence continuing northeasterly, forming an interior angle of 90 degrees 00 minutes 00 seconds with the last mentioned course, for 15.00 feet to an angle point;
4. Thence continuing southeasterly, forming an interior angle of 90 degrees 00 minutes 00 seconds with the last mentioned course, for 33.73 feet to an angle point.
5. Thence continuing southwesterly, forming an interior angle of 87 degrees 01 minutes 31 seconds with the last mentioned course, for 28.26 feet to an angle point;
6. Thence continuing northwesterly, forming an interior angle of 74 degrees 06 minutes 20 seconds with the last mentioned course, for 20.28 feet to an angle point;
7. Thence continuing northeasterly, forming an interior angle of 105 degrees 18 minutes 41 seconds with the last mentioned course, for 5.70 feet to an angle point.
8. Thence continuing northwesterly, forming an interior angle of 274 degrees 21 minutes 58 seconds with the last mentioned course, for 6.33 feet to the point or place of beginning.

This damage parcel consists of a portion of tax lot 200 in Staten Island tax block 6249 as shown on the "tax map" of the City of New York, Borough of Staten Island, as said "tax map" existed on August 17, 2009, and comprises an area of 700.6 square feet or 0.0161 acres.

DAMAGE PARCEL 24
PART OF LOT 38 IN BLOCK 6249

Beginning at the southeastern corner of Lot 38, Block 6249;

1. Running thence southwesterly, for 59.46 feet to an angle point;
2. Thence continuing northwesterly, forming an interior angle of 86 degrees 18 minutes 24 seconds with the last mentioned course, for 20.19 feet to an angle point;
3. Thence continuing northeasterly, forming an interior angle of 93 degrees 06 minutes 36 seconds with the last mentioned course, for 63.72 feet to an angle point;
4. Thence continuing southeasterly, forming an interior angle of 74 degrees 41 minutes 19 seconds with the last mentioned course, for 20.28 feet to the point or place of beginning.

This damage parcel consists of a portion of tax lot 40 in Staten Island tax block 6249 as shown on the "tax map" of the City of New York, Borough of Staten Island, as said "tax map" existed on August 17, 2009, and comprises an area of 1,222.2 square feet or 0.0281 acres.

DAMAGE PARCEL 25
PART OF LOT 33 IN BLOCK 6249

Beginning at the southeastern corner of Lot 33, Block 6249;

1. Running thence southeasterly, for 78.97 feet to an angle point;
2. Thence continuing northwesterly, forming an interior angle of 80 degrees 17 minutes 27 seconds with the last mentioned course, for 21.24 feet to an angle point;
3. Thence continuing northeasterly, forming an interior angle of 99 degrees 07 minutes 34 seconds with the last mentioned course, for 76.70 feet to an angle point;
4. Thence continuing southeasterly, forming an interior angle of 86 degrees 53 minutes 24 seconds with the last mentioned course, for 20.19 feet to the point or place of beginning.

This damage parcel consists of a portion of tax lot 33 in Staten Island tax block 6249 as shown on the "tax map" of the City of New York, Borough of Staten Island, as said "tax map" existed on August 17, 2009, and comprises an area of 1,599.7 square feet or 0.0367 acres.

DAMAGE PARCEL 26

PART OF LOT 30 IN BLOCK 6249

Beginning at the southeastern corner of Lot 30, Block 6249;

1. Running thence southwesterly, for 26.61 feet to an angle point;
2. Thence continuing southwesterly, forming an interior angle of 175 degrees 30 minutes 12 seconds with the last mentioned course, for 23.40 feet to an angle point;
3. Thence continuing northwesterly, forming an interior angle of 84 degrees 47 minutes 16 seconds with the last mentioned course, for 19.89 feet to an angle point;
4. Thence continuing northeasterly, forming an interior angle of 99 degrees 07 minutes 34 seconds with the last mentioned course, for 50.16 feet to an angle point;
5. Thence continuing southeasterly, forming an interior angle of 80 degrees 52 minutes 26 seconds with the last mentioned course, for 21.24 feet to the point or place of beginning.

This damage parcel consists of a portion of tax lot 30 in Staten Island tax block 6249 as shown on the "tax map" of the City of New York, Borough of Staten Island, as said "tax map" existed on August 17, 2009, and comprises an area of 1,042.9 square feet or 0.0239 acres.

DAMAGE PARCEL 27

PART OF LOT 25 IN BLOCK 6249

Beginning at the southeastern corner of Lot 25, Block 6249;

1. Running thence southwesterly, for 51.67 feet to an angle point;
2. Thence continuing southwesterly, forming an interior angle of 175 degrees 23 minutes 11 seconds with the last mentioned course, for 36.45 feet to an angle point;
3. Thence continuing northwesterly, forming an interior angle of 84 degrees 30 minutes 16 seconds with the last mentioned course, for 11.04 feet to an angle point;
4. Thence continuing northeasterly, forming an interior angle of 104 degrees 01 minutes 23 seconds with the last mentioned course, for 88.07 feet to an angle point;
5. Thence continuing southeasterly, forming an interior angle of 80 degrees 52 minutes 26 seconds with the last mentioned course, for 19.89 feet to the point or place of beginning.

This damage parcel consists of a portion of tax lot 25 in Staten Island tax block 6249 as shown on the "tax map" of the City of New York, Borough of Staten Island, as said "tax map" existed on August 17, 2009, and comprises an area of 1,421.6 square feet or 0.0326 acres.

DAMAGE PARCEL 28

PART OF LOT 21 IN BLOCK 6249

Beginning at the southeastern corner of Lot 21, Block 6249;

1. Running thence southwesterly, for 17.89 feet to an angle point;
2. Thence continuing southwesterly, forming an interior angle of 163 degrees 38 minutes 20 seconds with the last mentioned course, for 57.11 feet to an angle point;
3. Thence continuing northeasterly, forming an interior angle of 03 degrees 50 minutes 51 seconds with the last mentioned course, for 44.50 feet to an angle point;
4. Thence continuing northeasterly, forming an interior angle of 201 degrees 02 minutes 28 seconds with the last mentioned course, for 30.64 feet to an angle point;
5. Thence continuing southeasterly, forming an interior angle of 75 degrees 58 minutes 37 seconds with the last mentioned course, for 11.04 feet to the point or place of beginning.

This damage parcel consists of a portion of tax lot 21 in Staten Island tax block 6249 as shown on the "tax map" of the City of New York, Borough of Staten Island, as said "tax map" existed on August 17, 2009, and comprises an area of 307.0 square feet or 0.0070 acres.

ROADWAY PARCEL

Beginning at the northwestern intersection of Alvine Avenue and Amboy Road;

1. Running thence northeasterly, for 281.11 feet to an angle point;
2. Thence continuing northwesterly, forming an interior angle of 297 degrees 58 minutes 58 seconds with the last mentioned course, for 1.47 feet to an angle point;
3. Thence continuing northeasterly, forming an interior angle of 63 degrees 23 minutes 16 seconds with the last mentioned course, for 38.04 feet to an angle point;
4. Thence continuing northwesterly, forming an interior angle of 266 degrees 08 minutes 08 seconds with the last mentioned course, for 167.56 feet to an angle point;
5. Thence continuing northeasterly, forming an interior angle of 90 degrees 10 minutes 20 seconds with the last mentioned course, for 80.00 feet to an angle point;
6. Thence continuing southeasterly, forming an interior angle of 89 degrees 49 minutes 44 seconds with the last mentioned course, for 148.52 feet to an angle point;
7. Thence continuing northeasterly, forming an interior angle of 275 degrees 34 minutes 55 seconds with the last mentioned course, for 60.29 feet to an angle point;
8. Thence continuing northeasterly, forming an interior angle of 179 degrees 59 minutes 49 seconds with the last mentioned course, for 20.10 feet to an

angle point;

9. Thence continuing northeasterly, forming an interior angle of 180 degrees 00 minutes 16 seconds with the last mentioned course, for 40.19 feet to an angle point;
10. Thence continuing northeasterly, forming an interior angle of 179 degrees 59 minutes 54 seconds with the last mentioned course, for 62.57 feet to an angle point;
11. Thence continuing southeasterly, forming an interior angle of 101 degrees 04 minutes 22 seconds with the last mentioned course, for 11.50 feet to an angle point;
12. Thence continuing northeasterly, forming an interior angle of 258 degrees 57 minutes 31 seconds with the last mentioned course, for 75.00 feet to an angle point;
13. Thence continuing northeasterly, forming an interior angle of 183 degrees 50 minutes 52 seconds with the last mentioned course, for 44.50 feet to an angle point;
14. Thence continuing northeasterly, forming an interior angle of 201 degrees 02 minutes 28 seconds with the last mentioned course, for 314.98 feet to an angle point;
15. Thence continuing northwesterly, forming an interior angle of 274 degrees 21 minutes 58 seconds with the last mentioned course, for 6.33 feet to an angle point;
16. Thence continuing northeasterly, forming an interior angle of 86 degrees 18 minutes 17 seconds with the last mentioned course, for 1.07 feet to an angle point;
17. Thence continuing northwesterly, forming an interior angle of 272 degrees 53 minutes 12 seconds with the last mentioned course, for 7.15 feet to an angle point;
18. Thence continuing northeasterly, forming an interior angle of 90 degrees 00 minutes 00 seconds with the last mentioned course, for 15.00 feet to an angle point;
19. Thence continuing southeasterly, forming an interior angle of 90 degrees 00 minutes 00 seconds with the last mentioned course, for 42.04 feet to an angle point;
20. Thence continuing northeasterly, forming an interior angle of 265 degrees 49 minutes 37 seconds with the last mentioned course, for 30.08 feet to an angle point;
21. Thence continuing northwesterly, forming an interior angle of 274 degrees 10 minutes 23 seconds with the last mentioned course, for 44.23 feet to an angle point;
22. Thence continuing northeasterly, forming an interior angle of 90 degrees 00 minutes 03 seconds with the last mentioned course, for 15.03 feet to an angle point;
23. Thence continuing southeasterly, forming an interior angle of 89 degrees 49 minutes 51 seconds with the last mentioned course, for 10.18 feet to an angle point;
24. Thence continuing northeasterly, forming an interior angle of 267 degrees 16 minutes 56 seconds with the last mentioned course, for 2.51 feet to an angle point;
25. Thence continuing southeasterly, forming an interior angle of 92 degrees 53 minutes 12 seconds with the last mentioned course, for 7.07 feet to an angle point;
26. Thence continuing northeasterly, forming an interior angle of 266 degrees 26 minutes 32 seconds with the last mentioned course, for 42.87 feet to an angle point;
27. Thence continuing northeasterly, forming an interior angle of 182 degrees 08 minutes 44 seconds with the last mentioned course, for 138.22 feet to a point;
28. Thence continuing northeasterly, on the arc of a circle curving to the left, the radius of which is 2,634.48 feet, the tangent of which forms an interior angle of 180 degrees 36 minutes 11 seconds with the last mentioned course, for 91.28 feet to a point;
29. Thence continuing northeasterly, forming an interior angle of 179 degrees 34 minutes 26 seconds with the tangent of the last mentioned course, for 55.65 feet to an angle point;
30. Thence continuing northwesterly, forming an interior angle of 271 degrees 08 minutes 14 seconds with the last mentioned course, for 5.48 feet to an angle point;
31. Thence continuing northeasterly, forming an interior angle of 87 degrees 13 minutes 18 seconds with the last mentioned course, for 12.96 feet to an angle point;
32. Thence continuing northeasterly, forming an interior angle of 181 degrees 36 minutes 45 seconds with the last mentioned course, for 41.66 feet to an angle point;
33. Thence continuing southeasterly, forming an interior angle of 89 degrees 56 minutes 17 seconds with the last mentioned course, for 3.43 feet to an angle point;
34. Thence continuing northeasterly, forming an interior angle of 270 degrees 00 minutes 00 seconds with the last mentioned course, for 97.50 feet to an angle point;
35. Thence continuing southeasterly, forming an interior angle of 72 degrees 58 minutes 43 seconds with the last mentioned course, for 18.42 feet to an angle point;
36. Thence continuing southwesterly, forming an interior angle of 107 degrees 58 minutes 15 seconds with the last mentioned course, for 4.71 feet to an angle point;
37. Thence continuing southeasterly, forming an interior angle of 246 degrees 20 minutes 17 seconds

38. Thence continuing southeasterly, forming an interior angle of 186 degrees 48 minutes 03 seconds with the last mentioned course, for 8.73 feet to an angle point;
39. Thence continuing southwesterly, forming an interior angle of 105 degrees 52 minutes 27 seconds with the last mentioned course, for 103.97 feet to an angle point;
40. Thence continuing southeasterly, forming an interior angle of 254 degrees 07 minutes 32 seconds with the last mentioned course, for 34.95 feet to an angle point;
41. Thence continuing southwesterly, forming an interior angle of 89 degrees 30 minutes 13 seconds with the last mentioned course, for 60.00 feet to an angle point;
42. Thence continuing northwesterly, forming an interior angle of 90 degrees 29 minutes 48 seconds with the last mentioned course, for 3.03 feet to an angle point;
43. Thence continuing southwesterly, forming an interior angle of 284 degrees 21 minutes 40 seconds with the last mentioned course, for 175.00 feet to an angle point;
44. Thence continuing southeasterly, forming an interior angle of 242 degrees 26 minutes 55 seconds with the last mentioned course, for 138.97 feet to an angle point;
45. Thence continuing southwesterly, forming an interior angle of 89 degrees 58 minutes 13 seconds with the last mentioned course, for 80.00 feet to an angle point;
46. Thence continuing northwesterly, forming an interior angle of 90 degrees 01 minutes 47 seconds with the last mentioned course, for 103.59 feet to an angle point;
47. Thence continuing southwesterly, forming an interior angle of 296 degrees 52 minutes 53 seconds with the last mentioned course, for 209.31 feet to an angle point;
48. Thence continuing southwesterly, forming an interior angle of 144 degrees 19 minutes 53 seconds with the last mentioned course, for 16.85 feet to an angle point;
49. Thence continuing southwesterly, forming an interior angle of 215 degrees 56 minutes 55 seconds with the last mentioned course, for 125.92 feet to point of tangency;
50. Thence continuing southwesterly, on the arc of a circle, curving to the left, the radius of which is 28.26 feet, for 32.14 feet to a point of compound curvature;
51. Thence continuing southeasterly, on the arc of a circle, curving to the left, the radius of which is 10.00 feet, for 8.49 feet to a point of curvature;
52. Thence continuing southeasterly, forming a tangent with the last mentioned course, for 83.10 feet to an angle point;
53. Thence continuing southwesterly, forming an interior angle of 51 degrees 24 minutes 37 seconds with the last mentioned course, for 5.11 feet to an angle point;
54. Thence continuing southeasterly, forming an interior angle of 305 degrees 37 minutes 49 seconds with the last mentioned course, for 259.82 feet to an angle point;
55. Thence continuing southeasterly, forming an interior angle of 183 degrees 00 minutes 22 seconds with the last mentioned course, for 53.86 feet to an angle point;
56. Thence continuing southeasterly, forming an interior angle of 183 degrees 38 minutes 54 seconds with the last mentioned course, for 10.64 feet to an angle point;
57. Thence continuing southeasterly, forming an interior angle of 181 degrees 01 minutes 09 seconds with the last mentioned course, for 1.58 feet to an angle point;
58. Thence continuing southeasterly, forming an interior angle of 184 degrees 36 minutes 17 seconds with the last mentioned course, for 26.65 feet to an angle point;
59. Thence continuing northwesterly, forming an interior angle of 301 degrees 46 minutes 36 seconds with the last mentioned course, for 19.02 feet to an angle point;
60. Thence continuing northeasterly, forming an interior angle of 68 degrees 39 minutes 01 seconds with the last mentioned course, for 85.89 feet to an angle point;
61. Thence continuing southeasterly, forming an interior angle of 111 degrees 20 minutes 59 seconds with the last mentioned course, for 22.09 feet to an angle point;
62. Thence continuing northeasterly, forming an interior angle of 265 degrees 59 minutes 29 seconds with the last mentioned course, for 20.13 feet to an angle point;
63. Thence continuing southeasterly, forming an interior angle of 77 degrees 44 minutes 11 seconds with the last mentioned course, for 60.30 feet to an angle point;
64. Thence continuing southwesterly, forming an interior angle of 98 degrees 57 minutes 36 seconds with the last mentioned course, for 3.21 feet to an angle point;
65. Thence continuing southeasterly, forming an interior angle of 278 degrees 45 minutes 35 seconds with the last mentioned course, for 6.28 feet to an angle point;
66. Thence continuing southwesterly, forming an interior angle of 74 degrees 36 minutes 26 seconds with the last mentioned course, for 82.98 feet to an angle point;
67. Thence continuing northwesterly, forming an

- interior angle of 105 degrees 23 minutes 34 seconds with the last mentioned course, for 12.20 feet to an angle point;
68. Thence continuing northwesterly, forming an interior angle of 240 degrees 02 minutes 18 seconds with the last mentioned course, for 12.94 feet to an angle point;
69. Thence continuing northwesterly, forming an interior angle of 177 degrees 45 minutes 41 seconds with the last mentioned course, for 53.71 feet to an angle point;
70. Thence continuing northwesterly, forming an interior angle of 172 degrees 29 minutes 48 seconds with the last mentioned course, for 44.12 feet to an angle point;
71. Thence continuing northwesterly, forming an interior angle of 179 degrees 27 minutes 03 seconds with the last mentioned course, for 26.65 feet to an angle point;
72. Thence continuing northwesterly, forming an interior angle of 173 degrees 00 minutes 50 seconds with the last mentioned course, for 154.70 feet to an angle point;
73. Thence continuing northwesterly, forming an interior angle of 182 degrees 09 minutes 28 seconds with the last mentioned course, for 46.88 feet to an angle point;
74. Thence continuing northwesterly, forming an interior angle of 181 degrees 12 minutes 48 seconds with the last mentioned course, for 53.34 feet to a point of tangency;
75. Thence continuing northwesterly, on the arc of a circle, curving to the left, the radius of which is 300.00 feet, for 188.85 feet to a point of curvature;
76. Thence continuing southeasterly, forming an interior angle of 282 degrees 17 minutes 01 seconds with the tangent of the last mentioned course, for 6.77 feet to an angle point;
77. Thence continuing southwesterly, forming an interior angle of 86 degrees 08 minutes 28 seconds with the last mentioned course, for 60.14 feet to an angle point;
78. Thence continuing northwesterly, forming an interior angle of 93 degrees 51 minutes 32 seconds with the last mentioned course, for 10.03 feet to an angle point;
79. Thence continuing southwesterly, forming an interior angle of 266 degrees 01 minutes 50 seconds with the last mentioned course, for 200.48 feet to an angle point;
80. Thence continuing southeasterly, forming an interior angle of 273 degrees 58 minutes 10 seconds with the last mentioned course, for 9.72 feet to an angle point;
81. Thence continuing southwesterly, forming an interior angle of 82 degrees 04 minutes 38 seconds with the last mentioned course, for 60.58 feet to an angle point;
82. Thence continuing northwesterly, forming an interior angle of 97 degrees 55 minutes 24 seconds with the last mentioned course, for 5.53 feet to an angle point;
83. Thence continuing southwesterly, forming an interior angle of 266 degrees 01 minutes 50 seconds with the last mentioned course, for 38.99 feet to an angle point;
84. Thence continuing southwesterly, forming an interior angle of 175 degrees 51 minutes 53 seconds with the last mentioned course, for 75.16 feet to an angle point;
85. Thence continuing northwesterly, forming an interior angle of 97 degrees 44 minutes 50 seconds with the last mentioned course, for 9.58 feet to an angle point;
86. Thence continuing southwesterly, forming an interior angle of 262 degrees 11 minutes 42 seconds with the last mentioned course, for 112.22 feet to an angle point;
87. Thence continuing northwesterly, forming an interior angle of 90 degrees 31 minutes 13 seconds with the last mentioned course, for 5.00 feet to an angle point;
88. Thence continuing southwesterly, forming an interior angle of 269 degrees 28 minutes 47 seconds with the last mentioned course, for 82.92 feet to an angle point;
89. Thence continuing northwesterly, forming an interior angle of 90 degrees 00 minutes 00 seconds with the last mentioned course, for 49.44 feet to the point of beginning.

This parcel comprised an area of 164,829.0 square feet or 3.784 acres.

Surveys, maps or plans of the property to be acquired are on file in the office of the Corporation Counsel of the City of New York, 100 Church Street, New York, New York 10007.

PLEASE TAKE FURTHER NOTICE THAT, pursuant to EDPL § 402(B)(4), any party seeking to oppose the acquisition must interpose a verified answer, which must contain specific denial of each material allegation of the petition controverted by the opponent, or any statement of new matter deemed by the opponent to be a defense to the proceeding. Pursuant to CPLR 403, said answer must be served upon the office of the Corporation Counsel at least seven (7) days before the date that the petition is noticed to be heard.

Dated: January 11, 2011, New York, New York
MICHAEL A. CARDOZO
Corporation Counsel of the City of New York
100 Church Street, Rm 5-241
New York, New York 10007
Tel. (212) 788-0705

SEE MAPS ON BACK PAGES

j28-f10

PROPERTY DISPOSITION

CITYWIDE ADMINISTRATIVE SERVICES

MUNICIPAL SUPPLY SERVICES

■ AUCTION

PUBLIC AUCTION SALE NUMBER 11001-L

NOTICE IS HEREBY GIVEN of a public auction of City fleet vehicles consisting of cars, vans, light duty vehicles, trucks, heavy equipment and miscellaneous automotive equipment to be held on Wednesday, February 2, 2011 (SALE NUMBER 11001-L). Viewing is on auction day only from 8:30 A.M. until 9:00 A.M. The auction begins at 9:00 A.M.

LOCATION: 570 Kent Avenue, Brooklyn, NY (in the Brooklyn Navy Yard between Taylor and Clymer Streets).

A listing of vehicles to be offered for sale in the next auction can be viewed on our website, on the Friday prior to the sale date at:

<http://www.nyc.gov/autoauction>
or
<http://www.nyc.gov/autoauctions>

Terms and Conditions of Sale can also be viewed at this site. For further information, please call (718) 417-2155 or (718) 625-1313.

j12-f2

POLICE

OWNERS ARE WANTED BY THE PROPERTY CLERK DIVISION OF THE NEW YORK CITY POLICE DEPARTMENT.

The following listed property is in the custody, of the Property Clerk Division without claimants.

Recovered, lost, abandoned property, property obtained from prisoners, emotionally disturbed, intoxicated and deceased persons; and property obtained from persons incapable of caring for themselves.
Motor vehicles, boats, bicycles, business machines, cameras, calculating machines, electrical and optical property, furniture, furs, handbags, hardware, jewelry, photographic equipment, radios, robes, sound systems, surgical and musical instruments, tools, wearing apparel, communications equipment, computers, and other miscellaneous articles.

INQUIRIES

Inquiries relating to such property should be made in the Borough concerned, at the following office of the Property Clerk.

FOR MOTOR VEHICLES

(All Boroughs):

- * College Auto Pound, 129-01 31 Avenue, College Point, NY 11354, (718) 445-0100
- * Gowanus Auto Pound, 29th Street and 2nd Avenue, Brooklyn, NY 11212, (718) 832-3852
- * Erie Basin Auto Pound, 700 Columbia Street, Brooklyn, NY 11231, (718) 246-2029

FOR ALL OTHER PROPERTY

- * Manhattan - 1 Police Plaza, New York, NY 10038, (212) 374-4925.
- * Brooklyn - 84th Precinct, 301 Gold Street, Brooklyn, NY 11201, (718) 875-6675.
- * Bronx Property Clerk - 215 East 161 Street, Bronx, NY 10451, (718) 590-2806.
- * Queens Property Clerk - 47-07 Pearson Place, Long Island City, NY 11101, (718) 433-2678.
- * Staten Island Property Clerk - 1 Edgewater Plaza, Staten Island, NY 10301, (718) 876-8484.

j1-d31

PROCUREMENT

"The City of New York is committed to achieving excellence in the design and construction of its capital program, and building on the tradition of innovation in architecture and engineering that has contributed to the City's prestige as a global destination. The contracting opportunities for construction/construction services and construction-related services that appear in the individual agency listings below reflect that commitment to excellence."

CITY UNIVERSITY

■ SOLICITATIONS

Goods

ASSORTED AIR FILTERS – Competitive Sealed Bids – PIN# 1771155 – DUE 02-25-11 AT 2:30 P.M. – Assorted Air Filters to be used in Air Handling Units throughout KCC Campus and Leon Goldstein High School. Last day to request bid package February 18, 2011. This is a Requirements Contract. Contract term is (1) one twelve month period with (4) four twelve month renewals.

Use the following address unless otherwise specified in notice, to secure, examine or submit bid/proposal documents, vendor pre-qualification and other forms; specifications/blueprints; other information; and for opening and reading of bids at date and time specified above.
City University, 2001 Oriental Blvd., Room A207K, 2nd Fl., Brooklyn, NY 11235. Julie Cardinali (718) 368-4613, fax: (718) 368-4613, jcardinali@kbcc.cuny.edu

j28

CITYWIDE ADMINISTRATIVE SERVICES

MUNICIPAL SUPPLY SERVICES

■ SOLICITATIONS

Goods

FORKLIFT, ROUGH TERRAIN - NYPD – Competitive Sealed Bids – PIN# 8571100390 – DUE 02-14-11 AT 10:30 A.M.

Use the following address unless otherwise specified in notice, to secure, examine or submit bid/proposal documents, vendor pre-qualification and other forms; specifications/blueprints; other information; and for opening and reading of bids at date and time specified above.
Department of Citywide Administrative Services
1 Centre Street, Room 1800, New York, NY 10007.
Anna Wong (212) 669-8610, fax: (212) 669-7603, dcasdmssbids@dcas.nyc.gov

j28

■ AWARDS

Goods

NYS CONTRACT SCIENTIFIC EQUIPMENT – Intergovernmental Purchase – PIN# 8571100479 – AMT: \$1,234,098.00 – TO: Applied Biosystems LLC, 850 Lincoln Centre Drive, Foster City, CA 94404.

Suppliers wishing to be considered for a contract with the Office of General Services of New York State are advised to contact the Procurement Services Group, Corning Tower, Room 3711, Empire State Plaza, Albany, NY 12242 or by phone: 518-474-6717.

j28

YSI TELEMETRY BUOY SYSTEM AND PARTS - BRAND SPECIFIC – Competitive Sealed Bids – PIN# 8571000438 – AMT: \$546,000.00 – TO: YSI Inc., 1700/1725 Brannum Lane, Yellow Springs, OH 45387.

j28

CEREALS, PASTA, RICE, DRIED LEGUMES/ CORNSTARCH – Other – PIN# 8571102766 – AMT: \$23,750.00 – TO: Mivila Corp. dba Mivila Foods, 226 Getty Avenue, Paterson, NJ 07503. Original Vendor: Robbins Sales Co. Inc. Basis for Buy-Against: Non-Delivery by Original Vendor on Purchase Order #1100385, Item #11

j28

NYS CONTR FOR PORTAL SOFTWARE - NYPD – Intergovernmental Purchase – PIN# 8571100482 – AMT: \$517,998.00 – TO: Intl. Business Machine Corp., 590 Madison Ave., 16th Fl., Drop 6518, NY, NY 10022. NYS Contract #PT64366.

● **NYS CONTR FOR MCAFFEE SOFTWARE PRODUCTS - DEP** – Intergovernmental Purchase – PIN# 8571100490 – AMT: \$526,125.04 – TO: Dyntek Services, Inc., 1250 Broadway, Suite 3801, NY, NY 10001. NYS Contracts #PT59096, PS59097.

Suppliers wishing to be considered for a contract with the Office of General Services of New York State are advised to contact the Procurement Services Group, Corning Tower, Room 3711, Empire State Plaza, Albany, NY 12242 or by phone: 518-474-6717.

j28

■ VENDOR LISTS

Goods

ACCEPTABLE BRAND LIST – In accordance with PPB Rules, Section 2-05(c)(3), the following is a list of all food items for which an Acceptable Brands List has been established.

1. Mix, Biscuit - AB-14-1:92
2. Mix, Bran Muffin - AB-14-2:91
3. Mix, Corn Muffin - AB-14-5:91
4. Mix, Pie Crust - AB-14-9:91
5. Mixes, Cake - AB-14-11:92A
6. Mix, Egg Nog - AB-14-19:93
7. Canned Beef Stew - AB-14-25:97
8. Canned Ham Shanks - AB-14-28:91
9. Canned Corned Beef Hash - AB-14-26:94
10. Canned Boned Chicken - AB-14-27:91
11. Canned Corned Beef - AB-14-30:91
12. Canned Ham, Cured - AB-14-29:91
13. Complete Horse Feed Pellets - AB-15-1:92
14. Canned Soups - AB-14-10:92D
15. Infant Formula, Ready to Feed - AB-16-1:93
16. Spices - AB-14-12:95
17. Soy Sauce - AB-14-03:94
18. Worcestershire Sauce - AB-14-04:94

Application for inclusion on the above enumerated Acceptable Brand Lists for foods shall be made in writing and addressed to: Purchase Director, Food Unit, Department of Citywide Administrative Services, Division of Municipal Supply Services, 1 Centre Street, 18th Floor, New York, NY 10007, (212) 669-4207.

j5-d31

EQUIPMENT FOR DEPARTMENT OF SANITATION – In accordance with PPB Rules, Section 2.05(c)(3), an acceptable brands list will be established for the following equipment for the Department of Sanitation:

- A. Collection Truck Bodies
- B. Collection Truck Cab Chassis
- C. Major Component Parts (Engine, Transmission, etc.)

Applications for consideration of equipment products for inclusion on the acceptable brands list are available from: Vendor Relations, Department of Citywide Administrative Services, Division of Municipal Supply Services, 1 Centre Street, 18th Floor, New York, NY 10007. (212) 669-8610.

j5-d31

OPEN SPACE FURNITURE SYSTEMS - CITYWIDE – In accordance with PPB Rules, Section 2.05(c)(3), an Acceptable Brands List, #AB-17W-1:99, has been established for open space furniture systems.

Application for consideration of product for inclusion on this acceptable brands list shall be made in writing and addressed to: Vendor Relations, Department of Citywide Administrative Services, Division of Municipal Supply Services, 1 Centre Street, 18th Floor, New York, NY 10007, (212) 669-8610.

j5-d31

INTENT TO AWARD

Services (Other Than Human Services)

UNARMED SECURITY GUARDS – Negotiated Acquisition – PIN# 85700700567 – DUE 02-04-11 AT 10:30 A.M. – DCAS/DMSS intends to negotiate with the current provider of Unarmed Security Guard Services, AlliedBarton Security Services, LLC, to extend the existing contract. It is anticipated that the contract term will be from March 10, 2011, through March 9, 2013. Organizations interested in responding to future solicitations for this service are invited to do so by calling the DCAS/DMSS Office of Vendor Relations at (212) 669-8562 to request a Vendor Package.

Available only from current provider.

Use the following address unless otherwise specified in notice, to secure, examine or submit bid/proposal documents, vendor pre-qualification and other forms; specifications/blueprints; other information; and for opening and reading of bids at date and time specified above.
 Department of Citywide Administrative Services,
 1 Centre Street, 18th Floor South, New York, NY 10007.
 Carol Green (212) 669-8530.

j28-f3

CORRECTION

CENTRAL OFFICE OF PROCUREMENT
SOLICITATIONS

Construction / Construction Services

UPGRADE TO VENTILATION SYSTEM AT RNDC – Negotiated Acquisition – PIN# 072201109CPD – DUE 02-16-11 AT 11:00 A.M. – The project is required due to Benjamin Litigation Court Order by the Federal Court. This order requires DOC to upgrade and enhance the ventilation in all six housing areas of Robert N. Davoren Center (RNDC). The Benjamin Litigation stipulates compliance by December 2011. A Mandatory site visit will be held Wednesday, January 26, 2011 at 8:00 A.M. at Department of Correction Headquarters, Bulova Corporate Center, 75-20 Astoria Blvd., Suite 160, East Elmhurst, New York 11370. If you have any questions, please call Cassandra L. Dunham at (718) 546-0766.

Robert N. Davoren Center (RNDC) Mechanical, Electrical and Structural Ventilation System is being upgraded. This Procurement is time sensitive and mandated by Federal Court Order. Bidders are hereby advised that this contract is subject to the Project Labor Agreement (PLA) entered in between the City and the Building and Construction Trades Council of Greater New York (“BCTC”) affiliated local unions.

Use the following address unless otherwise specified in notice, to secure, examine or submit bid/proposal documents, vendor pre-qualification and other forms; specifications/blueprints; other information; and for opening and reading of bids at date and time specified above.
 Department of Correction, 75-20 Astoria Boulevard, Suite 160, East Elmhurst, NY 11370.
 Cassandra Dunham (718) 546-0766, fax: (718) 278-6205,
 cassandra.dunham@doc.nyc.gov

j24-28

ECONOMIC DEVELOPMENT CORPORATION

CONTRACTS
SOLICITATIONS

Goods & Services

M/W/DBE TECHNICAL ADVISOR, CONSULTANT SERVICES RFP – Request for Proposals – PIN# 47420001 – DUE 02-28-11 AT 4:00 P.M. – New York City Economic Development Corporation (NYCEDC) is seeking a consultant or consultant team to provide in-depth and individualized technical assistance to select certified M/W/DBE construction firms in NYC with the goal of addressing the business, financial and technical management needs of their businesses.

NYCEDC plans to select a consultant on the basis of factors stated in the RFP which include, but are not limited to: the quality of the proposal, experience of key staff identified in the proposal, experience and quality of any subcontractors proposed, demonstrated successful experience in performing services similar to those encompassed in the RFP and the proposed fee, if applicable.

Companies who have been certified with the New York City Department of Small Business Services as Minority and Women Owned Business Enterprises (“M/WBE”) are strongly encouraged to apply. To learn more about M/WBE certification and NYCEDC’s M/WBE program, please visit <http://www.nycedc.com/opportunitymwdbe>.

An optional informational session will be held on Monday, February 7, 2011 at 3:00 P.M. at NYCEDC. Those who wish to attend should RSVP by email to techrfp@nycedc.com on or before February 4, 2011.

Respondents may submit questions and/or request clarifications from NYCEDC no later than 5:00 P.M. on Friday, February 11, 2011. Questions regarding the subject matter of this RFP should be directed to techrfp@nycedc.com. Answers to all questions will be posted by Friday, February 18, 2011, to www.nycedc.com/RFP.

To download a copy of the solicitation documents please visit www.nycedc.com/RFP. Please submit five (5) sets of your proposal to NYCEDC.

Use the following address unless otherwise specified in notice, to secure, examine or submit bid/proposal documents, vendor pre-qualification and other forms; specifications/blueprints; other information; and for opening and reading of bids at date and time specified above.
 Economic Development Corp., 110 William Street, 6th Floor,
 New York, NY 10038. Maryann Catalano (212) 312-3969;
 Fax: (212) 312-3918, techrfp@nycedc.com.

j28

HEALTH AND HOSPITALS CORPORATION

The New York City Health and Hospitals Corporation is regularly soliciting bids for supplies and equipment at its Central Purchasing Offices, 346 Broadway, New York City, Room 516, for its Hospitals and Diagnostic and Treatment Centers. All interested parties are welcome to review the bids that are posted in Room 516 weekdays between 9:00 a.m. and 4:30 p.m. For information regarding bids and the bidding process, please call (212) 442-4018.

j1-d31

SOLICITATIONS

Construction Related Services

ELECTRICAL POWER SERVICE UPGRADE PROJECT – Competitive Sealed Bids – PIN# 111-11-050 – DUE 02-25-11 AT 3:00 P.M. – The project scope of work requires demolition, replacement and relocation the “F and G” power service equipment. The original power source shall be eliminated and a new power source from the existing switchboards shall be restored. All existing loads shall be checked for their condition and extended to a new service equipment location. Work includes demolition, installation of new electrical equipment, devices, conduits, wiring and labeling of equipment and feeders.

Please note that there is a mandatory pre-bid meeting for this project. For convenience two meetings are scheduled on Wednesday, February 9, 2011 at 10:00 A.M. and Thursday, February 10, 2011 at 10:00 A.M. The meetings will take place in the Administration Building, Room A708. Attendance is required to (1) one of the meetings in order to be eligible to submit a bid.

To obtain a bid package contact Eric Novak at (212) 562-2887 or preferred via e-mail at Eric.Novak@bellevue.nychhc

Use the following address unless otherwise specified in notice, to secure, examine or submit bid/proposal documents, vendor pre-qualification and other forms; specifications/blueprints; other information; and for opening and reading of bids at date and time specified above.
 Bellevue Hospital Center, Purchasing, 462 First Avenue,
 Administration Building, 7th Floor, Room A704, New York,
 NY 10016. Eric Novak (212) 562-2887, fax: (212) 562-4998,
 Eric.Novak@bellevue.nychhc.org

j28

HEALTH AND MENTAL HYGIENE

AGENCY CHIEF CONTRACTING OFFICER
SOLICITATIONS

Human / Client Services

NEW YORK/NY III SUPPORTED HOUSING CONGREGATE – Competitive Sealed Proposals – Judgment required in evaluating proposals - PIN# 81608PO076300ROX00-R – DUE 03-22-12 AT 4:00 P.M.

– The Department is issuing a RFP to establish 3,000 units of citywide supportive housing in newly constructed or rehabilitated single-site buildings for various homeless populations pursuant to the New York III Supported Housing agreement. The subject RFP will be open-ended and proposals will be accepted on an on-going basis. The RFP is available on-line at <http://www.nyc.gov/html/doh/html/acco/acco-rfp-nynyccongregate-20070117-form.shtml>. A pre-proposal conference was held on March 6, 2007 at 2:00 P.M. at 125 Worth Street, 2nd Floor Auditorium, New York, N.Y. Any questions regarding this RFP must be sent in writing in advance to Contracting Officer at the above address or fax to (212) 219-5865. All proposals must be hand delivered at the Agency Chief Contracting Officer, 93 Worth Street, Room 812, New York, NY 10013, no later than March 22, 2012.

As a minimum qualification requirement for (1) the serious and persistent mentally ill populations, the proposer must be incorporated as a not-for-profit organization, and (2) for the young adult populations, the proposer must document site control and identify the source of the capital funding and being used to construct or renovate the building.

Use the following address unless otherwise specified in notice, to secure, examine or submit bid/proposal documents, vendor pre-qualification and other forms; specifications/blueprints; other information; and for opening and reading of bids at date and time specified above.
 Health and Mental Hygiene, 93 Worth Street, Room 812,
 New York, NY 10013. Huguette Beauport (212) 219-5883,
 fax: (212) 219-5890, hbeaupor@health.nyc.gov

o1-m21

HOMELESS SERVICES

OFFICE OF CONTRACTS AND PROCUREMENT
SOLICITATIONS

Human / Client Services

CORRECTION: TRANSITIONAL RESIDENCES FOR HOMELESS/ DROP-IN CENTERS – Competitive Sealed Proposals – Judgment required in evaluating proposals - PIN# 071-00S-003-262Z – DUE 06-27-11 AT 10:00 A.M. – CORRECTION: The Department of Homeless Services is soliciting proposals from organizations interested in developing and operating transitional residences for homeless adults and families including the Neighborhood Based Cluster Residence and drop-in centers for adults. This is an open-ended solicitation; there is no due date for submission.

Use the following address unless otherwise specified in notice, to secure, examine or submit bid/proposal documents, vendor pre-qualification and other forms; specifications/blueprints; other information; and for opening and reading of bids at date and time specified above.
 Department of Homeless Services, 33 Beaver Street,
 13th Floor, New York, NY 10004.
 Marta Zmoira (212) 361-0888, mzmoira@dhs.nyc.gov

j6-20

HUMAN RESOURCES ADMINISTRATION

INTENT TO AWARD

Human / Client Services

HOME ATTENDANT SERVICES – Negotiated Acquisition/Pre-Qualified List – PIN# 06911H077800 – DUE 02-07-11 AT 5:00 P.M. – For Information Purpose Only

1. Association For Services For the Aged located at 36-36 33rd Street, Long Island City, NY 11106. Contract amount: \$0. City Share - \$15,861,505 (Medicaid Management Information System (MMIS)). PIN: 06911H077801.

2. Barele, Inc. D/B/A Omega Home Health Services, 44 Court Street, Suite 700, Brooklyn, NY 11201. Contract amount: \$0. City Share - \$9,755,167 (MMIS). PIN: 06911H077802.

3. Best Care, Inc. D/B/A All City Care, 300 Hempstead Turnpike, Levittown, NY 11756. Contract amount: \$0. City Share - \$8,204,583 (MMIS). PIN: 06911H077803.

4. Beth Emeth Home Attendant Services, INC., 1080 McDonald Avenue, Brooklyn, NY 11230. Contract amount: \$0. City Share - \$14,340,111 (MMIS). PIN: 06911H077804.

5. Bhrags Home Care, Inc., 444 Thomas Boyland Avenue, Brooklyn, NY 11212. Contract amount: \$0. City Share - \$12,829,133 (MMIS). PIN: 06911H077805.

6. Bushwick Stuyvesant Heights Home Attendant, Inc., 1004 Gates Avenue, Brooklyn, NY 11221. Contract amount: \$0. City share - \$8,959,980 (MMIS). PIN: 06911H077806.

7. Cabs Home Attendant Services, 545 Broadway, Brooklyn, NY 11206 (2 contracts). Contract amounts: \$0. City Share - \$18,965,135 (MMIS). PIN: 06911H077807 and \$8,045,419 (MMIS). PIN: 06911H077808.

8. Chinese American Planning Council Home Attendant Program, 1 York Street, 2nd Floor, New York, NY 10013 (2 contracts). Contract amount: \$0. City Share - \$8,807,294 (MMIS) PIN:06911H077809 and \$22,167,645 (MMIS) PIN: 06911H077830.

9. Community Home Care Referral D/B/A Helping Hands Attendant Services, 3920 13TH Avenue, Bklyn., NY 11218. Contract amount: \$0. City Share - \$13,328,688 (MMIS). PIN: 06911H077810.

10. C.I.D.N.Y. Independent Living Services, Inc., 841 Broadway, New York, NY 10003. Contract amount: \$0. City Share - \$8,134,462 (MMIS). PIN: 06911H077829.

11. Council For Human Service Home Care Services, 2253 Third Avenue, 4th floor, New York, NY 10035. Contract amount: \$0. City Share - \$8,668,187. PIN: 06911H077831.

12. F.E.G.S. Home Attendant Services, Inc., 240 East 123rd Street, New York, NY 10035. Contract amount: \$0. City Share - \$14,001,648 (MMIS). PIN: 06911H077832.

13. Family Home Care Services of Brooklyn and Queens, Inc., 168 Seventh Street Ground Floor, Brooklyn NY 11215 (2 contracts). Contract amounts: \$0. City Share - \$23,607,581 (MMIS); PIN: 06911H077811 and 241 37th Street, Brooklyn NY 11232 - \$7,784,715 (MMIS); PIN: 06911H077840.

14. First Chinese Presbyterian Community Affairs Home Attendant Corp., 121 Avenue of the Americas, Suite 504, New York, NY 10013. Contract amount: \$0. City Share - \$23,266,623 (MMIS); PIN: 06911H077833.

15. Home Attendant Services of Hyde Park, 1273 53rd Street, Bklyn., NY 11219. Contract amount: \$0. City Share - \$15,865,949 (MMIS); PIN: 06911H077813.

16. Home Attendant Vendor Agency, 3036B Nostrand Avenue, Bklyn., 11229. Contract amount: \$0. City Share - \$19,331,526 (MMIS); PIN: 06911H077814.

17. Home Care Services for Independent Living, 2044 Ocean Avenue, Bklyn., NY 11230. Contract amount: \$0. City Share - \$21,123,449 (MMIS); PIN: 06911H077815.

18. Home Health Management Services, 30 Broad Street, 12th Floor, New York, NY 10004. Contract amount: \$0. City Share - \$21,302,817 (MMIS). PIN: 06911H077834.

19. Home Services Sisetms, Inc., 32-75 Steinway Street, Astoria, NY 11103 (2 contracts). Contract amounts: \$0. City Share - \$11,721,615 (MMIS); PIN: 06911H077812 and \$23,225,809 (MMIS); PIN: 06911H077841.

20. Human Development Association, Inc., 12 Heyward Street, Bklyn., NY 11211. Contract amount: \$0. City Share - \$21,646,442 (MMIS); PIN: 06911H077816.

21. Jewish Community Council Services Commission, Inc., 80 Maiden Lane, 10th floor, Kew Gardens, NY 11415. Contract amount: \$0. City Share - \$13,552,367 (MMIS); PIN: 06911H077842.

22. Mobilization for Youth Health Services, Inc., 199 Avenue B, New York, NY 10009. Contract amount: \$0. City Share - \$7,901,053 (MMIS); PIN: 06911H077835.

23. New York Foundation for Citizens Home Attendant Services, Inc., 11 Park Place, Suite 1416, New York, NY 10007. Contract amount: \$0. City Share - \$14,223,489 (MMIS); PIN: 06911H077836.

24. North General Home Attendant Corp., 205 East 122nd Street, New York, NY 10035. Contract amount: \$0. City Share - \$9,264,036 (MMIS); PIN: 06911H077837.

25. People Care, Inc., 116 West 32nd Street, 15th Floor, New York, NY 10001 (3 contracts). Contract amount: \$0. City Share - \$6,101,914 (MMIS); PIN: 06911H077838; \$3,546,380 (MMIS) PIN: 06911H077843; \$6,716,780 (MMIS) PIN: 06911H077819.

26. Personal Touch Home Care, Inc., 186-18 Hillside Avenue, Jamaica, NY 11432. Contract amount: \$0. City Share - \$12,603,675 (MMIS); PIN: 06911H077820.

27. Pomonok Home Services, Inc., 61-17 190th Street, Fresh Meadows, NY 11365. Contract amount: \$0. City Share - \$15,122,725 (MMIS); PIN: 06911H077844.

28. Premier Home Health Care Services, Inc. D/B/A First Aide Home Care, 360 Hamilton Avenue, White Plains, NY 10601. Contract amount: \$0. City Share - \$7,544,700 (MMIS) PIN: 06911H077821.

29. Prestige Home Attendant, Inc., D/B/A All Season Home Attendant, 377 Broadway, 2nd Floor, New York, NY 10013 (2 contracts). Contract amounts: \$0. City Share - \$10,414,984 (MMIS); PIN: 06911H077822 and \$9,612,657 (MMIS), PIN: 06911H077845.

30. Progressive Home Health Services, 132 West 31 Street, 7th Floor, New York, NY 10001. Contract amount: \$0. City Share - \$10,842,774 (MMIS); PIN: 06911H077817.

31. Project O.H.R., Inc. (Office of Home Care Referral), 80 Maiden Lane, 10th Floor, New York, NY 10038. Contract amount: \$0. City Share - \$28,228,011 (MMIS); PIN: 06911H077823.

32. Ridgewood Bushwick Senior Citizens Council, 533 Bushwick Avenue, Bklyn., NY 11206 (2 contracts) Contract amounts: \$0. City Share - \$15,683,312 (MMIS); PIN: 06911H077824 and \$8,158,889 (MMIS); PIN: 06911H077846.

33. Rockaway Home Attendant Services, Inc., 1603 Central Avenue, Far Rockaway, NY 11691. Contract amount: \$0. City Share - \$10,485,744 (MMIS), PIN: 06911H077847.

34. Services for the Aged, 36-36 33rd Street, Long Island City, NY 11106. Contract amount: \$0. City Share - \$7,093,329 (MMIS), PIN: 06911H077848.

35. St. Nicholas Human Support Corp., 2 Kingsland Avenue, Bklyn., NY 11211. Contract amount: \$0. City Share - \$15,471,405 (MMIS), PIN: 06911H077826.

36. Stella Orton Home Care Agency, 3155 Amboy Road, Staten Island, NY 10306. Contract amount: \$0. City Share - \$20,418,734 (MMIS), PIN: 06911H077852.

37. Sunnywide Home Care Agency, 4331 39th Street, Sunnyside, NY 11104. Contract amount: \$0. City Share - \$16,005,117 (MMIS), PIN: 06911H077850.

38. United Jewish Council of the East Side Home Attendant Services, 500A Grand Street, New York, NY 10002. Contract amount: \$0. City Share - \$19,463,011 (MMIS), PIN: 06911H077839.

39. VIP Health Care Services, Inc., 116-12 Myrtle Avenue, Richmond Hill, NY 11418 (2 contracts). Contract amounts: \$0. City Share - \$6,629,671 (MMIS), PIN: 06911H077828 and \$4,627,051 (MMIS), PIN: 06911H077851.

40. P.S.C. Community Services, Inc., 120 Jewel Street, Bklyn., NY 11222. Contract amount: \$0. City Share - \$14,310,308 (MMIS). PIN: 06911H077818.

41. Services for the Underserved Home Attendant Program, Inc., 305 Seventh Avenue, 10th Floor, New York, NY 10001. Contract amount: \$0. City Share - \$10,296,654 (MMIS), PIN: 06911H077827.

42. Social Concern Community Development Corp., 226-18 Merick Boulevard, Laurelton, NY 11413. Contract amount: \$0. City Share - \$9,932,244 (MMIS), PIN: 06911H077849.

43. School Settlement Home Attendant Service Corp., 357 Manhattan Avenue, Brooklyn, NY 11211. Contract amount: \$0. City Share - \$15,162,788 (MMIS), PIN: 06911H077825.

The Human Resources Administration (HRA/Home Care Services Program (HCSP) plans to enter into negotiations with the organizations that currently provide Home Attendant Services to Medicaid-Eligible Individuals in the boroughs of Manhattan, Queens, Brooklyn, and Staten Island to allow these contractors to continue to provide these critical services until new contracts are in place. It is anticipated that the contract term will be from 1/1/2011 to 6/30/2011.

Organizations interested in responding to a future solicitation for these services are invited to do so by filling with the new York City Vendor Enrollment application, on line www.nyc.gov/selltonyc.

Use the following address unless otherwise specified in notice, to secure, examine or submit bid/proposal documents, vendor pre-qualification and other forms; specifications/blueprints; other information; and for opening and reading of bids at date and time specified above.
Human Resources Administration, 80 Water Street, New York, NY 10038. Sharon Webley (212) 331-3448, webleys@hra.nyc.gov

j27-f2

CONTRACTS**■ INTENT TO AWARD***Human / Client Services*

EMERGENCY SHELTER SERVICES – Negotiated Acquisition – DUE 02-07-11 AT 5:00 P.M. – The contract term for the vendors listed below: 03/01/11-02/29/12

Jewish Board of Family and Children's Services, Inc. 135 West 50th Street, 6th Floor, New York, NY 10020 E-PIN# 06909X0009CNVN002

Center for the Elimination of Violence In the Family, Inc. 25 Chapel Street, Suite 904, Brooklyn, NY 11201 E-PIN# 06909X0008CNVN004

Volunteers of America-Greater New York, Inc. 340 West 85th Street, New York, NY 10024 E-PIN# 06909X0015CNVN002

H.E.L.P. Social Services Corporation 5 Hanover Square, 17th Floor, New York, NY 10004 E-PIN# 06909X0016CNVN002

The Human Resources Administration (HRA/Office of Domestic Violence and Emergency Intervention Services) intends to use the Negotiated Acquisition Extension process due to the compelling need to continue critical services. The extension will allow the vendors to continue to provide Emergency Shelter Services for Victims of Domestic Violence until new contracts are in place. It is anticipated that the contract term will be from March 1, 2011 to February 29, 2012.

Organizations interested in responding to a future solicitation for these services are invited to do so by calling the New York Vendor Enrollment Center at (212) 857-1680 to request an application or fill out one on-line by visiting www.nyc.gov/selltonyc.

THIS NOTICE IS FOR INFORMATIONAL PURPOSES ONLY.

Use the following address unless otherwise specified in notice, to secure, examine or submit bid/proposal documents, vendor pre-qualification and other forms; specifications/blueprints; other information; and for opening and reading of bids at date and time specified above.
Human Resources Administrative, 180 Water Street, 24th Fl., New York, NY 10038. Vivian Williams (212) 331-4587, williamsv@hra.nyc.gov

j28

Services (Other Than Human Services)

SECURITY GUARD SERVICES – Negotiated Acquisition – Available only from a single source - PIN# 069-11-110-0030 – DUE 02-11-11 AT 3:00 P.M. – The contract term for the vendor listed below: May 1, 2011 to April 30, 2012.

FJC Security Services, Inc. 275 Jericho Turnpike Floral Park, NY 11001 EPIN: 06906B0007CNVN002

This notice is for informational purposes only

Any vendor who believes they can also provide services for such procurement in the future is invited to call the NYC Vendor Enrollment Center at (212) 857-1680 to request an application or may complete the application on-line by visiting www.nyc.gov/selltonyc. If you have any questions, you may also contact Ms. Donna Wilson in writing at the below address.

Use the following address unless otherwise specified in notice, to secure, examine or submit bid/proposal documents, vendor pre-qualification and other forms; specifications/blueprints; other information; and for opening and reading of bids at date and time specified above.
Human Resources Administration, 180 Water Street, 14th Floor, New York, NY 10038. Donna Wilson (212) 331-4843, fax: (212) 331-3457, wilsond@hra.nyc.gov

j28-f3

JUVENILE JUSTICE**■ SOLICITATIONS***Human / Client Services*

PROVISION OF NON-SECURE DETENTION GROUP HOMES – Negotiated Acquisition – Judgment required in evaluating proposals - PIN# 13010DJJ000 – DUE 06-30-11 AT 5:00 P.M. – ACS Division of Youth and Family Justice is soliciting applications from organizations interested in operating non-secure detention group homes in New York City. This is an open-ended solicitation; applications will be accepted on a rolling basis until 5:00 P.M. on 6/30/11.

Use the following address unless otherwise specified in notice, to secure, examine or submit bid/proposal documents, vendor pre-qualification and other forms; specifications/blueprints; other information; and for opening and reading of bids at date and time specified above.
Department of Juvenile Justice, 150 William Street, 9th Floor, New York, NY 10038. Patricia Chabla (212) 341-3505, fax: (212) 341-3625, Patricia.chabla@djj.state.ny.us

d15-j29

PARKS AND RECREATION**CONTRACT ADMINISTRATION****■ AWARDS***Construction / Construction Services*

PLANTING OF NEW AND REPLACEMENT STREET TREES – Competitive Sealed Bids – PIN# 8462010X000C07 – AMT: \$973,000.00 – TO: Mana Construction Group, 1150 Shames Drive, Westbury, NY 11590. In Community Boards 1-9, The Bronx, known as Contract #XG-910M.

j28

REVENUE AND CONCESSIONS**■ SOLICITATIONS***Services (Other Than Human Services)*

RENOVATION, OPERATION AND MAINTENANCE OF A CAFE – Competitive Sealed Proposals – Judgment required in evaluating proposals - PIN# M124-SB – DUE 03-04-11 AT 3:00 P.M. – At First Park in Manhattan. There will be a recommended site visit on Wednesday, February 9, 2011 at 3:00 P.M. We will be meeting at the snack bar entrance, which is located on East Houston Street, at First Park in Manhattan. If you are considering responding to this RFP, please make every effort to attend this recommended site visit.

TELECOMMUNICATION DEVICE FOR THE DEAF (TDD) 212-504-4115

Use the following address unless otherwise specified in notice, to secure, examine or submit bid/proposal documents, vendor pre-qualification and other forms; specifications/blueprints; other information; and for opening and reading of bids at date and time specified above.

Park and Recreation, The Arsenal-Central Park, 830 Fifth Avenue, Room 407, New York, NY 10021. Charlotte Hall (212) 360-1397, fax: (212) 360-3434, charlotte.hall@parks.nyc.gov

j25-f7

RENOVATION, OPERATION AND MAINTENANCE OF A HIGH-QUALITY RESTAURANT, CATERING FACILITY, AND SNACK BAR – Competitive Sealed Proposals – Judgment required in evaluating proposals - PIN# R104-R – DUE 03-17-11 AT 3:00 P.M. – At South Shore Golf Course, Staten Island. There will be a recommended proposer meeting on Tuesday, February 15, 2011 at 11:00 A.M. at the proposed concession site, which is located between the West Shore Expressway and Alverton Avenue, off Huguenot Avenue, Staten Island. We will be meeting in front of the current restaurant. If you

are considering responding to this RFP, please make every effort to attend this recommended meeting. Parks will arrange site tours with potential proposers by appointment. TELECOMMUNICATION DEVICE FOR THE DEAF (TDD) 212-504-4115

Use the following address unless otherwise specified in notice, to secure, examine or submit bid/proposal documents, vendor pre-qualification and other forms; specifications/blueprints; other information; and for opening and reading of bids at date and time specified above.
Parks and Recreation, The Arsenal-Central Park, 830 Fifth Avenue, Room 407, New York, NY 10021. Davita Mabourakh (212) 360-1397, fax: (212) 360-3434, davita.mabourakh@parks.nyc.gov

j24-f4

SALE OF NATIVE AMERICAN CUISINE FROM A MOBILE FOOD UNIT – Competitive Sealed Proposals – Judgment required in evaluating proposals - PIN# M7-2-CG-2011 – DUE 02-25-11 AT 3:00 P.M. – At Bowling Green, Manhattan.

TELECOMMUNICATION DEVICE FOR THE DEAF (TDD) 212-504-4115

Use the following address unless otherwise specified in notice, to secure, examine or submit bid/proposal documents, vendor pre-qualification and other forms; specifications/blueprints; other information; and for opening and reading of bids at date and time specified above.

Parks and Recreation, The Arsenal-Central Park, 830 Fifth Avenue, Room 407, New York, NY 10021. Rachel Aland (212) 360-1397, fax: (212) 360-3434, rachel.aland@parks.nyc.gov

j19-f1

SCHOOL CONSTRUCTION AUTHORITY**CONTRACT ADMINISTRATION****■ SOLICITATIONS***Services (Other Than Human Services)*

HR SCA-WIDE CIVIL SERVICE TESTING SERVICES – Request for Proposals – RFP# 11-00047R – DUE 02-14-11 AT 2:00 P.M. – Please see attachment in “City Record Online” for additional details.

Use the following address unless otherwise specified in notice, to secure, examine or submit bid/proposal documents, vendor pre-qualification and other forms; specifications/blueprints; other information; and for opening and reading of bids at date and time specified above.
School Construction Authority, 30-30 Thomson Avenue, 1st Floor, Long Island City, New York 11101. Nacardie Louis (718) 752-5851, fax: (718) 752-2851, nlouis@nyscsca.org

j28

SMALL BUSINESS SERVICES**PROCUREMENT****■ SOLICITATIONS***Services (Other Than Human Services)*

FASTTRAC PROGRAM SERVICES – Request for Proposals – PIN# 801SBS110006 – DUE 03-07-11 AT 3:00 P.M. – FastTrac courses provide participants access to one-on-one assistance and interactive presentations from experienced entrepreneurs and connect them to business assistance services to improve their chances of success in the economic climate. The main objective of FastTrac is to help aspiring entrepreneurs and existing businesses hone the skills needed to start, manage and grow a successful business in the current economy. There are two FastTrac courses for entrepreneurs that are offered at no cost to New Yorkers: FastTrac NewVenture and FastTrac GrowthVenture.

NYC Department of Small Business Services is seeking appropriately qualified vendors to directly manage the day to day aspects of the FastTrac program: marketing and outreach, recruitment and management of Facilitators and Business Coaches, recruitment and management of guest speakers, classroom space, participant registration, budget, class logistics, reporting and evaluating program performance, alumni communication and networking, and coordination with NYC Business Solutions.

This solicitation is being issued pursuant to New York City Procurement Policy Board Rules, in accordance with Section 3-03, Competitive Sealed Proposals.

RFP package may be downloaded from the SBS website at www.nyc.gov/sbs, or obtained in person at the NYC Department of Small Business Services, Procurement Unit, 110 William Street, 7th Fl., New York, NY 10038, Monday through Friday, between the hours of 9:00 A.M. to 5:00 P.M., excluding holidays and weekends, beginning on January 25, 2011 and continuing until March 7, 2011.

A pre-proposal conference for interested applicants will be held on February 8, 2011 from 3:00 P.M. - 5:00 P.M., at 110 William Street, 4th Fl., EDC Conference Room, New York, NY 10038. Space constraints limit attendance to two persons per proposing organization (attendance need not be confirmed). All questions regarding this solicitation shall be due no later than 12:00 P.M. on February 11, 2011.

The original and four (4) copies of the complete proposal and all attachments must be hand-delivered or sent through certified mail to the address listed in the RFP, no later than 3:00 P.M., on March 7, 2011. Proposals received after the due date and time are late and shall not be accepted by the Agency, except as provided under New York City's Procurement Policy Board Rules.

Use the following address unless otherwise specified in notice, to secure, examine or submit bid/proposal documents, vendor pre-qualification and other forms; specifications/blueprints; other information; and for opening and reading of bids at date and time specified above.
Department of Small Business Services, 110 William Street, 7th Floor, New York, NY 10038. Daryl Williams (212) 618-8731, fax: (212) 618-8867, procurementhelpdesk@sbs.nyc.gov

j25-31

CITY-WIDE ECONOMIC DEVELOPMENT SERVICES TO PROMOTE AND ENCOURAGE TOURISM IN THE CITY OF NEW YORK – Sole Source – Available only from a single source - PIN# 801SBS110096 – DUE 02-11-11 AT 2:00 P.M. – The Department of Small Business Services intends to enter into sole source negotiations to acquire services to promote and encourage tourism in the City of New York and city-wide marketing, tourism, and licensing services from the NYC and Company, Inc. Any firm that believes it is qualified and has the in-house expertise to provide such services or would like to provide such services in the future is invited to do so. Please indicate our interest by letter, which must be received no later than February 11, 2011, 2:00 P.M. to Mr. Daryl Williams, Agency Chief Contracting Officer, NYC Department of Small Business Services, 110 William Street, 7th Floor, New York, New York 10038.

Use the following address unless otherwise specified in notice, to secure, examine or submit bid/proposal documents, vendor pre-qualification and other forms; specifications/blueprints; other information; and for opening and reading of bids at date and time specified above.
Department of Small Business Services, 110 William Street, 7th Floor, New York, NY 10038.
Daryl Williams (212) 618-8731, fax: (212) 618-8867, dwilliams@qsbs.nyc.gov

j24-28

TRANSPORTATION

SOLICITATIONS

Services (Other Than Human Services)

DISPOSAL SERVICES FOR CONSTRUCTION WASTE MATERIAL – Competitive Sealed Bids – PIN# 84110MBSM522 – DUE 03-10-11 AT 11:00 A.M. – Contract available during the hours of 9:00 A.M. - 3:00 P.M. ONLY. Transportation and Disposal Services for construction waste material generated by Citywide Concrete Program. A pre-bid meeting (optional) will be held on Tuesday, February 15, 2011 at 1:00 P.M. at 55 Water Street, Ground Floor Conference Room, New York, NY 10041. A deposit of \$50.00 in the form of a certified check or money order made payable to New York City Department of Transportation is required to obtain Contract/Bid Documents. NO CASH ACCEPTED. Refund will be made only for Contract/Bid Proposal Documents that are returned in its original condition within 10 days after bid opening. Any persons delivering bid documents must enter the building located on the south side of the Building facing the Vietnam Veterans Memorial. All visitors must go through the building's security screening process. Bidders should allow extra time and ensure that proper government issued photo identification (ie. Drivers License, Passport, Identification card) is available upon request. Please ensure that your company's address, telephone and fax numbers are submitted by your company (or messenger service) when picking up contract documents. For additional information please contact Mark Connelly at (212) 839-4334. Vendor Source ID#: 72558.

Use the following address unless otherwise specified in notice, to secure, examine or submit bid/proposal documents, vendor pre-qualification and other forms; specifications/blueprints; other information; and for opening and reading of bids at date and time specified above.
Department of Transportation, Contract Management Unit, Office of the Agency Chief Contracting Officer, 55 Water Street, Ground Floor, New York, NY 10041. Bid Window (212) 839-9435.

j28

INTENT TO AWARD

Goods & Services

MAINTENANCE AND REPAIR SERVICES ON RICOH COPIERS – Sole Source – Available only from a single source - PIN# 84111MBAD564 – DUE 02-07-11 AT 5:00 P.M. – The Department of Transportation intends to enter into a one year Sole Source Maintenance and Repair Agreement with three one year options to renew for the fleet of Ricoh Copiers at 55 Water Street. The Ricoh Copier fleet includes two models of multifunction copiers manufactured by Ricoh of America (Ricoh) totaling seventy-five (75) copiers. DOT IT and Telecom are requesting the procurement of continued service from a licensed Ricoh service provider to guarantee timely maintenance and repairs of its fifteen (15) AFICIO MPC 5000 and sixty (60) AFICIO MP6000 copiers. Use of another company's services would possibly void the system warranty if non-authorized technicians were to perform servicing on the system. Any firm which believes that it can also provide these services given the specified limitations is invited to so indicate by letter, which must be received no later than 5:00 P.M. on February 7, 2011 to the attention of Nancy Carolan, Agency Chief Contracting Officer, 55 Water Street, 8th Floor, NY, NY 10041, or email ncarolan@dot.nyc.gov

Use the following address unless otherwise specified in notice, to secure, examine or submit bid/proposal documents, vendor pre-qualification and other forms; specifications/blueprints; other information; and for opening and reading of bids at date and time specified above.
Department of Transportation, 55 Water Street, 8th Floor, NY, NY 10041. Nancy Carolan, Agency Chief Contracting Officer, (212) 839-9292, ncarolan@dot.nyc.gov

j24-28

PURCHASE REPLACEMENT GRANITE

COBBLESTONES – Sole Source – Available only from a single source - PIN# 84111MBSM565 – DUE 02-07-11 AT 5:00 P.M. – The Department of Transportation's Citywide Concrete Program within the Division of Sidewalk and Inspection Management intends to enter into a one year contract with three one year options to renew. Sole Source Agreement to purchase replacement granite cobblestones for use in pedestrian crosswalks within cobblestone roadways. The products is both ADA compliant as well as faster and easier to install than other products on the market made of pre-cast concrete or other man-made materials which are more prone to breakage. Eurocobble modular units are the only solid granite products of this type which is available. Modular granite cobblestones are the most durable product available to support and sustain heavy commercial vehicle loads compounded by heavy traffic volumes typical of New York City's busy roadways.

The Division requires pavers of solid granite cut to approximately 4"x4"x2". The pavers are typically set in a bed of grout or mortar with the top half of the joints empty so as to allow them to be filled after placement in the roadway. Any firm which believes that it can also provide this product, given the specified limitations, is invited to so indicate by letter, which must be received no later than 5:00 P.M. on February 7, 2011 to the attention of Nancy Carolan, Agency Chief Contracting Officer, 55 Water Street, 8th Floor, NY, NY 10041, or email mcarolan@dot.nyc.gov

Use the following address unless otherwise specified in notice, to secure, examine or submit bid/proposal documents, vendor pre-qualification and other forms; specifications/blueprints; other information; and for opening and reading of bids at date and time specified above.
Department of Transportation, 55 Water Street, 8th Floor, NY, NY 10041. Nancy Carolan, Agency Chief Contracting Officer, (212) 839-9292, ncarolan@dot.nyc.gov

j24-28

TRIBOROUGH BRIDGE & TUNNEL AUTHORITY

SOLICITATIONS

Goods

CARBON MONOXIDE MONITORING AND RECORDING EQUIPMENT – Competitive Sealed Bids – PIN# OP1455000000 – DUE 02-16-11 AT 3:00 P.M.

Use the following address unless otherwise specified in notice, to secure, examine or submit bid/proposal documents, vendor pre-qualification and other forms; specifications/blueprints; other information; and for opening and reading of bids at date and time specified above.
Triborough Bridge and Tunnel Authority, 3 Stone Street, Bid Suite, New York, NY 10004.
Victoria Warren (646) 252-6101, fax: (646) 252-6108, vprocure@mtabt.org

j28

AGENCY PUBLIC HEARINGS ON CONTRACT AWARDS

NOTE: Individuals requesting Sign Language Interpreters should contact the Mayor's Office of Contract Services, Public Hearings Unit, 253 Broadway, 9th Floor, New York, N.Y. 10007, (212) 788-7490, no later than SEVEN (7) BUSINESS DAYS PRIOR TO THE PUBLIC HEARING. TDD users should call Verizon relay services.

HUMAN RESOURCES ADMINISTRATION

PUBLIC HEARINGS

NOTICE IS HEREBY GIVEN that a Contract Public Hearing will be held on Thursday, February 10, 2011 at the Human Resources Administration of the City of New York, 180 Water Street, 12th Floor, Borough of Manhattan, commencing at 10:00 a.m. on the following:

IN THE MATTER of one (1) proposed contract between the Human Resources Administration of the City of New York and the vendor listed below for the Provision of Transitional Congregate Housing and Supportive Services for Persons Living with AIDS or Advanced HIV Illness. The term of this contract will be for four (4) months from November 1, 2010 to March 31, 2011.

Contractor/Address

Comunilife, Inc.
214 West 29th St., 8th Fl., New York, New York 10001

E-PIN 06904X0017CNVN002 **Amount** \$540,196.00
Service Area Manhattan

The proposed contractor has been selected by means of the Negotiated Acquisition Extension method pursuant to Section 3-04(b)(2)(iii) of the Procurement Policy Board Rules.

A draft copy of the proposed contract is available for public inspection at the Human Resources Administration of the City of New York, 180 Water Street, Room 1420, New York, N.Y. 10038 on business days, from January 28, 2011 to February 10, 2011, excluding holidays and weekends, from 10:00 A.M. to 4:00 P.M.

IN THE MATTER of one (1) proposed contract between the Human Resources Administration of the City of New York and the vendor listed below for the Provision of Permanent Congregate Housing and Supportive Services for Persons Living with AIDS or Advanced HIV Illness. The term of this contract will be for one (1) year from January 1, 2011 to December 31, 2011.

Contractor/Address

Flemister Housing Development Fund Corporation
527 West 22nd Street, New York, New York 10011

E-PIN 06905X0002CNVN001 **Amount** \$1,378,370.00
Service Area Manhattan

The proposed contractor has been selected by means of the Negotiated Acquisition Extension method pursuant to Section 3-04(b)(2)(iii) of the Procurement Policy Board Rules.

A draft copy of the proposed contract is available for public inspection at the Human Resources Administration of the City of New York, 180 Water Street, Room 1420, New York, N.Y. 10038 on business days, from January 28, 2011 to February 10, 2011, excluding holidays and weekends, from 10:00 A.M. to 4:00 P.M.

j28

NOTICE IS HEREBY GIVEN that a Contract Public Hearing will be held on Thursday, February 10, 2011, at the Human Resources Administration of the City of New York, 180 Water Street, 12th Floor, Borough of Manhattan, commencing at 10:00 A.M. on the following:

IN THE MATTER of two (2) proposed contracts between the Human Resources Administration of the City of New York and the vendors listed below for the provision of Consumer Directed Personal Assistance Services to Medicaid Eligible Individuals. The contract term shall be from March 1, 2011 to February 29, 2012.

Contractor/Address

1. Concepts of Independence, Inc.
120 Wall Street, Suite 1010, New York, NY 10005

PIN 06911H076901
Contract Amount \$0.City Share - \$73,301,302(*MMIS)
Service Area Citywide

2. Chinese American Planning Council Home Attendant Program, 1 York Street, 2nd Floor, New York, NY 10013

PIN 06911H076902
Contract Amount \$0.City Share - \$36,632,975(*MMIS)
Service Area Citywide

*Medicaid Management Information System

The proposed contractors have been selected by means of the Negotiated Acquisition Extension method pursuant to Section 3-04(b)(2)(iii) of the Procurement Policy Board Rules.

Draft copies of the proposed contracts are available for public inspection at the Human Resources Administration of the City of New York, 180 Water Street, 14th Floor, Room 1420, New York, N.Y. 10038 on business days, from January 28, 2011 to February 10, 2011, excluding holidays, from 10:00 A.M. to 5:00 P.M.

IN THE MATTER of fifty two (52) proposed contracts between the Human Resources Administration of the City of New York and the vendors listed below for the provision of Home Attendant Services to Medicaid Eligible Individuals in the Boroughs of Manhattan, Queens, Brooklyn and Staten Island. The contract term shall be from January 1, 2011 to June 30, 2011.

Contractor/Address

1. Association For the Services for the Aged
36-36 33rd Street, Long Island City, NY 11106

PIN# 06911H077801
Contract Amount \$0.City Share - \$15,861,505(*MMIS)

2. Barele, Inc. d/b/a OMEGA Home Health Services
44 Court Street, Suite 700, Brooklyn, NY 11201

PIN# 06911H077802
Contract Amount \$0.City Share - \$9,755,167(*MMIS)

3. Best Care, Inc. (All City Care)
3000 Hempstead Turnpike, Levittown, NY 11756

PIN# 06911H077803
Contract Amount \$0.City Share - \$8,204,583(*MMIS)

4. Beth Emeth Home Attendant Services, Inc.
1080 McDonald Avenue, Brooklyn, NY 11230

PIN# 06911H077804
Contract Amount \$0.City Share - \$14,340,110(*MMIS)

5. BHRAGS Home Care Inc.
444 Thomas Boyland Ave., Brooklyn, NY 11212

PIN# 06911H077805
Contract Amount \$0.City Share - \$12,829,133(*MMIS)

6. Bushwick Stuyvesant Heights Home Attendant, Inc.
1004 Gates Avenue, Brooklyn, NY 11221

PIN# 06911H077806
Contract Amount \$0.City Share - \$8,959,980(*MMIS)

7. CABS Home Attendant Service
44 Varet Street, Brooklyn, NY 11206

PIN# 06911H077807
Contract Amount \$0.City Share - \$18,965,135(*MMIS)

8. CABS Home Attendant Service
44 Varet Street, Brooklyn, NY 11206

PIN# 06911H077808
Contract Amount \$0.City Share - \$8,045,419 (*MMIS)

9. Chinese American Planning Council HA Program
One York Street, 2nd Floor, New York, NY 10013

PIN# 06911H077809
Contract Amount \$0.City Share - \$8,807,294 (*MMIS)

10. Community Home Care Referral D/B/A Helping Hands Attendant Services, 3920 13th Avenue, Brooklyn, NY 11218

PIN# 06911H077810
Contract Amount \$0.City Share - \$ 13,328,688(*MMIS)

11. Family Home Care Services of Brooklyn & Queens, Inc.
168 Seventh St. Ground Fl., Brooklyn, NY 11215

PIN# 06911H077811
Contract Amount \$0.City Share - \$23,607,581(*MMIS)

12. Home Services Systems, Inc.
32-75 Steinway Street, Astoria, NY 11103

PIN# 06911H077812
Contract Amount \$0.City Share - \$11,721,615(*MMIS)

13. Home Attendant Services of Hyde Park
1273 53rd Street, Brooklyn, NY 11219

PIN# 06911H077813
Contract Amount \$0.City Share - \$15,865,949(*MMIS)

14. Home Attendant Vendor Agency
3036B Nostrand Avenue, Brooklyn, NY 11229

PIN# 06911H077814
Contract Amount \$0.City Share - \$19,331,526(*MMIS)

15. Home Care Services for Independent Living
2044 Ocean Avenue, Suite 4-B, Brooklyn, NY 11230

PIN# 06911H077815
Contract Amount \$0.City Share - \$21,123,449(*MMIS)

16. Human Development Association, Inc.
12 Heyward Street, Brooklyn, NY 11211

PIN# 06911H077816
Contract Amount \$0.City Share - \$ 21,646,442(*MMIS)

17. Progressive Home Health Services
132 West 31st Street, Fl. 7, New York, NY 10001

PIN# 06911H077817
Contract Amount \$0.City Share - \$10,842,774(*MMIS)

18. P.S.C. Community Services, Inc.
120 Jewel St., 2nd Floor, Brooklyn, NY 11222

- PIN# 06911H077818**
Contract Amount \$0.City Share - \$ 14,310,308(*MMIS)
19. People Care, Inc. D/B/A Assisted Care
116 West 32nd Street, 14th Floor, New York, NY 10001
- PIN# 06911H077819**
Contract Amount \$0.City Share - \$ 6,716,780(*MMIS)
20. Personal Touch Home Care of N.Y., Inc.
186-18 Hillside Avenue, Jamaica, NY 11432
- PIN# 06911H077820**
Contract Amount \$0.City Share - \$ 12,603,675 (*MMIS)
21. Premier Home Health Care of N.Y., Inc
360 Hamilton Ave., White Plains, NY 10601
- PIN# 06911H077821**
Contract Amount \$0.City Share - \$7,544,700 (*MMIS)
22. Prestige Home Attendant, Inc. D/B/A all Season Home Attendant, 377 Broadway, 2nd Floor (Front) New York, NY 10013
- PIN# 06911H077822**
Contract Amount \$0.City Share - \$10,414,984(*MMIS)
23. Project O.H.R., Inc. (Office of HC Referral)
80 Maiden Lane, 10th Floor, New York, NY 10038
- PIN# 06911H077823**
Contract Amount \$0.City Share - \$28,228,011(*MMIS)
24. Ridgewood Bushwick Senior Citizens Council
533 Bushwick Avenue, Brooklyn, NY 11206
- PIN# 06911H077824**
Contract Amount \$0.City Share - \$15,683,312(*MMIS)
25. School Settlement Home Attendant Service Corp.
357 Manhattan Avenue, Brooklyn, NY 11211
- PIN# 06911H077825**
Contract Amount \$0.City Share - \$15,162,788 (*MMIS)
26. St. Nicholas Human Support Corp.
2 Kingsland Ave., Brooklyn, NY 11211
- PIN# 06911H077826**
Contract Amount \$0.City Share - \$15,471,405(*MMIS)
27. Services for the Underserved Home Attendant Program, Inc.
305 7th Ave., New York, N.Y. 10001
- PIN# 06911H077827**
Contract Amount \$0.City Share - \$10,296,654(*MMIS)
28. VIP Health Care Services
116-12 Myrtle Avenue, Richmond Hill, NY 11418
- PIN# 06911H077828**
Contract Amount \$0.City Share - \$6,629,671(*MMIS)
29. C.I.D. N. Y. Independent Living Services Inc.
841 Broadway, New York, NY 10003,
- PIN# 06911H077829**
Contract Amount \$0.City Share - \$8,134,462(*MMIS)
30. Chinese American Planning Council Home Attendant Program, Inc., One York Street, 2nd Floor, New York, NY 10013
- PIN# 06911H077830**
Contract Amount \$0.City Share - \$22,167,645(*MMIS)
31. Council for Human Services Home Care Services, Corp.
253 Third Avenue, 4th Floor, New York, NY 10035
- PIN# 06911H077831**
Contract Amount \$0.City Share - \$8,668,187(*MMIS)
32. FECS Home Attendant Services, Inc.
424 East 147th Street 4th Floor, Bronx, NY 10455
- PIN# 06911H077832**
Contract Amount \$0.City Share - \$14,001,648(*MMIS)
33. First Chinese Presbyterian Community Affairs Home Attendant Corp., 121 Avenue of the Americas Suite 504, New York, NY 10013
- PIN# 06911H077833**
Contract Amount \$0.City Share - \$23,266,623(*MMIS)
34. Home Health Management Services
30 Broad Street, 12th Floor, New York, NY 10004
- PIN# 06911H077834**
Contract Amount \$0.City Share - \$21,302,817(*MMIS)
35. Mobilization for Youth Health Services, Inc.
199 Avenue B, New York, NY 10009
- PIN# 06911H077835**
Contract Amount \$0.City Share - \$7,901.053(*MMIS)
36. New York Foundation for Citizens Home Attendant Services, Inc., 11 Park Place, Suite 1416 New York, NY 10007
- PIN# 06911H077836**
Contract Amount \$0.City Share - \$14,223,489 (*MMIS)
37. North General Home Attendant Corporation
205 East 122nd Street, New York, NY 10035
- PIN# 06911H077837**
Contract Amount \$0.City Share - \$9,264,036 (*MMIS)
38. People Care Inc. D/B/A Assisted Care
116 West 32nd Street, 14th Floor, New York, NY 10001
- PIN# 06911H077838**
Contract Amount \$0.City Share - \$6,101,914 (*MMIS)
39. United Jewish Council of East Side Home Attendant Services
500a Grand Street, New York, NY 10002
- PIN# 06911H077839**
Contract Amount \$0.City Share - \$19,463,011 (*MMIS)
40. Family Home Care Services of Brooklyn & Queens Inc.
241 37th Street, Brooklyn, NY 11232
- PIN# 06911H077840**
Contract Amount \$0.City Share - \$7,784,715(*MMIS)
41. Home Services Systems, Inc.
3275 Steinway Street, Astoria, NY 11103

- PIN# 06911H077841**
Contract Amount \$0.City Share - \$23,225,809 (*MMIS)
42. Jewish Community Council Services Commission, Inc.
80 Maiden Lane, 10th Floor, Kew Gardens, NY 11415
- PIN# 06911H077842**
Contract Amount \$0.City Share - \$13,552,367 (*MMIS)
43. People Care Inc. D/B/A Assisted Care
116 West 32nd Street, 14th Floor, New York, NY 10001
- PIN# 06911H077843**
Contract Amount \$0.City Share - \$3,546,380 (*MMIS)
44. Pomonok Home Services, Inc.
61-17 190th Street, Fresh Meadows, NY 11365
- PIN# 06911H077844**
Contract Amount \$0.City Share - \$15,122,725(*MMIS)
45. Prestige Home Attendant, Inc D/B/A All Season Home Attendant, 377 Broadway, 2nd Floor (Front) New York, NY 10013
- PIN# 06911H077845**
Contract Amount \$0.City Share - \$9,612,657 (*MMIS)
46. Ridgewood Bushwick Senior Citizens Council
533 Bushwick Avenue, Brooklyn, NY 11206
- PIN# 06911H077846**
Contract Amount \$0.City Share - \$8,158,889(*MMIS)
47. Rockaway Home Attendant Services, Inc.
1603 Central Avenue, Far Rockaway, NY 11691
- PIN# 06911H077847**
Contract Amount \$0.City Share - \$10,485,744(*MMIS)
48. Services for the Aged
36-36 33rd Street, Long Island City, NY 11106

- PIN# 06911H077848**
Contract Amount \$0.City Share - \$7,093,329(*MMIS)
49. Social Concern Community Development Corp.
226-18 Merrick Boulevard, Laurelton, New York 11413
- PIN# 06911H077849**
Contract Amount \$0.City Share - \$9,932,244(*MMIS)
50. Sunnyside Home Care Project, Inc.
4331 39th Street, Sunnyside, NY 11104
- PIN# 06911H077850**
Contract Amount \$0.City Share - \$16,005,117(*MMIS)
51. VIP HC Services
116-12 Myrtle Avenue, Richmond Hill, NY 11418
- PIN# 06911H077851**
Contract Amount \$0.City Share - \$4,627,051(*MMIS)
52. Stella Orton Home Care Agency
3155 Amboy Road, Staten Island, NY 10306
- PIN# 06911H077852**
Contract Amount \$0.City Share - \$20,418,734(*MMIS)
- *Medicaid Management Information System (MMIS)

The proposed contractors have been selected by means of the Negotiated Acquisition Extension method pursuant to Section 3-04(b)(2)(iii) of the Procurement Policy Board Rules.

A copy of the draft contract is available for public inspection at Human Resources Administration, Office of Contracts, 180 Water Street, 14th Floor, Room 1420 Borough of Manhattan, on business days from January 28, 2011 to February 10, 2011, excluding holidays and weekends, between the hours of 10:00 A.M and 4:00 P.M.

☛ j28

SPECIAL MATERIALS

CITYWIDE ADMINISTRATIVE SERVICES

MUNICIPAL SUPPLY SERVICES

■ NOTICE

**OFFICIAL FUEL PRICE SCHEDULE NO. 6613
FUEL OIL AND KEROSENE**

CONTRACT NO.	ITEM NO.	FUEL/OIL TYPE	VENDOR	CHANGE	PRICE EFF. 1/24/2011
2887105	2.0	#1DULS	MANH	SPRAGUE ENERGY CORP +.0412 GAL.	3.2361 GAL.
2887105	3.0	#1DULS	BRONX	SPRAGUE ENERGY CORP +.0412 GAL.	3.2361 GAL.
2887105	4.0	#1DULS	BROOKLYN	SPRAGUE ENERGY CORP +.0412 GAL.	3.2711 GAL.
2887105	5.0	#1DULS	QUEENS	SPRAGUE ENERGY CORP +.0412 GAL.	3.2711 GAL.
2887105	6.0	#1DULS	S.I.	SPRAGUE ENERGY CORP +.0412 GAL.	3.3361 GAL.
2887105	7.0	#1DULS	P/U	SPRAGUE ENERGY CORP +.0412 GAL.	3.1479 GAL.
2887086	3.0	#1DULSB20	CITY WIDE BY TW	SPRAGUE ENERGY CORP +.0366 GAL.	3.3431 GAL.
2887086	7.0	#1DULSB20	P/U	SPRAGUE ENERGY CORP +.0366 GAL.	3.2734 GAL.
2887086	1.0	#1DULSB5	CITY WIDE BY TW	SPRAGUE ENERGY CORP +.0401 GAL.	3.2014 GAL.
2887086	5.0	#1DULSB5	P/U	SPRAGUE ENERGY CORP +.0401 GAL.	3.1194 GAL.
3087064	1.0	#1DULSB50	CITY WIDE BY TW	METRO FUEL OIL CORP. +.0298 GAL.	4.1302 GAL.
2887052	1.0	#2	MANH	RAPID PETROLEUM +.0402 GAL.	2.7177 GAL.
2887052	4.0	#2	BRONX	RAPID PETROLEUM +.0402 GAL.	2.7175 GAL.
2887052	7.0	#2	BROOKLYN	RAPID PETROLEUM +.0402 GAL.	2.7071 GAL.
2887052	13.0	#2	S.I.	RAPID PETROLEUM +.0402 GAL.	2.7506 GAL.
2887053	10.0	#2	QUEENS	METRO FUEL OIL CORP. +.0402 GAL.	2.7404 GAL.
2887169	1.0	#2B5	CITY WIDE BY TW	METRO FUEL OIL CORP. +.0391 GAL.	3.1606 GAL.
2887105	8.0	#2DHS	BARGE M.T.F. 111	SPRAGUE ENERGY CORP +.0402 GAL.	2.9932 GAL.
2887106	9.0	#2DHS	BARGE WI	METRO FUEL OIL CORP. +.0402 GAL.	2.9046 GAL.
2887301	1.0	#2DLS	BARGE ST. GEORGE	METRO FUEL OIL CORP. +.0367 GAL.	2.9878 GAL.
2887301	3.0	#2DLS	P/U	METRO FUEL OIL CORP. +.0367 GAL.	2.8506 GAL.
2887105	1.0	#2DULS	CITY WIDE BY TW	SPRAGUE ENERGY CORP +.0350 GAL.	2.8544 GAL.
2887105	1.1	#2DULS	P/U	SPRAGUE ENERGY CORP +.0350 GAL.	2.8194 GAL.
2887301	2.0	#2DULS	BARGE ST. GEORGE	METRO FUEL OIL CORP. +.0350 GAL.	2.9341 GAL.
2887086	4.0	#2DULSB20	CITY WIDE BY TW	SPRAGUE ENERGY CORP +.0316 GAL.	3.1265 GAL.
2887086	8.0	#2DULSB20	P/U	METRO FUEL OIL CORP. +.0316 GAL.	3.4773 GAL.
2887086	2.0	#2DULSB5	CITY WIDE BY TW	SPRAGUE ENERGY CORP +.0342 GAL.	2.9467 GAL.
2887105	10.0	#2DULSB5	BARGE ST. GEORGE	SPRAGUE ENERGY CORP +.0342 GAL.	3.4820 GAL.
2887159	6.0	#2DULSB5	P/U	METRO FUEL OIL CORP. +.0342 GAL.	2.9944 GAL.
3087065	2.0	#2DULSB50	CITY WIDE BY TW	SPRAGUE ENERGY CORP. +.0267 GAL.	3.9010 GAL.
2887274	7.0	#2DULSDISP	DISPENSED	SPRAGUE ENERGY CORP. +.0350 GAL.	3.1813 GAL.
2887052	2.0	#4	MANH	RAPID PETROLEUM -.0063 GAL.	2.4802 GAL.
2887052	5.0	#4	BRONX	RAPID PETROLEUM -.0063 GAL.	2.4836 GAL.
2887052	8.0	#4	BROOKLYN	RAPID PETROLEUM -.0063 GAL.	2.4944 GAL.
2887052	14.0	#4	S.I.	RAPID PETROLEUM -.0063 GAL.	2.5274 GAL.
2887053	11.0	#4	QUEENS	METRO FUEL OIL CORP. -.0063 GAL.	2.4992 GAL.
2887052	3.0	#6	MANH	RAPID PETROLEUM -.0374 GAL.	2.3376 GAL.
2887052	6.0	#6	BRONX	RAPID PETROLEUM -.0374 GAL.	2.3376 GAL.
2887052	9.0	#6	BROOKLYN	RAPID PETROLEUM -.0374 GAL.	2.3526 GAL.
2887052	15.0	#6	S.I.	RAPID PETROLEUM -.0374 GAL.	2.3886 GAL.
2887054	12.0	#6	QUEENS	CASTLE OIL CORPORATION -.0374 GAL.	2.3567 GAL.
2787347	1.0	JETA	FLOYD BENNETT	SPRAGUE ENERGY CORP +.0492 GAL.	3.4746 GAL.

**OFFICIAL FUEL PRICE SCHEDULE NO. 6614
FUEL OIL, PRIME AND START**

CONTRACT NO.	ITEM NO.	FUEL/OIL TYPE	VENDOR	CHANGE	PRICE EFF. 1/24/2011
3087154	1.0	#2	MANH	F & S PETROLEUM CORP. +.0402 GAL.	2.8242 GAL.
3087154	79.0	#2	BRONX	F & S PETROLEUM CORP. +.0402 GAL.	2.8242 GAL.
3087154	157.0	#2	BKLYN, QUEENS, SI	F & S PETROLEUM CORP. +.0402 GAL.	2.9042 GAL.
3087225	1.0	#4	CITY WIDE BY TW	METRO FUEL OIL CORP. -.0063 GAL.	2.9284 GAL.
3087225	2.0	#6	CITY WIDE BY TW	METRO FUEL OIL CORP. -.0374 GAL.	2.7426 GAL.

**OFFICIAL FUEL PRICE SCHEDULE NO. 6615
FUEL OIL AND REPAIRS**

CONTRACT NO.	ITEM NO.	FUEL/OIL TYPE	VENDOR	CHANGE	PRICE EFF. 1/24/2011
3087115	1.0	#2	MANH & BRONX	PACIFIC ENERGY +.0402 GAL.	2.6496 GAL.
3087115	80.0	#2	BKLYN, QUEENS, SI	PACIFIC ENERGY +.0402 GAL.	2.6548 GAL.
3087218	1.0	#4	CITY WIDE BY TW	PACIFIC ENERGY -.0063 GAL.	2.8697 GAL.
3087218	2.0	#6	CITY WIDE BY TW	PACIFIC ENERGY -.0374 GAL.	2.7955 GAL.

**OFFICIAL FUEL PRICE SCHEDULE NO. 6616
GASOLINE**

CONTRACT NO.	ITEM NO.	FUEL/OIL TYPE	VENDOR	CHANGE	PRICE EFF. 1/24/2011
3187093	5.0	E70	CITY WIDE BY TW	SPRAGUE ENERGY CORP. +.0026 GAL.	2.5659 GAL.
2887274	6.0	PREM	CITY WIDE BY VEHICLE	SPRAGUE ENERGY CORP. -.0033 GAL.	3.0025 GAL.
3187093	2.0	PREM	CITY WIDE BY TW	SPRAGUE ENERGY CORP. -.0033 GAL.	2.6630 GAL.
3187093	4.0	PREM	P/U	SPRAGUE ENERGY CORP. -.0033 GAL.	2.5839 GAL.

Table with columns for address, area, and volume. Includes entries like 2887274 1.0 U.L. MANH P/U BY VEHICLE SPRAGUE ENERGY CORP. -.0001 GAL. 2.9540 GAL.

39 12081 P/O 197
40 12081 P/O 199
Acquired in the proceeding, entitled: 142ND STREET FROM BASCOM AVE. TO SUTTER AVE. subject to any liens and encumbrances of record on such property.

COMPTROLLER

NOTICE

NOTICE OF ADVANCE PAYMENT OF AWARDS PURSUANT TO THE STATUTES IN SUCH cases made and provided, notice is hereby given that the Comptroller of the City of New York, will be ready to pay, at 1 Centre St., RM 629, New York, NY 10007 on January 28, 2011, to the person or persons legally entitled an amount as certified to the Comptroller by the Corporation Counsel on damage parcels, as follows:

Table with columns: Damage Parcel No., Block, Lot. Includes rows like 1 12057 P/O 58, 4 12060 P/O 62, 15 12070 P/O 85.

35 12081 P/O 189
Acquired in the proceeding, entitled: 142ND STREET FROM BASCOM AVE. TO SUTTER AVE. subject to any liens and encumbrances of record on such property. The amount advanced shall cease to bear interest on the specified date above.
JOHN C. LIU
Comptroller
j13-28

NOTICE OF ADVANCE PAYMENT OF AWARDS PURSUANT TO THE STATUTES IN SUCH cases made and provided, notice is hereby given that the Comptroller of the City of New York, will be ready to pay, at 1 Centre St., Rm. 629, New York, NY 10007 on February 1, 2011, to the person or persons legally entitled an amount as certified to the Comptroller by the Corporation Counsel on damage parcels, as follows:

Table with columns: Damage Parcel No., Block, Lot. Includes rows like 36 12081 P/O 191, 37 12081 P/O 193, 38 12081 P/O 195.

JOHN C. LIU
Comptroller
j18-f1
NOTICE OF ADVANCE PAYMENT OF AWARDS PURSUANT TO THE STATUTES IN SUCH cases made and provided, notice is hereby given that the Comptroller of the City of New York, will be ready to pay, at 1 Centre St., Rm. 629, New York, NY 10007 on February 4, 2011 to the person or persons legally entitled an amount as certified to the Comptroller by the Corporation Counsel on damage parcels, as follows:

Damage Parcel No. Block Lot
46 120801 P/O 240
Acquired in the proceeding, entitled: 142ND STREET FROM BASCOM AVE. TO SUTTER AVE. subject to any liens and encumbrances of record on such property. The amount advanced shall cease to bear interest on the specified date above.
JOHN C. LIU
Comptroller
j21-f4

CHANGES IN PERSONNEL

Table for DEPARTMENT OF EDUCATION ADMIN FOR PERIOD ENDING 12/23/10. Columns: NAME, NUM, SALARY, ACTION, PROV, EFF DATE. Includes names like SCHUMANN JULIE, SCHUTZ SHOSHANA, SCIULARA MARTHA.

Table for OFFICE OF PROBATION FOR PERIOD ENDING 12/23/10. Columns: NAME, NUM, SALARY, ACTION, PROV, EFF DATE. Includes names like ALBRIGHT ALPHONZO, ALBRIGHT ALPHONZO, LAPORTE ERICA.

Table for DEPARTMENT OF BUSINESS SERV. FOR PERIOD ENDING 12/23/10. Columns: NAME, NUM, SALARY, ACTION, PROV, EFF DATE. Includes names like BARNESMCPHERSON GEORGETT B, BOONMALERT BOONSAK D, ORTIZ LARISA.

Table for HOUSING PRESERVATION & DVLPMT FOR PERIOD ENDING 12/23/10. Columns: NAME, NUM, SALARY, ACTION, PROV, EFF DATE. Includes names like ARAGON LUIZ, CUCCHIARO JOSHUA, FAICCO STEVEN.

Table for DEPARTMENT OF BUILDINGS FOR PERIOD ENDING 12/23/10. Columns: NAME, NUM, SALARY, ACTION, PROV, EFF DATE. Includes names like CURTIS EDWARD J, ENDRULAT PAUL, FAUBION ERIC.

Table for DEPT OF HEALTH/MENTAL HYGIENE FOR PERIOD ENDING 12/23/10. Columns: NAME, NUM, SALARY, ACTION, PROV, EFF DATE. Includes names like ADONIS MILHARDI G, ALBERTI PHILIP M, BAEZ RICARDO.

Table with columns: NAME, NUM, SALARY, ACTION, PROV, EFF DATE. Includes names like KOCHMAN ANNE E, KRAUSMAN RUTH N, KRAUSMAN RUTH N.

Table for ADMIN TRIALS AND HEARINGS FOR PERIOD ENDING 12/23/10. Columns: NAME, NUM, SALARY, ACTION, PROV, EFF DATE. Includes names like MASULLO GALE P, RUBIN JERILYN F.

Table for DEPT OF ENVIRONMENT PROTECTION FOR PERIOD ENDING 12/23/10. Columns: NAME, NUM, SALARY, ACTION, PROV, EFF DATE. Includes names like ALBRIGHT WILLIAM H, ALI SADEK M, ANTENUCCI ETTORE.

Table for DEPARTMENT OF SANITATION FOR PERIOD ENDING 12/23/10. Columns: NAME, NUM, SALARY, ACTION, PROV, EFF DATE. Includes names like ACEVEDO JR JOHNNY J, AGRUSA MARCELLO A, ALFONZO RAYMOND E.

Table with columns: NAME, ADDRESS, STATUS, DATE. Lists various employees and their appointment/resignation dates.

DEPARTMENT OF FINANCE FOR PERIOD ENDING 12/23/10. Table with columns: NAME, TITLE, NUM, SALARY, ACTION, PROV, EFF DATE.

DEPARTMENT OF TRANSPORTATION FOR PERIOD ENDING 12/23/10. Table with columns: NAME, TITLE, NUM, SALARY, ACTION, PROV, EFF DATE.

LATE NOTICE

TRANSPORTATION

PUBLIC HEARING

NOTICE OF CONTINUATION OF PUBLIC HEARING

On February 10, 2011, the Department of Transportation will continue the public hearing held on January 27, 2011 on the following rule: Proposed Amendments to Rules Relating to Construction Activity, Underground Street Access Covers, Transformer Vault Covers and Gratings, and Excavation and Restoration Requirements.

COURT NOTICE MAPS FOR RICHMOND COUNTY DAMAGE AND ACQUISITION NO. 4173

Large map area containing a table of assessed valuations, a key map showing street layouts (Albee Avenue, Amboy Road, Annadale Road, etc.), and a title block with project details and signatures.

COURT NOTICE MAPS FOR RICHMOND COUNTY DAMAGE AND ACQUISITION NO. 4173

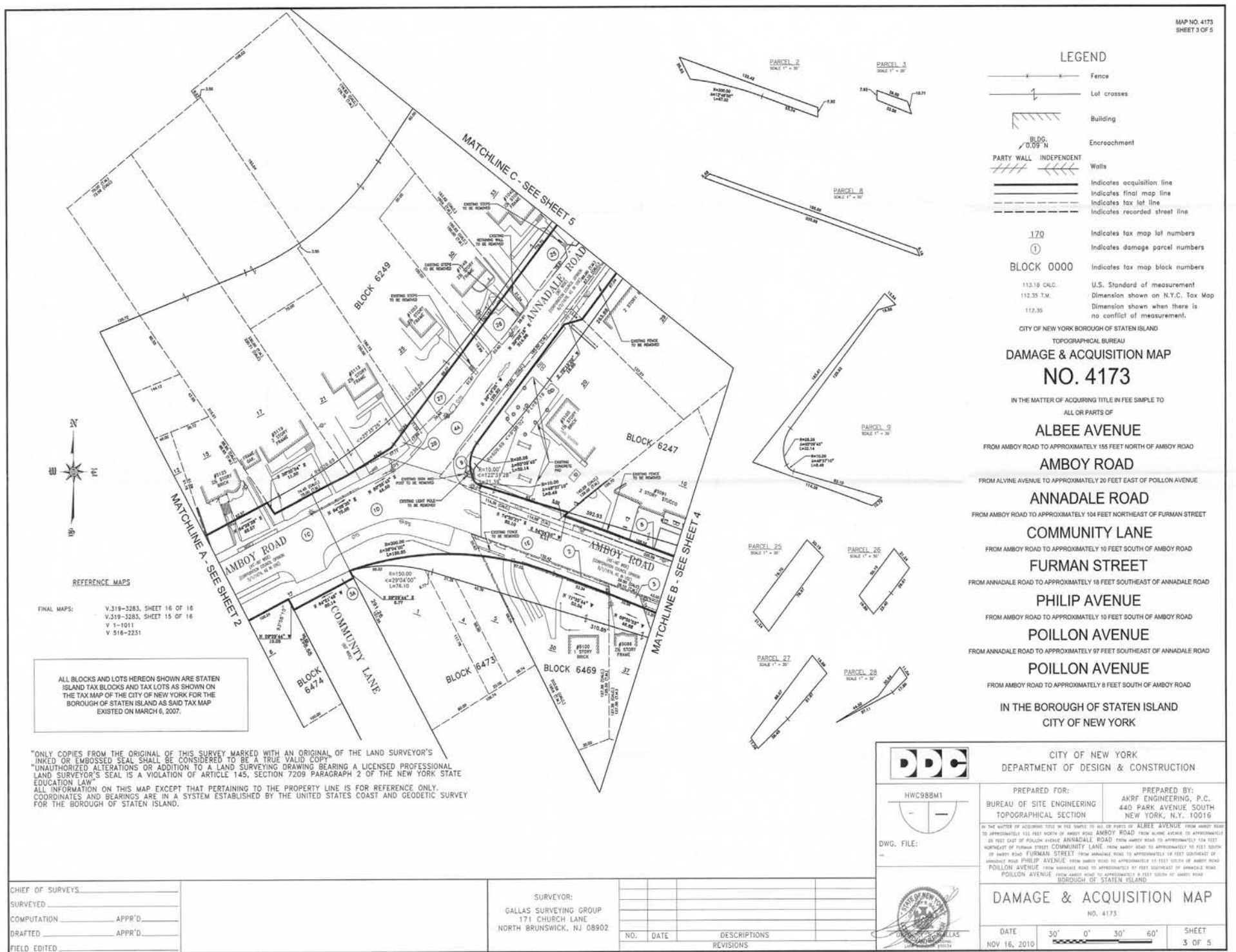
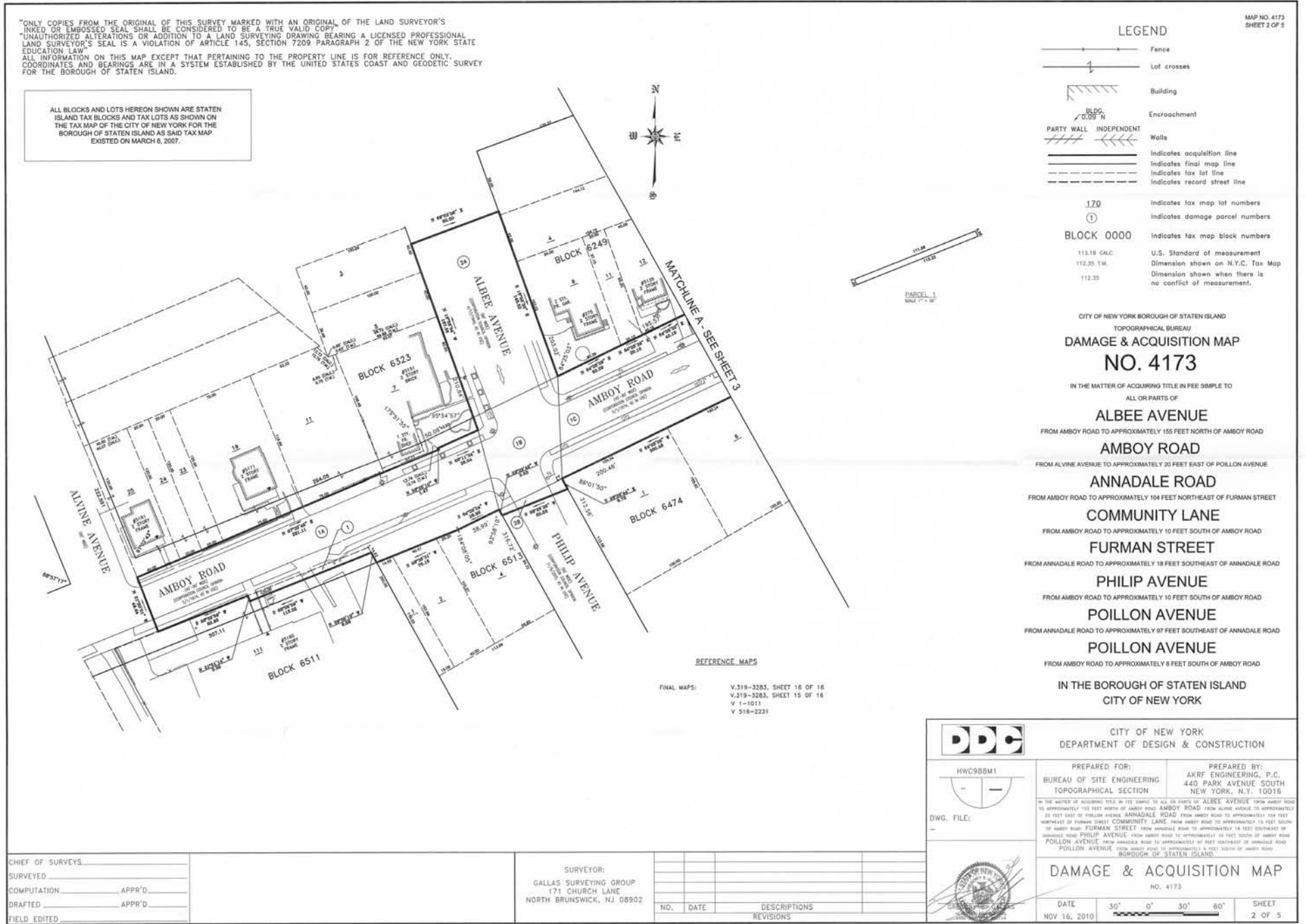

COURT NOTICE MAPS FOR RICHMOND COUNTY DAMAGE AND ACQUISITION NO. 4173

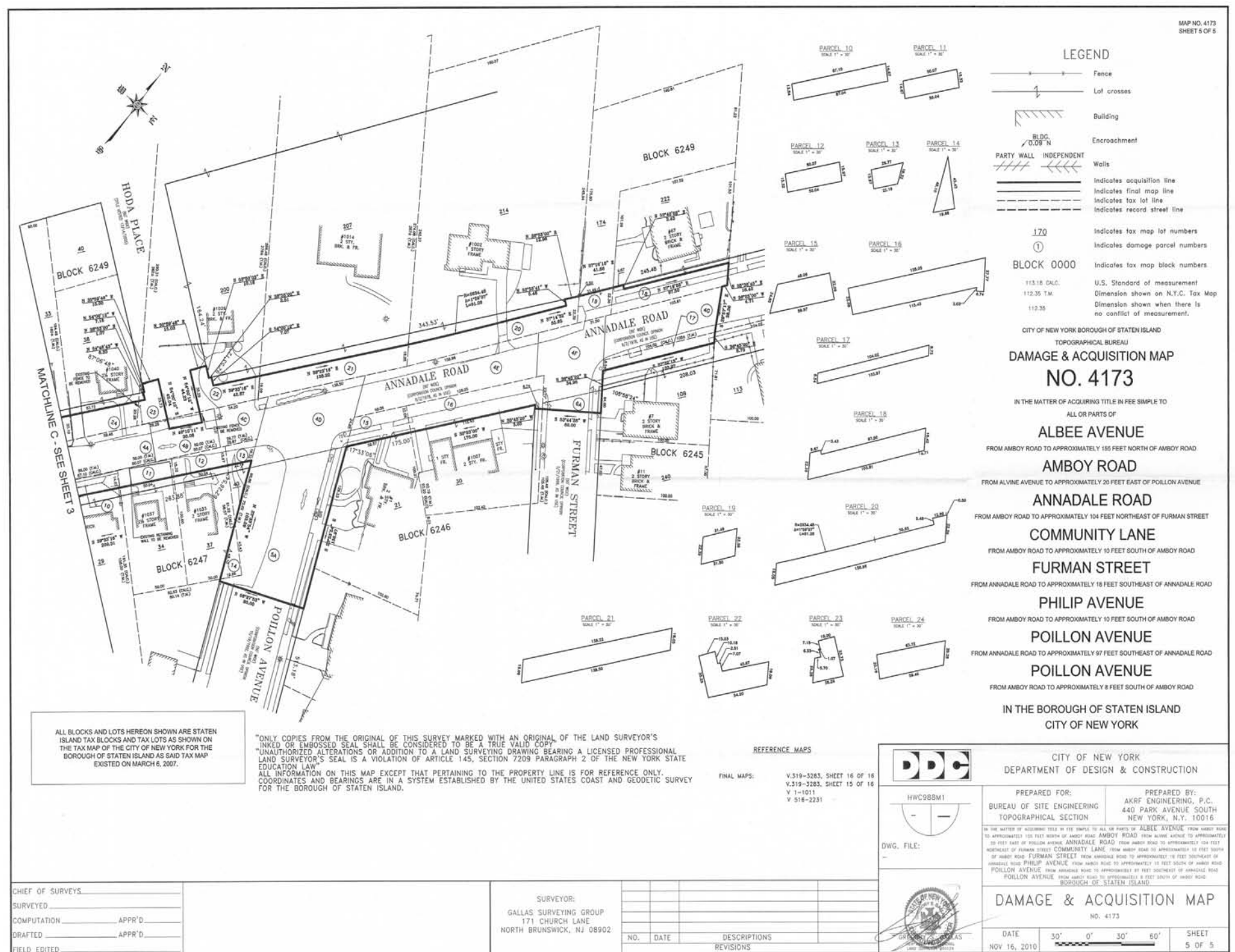
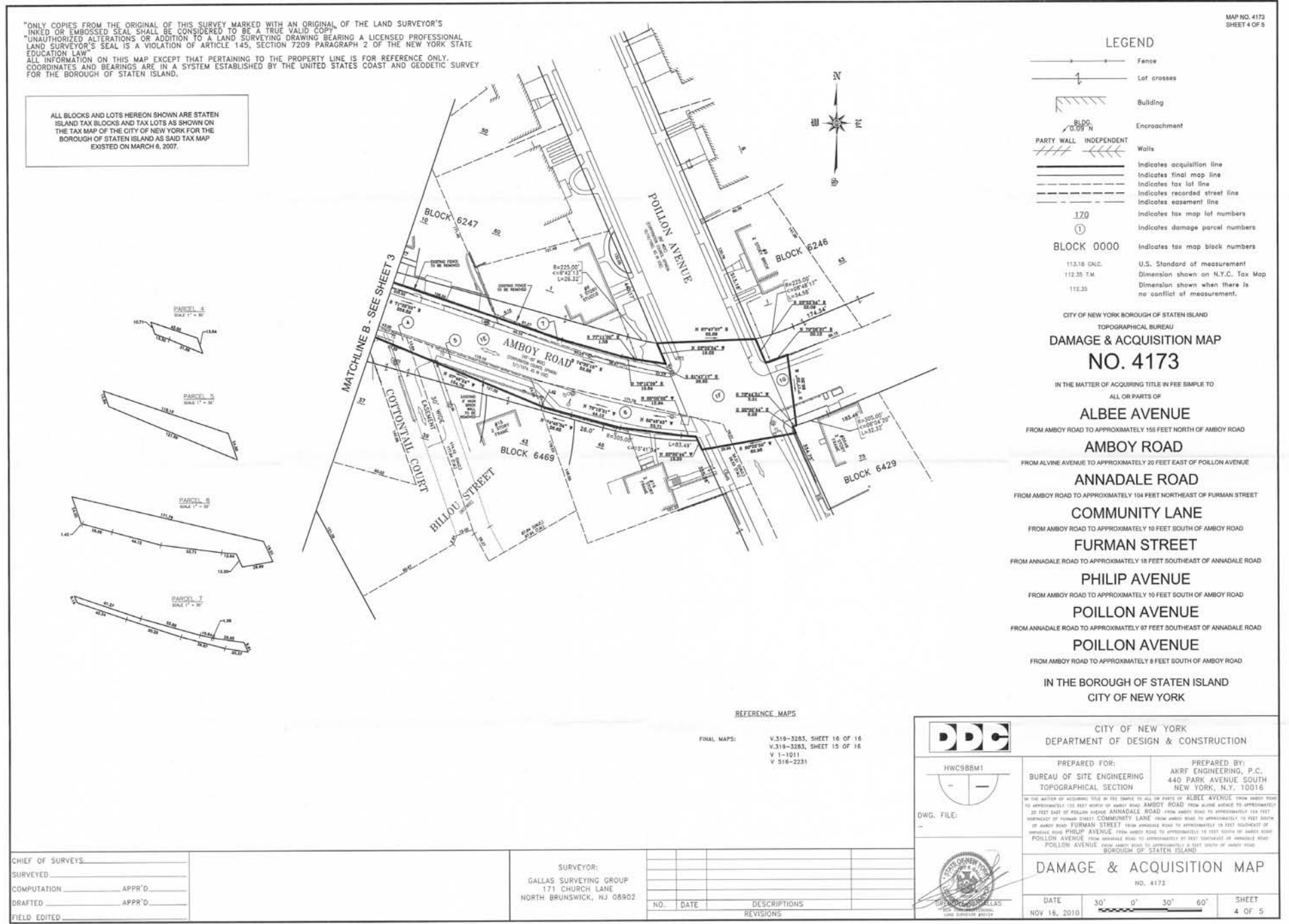

READER'S GUIDE

The City Record (CR) is, published each business day and includes notices of proposed New York City procurement actions, contract awards, and other procurement-related information. Solicitation notices for most procurements valued at or above \$100,000 for information technology and for construction and construction related services, above \$50,000 for other services, and above \$25,000 for other goods are published for at least one day. Other types of procurements, such as sole source, require notice in the City Record for five consecutive days. Unless otherwise specified, the agencies and offices listed are open for business Mondays thru Fridays from 9:00 A.M. to 5:00 P.M. except legal holidays.

NOTICE TO ALL NEW YORK CITY CONTRACTORS

The New York State Constitution ensures that all laborers, workers or mechanics employed by a contractor or subcontractor doing public work are to be paid the same wage rate that prevails in the trade where the public work is being done. Additionally, New York State Labor Law §§ 220 and 230 provide that a contractor or subcontractor doing public work in construction or building service must pay its employees no less than the prevailing wage. Section 6-109 (the Living Wage Law) of the New York City Administrative Code also provides for a "living wage", as well as prevailing wage, to be paid to workers employed by City contractors in certain occupations. The Comptroller of the City of New York is mandated to enforce prevailing wage. Contact the NYC Comptrollers Office at www.comptroller.nyc.gov, click on Labor Law Schedules to view rates.

New York City's "Burma Law" (Local Law No. 33 of 1997) No Longer to be Enforced. In light of the United States Supreme Court's decision in **Crosby v. National Foreign Trade Council**, 530 U.S. 363 (2000), the City has determined that New York City's Local Law No. 33 of 1997 (codified in Administrative Code Section 6-115 and Charter Section 1524), which restricts City business with banks and companies doing business in Burma, is unconstitutional. This is to advise, therefore, that the language relating to Burma contained in existing New York City contracts may not be enforced.

CONSTRUCTION/CONSTRUCTION SERVICES OR CONSTRUCTION RELATED SERVICES

The City of New York is committed to achieving excellence in the design and construction of its capital program, and building on the tradition of innovation in architecture and engineering that has contributed to the City's prestige as a global destination.

VENDOR ENROLLMENT APPLICATION

New York City procures approximately \$7 billion worth of goods, services, construction and construction-related services every year. The NYC Procurement Policy Board Rules require that agencies primarily solicit from established mailing lists called bidder/proposer lists. To register for these lists-free of charge-, prospective suppliers should fill out and submit the NYC-FMS Vendor Enrollment application.

- Online at <http://nyc.gov/selltonyc>
- To request a hardcopy application, call the Vendor Enrollment Center at (212) 857-1680.

Attention Existing Suppliers:

Even if you already do business with NYC agencies, be sure to fill out an application. We are switching over to citywide, centralized Bidders Lists instead of the agency-specific lists previously used to issue notices about upcoming contract opportunities. To continue receiving notices of New York City contract opportunities, you must fill out and submit a NYC-FMS Vendor Enrollment application. If you are uncertain whether you have already submitted an application, call us at (212) 857-1680.

SELLING TO GOVERNMENT TRAINING WORKSHOP

New and experienced vendors are encouraged to register for a free training course on how to do business with New York City. "Selling to Government" workshops are conducted by the Department of Small Business Services, 110 William Street, New York, NY 10038. Morning and afternoon sessions are convened on the first Tuesday of each month. For more information, and to register, call (212) 618-8845.

PRE-QUALIFIED LIST

New York City procurement policy permits agencies to develop and solicit from pre-qualified lists of vendors, under prescribed circumstance. When it is decided by an agency to develop a pre-qualified list, criteria for pre-qualification must be clearly explained in the solicitation and notice of the opportunity to pre-qualify for that solicitation must be published in at least five issues of the CR.

Information and qualification questionnaires for inclusion on such list may be obtained directly from the Agency Chief Contracting Officer at each agency, (see Vendor Information Manual). A completed qualification Questionnaire may be submitted to the Chief Contracting Officer at any time, unless otherwise indicated and action (approval or denial) shall be taken by the agency within 90 days from the date of submission. Any denial or revocation of pre-qualified status can be appealed to the Office of Administrative Trials and Hearings, (OATH), Section 3-11 of the Procurement Policy Board Rules describes the criteria for the general use of pre-qualified lists.

NON-MAYORAL ENTITIES

The following agencies are not subject to Procurement Policy Board rules and do not follow all of the above procedures: City University, Department of Education, Metropolitan Transportation Authority, Health & Hospitals Corporation, Housing Authority. Suppliers interested in applying for inclusion on bidders list should contact these entities directly (see Vendor Information Manual) at the addresses given.

PUBLIC ACCESS CENTER

The Public Access Center is available to suppliers and the public as a central source for supplier-related information through on-line computer access. The Center is located at 253 Broadway, 9th floor, in lower Manhattan, and is open Monday through Friday from 10:00 A.M to 3:00 P.M. For information, contact the Mayor's Office of Contract Services at (212) 788-0010.

ATTENTION: NEW YORK CITY MINORITY AND WOMEN OWNED BUSINESS ENTERPRISES

Join the growing number of Minority and Women Owned Business Enterprises (M/WBEs) that are competing for New York City's business. In order to become certified for the program, your company must substantiate that it: (1) is at least fifty-one percent (51%) owned, operated and controlled by a minority or woman and (2) is either located in New York City or has a significant tie to New York City's business community. To obtain a copy of the certification application and to learn more about the program, contact the New York City Department of Small Business Services, 110 William Street, 2nd Floor, New York, New York 10038 (212) 513-6311.

PROMPT PAYMENT

It is the policy of the City of New York to pay its bills promptly. The Procurement Policy Board Rules generally require that the City pay its bills within 30 days after the receipt of a proper invoice. The City now pays interest on all late invoices. The grace period that formerly existed was eliminated on July 1, 2000. However, there are certain types of payments that are not eligible for interest. These are listed in Section 4-06 of the Procurement Policy Board Rules. The Comptroller and OMB determine the interest rate on late payments twice a year, in January and in July.

PROCUREMENT POLICY BOARD RULES

The Rules may also be accessed on the City Website, <http://nyc.gov/selltonyc>

COMMON ABBREVIATIONS USED IN THE CR

The CR contains many abbreviations. Listed below are simple explanations of some of the most common ones appearing in the CR:

- AB Acceptable Brands List
- AC Accelerated Procurement
- AMT Amount of Contract
- BL Bidders List
- CSB Competitive Sealed Bidding (including multi-step)
- CB/PQ CB from Pre-qualified Vendor List
- CP Competitive Sealed Proposal (including multi-step)
- CP/PQ CP from Pre-qualified Vendor List
- CR The City Record newspaper
- DA Date bid/proposal documents available
- DUE Bid/Proposal due date; bid opening date
- EM Emergency Procurement
- IG Intergovernmental Purchasing
- LBE Locally Based Business Enterprise
- M/WBE Minority/Women's Business Enterprise
- NA Negotiated Acquisition
- NOTICE.... Date Intent to Negotiate Notice was published in CR
- OLB..... Award to Other Than Lowest Responsible & Responsive Bidder/Proposer
- PIN..... Procurement Identification Number
- PPB Procurement Policy Board
- PQ Pre-qualified Vendors List
- RS..... Source required by state/federal law or grant
- SCE Service Contract Short-Term Extension
- DP Demonstration Project
- SS Sole Source Procurement
- ST/FED Subject to State &/or Federal requirements

KEY TO METHODS OF SOURCE SELECTION

The Procurement Policy Board (PPB) of the City of New York has by rule defined the appropriate methods of source selection for City procurement and reasons justifying their use. The CR procurement notices of many agencies include an abbreviated reference to the source selection method utilized. The following is a list of those methods and the abbreviations used:

- CSB **Competitive Sealed Bidding** (including multi-step)
Special Case Solicitations / Summary of Circumstances:
- CP **Competitive Sealed Proposal** (including multi-step)
- CP/1 Specifications not sufficiently definite
- CP/2 Judgement required in best interest of City
- CP/3 Testing required to evaluate
- CB/PQ/4
- CP/PQ/4 **CB or CP from Pre-qualified Vendor List/** Advance qualification screening needed
- DP Demonstration Project
- SS **Sole Source Procurement/**only one source
- RS..... Procurement from a Required Source/ST/FED
- NA..... Negotiated Acquisition
For ongoing construction project only:
- NA/8 Compelling programmatic needs

- NA/9 New contractor needed for changed/additional work
- NA/10 Change in scope, essential to solicit one or limited number of contractors
- NA/11 Immediate successor contractor required due to termination/default
For Legal services only:
- NA/12 Specialized legal devices needed; CP not advantageous
- WA **Solicitation Based on Waiver/Summary of Circumstances** (Client Services/BSB or CP only)
- WA1 Prevent loss of sudden outside funding
- WA2 Existing contractor unavailable/immediate need
- WA3 Unsuccessful efforts to contract/need continues
- IG **Intergovernmental Purchasing** (award only)
- IG/F Federal
- IG/S State
- IG/O Other
- EM **Emergency Procurement** (award only) An unforeseen danger to:
- EM/A Life
- EM/B Safety
- EM/C Property
- EM/D A necessary service
- AC **Accelerated Procurement/**markets with significant short-term price fluctuations
- SCE **Service Contract Extension/**insufficient time; necessary service; fair price
Award to Other Than Lowest Responsible & Responsive Bidder or Proposer / Reason (award only)
- OLB/a anti-apartheid preference
- OLB/b local vendor preference
- OLB/c recycled preference
- OLB/d other: (specify)

HOW TO READ CR PROCUREMENT NOTICES

Procurement Notices in the CR are arranged by alphabetically listed Agencies, and within Agency, by Division if any. The notices for each Agency (or Division) are further divided into three subsections: Solicitations, Awards; and Lists & Miscellaneous notices. Each of these subsections separately lists notices pertaining to Goods, Services, or Construction.

Notices of Public Hearings on Contract Awards appear at the end of the Procurement Section. At the end of each Agency (or Division) listing is a paragraph giving the specific address to contact to secure, examine and/or to submit bid or proposal documents, forms, plans, specifications, and other information, as well as where bids will be publicly opened and read. This address should be used for the purpose specified UNLESS a different one is given in the individual notice. In that event, the directions in the individual notice should be followed. The following is a SAMPLE notice and an explanation of the notice format used by the CR.

SAMPLE NOTICE:

POLICE

DEPARTMENT OF YOUTH SERVICES

■ SOLICITATIONS

Services (Other Than Human Services)

BUS SERVICES FOR CITY YOUTH PROGRAM – Competitive Sealed Bids – PIN# 056020000293 – DUE 04-21-03 AT 11:00 A.M.

Use the following address unless otherwise specified in notice, to secure, examine or submit bid/proposal documents, vendor pre-qualification and other forms; specifications/blueprints; other information; and for opening and reading of bids at date and time specified above.
NYPD, Contract Administration Unit, 51 Chambers Street, Room 310, New York, NY 10007. Manuel Cruz (646) 610-5225.

☛ m27-30

ITEM	EXPLANATION
POLICE DEPARTMENT	Name of contracting agency
DEPARTMENT OF YOUTH SERVICES	Name of contracting division
■ SOLICITATIONS	Type of Procurement action
<i>Services (Other Than Human Services)</i>	Category of procurement
BUS SERVICES FOR CITY YOUTH PROGRAM	Short Title
CSB	Method of source selection
PIN # 056020000293	Procurement identification number
DUE 04-21-03 AT 11:00 am	Bid submission due 4-21-03 by 11:00 am; bid opening date/time is the same.
<i>Use the following address unless otherwise specified in notice, to secure, examine-submit bid/proposal documents; etc.</i>	Paragraph at the end of Agency Division listing giving contact information, or submit bid/information and Agency Contact address
	NYPD, Contract Administration Unit 51 Chambers Street, Room 310 New York, NY 10007. Manuel Cruz (646) 610-5225.
☛	Indicates New Ad
m27-30	Date that notice appears in City Record

NUMBERED NOTES

Numbered Notes are Footnotes. If a Numbered Note is referenced in a notice, the note so referenced must be read as part of the notice. **1.** All bid deposits must be by company certified check or money order made payable to Agency or Company.