

CELEBRATING OVER 150 YEARS



THE CITY RECORD

Official Journal of The City of New York

VOLUME CLIII NUMBER 85

MONDAY, MAY 4, 2026

Price: \$4.00

TABLE OF CONTENTS

PUBLIC HEARINGS AND MEETINGS

| | |
|---------------------------------------------|------|
| Board Meetings | 1885 |
| City Council | 1886 |
| City Planning | 1886 |
| Community Boards | 1888 |
| Landmarks Preservation Commission | 1888 |

PROPERTY DISPOSITION

| | |
|--------------------------------------------|------|
| Citywide Administrative Services | 1889 |
|--------------------------------------------|------|

PROCUREMENT

| | |
|------------------------------------------|------|
| Design and Construction | 1890 |
| Environmental Protection | 1890 |
| Housing Authority | 1890 |
| Human Resources Administration | 1891 |
| Police Department | 1891 |
| Probation | 1892 |
| Sanitation | 1893 |
| School Construction Authority | 1894 |

| | |
|-------------------------------------------|------|
| Youth and Community Development | 1894 |
|-------------------------------------------|------|

PUBLIC COMMENT ON CONTRACT AWARDS

| | |
|---------------------------------------------------------|------|
| Finance | 1894 |
| Health and Mental Hygiene | 1894 |
| Homeless Services | 1895 |
| Human Resources Administration | 1895 |
| Information Technology and Telecommunications | 1895 |
| Law Department | 1895 |
| Parks and Recreation | 1895 |
| Youth and Community Development | 1896 |

AGENCY RULES

| | |
|--------------------------|------|
| Buildings | 1896 |
| Transportation | 1899 |

SPECIAL MATERIALS

| | |
|-----------------------------------------------|------|
| Comptroller | 1914 |
| Office of the Mayor | 1914 |
| Mayor's Office of Contract Services | 1914 |
| Changes in Personnel | 1915 |

THE CITY RECORD

ZOHRAN K. MAMDANI

Mayor

YUME KITASEI

Commissioner, Department of Citywide Administrative Services

JANAE C. FERREIRA

Editor, The City Record

Published Monday through Friday except legal holidays by the New York City Department of Citywide Administrative Services under Authority of Section 1066 of the New York City Charter.

Subscription \$500 yearly.

Editorial Office/Subsription Changes:
The City Record, 1 Centre Street, Room 2170,
New York, NY 10007-1602, (212) 386-0055,
cityrecord@dcas.nyc.gov

Visit The City Record Online (CROL) at www.nyc.gov/cityrecord for a searchable database of all notices published in The City Record.

PUBLIC HEARINGS AND MEETINGS

See Also: Procurement; Agency Rules

BOARD MEETINGS

MEETING

City Planning Commission

Meets in NYC City Planning Commission Hearing Room, Lower Concourse, 120 Broadway, New York, NY 10271, twice monthly on Wednesday, at 10:00 A.M., unless otherwise ordered by the Commission.

City Council

Meets by Charter twice a month in Councilman's Chamber, City Hall, Manhattan, NY 10007, at 1:30 P.M.

Contract Awards Public Hearing

Meets bi-weekly, on Thursday, at 10:00 A.M. In order to access the Public Hearing and testify, please call 1-646-992-2010, Access Code: 715 951 139, no later than 9:55 A.M.

Civilian Complaint Review Board

Generally meets at 10:00 A.M. on the second Wednesday of each month at 40 Rector Street, 2nd Floor, New York, NY 10006. Visit <http://www.nyc.gov/html/ccrb/html/meeting.html> for additional information and scheduling changes.

Design Commission

Meets at City Hall, Third Floor, New York, NY 10007. For meeting schedule, please visit nyc.gov/designcommission or call (212) 788-3071.

Department of Education

Meets in the Hall of the Board for a monthly business meeting on the Third Wednesday, of each month at 6:00 P.M. The Annual Meeting is held on the first Tuesday of July at 10:00 A.M.

Board of Elections

32 Broadway, 7th Floor, New York, NY 10004, on Tuesday, at 1:30 P.M. and at the call of the Commissioner.

Environmental Control Board

Meets at 100 Church Street, 12th Floor, Training Room #143, New York, NY 10007 at 9:15 A.M. once a month at the call of the Chairman.

Board of Health

Meets at Gotham Center, 42-09 28th Street, Long Island City, NY 11101, at 10:00 A.M., quarterly or at the call of the Chairman.

Health Insurance Board

Meets in Room 530, Municipal Building, Manhattan, NY 10007, at the call of the Chairman.

Board of Higher Education

Meets at 535 East 80th Street, Manhattan, NY 10021, at 5:30 P.M., on fourth Monday in January, February, March, April, June, September, October, November and December. Annual meeting held on fourth Monday in May.

Citywide Administrative Services

Division of Citywide Personnel Services will hold hearings as needed in Room 2203, 2 Washington Street, New York, NY 10004.

Commission on Human Rights

Meets on 10th Floor in the Commission's Central Office, 40 Rector Street, New York, NY 10006, on the fourth Wednesday of each month, at 8:00 A.M.

In Rem Foreclosure Release Board

Meets in Spector Hall, 22 Reade Street, Main Floor, Manhattan, monthly on Tuesdays, commencing 10:00 A.M., and other days, times and location as warranted.

Franchise and Concession Review Committee

Meets in Spector Hall, 22 Reade Street, Main Floor, and other days, times and location as warranted.

Real Property Acquisitions and Dispositions

Meets bi-weekly, on Wednesday, at 10:00 A.M. In order to access the Public Hearing and testify, please call 1-646-992-2010, Access Code: 717 876 299, no later than 9:55 A.M.

Landmarks Preservation Commission

Meets in the Hearing Room, 253 Broadway, 2nd Floor in Manhattan, on approximately three Tuesdays each month, commencing at 9:30 A.M. unless otherwise noticed by the Commission. For current meeting dates, times and agendas, please visit our website at www.nyc.gov/landmarks.

Employees' Retirement System

Meets in the Boardroom, 22nd Floor, 335 Adams Street, Brooklyn, NY 11201, at 9:30 A.M., on the second Thursday of each month, at the call of the Chairman.

Housing Authority

New York City Housing Authority Board Meetings are scheduled for the last Wednesday of each month (except August) at 10:00 A.M. in the Ceremonial Room on the 5th Floor of 90 Church Street, New York, NY 10007 (unless otherwise noted). Any changes to the schedule will be posted here and on NYCHA's website at <https://www.nyc.gov/site/nycha/about/board-meetings.page> to the extent practicable, at a reasonable time before the meeting. For additional information, please visit NYCHA's website or contact (212) 306-6088.

Parole Commission

Meets at its office, 100 Centre Street, Manhattan, NY 10013, on Thursday, at 10:30 A.M.

Board of Revision of Awards

Meets in Room 603, Municipal Building, Manhattan, NY 10007, at the call of the Chairman.

Board of Standards and Appeals

Meets at 22 Reade Street, 1st Floor, in Manhattan on Mondays and Tuesdays at 10:00 A.M. Review sessions are customarily held immediately before the public hearing. For changes in the schedule or additional information, please call the Board's office at (212) 386-0009 or consult the Board's website at www.nyc.gov/bsa.

Tax Commission

Meets in Room 936, Municipal Building, Manhattan, NY 10007, each month at the call of the President. Manhattan, monthly on Wednesdays, commencing 2:30 P.M.

CITY COUNCIL

■ PUBLIC HEARINGS

NOTICE IS HEREBY GIVEN that the Council has scheduled the following public hearing on the matters indicated below:

The Subcommittee on Landmarks, Public Sitings, Resiliency, and Dispositions will hold a public hearing, accessible remotely and in person, at 250 Broadway, 8th Floor, Committee Room 3, New York, NY 10007, on the following matters commencing at 11:00 A.M. on May 13, 2026. The hearing will be live-streamed on the Council's website at <https://council.nyc.gov/live/>. Please visit <https://council.nyc.gov/land-use/> in advance for information about how to testify and how to submit written testimony.

**351 POWERS AVENUE ARTICLE XI DISPOSITION
BRONX CB - 1 G 260001 XAX**

Application submitted by the Department of Housing Preservation and Development (HPD) for the proposed sale of 351 Powers Avenue (Block 2571, p/o Lot 1) to a developer to be selected by HPD for the nominal price of \$1 per tax lot, pursuant to Section 576-a(2) of the Private Housing Finance Law to facilitate the development of rental housing for low-income families, Borough of the Bronx, Community District 1, Council District 8.

For questions about accessibility and requests for additional accommodations, including language access services, please contact swerts@council.nyc.gov or nbenjamin@council.nyc.gov or (212) 788-6936 at least three (3) business days before the hearing.

Accessibility questions: Kaitlin Greer, kgreer@council.nyc.gov, by: Friday, May 8, 2026, 3:00 P.M.



CITY PLANNING

■ PUBLIC HEARINGS

The City Planning Commission will hold a public hearing accessible both in-person and remotely via the teleconferencing application Zoom, at 10:00 A.M. Eastern Daylight Time, on Wednesday, May 13, 2026, regarding the calendar items listed below. The public hearing will be held in person in the NYC City Planning Commission Hearing Room, Lower Concourse, 120 Broadway, New York, NY.

The meeting will be live streamed through Department of City Planning's (DCP's) website and accessible from the following webpage, which contains specific instructions on how to observe and participate, as well as materials relating to the meeting: <https://www.nyc.gov/content/planning/pages/calendar>

Members of the public attending remotely should observe the meeting through DCP's website. Testimony can be provided verbally by joining the meeting using either Zoom or by calling the following number and entering the information listed below:

877 853 5247 US Toll-free
888 788 0099 US Toll-free

253 215 8782 US Toll Number
213 338 8477 US Toll Number

Meeting ID: **618 237 7396**
[Press # to skip the Participation ID]
Password: 1

To provide verbal testimony via Zoom please follow the instructions available through the above webpage (link above).

Written comments will also be accepted until 11:59 P.M., one week before the date of the vote. Please use the CPC Comments form that is accessible through the above webpage.

Please inform the Department of City Planning if you need a reasonable accommodation, such as a sign language interpreter, in order to participate in the meeting. The submission of testimony, verbal or written, in a language other than English, will be accepted, and real time interpretation services will be provided based on available resources. Requests for a reasonable accommodation or foreign language assistance during the meeting should be emailed to [AccessibilityInfo@planning.nyc.gov] or made by calling 212-720-3366. Requests must be submitted at least five business days before the meeting.

**BOROUGH OF THE BRONX
Nos. 1 and 2
1160 PUGSLEY AVENUE REZONING
No. 1**

CD 9 C 250245 ZMX
IN THE MATTER OF an application submitted by 1160-1178 Pugsley Ave LLC pursuant to Section 197-c and 201 of the New York City Charter for the amendment of the Zoning Map, Section No. 4b:

1. changing from an R5 District to an R7A District property bounded by Powell Avenue, a line 95 feet easterly of Pugsley Avenue, Haviland Avenue, and Pugsley Avenue; and
2. establishing within the proposed R7A District a C2-4 District bounded by Powell Avenue, a line 95 feet easterly of Pugsley Avenue, Haviland Avenue, and Pugsley Avenue;

as shown on a diagram (for illustrative purposes only) dated January 21, 2026, and subject to the conditions of CEQR Declaration E-825.

No. 2

CD 9 N 250246 ZRX
IN THE MATTER OF an application by 1160-1178 Pugsley Ave LLC, pursuant to Section 201 of the New York City Charter, for an amendment of the Zoning Resolution of the City of New York, amending APPENDIX F (Mandatory Inclusionary Housing Areas and former Inclusionary Housing Designated Areas) for the purpose of establishing a Mandatory Inclusionary Housing area.

* * *

Matter underlined is new, to be added;
Matter ~~struck out~~ is to be deleted;
Matter within # # is defined in Section 12-10;
* * * indicates where unchanged text appears in the Zoning Resolution.

* * *

APPENDIX F
Mandatory Inclusionary Housing Areas and former
Inclusionary Housing Designated Areas

BRONX

Bronx Community District 9

Map 1 - [date of adoption]

[EXISTING MAP]

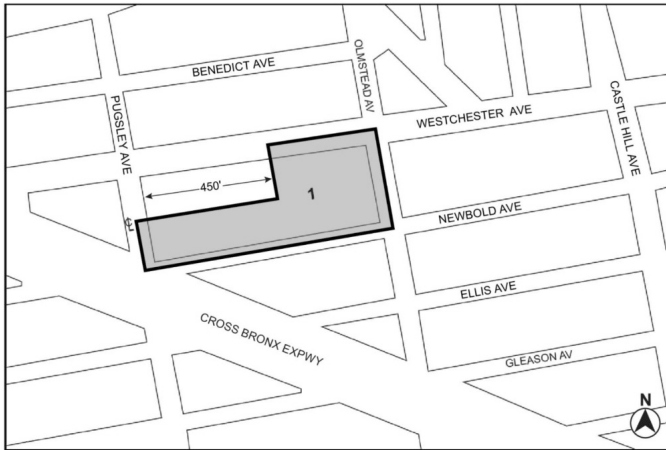

Mandatory Inclusionary Housing Program area see Section 23-154(d)(3)
Area 1- 5/24/17 MIH Program Option 1

[PROPOSED MAP]

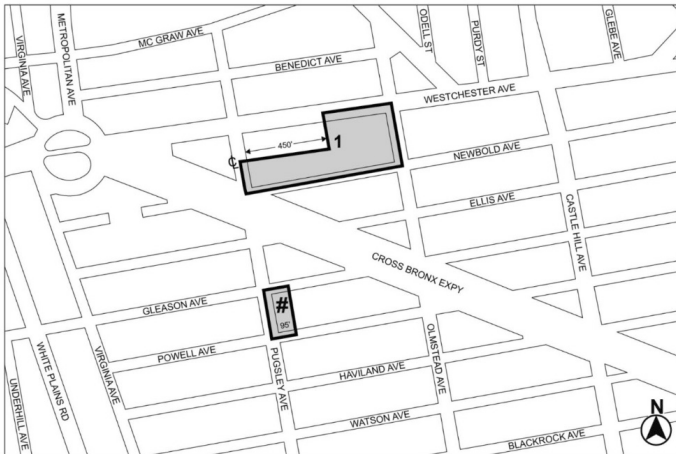

Mandatory Inclusionary Housing area
Area 1 - 5/24/17 MIH Option 1
Area # - [date of adoption] MIH Option 1 and Option 2

Portion of Community District 9, Bronx

* * *

BOROUGH OF BROOKLYN
Nos. 3 and 4
1166 BEDFORD AVENUE REZONING
No. 3

CD 3
IN THE MATTER OF an application submitted by Khalifah
Residences LLC pursuant to Sections 197-c and 201 of the New York
City Charter for an amendment of the Zoning Map, Section No. 17a by
changing from an R6A District to an R7X District property bounded by
Madison Street, Bedford Avenue, Putnam Avenue, and a line 100 feet
westerly of Bedford Avenue, as shown on a diagram (for illustrative
purposes only) dated January 21, 2026, and subject to the conditions of
CEQR Declaration E-867.

No. 4

N 260163 ZRK

CD 3
IN THE MATTER OF an application submitted by Khalifah
Residences LLC, pursuant to Section 201 of the New York City Charter,
for an amendment of the Zoning Resolution of the City of New York,
amending APPENDIX F (Mandatory Inclusionary Housing Areas and
former Inclusionary Housing Designated Areas) for the purpose of
establishing a Mandatory Inclusionary Housing area.

Matter underlined is new, to be added;
Matter struck out is to be deleted;
Matter within # # is defined in Section 12-10;
* * * indicates where unchanged text appears in the Zoning
Resolution.

* * *

APPENDIX F
Mandatory Inclusionary Housing Areas and former
Inclusionary Housing Designated Areas

BROOKLYN

Brooklyn Community District 3

Map 1 - [date of adoption]

[EXISTING MAP]

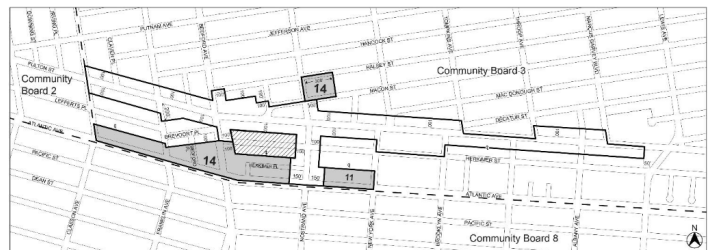

Community District Boundaries
Excluded Area
Former Inclusionary Housing designated area
Mandatory Inclusionary Housing area
Area 11 - 5/16/24 MIH Program Option 1 and Option 3
Area 14 - 5/28/25 MIH Program Option 1

[PROPOSED MAP]

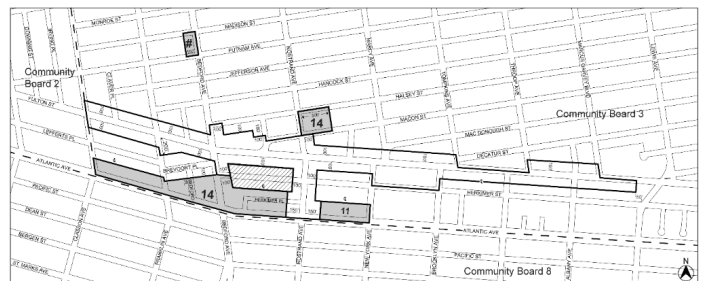

Community District Boundaries
Excluded Area
Former Inclusionary Housing designated area
Mandatory Inclusionary Housing area
Area 11 - 5/16/24 MIH Program Option 1 and Option 3
Area 14 - 5/28/25 MIH Program Option 1
Area # - [date of adoption] MIH Option 1 and Option 2

Portion of Community District 3, Brooklyn

* * *

BOROUGH OF STATEN ISLAND
No. 5
SAW MILL CREEK MARSH PARK ADDITION

CD 2
IN THE MATTER OF an application submitted by the Department
of Citywide Administrative Services and the Department of Parks and
Recreation, pursuant to Section 197-e of the New York City Charter, for
acquisition of property located at Block 1780, Lot 15 Borough of Staten
Island, Community District 2, and for site selection of such property for
preservation of wetland area.

Sara Avila, Calendar Officer
City Planning Commission

120 Broadway, 31st Floor, New York, NY 10271
Telephone (212) 720-3366

Accessibility questions: AccessibilityInfo@planning.nyc.gov;
(212) 720-3366, by: Wednesday, May 6, 2026, 5:00 P.M.



a29-my13

COMMUNITY BOARDS

■ PUBLIC HEARINGS

NOTICE IS HEREBY GIVEN that the following matters have been scheduled for public hearing by Community Board:

BOROUGH OF BROOKLYN

COMMUNITY BOARD NO. 01 - Tuesday, May 12, 6:00 P.M., at Swinging Sixties Senior Center, 211 Ainslie Street (corner of Manhattan Avenue), Brooklyn, NY 11211.

AGENDA

Project Name: 289 Kent Avenue Rezoning, Application #: C 260087ZMK, CEQR Number: 26DCP046K

IN THE MATTER OF an application submitted by Web Holdings LLC pursuant to Sections 197-c and 201 of the New York City Charter for an amendment of the Zoning Map, Section No. 12d:

1. changing from an M3-1 District to an M1-3A/R7X District property bounded by South 1st Street, a line 200 feet northwesterly of Wythe Avenue, South 2nd Street, and Kent Avenue;
2. changing from an M3-1 District to an M1-2A District property bounded by a line midway between South 1st Street and South 2nd Street, Wythe Avenue, South 2nd Street, and a line 200 feet northwesterly of Wythe Avenue; and
3. establishing a Special Mixed Use District (MX-8) bounded by South 1st Street, a line 200 feet northwesterly of Wythe Avenue, South 2nd Street, and Kent Avenue;

as shown on a diagram (for illustrative purposes only) dated April 13, 2026, and subject to the conditions of CEQR Declaration E-905.

Accessibility questions: bk01@cb.nyc.gov or (718) 389-0009, by: Thursday, May 7, 2026, 2:00 P.M.



my4-12

NOTICE IS HEREBY GIVEN that the following matters have been scheduled for public hearing by Community Board:

BOROUGH OF QUEENS

COMMUNITY BOARD NO. 11 - Monday, May 4, 2026 7:30 P.M., Bayside High School, 32-24 Corporal Kennedy Street, Bayside, NY 11361.

ULURP Application-

ULURP #C250331ZMQ, 189-10 Northern Blvd. An application to the NYC Dept. of City Planning for a zoning map amendment from R3X and R3- 2 to R3-2/C2-4 to facilitate a new mixed-use three-story commercial and community facility building.

my4

NOTICE IS HEREBY GIVEN that the following matter has been scheduled for a public hearing by Bronx Community Board:

BOROUGH OF THE BRONX

COMMUNITY BOARD NO. 10 - Thursday, 7:00 P.M., May 7, 2026, at ArchCare at Providence Rest Nursing Home and Rehabilitation Center, 3304 Waterbury Avenue, Bronx 10465. A public hearing in the matter of 815 Hutchinson River Parkway Rezoning Application # 240161ZMX, CEQR Number: 26DCP016X, to amend the Zoning Map, Section No. 7a, changing from an M 1-2 District to a C8-3 District property bounded by Lafayette Avenue, the westerly service road of the Hutchinson River Parkway, Wenner Place and Brush Avenue.

Accessibility questions: Accessibility questions: Bronx Community Board #10, (718) 892-1161, by: Wednesday, May 6, 2026, 12:00 P.M.



my1-7

LANDMARKS PRESERVATION COMMISSION

■ PUBLIC HEARINGS

NOTICE IS HEREBY GIVEN that pursuant to the provisions of Title 25, Chapter 3 of the Administrative Code of the City of New York (Sections 25-303, 25-307, 25-308, 2-309, 25-313, 25-318, 25-320) on Tuesday, May 12, 2026, at 9:00 A.M., a public hearing will be held in the public hearing room at 253 Broadway, 2nd Floor, Borough of Manhattan, with respect to the following properties, and then followed by a public meeting. Participation by video conference may be available as well. Please check the hearing page on LPC's website (<https://www.nyc.gov/site/lpc/hearings/hearings.page>) for updated hearing information.

The final order and estimated times for each application will be posted on the Landmarks Preservation Commission website the Friday before the hearing. Please note that the order and estimated times are subject to change. An overflow room is located outside of the primary doors of the public hearing room. Any person requiring reasonable accommodation in order to participate in the hearing or attend the meeting should contact Elizabeth Le, Community and Intergovernmental Affairs Associate, at ele@lpc.nyc.gov or (212) 602-7254 no later than five (5) business days before the hearing or meeting. Members of the public who are not attending in person can observe the meeting on LPC's YouTube channel at www.youtube.com/nyclpc and may testify on particular matters by joining the meeting using either the Zoom app or by calling in from any phone. Specific instructions on how to observe and testify, including the meeting ID and password, and the call-in number, will be posted on the agency's website, on the Monday before the public hearing.

230 Grosvenor Street - Douglaston Historic District

LPC-26-09539 - Block 8033 - Lot 44 - Zoning: R1-2

CERTIFICATE OF APPROPRIATENESS

A Tudor Revival style free-standing house designed by Walter I. Halliday and built in 1927. Application is to install awnings.

372 Clinton Avenue - Clinton Hill Historic District

LPC-26-05817 - Block 1943 - Lot 32 - Zoning: R6B

CERTIFICATE OF APPROPRIATENESS

An altered Neo-Grec style rowhouse designed by Robert Dixon and built in 1878. Application is to construct a two-story rear deck.

480 Willoughby Avenue - Willoughby-Hart Historic District

LPC-26-08073 - Block 1766 - Lot 26 - Zoning: R6B

CERTIFICATE OF APPROPRIATENESS

A Neo-Grec style rowhouse designed by Arthur Taylor and built c. 1883. Application is to construct a rear yard addition, alter and excavate the areaway, create a new masonry opening, and replace windows.

675 Hudson Street - Gansevoort Market Historic District

LPC-26-07933 - Block 629 - Lot 1 - Zoning: M1-5

CERTIFICATE OF APPROPRIATENESS

A vernacular/Neo-Grec style factory building, built c. 1849, with an addition built c. 1854-60 and altered c. 1884. Application is to construct a rooftop addition, replace windows, install awnings, construct a vestibule, create areaways, excavate the cellar, and remove interior floors.

595 Madison Avenue (aka 593-599 Madison Avenue, 41 East 57th Street) - Individual and Interior Landmark

LPC-26-06412 - Block 1293 - Lot 26 - Zoning: C5-3, MID

CERTIFICATE OF APPROPRIATENESS

An Art Deco skyscraper designed by Walker & Gillette and built in 1928-29. Application is to replace a door.

245 Fifth Avenue - Madison Square North Historic District

LPC-26-03094 - Block 857 - Lot 76 - Zoning: C5-2

CERTIFICATE OF APPROPRIATENESS

A Neo-Gothic style commercial, store and lofts building designed by George F. Pelham and built in 1926-27. Application is to install a marquee, awnings and light fixtures and replace doors.

514 Cathedral Parkway - Morningside Heights Historic District

LPC-26-02348 - Block 1881 - Lot 7503 - Zoning: R8

CERTIFICATE OF APPROPRIATENESS

An Arts and Crafts style apartment building designed by Schwartz & Gross and built in 1911. Application is to establish a Master Plan governing the future installation of windows.

140 West 88th Street - Upper West Side/Central Park West Historic District

LPC-26-08279 - Block 1218 - Lot 45 - Zoning: R7-2

CERTIFICATE OF APPROPRIATENESS

A Renaissance Revival style rowhouse designed by Neville & Bagge and built in 1894. Application is to construct rooftop and rear additions and reconstruct the rear façade.

125 East 64th Street - Upper East Side Historic District

LPC-26-05686 - Block 1399 - Lot 10 - **Zoning:** R6B
CERTIFICATE OF APPROPRIATENESS
 A Neo-Grec style rowhouse designed by John McCool and built in 1876-77 and altered in 1924. Application is to replace windows.

159 East 78th Street - Individual Landmark
LPC-26-09397 - Block 1413 - Lot 124 - **Zoning:** R8B
TRANSFER OF DEVELOPMENT RIGHTS
 A Vernacular Italianate style rowhouse built in 1861. Application is to request that the Landmarks Preservation Commission issue a favorable report to the City Planning Commission regarding the continuing maintenance program for the landmark in connection with a transfer of development rights pursuant to Section 75-42 of the Zoning Resolution.

161 East 78th Street - Individual Landmark
LPC-26-09379 - Block 1413 - Lot 25 - **Zoning:** R8B
TRANSFER OF DEVELOPMENT RIGHTS
 A Vernacular Italianate style rowhouse built in 1861. Application is to request that the Landmarks Preservation Commission issue a favorable report to the City Planning Commission regarding the continuing maintenance program for the landmark in connection with a transfer of development rights pursuant to Section 75-42 of the Zoning Resolution.

a29-my12

NOTICE IS HEREBY GIVEN that pursuant to the provisions of Title 25, Chapter 3 of the Administrative Code of the City of New York (Sections 25-303, 25-307, 25-308, 25-309, 25-313, 25-318, 25-320) on Tuesday, May 5, 2026, at 9:00 A.M., a public hearing will be held in the public hearing room at 253 Broadway, 2nd Floor, Borough of Manhattan, with respect to the following properties, and then followed by a public meeting. Participation in the video conference may be available as well. Please check the hearing page on LPC's website (<https://www.nyc.gov/site/lpc/hearings/hearings.page>) for updated hearing information.

The final order and estimated times for each application will be posted on the Landmarks Preservation Commission website the Friday before the hearing. Please note that the order and estimated times are subject to change. An overflow room is located outside of the primary doors of the public hearing room. Any person requiring reasonable accommodation in order to participate in the hearing or attend the meeting should contact Elizabeth Le, Community and Intergovernmental Affairs Associate, at ele@lpc.nyc.gov or (212) 602-7254 no later than five (5) business days before the hearing or meeting. Members of the public not attending in person can observe the meeting on LPC's YouTube channel at www.youtube.com/nyclpc and may testify on particular matters by joining the meeting using either the Zoom app or by calling in from any phone. Specific instructions on how to observe and testify, including the meeting ID and password, and the call-in number, will be posted on the agency's website, on the Monday before the public hearing.

10 Pierrepont Street - Brooklyn Heights Historic District
LPC-26-08142 - Block 241 - Lot 123 - **Zoning:** R6
CERTIFICATE OF APPROPRIATENESS
 A Neo-Renaissance style rowhouse designed by J.C. Cady and built in c. 1895. Application is to install an areaway lift and construct a rooftop bulkhead and railings.

91 Atlantic Avenue - Brooklyn Heights Historic District
LPC-26-08043 - Block 274 - Lot 14 - **Zoning:** R6, C1-3
CERTIFICATE OF APPROPRIATENESS
 A Greek Revival style commercial building-built c. 1850-60. Application is to construct a rooftop addition and railings.

248 West 12th Street - Greenwich Village Historic District
LPC-26-06819 - Block 615 - Lot 23 - **Zoning:** R6
CERTIFICATE OF APPROPRIATENESS
 A rowhouse built in 1852. Application is to modify lintels and sills.

702 Greenwich Street - Greenwich Village Historic District Extension
LPC-26-07507 - Block 631 - Lot 24 - **Zoning:** C1-6A
CERTIFICATE OF APPROPRIATENESS
 A Moderne utilitarian style garage and office building designed by Harry Silverman and built in 1937. Application is to replace storefront infill and install an awning.

105 Fifth Avenue - Ladies' Mile Historic District
LPC-26-07668 - Block 846 - Lot 71 - **Zoning:** C6-4M, M1-5M
CERTIFICATE OF APPROPRIATENESS
 A Neo-Renaissance style store and lofts building designed by Robert Maynicke and built in 1901-1902. Application is to alter the façade and replace entrance infill.

1 East 75th Street - Upper East Side Historic District
LPC-26-07720 - Block 1390 - Lot 1 - **Zoning:** R10, P1
CERTIFICATE OF APPROPRIATENESS

An Italian Renaissance style residence designed by H.D. Hale and J.G. Rogers and built in 1907-09. Application is to install a barrier-free access lift.

27 Hamilton Terrace - Hamilton Heights Historic District
LPC-26-06747 - Block 2050 - Lot 103 - **Zoning:** R6A
CERTIFICATE OF APPROPRIATENESS
 An Italian Renaissance style townhouse designed by Robert Kelly and William Strom and built in 1897-1898. Application is to combine masonry openings and install new infill.

a22-my5

PROPERTY DISPOSITION

The City of New York in partnership with GovDeals.com posts online auctions. All auctions are open to the public.

Registration is free and new auctions are added weekly. To review auctions or register visit <https://www.govdeals.com>

CITYWIDE ADMINISTRATIVE SERVICES

■ SALE

The City of New York in partnership with GovDeals.com posts vehicle and heavy machinery auctions online every week at: <https://www.govdeals.com/en/nyc-dcas-fleet>.

All auctions are open to the public and registration is free.

For help with registration or for general questions, please contact the GovDeals customer support team at 844-704-0367 or osr@govdeals.com.

n14-my3

PROCUREMENT

“Compete To Win” More Contracts!

Thanks to a new City initiative - “Compete To Win” - the NYC Department of Small Business Services offers a new set of FREE services to help create more opportunities for minority and Women-Owned Businesses to compete, connect and grow their business with the City. With NYC Construction Loan, Technical Assistance, NYC Construction Mentorship, Bond Readiness, and NYC Teaming services, the City will be able to help even more small businesses than before.

● Win More Contracts, at nyc.gov/competetowin

“The City of New York is committed to achieving excellence in the design and construction of its capital program, and building on the tradition of innovation in architecture and engineering that has contributed, to the City’s prestige as a global destination. The contracting opportunities for construction/construction services and construction-related services that appear in the individual agency listings below reflect that commitment to excellence.”

HHS ACCELERATOR PREQUALIFICATION

To respond to human services Requests for Proposals (RFPs), in accordance with Section 3-16 of the Procurement Policy Board Rules of the City of New York (“PPB Rules”), vendors must first complete and submit an electronic HHS Accelerator Prequalification Application using the City’s PASSPort system. The PASSPort system is a web-based system maintained by the City of New York for use by its

Mayoral Agencies to manage procurement. Important business information collected in the Prequalification Application is required every three years. Documents related to annual corporate filings must be submitted on an annual basis to remain eligible to compete. Prequalification applications will be reviewed to validate compliance with corporate filings and organizational capacity. Approved organizations will be eligible to compete and would submit electronic proposals through the PASSPort system. The PASSPort Public Portal, which lists all RFPs, including HHS RFPs that require HHS Accelerator Prequalification, may be viewed, at https://passport.cityofnewyork.us/page.aspx/en/rfp/request_browse_public

All current and prospective vendors should frequently review information listed on roadmap to take full advantage of upcoming opportunities for funding. For additional information about HHS Accelerator Prequalification and PASSPort, including background materials, user guides and video tutorials, please visit <https://www.nyc.gov/site/mocs/hhsa/hhs-accelerator-guides.page>

DESIGN AND CONSTRUCTION

■ AWARD

Construction / Construction Services

NON-STANDARD PEDESTRIAN RAMPS UPGRADES - Competitive Sealed Bids - PIN# 85025B0047001 - AMT: \$13,756,853.00 - TO: JLV IV Enterprises Inc., 98-05 217th Street, Queens Village, NY 11429.

Including curbs and sidewalk reconstruction, pavement markings, street lighting, and traffic signal work. Together with all work incidental thereto Borough of Brooklyn, City of New York. Community Boards: 7, 10, 11, 12, 14.

Special Case Determination not applicable - As per PPB Rule 3-01 (b) using Preferred Method - Competitive Sealed Bidding awarded to lowest bid

my4

HWPR25KR, STANDARD PEDESTRIAN RAMP UPGRADES

- Competitive Sealed Bids - PIN# 85026B0027001 - AMT: \$24,667,067.00 - TO: JRCRUZ Corp., 33 W. Main Street, Holmdel, NJ 07733.

Together with all work incidental thereto Borough of Brooklyn and Staten Island, City of New York. Brooklyn CBs: 7,10,11,12,13,14,15,17 and 18 Staten Island: 1,2,3. 730 CCDs

Special Case Determination not applicable - As per PPB Rule 3-01 (b) using Preferred Method - Competitive Sealed Bidding awarded to lowest bid

my4

ENVIRONMENTAL PROTECTION

WASTEWATER TREATMENT

■ SOLICITATION

Construction Related Services

82626B0047-BWT-TI-182 TALLMAN ISLAND WRRF CHLORINATION SYSTEM UPGRADE - Competitive Sealed Bids - PIN# 82626B0047 - Due 5-28-26 at 10:00 A.M.

This Competitive Sealed Bid ("RFx") is being released through PASSPort, New York City's online procurement portal. Responses to this RFx should be submitted via PASSPort. To access the solicitation, vendors should visit the PASSPort Public Portal at <https://www.nyc.gov/site/mocs/passport/about-passport.page> and click on the "Search Funding Opportunities in PASSPort" blue box. This will take you to the Public Portal of all procurements in the PASSPort system. To quickly locate the RFx, insert the EPIN 82626B0047 into the Keywords search field. If you need assistance submitting a response, please contact help@mocs.nyc.gov.

Bid opening Location - Microsoft Teams Pre bid conference location -Microsoft Teams Mandatory: no Date/Time - 2026-05-11 00:00:00.

my4

■ AWARD

Services (other than human services)

BWT NYWEA CONFERENCE 6031161X - Other - PIN# 82626U0020001 - AMT: \$52,920.00 - TO: New York Water Environment Assoc., 525 Plum Street, Suite 102, Syracuse, NY 13204.

my4

HOUSING AUTHORITY

PROCUREMENT

■ SOLICITATION

Construction Related Services

INDEFINITE DELIVERY INDEFINITE QUANTITY (IDIQ) CONTRACT FOR INSTALLATION OF VINYL COMPOSITION (V/C) FLOOR TILE IN APARTMENTS AND PUBLIC SPACES LOCATED IN VARIOUS, BX NEIGHBORHOODS, BK NEIGHBORHOOD, MN NEIGHBORHOOD & QUEENS NEIGHBORHOOD, DEVELOPMENTS - Competitive Sealed Bids - Due 5-27-26 at 2:00 P.M.

PIN# 521150 Neighborhood (BX02), Various Developments-Bronx
 PIN# 521151 Neighborhood (BX05), Various Developments-Bronx
 PIN# 521152 Neighborhood (BX07), Various Developments-Bronx
 PIN# 521153 Neighborhood (BK03), Various Developments-Brooklyn
 PIN# 521154 Neighborhood (BK07), Various Developments-Brooklyn
 PIN# 521155 Neighborhood (BK(TBD-02), Various Developments-Brooklyn

PIN# 521156 Neighborhood (MN01), Various Developments-Manhattan

PIN# 521157 Neighborhood (MN03), Various Developments-Manhattan

PIN# 521158 Neighborhood (MN(TBD-02), Various Developments-Manhattan

PIN# 521159 Neighborhood (MN(TBD-03), Various Developments-Manhattan

PIN# 521160 Neighborhood (QS03), Various Developments-Queens

Indefinite Delivery Indefinite Quantity (IDIQ) Contract for Installation of Vinyl Composition (V/C) Floor Tile in Apartments and Public Spaces Located in various, BX Neighborhoods, BK Neighborhood, MN Neighborhood & Queens Neighborhood, Developments for RFQ Series 521150- 521160.

No Bid Security

NYCHA vendors are contractually obligated to adhere to Section 3 requirements.

NYCHA intends to separately solicit and award a series of Eleven (11) IDIQ contracts for Installation of Vinyl Composition (V/C) Floor Tile in Apartments and Public Spaces pursuant to RFQs: 521150-BX02, 521151-BX05, 521152-BX07, 521153-BK03, 521154-BK07, 521155-BK(TBD-02), 521156-MN01, 521157-MN03, 521158-MN(TBD-02), 521159-MN(TBD-03) & 521160- QS03 (or this "Bid Series").

Contract term: The Contract shall be for a period of three (3) years from the commencement date specified on NYCHA's Notice to Proceed (NTP). NYCHA reserves the right to extend the contract term for up to two (2) additional one-year renewals at its sole discretion.

Contract Award Limitations: NYCHA intends to separately solicit and award a series of Eleven (11) IDIQ contracts for Installation of Vinyl Composition (V/C) Floor Tile in Apartments and Public Spaces pursuant to RFQs: 521150-BX02, 521151-BX05, 521152-BX07, 521153-BK03, 521154-BK07, 521155-BK(TBD-02), 521156-MN01, 521157-MN03, 521158-MN(TBD-02), 521159-MN(TBD-03) & 521160- QS03 (or this "Bid Series").

a. NYCHA has determined, in NYCHA's best interest, that a bidder (a "Bidder") cannot be awarded more than one of the aforementioned (11) IDIQ contracts, irrespective of whether the Bidder submits multiple bids for contract awards in the Bid Series ("Step 1"). Therefore, if the Bidder is awarded one of the IDIQ contracts in the Bid Series in Step 1, the bidder shall be ineligible for the award of any additional IDIQ contracts in the Bid Series, regardless of whether the Bidder is the low bidder on these contracts (the "Additional Contracts"), but subject to Step 2 below.

b. If the bidder would have been the lowest, responsive, responsible Bidder on an Additional Contract but for the award limiting language

in Step 1, and NYCHA (i) has not received any other bids for the Additional Contract or (ii) NYCHA has determined that the next lowest bidder is ineligible for the award of the Additional Contract including, but not limited to, due the Step 1 award limiting language or due to a non-responsive or non-responsibility determination, NYCHA may, at its sole and absolute discretion, award the Additional Contract to the Bidder (“Step 2”).

c. Provided, however, that the Bidder shall not be awarded more than one (1) Additional Contract(s) under Step 2.

Solicitations Subjected to Davis Bacon Prevailing Wage Schedule: Labor Law 220i Registration Certificates and Certification

Bidders are hereby notified that effective as of December 30, 2024, as a precondition to submitting its Bid, the Bidder and each subcontractor identified by the Bidder in its Bid, must be registered with the New York State Department of Labor (“NY DOL”) pursuant to Article 8, Section 220-i of the New York State Labor Law (“LL 220-i”).

Instructions on how to register can be found at <https://dol.ny.gov/contractor-and-subcontractor-landing>.

Current Prevailing Wage Links are posted on iSupplier under the Quick Links Section of Sourcing Supplier. The vendors are responsible for remaining informed of all updates to the Prevailing Wage Schedule.

Pre-qualification: To be considered eligible for the award, a bidder must pre-qualify as an “Approved Supplier via NYCHA-Tile Pre-Qualification List (PQL) and appear on the active approved vendor list <https://www.nycha.gov/site/nycha/business/nycha-pql.page>

Section 3 REO & OEO Plans: Section 3 REO & OEO Plans must be submitted via eComply, <https://nycha.ecomply.us/> and no later than Bid Submission Deadline.

For eComply log-in assistance contact eComply Tech support: support@ecomplysolutions.com

For Section 3 submissions assistance contact NYCHA’s SMP Vendor Diversity team:

ecomply.support@nycha.nyc.gov

Reminder: DO NOT include Section 3 documentation within bid submission via iSupplier.

Pre-Bid Conference:

A non-mandatory Virtual Pre-Bid Conference will be hosted, Friday, May 8, 2026, at 11:00 AM, and will be conducted remotely via Microsoft Teams meeting. Attendance is strongly encouraged and NYCHA requests that Bidders thoroughly review bid documents in advance of the meeting.

RFQ Question Submission Deadline: Wednesday, 05/13/2026 at 2:00 P.M.

Question and Answer Release Date: Wednesday, 05/20/2026 at 2:00 P.M.

To participate in the Pre-Bid Conference, please follow the options below: or outlined in the attachment.

To attend the Pre-Bid Conference either:

Microsoft Teams meeting (Join on your computer or mobile app)

Option 1: Copy and paste the below into your browser

Join: <https://teams.microsoft.com/meet/262624692754554?p=LkeFLRX2lejzTJNJ3R>

Meeting ID: 262 624 692 754 554

Passcode: A7KM74Yc

Option 2: Call In (audio only)

+1 646-838-1534,,711424925# United States, New York City

Phone conference ID: 711 424 925#

Option 3: Access the attached document “TEAMS Meeting Link RFQs 521150-521160.docx” and click on the embedded link to join.

Questions pertaining to this “Solicitation Series, RFQ#521150-521160” and submitted via the NYCHA Cyclical Procurement mailbox at: cyclical.procurement@nycha.nyc.gov (include RFQ number in subject field) prior to Question Deadline will be accepted.

RFQ Question Submission Deadline: Wednesday, 05/13/ 2026 at 2:00 P.M.

Question and Answer Release Date: Wednesday, 05/20/2026 at 2:00 P.M.

Bid Submission Deadline: Wednesday, 05/27/2026 at 11:00 A.M.

In addition to the documents attached below, bidders are directed to review the Special Notices and Conditions, Instructions to Bidders, and General Conditions prior to submitting a bid. To access these documents, click on the “Contract Terms” tab above, and then “Preview Contract Terms,” to download a PDF version.

Please note that in the event NYCHA receives no responses in connection with this RFQ by the “original” bid submission deadline, the bid submission deadline shall be extended automatically for seven (7) calendar days. The foregoing extension does not in any way limit NYCHA’s right to extend the bid submission deadline for any other reason.

Prior to submitting a bid, please confirm that your bid response includes all required forms & Documentation, and that all required forms and documentation are properly completed, signed, and notarized, where applicable.

Reminder: DO NOT include Section 3 documentation within bid submission via iSupplier

Interested vendors are invited to obtain a copy of the opportunity at NYCHA’s website by going to <http://www.nyc.gov/nychabusiness>. On the left side, click on “iSupplier Vendor Registration/Login “ link.(1) If you have an iSupplier account, then click on the “Login for registered vendors” link and sign into your iSupplier account.(2) If you do not have an iSupplier account you can request an account by clicking on “New suppliers register in iSupplier” to apply for log-in credentials. Once you have accessed your iSupplier account, log into your account, then choose under the Oracle Financials home page, the menu option “Sourcing Supplier”, then choose “Sourcing”, then choose Sourcing Homepage”; and conduct a search in the “Search Open Negotiations” box for RFQs: 521150, 521151, 521152, 521153, 521154, 521155, 521156, 521157, 521158, 521159 & b521160 (or this “Bid Series”). Note: We’re accepting only electronic bids submitted online via iSupplier. Paper bids will not be accepted or considered. Please contact NYCHA Procurement at procurement@nycha.nyc.gov for assistance.

Use the following address unless otherwise specified in notice, to secure, examine or submit bid/proposal documents, vendor pre-qualification and other forms; specifications/blueprints; other information; and for opening and reading of bids at date and time specified above.

Housing Authority, 90 Church Street, New York, NY 10007. Bunesh “Tan” Singh (212) 306-4718; bunesh.singh@nycha.nyc.gov

my4

HUMAN RESOURCES ADMINISTRATION

AWARD

Services (other than human services)

IT CONSULTING SERVICES FOR ENTERPRISE DOCUMENT AUTOMATION - Intergovernmental Purchase - PIN# 06926G0043001 - AMT: \$110,830.00 - TO: InfoPeople Corporation, 450 7th Avenue, Suite 1106, New York, NY 10123-0105.

The period of performance will be for thirty-six (36) months from March 1, 2026 to February 28, 2029.

my4

POLICE DEPARTMENT

MANAGEMENT AND BUDGET

SOLICITATION

Services (other than human services)

05626B0004-ARMORED CAR SERVICES FOR CITYWIDE NYPD TOW POUNDS - Competitive Sealed Bids - PIN# 05626B0004 - Due 5-27-26 at 2:00 P.M.

Late Bids will NOT be accepted. This Competitive Sealed Bid (“CSB”) is being released through PASSPort – New York City’s online procurement portal. Responses to this CSB must be submitted via PASSPort. To access the solicitation, vendors should visit the PASSPort Public Portal at <https://www1.nyc.gov/site/mocs/systems/about-go-to-passport.page> and click on the “PASSPort Public” blue button. Once there, click on the “Browse Solicitations” menu selection and enter the CSB EPIN (05626B0004) into the Keywords search field.

my4

PROBATION

JUVENILE OPERATIONS

■ INTENT TO AWARD

Human Services/Client Services

FY26-27 PARENT SUPPORT PROGRAM NAE CONTRACT WITH CCFY - Negotiated Acquisition - Other - PIN# 78126N0005 - Due 5-15-26 at 4:00 P.M.

Pursuant to Section 3-04(b)(2)(iii) of the Procurement Policy Board (PPB) Rules, the New York City Department of Probation (DOP) intends to enter into a Negotiated Acquisition Extension (NAE) with Community Connections For Youth, Inc., (CCFY) for the continued provision of services under the Parent Support Program.

Sourcing EPIN: 78126N0005
Vendor: Community Connections For Youth, Inc.
Vendor Address: 369 E 149th Street, Bronx, New York 10455.

The Parent Support Program is a family-centered, peer-driven intervention designed to support parents and caregivers of justice-involved youth under probation supervision. Under this extension, the provider will continue to deliver individualized, one-on-one coaching and guidance to families, helping them navigate probation requirements, Family Court processes, and related service systems.

Services include ongoing peer coaching, monthly workshops, and connections to community-based resources and benefits beyond DOP. Support is provided both in Family Court locations and within the community to ensure accessibility for families when and where it is needed. CCFY and DOP work with Parent Coaches to provide guidance during both traditional and non-traditional hours, including urgent or time-sensitive situations.

Term: October 1, 2025 through June 30, 2027
Total Contract Amount: \$231,268.50

This NAE is necessary to ensure continuity of critical services while the Department completes a competitive procurement. This notice is for informational purposes only. Vendors interested in expressing interest in this or future procurements for similar services may contact Chairon Jeffrey at cjeffrey@probation.nyc.gov. Organizations are also encouraged to register with the City's digital procurement system, PASSPort, at www.nyc.gov/PASSPort.

my4

FY26-27 PARENT SUPPORT PROGRAM NAE CONTRACT WITH GOOD SHEPHERD SERVICES. - Negotiated Acquisition - Other - PIN# 78126N0003 - Due 5-15-26 at 4:00 P.M.

Pursuant to Section 3-04(b)(2)(iii) of the Procurement Policy Board (PPB) Rules, the New York City Department of Probation (DOP) intends to enter into a Negotiated Acquisition Extension (NAE) with Good Shepherd Services for the continued provision of services under the Parent Support Program.

Sourcing EPIN: 78126N0003
Vendor: Good Shepherd Services
Vendor Address: 305 Seventh Avenue, New York 10001.

The Parent Support Program is a family-centered, peer-driven intervention designed to support parents and caregivers of justice-involved youth under probation supervision. Under this extension, the provider will continue to deliver individualized, one-on-one coaching and guidance to families, helping them navigate probation requirements, Family Court processes, and related service systems.

Services include ongoing peer coaching, monthly workshops, and connections to community-based resources and benefits beyond DOP. Support is provided both in Family Court locations and within the community to ensure accessibility for families when and where it is needed. GSS and DOP work with Parent Coaches to provide guidance during both traditional and non-traditional hours, including urgent or time-sensitive situations.

Term: October 1, 2025 through June 30, 2027
Total Contract Amount: \$560,810.04

This NAE is necessary to ensure continuity of critical services while the Department completes a competitive procurement. This notice is for informational purposes only. Vendors interested in expressing interest in this or future procurements for similar services may contact Chairon Jeffrey at cjeffrey@probation.nyc.gov. Organizations are also encouraged to register with the City's digital procurement system, PASSPort, at www.nyc.gov/PASSPort.

my4

FY26-27 PARENT SUPPORT PROGRAM NAE CONTRACT WITH YOUTH JUSTICE NETWORK, INC. - Negotiated Acquisition - Other - PIN# 78126N0006 - Due 5-15-26 at 4:00 P.M.

Pursuant to Section 3-04(b)(2)(iii) of the Procurement Policy Board (PPB) Rules, the New York City Department of Probation (DOP) intends to enter into a Negotiated Acquisition Extension (NAE) with Youth Justice Network, Inc., for the continued provision of services under the Parent Support Program.

Sourcing EPIN: 78126N0006
Vendor: Youth Justice Network, Inc.
Vendor Address: 63 West 125th Street, New York 10027.

The Parent Support Program is a family-centered, peer-driven intervention designed to support parents and caregivers of justice-involved youth under probation supervision. Under this extension, the provider will continue to deliver individualized, one-on-one coaching and guidance to families, helping them navigate probation requirements, Family Court processes, and related service systems.

Services include ongoing peer coaching, monthly workshops, and connections to community-based resources and benefits beyond DOP. Support is provided both in Family Court locations and within the community to ensure accessibility for families when and where it is needed. YJN and DOP work with Parent Coaches to provide guidance during both traditional and non-traditional hours, including urgent or time-sensitive situations.

Term: October 1, 2025 through June 30, 2027
Total Contract Amount: \$545,470.71

This NAE is necessary to ensure continuity of critical services while the Department completes a competitive procurement. This notice is for informational purposes only. Vendors interested in expressing interest in this or future procurements for similar services may contact Chairon Jeffrey at cjeffrey@probation.nyc.gov. Organizations are also encouraged to register with the City's digital procurement system, PASSPort, at www.nyc.gov/PASSPort.

my4

FY26-27 PARENT SUPPORT PROGRAM NAE CONTRACT WITH JUSTICE INNOVATION, INC. - Negotiated Acquisition - Other - PIN# 78126N0004 - Due 5-15-26 at 4:00 P.M.

Pursuant to Section 3-04(b)(2)(iii) of the Procurement Policy Board (PPB) Rules, the New York City Department of Probation (DOP) intends to enter into a Negotiated Acquisition Extension (NAE) with Justice Innovation, Inc., for the continued provision of services under the Parent Support Program.

Sourcing EPIN: 78126N0004
Vendor: Justice Innovation, Inc.
Vendor Address: 520 8th Avenue, 18th Floor, New York 10018.

The Parent Support Program is a family-centered, peer-driven intervention designed to support parents and caregivers of justice-involved youth under probation supervision. Under this extension, the provider will continue to deliver individualized, one-on-one coaching and guidance to families, helping them navigate probation requirements, Family Court processes, and related service systems.

Services include ongoing peer coaching, monthly workshops, and connections to community-based resources and benefits beyond DOP. Support is provided both in Family Court locations and within the community to ensure accessibility for families when and where it is needed. JI and DOP work with Parent Coaches to provide guidance during both traditional and non-traditional hours, including urgent or time-sensitive situations.

Term: October 1, 2025 through June 30, 2027
Total Contract Amount: \$248,928.73

This NAE is necessary to ensure continuity of critical services while the Department completes a competitive procurement. This notice is for informational purposes only. Vendors interested in expressing interest in this or future procurements for similar services may contact Chairon Jeffrey at cjeffrey@probation.nyc.gov. Organizations are also encouraged to register with the City's digital procurement system, PASSPort, at www.nyc.gov/PASSPort.

my4

FY26-27 PEAK PROGRAM NAE CONTRACT WITH CASES - Negotiated Acquisition - Other - PIN# 78126N0008 - Due 5-15-26 at 4:00 P.M.

Pursuant to Section 3-04(b)(2)(iii) of the Procurement Policy Board (PPB) Rules, the New York City Department of Probation (DOP) intends to enter into a Negotiated Acquisition Extension (NAE) with Center for Alternative Sentencing and Employment Services (CASES) for the continued provision of services under the Pathways to Excellence, Achievement, and Knowledge (PEAK) Program.

Sourcing EPIN: 78126N0008

Vendor: Center for Alternative Sentencing and Employment Services, Inc.

Vendor Address: 25 Chapel Street, Brooklyn, NY 11201

The PEAK Program is an education-focused Alternative to Placement (ATP) intervention designed to support justice-involved youth under probation supervision through structured, community-based programming. Under this extension, CASES will continue to provide comprehensive academic and youth development services in partnership with educational institutions and community-based organizations.

Services include the delivery of a structured daily program that integrates academic instruction, credit recovery, workforce readiness, and social-emotional development. Participants receive individualized support designed to improve school engagement, strengthen life skills, and promote positive behavioral outcomes. Programming is delivered through a combination of classroom-based instruction, enrichment activities, and supportive services that address the educational and developmental needs of participants.

Through participation in the PEAK Program, youth are provided with opportunities to build academic competencies, develop career readiness skills, and establish positive connections to school and community. CASES will coordinate closely with DOP staff and partner organizations to ensure consistent engagement, monitor participant progress, and support successful program completion.

Term: October 1, 2025 through June 30, 2027

Total Contract Amount: \$1,732,163.90

This NAE is necessary to ensure continuity of critical services while the Department completes a competitive procurement. This notice is for informational purposes only. Vendors interested in expressing interest in this or future procurements for similar services may contact Chairon Jeffrey at cjeffrey@probation.nyc.gov. Organizations are also encouraged to register with the City's digital procurement system, PASSPort, at www.nyc.gov/PASSPort.

my4

DOP FY26-27 MOBILE ADOLESCENT THERAPY PROGRAM

NAE CONTRACT WITH CASES - Negotiated Acquisition - Other - PIN# 78126N0013 - Due 5-15-26 at 4:00 P.-M.

Pursuant to Section 3-04(b)(2)(iii) of the Procurement Policy Board (PPB) Rules, the New York City Department of Probation (DOP) intends to enter into a Negotiated Acquisition Extension (NAE) with Center for Alternative Sentencing and Employment Services (CASES) for the continued provision of services under the Mobile Adolescent Therapy (MAT) Program.

Sourcing EPIN: 78126N0013

Vendor: Center for Alternative Sentencing and Employment Services, Inc.

Vendor Address: 25 Chapel Street, Brooklyn, NY 11201

The Mobile Adolescent Therapy (MAT) Program is a community-based therapeutic intervention designed to support justice-involved youth and young adults under probation supervision and their families through intensive, home- and community-based services. Under this extension, CASES will continue to provide strength-based individual and family therapy tailored to meet participants where they are, both geographically and developmentally.

Services focus on addressing substance use, improving family communication and functioning, supporting mental health needs, and challenging behaviors and thought patterns associated with continued justice system involvement. Clinicians work closely with participants and their families to stabilize crises, strengthen relationships, and promote positive behavioral change through individualized treatment planning and consistent engagement.

Term: October 1, 2025 through June 30, 2027

Total Contract Amount: \$459,014.66

This NAE is necessary to ensure continuity of critical services while the Department completes a competitive procurement. This notice is for informational purposes only. Vendors interested in expressing interest in this or future procurements for similar services may contact Chairon Jeffrey at cjeffrey@probation.nyc.gov. Organizations are also encouraged to register with the City's digital procurement system, PASSPort, at www.nyc.gov/PASSPort.

my4

FY26-27 PARENT SUPPORT PROGRAM NAE CONTRACT WITH NYCID - Negotiated Acquisition - Other - PIN# 78126N0007 - Due 5-15-26 at 4:00 P.M.

Pursuant to Section 3-04(b)(2)(iii) of the Procurement Policy Board (PPB) Rules, the New York City Department of Probation (DOP)

intends to enter into a Negotiated Acquisition Extension (NAE) with New York Center for Interpersonal Development, Inc., (NYCID) for the continued provision of services under the Parent Support Program.

Sourcing EPIN: 78126N0007

Vendor: New York Center for Interpersonal Development, Inc.

Vendor Address: 130 Stuyvesant Place, 5th Floor, New York 10301.

The Parent Support Program is a family-centered, peer-driven intervention designed to support parents and caregivers of justice-involved youth under probation supervision. Under this extension, the provider will continue to deliver individualized, one-on-one coaching and guidance to families, helping them navigate probation requirements, Family Court processes, and related service systems.

Services include ongoing peer coaching, monthly workshops, and connections to community-based resources and benefits beyond DOP. Support is provided both in Family Court locations and within the community to ensure accessibility for families when and where it is needed. NYCID and DOP work with Parent Coaches to provide guidance during both traditional and non-traditional hours, including urgent or time-sensitive situations.

Term: October 1, 2025 through June 30, 2027

Total Contract Amount: \$230,230.00

This NAE is necessary to ensure continuity of critical services while the Department completes a competitive procurement. This notice is for informational purposes only. Vendors interested in expressing interest in this or future procurements for similar services may contact Chairon Jeffrey at cjeffrey@probation.nyc.gov. Organizations are also encouraged to register with the City's digital procurement system, PASSPort, at www.nyc.gov/PASSPort.

my4

SANITATION

AGENCY CHIEF CONTRACTING OFFICE

SOLICITATION

Services (other than human services)

COMMERCIAL WASTE ZONE MIDTOWN NORTH AND MANHATTAN SOUTHWEST IMPLEMENTATION - Competitive Sealed Proposals - PIN# 82726CWZMNMS - Due 6-10-26 at 4:00 P.M.

To provide commercial waste hauling services for the Midtown North and/or Manhattan Southwest Commercial Waste Zones ("CWZ"). Services include Refuse, Recycling and Organic Waste collection, transport and removal from commercial establishments.

This RFP is being issued for one award in the Midtown North zone and one award in the Manhattan Southwest zone (two awards in total). DSNY is seeking appropriately experienced and qualified firms to perform a full range of commercial waste collection, transport, removal, and disposal services in either or both the Midtown North and Manhattan Southwest zones.

Deadline to Submit Questions Regarding the RFP: May 13, 2026

Hand-carried Proposals may be delivered to the aforementioned address ONLY between the hours of 9:00 A.M. - 4:30 P.M., Mondays through Fridays, excluding holidays observed by the Department. Please leave extra time to pass through the security checkpoint at the entrance to the building. Proposers are responsible for informing any commercial delivery service, if used, of all delivery requirements and for ensuring that the required address information appears on the outer wrapper or envelope used by such service (see Section V.A.6). The Department will not provide confirmation of receipt of a Proposal, except at the request of the Proposer.

Proposals received after the Proposal Due Date and Time are late and will not be accepted by the Department. Proposers should plan accordingly, to ensure that their proposals are submitted to the Department prior to the Proposal Due Date and Time.

Use the following address unless otherwise specified in notice, to secure, examine or submit bid/proposal documents, vendor pre-qualification and other forms; specifications/blueprints; other information; and for opening and reading of bids at date and time specified above.

Sanitation, 44 Beaver Street, 2nd Floor, Room 201, New York, NY 10004. John Gioia (212) 437-5041; johngioia@dnsny.nyc.gov

a22-my5

SOLID WASTE MANAGEMENT

AWARD

Services (other than human services)

WATER INFRASTRUCTURE OPERATIONS - Negotiated Acquisition - Other - PIN# 82725N0002001 - AMT: \$14,460,000.00 - TO: Inframark LLC, 2002 West Grand Parkway North, Suite 100, Katy, TX 77449.

my4

SCHOOL CONSTRUCTION AUTHORITY

CONTRACT ADMINISTRATION

SOLICITATION

Construction / Construction Services

FLOOD ELIMINATION/PARAPETS/EXTERIOR MASONRY - Competitive Sealed Bids - PIN# SCA26-23415D-1 - Due 5-18-26 at 12:00 P.M.

School: JHS 157 (Queens)

Location: 62-55 102nd Street, Forest Hills, NY 11374

Pre-Bid walk through: May 8, 2026 at 11:00 A.M.

All bidders must be pre-qualified at the time of bid opening.

Use the following address unless otherwise specified in notice, to secure, examine or submit bid/proposal documents, vendor pre-qualification and other forms; specifications/blueprints; other information; and for opening and reading of bids at date and time specified above.

School Construction Authority, 25-01 Jackson Avenue, Long Island City, NY 11101. Raymond Lewis (718) 472-8367; RLewis@nycsca.org

my4

YOUTH AND COMMUNITY DEVELOPMENT

AGENCY CHIEF CONTRACTING OFFICE

AWARD

Human Services / Client Services

FY26 SUMMER YOUTH EMPLOYMENT PROGRAM (SYEP) CONTINUATION PLAN CONTRACT CONSOLIDATION - Negotiated Acquisition - Other - PIN# 26026N0011039 - AMT: \$1,575,509.00 - TO: Young Men's and Women's Hebrew Association of Washington Heights & Inwood, 54 Nagle Avenue, New York, NY 10040-1406.

Summer Youth Employment Program (SYEP) providers through a variety of program models, serves youth ages 14-24 throughout New York City by providing opportunities to become familiar with the world of work, gain employment experience, and identify educational pathways that support career and life goals. This program is integral to the City's workforce development strategy and provides a critical intervention point for underserved youth population.

my4

SUMMER YOUTH EMPLOYMENT PROGRAM (SYEP) CONTINUATION PLAN CONTRACT - Negotiated Acquisition - Other - PIN# 26026N0011065 - AMT: \$1,645,298.00 - TO: Community Association of Progressive Dominicans, 300 East 175th Street, Bronx, NY 10457.

Summer Youth Employment Program (SYEP) providers through a variety of program models, serves youth ages 14-24 throughout New York City by providing opportunities to become familiar with the world of work, gain employment experience, and identify educational pathways that support career and life goals. This program is integral to the City's workforce development strategy and provides a critical intervention point for underserved youth population.

my4

SUMMER YOUTH EMPLOYMENT PROGRAM (SYEP) NAQ - Negotiated Acquisition - Other - PIN# 26026N0011029 - AMT:

\$1,547,313.00 - TO: United Activities Unlimited Inc., 1200 South Avenue, Suite 304, Staten Island, NY 10314.

Summer Youth Employment Program (SYEP) providers through a variety of program models, serves youth ages 14-24 throughout New York City by providing opportunities to become familiar with the world of work, gain employment experience, and identify educational pathways that support career and life goals. This program is integral to the City's workforce development strategy and provides a critical intervention point for underserved youth population.

my4

PUBLIC COMMENT ON CONTRACT AWARDS

FINANCE

NOTICE

This is a notice that NYC Department of Finance is seeking comments from the public about the proposed contract below.

Contract Type: Contract
Contractor: Immediate Mailing Services Inc
Contractor Address: 245 Commerce Blvd, Liverpool, NY 13088
Scope of Services: Printing of Parking Notices & Correspondence Services
Maximum Value: \$ 2,626,800.00
Term: June 1, 2026, through May 31, 2027.
E-PIN: 83626N0001001
Procurement Method: Negotiated Acquisition Extension
Procurement Policy Board Rule: Section 3-04(b)(2)(iii)

How can I comment on this proposed contract award? Please submit your comment to https://forms.office.com/g/WpeeVsNTY4. Be sure to include the E-PIN above in your message.

Comments must be submitted before 5:00 P.M. EST on Monday, May 11, 2026.

my4

HEALTH AND MENTAL HYGIENE

NOTICE

This is a notice that the NYC Department of Health and Mental Hygiene is seeking comments from the public about the proposed contract below.

Contract Type: New Contract
Contractor: Hart Leo LLC
Contractor Address: 4-75 48th Avenue, PH3808, Long Island City, NY 11109
Scope of Services: Hart Leo LLC ("The Contractor") will provide, the New York City Department of Health and Mental Hygiene ("NYC Health Department" or "the Agency"), gift cards to be used as incentives for the Bureau of Hepatitis, HIV and STI (BHHS)'s Programs in the Division of Disease Control, including, but not limited to, Prevention Programs, Ryan White, Viral Hepatitis, Sexually Transmitted Infections (STIs), National HIV Behavioral Surveillance (NHBS), and Expanded Surveillance Projects, City wide.
Maximum Value: \$250,000.00
Term: August 1, 2026 through July 31, 2031, No Renewal
E-PIN: 81626W0035001
Procurement Method: MWBE
Procurement Policy Board Rule: Section 3-08 (c)(1)(iv)

How can I comment on this proposed contract award? Please submit your comment to PublicComment@health.nyc.gov. Be sure to include the E-PIN above in your message.

Comments must be submitted before 2:00 P.M. on Monday, May 11, 2026.

my4

This is a notice that the NYC Department of Health and Mental Hygiene is seeking comments from the public about the proposed contract below.

Contract Type: New Contract
Contractor: New York State Industries for the Disabled Inc
Contractor Address: 11 Columbia Circle Drive, Albany, NY 12203-5156
Scope of Services: Data entry and service of Secondary Notice Violations on mobile food vending units; to be performed at 1231 Lafayette Avenue, Bronx, NY 10474 as specified.
Maximum Value: \$464,500.00
Term: July 1, 2026, through June 30, 2032, with no options to renew
E-PIN: 81626M0013001
Procurement Method: Required Method (Preferred Source)
Procurement Policy Board Rule: Section 1-02(d)(1)

How can I comment on this proposed contract award?
 Please submit your comment to PublicComment@health.nyc.gov. Be sure to include the E-PIN above in your message.

Comments must be submitted before 2.00 P.M. on Monday, May 11, 2026

my4

HOMELESS SERVICES

NOTICE

CORRECTED NOTICE

This is a notice that NYC Department of Homeless Services is seeking comments from the public about the proposed contract listed below.

Contract Type: General Contract – (CT1)
Contractor: BHRAGS Home Care Corp.
Contractor Address: 2005 Nostrand Avenue, Brooklyn, NY 11210
Scope of Services: Shelter Facilities for Homeless Single Adults in Brooklyn, NY
Maximum Value: \$136,504,445.00
Term: 07/01/2026 – 06/30/2031
Renewal Clause: 07/01/2031 – 06/30/2035
E-PIN: 07122P0012029
Procurement Method: Competitive Sealed Proposal
Procurement Policy Board Rule: Section 3-03

How can I comment on this proposed contract award?
 Please submit your comment to PublicComments@dss.nyc.gov. Be sure to include the E-PIN above in your message.

Comments must be submitted before 10:00 A.M. on Monday, May 11, 2026.

my4

HUMAN RESOURCES ADMINISTRATION

NOTICE

This is a notice that Department of Social Services/Human Resources Administration is seeking comments from the public about the proposed contract below.

Contract Type: Contract
Contractor: Absorb Software Inc.
Contractor Address: 520 3 Ave SW, Suite 308, T2P 0R3, Calgary, Canada
Scope of Services: Subscription Services for e-learning Management System '26-'31
Maximum Value: \$994,500.00
Term: 4/1/2026 through 3/31/2031
E-PIN: 06926U0005001
Procurement Method: Subscription
Procurement Policy Board Rule: Section 1-02(f)(5)

How can I comment on this proposed contract award?
 Please submit your comment to PublicComments@dss.nyc.gov. Be sure to include the E-PIN above in your message.

Comments must be submitted before 12:00 P.M. on Friday, May 15, 2026.

my4

INFORMATION TECHNOLOGY AND TELECOMMUNICATIONS

NOTICE

This is a notice that the NYC Office of Technology & Innovation is seeking comments from the public about the proposed contract below.

Contract Type: CT1
Contractor: Compulink Technologies, Inc.
Contractor Address: 260 W 39th St, Room 302, New York, NY 10018
Scope of Services: Starlink Satellite service is necessary for Emergency Command Vehicles during large scale events and emergency response scenarios.
Maximum Value: \$127,972.00
Term: 7/1/2025 to 3/6/2027
E-PIN: 85825W0132001A001
Procurement Method: M/WBE Small Purchase
Procurement Policy Board Rule: Section 3-08 (c)(1)(iv)

How can I comment on this proposed contract award?
 Please submit your comments through the following:
MWBECROLComments@oti.nyc.gov.

Comments must be submitted no later than 10:00 A.M. ET, on Monday, May 11, 2026.

my4

LAW DEPARTMENT

NOTICE

This is a notice that the Law Department is seeking comments from the public about the proposed contract below.

Contract Type: Contract extension
Contractor: The MCS Group, Inc.
Contractor Address: 1601 Market Street, Suite 800, Philadelphia, PA 19103
Scope of Services: Electronic retrieval of medical records
Maximum Value: \$1,800,000.00
Term: 8/31/2025 through 11/30/2026.
E-PIN: 02525N0060001
Procurement Method: Negotiated Acquisition Extension
Procurement Policy Board Rule: Section 3-04(b)(2)(iii)

How can I comment on this proposed contract award?
 Please submit your comments to hsheehan@law.nyc.gov. Be sure to include the E-PIN above in your message.

Comments must be submitted before 5:00 P.M. on Monday, May 11, 2026.

my4

PARKS AND RECREATION

NOTICE

This is a notice that NYC Parks is seeking comments from the public about the proposed contract below.

Contract Type: Contract
Contractor: Prestige Pavers of NYC Inc
Contractor Address: 162-48A 14th Avenue, Whitestone, NY 11357
Scope of Services: X123-124M Noble Playground Water Service Reconstruction, Bronx
Award Amount: \$493,638.00
Term: July 1, 2026 to April 2, 2027
E-PIN: 84626W0031001
Procurement Method: MWBE Small Purchase
Procurement Policy Board Rule: §3-08(c)(1)(iv)

How can I comment on this proposed contract award?
 Please submit your comment to PublicComments.Capital@parks.nyc.gov. Be sure to include the E-PIN above in your message.

Comments must be submitted before 2:00 P.M. on Monday, May 11, 2026.

my4

YOUTH AND COMMUNITY DEVELOPMENT

■ NOTICE

This is a notice that The Department of Youth & Community Development (DYCD) is seeking comments from the public about the proposed contract below.

Contract Type: Contract
Contractor Name: Boxer Inc
Contractor Address: P.O. Box 3913 New York, NY 10163
Scope of Service: The Department of Youth and Community Development (DYCD) will contract with the following provider to provide boxing training and mentoring activities for high-risk youth and young adults, a fitness center for Brownsville residents of all ages, and onsite case management.
Contract Amount: \$3,231,900.00
Term: January 1, 2026 through June 30, 2029
E-PIN: 26026P0002001
Procurement Method: Competitive Sealed Proposal
Procurement Policy Board Rule: Section 3-03

How can I comment on this proposed contract award?
Please submit your comment to <https://forms.office.com/g/4bZPLyJc0z>. Be sure to include the ID # above in your message.

Comments must be submitted before 3:00 P.M. on Monday, May 11, 2026.

my4

AGENCY RULES

BUILDINGS

■ NOTICE

Regulatory Agenda for FY 2027

Pursuant to Section 1042 of the New York City Charter, the NYC Department of Buildings (“the Department”) hereby publishes its Regulatory Agenda for Fiscal Year 2027, which begins on July 1, 2026 and ends on June 30, 2027. The Rules of the New York City Department of Buildings are authorized pursuant to Section 643 of the New York City Charter and are found in Title 1 of the Rules of the City of New York. The Rules are supplementary and include technical determinations as well as administrative procedure necessary to carry out the law.

Promulgation of the following rules and regulations of the Department of Buildings is anticipated by the first day of July 2027:

1. Rule relating to Corrective Action Plans (CAP).

- A. **Reason:** To establish the criteria to request Corrective Action Plans (CAPs). Local Law 79 of 2024 requires rules to establish criteria for when a CAP is required.
- B. **Anticipated contents:** Rule to establish the criteria for requesting Corrective Action Plans (CAPs) from buildings where there is a potential for a hazardous condition or other safety concern.
- C. **Objectives:** Provide professionals and building owners with requirements for inspections, documentation, and reporting of potentially hazardous conditions.
- D. **Legal basis:** Section 643 of the New York City Charter; Article 326 of Chapter 3 of Title 28 of the New York City Administrative Code.
- E. **Types of individuals and entities likely to be affected:** Building owners, registered design professionals, and contractors.
- F. **Other relevant laws:** None
- G. **Approximate schedule:** Second half of FY’27

Contact person: Olga Suto, Assistant Commissioner, Existing Buildings Compliance (212) 393-2621

2. Rule relating to QPSI, QEWI, and QRWI designations.

- A. **Reason:** To establish a fee for applicants to obtain initial and annual renewal of Department designations.
- B. **Anticipated contents:** Rule to be amended to require an initial and annual fee to obtain and renew Qualified Parking Structure Inspector (QPSI), Qualified Exterior Wall Inspector (QEWI) and Qualified Retaining Wall Inspector (QRWI) designations.
- C. **Objectives:** Provide professionals and building owners with requirements for obtaining and renewing Department designations for Qualified Parking Structures, Exterior Wall and Retaining Wall inspectors.
- D. **Legal basis:** Section 643 of the New York City Charter; Article 112 of Chapter 1 of Title 28 of the New York City Administrative Code.
- E. **Types of individuals and entities likely to be affected:** Building owners, registered design professionals, and contractors.
- F. **Other relevant laws:** None
- G. **Approximate schedule:** First half of FY’27

Contact person: Olga Suto, Assistant Commissioner, Existing Buildings Compliance (212) 393-2621

3. Rule relating to verification of zoning lot formation.

- A. **Reason:** To require an applicant for construction document approval in connection with a development or enlargement, or in connection with the issuance of a certificate of occupancy based on a zoning lot with new metes and bounds, to verify proper zoning lot formation in order to comply with the requirements of the New York City Zoning Resolution.
- B. **Anticipated contents:** The proposed rule will state the requirements associated with verification of proper zoning lot formation, including the requirement for a licensed title insurance company to list all zoning lot documents recorded against the property.
- C. **Objectives:** To authorize a verification process, as set forth in a Department Buildings Bulletin, requiring applicants to provide a complete zoning analysis on forms provided by the Department to ensure that a proposed zoning lot does not conflict with an already formed zoning lot.
- D. **Legal basis:** Sections 643 and 1043 of the New York City Charter and sections 28-104.2.4 and 28-104.2.5 of the New York City Administrative Code, which require a complete zoning analysis prior to full or partial construction document approval.
- E. **Types of individuals and entities likely to be affected:** Owners, registered design professionals, title insurance company agents, and land use attorneys who prepare zoning lot exhibits.
- F. **Other relevant laws:** None
- G. **Approximate schedule:** Second half of FY ‘27

Contact person: Shane Rosen-Gould, Assistant General Counsel, (212) 393-6613 |

4. Rule(s) necessary to implement revisions to the Building Code related to sidewalk shed designs and sidewalk shed alternatives.

- A. **Reason:** Recent amendments to Section 3307 of the New York City Building Code seek to encourage use of containment netting as an alternative to the installation of a sidewalk shed in certain scenarios and provide for the specific requirements to be established by rule. Those amendments also authorize the Department to amend sidewalk shed design and construction requirements by rule.
- B. **Anticipated contents:** Requirements regarding the use of containment netting as an alternative to a sidewalk shed, and amendments to the design and construction requirements for sidewalk sheds.
- C. **Objectives:** Establish requirements to further facilitate use of containment netting as an alternative to sidewalk sheds in certain scenarios, and amend existing sidewalk shed design and construction requirements to support the implementation of new design requirements that improve the pedestrian experience while still meeting the safety

requirements for public protection.

- D. Legal Basis: Section 643 of the New York City Charter and Section BC 3307 of the New York City Building Code.
- E. Types of individuals and entities likely to be affected: Building owners, Qualified Exterior Wall Inspectors and other registered design professionals, contractors.
- F. Other relevant laws: Construction Codes.
- G. Approximate schedule: First half of FY'27

Contact person: Dorecia Phillip, Assistant Commissioner, Regulatory and Policy Affairs and Policy Development, (212) 393-2734

5. Rules relating to sustainable building practices.

- A. Reason: The Department oversees a suite of interdependent laws designed to reduce greenhouse gas emissions, increase energy efficiency, and incentivize sustainable building practices, including the Energy Conservation Code, Local Law 97, Local Law 88, Local Law 84, Local Law 33, and Local Law 87.
- B. Anticipated contents: Create and amend rules to clarify and streamline the implementation and enforcement of sustainability laws.
- C. Objectives: Establish procedures for implementation and enforcement of sustainability laws and to align these laws with New York City energy efficiency and greenhouse gas emission reduction goals.
- D. Legal basis: Section 651 of the New York City Charter; Articles 308, 309, 310, 311, 320 and 321 of Chapter 3 of Title 28 of the New York City Administrative Code.
- E. Types of individuals and entities likely to be affected: Building owners, registered design professionals, licensed plumbers, and licensed master and special electricians.
- F. Other relevant laws: New York City Energy Conservation Code and New York City Construction Codes.
- G. Approximate schedule: Throughout FY'27.

Contact person: Beth Golub, Director of Sustainability Policy and Legal Affairs, (212) 323-8910

6. Rule related to implementation of the 2025 NYCECC update.

- A. Reason: Local Law 47 of 2026 amended the Energy Conservation Code to conform with the New York State energy code and accommodate construction requirements unique to New York City. The code updates require rule amendments to bring RCNY 5000 and RCNY 101-07 into alignment with new elements in the code.
- B. Anticipated Contents: The Department will provide rules related to how energy analysis and supporting documentation must be submitted for approval and details for the progress inspections required for energy code compliance during construction.
- C. Objectives: Provide clear rules for industry regarding what needs to be presented in design plans and what progress inspectors need to review in the course of construction.
- D. Legal Basis: Section 651 of the New York City Charter; New York City Administrative Code 28-1001.2
- E. Types of individuals and entities likely to be affected: Architects, Engineers, Building Owners.
- F. Other Relevant Laws: None
- G. Approximate Schedule: First Quarter of FY '27

Contact person: Beth Golub, Director of Sustainability Policy and Legal Affairs, (212) 323-8910

7. Rule related to Local Law 23 of 2026 cooling systems in tenant occupied dwellings.

- A. Reason: Local Law 23 of 2026 relates to cooling equipment in tenant occupied spaces and requires the Department to promulgate rules defining the capacity of such cooling systems that complies with existing Building Code requirements.
- B. Anticipated Contents: The Department will establish installation requirements for centrally-supplied cooling equipment, ensuring that such equipment complies with applicable Building Code provisions.

C. Objectives: Provide clarity on compliance requirements.

- D. Legal Basis: Section 651 of the New York City Charter; New York City Administrative Code Article 27-2030
- E. Types of individuals and entities likely to be affected: Building owners, registered design professionals, licensed plumbers, and licensed master and special electricians.
- F. Other Relevant Laws: New York City Energy Conservation Code and New York City Construction Codes.
- G. Approximate Schedule: Second Quarter of FY '27

Contact person: Beth Golub, Director of Sustainability Policy and Legal Affairs, (212) 323-8910

8. Rule related to temporary program for basements and cellars in existing 1- or 2-family residence.

- A. Reason: Local Law 126 of 2024 requires rules to implement basement apartment pilot.
- B. Anticipated contents: Rule to add standards for basement and cellar apartments in one- or two-family homes and will allow tenants to live in eligible basement or cellar apartments while they are brought up to standard, with a clear deadline for meeting each of the requirements to enter into a temporary residence program pursuant to LL 126.
- C. Objectives: Set standards for homeowners to bring their eligible basement and cellar apartments up to code standards to allow such apartments to be legally occupied.
- D. Legal basis: Section 643 of the New York City Charter; Article 507 of Chapter 5 of Title 28 of the New York City Administrative Code.
- E. Types of individuals and entities likely to be affected: Building owners.
- F. Other relevant laws: None
- G. Approximate schedule: Second half of FY'27

Contact person: Gus Sirakis, Deputy Commissioner, Development and Technical Affairs (212) 393-2653

9. Rule related to temporary program for basements and cellars in multiple dwellings.

- A. Reason: Local Law 126 of 2024 requires rules to implement basement apartment pilot in multiple dwellings.
- B. Anticipated contents: Rule to add standards for basement and cellar apartments in multiple dwellings and will allow tenants to live in eligible basement or cellar apartments while they are brought up to standard, with a clear deadline for meeting each of the requirements to enter into a temporary residence program pursuant to LL 126.
- C. Objectives: Set standards for owners of multiple dwellings to bring their eligible basement and cellar apartments up to code standards to allow such apartments to be legally occupied.
- D. Legal basis: Section 643 of the New York City Charter; Article 507 of Chapter 5 of Title 28 of the New York City Administrative Code.
- E. Types of individuals and entities likely to be affected: Building owners.
- F. Other relevant laws: None
- G. Approximate schedule: Second half of FY'27

Contact person: Gus Sirakis, Deputy Commissioner, Development and Technical Affairs (212) 393-2653

10. Rule related to manufactured (modular) homes used as Ancillary Dwelling Units (ADUs).

- A. Reason: Local Law 127 of 2024 requires rules for manufactured (modular) homes used as Ancillary Dwelling Units (ADUs).
- B. Anticipated contents: Rule to establish the criteria for manufactured (modular) homes to be used as ADUs.
- C. Objectives: Set standards for developers and building owners to install manufactured (modular) homes to be used as ADUs.
- D. Legal basis: Section 643 of the New York City Charter; Appendix U of the New York City Building Code.
- E. Types of individuals and entities likely to be affected: Building owners, developers.
- F. Other relevant laws: None

G. Approximate schedule: Second half of FY'27
Contact person: Gus Sirakis, Deputy Commissioner, Development and Technical Affairs (212) 393-2653

11. Rule relating to incomplete inspections.

- A. Reason: To address situations where an electrical, plumbing or construction inspection cannot be completed because the permit holder or licensee is not prepared or willing to assist Department inspectors in conducting the inspection, or cannot provide full access to the permitted work.
- B. Anticipated contents: Rule to establish a fee of \$200 for each incomplete inspection and a procedure to bar a licensee's business from filing new permits or requesting new inspections until all fees are paid.
- C. Objectives: Reduce impacts on the Department's inspection staff by incentivizing compliance with inspection requirements and schedules.
- D. Legal basis: Section 643 of the New York City Charter; Section 28-116.3 of the New York City Administrative Code.
- E. Types of individuals and entities likely to be affected: Permittees, licensees, registered design professionals, building owners and contractors.
- F. Other relevant laws: None
- G. Approximate schedule: Second half of FY'27

Contact person: Dawn Davidson, Executive Project Manager, Strategic Planning, (212) 393-2045

12. Rule relating to natural gas detectors.

- A. Reason: Local Law 102 of 2025 extended the deadline for the installation of natural gas detector devices to January 1, 2027 from May 1, 2025.
- B. Anticipated contents: Rule to amend the installation deadline to conform to changes from LL 102 and to make additional changes requested by the Department's technical unit.
- C. Objectives: amend the installation deadline to conform to changes from LL 102 and to make additional changes requested by the Department's technical unit.
- D. Legal basis: Section 643 of the New York City Charter; Section 28-315.2.4 of the New York City Administrative Code.
- E. Types of individuals and entities likely to be affected: Building owners.
- F. Other relevant laws: None
- G. Approximate schedule: First half of FY'27

Contact person: Laura Grieco, Director, Engineering (212) 393-2674

13. Rule relating to OATH summons violation schedule update.

- A. Reason: To amend the penalty schedule to align with §28-202.1 of the Admin. Code and to make other needed additions and amendments, including ones related to small businesses.
- B. Anticipated contents: Rule to amend the penalty schedule to align with §28-202.1 of the Admin. Code and to make other needed additions and amendments, including ones related to small businesses.
- C. Objectives: To align the penalty schedule with §28-202.1 of the Admin. Code and to make other needed additions and amendments.
- D. Legal basis: Section 643 of the New York City Charter; Section 28-202.1 of the New York City Administrative Code.
- E. Types of individuals and entities likely to be affected: Building owners, registered design professionals, and contractors.
- F. Other relevant laws: None
- G. Approximate schedule: First half of FY'27

Contact person: Shamonda Graham, Executive Director, Administrative Enforcement, (212) 720-0655

14. Rule to add or amend fees.

- A. Reason: To amend various department fees identified through internal review to align with changes to processes and procedures.
- B. Anticipated contents: Amend existing fees and add new fees.

- C. Objectives: Amend existing fees and add new fees.
- D. Legal basis: Section 643 of the New York City Charter; Article 112 of Chapter 1 of Title 28 of the New York City Administrative Code.
- E. Types of individuals and entities likely to be affected: Building owners, registered design professionals, licensees and contractors.
- F. Other relevant laws: None
- G. Approximate schedule: Throughout FY'27

Contact person: Allan (Michele) Clarke, Director, Revenue Planning and Compliance, (212) 393-2154

15. Rules necessary to implement the NYC Existing Building Code.

- A. Reason: To align the department's rules with the new code requirements.
- B. Anticipated contents: Requirements necessary to implement the NYC Existing Building Code.
- C. Objectives: Amend existing rules and adopt new rules necessary to implement the requirements of the new NYC Existing Building Code.
- D. Legal basis: Section 643 of the New York City Charter, Local Laws 33 and 42 of 2026
- E. Types of individuals and entities likely to be affected: Building owners, tenants, registered design professionals, permittees, licensees and contractors.
- F. Other relevant laws: None.
- G. Approximate schedule: Throughout FY'26.

Contact person: Dawn Davidson, Executive Project Manager, Strategic Planning, (212) 393-2045

16. Rule relating to facades.

- A. Reason: To incorporate changes to the façade rule suggested by a Department consultant's review.
- B. Anticipated contents: Changes suggested by a Department consultant.
- C. Objectives: To incorporate changes to the façade rule suggested by a Department consultant's review.
- D. Legal basis: Section 643 of the New York City Charter; Article 302 of Chapter 3 of Title 28 of the New York City Administrative Code.
- E. Types of individuals and entities likely to be affected: Building owners, registered design professionals, and contractors.
- F. Other relevant laws: None
- G. Approximate schedule: Second half of FY'27

Contact person: Yegal Shamash, First Deputy Commissioner, (212) 393-2609

17. Rule relating to site safety manager license qualifications.

- A. Reason: To clarify when the required 18-month training program must be completed.
- B. Anticipated contents: Clarification of when the required 18-month training program must be completed.
- C. Objectives: To clarify when the required 18-month training program must be completed.
- D. Legal basis: Section 643 of the New York City Charter; Article 402 of Chapter 4 of Title 28 of the New York City Administrative Code.
- E. Types of individuals and entities likely to be affected: Applicants for a site safety license.
- F. Other relevant laws: None
- G. Approximate schedule: First half of FY'27

Contact person: Charles Shelhamer, Deputy Director of Code Development, (212) 393-2113

TRANSPORTATION

■ PUBLIC HEARINGS

Notice of Public Hearing and Opportunity to Comment on Proposed Rules

What are we proposing? This proposed rule would amend section 4-13 of Chapter 4 of Title 34 of the Rules of the City of New York (“34 RCNY”) to update the citywide truck routes.

When and where is the hearing? The New York City Department of Transportation (“DOT”) will hold a public hearing on the proposed rule online. The public hearing will take place on Tuesday, June 9, 2026 at 10:00 A.M.

Join through Internet:

- To join the hearing via your browser, either click on the following URL link or copy and paste it into your browser’s address bar.
Join Zoom Meeting
<https://zoom.us/j/94927193122?pwd=Bb3jcvqh26hLbkFFwU6ZpU80XZG1aW.1>
Meeting ID: 949 2719 3122
Passcode: 347920
- Then follow the prompts.
- If you have low bandwidth or inconsistent Internet connection, we suggest you use the “Call-in” option for the hearing.

Join via phone only:

- To join the meeting only by phone, use the following information to connect:
Phone: 1-929-205-6099
Access code:
Password:

How do I comment on the proposed rules? Anyone can comment on the proposed rules by:

- Website.** You can submit comments to DOT through the NYC rules website at <http://rules.cityofnewyork.us>.
- Email.** You can email comments to rules@dot.nyc.gov.
- Mail.** You can mail comments to Stephen Solecki, Deputy Director, Freight Corridor Initiatives & Operations, New York City Department of Transportation, 55 Water Street, 6th Floor, New York, NY 10041.
- Fax.** You can fax comments to Stephen Solecki at (212) 839-9685.
- By speaking at the hearing.** Anyone who wants to comment on the proposed rule at the public hearing must sign up to speak. You can sign up before the hearing by emailing rules@dot.nyc.gov by June 8, 2026 and including your name and affiliation. While you will be given an opportunity during the hearing to indicate that you would like to provide comments, we prefer that you sign up in advance. You can speak for up to three minutes. Please note that the hearing is for accepting oral testimony only and is not held in a “Question and Answer” format.

Is there a deadline to submit written comments? The deadline for written comments is 5 p.m. on June 9, 2026.

Do you need assistance to participate in the hearing? You must tell the DOT Office of the General Counsel if you need a reasonable accommodation of a disability during the hearing. You must tell us if you need a sign language interpreter. You can tell us by e-mailing at rules@dot.nyc.gov. If you wish to receive a reasonable accommodation, you must do so by Tuesday, June 2, 2026.

Can I review the comments made on the proposed rules? You can review the comments made online on the proposed rules by going to the website at <http://rules.cityofnewyork.us/>. Copies of all comments submitted online, copies of all written comments, and a recording of the hearing may be requested by emailing rules@dot.nyc.gov.

What authorizes DOT to make this rule? Section 2903(a) of the New York City Charter (City Charter) authorizes DOT to make this proposed rule. This proposed rule was included in DOT’s regulatory agenda.

Where can I find DOT’s rules? DOT’s rules are in Title 34 of the Rules of the City of New York.

What rules govern the rulemaking process? DOT must meet the requirements of Section 1043 of the City Charter when creating or changing rules. This notice is made according to the requirements of

Section 1043(b) of the City Charter.

Statement of Basis and Purpose of Proposed Rule

The Commissioner of the New York City Department of Transportation (“DOT”) is authorized to promulgate rules regarding parking and traffic operations in the City pursuant to Section 2903(a) of the New York City Charter. The rules that DOT is seeking to amend are contained within Chapter 4 of Title 34 of the Rules of the City of New York (“Traffic Rules”).

These rules are proposed pursuant to Local Law 171 of 2023 (“Local Law 171”), which required DOT “to redesign the city truck route network and make any changes to such network that the department determines would enhance safety, increase visibility, reduce traffic congestion, reduce vehicle miles traveled, or otherwise facilitate the conduct of vehicular traffic within the city truck route network.” Local Law 171 required DOT to consult with specified agencies and other interested groups in conducting this redesign and to publish a report on the proposed redesign prior to its adoption. DOT published a report titled New York City Truck Route Network Redesign on November 26, 2025. This report presents DOT’s findings, analyses, and recommendations to improve freight movement while simultaneously promoting safety, efficiency, and sustainability across the five boroughs. The findings and recommendations set forth in the report are the basis for the proposed rule.

The proposed rule would amend section 4-13 of the rules to update the truck route tables—removing old routes and adding new ones—in the “Street” and “Limit” columns. These route changes are being proposed to promote safety, efficiency, and sustainability. Further explanation is provided in the DOT report, which is available at <https://www.nyc.gov/html/dot/downloads/pdf/truck-network-redesign-report.pdf>.

The proposed rule would also update the language in section 4-13 to replace binary pronouns with gender-inclusive pronouns. Specifically, amendments would be made to section 4-13 as follows:

- Section 4-13(b) would be amended by updating “Through Truck Routes” and “Local Truck Routes” for the Borough of Queens.
- Section 4-13(c) would be amended by updating “Through Truck Routes” and “Local Truck Routes” for the Borough of Staten Island.
- Section 4-13(d) would be amended by updating “Through Truck Routes” and “Local Truck Routes” for the Borough of Manhattan.
- Section 4-13(e) would be amended by updating “Through Truck Routes” and “Local Truck Routes” for the Borough of Brooklyn.
- Section 4-13(f) would be amended by updating “Through Truck Routes” and “Local Truck Routes” for the Borough of the Bronx.

New material is underlined.

[Deleted material is in brackets.]

Asterisks (***) indicate unamended text.

Section 1. Subdivision (b) of section 4-13 of chapter 4 of Title 34 of the Rules of the City of New York is amended to read as follows:

(b) *Truck routing rules for the Borough of Queens.*

(1) *Through trucks.* An operator of any truck as defined above, having neither an origin nor a destination within the Borough of Queens shall restrict the operation of such vehicle to those street segments on the following list. These are designated as “Through Truck Routes.” All trucks must adhere to all posted signs indicating locations that limit the height of vehicles permitted to operate thereon.

THROUGH TRUCK ROUTE NETWORK

| Street | Limits |
|------------------------------------------------|----------------------------------------------------------------------------------------------------------------------------|
| Astoria [Blvd.] Boulevard (North and South) | [29th St.] <u>21st Street</u> to Northern [Blvd.] Boulevard |
| Atlantic Avenue | [Kings County Line] <u>Eldert Lane</u> to Van Wyck Expressway |
| Beach Channel Drive | Marine [Pkway] <u>Parkway Bridge</u> to <u>Beach 84th Street</u> and <u>Beach 79th Street</u> to Nassau County Line |
| <u>Borden Avenue</u> | <u>Long Island Expressway</u> to <u>60th Street</u> |
| Braddock Avenue | Hillside Avenue to [Jamaica Avenue] <u>Jericho Turnpike</u> |
| Bradley Avenue | Greenpoint Avenue to Van Dam Street |

| | |
|-------------------------------------------------------------|------------------------------------------------------------------------------------------------|
| [Bridge Plaza South] | [Queensboro Bridge to Jackson Avenue] |
| Brooklyn-Queens Expressway | Kings County Line to Astoria Boulevard (North and South) |
| Clearview Expressway | Throgs Neck Bridge to Hillside Avenue |
| Crescent Street | 41st Avenue to Bridge Plaza |
| Cross Island Parkway Service Roads | Whitestone Expressway to Francis Lewis Boulevard |
| <u>Eliot Avenue</u> | <u>Long Island Expressway to Queens Boulevard</u> |
| Francis Lewis Boulevard | Cross Island Parkway Service Road to Springfield Boulevard |
| Grand Central Parkway | Triborough Bridge to the Brooklyn-Queens Expressway (western leg) |
| Greenpoint Avenue | Van Dam Street to Queens Boulevard |
| Hempstead Avenue | Jamaica Avenue to Nassau County Line |
| Hillside Avenue | Myrtle Avenue to [Nassau County] <u>City Line</u> |
| Hoyt Avenue (North and South) | Astoria Boulevard to 21st Street |
| Jackson Avenue | [Borden Avenue] <u>Vernon Boulevard</u> to [Northern] <u>Queens Boulevard</u> |
| Jamaica Avenue | Francis Lewis Boulevard to [Nassau County Line] <u>Jericho Turnpike</u> |
| <u>Jericho Turnpike</u> | <u>Jamaica Avenue to 257th Street</u> |
| Linden Boulevard | [Kings County Line] <u>Sapphire Street</u> to North and South Conduit Avenue |
| Long Island Expressway (<u>Queens Midtown Expressway</u>) | Queens Midtown Tunnel to [Nassau County] <u>City Line</u> |
| <u>Marina Road</u> | <u>Northern Boulevard to Van Wyck Expressway</u> |
| Myrtle Avenue | [Kings County Line] <u>Wyckoff Avenue</u> to Hillside Avenue |
| <u>Nassau Expressway</u> | <u>South Conduit Avenue to Farmers Boulevard and North Conduit Avenue to Farmers Boulevard</u> |
| North [and South] Conduit Avenue [(Sunrise Highway)] | [Linden] <u>Conduit Boulevard</u> to [Nassau County Line] <u>Sunrise Highway</u> |
| Northern Boulevard | [Jackson Avenue] <u>41st Street</u> to [Nassau County Line] <u>Glenwood Street</u> |
| Queens Boulevard | Jackson Avenue to Hillside Avenue |
| <u>Queens Plaza East (Northern Boulevard)</u> | <u>41st Avenue to Queens Boulevard</u> |
| <u>Queens Plaza North</u> | <u>Queensboro Bridge to Northern Boulevard</u> |
| <u>Queens Plaza South</u> | <u>Queensboro Bridge to Jackson Avenue</u> |
| Rockaway Boulevard | North and South Conduit Avenue to [Nassau County] <u>City Line</u> |
| <u>Rockaway Freeway (Beach Channel Drive)</u> | <u>Beach 84th Street to Beach 79th Street</u> |
| <u>South Conduit Avenue</u> | <u>Conduit Boulevard to Cross Bay Boulevard and Nassau Expressway to City Line</u> |
| <u>Sunrise Highway</u> | <u>North Conduit Avenue to Nassau County Line</u> |

| | |
|-------------------------|--------------------------------------------------------------------------------------|
| Springfield Boulevard | Jamaica Avenue to North and South Conduit Avenues |
| Thomson Avenue | [Jackson Avenue] <u>44th Drive</u> to Queens Boulevard |
| Van Dam Street | Greenpoint Avenue to Queens Boulevard |
| Van Wyck Expressway | Whitestone Expressway to North and South Conduit Avenues |
| <u>Vernon Boulevard</u> | <u>Borden Avenue to Jackson Avenue</u> |
| Whitestone Expressway | Whitestone Bridge to Astoria Boulevard |
| 21st Street | [Borden Avenue] <u>Queens Midtown Expressway</u> to [24th Avenue] <u>41st Street</u> |
| 24th Avenue | 21st Street to 29th Street |
| 29th Street | 24th Avenue to <u>Hoyt Avenue North and Hoyt Avenue South</u> to Astoria Boulevard |
| 41st Avenue | 21st Street to Crescent Street |
| <u>68th Street</u> | <u>Brooklyn Queens Expressway to Northern Boulevard</u> |
| [213th Street] | [Hempstead Avenue to Jamaica Avenue] |

(2) *Local trucks.* An operator of any truck as defined in paragraph (a)(1) above, with an origin or destination for the purpose of delivery, loading, or servicing within the Borough of Queens, shall only operate such vehicle over the street segments designated as “Through Truck Routes” in paragraph (b)(1) above and the following streets listed [streets] as “Local Truck Routes”, except that an operator may operate on a street not designated below for the purpose of arriving at [his/her] the destination. This shall be accomplished by leaving a designated truck route at the intersection that is nearest and provides the most direct route to [his/her] the destination, proceeding by the most direct route while observing existing street directions and turn restrictions, and then returning to the nearest designated truck route by the most direct route. If the operator has additional destinations in the immediate vicinity, [he/she] they may proceed by the most direct route to [his/her] the next destination without returning to a designated truck route, provided that the operator’s next destination does not require that [he/she] they cross a designated truck route. All trucks must adhere to all posted signs indicating locations that limit the height of vehicles permitted to operate thereon.

LOCAL TRUCK ROUTE NETWORK

| Street | Limits |
|----------------------------------------------------|-------------------------------------------------------------------------------------------------------------------------------------|
| Astoria [Blvd.] <u>Boulevard</u> (North and South) | 8th Street to [Northern Boulevard] <u>21st Street</u> |
| [Atlantic Avenue] | [Kings County Line to Van Wyck Expressway] |
| Baisley Boulevard | Rockaway Boulevard to Merrick Boulevard |
| [Beach Channel Drive] | [Marine Pkwy Bridge to Nassau County Line] |
| Borden Avenue | 2nd Street to [Greenpoint Avenue] <u>Long Island Expressway Exit 17, 54th Avenue to 63rd Street, and 58th Street to 69th Street</u> |
| [Braddock Avenue] | [Hillside Avenue to Jamaica Avenue] |
| Bradley Avenue | Greenpoint Avenue to Van Dam Street |
| [Bridge Plaza] | [Queensboro Bridge to Jackson Avenue] |
| Broadway | Vernon Boulevard to Queens Boulevard |
| [Brooklyn-Queens Expressway] | [Kings County Line to Astoria Boulevard (North and South)] |
| Central Avenue | Myrtle Avenue to Cooper Avenue |

| | |
|-------------------------------------------|----------------------------------------------------------------------------------------------------------------------------------------------------------|
| [Clearview Expressway] | [Throgs Neck Bridge to Hillside Avenue] |
| Clintonville Street | Cross Island Parkway South Service Road to 7th Avenue |
| College Point [Avenue] Boulevard | Long Island Expressway to 14th Avenue |
| Cooper Avenue | [Kings County Line] <u>Irving Avenue</u> to Woodhaven Boulevard |
| [Crescent Street] | [41st Avenue to Bridge Plaza] |
| Cross Bay Boulevard | [Liberty Avenue] <u>Rockaway Boulevard</u> to Beach Channel Drive |
| [Cross Island Pkwy. Service Rds.] | [Whitestone Expressway to Francis Lewis Boulevard] |
| Cypress Avenue | Flushing Avenue to Cooper Avenue |
| <u>Cypress Hills Street</u> | <u>65th Place to Cooper Avenue</u> |
| Ditmars Boulevard | 49th Street to Hazen Street, and <u>81st Street to 23rd Avenue</u> |
| [Ditmars Boulevard] | [81st Street to 23rd Avenue] |
| [Dunkirk Street] | [Liberty Avenue to Linden Boulevard] |
| Farmers Boulevard | Liberty Avenue to [North and South Conduit Avenue] <u>Rockaway Boulevard</u> |
| Flushing Avenue | [Kings County Line] <u>Seneca Avenue</u> to 55th Street |
| [Francis Lewis Boulevard] | [Cross Island Parkway Service Roads to Springfield Boulevard] |
| Fresh Pond Road | Metropolitan Avenue to Myrtle Avenue |
| Grand Avenue | [Kings County Line] <u>Grand Street</u> to Rust Street, and <u>55th Drive (Borden Avenue/Queens Midtown Expressway Service Road) to Queens Boulevard</u> |
| [Grand Avenue] | [Borden Avenue to Queens Boulevard] |
| <u>Grand Central Parkway Service Road</u> | <u>Astoria Boulevard North to 82nd Street</u> |
| [Greenpoint Avenue] | [Van Dam Street to Queens Boulevard] |
| Guy R. Brewer Boulevard | Liberty Avenue to North and South Conduit Avenue |
| Hazen Street | 20th Avenue to Astoria Boulevard <u>North</u> |
| [Hempstead Avenue] | [Jamaica Avenue to Nassau County Line] |
| [Hillside Avenue] | [Myrtle Avenue to Nassau County Line] |
| Hoyt Avenue (North and South) | Astoria Boulevard to 21st Street |
| [Jackson Avenue] | [Borden Avenue to Northern Boulevard] |
| Jamaica Avenue | Merrick Boulevard to [Nassau County Line] <u>Francis Lewis Boulevard</u> |
| Junction Boulevard | 32nd Avenue to Queens Boulevard |
| Kissena Boulevard | Main Street to Parsons Boulevard |
| <u>Laurel Hill Boulevard</u> | <u>Review Avenue to 54th Avenue</u> |
| <u>Lefferts Boulevard</u> | <u>North Conduit Avenue to South Conduit Avenue</u> |
| Liberty Avenue | Van Wyck Expressway to [Farmers Boulevard] <u>Hilburn Avenue</u> |
| Linden Boulevard | Kings County Line to North and South Conduit Avenues [and Newburg Street to Farmers Boulevard] |
| Linden Place | Whitestone Expressway to Northern Boulevard |
| [Long Island Expressway] | [Queens Midtown Tunnel to Nassau County Line] |

| | |
|--------------------------------------------------|--------------------------------------------------------------------------------------------------------|
| Main Avenue | Vernon Boulevard to Astoria Boulevard |
| Main Street | Northern Boulevard to Queens Boulevard |
| [Maurice Avenue] | [L.I.E. to 56th Terrace] |
| Maspeth Avenue | [49th Street] 48th Street to <u>58th Street</u> |
| [Maspeth Avenue] | [Page Place to Maurice Avenue] |
| <u>Maurice Avenue</u> | <u>Queens Midtown Expressway to 58th Street</u> |
| Merrick Boulevard | Hillside Avenue to [Nassau County Line] <u>Hook Creek Boulevard</u> |
| Metropolitan Avenue | [Kings County Line] <u>Onderdonk Avenue</u> to Hillside Avenue |
| [Myrtle Avenue] | [Kings County Line to Hillside Avenue] |
| North and South Conduit Avenue (Sunrise Highway) | Linden Boulevard to [Nassau County] City Line |
| [Northern Boulevard] | [Jackson Avenue to Nassau County Line] |
| Page Place | Grand Avenue to Maspeth Avenue |
| Parsons Boulevard | Kissena Boulevard to Union Turnpike |
| [Queens Boulevard] | [Jackson Avenue to Hillside Avenue] |
| <u>Queens Plaza North</u> | <u>Queensboro Bridge to Northern Boulevard</u> |
| <u>Queens Plaza South</u> | <u>Queensboro Bridge to Jackson Avenue</u> |
| Review Avenue | Borden Avenue to Laurel Hill Boulevard |
| Rockaway Boulevard | Atlantic Avenue to [Nassau County Line] <u>North and South Conduit Avenues</u> |
| Roosevelt Avenue | Queens Boulevard to Main Street |
| Rust Street | [58th Street] <u>56th Drive</u> to [Flushing Avenue] <u>Grand Avenue</u> |
| [Rust Street] | [56th Terrace to 58th Street] |
| <u>Saint Felix Avenue</u> | <u>Copper Avenue to Cypress Avenue</u> |
| [Springfield Boulevard] | [Jamaica Avenue to North and South Conduit Avenue] |
| <u>Starr Avenue</u> | <u>Van Dam Street to Borden Avenue</u> |
| Steinway Street | Northern [Blvd.] <u>Boulevard</u> to [Astoria Blvd. North] <u>19th Avenue</u> |
| [Steinway Street] | [Astoria Blvd. North to 19th Avenue] |
| <u>Sutter Avenue</u> | <u>North Conduit Avenue to Kings County Line</u> |
| Sutphin Boulevard | 94th Avenue to Liberty Avenue |
| [Thomson Avenue] | [Jackson Avenue to Queens Boulevard] |
| Union Turnpike | Myrtle Avenue to [Nassau County Line] <u>Lakeville Road</u> |
| [Van Dam Street] | [Queens Boulevard to Greenpoint Avenue] |
| Van Wyck Expressway | [Whitestone Expressway] <u>North and South Conduit Avenue</u> to John F. Kennedy International Airport |
| Vernon Boulevard | Borden Avenue to [8th Street] <u>Main Avenue</u> |
| [Whitestone Expressway] | [Whitestone Bridge to Astoria Boulevard] |
| Willets Point Boulevard | [Roosevelt Avenue] <u>127th Street</u> to Northern Boulevard |
| Woodhaven Boulevard | [Liberty Avenue] <u>Rockaway Boulevard</u> to Queens Boulevard |

| | |
|--------------------|--------------------------------------------------------------------------------------------------------|
| 8th Street | Astoria Boulevard to [Vernon Boulevard] <u>Main Avenue</u> |
| <u>10th Street</u> | <u>10th Street</u> <u>44th Drive to Vernon Boulevard</u> |
| 14th Road | College Point Boulevard to 110th Street |
| 14th Avenue | Cross Island Parkway Service Road to Whitestone Expressway and College Point Boulevard to 110th Street |
| 15th Avenue | College Point Boulevard to [110th] <u>110th Street</u> |
| 19th Avenue | Steinway Street to 81st Street |
| 20th Avenue | 21st Street to Hazen Street, and <u>Whitestone Expressway to College Point Boulevard</u> |
| [20th Avenue] | [Whitestone Expressway to College Point Boulevard] |
| 21st Street | [Borden Avenue] <u>24th Avenue</u> to 20th Avenue |
| 23rd Avenue | Astoria Boulevard South to [Ditmars Boulevard] <u>82nd Street</u> |
| [24th Avenue] | [21st Street to 29th Street] |
| [29th Street] | [24th Avenue to Astoria Boulevard] |
| <u>32nd Street</u> | <u>Astoria Boulevard North to Astoria Boulevard South</u> |
| <u>38th Avenue</u> | <u>Northern Boulevard to Vernon Boulevard</u> |
| 39th Street | Queens Boulevard to Northern Boulevard |
| [41st Avenue] | [21st Street to Crescent Street] |
| 43rd Street | 53rd Avenue to [54th Avenue] <u>56th Road</u> |
| <u>44th Drive</u> | <u>Vernon Boulevard to Thomson Avenue</u> |
| 47th Street | Grand Avenue to 58th Road |
| 48th Street | [Long Island Expressway to 55th] <u>53rd Avenue to 56th Road and Maspeth Avenue to 58th Road</u> |
| [48th Street] | [Maspeth Avenue to 58th Road and 55th Avenue to 56th Road] |
| 49th Street | Ditmars Boulevard to Astoria Boulevard South, and <u>Maspeth Avenue to 56th Road</u> |
| [49th Street] | [Maspeth Avenue to 56th Road] |
| 53rd Avenue | 43rd Street to 48th Street |
| 54th Avenue | Laurel Hill Boulevard to 43rd Street, and <u>58th Street to Borden Avenue</u> |
| 54th Street | Flushing Avenue to Grand Avenue |
| 55th Avenue | 48th Street to 58th Street |
| 55th Drive | [Maurice] <u>Borden Avenue</u> to [58th Street] <u>Grand Avenue</u> |
| 55th Street | Flushing Avenue to Grand Avenue |
| 56th Drive | 56th Road to 58th Street |
| 56th Road | Laurel Hill Boulevard to 56th Drive |
| [56th Road] | [56th Drive to 56th Terrace] |
| 56th Terrace | 58th Street to Rust Street |
| 57th Place | Maspeth Avenue to Rust Street |
| 58th Road | 47th Street to 48th Street |
| 58th Street | Queens Boulevard to Maspeth Avenue |
| 62nd Drive | Junction Boulevard to Queens Boulevard |

| | |
|----------------------------------------------------------------|----------------------------------------------------------------|
| <u>65th Place</u> | <u>Laurel Hill Boulevard to Queens Boulevard</u> |
| 69th Street | Long Island Expressway to Metropolitan [Ave.] <u>Avenue</u> |
| <u>73rd Place</u> | <u>Cooper Avenue to Cooper Avenue (Central Avenue)</u> |
| <u>82nd Street</u> | <u>Astoria Boulevard to Grand Central Parkway Service Road</u> |
| 94th Avenue | Van Wyck Expressway to Sutphin Boulevard |
| 94th Street | [La Guardia Airport] <u>Runway Drive</u> to 32nd Avenue |
| 108th Street | Astoria Boulevard to Queens Boulevard |
| 110th Street | 14th Avenue to 15th Avenue |
| 126th Street | Northern Boulevard to Roosevelt Avenue |
| <u>138th Street</u> | <u>Main Street to Queens Boulevard</u> |
| <u>141st Street (Grand Central Parkway Service Road North)</u> | <u>Main Street to Union Turnpike</u> |
| 154th Street | Cross Island Parkway North Service Road to 10th Avenue |
| 168th Street | Merrick Boulevard to Hillside Avenue |
| [213th Street] | [Hempstead Avenue to Jamaica Avenue] |

§2. Subdivision (c) of section 4-13 of chapter 4 of Title 34 of the Rules of the City of New York is amended to read as follows:

(c) *Truck routing rules for the Borough of Staten Island.*

(1) *Through trucks.* An operator of any truck as defined in paragraph (a)(1) above, having neither an origin nor a destination within the Borough of Staten Island, shall restrict the operation of such vehicle to those street segments on the following list. These are designated as “Through Truck Routes.” All trucks must adhere to all posted signs indicating locations that limit the height of vehicles permitted to operate thereon.

THROUGH TRUCK ROUTE NETWORK

| Street | Limits |
|----------------------------------------|----------------------------------------------------------------------------|
| Bayonne Bridge | Dr. Martin Luther King, Jr. Expressway to New Jersey State Line |
| Dr. Martin Luther King, Jr. Expressway | Victory Boulevard to Bayonne Bridge |
| Goethals Bridge | Staten Island Expressway to New Jersey State Line |
| Outerbridge Crossing | West Shore Expressway to New Jersey State Line |
| Staten Island Expressway | Goethals Bridge to Verrazano Narrows Bridge |
| Verrazano-Narrows Bridge | Staten Island Expressway to Kings County Line |
| West Shore Expressway | Staten Island Expressway to [Richmond Parkway] <u>Outerbridge Crossing</u> |

(2) *Local trucks.* (i) *2 axles, 6 tires.* An operator of any truck as defined in paragraph (a)(1) above, with 2 axles, 6 tires and having an origin or destination for the purpose of delivery, loading, or servicing within the Borough of Staten Island, shall only operate such vehicle over the street segments designated as “Through Truck Routes” in paragraph (c)(1) above and the street segments designated on the following [listed] lists as “Local Truck Routes” and “Limited Local-Truck Routes,” except that an operator may drive on a street not designated below for the purpose of arriving at [his/her] the destination. This shall be accomplished by leaving a designated truck route at the intersection which is nearest and provides the most direct route to [his/her] the destination, proceeding by the most direct route while observing existing street directions and turn restrictions, and then returning

to the nearest designated truck route by the most direct route. If the operator has additional destinations in the immediate vicinity, [he/she] they may proceed by the most direct route to [his/her] the next destination without returning to a designated truck route, provided that the operator's next destination does not require that [he/she] they cross a designated truck route. All trucks must adhere to all posted signs indicating locations that limit the height of vehicles permitted to operate thereon.

(ii) *3 or more axles.* An operator of any truck as defined in paragraph (a)(1) above, with 3 or more axles, and having an origin or destination for the purpose of delivery, loading, or servicing within the Borough of Staten Island, shall only operate such vehicle over the following listed "[local truck routes] Local Truck Routes," except under the conditions described in subparagraph (2)(i), above.

LOCAL TRUCK ROUTE NETWORK

| Street | Limits |
|------------------------------------------|------------------------------------------------------------------------------------------------------------------------|
| Amboy Road | Richmond Road to Wards Point Avenue |
| Arden Avenue | [Veterans Road] West <u>Service Road</u> to Hylan Boulevard |
| Arthur Kill Road | Richmond Road to Main Street |
| Bay Street | Richmond Terrace to School Road |
| [Bayonne Bridge] | [Dr. Martin Luther King, Jr. Expressway to New Jersey State Line] |
| Bloomfield Avenue | Chelsea Road to Gulf Avenue |
| <u>Bloomfield Road (Chelsea Road)</u> | <u>Chelsea Road to West Shore Expressway Exit South Avenue</u> |
| Bloomingtondale Road | Amboy Road to Arthur Kill Road |
| Boscombe Avenue | Page Avenue to Weiner Street |
| Bradley Avenue | South Gannon Avenue to Victory Boulevard |
| Broad Street | Van Duzer Street to Bay Street |
| Broadway | Forest Avenue to Richmond Terrace |
| Buel Avenue | Hylan Boulevard to Richmond Road |
| [Castleton Avenue] | [Jewett Avenue to Jersey Street] |
| Castleton Avenue | [Jewett Avenue] <u>Jersey Street</u> to Port Richmond Avenue |
| Chelsea Road | South Avenue to <u>West Shore Expressway Exit South Avenue and Bloomfield Road (Chelsea Road) to Bloomfield Avenue</u> |
| <u>Christopher Lane</u> | <u>Richmond Avenue to Victory Boulevard</u> |
| Clarke Avenue | Arthur Kill Road to Amboy Road |
| Clove Road | Narrows Road South to Richmond Terrace |
| [Dr. Martin Luther King, Jr. Expressway] | [Victory Boulevard to Bayonne Bridge] |
| Draper Place | Richmond Avenue to Richmond Avenue |
| Drumgoole Road East | Bloomingtondale Road to [Richmond] <u>Wainwright Avenue</u> |
| Drumgoole Road West | Arthur Kill Road to [Veterans] <u>Bloomingtondale Road</u> |
| <u>East Service Road</u> | <u>West Shore Expressway to Victory Boulevard</u> |
| Ebbitts Avenue | Hylan Boulevard to Mill Road |
| Edgewater Street | Bay Street to [Hyland] <u>Hylan Boulevard</u> |
| Edward Curry Avenue | Chelsea Road to South Avenue |

| | |
|----------------------------------------------------------|--------------------------------------------------------------------------------------------------------------------|
| Englewood Avenue | Veterans Road West to Veterans Road East |
| Fahy Avenue | South Avenue to Lamberts Lane |
| Father Capodanno [Blvd.] <u>Boulevard</u> [Seaside Blvd] | Midland Avenue to Lily Pond Avenue |
| Forest Avenue | [Western] <u>Gulf Avenue</u> to Victory Boulevard |
| Foster Road | Woodrow Road to Amboy Road |
| Front Street | Bay Street to [Murry Hulbert Avenue] <u>Hannah Street</u> |
| Giffords Lane | Arthur Kill Road to Amboy Road |
| Glen Street | <u>South Avenue to West Shore Expressway North Entrance and Edward Curry Avenue to [Fahy Avenue] South Avenue</u> |
| [Goethals Bridge] | [Staten Island Expressway to New Jersey State Line] |
| Goethals Road North | Western Avenue to [West Caswell] <u>Richmond Avenue</u> |
| Gulf Avenue | [Forest] <u>Western Avenue</u> to Edward Curry Avenue |
| Guyon Avenue | Hylan Boulevard to Amboy Road |
| <u>Hannah Street</u> | <u>Bay Street to Front Street</u> |
| Huguenot Avenue | Arthur Kill Road to Hylan Boulevard |
| Hylan Boulevard | Satterlee [Avenue] <u>Street</u> to Steuben Street, and [Narrows Road South] <u>Olga Place</u> to Edgewater Street |
| Jersey Street | Richmond Terrace to Victory Boulevard |
| Jewett Avenue | Richmond Terrace to Victory Boulevard |
| Justin Avenue | Amboy Road to Hylan Boulevard |
| Lamberts Lane | Fahy Avenue to [Victory Boulevard] <u>Richmond Avenue</u> |
| Lily Pond Avenue | School Road to Father Capodanno Boulevard (Seaside Boulevard) |
| Lincoln Avenue | [Hyland] <u>Hylan Boulevard</u> to Richmond Road |
| <u>Lincoln Place</u> | <u>School Road to Narrows Road North</u> |
| Little Clove Road | Renwick Avenue to [Narrows Road North] <u>Clove Road</u> |
| Main Street | Arthur Kill Road to Hylan Boulevard |
| Manor Road | Schmidts Lane to Victory Boulevard |
| [Meeker Avenue] | [Forest Avenue to Gulf Avenue] |
| Midland Avenue | Richmond Road to Father Capodanno Boulevard (Seaside Boulevard) |
| Milford Drive | Renwick Avenue to Clove Road |
| Mill Road | Tysens Lane to New Dorp Lane |
| Morley Avenue | Richmond Road to Richmond Road |
| Morningstar Road | Richmond Terrace to [Richmond] <u>Forest Avenue</u> |
| Narrows Road North | [Verrazano Narrows Bridge] <u>Lincoln Place</u> to Little Clove Road |

| | |
|----------------------------------|-----------------------------------------------------------------------------------|
| Narrows Road South | Clove Road to [Verrazano Narrows Bridge] <u>Lily Pond Avenue</u> |
| Nelson Avenue | Amboy Road to Hylan Boulevard |
| New Dorp Lane | Mill Road to Hylan Boulevard |
| North Bridge Street | [Veterans Road] <u>West Shore Parkway</u> to Arthur Kill Road |
| North Gannon Avenue | [Slosson] <u>Reon Avenue</u> to [Willow Road East] <u>Victory Boulevard</u> |
| [Outerbridge Crossing] | [West Shore Expressway to New Jersey State Line] |
| Page Avenue | South Bridge Street to Hylan Boulevard |
| Port Richmond Avenue | [Forest Avenue] <u>Trantor Place</u> to Richmond Terrace |
| Renwick Avenue | Milford Drive to Little Clove Road |
| <u>Reon Avenue</u> | <u>North Gannon Avenue</u> to <u>Slosson Ave</u> |
| Richmond Avenue | Hylan Boulevard to Forest Avenue |
| Richmond Parkway | Outerbridge Crossing to West Shore Expressway |
| Richmond Road | Van Duzer Street to Morley Avenue and Morley Avenue to Arthur Kill Road |
| Richmond Terrace | Western Avenue to Bay Street |
| Richmond Valley Road | Arthur Kill Road to Page Avenue |
| Rossville Avenue | Arthur Kill Road to Woodrow Road |
| St. Pauls Avenue | Van Duzer Street to Van Duzer Street |
| Schmidts Lane | Manor Road to Slosson Avenue |
| School Road | [Lily Pond] <u>Tompkins Avenue</u> to Bay Street |
| Seaview Avenue | Father Capodanno Boulevard (Seaside Boulevard) to Hylan Boulevard |
| Seguine Avenue | Amboy Road to Hylan Boulevard |
| Sharrott Avenue | Amboy Road to Hylan Boulevard |
| [Sharrots] <u>Sharrotts Road</u> | Veterans Road East to Veterans Road West |
| Slosson Avenue | Victory Boulevard to Schmidts Lane |
| South Avenue | Richmond Terrace to Chelsea Road |
| South Bridge Street | Arthur Kill Road to Page Avenue |
| South Gannon Avenue | Victory Boulevard to Manor Road |
| [Staten Island Expressway] | [Goethals Bridge to Verrazano Narrows Bridge] |
| Steuben Street | Hylan Boulevard to [Narrows Road South] <u>Olga Place</u> |
| Targee Street | Van Duzer Street to Richmond Road |
| Tompkins Avenue | Hylan Boulevard to Broad Street |
| Trantor Place | Walker Street to [Dr. Martin Luther King, Jr. Expressway] Bayonne Bridge Entrance |
| Travis Avenue | South Avenue to Draper Place |
| Tyrellan Avenue | Boscombe Avenue to Veterans Road West |
| Tysens Lane | Mill Road to Hylan Boulevard |

| | |
|-----------------------------------------|---------------------------------------------------------------------------------------------------------------------------------------------------|
| Vanderbilt Avenue | Richmond Road to Bay Street |
| Van Duzer Street | Richmond Road to Victory Boulevard |
| Van Duzer [St.] <u>Street Extension</u> | Van Duzer Street to Bay Street |
| [Verrazano-Narrows Bridge] | [Staten Island Expressway to Kings County Line] |
| Veterans Road East | Drumgoole Road West to Sharrotts Road, and Bloomingdale Road to [Arthur Kill Road] <u>Rossville Avenue</u> |
| Veterans Road West | [Arden Road to Bloomingdale Road] <u>West Shore Expressway South Entrance</u> to <u>Rossville Avenue</u> , and Sharrotts Road to Arthur Kill Road |
| <u>Veterans Road South</u> | <u>Bloomingdale Road</u> to <u>West Shore Expressway</u> |
| Victory Boulevard | West Shore Expressway to Bay Street |
| <u>Wainwright Avenue</u> | <u>Drumgoole Road East</u> to <u>Richmond Avenue</u> |
| Walker Street | Morningstar Road to Port Richmond Avenue |
| West Caswell Avenue | [Goethals Road North] <u>Richmond Avenue</u> to Willow Road West |
| <u>West Service Road</u> | <u>West Shore Expressway</u> to <u>Arthur Kill Road</u> |
| [West Shore Expressway] | [Staten Island Expressway to Outerbridge Crossing] |
| <u>West Shore Parkway</u> | <u>North Bridge Street</u> to <u>Veterans Road West</u> |
| Western Avenue | [Forest] <u>Gulf Avenue</u> to Richmond Terrace |
| Willow Road East | [North Gannon Avenue] <u>Victory Boulevard</u> to Forest Avenue |
| Willow Road West | [Forest Avenue] <u>Dr. Martin Luther King, Jr. Expressway</u> to West Caswell Avenue |
| Woodrow Road | Bloomingdale Road to Arthur Kill Road |
| Woolley Avenue | South Gannon Avenue to Victory Boulevard |

LIMITED LOCAL TRUCK ROUTE NETWORK

| Street | Limits |
|--------------------|-----------------------------------------------|
| Bradley Avenue | Brielle Avenue to South Gannon Avenue |
| Brielle Avenue | Rockland Avenue to Manor Road |
| Forest Hill Road | Richmond Hill Road to Willowbrook Road |
| Manor Road | Brielle Avenue to Schmidts Lane |
| Ocean Terrace | Manor Road to Todt Hill Road |
| Richmond Hill Road | Richmond Avenue to Forest Hill Road |
| Richmond Road | Rockland Avenue to Morley Avenue |
| Rockland Avenue | Richmond Avenue to Richmond Road |
| Slosson Avenue | Schmidts [Land] <u>Lane</u> to Todt Hill Road |
| Todt Hill Road | Slosson Avenue to Richmond Road |

| | |
|----------------|-----------------------------------------|
| Woolley Avenue | Willowbrook Road to South Gannon Avenue |
|----------------|-----------------------------------------|

§3. Paragraphs (1) through (3) of subdivision (d) of section 4-13 of chapter 4 of Title 34 of the Rules of the City of New York are amended, and paragraphs (4) through (6) are renumbered to read as follows:

(1) *Through trucks.* An operator of any truck as defined in paragraph (a)(1) above, having neither an origin nor a destination within the Borough of Manhattan, shall restrict the operation of such vehicle to those street segments designated on the following list as “Through Truck Routes.” All trucks must adhere to all posted signs indicating locations that limit the height of vehicles permitted to operate thereon.

THROUGH TRUCK ROUTE NETWORK

| Street | Limits |
|-------------------------------------|-------------------------------------------------------------------------------------|
| Allen Street | Delancey Street to Houston Street |
| Avenue of the Americas (6th Avenue) | West Broadway to Houston Street |
| Beach Street | West Broadway to Varick Street |
| Canal Street | Manhattan Bridge to West Street |
| Chrystie Street | Delancey Street to Houston Street |
| Delancey Street | Williamsburg Bridge to Bowery |
| Dyer Avenue | 34th Street to Lincoln Tunnel, and Lincoln Tunnel to 42nd Street |
| [Dyer Avenue] | [Lincoln Tunnel to 42nd Street] |
| Houston Street | Allen Street to Varick Street |
| Hudson Street | Laight Street to Holland Tunnel Entrance |
| Kenmare Street | Bowery to Lafayette Street |
| Lafayette Street | Kenmare Street to Canal Street |
| Laight Street | Varick Street to Canal Street |
| [**]Queens Midtown Tunnel | 34th Street to Tunnel Approach |
| [**]Queens Midtown Tunnel | 34th Street to Tunnel Exit |
| Trans-Manhattan [Expway] Expressway | Alexander Hamilton Bridge to George Washington Bridge |
| Varick Street | Houston Street to [Holland Tunnel Entrance] Broome Street |
| Walker Street | Canal Street to West Broadway |
| West Broadway | Beach Street to Avenue of the Americas |
| West Street | [Brooklyn Battery] Hugh L Carey Tunnel to [Gansevoort Street] West 14th Street |
| 11th Avenue | [Gansevoort Street] West 14th Street to 22nd Street, and 34th Street to 42nd Street |
| [11th Avenue] | [34th Street to 42nd Street] |
| 12th Avenue | 22nd Street to 34th Street |
| [**]34th Street | Queens Midtown Tunnel Entrance to Dyer Avenue |
| 34th Street | Dyer Avenue to 12th Avenue |
| 40th Street | Lincoln Tunnel entrance to 11th Avenue |
| 42nd Street | Dyer Avenue to 11th Avenue |

[** All through trucks are prohibited from 34th Street between the Queens Midtown Tunnel and Dyer Avenue between the hours of 11:00 A.M. and 6:00 P.M.]

(2) *Local trucks.* An operator of any truck as defined in paragraph (a)

(1) above, having an origin or destination for the purpose of delivery, loading, or servicing within the Borough of Manhattan, shall restrict the operation of such vehicle to the street segments designated as “Through Truck Routes” in paragraph (d)(1) above and those street segments designated on the following list as “Local Truck Routes,” except that an operator may operate on a street not designated below for the purpose of leaving [his/her] the point of origin or arriving at [his/her] the destination (subject to restrictions specified in §4-13(d)(3) through §4-13(d)(5) of these rules). This shall be accomplished by leaving a designated truck route at an intersection that is nearest and provides the most direct route to [his/her] the destination, proceeding by the most direct route while observing existing street directions and turn restrictions, and then returning to the nearest designated truck route by the most direct route. If the operator has additional destinations in the immediate vicinity, [he/she] they may proceed by the most direct route to [his/her] the next destination without returning to a designated truck route, provided that the operator’s next destination does not require that [he/she] they cross a designated truck route. All trucks must adhere to all posted signs indicating locations that limit the height of vehicles permitted to operate thereon.

LOCAL TRUCK ROUTES

| Street | Limits |
|--------------------------------------------|------------------------------------------------------------------------------------|
| Adam Clayton Powell, Jr. [Blvd.] Boulevard | Central Park North to 155th Street |
| Allen Street | Division Street to [Houston] Delancey Street |
| Amsterdam Avenue | 59th Street to 181st Street |
| Avenue of the Americas (6th Avenue) | Church Street to West Broadway and West Houston Street to 31st Street |
| Barclay Street | Broadway to West Street |
| Battery Park Underpass | South Street to West Street |
| Battery Place | State Street to West Street |
| [Beach Street] | [West Broadway to Varick Street] |
| Bowery | [St. James Place] Division Street to Cooper Square |
| Broadway | State Street to 14th Street and Columbus Circle to Bronx County Line |
| [Broadway] | [17th Street to 31st Street] |
| [Broadway] | [Columbus Circle to 230th Street] |
| Broome Street | Centre Street to Watts Street |
| Canal Street | Chrystie Street to [West] Allen Street |
| [Canal Street] | [Chrystie Street to Forsyth Street] |
| Cathedral Parkway (110th Street) | [8th Avenue] Fredrick Douglass Circle to Broadway |
| Central Park North | Adam Clayton Powell, Jr., [Blvd.] Boulevard to [8th Ave.] Fredrick Douglass Circle |
| Central Park South | Columbus Circle to [Grand Army Plaza] 5th Avenue |
| Central Park Traverse Roads 1, 2, 3 & 4 | Fifth Avenue to Central Park West |
| Central Park West | 81st Street to 82nd Street |
| Centre Street | Canal Street to Broome Street |
| Chatham Square | Worth Street to Division Street |
| Chrystie Street | Canal Street to [Houston] Delancey Street |
| Church Street | Liberty Street to Avenue of the Americas |
| Clarkson Street | 7th Avenue South to West Street |

| | |
|----------------------------------|------------------------------------------------------------------------------------------------------------------------|
| Columbus Avenue | 59th Street to Cathedral Parkway |
| Columbus Circle | Entire Length |
| Cooper Square | Bowery to Third Avenue |
| [Delancey Street] | [Williamsburg Bridge to Bowery] |
| [Division Street] | [Bowery to Pike Street] |
| [Dyer Avenue] | [Lincoln Tunnel to 42nd Street] |
| [Dyer Avenue] | [Lincoln Tunnel to 34th Street] |
| <u>East Broadway</u> | <u>Pike Street to Chatham Square</u> |
| [Forsyth Street] | [Division Street to Canal Street] |
| Fort Washington Avenue | 178th Street to 181st Street [Avenue] |
| <u>Galvin Avenue</u> | <u>41st Street to Lincoln Tunnel Entrance</u> |
| Grand Street | Allen Street to West Broadway |
| Greenwich Avenue | Avenue of the Americas to 8th Avenue |
| Houston Street | [1st Avenue] <u>Varick Street</u> to West Street |
| Hudson Street | Worth Street to [8th Avenue] <u>Laight Street, and Canal Street to Bleecker Street</u> |
| [Kenmare Street] | [Bowery to Lafayette Street] |
| [Lafayette Street] | [Kenmare Street to Canal Street] |
| [Laight Street] | [Varick Street to Canal Street] |
| Lexington Avenue | 23rd Street to 125th Street |
| Lincoln Tunnel Access | 30th Street to Lincoln Tunnel |
| Madison Avenue | 84th Street to 86th Street, <u>96th Street to 97th Street, and 125th Street to Madison Avenue Bridge</u> |
| [Madison Avenue] | [96th Street to 97th Street] |
| [Madison Avenue] | [125th Street to Madison Avenue Bridge] |
| Maiden Lane | South Street to Water Street |
| Nagle Avenue | Broadway to 10th Avenue |
| Pearl Street | Water Street to St. James Place |
| Pike Slip | South Street to Cherry Street |
| Pike Street | Cherry Street to Division Street |
| [Queens Midtown Tunnel Approach] | [34th Street to Tunnel] |
| [Queens Midtown Tunnel Exit] | [34th Street to Tunnel] |
| St. James Place | Pearl Street to [Bowery] <u>Oliver Street</u> |
| South Street | [State] <u>Whitehall</u> Street to Pike Slip |
| State Street | [South] <u>Whitehall</u> Street to Broadway |
| [Trans-Manhattan Expwy] | [Alexander Hamilton Bridge to George Washington Bridge] |
| Trinity Place | [Brooklyn Battery] <u>Hugh L Carey Tunnel</u> to Liberty Street |
| [Union Square East] | [14 th Street to 17th Street] |
| Varick Street | [West Broadway to 7th Avenue South] <u>Clarkson Street to West Houston Street and Broome Street to Franklin Street</u> |

| | |
|-------------------------------------|------------------------------------------------------------------------------------------------------------------------------|
| Vesey Street | Broadway to [West] <u>Church</u> Street |
| Walker Street | Canal Street to West Broadway |
| Water Street | State Street to [Pearl] <u>Fulton</u> Street |
| Watts Street | Broome Street to Holland Tunnel entrance |
| West Broadway | Worth Street to [Varick] <u>Franklin Street and Avenue of the Americas (6th Avenue) to Grand Street</u> |
| [West Broadway] | [Beach Street to Grand Street] |
| West Street | Battery Park Underpass to [Gansevoort Street] <u>Hugh L. Carey Tunnel</u> |
| <u>Whitehall Street</u> | <u>South Street to State Street</u> |
| Worth Street | St. James Place to Hudson Street |
| 1st Avenue | Houston Street to Willis Avenue Bridge |
| 2nd Avenue | Houston Street to 128th Street |
| 3rd Avenue | [Cooper Square] <u>Saint Marks Place</u> to 125th Street |
| <u>4th Avenue</u> | <u>East 14th Street to East 15th Street</u> |
| 5th Avenue | [22nd Street to 26th Street] <u>31st Street to 14th Street, 85th Street to 86th Street, and 125th Street to 138th Street</u> |
| [5th Avenue] | [85th Street to 86th Street] |
| [5th Avenue] | [125th Street to 138th Street] |
| 6th Avenue (Avenue of the Americas) | Church Street to 31st Street |
| 7th Avenue | [14th] <u>11th</u> Street to 31st Street |
| 7th Avenue South | [Varick] <u>Franklin</u> Street to [14th] <u>11th</u> Street |
| 8th Avenue | [Hudson] <u>Bleecker</u> Street to Columbus Circle |
| 8th Street | Avenue of the Americas to Broadway |
| 9th Avenue | 14th Street to 59th Street |
| 10th Avenue | Little West 12th Street to 59th Street <u>and Nagle Avenue to Broadway</u> |
| [10th Avenue] | [Nagle Avenue to Broadway] |
| 11th Avenue | [Gansevoort] <u>22nd</u> Street to [57th] <u>34th</u> Street and <u>42nd</u> Street to <u>57th</u> Street |
| [11th Ave. service road] | [Gansevoort Street to 23rd Street] |
| 12th Avenue | [22nd] <u>34th</u> Street to 59th Street |
| 14th Street | 1st Avenue to 11th Avenue |
| 15th Street | 9th Avenue to 11th Avenue |
| [17th Street] | [Union Square East to Broadway] |
| [22nd Street] | [5th Avenue to Broadway] |
| 23rd Street | 1st Avenue to [12th] <u>11th</u> Avenue |
| [26th Street] | [5th Avenue to Broadway] |
| 30th Street | [Broadway] <u>5th</u> Avenue to 11th Avenue |

| | |
|---------------|---------------------------------------------------------------------------|
| 31st Street | 3rd Avenue to 10th Avenue |
| 34th Street | 1st Avenue to [12th Avenue] <u>Queens Midtown Tunnel Entrance</u> |
| 36th Street | Queens Midtown Tunnel entrance to 2nd [Ave.] <u>Avenue</u> |
| [40th Street] | [Lincoln Tunnel entrance to 11th Avenue] |
| 41st Street | 9th Avenue to Lincoln Tunnel Entrance |
| 42nd Street | 1st Avenue to <u>Dyer Avenue and 11th Avenue</u> to 12th Avenue |
| 57th Street | 1st Avenue to 12th Avenue |
| 59th Street | 1st Avenue to [Grand Army Plaza] <u>5th Avenue</u> |
| 60th Street | 1st Avenue to Lexington Avenue |
| 65th Street | 1st Avenue to 5th Avenue <u>and Central Park West to Amsterdam Avenue</u> |
| [65th Street] | [Central Park West to Amsterdam Avenue] |
| 66th Street | 1st Avenue to 5th Avenue <u>and Central Park West to Amsterdam Avenue</u> |
| [66th Street] | [Central Park West to Amsterdam Avenue] |
| 75th Street | Amsterdam Avenue to Broadway |
| 79th Street | 1st Avenue to 5th Avenue <u>and Columbus Avenue to Broadway</u> |
| [79th Street] | [Columbus Avenue to Broadway] |
| 81st Street | Central Park West to Columbus Avenue |
| 82nd Street | Central Park West to Broadway |
| 84th Street | Madison Avenue to 5th Avenue |
| 86th Street | 1st Avenue to 5th Avenue <u>and Central Park West to Broadway</u> |
| [86th Street] | [Central Park West to Broadway] |
| 96th Street | 1st Avenue to 5th Avenue <u>and Central Park West to Broadway</u> |
| [96th Street] | [Central Park West to Broadway] |
| 97th Street | Madison Avenue to 5th Avenue <u>and Central Park West to Broadway</u> |
| [97th Street] | [Central Park West to Broadway] |
| 116th Street | 1st Avenue to Adam Clayton Powell, Jr. [Blvd.] <u>Boulevard</u> |
| 124th Street | 1st Avenue to Triborough Bridge entrance |
| 125th Street | 1st Avenue to Broadway |
| 128th Street | 2nd Avenue to 3rd Avenue Bridge |
| 138th Street | Madison Avenue Bridge to 5th Avenue |
| 145th Street | 145th Street Bridge to Broadway |
| 155th Street | Macombs Dam Bridge to Broadway |
| 178th Street | Amsterdam Avenue to George Washington Bridge exit |
| 179th Street | Amsterdam Avenue to George Washington Bridge entrance |

| | |
|--------------|-----------------------------------------------------------|
| 181st Street | Washington Bridge to Fort Washington [Ave.] <u>Avenue</u> |
| 207th Street | University Heights Bridge to Broadway |
| 215th Street | Tenth Avenue to Broadway |

(3) *Limited truck zones.*

(i) *Restrictions.* Notwithstanding the provisions of paragraphs (a), (d)(1) and (d)(2) of this section, no operator of a truck as defined in paragraph (a)(1) of this section shall operate, enter, stop, stand or park [his/her] their vehicle upon any of the streets designated on the following list as “Limited Truck Zones” except for the purpose of making a delivery, loading, or servicing within said zone. This shall be accomplished by leaving a designated truck route at the intersection that is nearest and provides the most direct route to [his/her] the destination, proceeding by the most direct route while observing existing street directions and turn restrictions, and then returning to the nearest designated truck route by the most direct route. If the operator has additional destinations in the immediate vicinity, [he/she] they may proceed by the most direct route to [his/her] the next destination without returning to a designated truck route provided that the operator’s next destination does not require that [he/she] they cross a designated truck route.

(ii) *Time period.* 24 hours per day, 7 days per week.

(iii) *Zones*

Zone A – *Chelsea* [Bounded] is bounded by:

- the northern property line of 16th Street[,] ;
- the eastern property line of Ninth Avenue[,] ;
- the northern property line of 18th Street[,] ;
- the eastern property line of Tenth Avenue[,] ;
- the southern property line of 30th Street[,] ;
- the western property line of Eighth Avenue[,] ;
- the southern property line of 25th Street[,] ;
- the western property line of Seventh Avenue[,] ;
- the northern property line of 19th Street; and
- the western property line of Eighth Avenue.

Trucks passing completely through the designated area, or entering it for the purpose of reaching or leaving a street within these boundaries, are permitted to traverse 23rd Street, Eighth Avenue and Ninth Avenue only.

Zone B – *Chinatown* [Bounded] is bounded by:

- the northern property line of Worth Street[,] ;
- the eastern property line of Baxter Street[,] ;
- the southern property line of Canal Street[,] ;
- the western property line of the Bowery; and
- the western property line of Chatham Square.

Zone C – *Greenwich Village* [Bounded] is bounded by:

- the northern property line of Spring Street[,] ;
- the eastern property line of Varick Street[,] ;
- the eastern property line of Seventh Avenue South[,] ;
- the northern property line of Clarkson Street[,] ;
- the eastern property line of Hudson Street[,] ;
- the northern property line of Morton Street[,] ;
- the eastern property line of Washington Street[,] ;
- the southern property line of Gansevoort Street[,] ;
- the southern property line of 14th Street[,] ;
- the western property line of Avenue of the Americas[,] ;
- the southern property line of 12th Street[,] ;
- the western property line of University Place[,] ;
- the southern property line of 8th Street[,] ;
- the western property line of Mercer Street[,] ;
- the northern property line of Houston Street; and
- the western property line of West Broadway.

Trucks passing completely through the designated area, or entering it for the purpose of reaching or leaving a street within these boundaries, are permitted to traverse Avenue of the Americas, Eighth Avenue, Eighth Street, Greenwich Avenue, Hudson Street (Northbound only), Seventh Avenue South, Varick Street and Houston Street only. Trucks with neither an origin nor a destination within Manhattan are restricted to Houston Street and Avenue of the Americas between Spring and Houston Streets only.

Zone D – *Little Italy* [Bounded] is bounded by:

- the northern property line of Canal Street[,] ;
- the eastern property line of Centre Street[,] ;
- the eastern property line of Cleveland Place[,] ;
- the eastern property line of Lafayette Street[,] ;
- the southern property line of Houston Street; and
- the western property line of Bowery.

Trucks passing completely through the designated area, or entering it

for the purpose of reaching or leaving a street within these boundaries, are permitted to traverse Grand Street, Kenmare Street and Canal Street only. Trucks with neither an origin nor a destination within Manhattan are restricted to Canal Street only.

- Zone E – Lower East Side [Bounded] is bounded by:
- the northern property line of Senator Robert F. Wagner Place[,] ;
 - the eastern property line of St. James Place[,] ;
 - the eastern property line of East Broadway[,] ;
 - the southern property line of Montgomery Street; and
 - the western property line of South Street.

Trucks passing completely through the designated area, or entering it for the purpose of reaching or leaving a street within these boundaries, are permitted to traverse Pike Slip and Pike Street only.]

(4) *Special garment center rule.*

[(5)] (4) *Operation of vehicles 33 feet or more in length restricted.*

[(6)] (5) *Special rules for vehicles 33 feet or more in length in the financial district and midtown core.*

§4. Subdivision (e) of Section 4-13 of Chapter 4 of Title 34 of the Rules of the City of New York are amended to read as follows:

(e) *Truck routing rules for the Borough of Brooklyn.*

(1) *Through trucks.* An operator of any truck as defined in paragraph (a)(1) above, having neither an origin nor a destination within the Borough of Brooklyn, shall restrict the operation of such vehicle to those street segments on the following list. These are designated as “Through Truck Routes.” All trucks must adhere to all posted signs indicating locations that limit the height of vehicles permitted to operate thereon.

THROUGH TRUCK ROUTE NETWORK

| Street | Limits |
|---------------------------------|--------------------------------------------------------------------------------|
| Atlantic Avenue | Columbia Street to [Queens County Line] <u>Eldert Lane</u> |
| Brooklyn-Queens Expressway | Gowanus Expressway to Queens County Line |
| Brooklyn-Queens Expressway Ramp | Williamsburg Bridge to Brooklyn-Queens Expressway |
| Church Avenue | McDonald Avenue to Flatbush Avenue |
| Columbia Street | Atlantic Avenue to [Brooklyn-Queens Expressway Ramps North to] Congress Street |
| Conduit Boulevard | Atlantic Avenue to [Queens County Line] <u>North and South Conduit Avenues</u> |
| Flatbush Avenue | Fulton Street to Atlantic Avenue and Church Avenue to Marine Parkway Bridge |
| Flatbush Avenue Extension | Manhattan Bridge to Fulton Street |
| Gowanus Expressway | [Brooklyn Battery] <u>Hugh L Carey Tunnel</u> to Verrazano Narrows Bridge |
| Jay Street | Manhattan Bridge Exit Ramp to Sands Street |
| McDonald Avenue | 10th Avenue to Church Avenue |
| Prospect Expressway | Gowanus Expressway to Church Avenue |
| Sands Street | Jay Street to Brooklyn-Queens Expressway Entrance |
| <u>South Conduit Avenue</u> | <u>Sutter Avenue to Queens County Line</u> |
| Tillary Street | Flatbush Avenue Extension to Brooklyn-Queens Expressway Ramps |

| | |
|-------------|--------------------------------------------------|
| 3rd Avenue | Flatbush Avenue to Atlantic Avenue |
| 10th Avenue | Prospect Expressway Exit Ramp to McDonald Avenue |

(2) *Local trucks.* An operator of any truck as defined in paragraph (a) (1) above, with an origin or destination for the purpose of delivery, loading, or servicing within the Borough of Brooklyn, may only operate such vehicle over the street segments designated as “Through Truck Routes” in paragraph (e)(1) above and the following street segments [listed streets,] designated as “Local Truck Routes,” except that an operator may operate on a street not designated below for the purpose of arriving at [his/her] the destination. This shall be accomplished by leaving a designated truck route at the intersection that is nearest and provides the most direct route to [his/her] the destination, proceeding by the most direct route while observing existing street directions and turn restrictions, and then returning to the nearest designated truck route by the most direct route. If the operator has additional destinations in the immediate vicinity, [he/she] they may proceed by the most direct route to [his/her] the next destination without returning to a designated truck route, provided that the operator’s next destination does not require that [he/she] they cross a designated truck route. All trucks must adhere to all posted signs indicating locations that limit the height of vehicles permitted to operate thereon.

LOCAL TRUCK ROUTE NETWORK

| Street | Limits |
|------------------------------------------|-----------------------------------------------------------------------------|
| Adams Street | Sands Street to Front Street |
| Ainslie Street | Rodney Street to Union Avenue |
| <u>Alabama Avenue</u> | <u>East New York Avenue to Atlantic Avenue</u> |
| Ash Street | McGuinness Boulevard to [Commercial Street] <u>Manhattan Avenue</u> |
| Atlantic Avenue | Furman Street to [Queens County Line] <u>Columbia Street</u> |
| Avenue D | Linden Boulevard to [Foster Avenue] <u>East 88th Street</u> |
| Avenue M | Flatlands Avenue to Kings Highway |
| Avenue N | Kings Highway to Flatlands Avenue |
| Avenue T | Flatbush Avenue to Ralph Avenue |
| <u>Avenue P</u> | <u>Kings Highway to East 16th Street and Dahill Road to McDonald Avenue</u> |
| Avenue U | 86th Street to [East 55th Street] <u>Flatbush Avenue</u> |
| Bay Parkway | Kings Highway to Belt Parkway Eastbound Service Road |
| Bay Street | Columbia Street to Smith Street |
| Beard Street | Van Brunt Street to Otsego Street |
| Bedford Avenue | [Rogers Avenue] <u>Dean Street</u> to Taylor Street |
| Bergen Street | 3rd Avenue to 5th Avenue |
| <u>Borinquen Place</u> | <u>Havemeyer Street to Grand Street</u> |
| Box Street | Commercial Street to McGuinness Boulevard |
| Bridgewater Street | Norman Avenue to Varick Street |
| Broadway | Kent Avenue to Jamaica Avenue |
| [Brooklyn-Queens Expressway] | Gowanus Expressway to Queens County Line] |
| [Brooklyn-Queens Expressway Access Ramp] | Williamsburg Bridge to Brooklyn-Queens Expressway] |
| <u>Bushwick Avenue</u> | <u>Metropolitan Avenue to Grand Street</u> |

| | |
|-----------------------------|-------------------------------------------------------------------------------------------------------|
| Cadman Plaza West | [Furman] <u>Prospect Street to [Court] Montague Street</u> |
| Caton Avenue | McDonald Avenue to Linden Boulevard |
| Cherry Street | Vandervoort Avenue to Varick Avenue |
| Church Avenue | Old New Utrecht Road to <u>McDonald Avenue and Flatbush Avenue to Linden Boulevard</u> |
| Classon Avenue | Kent Avenue to Flushing Avenue |
| Clinton Street | Hamilton Avenue to Bay Street |
| Columbia Street | [Atlantic Avenue to Irving;] <u>Congress Street to Degraw Street and Bay Street to Halleck Street</u> |
| Commercial Street | Manhattan Avenue to Franklin Street |
| Concord Street | Flatbush Avenue Extension to Jay Street |
| Conduit Boulevard | Atlantic Avenue to [Queens County Line] <u>North and South Conduit Avenues</u> |
| Coney Island Avenue | Caton Avenue to Neptune Avenue |
| Cooper Street | Broadway to [Queens County Line] <u>Irving Avenue</u> |
| Court Street | Hamilton Avenue to Bay Street and Cadman Plaza West to Atlantic Avenue |
| Cropsey Avenue | 18th Avenue to Neptune Avenue |
| <u>Dahill Road</u> | <u>65th Street to Avenue P</u> |
| <u>Degraw Street</u> | <u>Columbia Street to Van Brunt Street</u> |
| DeKalb Avenue | Nostrand Avenue to Flatbush Avenue Extension |
| Delavan Street | Columbia Street to Van Brunt Street |
| Driggs Avenue | South 4th Street to Broadway |
| <u>East 16th Street</u> | <u>Kings Highway to Avenue P</u> |
| <u>East 88th Street</u> | <u>Avenue D to Foster Avenue</u> |
| East New York Avenue | Troy Avenue to Rockaway Avenue and <u>Herkimer Street to Fulton Street</u> |
| Empire Boulevard | Flatbush Avenue to Utica Avenue |
| <u>Erskine Street</u> | <u>Vandalia Avenue to Seaview Avenue</u> |
| Flatbush Avenue | [Fulton Street] <u>Atlantic Avenue to [Marine Parkway Bridge] Church Avenue</u> |
| [Flatbush Avenue Extension] | [Manhattan Bridge to Fulton Street] |
| Flatlands Avenue | Avenue N to [Pennsylvania] <u>Fountain Avenue</u> |
| Flushing Avenue | Navy Street to [Queens County Line] <u>Seneca Avenue</u> |
| Fort Hamilton Parkway | 82nd Street to 92nd Street |
| Foster Avenue | Kings Highway to Remsen Avenue |
| Fountain Avenue | Linden Boulevard to [Spring Creek Landfill Site] <u>Seaview Avenue</u> |
| Franklin Street | Commercial Street to [Kent Avenue] <u>North 14th Street</u> |
| Freeman Street | Provost Street to McGuinness Boulevard |
| Front Street | [Cadman Plaza West] <u>Old Fulton Street to Hudson Avenue</u> |
| Fulton Street | [Jewell Square] <u>Jamaica Avenue to Pennsylvania Avenue</u> |

| | |
|--------------------------------|------------------------------------------------------------------------------------|
| Furman Street | [Cadman Plaza West] <u>Old Fulton Street to Atlantic Avenue</u> |
| Gardner Avenue | Grand Street to Meadow Street |
| [Gowanus Expressway] | [Brooklyn Battery Tunnel to Verrazano Narrows Bridge] |
| Grand Street | Grand Street [Extension] to [Queens County Line] <u>Grand Avenue</u> |
| [Grand Street Extension] | [Havemeyer Street to Grand Street] |
| Green Street | McGuinness Boulevard to Provost Street |
| Greenpoint Avenue | [Van Dam Street to Queens Boulevard] <u>Queens County Line to Franklin Street</u> |
| Halleck Street | Otsego Street to Columbia Street |
| Hamilton Avenue | Van Brunt Street to 3rd Avenue |
| Harrison Avenue | Union Avenue to Flushing Avenue |
| Havemeyer Street | Broadway to South [4th] <u>3rd Street</u> |
| Herkimer Street | Van Sinderen Avenue to [Jewell Square] <u>Williams Avenue</u> |
| Hicks Street | Hamilton Avenue to Nelson Street and <u>Old Fulton Street to Doughty Street</u> |
| Hudson Avenue | Front Street to Navy Street |
| <u>Humboldt Street</u> | <u>Bayard Street to Meeker Avenue</u> |
| [Irving Street] | [Van Brunt Street to Columbia Street] |
| [Jamaica Avenue] | [Broadway to Pennsylvania Avenue] |
| Jay Street | Prospect Street to <u>Sands Street and High Street to Fulton Street</u> |
| Johnson Avenue | Flushing Avenue to Morgan Avenue |
| [Kane Street] | [Columbia Street to Van Brunt Street] |
| Kent Avenue | [Franklin] <u>North 14th Street to Myrtle Avenue</u> |
| Kings Highway | Foster Avenue to Bay Parkway |
| Kingsland Avenue | Greenpoint Avenue to Norman [Street] <u>Avenue</u> |
| Knickerbocker Avenue | Flushing Avenue to [Morgan] <u>Johnson Avenue</u> |
| Lafayette Avenue | [Flatbush] <u>3rd Avenue to Nostrand Avenue</u> |
| Lee Avenue | Taylor Street to Flushing Avenue |
| <u>Lewis Avenue</u> | <u>Broadway to Myrtle Avenue</u> |
| Linden Boulevard | Caton Avenue to [Queens County Line] <u>Sapphire Street</u> |
| Lombardy Street | Vandervoort Avenue to Varick Avenue |
| Louisiana Street | Vandalia Avenue to Seaview Avenue |
| Manhattan Avenue | Commercial Street to Greenpoint Avenue |
| <u>Marcus Garvey Boulevard</u> | <u>Broadway to Myrtle Avenue</u> |
| Marcy Avenue | Metropolitan Avenue to Division Avenue, and <u>Gerry Street to Flushing Avenue</u> |
| McDonald Avenue | [20th Street] <u>Church Avenue to Shell Road</u> |
| McGuinness Boulevard | Ash [Avenue] <u>Street to Meeker Avenue</u> |

| | | | |
|---------------------------|--------------------------------------------------------------------------------------------------------------|----------------------------|-----------------------------------------------------------------------------------------------|
| Meadow Street | Gardner Avenue to Varick Avenue | Shell Road | [McDonald Avenue] <u>Avenue X</u> to Neptune Avenue |
| Meeker Avenue | Metropolitan Avenue to Varick Avenue | Smith Street | Fulton Street to Atlantic Avenue and Bay Street to 9th Street |
| Metropolitan Avenue | Kent Avenue to [Queens County Line] <u>Onderdonk Avenue</u> | South 3rd Street | Roebing Street to [Grand Street Extension] <u>Borinquen Place</u> |
| Morgan Avenue | Meeker Avenue to Flushing Avenue | South 4th Street | Rodney Street to Driggs Avenue |
| Myrtle Avenue | [Jay Street] <u>Flatbush Avenue Extension</u> to [Queens County Line] <u>Palmetto Street</u> | Surf Avenue | West 8th Street to West 17th Street |
| Nassau Street | Flatbush Avenue Extension to [Flushing Avenue] <u>Navy Street</u> | <u>Sutter Avenue</u> | <u>South Conduit Avenue to Queens County Line</u> |
| Navy Street | Hudson Avenue to Tillary Street | Taylor Street | Bedford Avenue to Lee Avenue |
| Nelson Street | Hicks Street to Columbia Street | Terrace Place | McDonald Avenue to [11th Avenue] <u>19th Street</u> |
| Neptune Avenue | Cropsey Avenue to Coney Island Avenue | Tillary Street | Cadman Plaza West to <u>Flatbush Avenue Extension</u> and <u>Prince Street</u> to Navy Street |
| <u>New Utrecht Avenue</u> | <u>39th Street to 18th Avenue</u> | Troy Avenue | East New York Avenue to Empire Boulevard |
| Norman Avenue | North Henry Street to [Bridgewater] <u>Apollo Street</u> | Union Avenue | [Harrison Avenue] <u>North 11th Street</u> to [Flushing Avenue] <u>Marcy Avenue</u> |
| North Henry Street | Greenpoint Avenue to Norman [Street] <u>Avenue</u> | [Union Avenue] | [North 11th Street to Lorimer Street] |
| North 10th Street | Union Avenue to Kent Avenue | Utica Avenue | Atlantic Avenue to Flatbush Avenue |
| North 11th Street | Kent Avenue to Union Avenue | Van Brunt Street | [Kane] <u>Degraw Street</u> to Beard Street |
| Nostrand Avenue | Flushing Avenue to Flatbush Avenue | <u>Van Dam Street</u> | <u>Meeker Avenue to Bridgewater Street</u> |
| <u>Old Fulton Street</u> | <u>Prospect Street to Furman Street</u> | <u>Van Sinderen Avenue</u> | <u>Broadway to Atlantic Avenue</u> |
| Old New Utrecht Road | Church Avenue to 14th Avenue | Vandalia Avenue | Louisiana Avenue to Pennsylvania Avenue and Fountain Avenue to <u>Erskine Street</u> |
| Paidge Avenue | McGuinness Boulevard to Provost Street | [Van Dam Street] | [Meeker Avenue to Bridgewater Street] |
| <u>Penn Street</u> | <u>Williamsburg Street East to Kent Avenue</u> | Vandervoort Avenue | Meeker Avenue to Grand Street |
| Pennsylvania Avenue | [Jamaica Avenue] <u>Fulton Street</u> to Vandalia Avenue[;] and Seaview Avenue to Spring Creek Landfill Site | [Van Sinderen Avenue] | [Broadway to Herkimer Street] |
| <u>Pitkin Avenue</u> | <u>East New York Avenue to Howard Avenue</u> | Varick Avenue | Lombardy Street to Meeker Avenue and <u>Metropolitan Avenue to Flushing Avenue</u> |
| Prospect Avenue | 3rd Avenue to Prospect Expressway 4th Avenue Exit | [Varick Avenue] | [Metropolitan Avenue to Flushing Avenue] |
| [Prospect Expressway] | [Gowanus Expressway to Church Avenue] | Varick Street | Meeker Avenue to Bridgewater Street |
| Prospect Street | Cadman Plaza West to Jay Street | <u>West 8th Street</u> | <u>Neptune Avenue to Surf Avenue</u> |
| Provost Street | Paidge Avenue to Greenpoint Avenue | <u>West 9th Street</u> | <u>Smith Street to Hamilton Avenue</u> |
| Ralph Avenue | Foster Avenue to Avenue T | <u>West 17th Street</u> | <u>Neptune Avenue to Surf Avenue</u> |
| Remsen Avenue | [Empire Boulevard] <u>East New York Avenue</u> to Flatlands Avenue | Williamsburg Street East | [Kent Avenue] <u>Penn Street</u> to [Division Avenue] <u>Rodney Street</u> |
| Rockaway Avenue | Broadway to East New York Avenue | Williamsburg Street West | Park Avenue to Division Avenue |
| Rockaway Parkway | <u>Linden Boulevard to East New York Avenue</u> | Woodhull Street | Hamilton Avenue Westbound to Hamilton Avenue Eastbound |
| Rodney Street | [Division Avenue] <u>Williamsburg Street East</u> to Metropolitan Avenue | York Street | Navy Street to Front Street |
| Roebing Street | Metropolitan Avenue to South 5th Street[;] and Broadway to Lee Avenue | 1st Avenue | 39th Street to 58th Street |
| Rogers Avenue | Flatbush Avenue to Bedford Avenue | 2nd Avenue | [58th] <u>29th Street</u> to 60th Street |
| Sands Street | Adams Street to Navy Street | 3rd Avenue | [Flatbush] <u>Atlantic Avenue</u> to [65th] <u>86th Street</u> |
| <u>Saratoga Avenue</u> | <u>East New York Avenue to Pitkin Avenue</u> | 4th Avenue | Flatbush Avenue to 39th Street |
| Schermerhorn Street | Smith Street to Flatbush Avenue | 5th Avenue | [Atlantic] <u>Flatbush Avenue</u> to Bergen Street |
| Seaview Avenue | Louisiana Avenue to Pennsylvania Avenue and <u>Erskine Street to Fountain Avenue</u> | 6th Avenue | 60th Street to 65th Street/[Gowanus Expressway] |

| | |
|-----------------------------|-----------------------------------------------------------------------------------------|
| 7th Avenue | Prospect Expressway to 20th Street[;] and 65th Street to 92nd Street |
| 9th Street | [Clinton] <u>Smith Street</u> to 4th Avenue |
| [10th Avenue] | [Prospect Expressway to 20th Street] |
| 11th Avenue | 18th Street to Terrace Place |
| 14th Avenue | Church Avenue to 39th Street |
| 18th Avenue | [86th Street] <u>New Utrecht Avenue</u> to Cropsey Avenue |
| 20th [Avenue] <u>Street</u> | 3rd Avenue to 10th Avenue |
| 25th [Street] <u>Avenue</u> | Cropsey Avenue to 86th Street |
| <u>29th Street</u> | <u>2nd Avenue to 3rd Avenue</u> |
| 39th Street | 1st Avenue to 14th Avenue |
| 43rd Street | 3rd Avenue to 1st Avenue |
| 58th Street | 1st Avenue to 3rd Avenue |
| 60th Street | 2nd Avenue to 6th Avenue |
| 65th Street | 3rd Avenue to McDonald Avenue |
| 86th Street | [Fort Hamilton Parkway] <u>3rd Avenue</u> to 18th Avenue[;] and 25th Avenue to Avenue U |
| 92nd Street | Fort Hamilton Parkway to 7th Avenue |

| | |
|---------------|---------------------------------------------------------|
| Willis Avenue | Willis [Ave.] <u>Avenue</u> Bridge to East 135th Street |
|---------------|---------------------------------------------------------|

(2) *Local trucks.* An operator of any truck as defined in paragraph (a) (1) above, with an origin or destination for the purpose of delivery, loading, or servicing within the Borough of the Bronx, will only operate such vehicle over the street segments designated as “Through Truck Routes” in paragraph (f)(1) above and the following street segments listed [streets,] as “Local Truck Routes,” except that an operator may operate on a street not designated below for the purpose of arriving at [his/her] the destination. This shall be accomplished by leaving a designated truck route at the intersection that is nearest and provides the most direct route to [his/her] the destination, proceeding by the most direct route while observing existing street directions and turn restrictions, and then returning to the nearest designated truck route by the most direct route. If the operator has additional destinations in the immediate vicinity, [he/she] they may proceed by the most direct route to [his/her] the next destination without returning to a designated truck route, provided that the operator’s next destination does not require that [he/she] they cross a designated truck route. All trucks must adhere to all posted signs indicating locations that limit the height of vehicles permitted to operate thereon.

LOCAL TRUCK ROUTE NETWORK

| Street | Limits |
|---------------------------------|--------------------------------------------------------------------------------------------------------------------------------------------------------------------------------------|
| Allerton Avenue | White Plains Road to Williamsbridge Road |
| Bailey Avenue | Van Cortlandt Park South to Sedgwick [Ave.] <u>Avenue</u> |
| Barry Street | Leggett Avenue to Oak Point Avenue |
| Bartow Avenue | East Gun Hill Road to Baychester Avenue |
| Baychester Avenue | East 241st Street to Edson Avenue[,] and New England Thruway (Northbound) Bartow Avenue Exit to [Co-op City Boulevard] <u>Tillotson Avenue</u> |
| Bergen Avenue | [Willis Avenue] <u>East 147th Street</u> to Westchester Avenue |
| Boone Avenue | West Farms Road to Whitlock Avenue |
| Boston Road | City Line to Bronx Park East[,] and East Tremont Avenue to Third Avenue |
| Broadway | City Line to New York County Line |
| Bronx Park East | Boston Road to [White Plains Road] <u>Bronxdale Avenue</u> |
| Brook Avenue | Webster Avenue to Elton Avenue and East 135th Street to East 132nd Street |
| Bruckner Boulevard (Northbound) | Third Avenue Bridge to <u>Willis Avenue Bridge, St. Anns Avenue to Kearney Avenue[, Kearney Avenue to MacDonough Place], and MacDonough Place to [Shore Road] Westchester Avenue</u> |
| Bruckner Boulevard (Southbound) | [Shore Road] <u>Westchester Avenue</u> to Cypress Avenue and Willis Avenue to Third Avenue Bridge |
| [Bruckner Expressway] | [New England Thruway to Triborough Bridge] |
| [Bryant Avenue] | [Bruckner Boulevard to Garrison Avenue] |
| Castle Hill Avenue | East Tremont Avenue to Lacombe Avenue |
| City Island Avenue | City Island Road to Belden Street |
| <u>City Island Circle</u> | <u>Entire Length</u> |
| City Island Road | Shore Road to City Island [Avenue] Circle and City Island Circle to <u>City Island Avenue</u> |
| Commerce Avenue | Westchester Avenue to [Zerega] <u>Haviland Avenue</u> |

§5. Subdivision (f) of section 4-13 of chapter 4 of Title 34 of the Rules of the City of New York is amended to read as follows:

(f) *Truck routing rules for the Borough of the Bronx.*

(1) *Through trucks.* An operator of any truck as defined in paragraph (a)(1) above, having neither an origin nor a destination within the Borough of the Bronx, will restrict the operation of such vehicle to those street segments on the following list. These are designated as “Through Truck Routes.” All trucks must adhere to all posted signs indicating locations that limit the height of vehicles permitted to operate thereon.

THROUGH TRUCK ROUTE NETWORK

| Street | Limits |
|----------------------------------------|--------------------------------------------------------------------------------------------------------------------------------------------------------------------------------------------------------|
| Buckner Boulevard | Willis Avenue Bridge to Bruckner Expressway Approach |
| Bruckner Expressway | New England Thruway to Triborough Bridge |
| Cross Bronx Expressway | Alexander Hamilton Bridge to [Cross Bronx Expressway] <u>Throgs Neck Bridge</u> |
| [Cross Bronx Expressway] | [Cross Bronx Expressway to Extension Throgs Neck Expressway] |
| East 135th Street | Major Deegan Expressway [Westbound] <u>Northbound-Willis Avenue Exit to Third Avenue Bridge Approach, and Major Deegan Expressway Southbound-Third Avenue Entrance to Third Avenue Bridge Approach</u> |
| Exterior Street | Major Deegan Expressway Southbound-East 138th Street Exit to [Third Avenue Bridge] <u>East 135th Street</u> |
| Hutchinson River Parkway | Bruckner Expressway to Bronx-Whitestone Bridge |
| Major Deegan Expressway | City Line to Triborough Bridge |
| New England Thruway | City Line to Bruckner Expressway |
| Sheridan [Expressway] <u>Boulevard</u> | Cross Bronx Expressway to Bruckner Expressway |
| Throgs Neck Expressway | Bruckner Expressway to Throgs Neck Bridge |

| | |
|----------------------------------------------------------------|----------------------------------------------------------------------------------------------------------------------------------------|
| Conner Street | [Provost Avenue] <u>Boston Road to Tillotson Avenue</u> |
| [Cross Bronx Expressway] | [Alexander Hamilton Bridge to Cross Bronx Expressway Extension] |
| Cross Bronx Expressway Eastbound Service Road | [Park Avenue] <u>3rd Avenue to Cross Bronx Expressway Eastbound Entrance Ramp</u> [, Harrod Avenue to Bruckner Interchange] |
| Cross Bronx Expressway Extension | Cross Bronx Expressway to Throgs Neck Expressway |
| Cross Bronx Expressway Westbound Service Road | Bruckner Interchange to Westchester Avenue, and Hugh J. Grant Circle to East 177th Street |
| Depot Place | Sedgwick Avenue to Exterior Street |
| Dickinson Avenue | [West Gun Hill Road] <u>Van Cortlandt Park South</u> to Sedgwick Avenue |
| Dupont Street | Leggett Avenue to Oak Point Avenue |
| East Bay Avenue | Tiffany Street to Halleck Street |
| East Burnside Avenue | Jerome Avenue to Valentine Avenue |
| [Eastchester Road] | [Boston Road to Williamsbridge Road] |
| East Fordham Road | Jerome Avenue to Pelham Parkway |
| East Gun Hill Road | Jerome Avenue to New England Thruway |
| East Tremont Avenue | Valentine Avenue to Dewey Avenue |
| East 132nd Street | <u>Locust Avenue to Brook Avenue</u> |
| East 135th Street | [Major Deegan Expressway Westbound-Willis Avenue Exit to Third Avenue Bridge Approach] <u>Brook Avenue to Cypress Avenue</u> |
| East 138th Street | Madison Avenue Bridge to East River |
| <u>East 139th Street</u> | <u>Morris Avenue to Third Avenue</u> |
| <u>East 140th Street</u> | <u>Locust Avenue to Bruckner Boulevard</u> |
| <u>East 141st Street</u> | <u>Locust Avenue to Bruckner Boulevard</u> |
| <u>East 147th Street</u> | <u>Third Avenue to Bergen Avenue</u> |
| [East 148th Street] | [Third Avenue to Bergen Avenue] |
| East 149th Street | 145th Street Bridge to East River |
| East 150th Street | Third Avenue to Melrose Avenue |
| East 161st Street | Jerome Avenue to Elton Avenue |
| East 163rd Street | Elton Avenue to [Stebbins] <u>Rev James A Polite Avenue</u> , and [Stebbins] <u>Rev James A Polite Avenue</u> to Hunts Point Avenue |
| East 167th Street | Jerome Avenue to River Avenue |
| [East 174th Street] | [Webster Avenue to Park Avenue] |
| East 175th Street | Cross Bronx Expressway (Westbound)-Webster Avenue Exit to Webster Avenue |
| East 177th Street | East Tremont Avenue to Cross Bronx Expressway Service Roads |
| <u>East 177th Street (Cross Bronx Expressway Service Road)</u> | <u>Cross Bronx Expressway Exit 4 EB to White Plains Road and Hugh J. Grant Circle to Havemeyer Avenue</u> |
| <u>East 178th Street</u> | <u>Valentine Avenue to Webster Avenue</u> |
| <u>East 188th Street (East Fordham Road)</u> | <u>Morris Avenue to East Fordham Road</u> |
| <u>East 189th Street</u> | <u>Washington Avenue to Webster Avenue</u> |
| East 233rd Street | Jerome Avenue to Boston Road |

| | |
|--------------------------------------------------------|---------------------------------------------------------------------------------------------------------------------------------------------|
| East 241st Street | White Plains Road to Baychester Avenue |
| <u>Eastchester Road</u> | <u>Boston Road to Williamsbridge Road</u> |
| Edgewater Road | Halleck Street to Bruckner Boulevard |
| Edson Avenue | Baychester Avenue to East Gun Hill Road |
| Edward L. Grant Highway | Washington Bridge to Jerome Avenue |
| Elton Avenue | East 163rd Street to East 161st Street |
| Exterior Street | [Jerome Avenue to Third Avenue Bridge] <u>Major Deegan Expressway Approach to Major Deegan Expressway Southbound-East 138th Street Exit</u> |
| <u>Food Center Drive</u> | <u>Halleck Street to Halleck Street</u> |
| Garrison Avenue | Leggett Avenue to Tiffany Street [, Bryant Avenue to Edgewater Road] |
| Givan Avenue | New England Thruway Southbound Service Road to Baychester Avenue |
| <u>Haviland Avenue (Commerce Avenue)</u> | <u>Commerce Avenue to Zerega Avenue</u> |
| Halleck Street | Edgewater Road to Ryawa Avenue |
| <u>Havemeyer Avenue</u> | <u>East 177th Street (Cross Bronx Expressway Eastbound Service Road) to Bruckner Boulevard</u> |
| Hollers Avenue | New England Thruway (Southbound)-Conner Street Exit to Conner Street |
| Hunts Point Avenue | Southern Boulevard to Bruckner Boulevard [, Randall Avenue to Halleck Street, Ryawa Avenue to New Market Road] |
| Hutchinson River Parkway [and Southbound] Service Road | [Bruckner Interchange] <u>Rohr Place to [Bronx-Whitestone Bridge] Hutchinson River Parkway Northbound-Schley Entrance</u> |
| Jerome Avenue | City Line to Major Deegan Expressway Approaches at the Macombs Dam Bridge |
| Kearney Avenue | [Bruckner Boulevard (Northbound)] <u>MacDonough Place</u> to Bruckner Boulevard (Northbound) |
| Lacombe Avenue | Soundview Avenue to Castle Hill Avenue |
| Lane Avenue (Westchester Square) | East Tremont Avenue to Westchester Avenue |
| <u>Locust Avenue</u> | <u>East 132nd Street to East 141st Street</u> |
| Leggett Avenue | Southern Boulevard to Randall Avenue |
| Macombs Dam Bridge Approach | Macombs Dam Bridge to Jerome Avenue |
| [Major Deegan Expressway] | [City Line to Triborough Bridge] |
| MacDonough Place | Bruckner Boulevard (Northbound) to [Bruckner Boulevard (Northbound)] <u>Kearney Avenue</u> |
| <u>Manida Street</u> | <u>Ryawa Avenue to Viele Avenue</u> |
| Melrose Avenue | [Webster Avenue] <u>East 165th Street to [Willis Avenue] East 149th Street</u> |
| <u>Morris Avenue</u> | <u>East 138th Street to East 139th Street</u> |
| Morris Park Avenue | Eastchester Road to East Tremont Avenue |
| Nereid Avenue | Webster Avenue to White Plains Road |
| [New England Thruway] | [City Line to Bruckner Expressway] |

| | |
|---------------------------------------------|--------------------------------------------------------------------------------------------------------------------------|
| New England Thruway Southbound Service Road | [Coroner] <u>Conner Street to Givan Avenue</u> |
| [New Market Road] | [East Bay Avenue to Hunts Point Avenue] |
| Oak Point Avenue | Barry Street to Halleck Street |
| [Park Avenue] | East 174th Street to Cross Bronx Expressway Eastbound Service Road] |
| Pelham Parkway | East Fordham Road to White Plains Road and Bruckner Boulevard to Shore Road |
| Pelham Parkway North | Eastchester Road to Boston Road |
| Pelham Parkway South | Boston Road to Eastchester Road |
| Provost Avenue | City Line to [Conner Street] <u>Boston Road</u> |
| Pugsley Avenue | East 177th Street to Westchester Avenue |
| Randall Avenue | Leggett Avenue to Halleck Street, and Cross Bronx Expressway Extension to East Tremont Avenue |
| <u>Rev James A Polite Avenue</u> | <u>East 163rd Street to East 163rd Street</u> |
| River Avenue | Jerome Avenue to East 149th Street |
| Ryawa Avenue | Halleck [Avenue] Street to [New Market Road] <u>Manida Street</u> |
| Sedgwick Avenue | Bailey Avenue to West Fordham Road [-] , Jerome Avenue to Depot Place, and Van Cortlandt Avenue West to Dickinson Avenue |
| [Sheridan Expressway] | [East Tremont Avenue to Bruckner Expressway] |
| Shore Road | Bruckner Expressway to City Island Road |
| Silver Street | Williamsbridge Road to East Tremont Avenue |
| Soundview Avenue | Bruckner Boulevard to Lacombe Avenue |
| Southern Boulevard | East Fordham Road [to East 163rd Street, Leggett Avenue] to East 149th Street |
| <u>St Anns Avenue</u> | <u>East 132nd Street to East 135th Street</u> |
| [Stebbins Avenue] | [East 163rd Street to East 163rd Street] |
| Third Avenue | Bruckner Boulevard to East [Fordham Road] <u>189th Street</u> |
| [Throgs Neck Expressway] | [Bruckner Expressway to Throgs Neck Bridge] |
| Tiffany Street | [Bruckner] <u>Southern Boulevard to Viele Avenue</u> |
| Tillotson Avenue | Conner Street to Co-op City Boulevard |
| Truxton Street | Leggett Avenue to Oak Point Avenue |
| University Avenue | West Fordham Road to [Washington Bridge] <u>Edward L Grant Highway</u> |
| Valentine Avenue | East Burnside Avenue to East Tremont [Ave.] <u>Avenue</u> |
| Van Cortlandt Avenue West | Bailey Avenue to Sedgwick Avenue |
| Van Cortlandt Park South | Broadway to Bailey Avenue |
| Viele Avenue | Tiffany Street to Halleck Street |
| <u>Walnut Avenue</u> | <u>East 132nd Street to East 141st Street</u> |
| <u>Washington Avenue</u> | <u>Fordham Road to East 189th Street</u> |
| Webster Avenue | City Line to [Melrose Avenue] <u>East 165th Street</u> |

| | |
|----------------------------|-------------------------------------------------------------------------------------|
| West Burnside Avenue | University Avenue to Jerome Avenue |
| West Farms Road | [East Tremont Avenue] <u>Boston Road</u> to Boone Avenue |
| West Fordham Road | University Heights Bridge to Jerome Avenue |
| West 230th Street | Broadway to Bailey Avenue |
| West Gun Hill Road | [Dickinson Avenue] <u>Van Cortlandt Park South</u> to Jerome Avenue |
| Westchester Avenue | Third Avenue to Bruckner Boulevard |
| White Plains Road | City Line to Bruckner Boulevard |
| Whitlock Avenue | Boone Avenue to Bruckner Boulevard |
| [Whittier Street] | [Bruckner Boulevard to Garrison Avenue] |
| <u>Williamsbridge Road</u> | Boston Road to East Tremont Avenue |
| Willis Avenue | [Willis Avenue Bridge] <u>East 135th Street</u> to East [149th] <u>147th Street</u> |
| Zerega Avenue | Westchester Avenue to Homer Avenue |

**NEW YORK CITY MAYOR'S OFFICE OF OPERATIONS
253 BROADWAY, 10th FLOOR
NEW YORK, NY 10007
212-788-1400**

**CERTIFICATION / ANALYSIS
PURSUANT TO CHARTER SECTION 1043(d)**

RULE TITLE: Amendment of Rules Relating to Citywide Truck Routes

REFERENCE NUMBER: DOT-92

RULEMAKING AGENCY: Department of Transportation

I certify that this office has analyzed the proposed rule referenced above as required by Section 1043(d) of the New York City Charter, and that the proposed rule referenced above:

- (i) Is understandable and written in plain language for the discrete regulated community or communities;
- (ii) Minimizes compliance costs for the discrete regulated community or communities consistent with achieving the stated purpose of the rule; and
- (iii) Does not provide a cure period because it does not establish a violation, modification of a violation, or modification of the penalties associated with a violation.

/s/ Francisco X. Navarro
Mayor's Office of Operations

January 15, 2026
Date

**NEW YORK CITY LAW DEPARTMENT
DIVISION OF LEGAL COUNSEL
100 CHURCH STREET
NEW YORK, NY 10007
212-356-4028**

**CERTIFICATION PURSUANT TO
CHARTER §1043(d)**

RULE TITLE: Amendment of Rules Relating to Citywide Truck Routes

REFERENCE NUMBER: 2026 RG 001

RULEMAKING AGENCY: Department of Transportation

I certify that this office has reviewed the above-referenced proposed rule as required by section 1043(d) of the New York City Charter, and that the above-referenced proposed rule:

- (i) is drafted so as to accomplish the purpose of the authorizing provisions of law;
- (ii) is not in conflict with other applicable rules;
- (iii) to the extent practicable and appropriate, is narrowly drawn to achieve its stated purpose; and

(iv) to the extent practicable and appropriate, contains a statement of basis and purpose that provides a clear explanation of the rule and the requirements imposed by the rule.

/s/ STEVEN GOULDEN
Senior Counsel

Date: January 15, 2026

Accessibility questions: (212) 839-6500, rules@dot.nyc.gov, by: Tuesday, June 2, 2026, 5:00 P.M.

cc

my4

SPECIAL MATERIALS

COMPTROLLER

NOTICE

NOTICE OF ADVANCE PAYMENT OF AWARDS PURSUANT TO THE STATUTES IN SUCH cases made and provided, notice is hereby given that the Comptroller of the City of New York, will be ready to pay, at 1 Centre Street, Room 629, New York, NY 10007 on 05/05/2026 to the person or persons legally entitled an amount as certified to the Comptroller by the Corporation Counsel on damage parcels, as follows:

| Damage Parcel No. | Block | Lot |
|-------------------|-------|--------------------------------|
| 279 & 279A | 13671 | PART OF AND ADJACENT TO LOT 44 |
| 280 & 280A | 13671 | PART OF AND ADJACENT TO LOT 42 |
| 217 & 217A | 13681 | PART OF AND ADJACENT TO LOT 38 |
| 218 & 218A | 13681 | PART OF AND ADJACENT TO LOT 39 |
| 219 & 219A | 13681 | PART OF AND ADJACENT TO LOT 42 |
| 220 & 220A | 13681 | PART OF AND ADJACENT TO LOT 43 |
| 221 & 221A | 13681 | PART OF AND ADJACENT TO LOT 45 |
| 222 & 222A | 13681 | PART OF AND ADJACENT TO LOT 47 |
| 223 & 223A | 13681 | PART OF AND ADJACENT TO LOT 49 |
| 224 & 224A | 13681 | PART OF AND ADJACENT TO LOT 50 |
| 225 & 225A | 13681 | PART OF AND ADJACENT TO LOT 55 |
| 226 & 226A | 13683 | PART OF AND ADJACENT TO LOT 64 |
| 227 & 227A | 13683 | PART OF AND ADJACENT TO LOT 62 |
| 228 & 228A | 13683 | PART OF AND ADJACENT TO LOT 60 |
| 229 & 229A | 13683 | PART OF AND ADJACENT TO LOT 58 |
| 230 & 230A | 13683 | PART OF AND ADJACENT TO LOT 56 |
| 231 & 231A | 13683 | PART OF AND ADJACENT TO LOT 54 |

Acquired in the proceeding entitled: Rosedale Area Streets - Stage 2 subject to any liens and encumbrances of record on such property. The amount advanced shall cease to bear interest on the specified date above.

MARK D. LEVINE
Comptroller
a21-my4

OFFICE OF THE MAYOR

NOTICE

EMERGENCY EXECUTIVE ORDER No. 2.22

April 25, 2026

WHEREAS, pursuant to a state of emergency first declared by Emergency Executive Order No. 224, dated October 7, 2022, and subsequent orders extending such state of emergency, the City has operated Humanitarian Emergency Response and Relief Centers to provide temporary housing in response to the substantial increase in new arrivals during recent years; and

WHEREAS, such orders issued prior to January 5, 2026 did not provide or require a plan for actions that would be taken to eliminate the need for the suspensions and modifications of laws and rules effected by the orders; and

WHEREAS, such state of emergency continues for the present pending the expedited development and implementation of such plan;

NOW, THEREFORE, pursuant to the powers vested in me as Mayor of the City of New York, by the laws of the State of New York and the City of New York, including but not limited to the New York Executive Law, the New York City Charter and the Administrative Code of the City of New York, and the common law authority to protect the public in the event of an emergency:

Section 1. Section 1 of Emergency Executive Order No. 2.21, dated April 20, 2026, is hereby extended for five (5) days.

§ 2. The Department of Social Services and the Department of Homeless Services, in consultation with the Law Department, shall regularly update the Mayor on the implementation action plan and efforts to phase out the continued use of facilities that have been operated in reliance on the suspensions and modifications of laws and rules.

§ 3. This Emergency Executive Order shall take effect immediately and shall remain in effect for five (5) days unless it is terminated or modified at an earlier date.

Zohran Kwame Mamdani
Mayor

APPENDIX

List of laws and regulations for which suspension continues for any facility subject to this order, including any operated by or on behalf of DSS or DHS, and any other facility existing on the effective date of this order:

- Sections 21-309 and 21-312 of the Administrative Code. (EEO No. 886, dated November 19, 2025, § 3, para. (d) and (g))
- Sections 21-124. (EEO No. 886, dated November 19, 2025, § 3, para. (h)(i))

my4

MAYOR'S OFFICE OF CONTRACT SERVICES

NOTICE

Notice of Intent to Renew or Amend Contract(s) Not Included in FY 2026 Annual Contracting Plan and Schedule

NOTICE IS HEREBY GIVEN that the Mayor will be entering into the following renewal(s)/amendment(s) of (a) contract(s) not included in the FY 2026 Annual Contracting Plan and Schedule that is published pursuant to New York City Charter § 312(a):

Agency: DPR-C
 Vendor: Asphalt Green, Inc.
 Description of Services to be Provided: Capital Construction Work at Asphalt Green Facility Sole Source Renewal
 Anticipated Procurement Method: Renewal
 Anticipated Start Date: 6/12/2026
 Anticipated End Date: 6/12/2028
 Anticipated Modifications to Scope: None
 Reason for Renewal/Amendment: Exercising the renewal option in the contract is in the best interest of the city
 Job Titles: This is a task order contract that does not simultaneously result in the award of a first task order; therefore, this information will be determined in conjunction with the issuance of each task order pursuant to this contract
 Headcount: TBD

Agency: DPR-C
 Vendor: Entech Engineering, P.C.
 Description of Services to be Provided: X045-115M - St Mary's Park Recreation Center Reconstruction SWO#9RXB
 Anticipated Procurement Method: Amendment-Task Order
 Anticipated Start Date: 3/17/2022
 Anticipated End Date: 10/31/2026
 Anticipated Modifications to Scope: Increase in additional fees for construction management services
 Reason for Renewal/Amendment: Continuation of services
 Job Titles: Project Manager; Construction Project Manager
 Headcount: 160

Agency: DPR-C
 Vendor: Sage & Coombe Architects, LLC
 Description of Services to be Provided: X045-115M - St Mary's Park Recreation Center Reconstruction SWO#5RE
 Anticipated Procurement Method: Amendment-Task Order

Anticipated Start Date: 8/14/2014
 Anticipated End Date: 6/30/2026
 Anticipated Modifications to Scope: Increase in additional fees for architecture design services
 Reason for Renewal/Amendment: Continuation of services
 Job Titles: Architects, Associate Urban Designer, Landmark Preservationist, Project Manager
 Headcount: 104

Agency: DPR-C
 Vendor: Arcadis of New York Inc.
 Description of Services to be Provided: CNYG-2822MR Construction Management Services Renewal Amendment 1
 Anticipated Procurement Method: Amendment-Master Agreement
 Anticipated Start Date: 4/25/2025
 Anticipated End Date: 4/25/2027
 Anticipated Modifications to Scope: Increase in additional capacity
 Reason for Renewal/Amendment: Continuation of services
 Job Titles: Project Manager; Construction Project Manager
 Headcount: 160

my4

CHANGES IN PERSONNEL

HOUSING PRESERVATION & DVLPMNT
FOR PERIOD ENDING 02/27/26

| NAME | TITLE | NUM | SALARY | ACTION | PROV EFF DATE | AGENCY |
|-------------|----------|---------|---------------|-----------|---------------|--------|
| HIBBERT | ELIZABET | 34202 | \$90551.0000 | APPOINTED | NO 11/23/25 | 806 |
| JOYNER | MAGGIE | 10124 | \$86804.0000 | INCREASE | NO 02/08/26 | 806 |
| KEBE | HAPHSATO | 56057 | \$51227.0000 | APPOINTED | YES 02/15/26 | 806 |
| KELLY | ROSA | L 95532 | \$207000.0000 | INCREASE | YES 02/15/26 | 806 |
| KITT SR | LESTER | M 56058 | \$72298.0000 | APPOINTED | YES 02/15/26 | 806 |
| LAMARCHE | ANGIE | P 34202 | \$90551.0000 | INCREASE | NO 02/15/26 | 806 |
| LEVY | DINA | M 94362 | \$277605.0000 | APPOINTED | YES 02/01/26 | 806 |
| LONDON | SEAN | 34202 | \$76279.0000 | APPOINTED | NO 11/23/25 | 806 |
| LU | RAY | 21210 | \$66330.0000 | APPOINTED | NO 02/03/26 | 806 |
| MORALES | ANGELINE | 12626 | \$86351.0000 | INCREASE | NO 02/08/26 | 806 |
| RASDELL | LATONYA | 12626 | \$92460.0000 | RESIGNED | NO 02/08/26 | 806 |
| RIVERA | GAMALIEL | 56058 | \$76576.0000 | INCREASE | YES 02/15/26 | 806 |
| SANCHEZ | RONALD | 1005A | \$114808.0000 | RESIGNED | NO 01/25/26 | 806 |
| SANTANA | VANESSA | D 56058 | \$72298.0000 | RESIGNED | YES 12/25/25 | 806 |
| SEVILLA | SABRINA | A 10251 | \$53479.0000 | APPOINTED | YES 11/23/25 | 806 |
| SMITH | KAYLA | J 56057 | \$51227.0000 | RESIGNED | YES 02/12/26 | 806 |
| SOLEYN | BRIANNA | 56058 | \$88650.0000 | APPOINTED | YES 02/15/26 | 806 |
| SPINELLO | MICHAEL | V 12626 | \$62517.0000 | APPOINTED | NO 11/09/25 | 806 |
| SPOONER | BEVON | R 34202 | \$76279.0000 | APPOINTED | YES 02/15/26 | 806 |
| THOMAS | DESTREE | 21744 | \$100904.0000 | APPOINTED | YES 02/15/26 | 806 |
| THOMOPOULOS | JOHN | 31675 | \$90744.0000 | INCREASE | NO 02/15/26 | 806 |
| WATSON | TRAVIS | J 31670 | \$71676.0000 | RESIGNED | NO 02/13/26 | 806 |

DEPARTMENT OF BUILDINGS
FOR PERIOD ENDING 02/27/26

| NAME | TITLE | NUM | SALARY | ACTION | PROV EFF DATE | AGENCY |
|-----------------|----------|---------|--------------|-----------|---------------|--------|
| AHMED | ADEL | M 31623 | \$73468.0000 | APPOINTED | YES 02/08/26 | 810 |
| APONTE | ANTHONY | J 31622 | \$64914.0000 | RESIGNED | YES 02/08/26 | 810 |
| BARKER | JASON | C 10251 | \$42288.0000 | APPOINTED | NO 01/11/26 | 810 |
| BEEKS | SHAUNTAY | F 10251 | \$48631.0000 | APPOINTED | NO 01/11/26 | 810 |
| CHAVIS | JAZMIN | 10251 | \$48631.0000 | APPOINTED | NO 01/11/26 | 810 |
| D'AMBROSIO | FRANK | 31629 | \$71581.0000 | APPOINTED | YES 02/08/26 | 810 |
| DONAGHY | KEVIN | J 31622 | \$71581.0000 | RESIGNED | YES 02/11/26 | 810 |
| ENGL | ANDREW | R 30087 | \$84498.0000 | RESIGNED | YES 01/29/26 | 810 |
| FRANKLIN | PAMELA | A 10251 | \$51960.0000 | RETIRED | NO 02/19/26 | 810 |
| FRAZIER | NATALIE | S 10251 | \$48631.0000 | APPOINTED | NO 02/08/26 | 810 |
| GONGORA | ANETTE | 10251 | \$48631.0000 | APPOINTED | NO 01/11/26 | 810 |
| JENDRYKA | PAWEL | 10251 | \$42288.0000 | APPOINTED | NO 01/25/26 | 810 |
| JOHNSON | KENNETH | L 31624 | \$71581.0000 | APPOINTED | YES 02/08/26 | 810 |
| JOHNSON-SQUIRES | JAMIE | D 22405 | \$79731.0000 | APPOINTED | YES 02/08/26 | 810 |
| JUAREZ | DAVID | 31622 | \$71581.0000 | RESIGNED | YES 02/14/26 | 810 |
| KINARIVALA | NATASHA | 22405 | \$79731.0000 | RESIGNED | NO 02/12/26 | 810 |
| LOYD | LUQUAN | A 56058 | \$72298.0000 | RESIGNED | YES 02/08/26 | 810 |
| LYNCH | TYRONE | A 31624 | \$71581.0000 | APPOINTED | YES 02/08/26 | 810 |
| MONDESIR | LORNA | A 10251 | \$48631.0000 | APPOINTED | NO 01/25/26 | 810 |

DEPARTMENT OF BUILDINGS
FOR PERIOD ENDING 02/27/26

| NAME | TITLE | NUM | SALARY | ACTION | PROV EFF DATE | AGENCY |
|-----------------|----------|---------|---------------|-----------|---------------|--------|
| POTAPOVA | TATIANA | 22405 | \$79731.0000 | APPOINTED | YES 02/08/26 | 810 |
| TESTANI | DOMENICO | 31622 | \$71581.0000 | RESIGNED | YES 02/10/26 | 810 |
| THOMAS | BERNADIN | 10251 | \$48631.0000 | APPOINTED | NO 01/25/26 | 810 |
| THUNDIYIL VALAT | MANUJIMA | M 31105 | \$55437.0000 | RESIGNED | NO 09/30/25 | 810 |
| VAISMAN | ANGELA | 10026 | \$200379.0000 | INCREASE | NO 02/08/26 | 810 |
| VASQUEZ | KIRA | M 10209 | \$19.3000 | APPOINTED | YES 02/20/26 | 810 |

DEPT OF HEALTH/MENTAL HYGIENE
FOR PERIOD ENDING 02/27/26

| NAME | TITLE | NUM | SALARY | ACTION | PROV EFF DATE | AGENCY |
|------------|--------|---------|---------------|-----------|---------------|--------|
| ARGUETA | MELANY | M 56057 | \$54769.0000 | RESIGNED | YES 01/13/26 | 816 |
| BORENSTEIN | DONALD | L 13402 | \$170000.0000 | APPOINTED | YES 02/08/26 | 816 |

| | | | | | | |
|-----------------|----------|---------|---------------|------------|--------------|-----|
| CHOWDHURY | RAHIMIA | R 10209 | \$17.5000 | RESIGNED | YES 01/30/26 | 816 |
| CHU | MONDIA | 8297A | \$95000.0000 | APPOINTED | NO 02/08/26 | 816 |
| CONLON | ELISSIA | 2184A | \$220684.0000 | INCREASE | YES 02/15/26 | 816 |
| COPELAND | KEVIN | S 90510 | \$48154.0000 | APPOINTED | NO 02/08/26 | 816 |
| DER | HENRY | K 10251 | \$48631.0000 | DECREASE | NO 02/08/26 | 816 |
| EDWARDS | SHAQUAN | W 31105 | \$55437.0000 | APPOINTED | NO 02/17/26 | 816 |
| ESCONDO | KIRKLYN | A 21744 | \$112883.0000 | RESIGNED | YES 02/12/26 | 816 |
| FIELDS | GLORIA | 10251 | \$48631.0000 | RESIGNED | NO 10/26/25 | 816 |
| FINE | ANDREW | D 95005 | \$185000.0000 | APPOINTED | YES 02/17/26 | 816 |
| FITZGERALD | DANIEL | C 10209 | \$21.4000 | APPOINTED | YES 02/10/26 | 816 |
| FONTANEZ-ALCANT | MARLIN | S 56057 | \$52952.0000 | INCREASE | YES 02/15/26 | 816 |
| FORTUNE | CLAUDINE | V 51011 | \$97908.0000 | RETIRED | NO 02/04/26 | 816 |
| GAY | DIANDRA | D 21744 | \$147193.0000 | INCREASE | YES 12/14/25 | 816 |
| GREEN | LETHA | 71022 | \$57790.0000 | RESIGNED | NO 02/06/26 | 816 |
| GU | PAUL | 21744 | \$112883.0000 | RESIGNED | YES 02/08/26 | 816 |
| GUVEN | SELIN | 10209 | \$21.4000 | APPOINTED | YES 02/17/26 | 816 |
| HENIEN | MARIAM | S 31215 | \$53132.0000 | RESIGNED | YES 02/08/26 | 816 |
| IRTAZA | TASMIA | S 10209 | \$21.4000 | APPOINTED | YES 02/11/26 | 816 |
| JUSTO-CRUZ | DAVID | R 10209 | \$17.7500 | RESIGNED | YES 02/14/26 | 816 |
| KIELTY | KELLY | E 21744 | \$138465.0000 | INCREASE | YES 02/15/26 | 816 |
| KING | RASHANA | 1022A | \$65000.0000 | APPOINTED | YES 02/17/26 | 816 |
| LIAN | ZI | 21744 | \$112883.0000 | RESIGNED | YES 02/06/26 | 816 |
| LIZARES | ROLAND | N 1000D | \$78633.0000 | PROMOTED | NO 02/01/26 | 816 |
| LOPEZ | SAMARA | C 10209 | \$18.8000 | APPOINTED | YES 02/12/26 | 816 |
| MANNING | HASAN | K 81815 | \$23.4800 | RESIGNED | NO 11/15/25 | 816 |
| MICHEL | TEDDY | L 10124 | \$63371.0000 | TERMINATED | NO 02/01/26 | 816 |
| MIKHAIL | MANAL | S 51195 | \$24.8800 | APPOINTED | NO 02/08/26 | 816 |
| MOHAMEDALI | ELAF | A 10209 | \$19.3000 | RESIGNED | YES 02/14/26 | 816 |
| MOOG | BERENICE | C 40910 | \$90680.0000 | APPOINTED | NO 11/16/25 | 816 |
| MOREHEAD | LIZETTE | L 56058 | \$66080.0000 | RESIGNED | YES 02/18/26 | 816 |
| MORRISON | JASON | M 1022A | \$104000.0000 | APPOINTED | YES 02/15/26 | 816 |
| NAQVI | SYEDA IF | Z 13611 | \$68814.0000 | RETIRED | NO 01/31/26 | 816 |
| NESBITT | BRYANT | A 52040 | \$55684.0000 | APPOINTED | YES 02/17/26 | 816 |

DEPT OF HEALTH/MENTAL HYGIENE
FOR PERIOD ENDING 02/27/26

| NAME | TITLE | NUM | SALARY | ACTION | PROV EFF DATE | AGENCY |
|-------------|----------|---------|---------------|-----------|---------------|--------|
| PETERS | SHANELL | J 56057 | \$52952.0000 | INCREASE | YES 02/15/26 | 816 |
| PIERRE-NOEL | YVON | A 31215 | \$54377.0000 | DECREASE | NO 05/26/25 | 816 |
| RAMOVIC | ALMIRA | 51022 | \$40.7000 | RESIGNED | YES 01/31/26 | 816 |
| RICE | SAVANNAH | M 13633 | \$113400.0000 | APPOINTED | YES 02/08/26 | 816 |
| ROMANO | MEGHAN | A 51611 | \$77211.0000 | APPOINTED | YES 02/08/26 | 816 |
| RUIZ | SARAI | 10209 | \$18.8000 | APPOINTED | YES 02/11/26 | 816 |
| SCAVONE | CHRISTOP | C 90635 | \$56887.0000 | APPOINTED | NO 02/08/26 | 816 |
| SIEVERS | REBECCA | L 21744 | \$100904.0000 | INCREASE | YES 02/16/26 | 816 |
| SILVA | CAROLINA | A 51195 | \$24.8800 | APPOINTED | NO 02/10/26 | 816 |
| SYDNR | KENYETTA | D 10124 | \$68333.0000 | INCREASE | NO 01/11/26 | 816 |
| TRAPP | TANYA | 10252 | \$71160.0000 | RETIRED | NO 02/12/26 | 816 |
| WANG | RICHARD | S 10209 | \$21.4000 | APPOINTED | YES 02/08/26 | 816 |
| YEH | SHANNA | Y 10209 | \$21.4000 | APPOINTED | YES 02/19/26 | 816 |

ADMIN TRIALS AND HEARINGS
FOR PERIOD ENDING 02/27/26

| NAME | TITLE | NUM | SALARY | ACTION | PROV EFF DATE | AGENCY |
|----------|----------|---------|---------------|-----------|---------------|--------|
| AMPUERO | KIARA | K 30087 | \$106404.0000 | RESIGNED | YES 02/06/26 | 820 |
| CAUGHMAN | VANESSA | J 13652 | \$113280.0000 | RETIRED | NO 02/17/26 | 820 |
| GENTILE | VINCENT | J 95005 | \$185380.0000 | RETIRED | YES 08/31/25 | 820 |
| GRUBMAN | JENNIFER | L 30086 | \$72510.0000 | APPOINTED | YES 02/08/26 | 820 |
| HARBER | HAZEL | B 12158 | \$47.7400 | RESIGNED | YES 02/25/25 | 820 |
| JAMES | DIANE | 10124 | \$84200.0000 | APPOINTED | YES 02/08/26 | 820 |
| KATZ | NOAH | D 10209 | \$19.8000 | RESIGNED | YES 02/10/26 | 820 |
| MAYUGA | VILDA | V 30189 | \$268493.0000 | APPOINTED | YES 02/08/26 | 820 |
| TAZRIN | JANNATUL | 60910 | \$62534.0000 | RESIGNED | YES 02/08/26 | 820 |
| WONG | EDMUND | 10124 | \$67513.0000 | APPOINTED | YES 02/08/26 | 820 |

DEPT OF ENVIRONMENT PROTECTION
FOR PERIOD ENDING 02/27/26

| NAME | TITLE | NUM | SALARY | ACTION | PROV EFF DATE | AGENCY |
|-----------------|----------|---------|---------------|------------|---------------|--------|
| ACOSTA CARABALL | YARITZA | R 21744 | \$87743.0000 | RESIGNED | YES 02/13/26 | 826 |
| BENSEDRINE | EMILE | A 56058 | \$62868.0000 | APPOINTED | YES 02/08/26 | 826 |
| BROOKS | SIMONE | N 10251 | \$53479.0000 | APPOINTED | NO 01/25/26 | 826 |
| CHEN | JIAN YE | 10251 | \$46516.0000 | APPOINTED | NO 01/25/26 | 826 |
| CHOU | CHEN YUA | 13632 | \$109518.0000 | RETIRED | NO 02/12/26 | 826 |
| GABRIEL | MARK | L 91717 | \$480.9700 | RESIGNED | YES 02/19/26 | 826 |
| GARCIA | LISA F | 94358 | \$291821.0000 | APPOINTED | YES 02/08/26 | 826 |
| GIANNELLI | JOSEPH T | 13632 | \$123208.0000 | INCREASE | YES 02/17/26 | 826 |
| HACKIMER | MACKENNA | B 21744 | \$74536.0000 | APPOINTED | YES 02/08/26 | 826 |
| HASSAN | SHAZIM | I 20410 | \$76279.0000 | APPOINTED | YES 02/08/26 | 826 |
| HURTADO | RAFAEL | A 91011 | \$49517.0000 | RESIGNED | YES 02/01/26 | 826 |
| IDEMU | MORENIKE | M 56058 | \$82811.0000 | APPOINTED | YES 02/08/26 | 826 |
| INFANTE | MIGUEL | S 20403 | \$68709.0000 | APPOINTED | YES 02/08/26 | 826 |
| KARAMCHAND | ERICK | 92611 | \$327.3600 | APPOINTED | YES 02/08/26 | 826 |
| KIM | BRIAN | J 56058 | \$62686.0000 | APPOINTED | YES 02/08/26 | 826 |
| LIVINGSTON | ERNEST | L 10015 | \$127038.0000 | RETIRED | NO 01/03/24 | 826 |
| MILLIEN | NERLANDE | 10251 | \$42288.0000 | TERMINATED | NO 01/09/26 | 826 |
| PANAYIOTOU | PETROS | 20210 | \$87701.0000 | PROMOTED | NO 03/16/25 | 826 |
| PHILIPPOSE | JESTIN | M 22425 | \$68871.0000 | RESIGNED | YES 02/08/26 | 826 |
| PRYOR | ALEXIA | A 20616 | \$68709.0000 | APPOINTED | YES 02/08/26 | 826 |
| RICHTER | KAITLYN | N 06804 | \$200000.0000 | INCREASE | YES 02/16/26 | 826 |
| RISSOLO | MICHELLE | A 21744 | \$124836.0000 | RETIRED | YES 02/18/26 | 826 |
| SHUKLA | SHASHANK | 13631 | \$89003.0000 | RESIGNED | NO 02/10/26 | 826 |
| ST. LAWRENCE | GRETEL | S 56058 | \$62868.0000 | APPOINTED | YES 02/08/26 | 826 |
| STEPHAN | EMILY | A 21744 | \$109565.0000 | APPOINTED | YES 02/08/26 | 826 |
| STROUD | MADISON | J 10251 | \$48631.0000 | APPOINTED | NO 01/25/26 | 826 |
| VOUSE | YVONNE | 10251 | \$48631.0000 | APPOINTED | NO 01/25/26 | 826 |

DEPARTMENT OF SANITATION
FOR PERIOD ENDING 02/27/26

Table with columns: NAME, TITLE, NUM, SALARY, ACTION, PROV, EFF DATE, AGENCY. Lists employees like ABUNDIS RAMIREZ, AGYEMAN, AKHRAMCHUK, etc.

DEPARTMENT OF SANITATION
FOR PERIOD ENDING 02/27/26

Table with columns: NAME, TITLE, NUM, SALARY, ACTION, PROV, EFF DATE, AGENCY. Lists employees like BRADLEY, BROWDER, BROWN, etc.

DEPARTMENT OF SANITATION
FOR PERIOD ENDING 02/27/26

Table with columns: NAME, TITLE, NUM, SALARY, ACTION, PROV, EFF DATE, AGENCY. Lists employees like HASKINS, HEALY, HENRY, etc.

Table with columns: NAME, TITLE, NUM, SALARY, ACTION, PROV, EFF DATE, AGENCY. Lists employees like LAURENCY, LEGIONS, LOPEZ, etc.

DEPARTMENT OF SANITATION
FOR PERIOD ENDING 02/27/26

Table with columns: NAME, TITLE, NUM, SALARY, ACTION, PROV, EFF DATE, AGENCY. Lists employees like OFORI, OLAVARRIA JR., ONOFRE, etc.

BUSINESS INTEGRITY COMMISSION
FOR PERIOD ENDING 02/27/26

Table with columns: NAME, TITLE, NUM, SALARY, ACTION, PROV, EFF DATE, AGENCY. Lists employees like DADI, RIVERA.

DEPARTMENT OF FINANCE
FOR PERIOD ENDING 02/27/26

Table with columns: NAME, TITLE, NUM, SALARY, ACTION, PROV, EFF DATE, AGENCY. Lists employees like AYBASTI, BRAY, CHOWDHURY, etc.