

- ELECTRICAL LEGENDS:**
1. SERVICE END BOX CON-ED SPEC EO-9525-B.
 2. (2) 600AMP SERVICE SWITCH FOR THE APARTMETR METER BANK.
 3. 250AF/400AS SERVICE SWITCH(SS#2) FOR BASE BUILDING.
 4. NEW METERBANK FOR APARTMENTS FOR BASE BUILDING.
 5. 150AMP HOUSE PANEL "HP-1".
 6. 100AMP HOUSE PANEL "HP-2".
 7. 20AF/30AS SERVICE SWITCH(SS#3) & METER STACKED FOR FIRE ALARM.
 8. 70AF/100AS SERVICE SWITCH(SS#4) & METER STACKED FOR SOLAR SYSTEM.

- ELECTRICAL KEYED NOTES:**
- A. E.C TO PROVIDE AND MAINTAIN WORKING SPACE IN FRONT OF THE ELECTRICAL EQUIPMENT PER NEC 110.26. ENSURE A MINIMUM CLEARANCE OF 3 FEET IN DEPTH, 30 INCHES IN WIDTH, AND 6 FEET 6 INCHES IN HEIGHT FOR SAFE OPERATION AND MAINTENANCE.
 - B. E.C TO PROVIDE DEDICATED SPACE FOR ELECTRICAL EQUIPMENT PER NEC 110.26(E). MAINTAIN A CLEAR ZONE EQUAL TO THE WIDTH AND DEPTH OF THE EQUIPMENT, EXTENDING 6 FEET ABOVE OR TO THE STRUCTURAL CEILING, WHICHEVER IS LOWER. FOREIGN SYSTEMS SUCH AS PIPING OR DUCTS ARE PERMITTED ABOVE THIS SPACE ONLY IF PROTECTED. A DRIP PAN SHALL BE INSTALLED TO PREVENT DAMAGE FROM LEAKS OR CONDENSATION.
 - C. E.C TO INSTALL OVERCURRENT PROTECTION DEVICES PER NEC 240.24. ENSURE ACCESSIBILITY, WITH THE HIGHEST OPERATING HANDLE NOT EXCEEDING 6 FT 7 IN. ABOVE THE FLOOR OR PLATFORM.
 - D. ALL RACEWAYS, BOXES, CABINETS, AND FITTINGS INSTALLED INSIDE THE BUILDING SHALL BE PROTECTED AGAINST CORROSION PER NEC 300.6. IN INDOOR WET LOCATIONS, ENSURE A 1/4-INCH AIRSPACE BETWEEN EXPOSED WIRING SYSTEMS AND SUPPORTING SURFACES TO PREVENT MOISTURE RETENTION AND DETERIORATION.

newyork engineers
MEP ENGINEERING
55 BROAD STREET, 4TH FLOOR
NEW YORK, NY 10004
T: 212-575-5300 ny-engineers.com

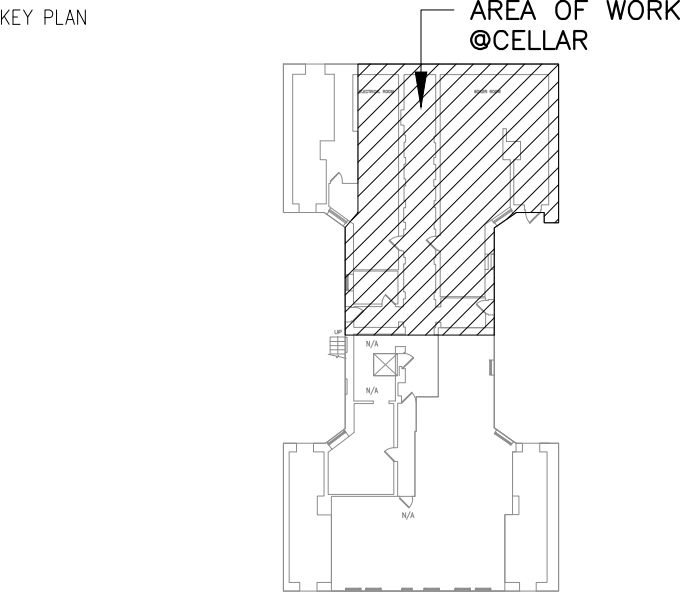

PROJECT NAME

415 WASHINGTON AVE
BOILER REPLACEMENT

PHYSICAL LOCATION

415 WASHINGTON AVE,
BROOKLYN, NY 11238

DRAWING TITLE

CELLAR BOILER ROOM
ELECTRICAL POWER
PART PLAN

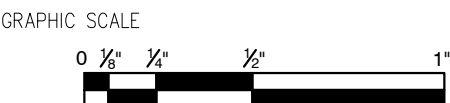

PROJECT NO. —
SCALE AS NOTED
DRAWN BY NYE
CHECKED BY NYE
DATE 01-16-23
SHEET NUMBER
E-200.00

1 CELLAR BOILER ROOM ELECTRICAL POWER PART PLAN
SCALE: 3/8"=1'-0"

THIS PLAN IS APPROVED ONLY FOR THE WORK INDICATED ON THE APPLICATION SPECIFICATION SHEET. ALL OTHER MATTERS SHOWN ARE NOT TO BE RELIED UPON, OR BE CONSIDERED AS BEING APPROVED OR IN ACCORDANCE WITH APPLICABLE CODES