

THE CITY OF NEW YORK  
HOUSING AND DEVELOPMENT ADMINISTRATION  
DEPARTMENT OF BUILDINGS

DEPARTMENTAL MEMORANDUM

DATE: January 26, 1973

TO: Borough Superintendents

FROM: Thomas V. Burke, P.E., Director of Operations

SUBJECT: Required Width of Stair Landings and Swing of Stair Doors -  
Section C26-604.8 (g)

A question has been raised in regard to Section C26-604.8 (g), which requires that "The swing of stair doors shall not block stairs or stair landings, nor shall any door at any point of its swing reduce the effective width of the landing or stair to less than 75% of the required width of the landing or stair, or to less than the width of the door opening on them".

The sketches on Enclosure No. 1 illustrates the clearance required for any width stair and door (sk.A), for a 36" door opening on a 36" stair (sk. B) and a 36" door opening on a 44" stair (sk. C). In these cases, note that the required clearance is usually equal to the door width. In the case of the 36" door opening on a 44" stair (sk. C), the required 44" landing width may be obstructed a maximum of 8" by the door swing.

*Thomas V. Burke*  
Thomas V. Burke, P.E.  
Director of Operations

TVB:IEM:JD:njk

cc: Comm. Stein  
Ass't Comm. Walsh  
Exec. Staff  
Industry

SK. A

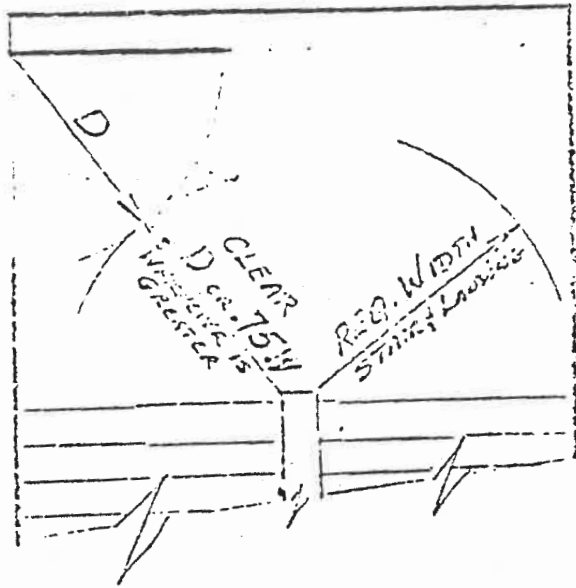

D = ACTUAL WIDTH OF  
THE DOOR

W = REQUIRED WIDTH  
OF STAIR

SK. B

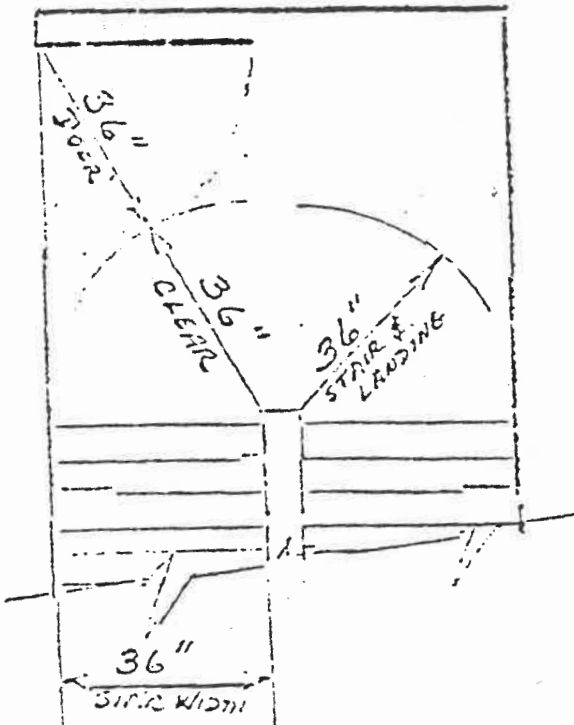

SK. C

