

CITY OF NEW YORK
DEPARTMENT OF BUILDINGS

Pursuant to Administrative Code Section 27-131, the following equipment or material has been found acceptable for use in accordance with the Report of the Material and Equipment Acceptance (MEA) Division.

Patricia J. Lancaster, A.I.A., Commissioner
MEA 248-03-M

Report of Material and Equipment Acceptance Division

Manufacturer – Oldcastle Precast Inc., 123 CR 101, South Bethlehem, NY 12161.

Trade Name – Oldcastle Precast Inc.

Product – Hollow core, prestressed, precast concrete slabs.

Pertinent Code Section(s) – 27-323, 27-324.

Prescribed Test(s) – RS 5-2 (ASTM E119-61).

Laboratory – Underwriters Laboratories Inc.

Test Reports – File R4130-1, dated June 12, 1958, File R4130-2, dated December 1, 1958 and File R7847, dated March 5, 1976 and UL Design #J994.

Description – Precast, prestressed hollow core concrete slabs of 8, 10, and 12 inch depth and 39 inch nominal width, using normal weight concrete having a minimum compressive strength of 4000 psi. The prestressing strands conform to the requirements of ASTM A416-68 and have a minimum clear cover of $\frac{3}{4}$ inch. A cross-section of the 8, 10, and 12 inch slab is shown below:

Design No. J994

Restrained Assembly Ratings — 1-1/2, 2, 3, 4 Hr.

Unrestrained Assembly Rating — 1-1/2 Hr.

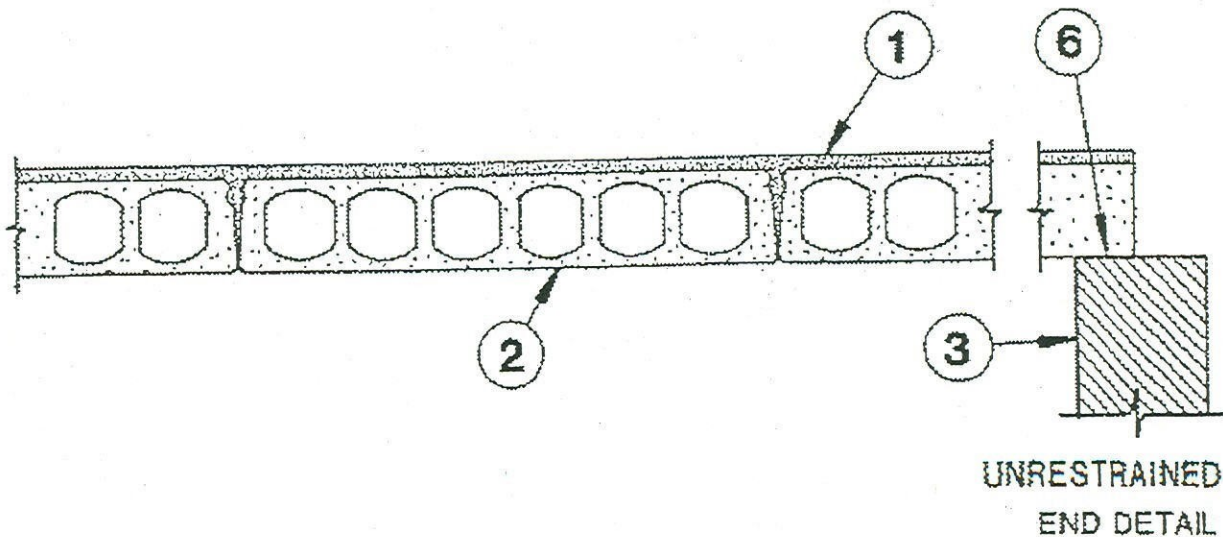

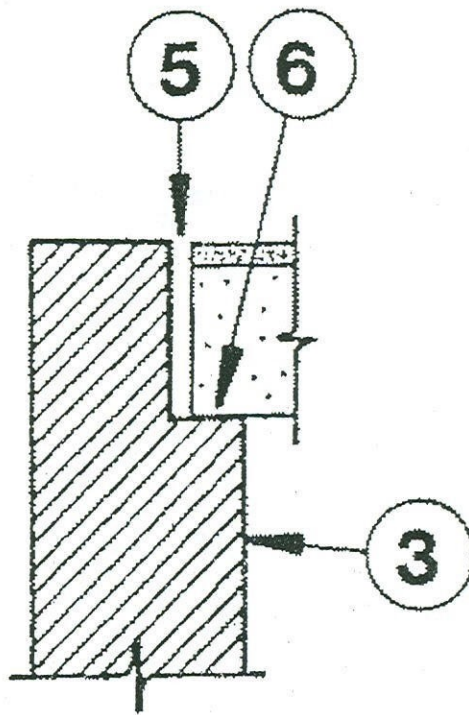

RESTRAINED END DETAIL

1. Concrete Topping — 3000 psi compressive strength, 110 to 153 pcf unit weight.

Assembly Rating Hr	Min Topping Thkns In.
1-1/2	0
2	1
3	2-1/8
4	3-3/8

1A. Floor Topping Mixture* — (Alternate to concrete topping) — 8 gal max water to 80 lbs min of floor topping mixture to 180 lbs max of sand compressive strength, 1000 psi.

Rating Hr	Mtl Thkns In.
2	1/2
3	1

HACKER INDUSTRIES INC — Firm-Fill Gypsum Concrete, Firm-Fill 2010, Firm-Fill 4010, Firm-Fill High Strength and Gyp-Span Radiant.

Floor Mat Materials* — (Optional) — Floor mat material nom 1/4 in. thick adhered to subfloor with Hacker Floor Primer. Primer to be applied to the surface of the mat

prior to the placement of a min 1-1/2 in. of floor-topping mixture.

HACKER INDUSTRIES INC — Type Sound-Mat.

1B. Alternate Floor Topping Mixture* — 3 to 7 gal of water mixed with 80 lbs of floor topping mixture and 1.0 to 2.1 cu ft of sand. Compressive strength to be 1000 psi min. Min thickness to be 3/4 in.

Rating Hr	Mtl Thkns In.
2	1/2
3	1

MAXXON CORP — Type D-C, GC, GC 2000, L-R or T-F.

Floor Mat Materials* — (Optional) — Floor mat material nom 1/4 in. thick adhered to subfloor with Maxxon Floor Primer. Primer to be applied to the surface of the mat prior to lath placement.

MAXXON CORP — Type Acousti-Mat.

Metal Lath — For use with floor mat material, 3/8 in. expanded galvanized steel diamond mesh, 3.4 lbs/sq yd placed over the floor mat material. Floor topping thickness a nom 1 in. over the floor mat.

Alternate Floor Mat Materials* (Optional)— Floor mat material nom 1/4 in. thick loose laid over the subfloor. Maxxon Floor Primer to be applied to the surface of the mat prior to the floor topping placement. Floor topping thickness a min 1 in. over the floor mat.

MAXXON CORP — Type Acousti-Mat II.

1C. Alternate Floor Topping Mixture* — Compressive strength to be 1500 psi minimum.

Rating Hr	Material Thickness-In.
2	1/2
3	1

UNITED STATES GYPSUM CO — Levelrock 2500, Levelrock RH

Floor Mat Materials* — (Optional) — Floor mat material nom 0.4 in. thick loose laid over the subfloor. Floor topping thickness a min 1 in. over the floor mat.

UNITED STATES GYPSUM CO — Type USG Sound Mat

Alternate Floor Mat Materials* — (Optional) - Floor mat material ranging from 3/8 in. to 3/4 in. thick loose laid over the subfloor. Floor topping thickness a min 1 in. over the floor mat.

UNITED STATES GYPSUM CO — Levelrock Brand Sound Reduction Board

1D. Alternate Floor Topping Mixture* — Compressive strength to be 2100 psi minimum. Refer to manufacturer's instructions accompanying the material for specific mix design.

Rating Hr	Material Thickness-In.
2	1/2
3	1

UNITED STATES GYPSUM CO — Levelrock 3500, Levelrock Commercial RH

Floor Mat Materials* — (Optional) — Floor mat material nom 0.4 in. thick loose laid over the subfloor. Floor topping thickness a min 1 in. over the floor mat.

UNITED STATES GYPSUM CO — Type USG Sound Mat

Alternate Floor Mat Materials* — (Optional) - Floor mat material ranging from 3/8 in. to 3/4 in. thick loose laid over the subfloor. Floor topping thickness a min 1 in. over the floor mat.

UNITED STATES GYPSUM CO — Levelrock Brand Sound Reduction Board

1E. Alternate Floor Topping Mixture* — Compressive strength to be 3000 psi minimum. Refer to manufacturer's instructions accompanying the material for specific mix design.

Rating Hr	Material Thickness-In.
2	1/2
3	1

UNITED STATES GYPSUM CO — Levelrock 4500

Floor Mat Materials* — (Optional) — Floor mat material nom 0.4 in. thick loose laid over the subfloor. Floor topping thickness a min 1 in. over the floor mat.

UNITED STATES GYPSUM CO — Type USG Sound Mat

Alternate Floor Mat Materials* — (Optional) - Floor mat material ranging from 3/8 in. to 3/4 in. thick loose laid over the subfloor. Floor topping thickness a min 1 in. over the floor mat.

UNITED STATES GYPSUM CO — Levelrock Brand Sound Reduction Board

1F. Alternate Floor Topping Mixture* — Compressive strength to be 3000 psi minimum. Refer to manufacturer's instructions accompanying the material for specific mix design.

Rating Hr	Material Thickness-In.
2	1/2
3	1

UNITED STATES GYPSUM CO — Levelrock SLC

Floor Mat Materials* — (Optional) — Floor mat material nom 0.4 in. thick loose laid over the subfloor. Floor topping thickness a min 1 in. over the floor mat.

UNITED STATES GYPSUM CO — Type USG Sound Mat

Alternate Floor Mat Materials* — (Optional) - Floor mat material ranging from 3/8 in. to 3/4 in. thick loose laid over the subfloor. Floor topping thickness a min 1 in. over the floor mat.

UNITED STATES GYPSUM CO — Levelrock Brand Sound Reduction Board

1G. Alternate Floor Topping Mixture* — 4 to 7 gal of water mixed with 80 lbs of floor topping mixture and 1.4 to 1.9 cu ft of sand. Compressive strength to be 1200 psi min. Min thickness to be 3/4 in.

Rating Hr	Material Thickness-In.
2	1/2
3	1

RAPID FLOOR SYSTEMS — Type RF, RFP or RFU.

Floor Mat Materials* — (Optional)- Floor mat material nom 1/4 in. thick adhered to subfloor with Maxxon Floor Primer. Primer to be applied over the surface of the mat prior to lath placement.

MAXXON CORP — Type Acousti-Mat.

Metal lath — For use with floor mat material, 3/8 in. expanded galvanized steel diamond mesh, 3.4 lbs/sq yd placed over the floor mat material. Floor topping thickness a nom 1 in. over the floor mat. **Alternate Floor Mat Material*** — (Optional)- Floor mat material nom 1/4 in. thick loose laid over the subfloor. Maxxon Floor Primer to be applied to the surface of the mat prior to the floor topping placement. Floor topping thickness a min 1 in. over the floor mat.

MAXXON CORP — Type Acousti-Mat II.

2. **Precast Concrete Units*** — Nom 8, 10 or 12 in. deep by 4 ft wide units. Carbonate aggregate concrete, cross-section similar to above illustration.

CORESLAB STRUCTURES INC

CORESLAB STRUCTURES (ONT) INC

OLDCASTLE PRECAST INC

3. **End Details** — Restrained and Unrestrained.

4. **Joint** — (Not Shown) — Grouted full length with sand-cement grout unless concrete topping is used.

Note: A 3/8 in. wide lateral expansion joint to be provided the full length and depth of the slabs for each 14 ft of width. Expansion obtained with noncombustible, compressible material, for example 6 sheets of 1/8 in. thick ceramic fiber paper.

5. **End Clearance** — Clearance for expansion at each end of slab shall be equal to $(L/17) \times (1/4 (+ \text{ or } -) 1/14)$ in. where 1 "L" is equal to length of span in feet.

6. **Min Bearing** — 1-1/2 in. for assembly rating of 3 hr or less and 3 in. for assembly rating of 4 hr.

*Bearing the UL Classification Mark

Recommendation – That the assembly shown above be accepted as having the hourly fire resistance ratings listed for floor and ceiling assemblies provided the follow conditions are complied with:

1. Structural requirements shall comply with Article 10, Reference Standard RS 10-3 and other applicable provisions of the Building Code.
2. Minimum bearing on supports as specified in UL File must be provided. The acceptance of this assembly is limited to fire resistance only. Structural and other requirements shall be in compliance with pertinent Building Code provisions an above mentioned limitations.

All shipments and deliveries of such equipment shall be provided with a metal tag, suitable placed, certifying that the materials shipped or delivered are equivalent to those tested and acceptable for use, as provided for in Section 27-131 of the Building Code.

Final Acceptance OCT/29/03
Examined by S Deekhudan