

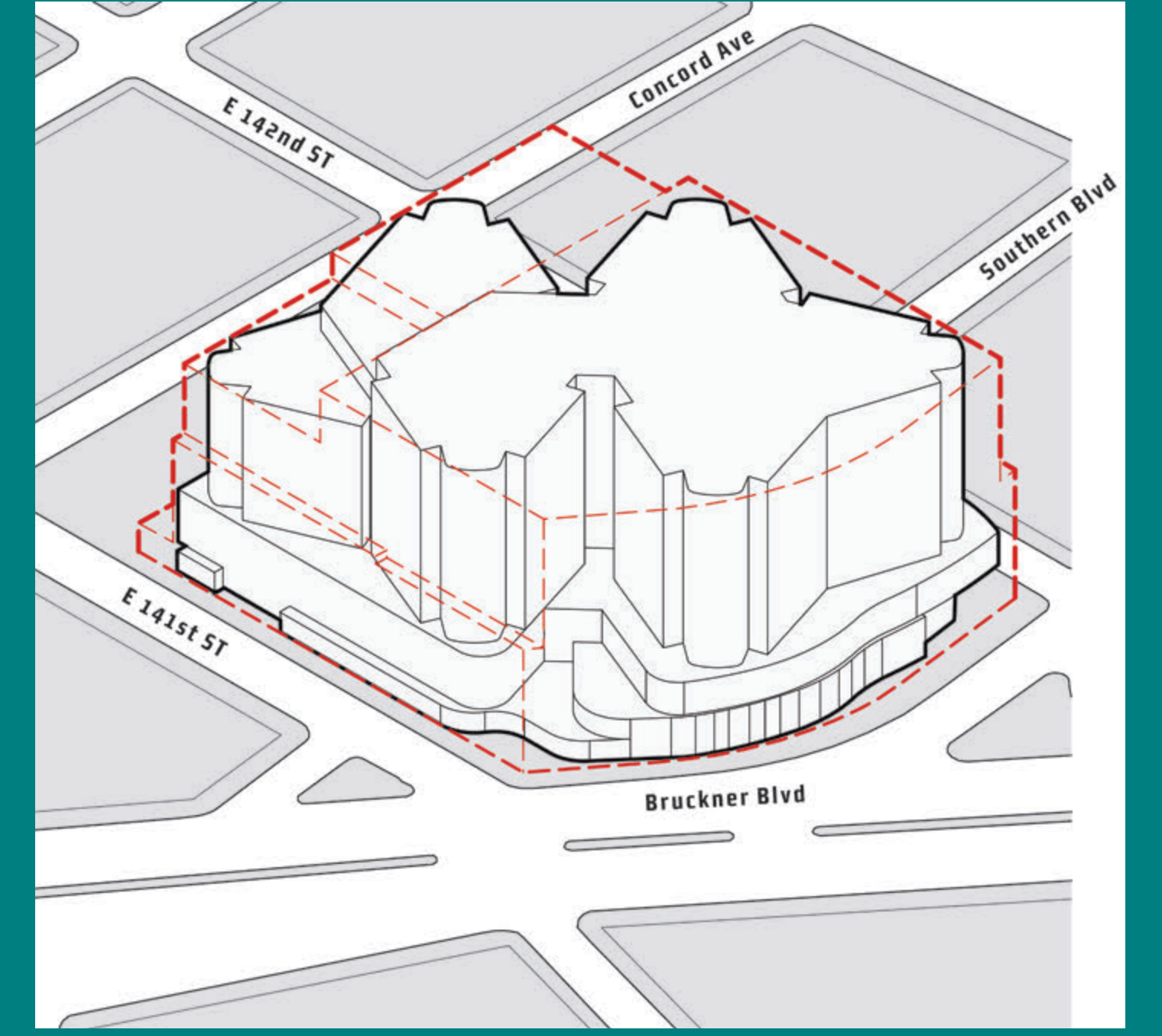

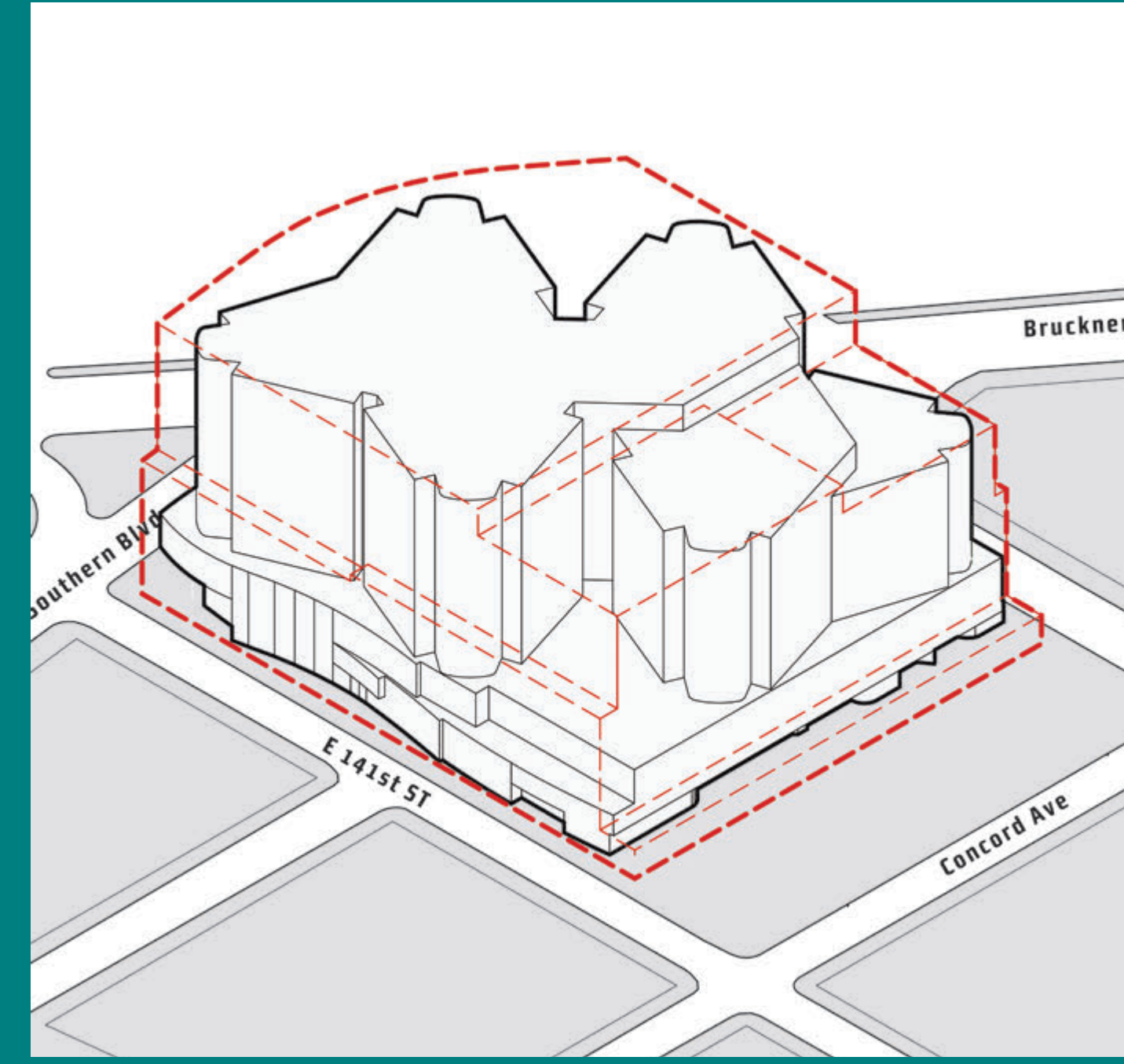

# Exterior Architecture

## Massing Strategy

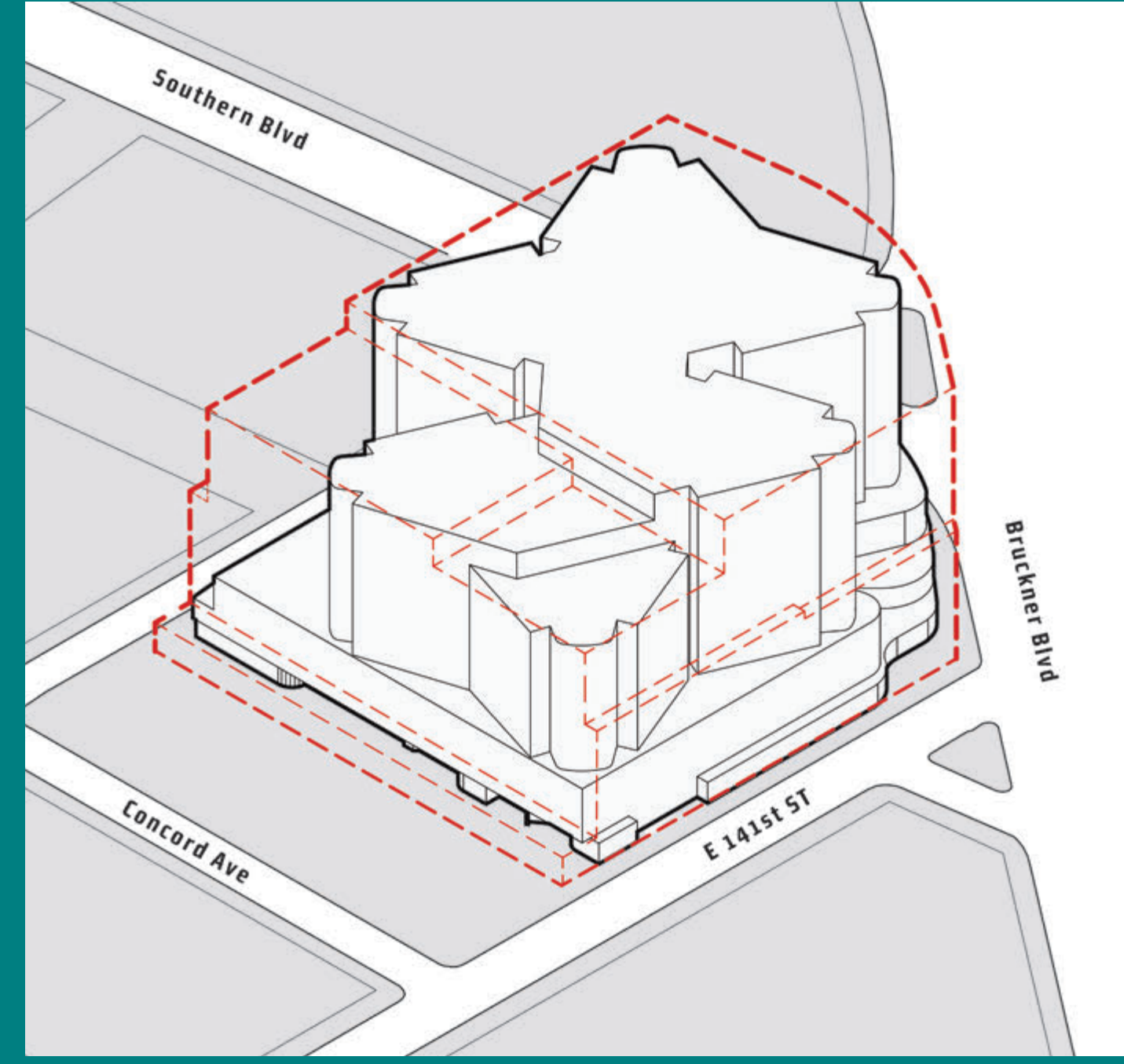
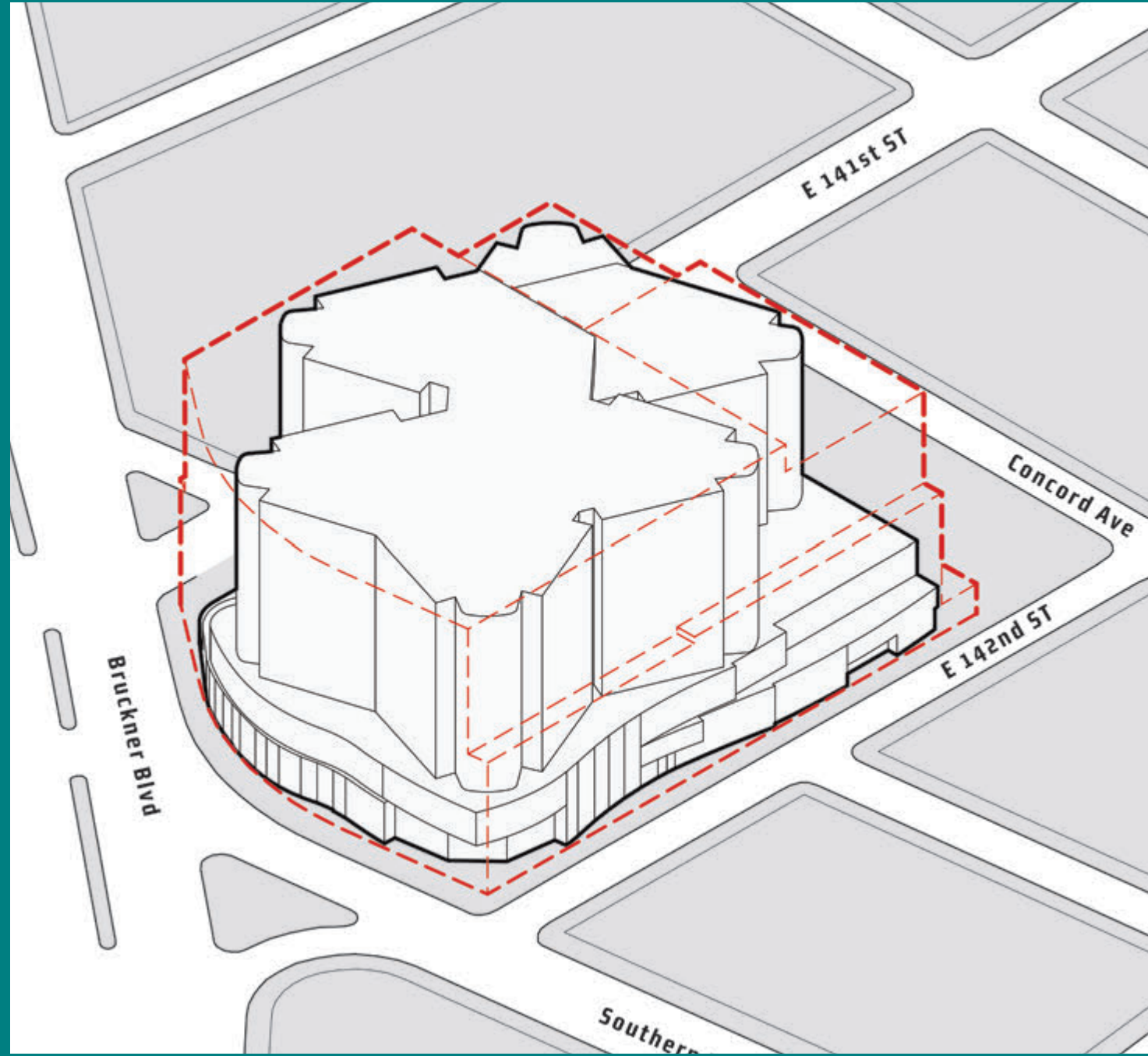

Building envelope adhering to setbacks as defined by the zoning requirements.

## Design Approach

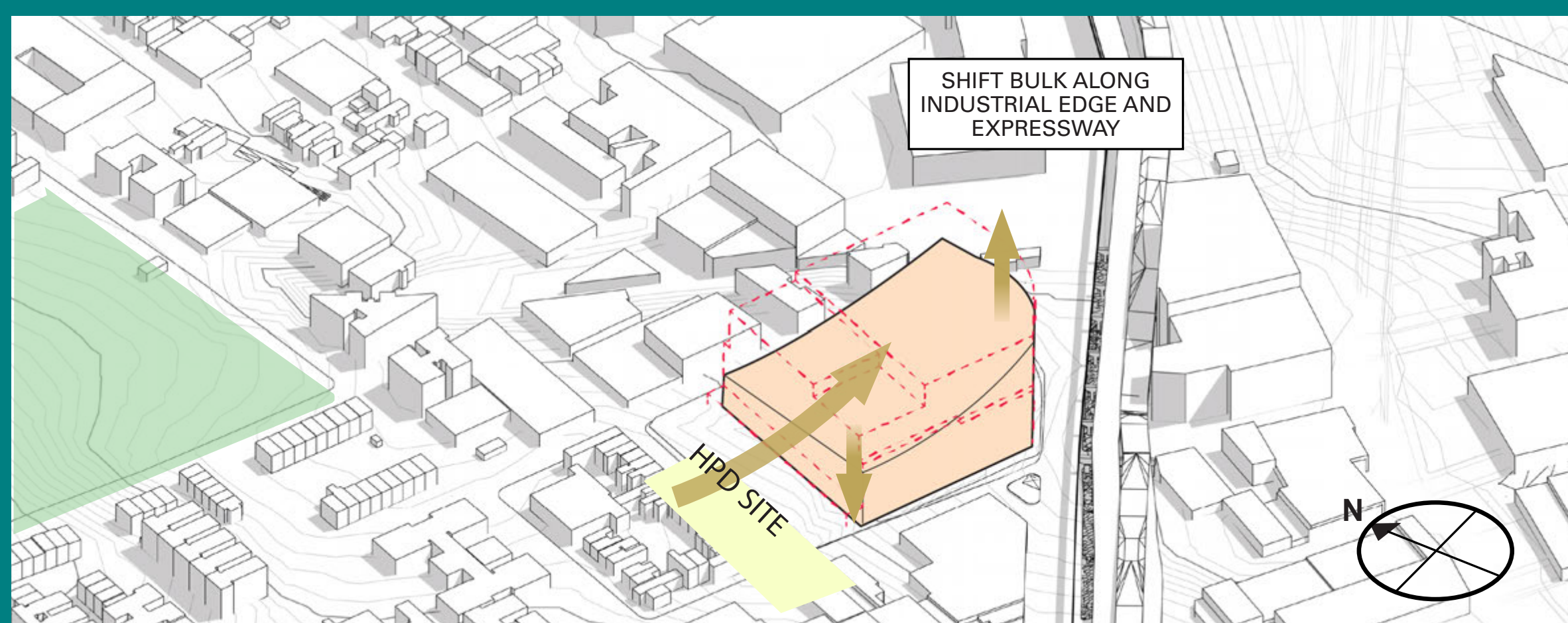

### Massing Strategy

The massing strategy responds to the neighborhood by gradually stepping from west to east, the building minimizes the height and massing on the low-rise residential side, and maximizes the height and massing toward the Bruckner Expressway.

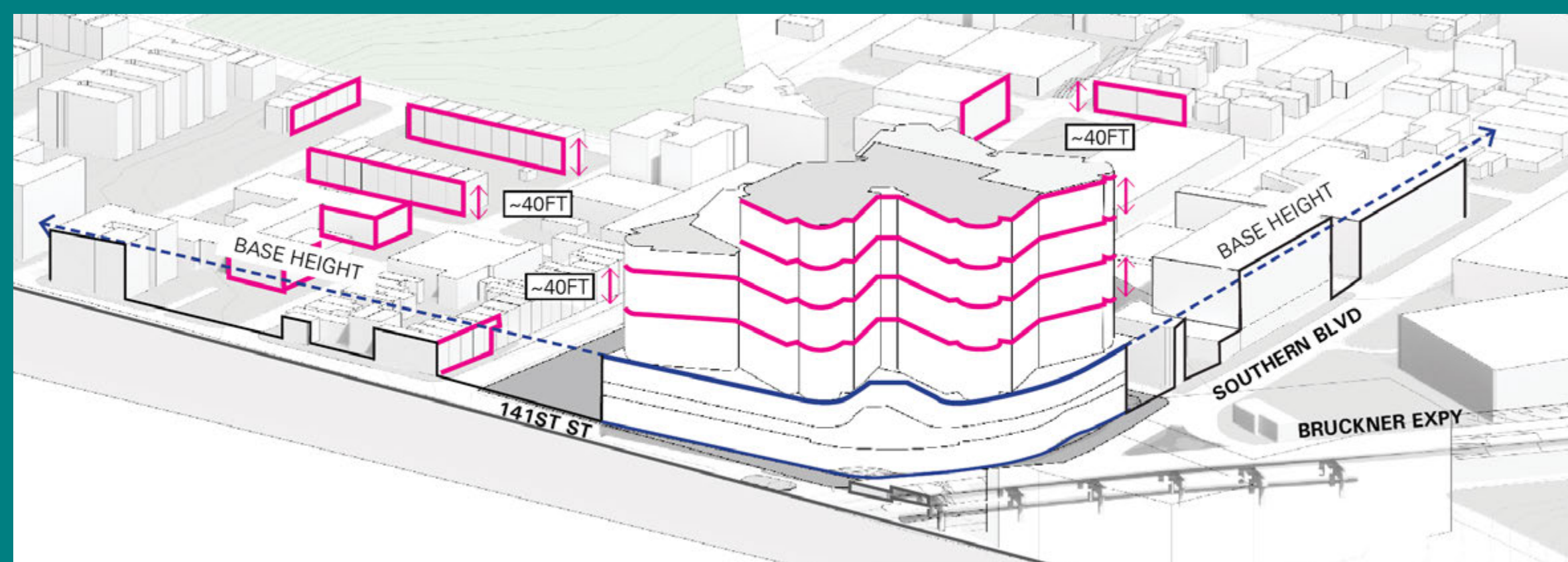

### Building Height

Subdivide building to relate to buildings in the neighborhood using horizontal features.

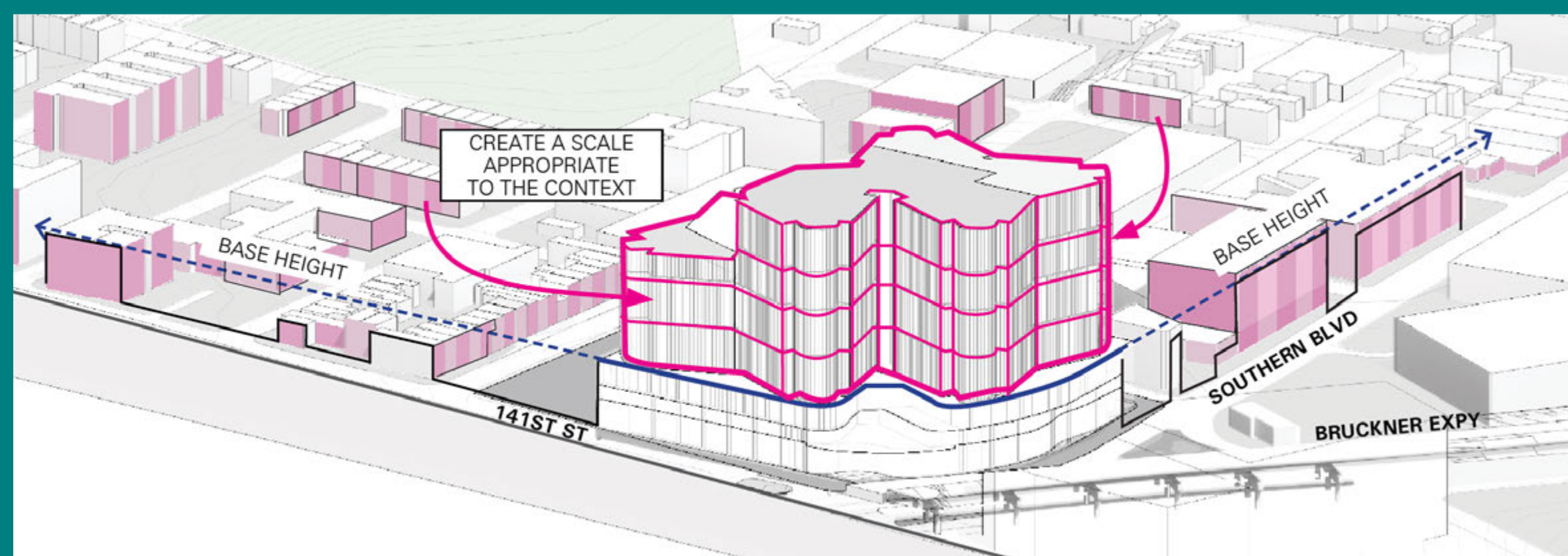

### Building Width and Scale

Subdivide building to relate to buildings in the neighborhood using vertical features.

## Understanding Community Context

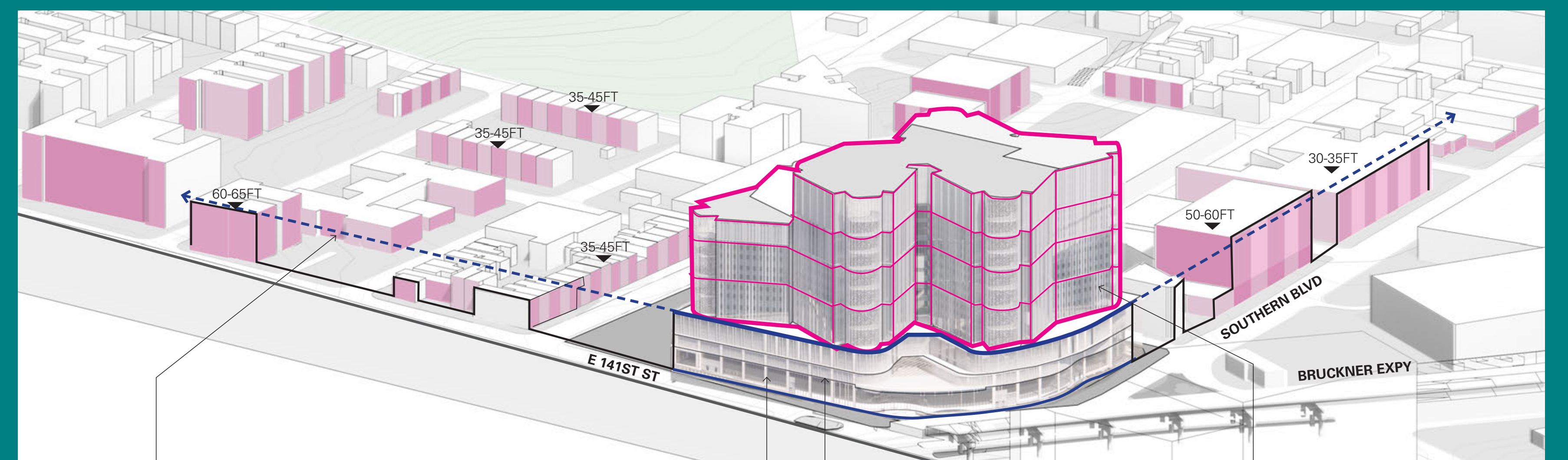

THE BASE RELATES TO SCALE OF NEIGHBORHOOD AT 60' TALL.

THE TOWER FACADE RELATES TO THE NEIGHBORING RESIDENTIAL BUILDINGS' EXTERIOR WINDOWS AND OPENINGS IN SCALE.

THE EXTERIOR DESIGN IS ALIGNED WITH THE ARCHITECTURAL LANGUAGE OF THE SURROUNDING MASONRY RESIDENTIAL BUILDINGS.

THE EXPRESSION OF THE BASE RESONATES WITH THE ADJACENT INDUSTRIAL AND RESIDENTIAL BUILDINGS.

HEIGHT IS REFLECTED ON THE SCALE OF THE NEIGHBORING BUILDINGS.



RESIDENTIAL BUILDINGS ADJACENT TO THE SITE

INDUSTRIAL BUILDINGS ADJACENT TO THE SITE

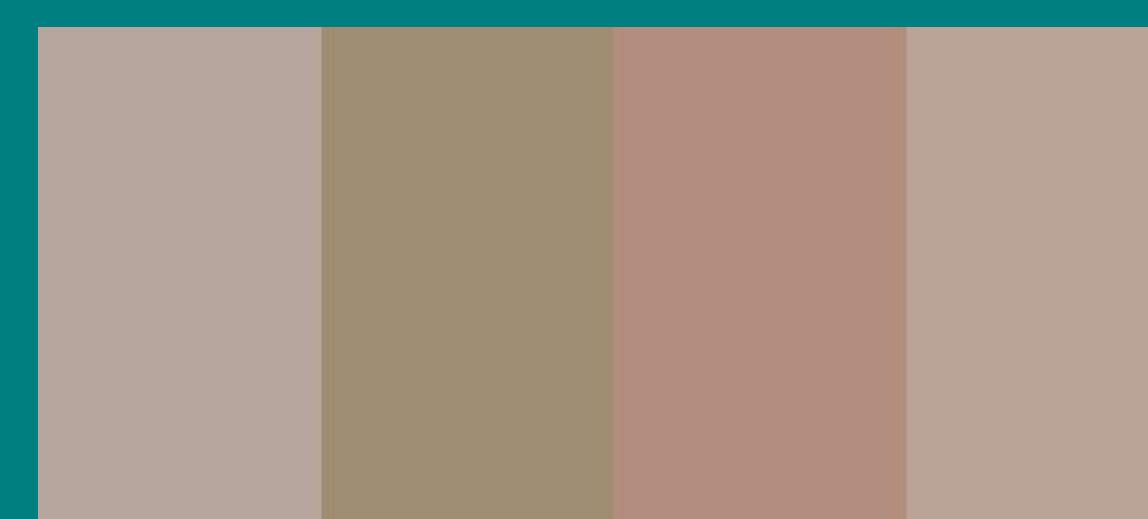
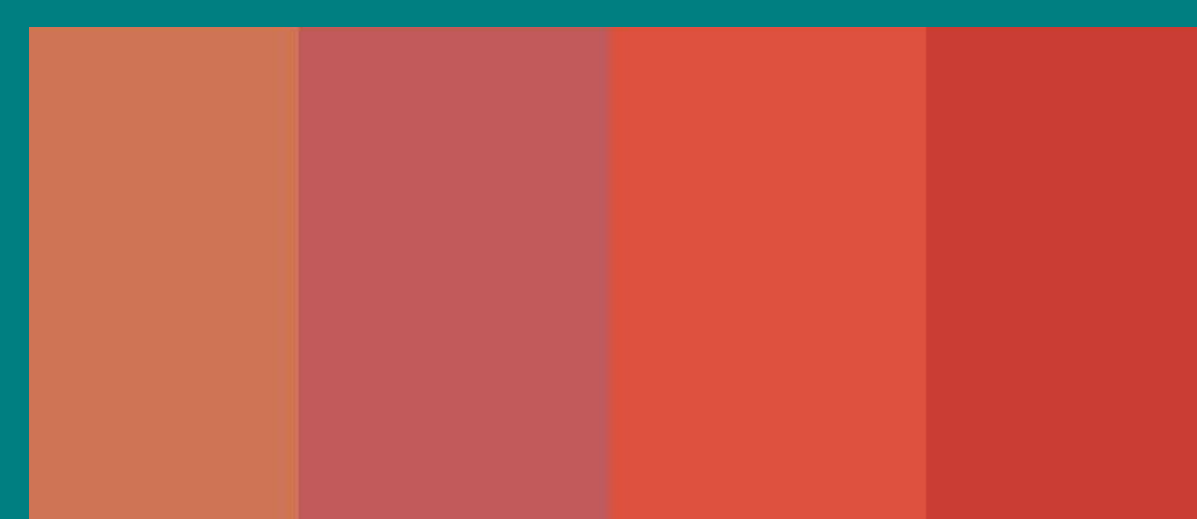

Colors taken from surrounding neighborhood buildings



View from E 141st Street & Jackson Avenue



View from Saint Mary's Park



View from Wales Avenue

\*Preliminary illustrations for discussion purposes only

\*Preliminary illustrations for discussion purposes only



Department of  
Design and  
Construction

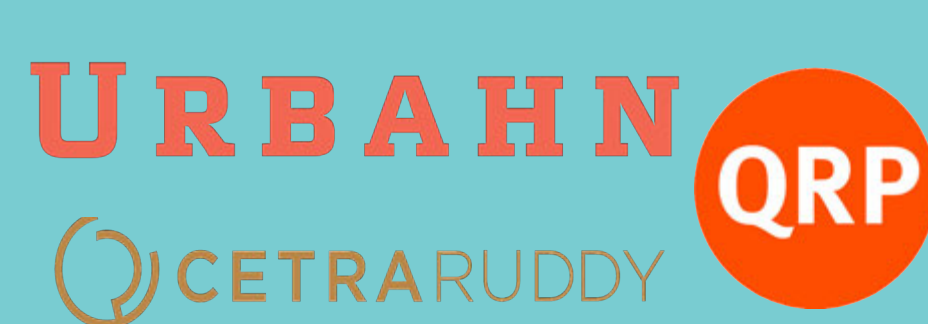
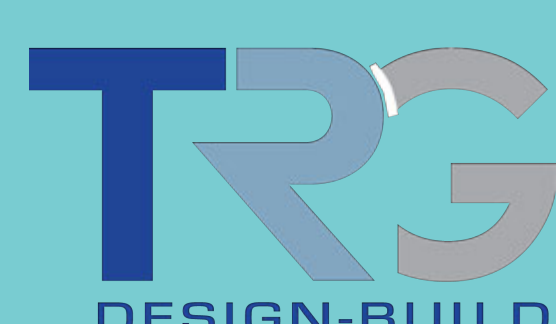

CETRARUDDY

The Bronx Borough-Based Jail Facility  
Community Design Workshop  
December 17th 2024



# Exterior Architecture

## Creating a Human-Centric Architecture



MAIN ENTRY FROM SOUTHERN BOULEVARD



COMMUNITY SPACE/RETAIL ENTRY VIEW FROM BRUCKNER BOULEVARD

\*Preliminary renderings for discussion purposes only



Department of  
Design and  
Construction

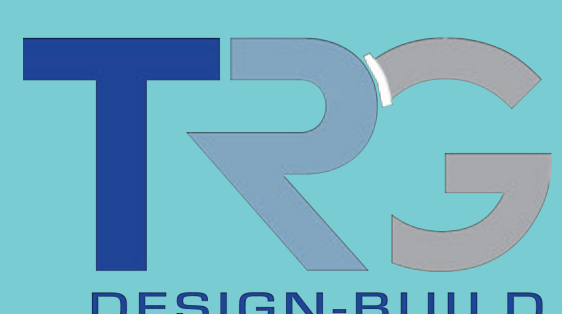

URBAHN  
CETRARUDDY



The Bronx Borough-Based Jail Facility  
Community Design Workshop  
December 17th 2024



# Exterior Architecture

What places, buildings, and building features enhance and reflect the neighborhood's spirit and identity?

How can the architecture help to convey an inspiring and welcoming feel to the surrounding community?

Additional comments or feedback:



Department of  
Design and  
Construction

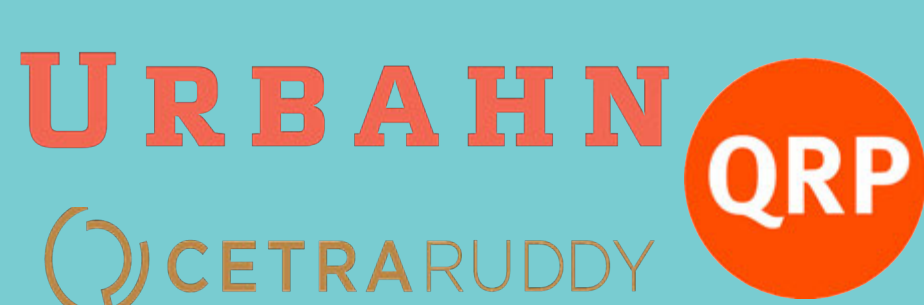
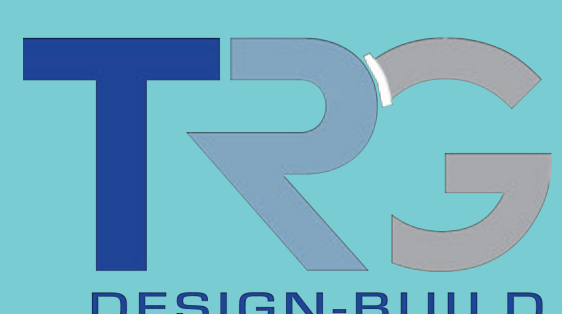

The Bronx Borough-Based Jail Facility  
Community Design Workshop  
December 17th 2024



# Public Realm

## A. NEIGHBORHOOD MAP

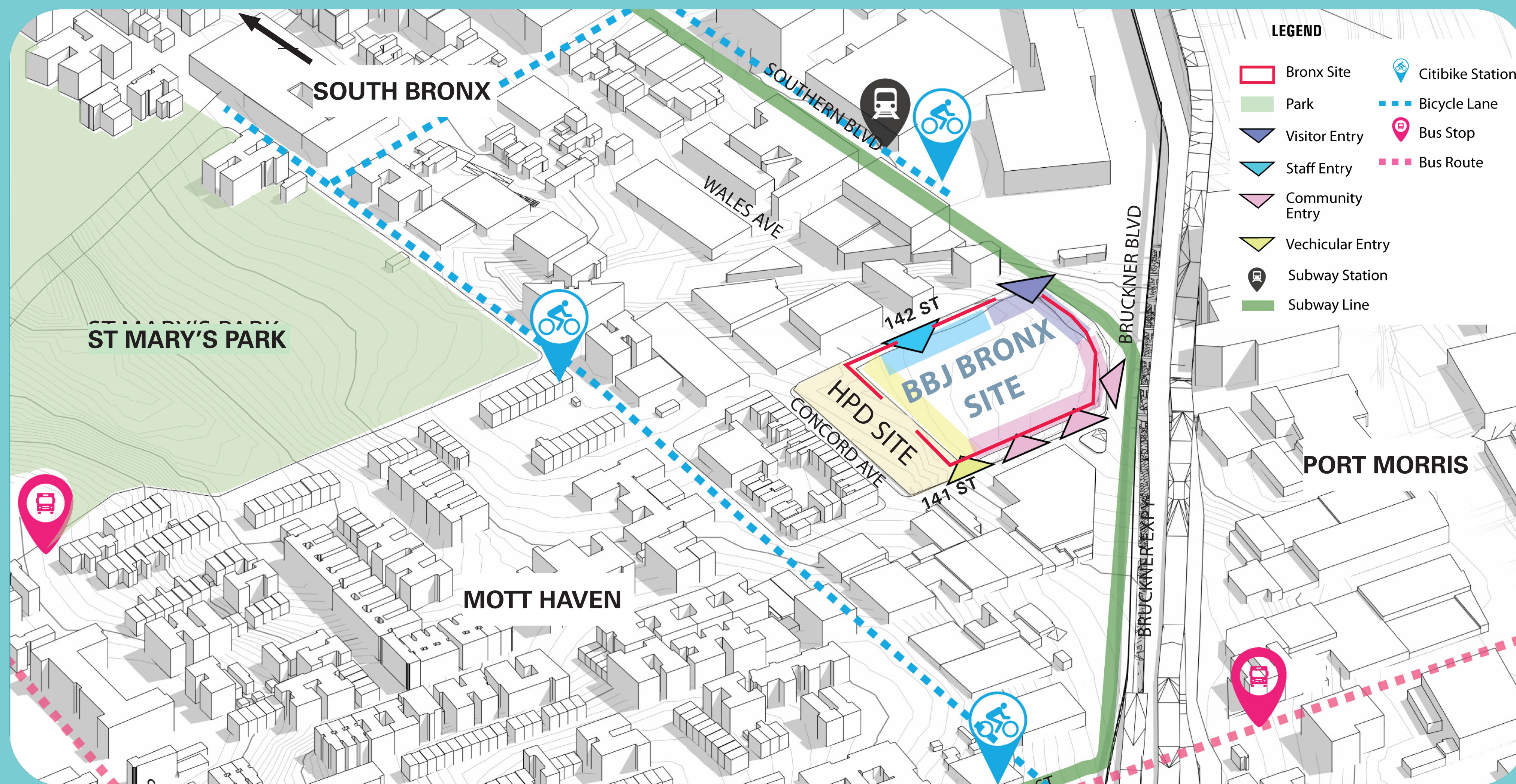

Use an **ORANGE DOT** on the SITE PLAN to show where you would like to sit.

Use a **PURPLE DOT** on the SITE PLAN to show where you would like bike racks.

Use a **RED DOT** on the SITE PLAN to show where you have traffic concerns.

## B. SITE PLAN

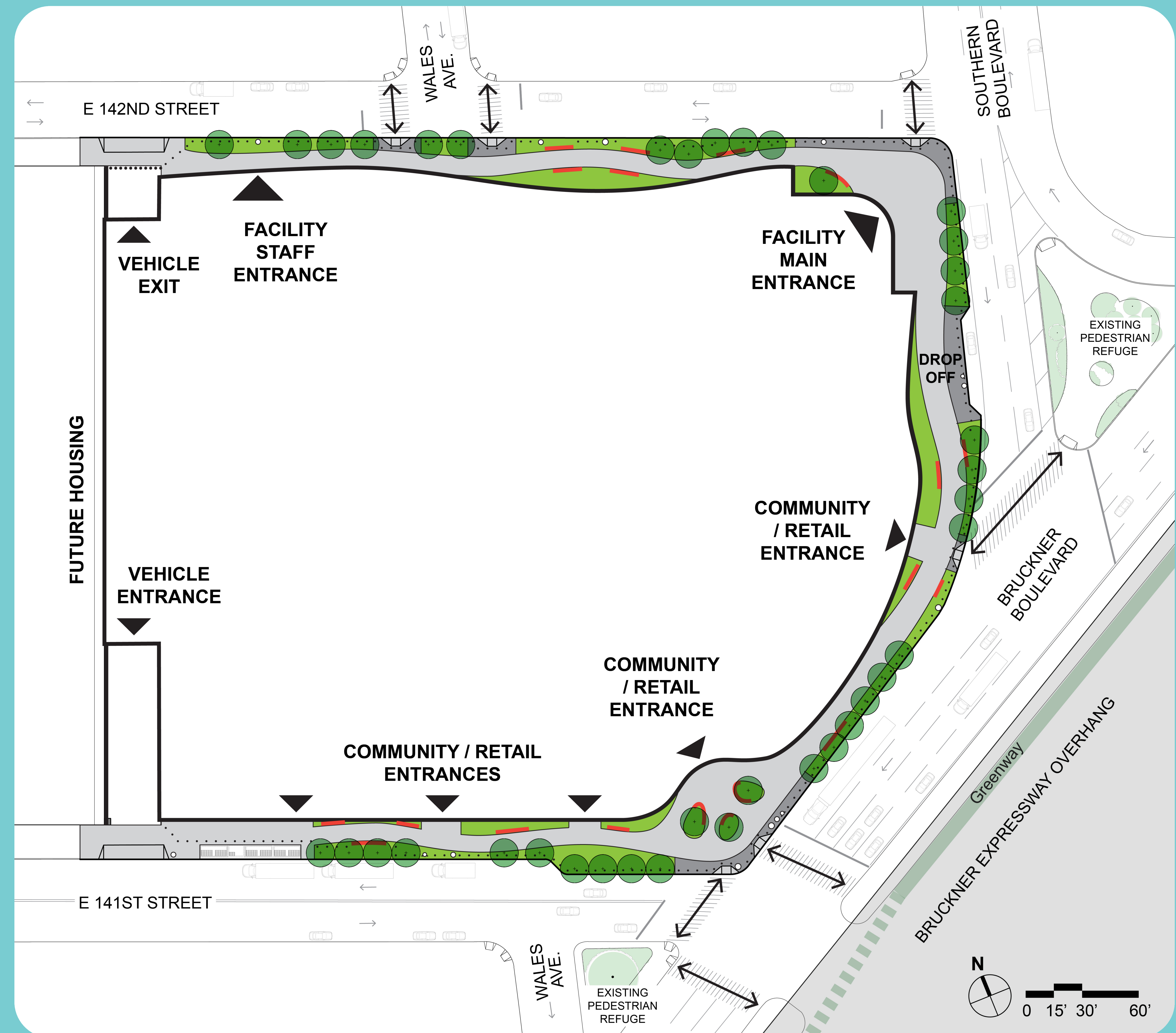

\*Preliminary illustration for discussion purposes only



# Public Realm

Take a look at the NEIGHBORHOOD MAP (A)

Put a **YELLOW DOT** below to show what neighborhood you live in or come from.

Mott Haven

Port Morris

South Bronx

Other

Put a **YELLOW DOT** below to show the way you intend to travel to the site most often.

Walk

Mass transit

Bike

Car

Put a **YELLOW DOT** below to show reasons for you to visit the site.

Work

Visiting retail

Visiting someone at the facility

Social Services



Department of  
Design and  
Construction

The Bronx Borough-Based Jail Facility  
Community Design Workshop

December 17th 2024

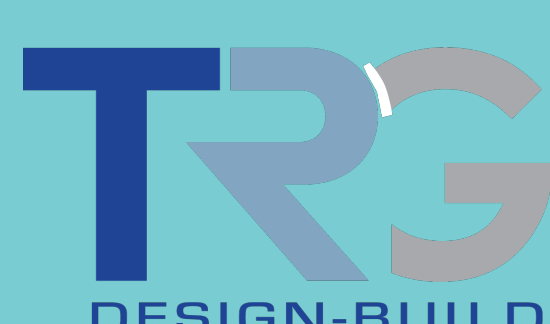

URBAHN  
CETRARUDDY





# Public Realm

Take a look at the SITE PLAN (B)

Put a **PINK DOT** below to show how you would primarily use the streetscape.

Walk by

Facility visitor

Retail visitor

Sit and relax

Other (Write in)

Are there any changes to the public space that you would recommend?



Department of  
Design and  
Construction

The Bronx Borough-Based Jail Facility  
Community Design Workshop

December 17th 2024





# Public Realm

## D. RENDERINGS - STREETSCAPE



142ND STREET STREETSCAPE EXPERIENCE



BRUCKNER BOULEVARD STREETSCAPE EXPERIENCE



141ST STREET STREETSCAPE EXPERIENCE

Use a **BLUE DOT** to mark your TOP 4 site features below.

Solo Seating

Group Seating

Trees/Shade

Bike Racks

Plantings

Other (Write In)

\*Preliminary renderings for discussion purposes only



Department of  
Design and  
Construction

The Bronx Borough-Based Jail Facility  
Community Design Workshop

December 17th 2024

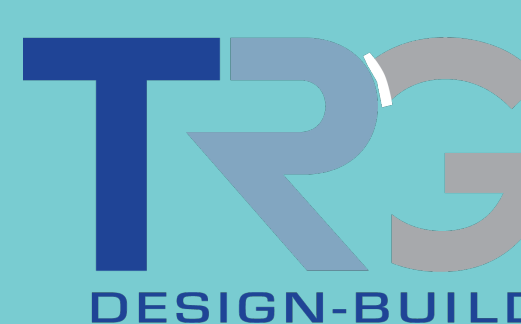

URBAHN  
CETRARUDDY





# Public Realm

## C. RENDERINGS - ENTRANCE PLAZAS



PUBLIC ENTRY VIEW AT 142ND STREET AND SOUTHERN BOULEVARD



COMMUNITY SPACE/RETAIL ENTRANCE VIEW AT E 141ST STREET AND BRUCKNER BOULEVARD

\*Preliminary illustration for discussion purposes only



Department of  
Design and  
Construction

The Bronx Borough-Based Jail Facility  
Community Design Workshop

December 17th 2024

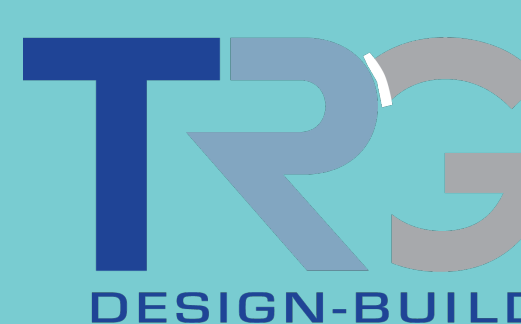

URBAHN  
CETRARUDDY





# Interior Public Spaces

## Design Guidelines

- Create a civic asset that respects and connects with the community.
- Foster a seamless indoor-outdoor relationship through natural light, transparency, and biophilic design.
- Shape a humane, inclusive environment with color, art, and natural materials.
- Design with a core commitment to equity, inclusion, and humanity.



PUBLIC LOBBY

\*Preliminary illustrations for discussion purposes only



Department of  
Design and  
Construction

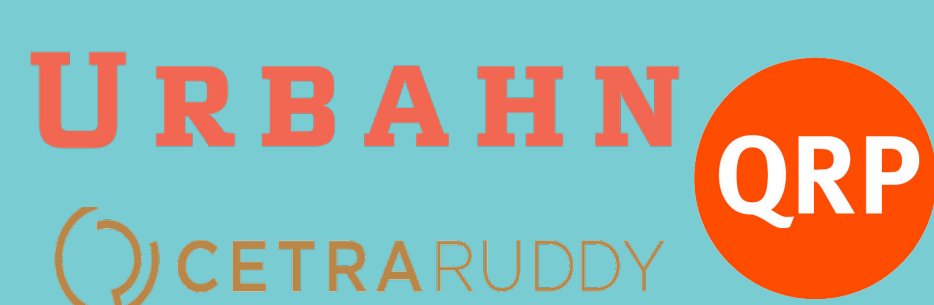
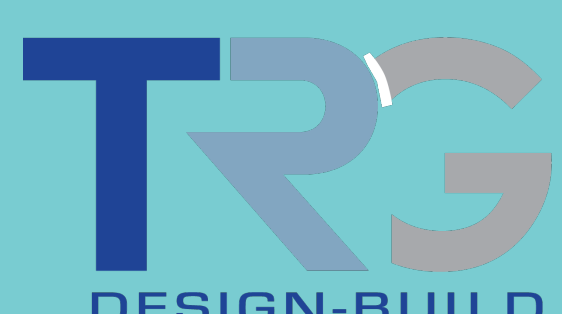

CETRARUDDY

The Bronx Borough-Based Jail Facility  
Community Design Workshop  
December 17th 2024



# Interior Public Spaces

## The Public Lobby

The Public Lobby embodies the mission of The Bronx Borough-Based Jail Facility, offering a welcoming, civic-focused space that is friendly, flexible, and comfortable for all people.

By incorporating glass and durable natural materials, the public lobby will serve as a beacon, fostering indoor-outdoor connectivity, while offering diverse seating, vibrant textures, and art to create a serene yet dynamic atmosphere.



PUBLIC LOBBY

\*Preliminary illustrations for discussion purposes only

## Creating Spaces that Champion Equity, Inclusion, and Community



PUBLIC LOBBY



CONTACT VISITING AREA

\*Preliminary illustrations for discussion purposes only



Department of  
Design and  
Construction

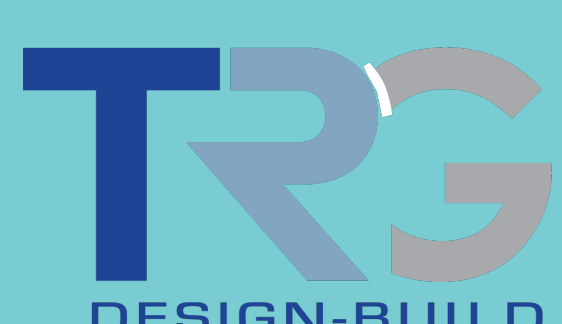

URBAHN  
CETRARUDDY QRP

The Bronx Borough-Based Jail Facility  
Community Design Workshop  
December 17th 2024



# Interior Public Spaces

## Visitor Waiting Area



VISITOR WAITING AREA

\*Preliminary illustrations for discussion purposes only

## Connecting Through Art

As a civic asset, the building will welcome and inspire visitors. Site-specific art, murals, and thoughtfully designed interiors will create an inviting and supportive environment for all staff, visitors and people in custody.

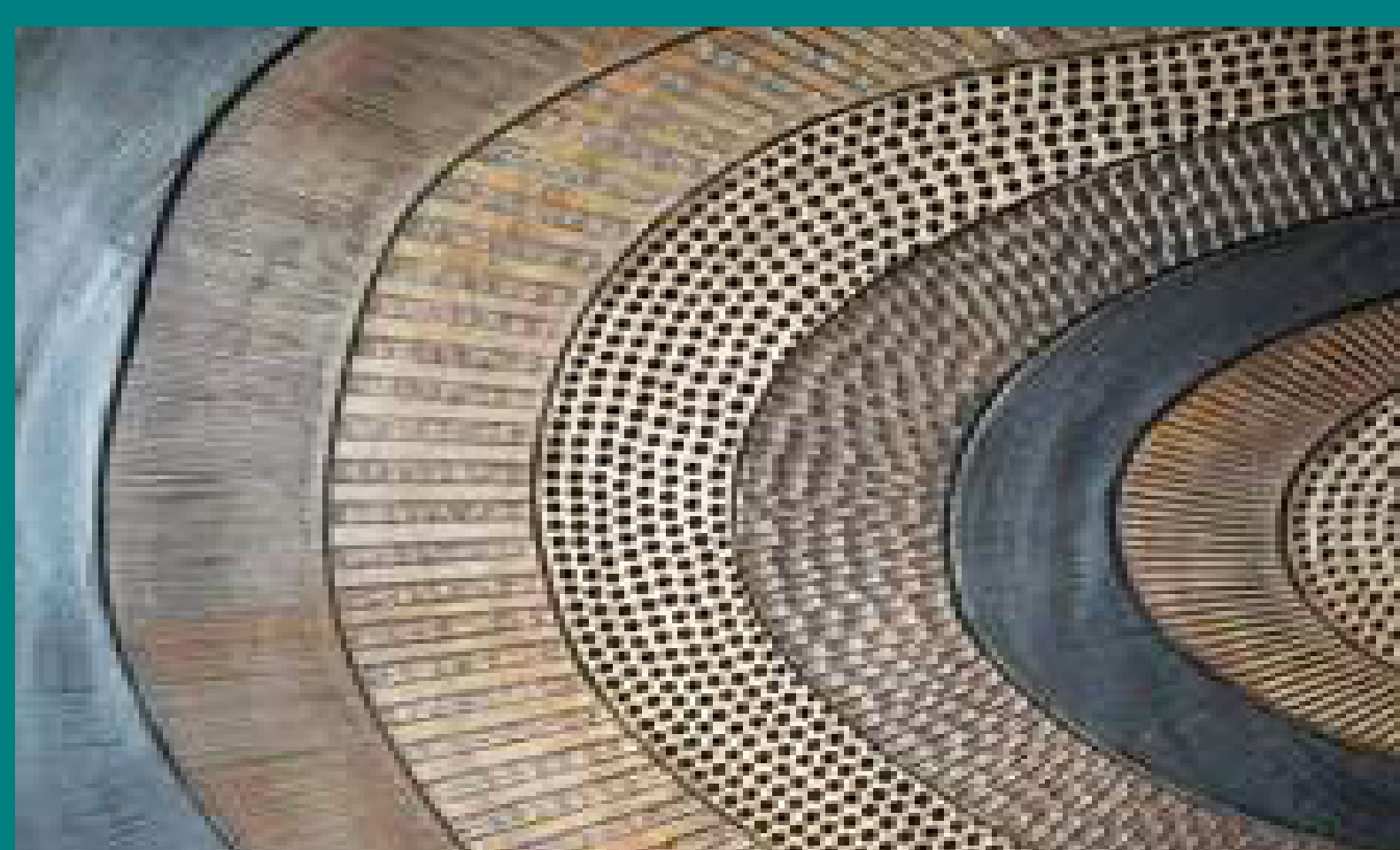

PRECEDENT EXAMPLES OF DIFFERENT TYPES OF ARTWORK

\*Precedent images for illustration purposes only



Department of  
Design and  
Construction

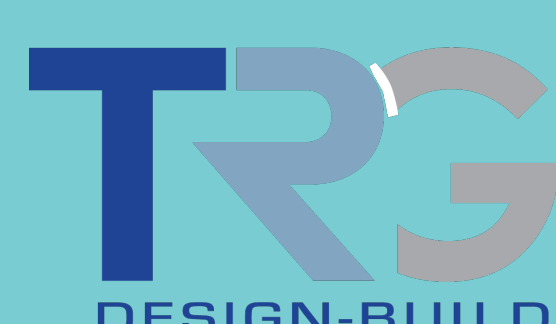

URBAHN  
CETRARUDDY



The Bronx Borough-Based Jail Facility  
Community Design Workshop  
December 17th 2024



# Interior Public Spaces

In the public lobby, what features, such as vending machines, charging stations, children's play area, display screens or art installations seem most valuable? What other features might be considered?

In the visitor waiting areas, do you have a preference for individual seats, bench seating or a combination of both?

Additional comments or feedback:



Department of  
Design and  
Construction

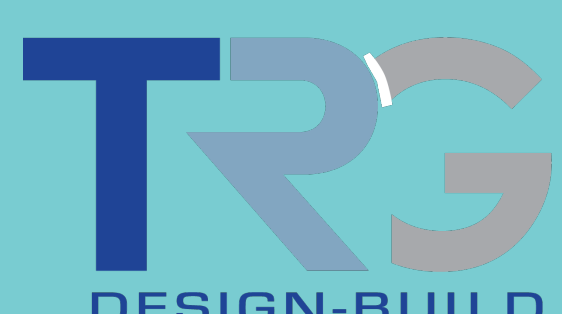

URBAHN  
CETRARUDDY



The Bronx Borough-Based Jail Facility  
Community Design Workshop  
December 17th 2024



# Interior Secure Spaces

## Guiding Principles

- **Luminosity and connection to natural light** - Transparency and exposure to outdoor environment.
- **Connectivity to nature/biophilia** - Use of natural materials and organic forms provide visual interest and foster inspiration.
- **Color and art** - Enliven large spaces to evoke a calm and serene atmosphere.

## Community, Dignity, Humanity, Respect, and Inspiration



CROSSROADS JUVENILE CENTER, BROOKLYN NY

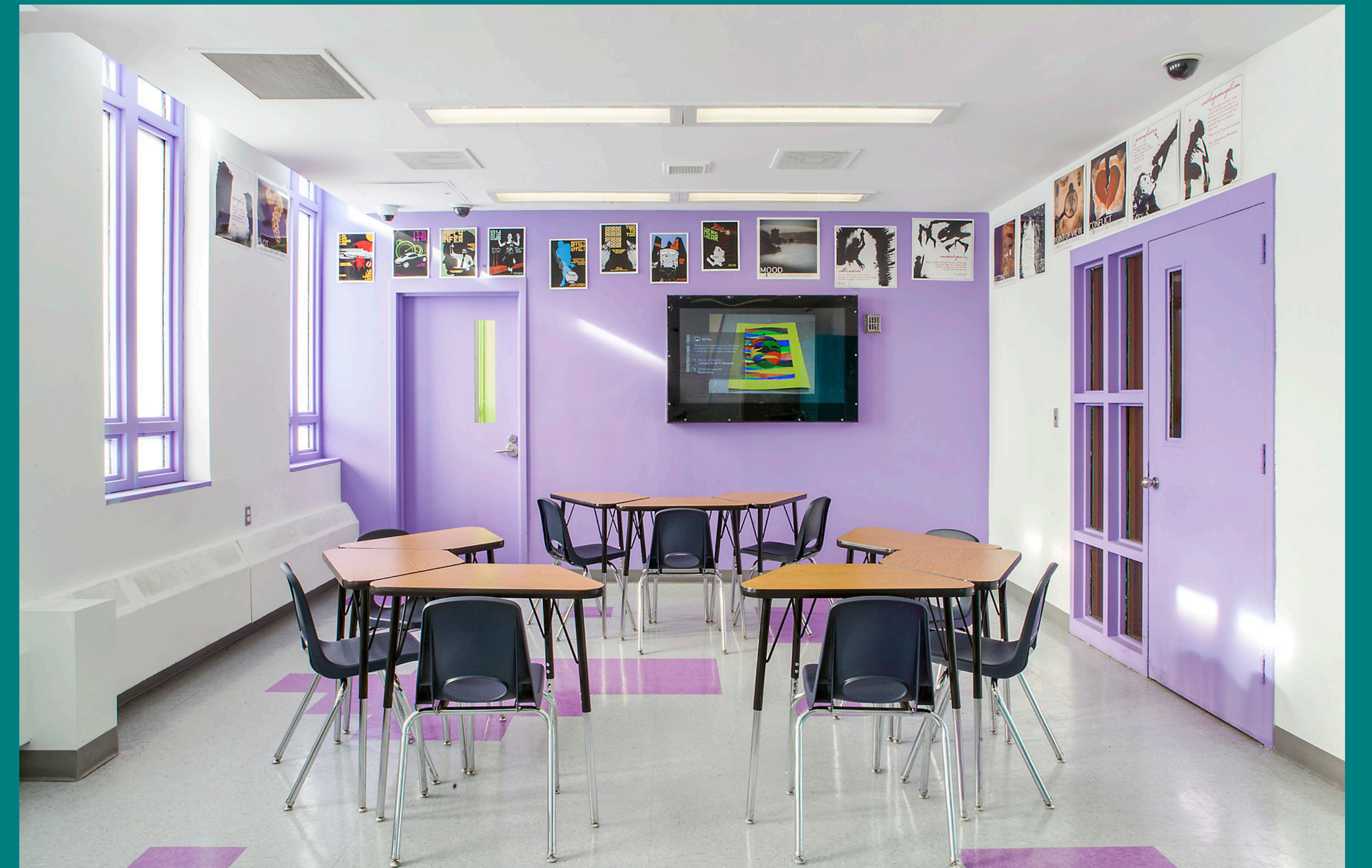

CROSSROADS JUVENILE CENTER, BROOKLYN NY

\*Inspirational precedent images for discussion purposes only

## Designing for Equity

- Single rooms ensure dignity, privacy, and safety.
- Access to natural daylight in both shared and individual spaces help to produce a calming environment.
- Open seating and normative furniture create opportunities for collaboration and reflection, while promoting a sense of community.



HALDEN PRISON, NORWAY

\*Inspirational precedent image for discussion purposes only



Department of  
Design and  
Construction

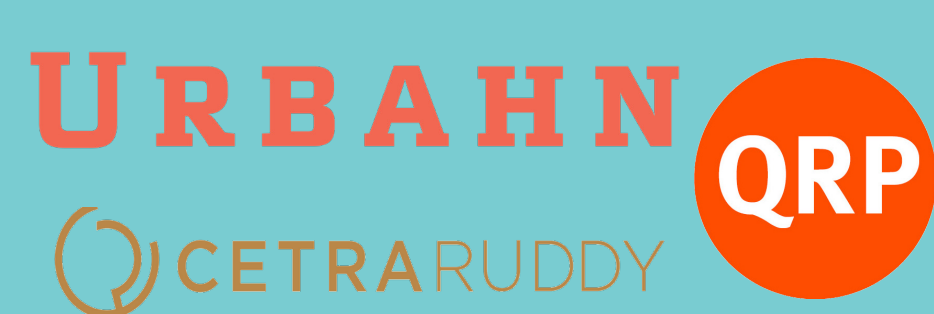
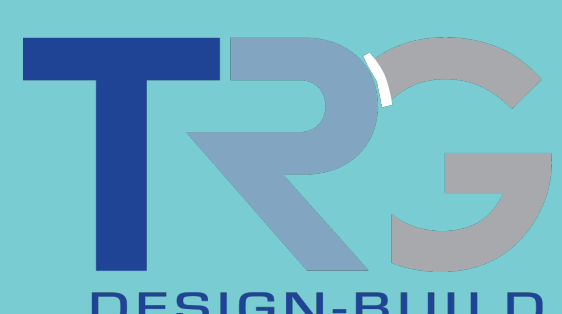

CETRARUDDY

The Bronx Borough-Based Jail Facility  
Community Design Workshop  
December 17th 2024



# Interior Secure Spaces

## Creating a Human-Centric Design



SINGLE STORY DAYROOM



DOUBLE STORY DAYROOM

\*Preliminary renderings for discussion purposes only



Department of  
Design and  
Construction

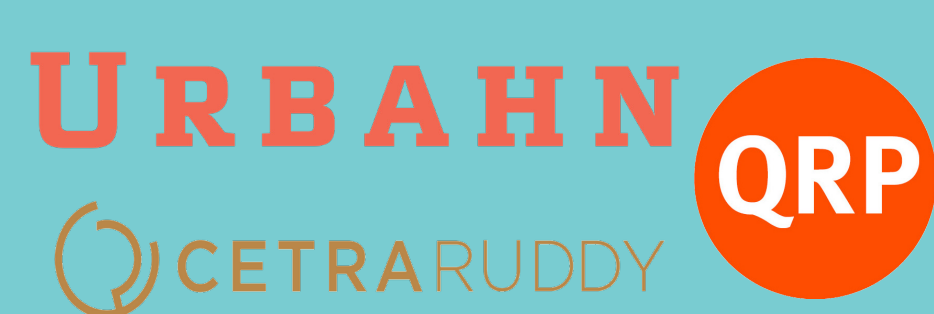
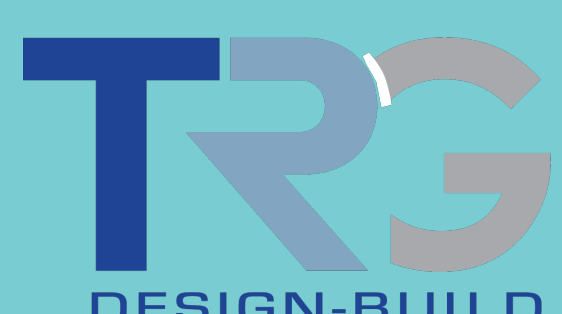

CETRARUDDY

The Bronx Borough-Based Jail Facility  
Community Design Workshop  
December 17th 2024



# Interior Secure Spaces

## Creating a Humane Environment

- Natural light
- Human experience
- Access to outdoor views
- Medical treatment
- Counseling
- Structured programs and education
- Group activities



HOUSING FLOOR CONCEPT

\*Rendering for discussion purposes only

## Understanding the Relationship to Programming and Daylight

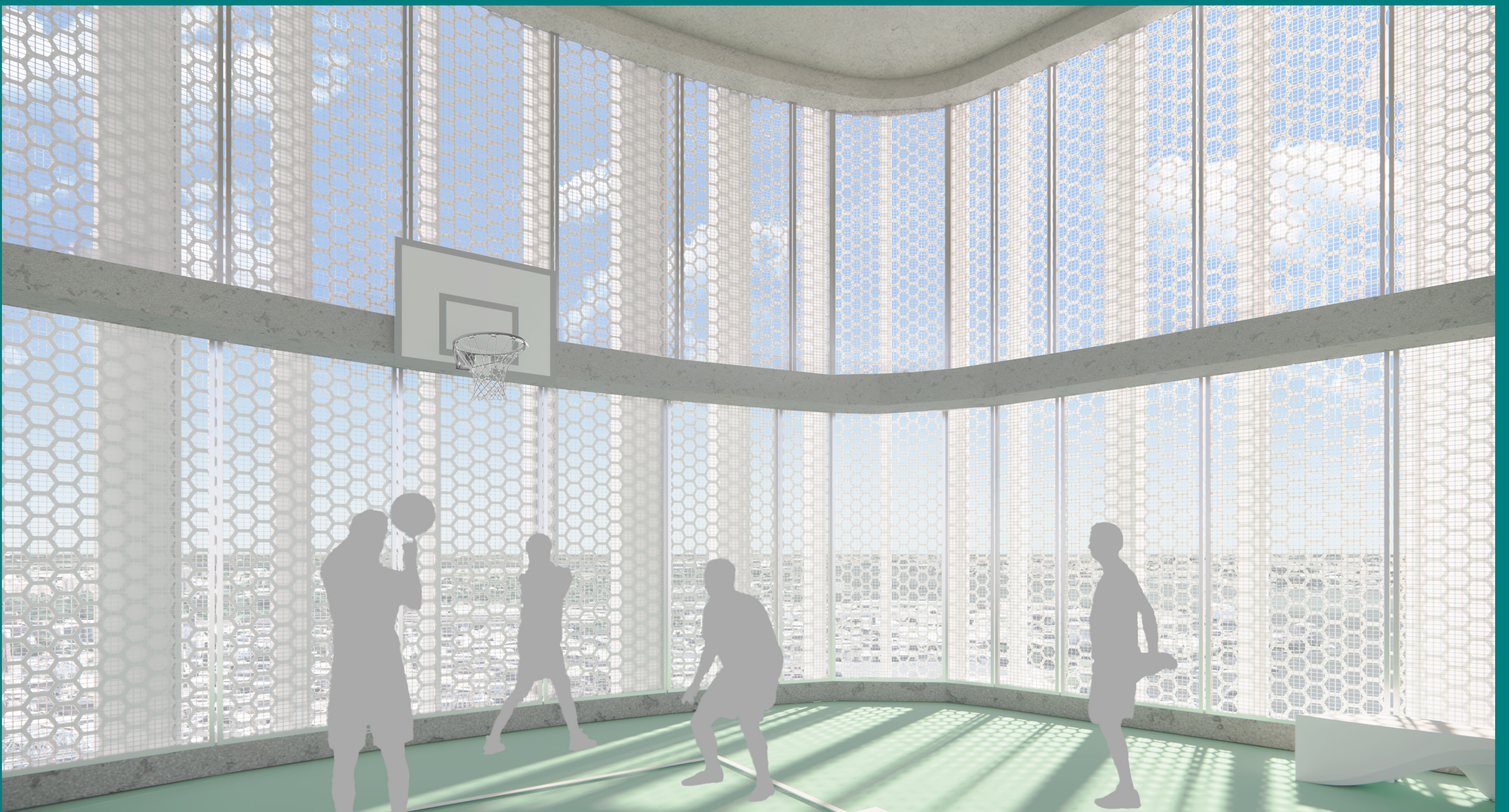

OUTDOOR RECREATION AT EACH HOUSING UNIT

\*Preliminary rendering for discussion purposes only



Department of  
Design and  
Construction

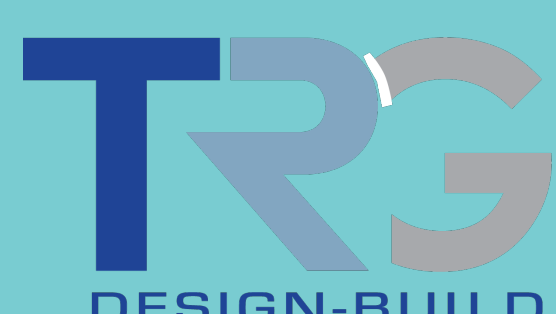

URBAHN

CETRARUDDY



The Bronx Borough-Based Jail Facility  
Community Design Workshop  
December 17th 2024



# Interior Secure Spaces

**Q: How can we best create an atmosphere that provides a calm, safe and stress reducing environment?**

**Example: maintaining privacy, preserving dignity, providing lighting and natural lighting, using warm materials and colors**

**How can the design provide a sense of dignity and reflect an everyday living environment?**

**Housing Areas**

**Program Spaces**

**Other**

**Additional comments or feedback:**



**Department of  
Design and  
Construction**

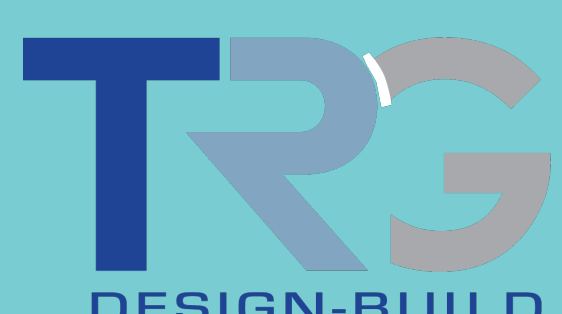

**URBAHN**  
CETRARUDDY



**The Bronx Borough-Based Jail Facility  
Community Design Workshop  
December 17th 2024**