



# COMMUNITY DESIGN WORKSHOP #1 FOR MANHATTAN FACILITY

## 第一場社區設計研討會 曼哈頓行政區設施

July 31, 2025  
2025年7月31日



### Manhattan Borough-Based Jail 曼哈頓城區拘留所

SITE

Manhattan  
曼哈頓

# Agenda 議程

July 2025

- 1 Introduction  
簡介
- 2 Community Engagement & Design Input Process  
社區參與及設計意見徵集
- 3 Design Progress  
設計進程
- 4 Q&A  
問答
- 5 Next Steps  
後續計劃

Manhattan

曼哈頓

# Community Engagement & Design Input Process

## 社區參與及設計意見徵集

# Manhattan Facility Design Engagement Plan

## 曼哈頓設施設計參與計劃

### 1) Community Intro Meeting with Elected officials and Working Group

- **Date:** June 27, 2025

### 2) M/WBE Information Session

- **Date:** August 2025

### 3) Two community design workshops and one Community Board 1 presentation

- **Estimated Date:** July & September 2025 (Workshops), November 2025 (CB1)
- **Purpose:** Receive and incorporate community input before PDC Conceptual Review

### 4) One community design workshop and one Community Board 1 presentation

- **Estimated Date:** Spring 2026
- **Purpose:** Receive and incorporate community input before PDC Preliminary Review

### 5) One community design workshop and one Community Board 1 presentation

- **Estimated Date:** Winter 2026 / 2027
- **Purpose:** Receive and incorporate community input before PDC Final Review

### 1) 與民選官員及工作小組舉行的社區介紹會議

- **日期:** 2025年6月27日

### 2) 少數族裔與女性企業信息交流會

- **日期:** 2025年8月

### 3) 兩場社區設計研討會 + 一場第一社區委員會(CB1)彙報會

- **預計日期:** 2025年7月與9月 (研討會), 2025年11月 (社區委員會CB1彙報)
- **目的:** 在公共設計委員會 (PDC) 概念方案評審前, 徵詢并整合社區意見

### 4) 一場社區設計研討會 + 一場第一社區委員會(CB1)彙報會

- **預計日期:** 2026年春季
- **目的:** 在公共設計委員會 (PDC) 方案階段評審前, 徵詢并整合社區意見

### 5) 一場社區設計研討會 + 一場第一社區委員會(CB1)彙報會

- **預計日期:** 2026年 / 2027年冬季
- **目的:** 在公共設計委員會 (PDC) 最終評審前, 徵詢并整合社區意見

# BBJ Design-Build & Engagement Process

## 城區拘留所設計施工一體化與公眾參與流程

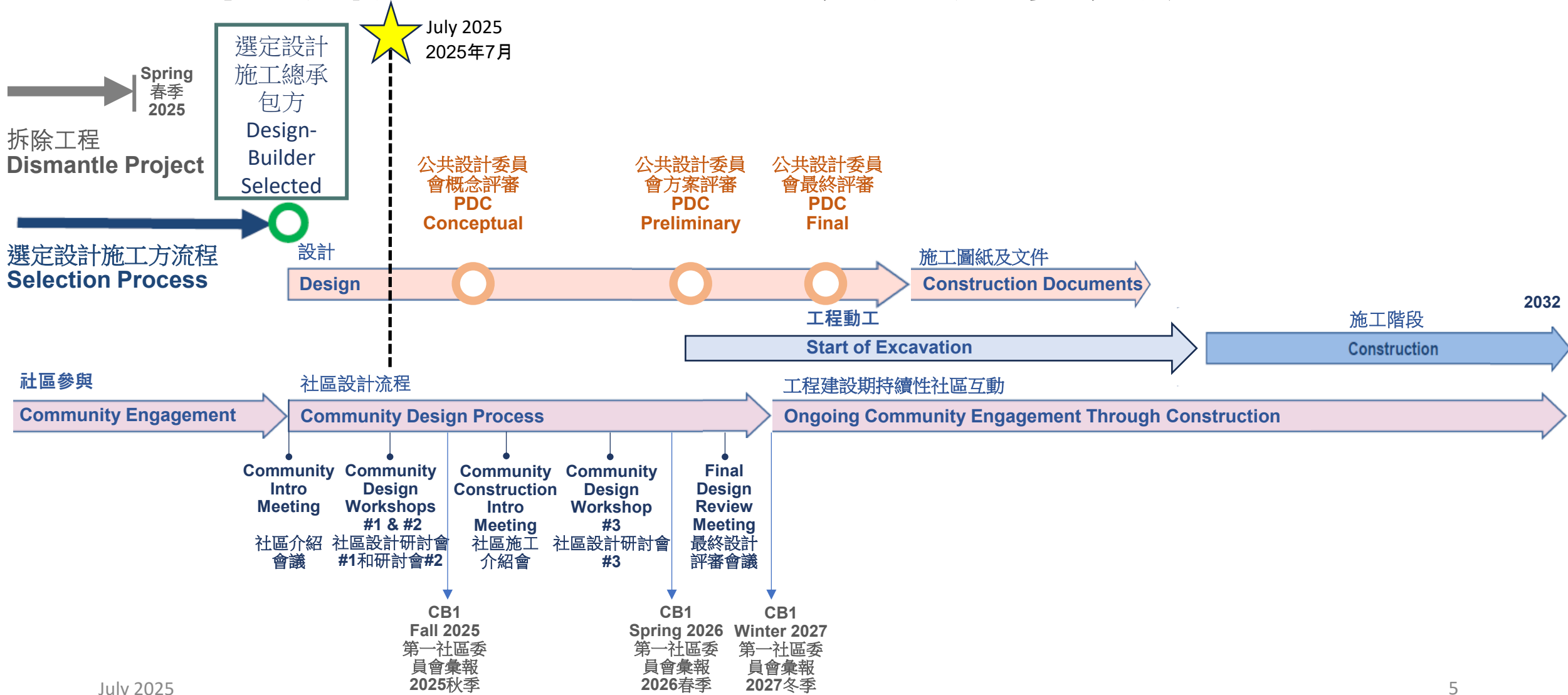

# BBJ Community Engagement – Primary Areas of Design Input

## 城區拘留所社區參與 – 設計意見徵集的主要區域

### Public Realm

- White street pedestrian arcade
- Centre & Baxter street design
- Site safety
- Lighting experience

### 公共界面

- 懷特街通道
- 中央街與巴士打街設計
- 場地安全
- 照明環境體驗

### Architecture

- Building facade
- Street level experience
- Outdoor building materials

### 建築設計

- 建築外立面
- 臨街界面體驗
- 室外建築材質

### Interior Public Spaces

- Public lobby
- Visitor spaces

### 室內公共空間

- 公共大堂
- 訪客區

### Interior Secure Spaces

- People in custody housing areas
- People in custody program space
- Recreation areas

### 室內管控空間

- 在押人員收容區域
- 在押人員活動空間
- 休閒娛樂區域

# BBJ Prior Community Engagement – What We Heard

## 城區拘留所前期社區參與 – 社區意見彙編

- Relate the proposed facility to the urban landscape and low-rise scale of Chinatown
- Use natural materials like brick, stone, and wood
- Avoid too much glass on the facade
- Use easily maintainable and durable materials
- Ensure safe, clean and open street experience
- Design vehicular access to ensure pedestrian safety
- Minimize disruption to traffic and parking
- Provide spaces for small businesses along White Street
- Activate ground floor
- Provide greenery, including trees and plants
- Add more light, illumination on the street
- Provide waiting area suitable for families
- Encourage public art projects and murals, created by artists in the surrounding community
- Hold workshops in both English and Chinese languages
- 使擬建設施與唐人街的城市景觀及低層建築風格相協調
- 選用磚、石和木材等天然材料
- 建築立面避免過多玻璃元素
- 采用經久耐用且易於維護的材料
- 確保街道環境安全、整潔、視野開闊
- 車行通道規劃設計保障行人安全
- 最大限度減少對交通及停車的影響
- 沿懷特街（White Street）設置小型商業空間
- 激活地面一層的空間活力
- 增加綠化植被（含樹木及植物）
- 增加自然采光，優化街道照明系統
- 設置家庭友好型等候區域
- 鼓勵周邊社區藝術家創作的公共藝術項目和壁畫
- 舉辦中英雙語研討會

Manhattan

曼哈頓

Design Progress

設計進程

# Manhattan Facility Project Overview

## 曼哈頓設施的項目概述

- **1,040 beds for men**

- Balanced therapeutic capacity
- Programmatic elements, including the gymnasium, multi-purpose rooms, and educational and workforce development spaces

- **125 accessory parking spaces below grade**

- Parking for authorized City vehicles, mitigating placard misuse
- Sally port for the facility will be operated between the Courthouse and the proposed Facility

- **20,000 SF of community & commercial space**

- Will operate separate and apart from the jail facility
- The City will conduct community engagement to determine programming for the community space later in the process
- **Including** 5,960 SF of retail space for Chung Pak

- **為男性提供 1,040 張床位**

- 療愈能力配置合理
- 功能空間布局，含健身房、多功能室以及教育培訓與職業技能發展空間

- **地下設有 125 個附屬停車位**

- 市政核準車輛專屬停車區，減少許可證濫用
- 安全交接區將設置在法院與擬建設施之間，以緩解周邊街道的交通壓力

- **20,000 平方英尺的社區空間 (& commercial)**

- 該空間獨立於拘留所設施運營
- 市政府將在後期階段通過社區徵詢確定空間功能規劃
- 為松柏大廈規劃了5,960平方英尺的商業空間。**(including)**

# DESIGNING FOR THE USERS 為所有使用者設計



**PERSONS IN CUSTODY**  
在押人員



**STAFF**  
工作人員



**HEALTH SERVICES**  
醫療服務



**WAREHOUSE**  
倉庫



**BUILDING SUPPORT SERVICE**  
建築支持服務



**LAUNDRY**  
洗衣房



**FOOD SERVICE**  
餐飲服務



**SUPPORT AGENCIES**  
服務機構

July 2025

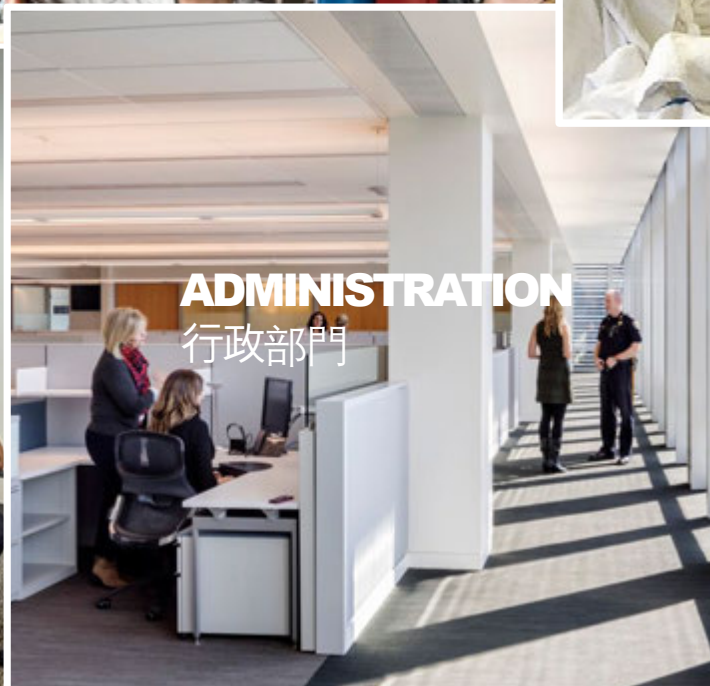

**ADMINISTRATION**  
行政部門



**VISITORS**  
訪客

# GUIDING PRINCIPLES

NATURAL LIGHT

SENSE OF AUTONOMY

ACCESS TO OUTDOORS

NORMALIZE THE SPACE

VARIETY OF MATERIALS, COLORS & TEXTURES

INCREASED ACCESS TO  
MEDICAL AND MENTAL HEALTHCARE

PROGRAMS & EDUCATION

# 設計原則

自然采光

自主感營造

戶外空間鏈接

空間標準化

多元材料、色彩與肌理

提升醫療保障與心理諮詢的通達性

培訓與教育空間

# CONTEXT RELATIONSHIPS 周邊環境關係



- |                     |            |
|---------------------|------------|
| <b>Legend:</b>      | <b>圖例:</b> |
| Community           | 社區         |
| Civic Center        | 市政中心       |
| Park and Open Space | 公園與開放空間    |
| Civic Service       | 市政服務       |
| Property Line       | 用地界線       |

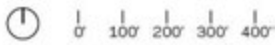

July 2025

# SITE PLAN 規劃平面圖

## Legend:

-  Vehicle Entrance 車輛入口
-  Building Main Entrance 建築主入口
-  Building Entrance 建築入口
-  Park and Open Space 公園與開放空間
-  Bike-Way 自行車道
-  Citi Bike 共享自行車
-  Public Parking 公共停車場
-  Civic Service 市政服務
-  Set-Back Line Above 上部建築退讓線
-  Set-Back Line 建築退讓線
-  Property Line 用地界線



July 2025

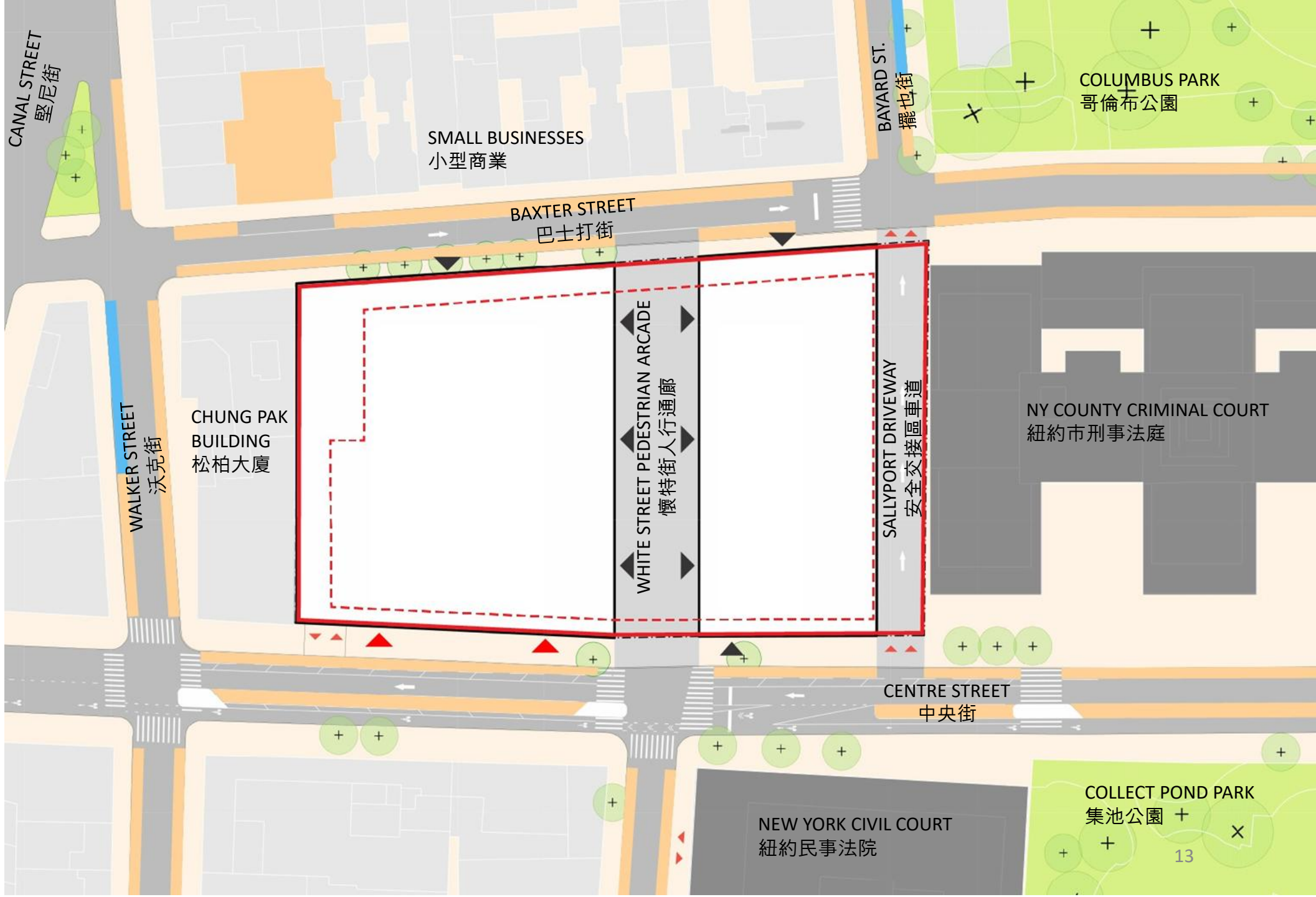

# GROUND FLOOR PLANNING

## 地面一層功能分區

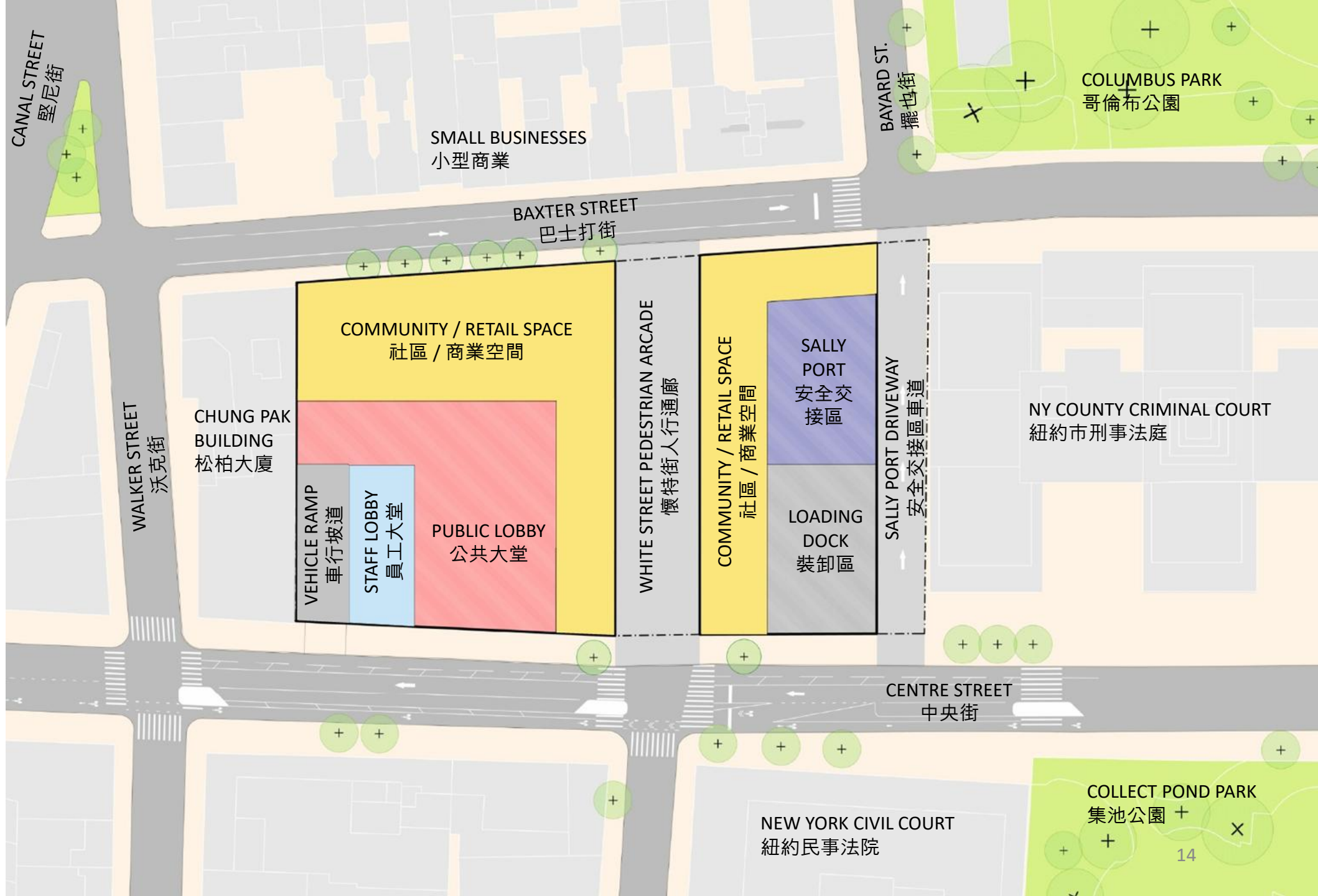

0' 20' 40' 60' 80'

July 2025

# PUBLIC SPACE CONNECTIONS 公共空間連接

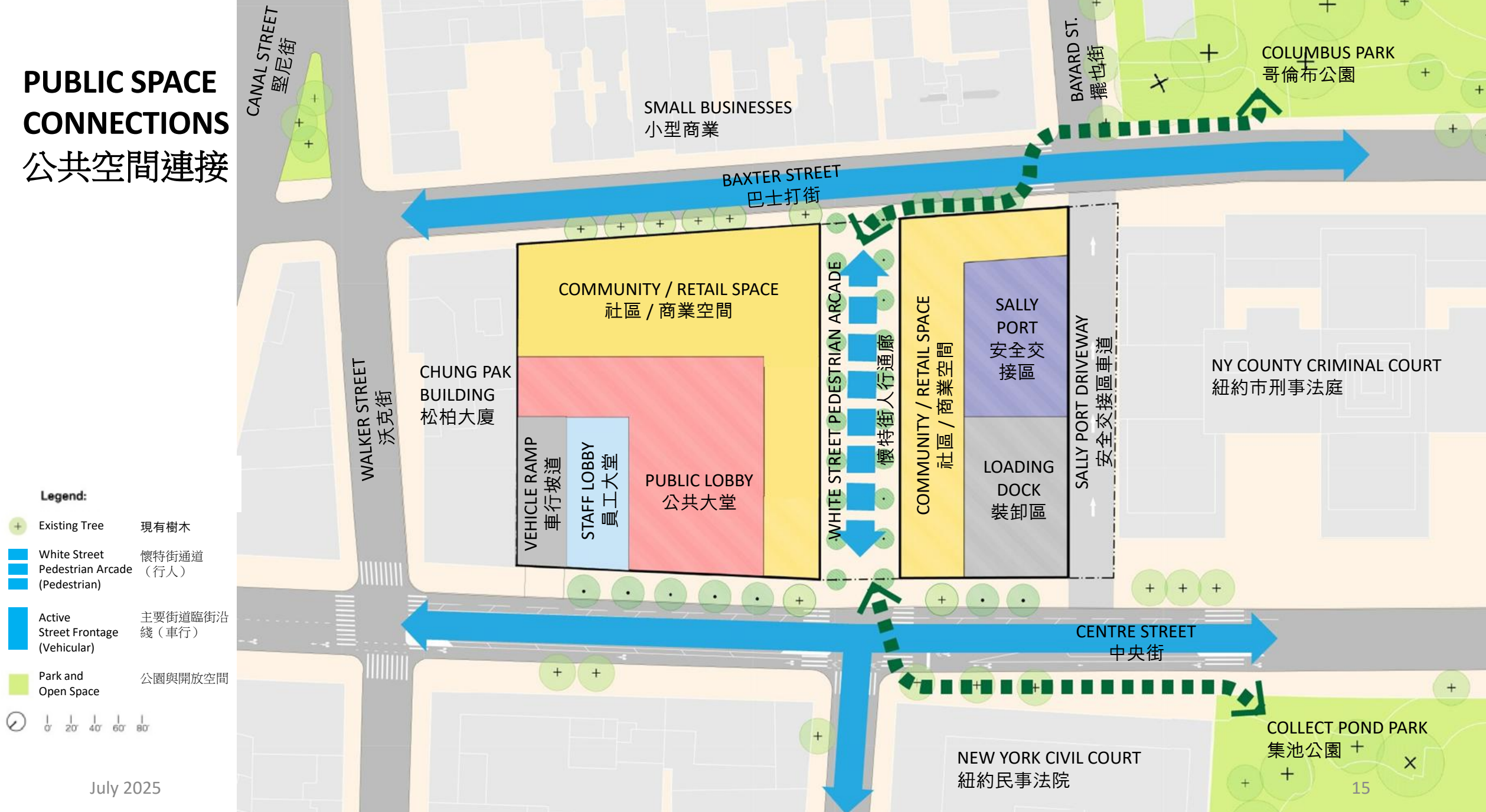

- Legend:**
- + Existing Tree 現有樹木
  - ▬ White Street Pedestrian Arcade (行人)
  - ▬ Active Street Frontage (Vehicular)
  - ▬ Park and Open Space 公園與開放空間



July 2025

SMALL BUSINESSES  
小型商業

COLUMBUS PARK  
哥倫布公園

CHUNG PAK BUILDING  
松柏大廈

COMMUNITY / RETAIL SPACE  
社區 / 商業空間

VEHICLE RAMP  
車行坡道

STAFF LOBBY  
員工大堂

PUBLIC LOBBY  
公共大堂

WHITE STREET PEDESTRIAN ARCADE  
懷特街人行通廊

COMMUNITY / RETAIL SPACE  
社區 / 商業空間

SALLY PORT  
安全交接區

LOADING DOCK  
裝卸區

SALLY PORT DRIVEWAY  
安全交接區車道

NY COUNTY CRIMINAL COURT  
紐約市刑事法庭

NEW YORK CIVIL COURT  
紐約民事法院

COLLECT POND PARK  
集池公園

# CENTRE STREET ELEVATION LOOKING WEST

## 中央街西向立面圖

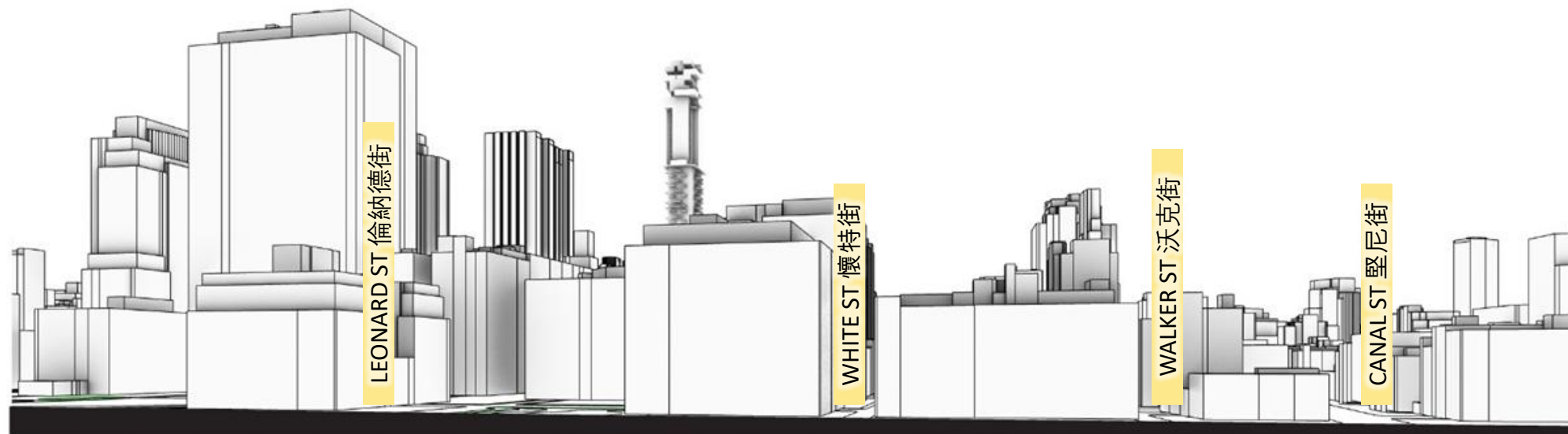



EXPERIENCE PRECEDENTS:  
CENTRE ST  
先例經驗:  
中央街

July 2025



TRAFFIC CALMING  
PEDESTRIAN SAFETY  
MICRO-CLIMATE MANAGEMENT  
BIOSWALE  
WELL LIT  
CLEAR WAYFINDING  
FORMAL SEATING  
HIDDEN SECURED EDGE  
INTEGRATED ENTRY



交通穩靜化  
行人安全保障  
微氣候調節  
生態調節溝系統管理  
光線充足  
清晰的導向系統  
固定式休憩設施  
隱蔽式安全邊界  
一體化入口



\*Preliminary illustrations for discussion purposes only  
圖示為初步說明，僅用於討論之用

# BAXTER STREET ELEVATION LOOKING EAST

## 巴士打街東向立面圖

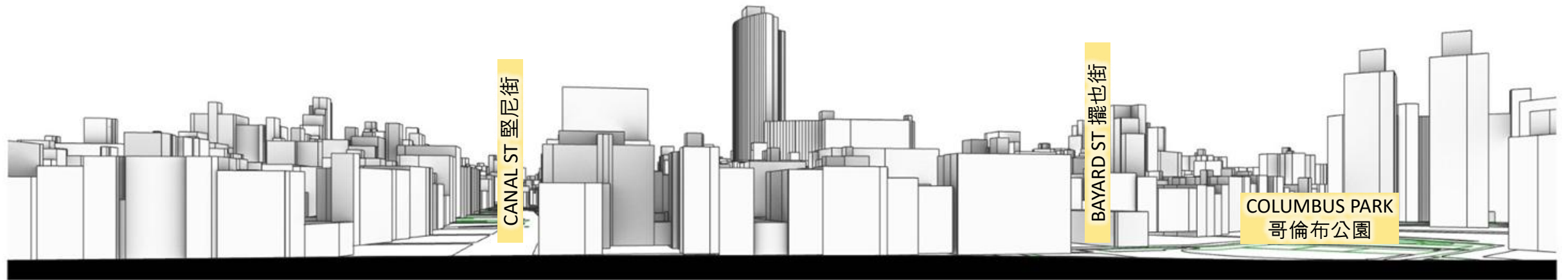

**EXPERIENCE PRECEDENTS:**  
**BAXTER ST**  
先例經驗：  
巴士打街



July 2025

COMMUNITY CORRIDOR  
PEDESTRIAN PRIORITY  
GREEN CONNECTION  
WELL LIT  
CLEAR WAYFINDING  
GATHERING PLACE



社區廊道  
行人優先  
綠植連接  
光線充足  
清晰的導向系統  
公共互動場所



20



\*Preliminary illustrations for discussion purposes Only  
圖示為初步說明，僅用於討論之用

PUBLIC PARKS  
公共公園



July 2025



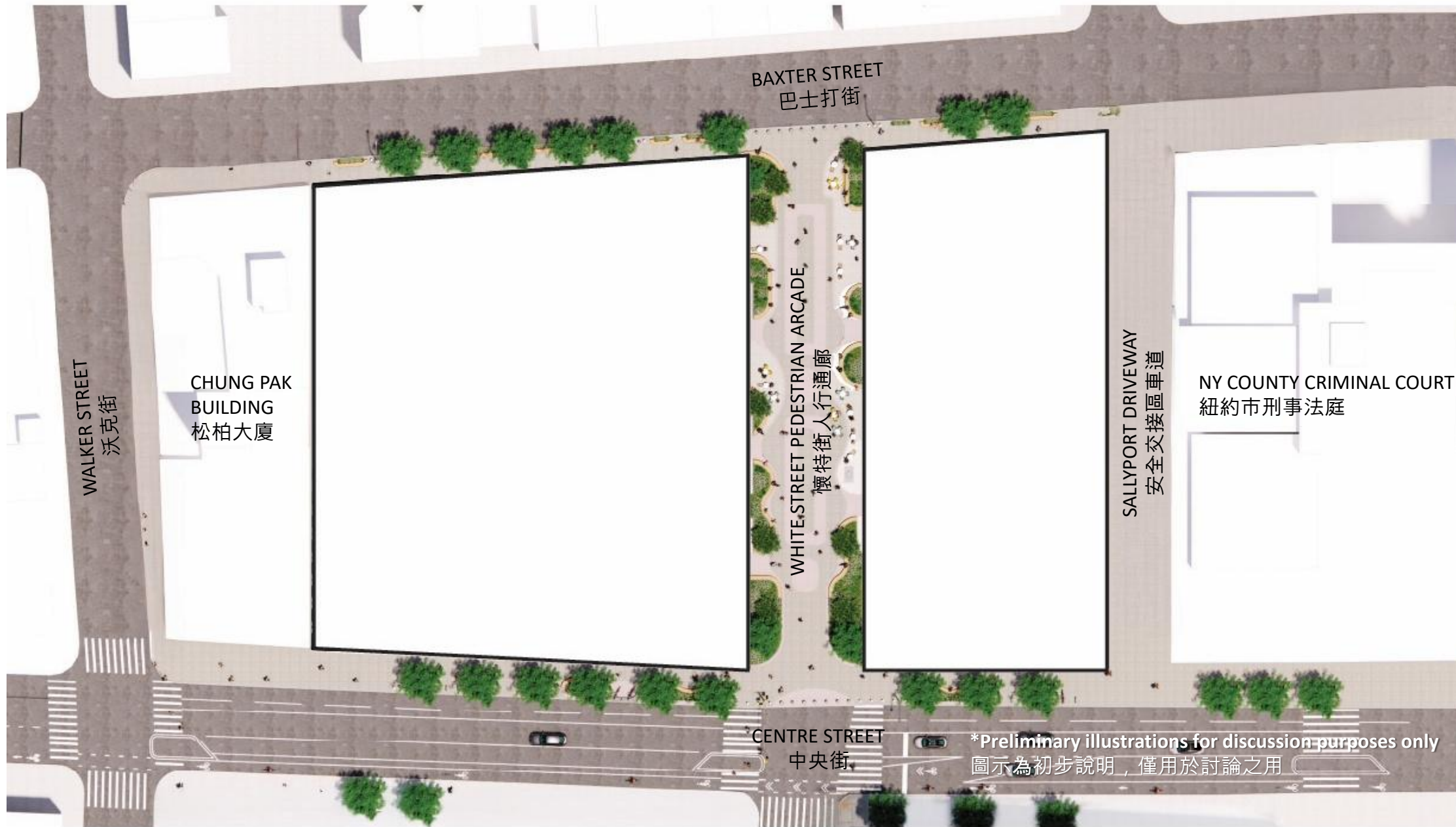

WALKER STREET  
沃克街

CHUNG PAK  
BUILDING  
松柏大廈

BAXTER STREET  
巴士打街

WHITE STREET PEDESTRIAN ARCADE  
懷特街人行通廊

SALLYPORT DRIVEWAY  
安全交接區車道

NY COUNTY CRIMINAL COURT  
紐約市刑事法庭

CENTRE STREET  
中央街

\*Preliminary illustrations for discussion purposes only  
圖示為初步說明，僅用於討論之用



\*Preliminary illustrations for discussion purposes only  
圖示為初步說明，僅用於討論之用

# PUBLIC LOBBY

## 公共大堂



\*Preliminary illustrations for discussion purposes only  
圖示為初步說明，僅用於討論之用

**PUBLIC LOBBY**  
公共大堂



\*Preliminary illustrations for discussion purposes only  
圖示為初步說明，僅用於討論之用

## CONTACT VISITING AREA

## 接觸式探視區



*\*Preliminary illustrations for discussion purposes only*  
圖示為初步說明，僅用於討論之用

# TYPICAL GENERAL POPULATION DAYROOM

## 典型在拘人員活動室



\*Preliminary illustrations for discussion purposes only  
圖示為初步說明，僅用於討論之用

# TYPICAL THERAPEUTIC DAYROOM

## 典型治療醫療活動室



\*Preliminary illustrations for discussion purposes only  
圖示為初步說明，僅用於討論之用

## TYPICAL CELL 典型拘留單元

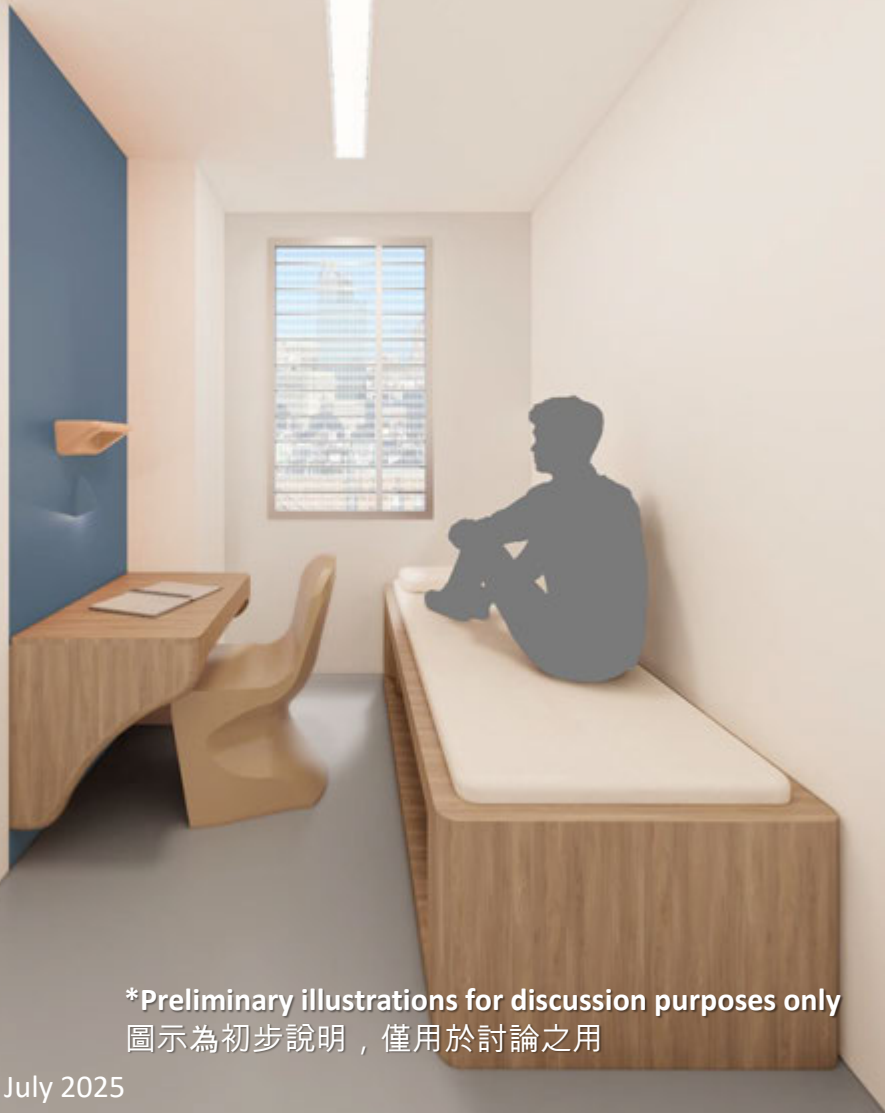

*\*Preliminary illustrations for discussion purposes only*  
圖示為初步說明，僅用於討論之用



# CONTEXT

## 周邊環境



City Hall  
市政廳



New York County  
Criminal Court  
紐約市刑事法庭



New York County  
Surrogate's Court  
紐約市遺產法院



Neighborhood Buildings  
社區鄰近建築

# INTERPRETING THE CIVIC CONTEXT THROUGH A MODERN LANGUAGE

運用當代建築語言呼應周邊城市環境文脈

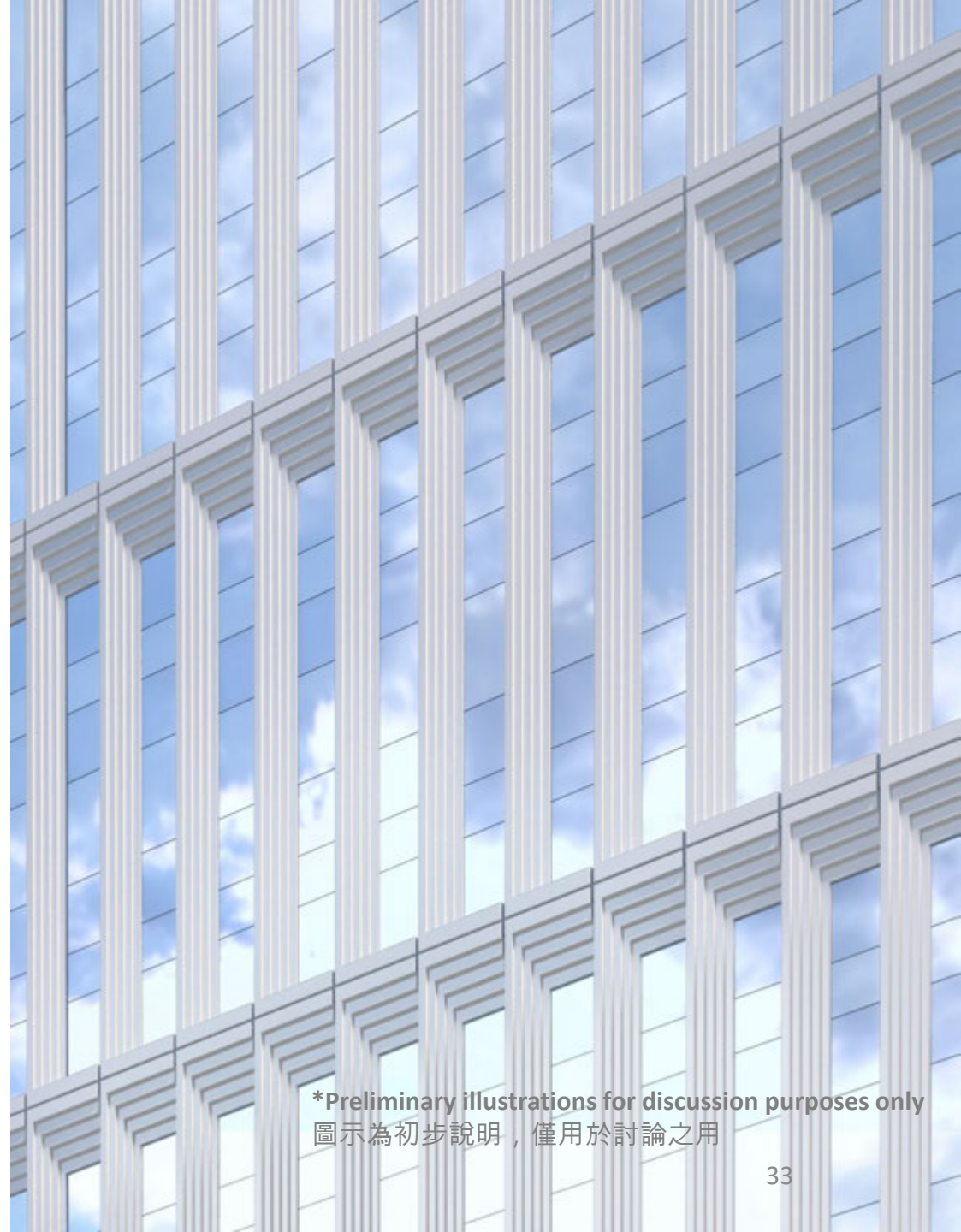

**\*Preliminary illustrations for discussion purposes only**  
圖示為初步說明，僅用於討論之用

## MATERIALITY RESPECTS THE CIVIC CONTEXT

建築材料呼應周邊建築特色



\*Preliminary illustrations for discussion purposes only  
圖示為初步說明，僅用於討論之用

VIEW ON CENTRE STREET LOOKING NORTH  
中央街北向街景視角



\*Preliminary illustrations for discussion purposes only  
圖示為初步說明，僅用於討論之用

# NORTH ELEVATION OF WHITE STREET PEDESTRIAN ARCADE

## 懷特街人行通廊北立面

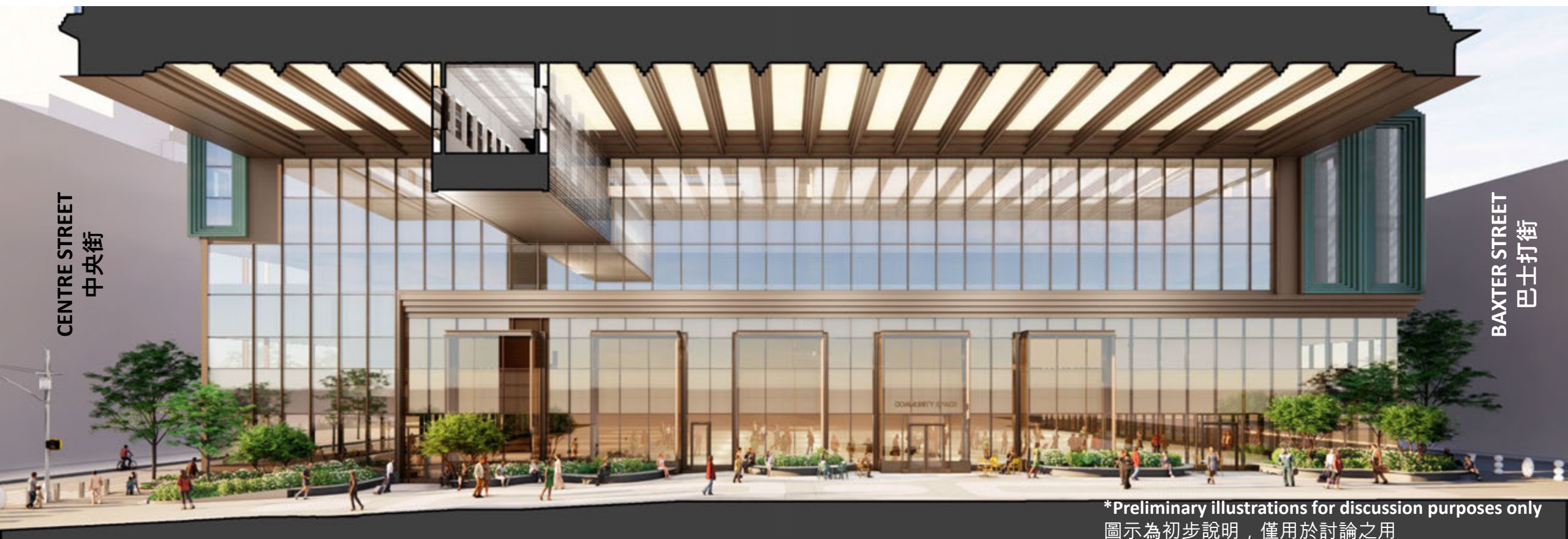

VIEW ON BAXTER STREET LOOKING NORTH  
巴士打街北向街景視角



\*Preliminary illustrations for discussion purposes only  
圖示為初步說明，僅用於討論之用

July 2025

## MASSING APPROACH – ULURP ENVELOPE

### 體量設計策略 – ULURP 控制輪廓

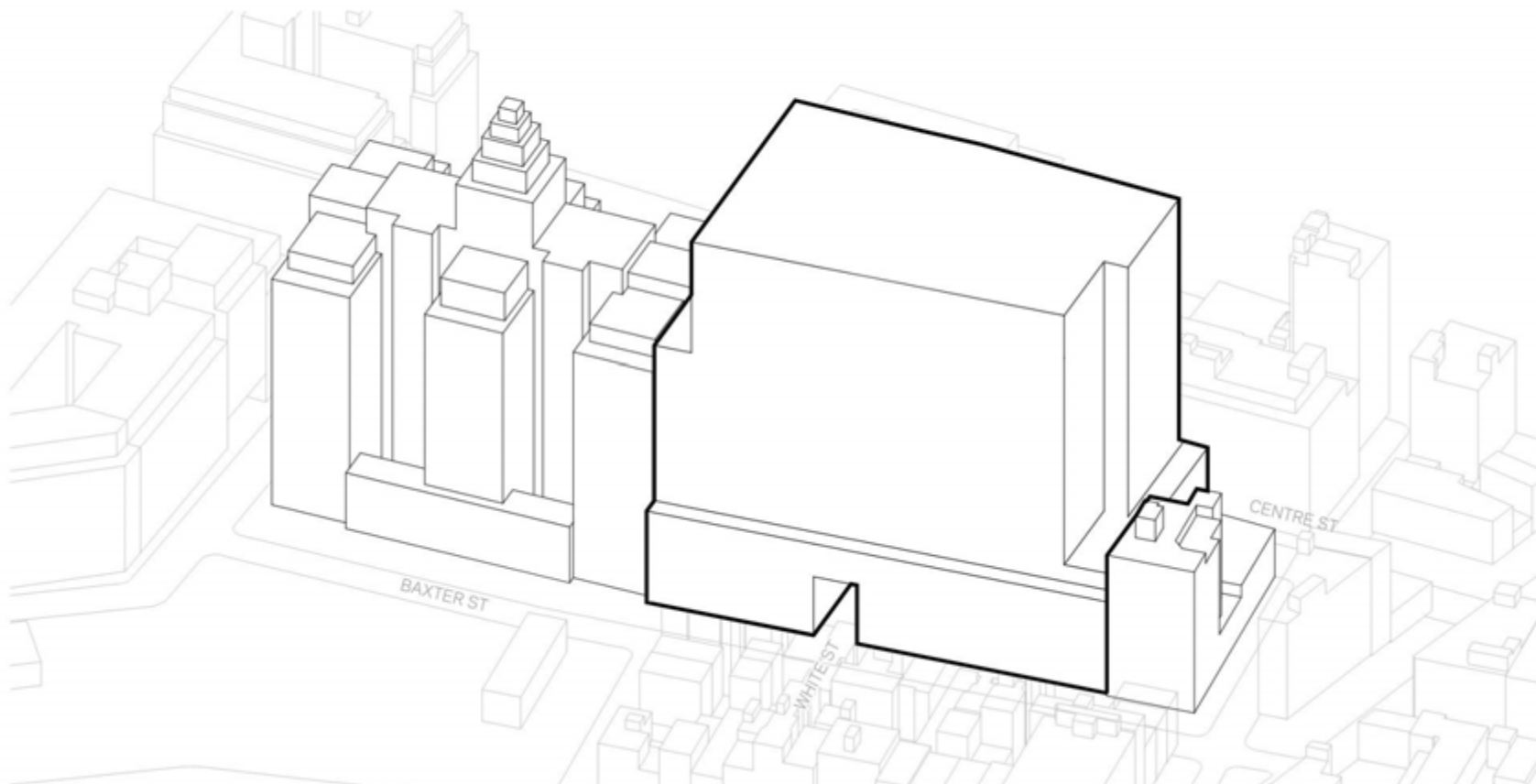

# MASSING APPROACH—RECONNECTING WHITE STREET PEDESTRIAN ARCADE

## 體量設計策略—重新連接懷特街人行通廊

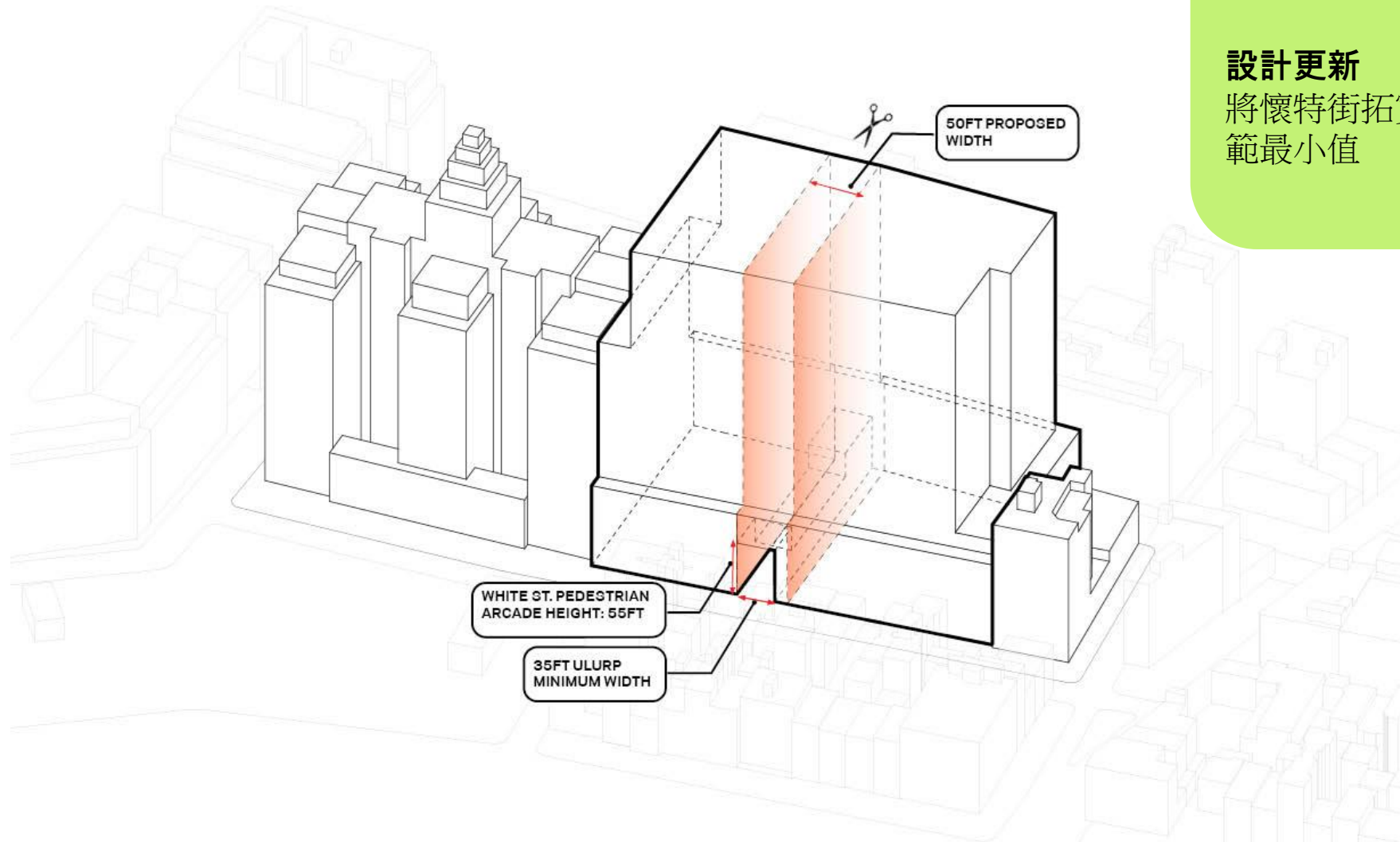

### Design Update

Widen White street beyond ULURP code minimum

### 設計更新

將懷特街拓寬超出ULURP規範最小值

## MASSING APPROACH – BREAKING THE SCALE DOWN

### 體量設計策略 – 分解減小建築體量

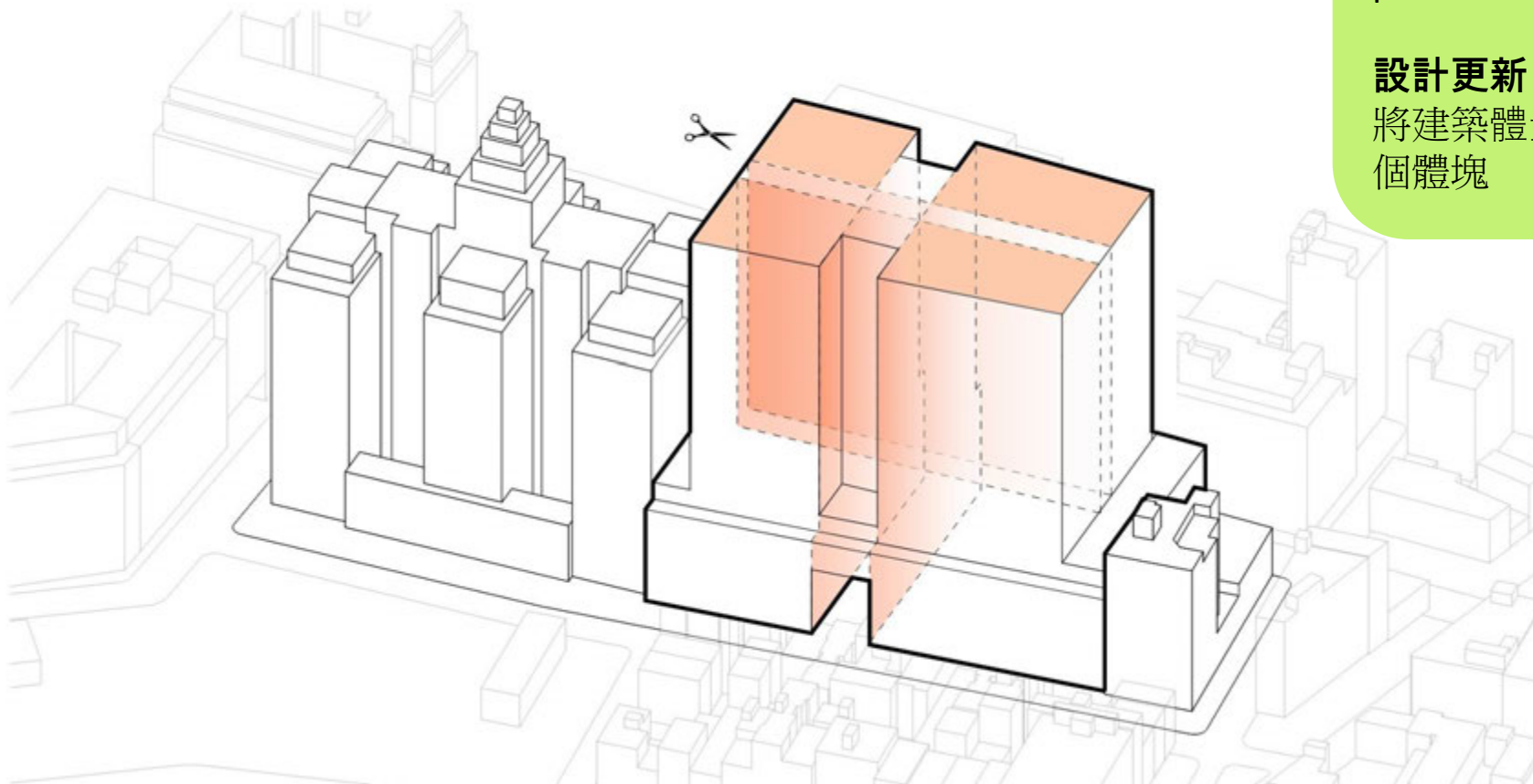

#### Design Update

Break down the building's scale by splitting into four parts

#### 設計更新

將建築體量分解減小為四個體塊

## MASSING APPROACH – LOWERING THE BUILDING

### 體量設計策略 – 降低建築高度

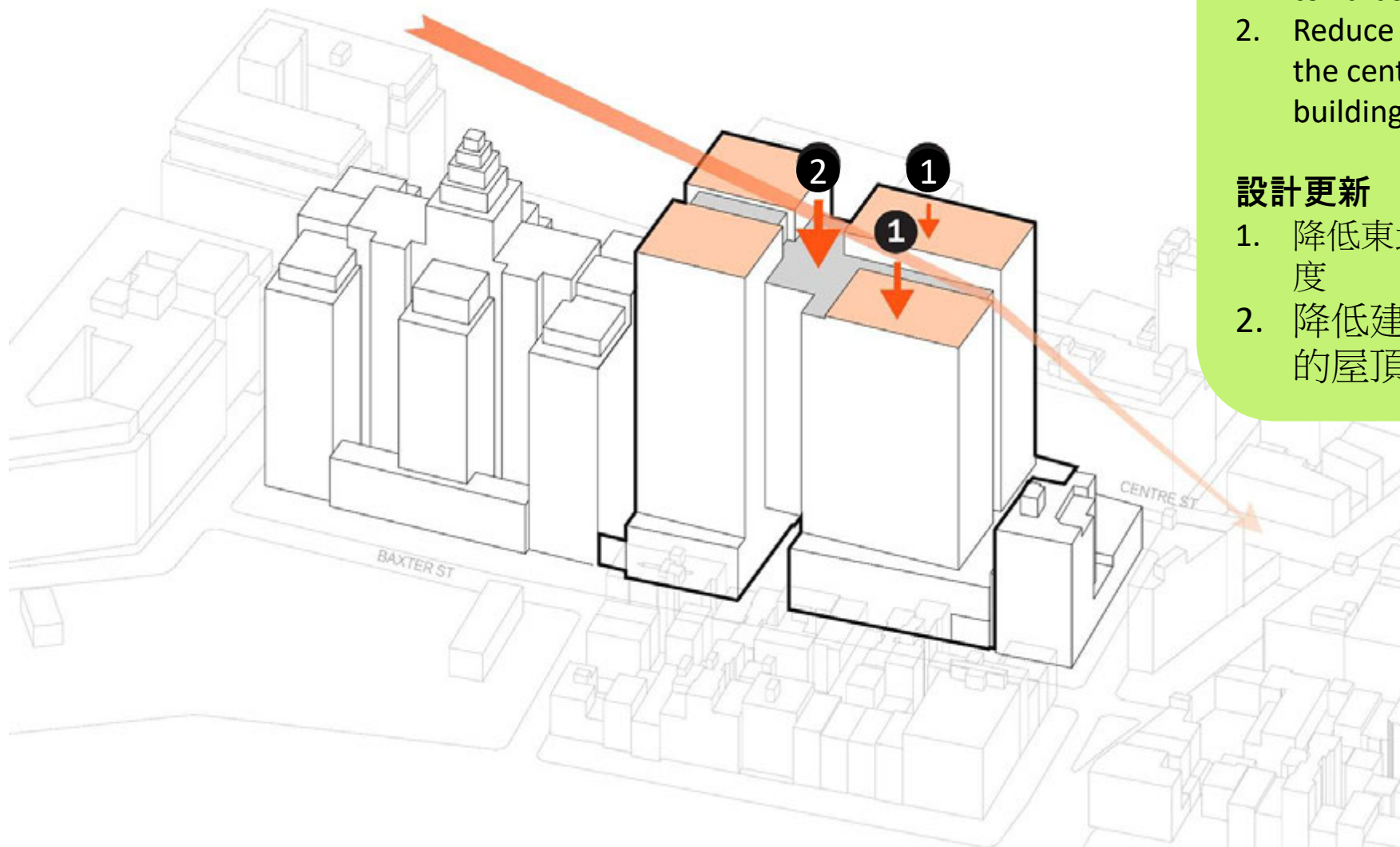

#### Design Update

1. Lower the building towards the northeast
2. Reduce roof height in the center of the building

#### 設計更新

1. 降低東北方向建築高度
2. 降低建築中心區域的屋頂高度

## MASSING APPROACH—OPENING UP WHITE STREET PEDESTRIAN ARCADE

### 體量設計策略—拓寬懷特街人行通廊

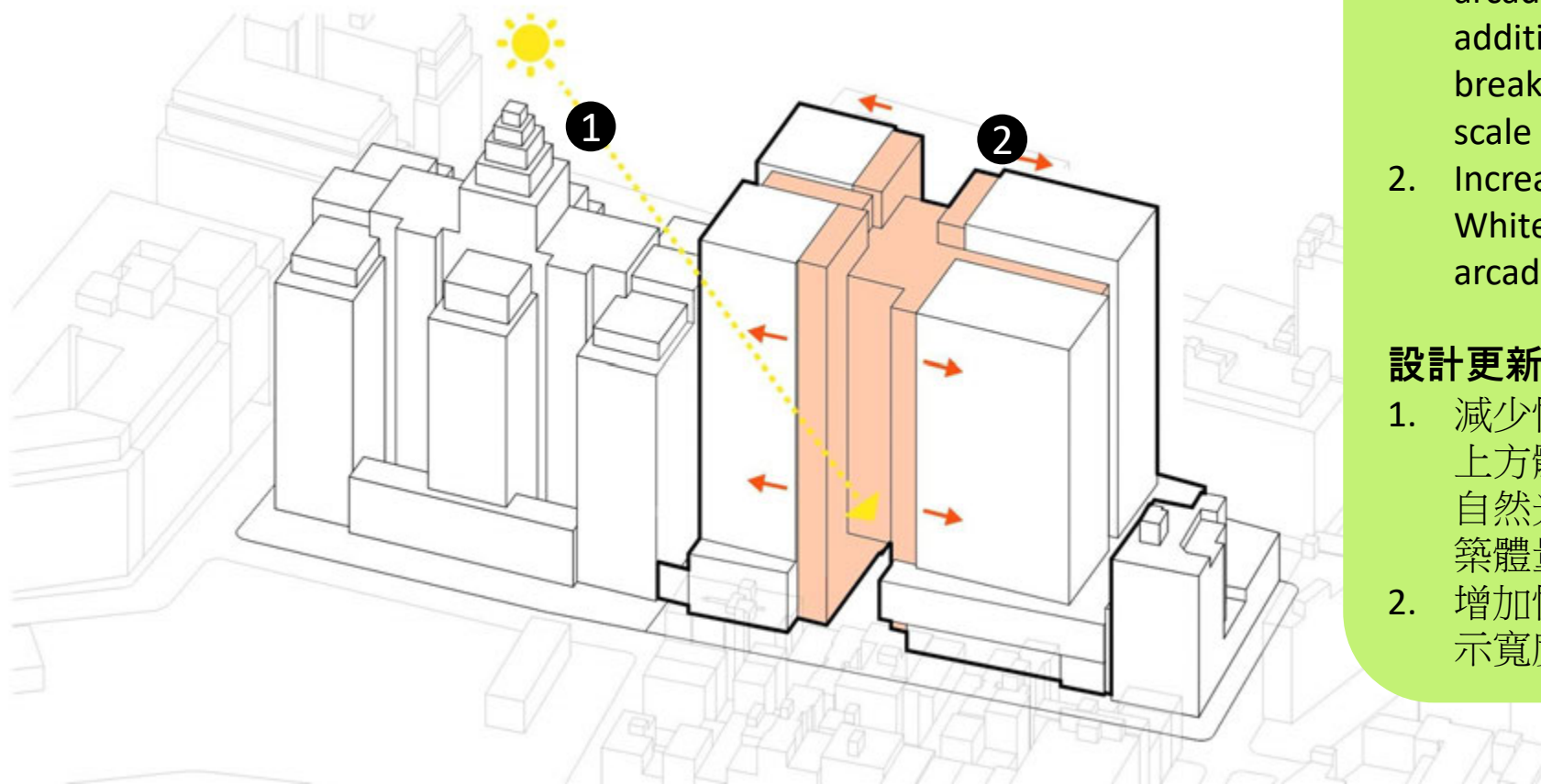

#### Design Update

1. Reduce massing above White Street pedestrian arcade to bring down additional daylight + break down building scale
2. Increase apparent White Street pedestrian arcade width

#### 設計更新

1. 減少懷特街人行通廊上方體量以引入更多自然光 + 分解減小建築體量
2. 增加懷特街通道的展示寬度

## MASSING APPROACH – CONTINUING THE CIVIC RHYTHM

### 體量設計策略 – 延續城市建築風格

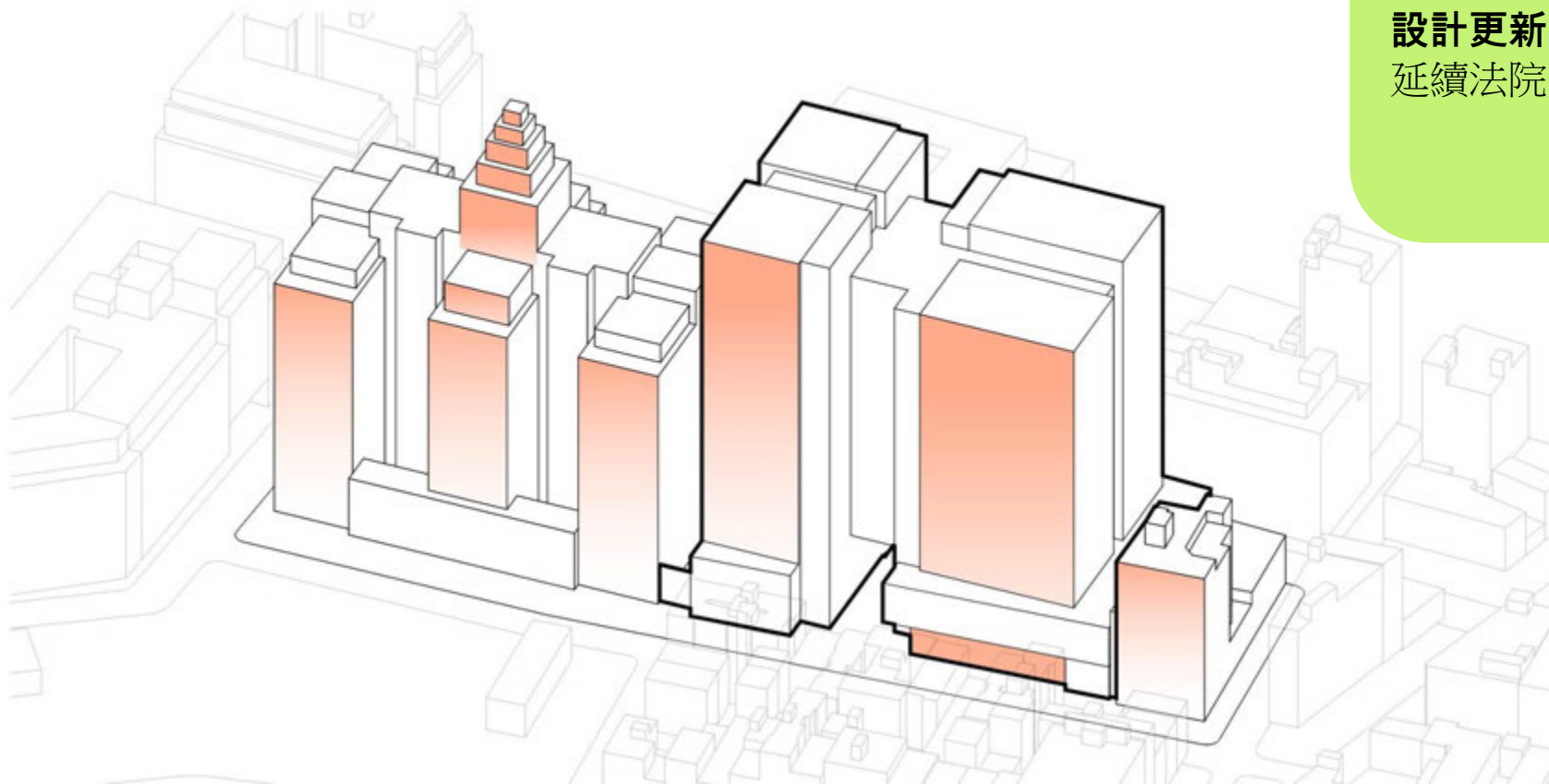

#### Design Update

Continue the vertical rhythm of the courthouse massing

#### 設計更新

延續法院建築體量的豎向

## MASSING APPROACH – CONTEXTUAL HORIZONTAL DATUM

### 體量設計策略 – 與周邊橫向基準線對齊

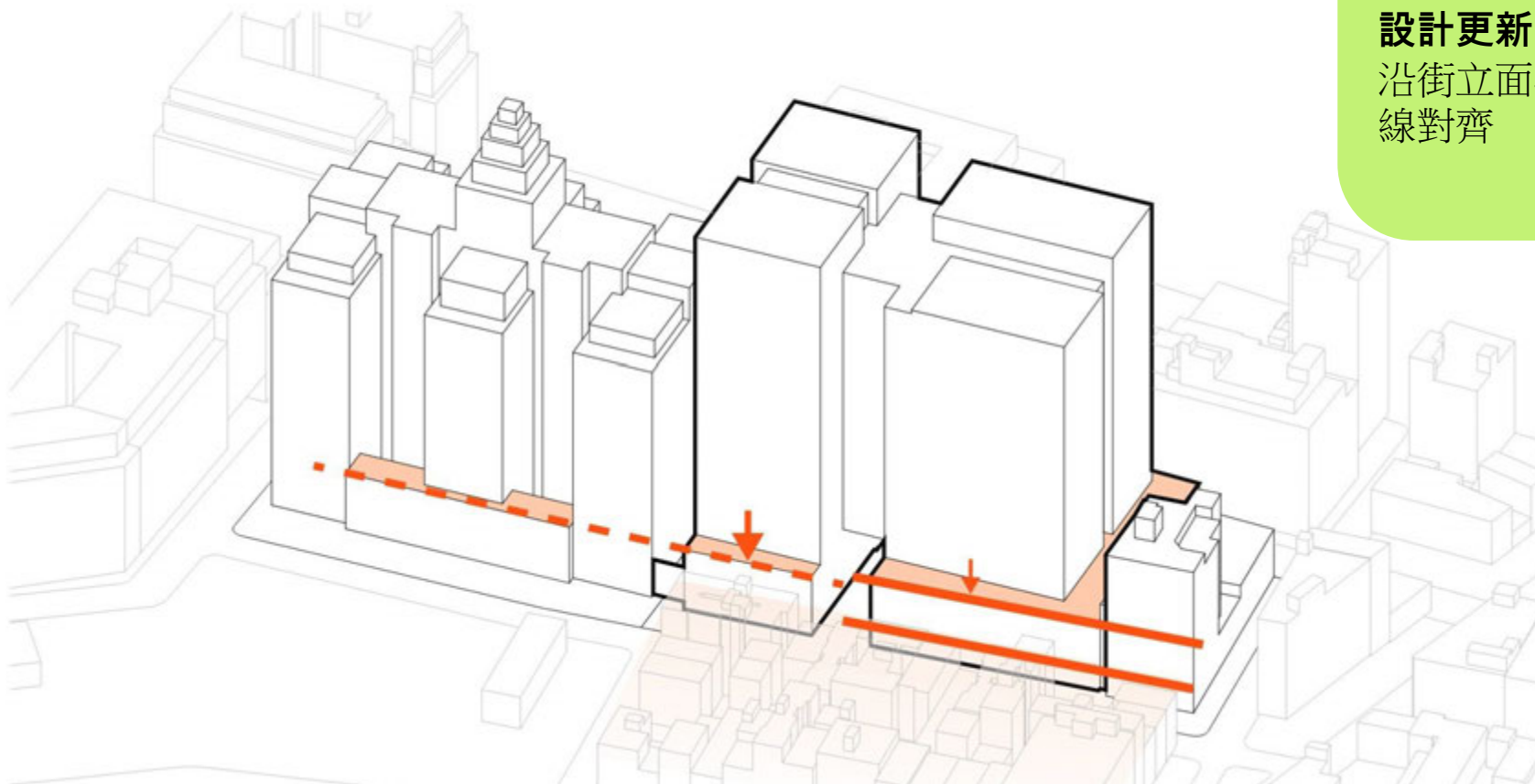

#### Design Update

Align with the existing datum along the street facade

#### 設計更新

沿街立面與周邊建築基準線對齊

## MASSING APPROACH – PROMOTING HUMAN SCALE APPROACH

### 體量設計策略 – 提升人性化尺度體驗

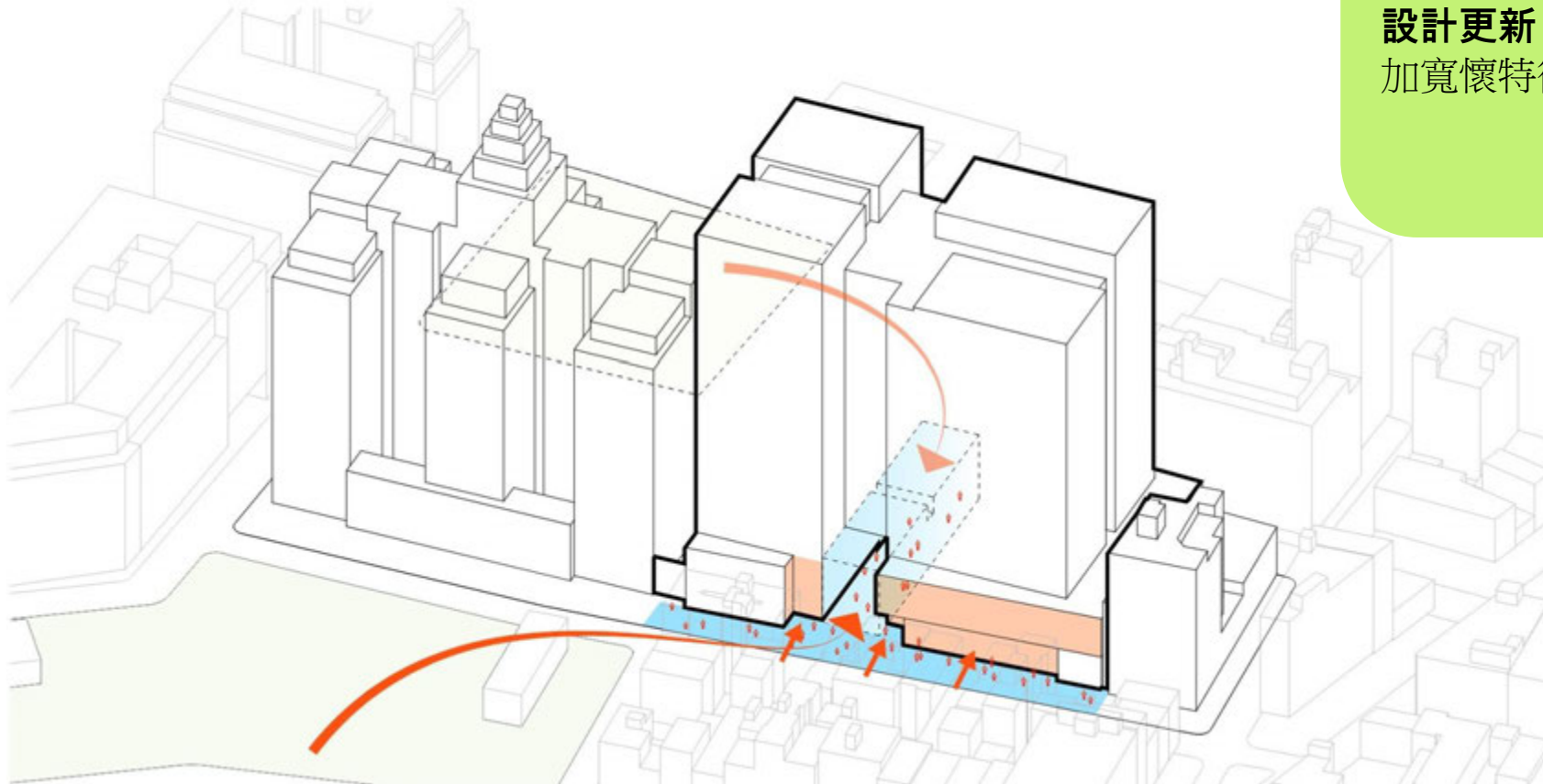

#### Design Update

Increased White Street pedestrian arcade width

#### 設計更新

加寬懷特街人行通廊

# MASSING APPROACH – BRINGING DAYLIGHT TO THE WHITE STREET PEDESTRIAN ARCADE

體量設計策略 – 引入自然光至懷特街人行通廊

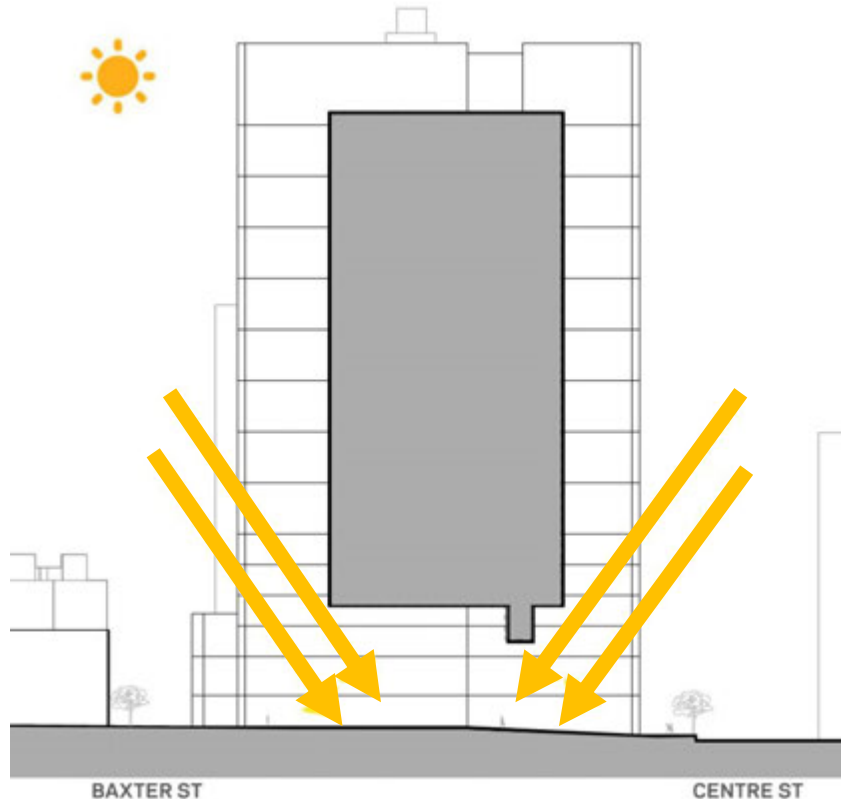
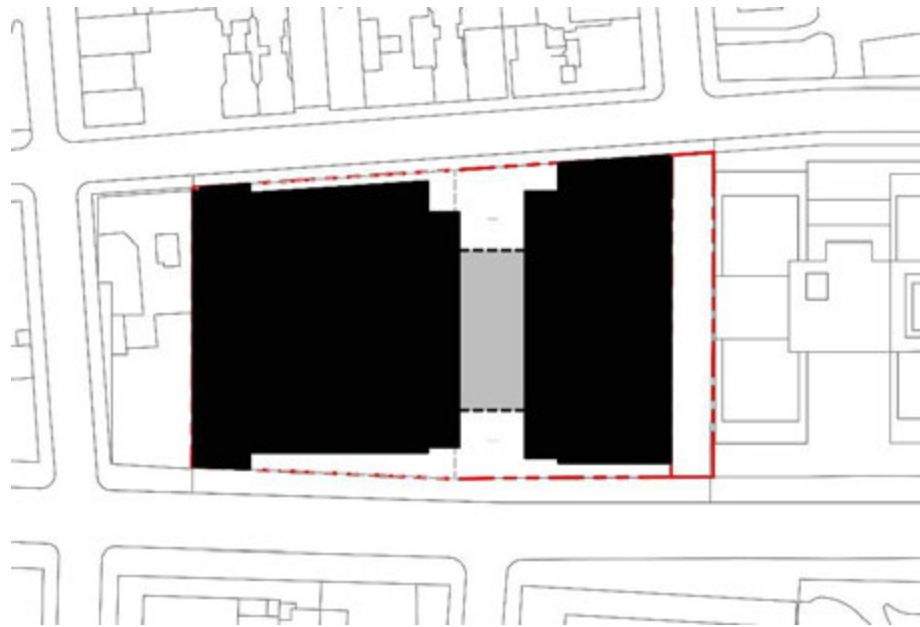

## Design Update

Reduce massing above White Street pedestrian arcade to bring additional daylight to the street + break down the overall building scale

## 設計更新

減少懷特街人行通廊上方體量以引入更多自然光至通廊 + 減小整體建築體量

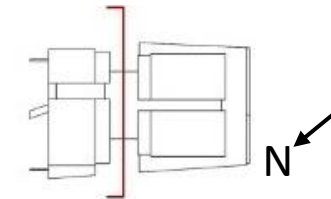

## VIEWS IN CONTEXT – FROM COLLECT POND PARK

### 周邊環境視角 – 集池公園視角



July 2025

*\*Preliminary illustrations for discussion purposes only  
圖示為初步說明，僅用於討論之用*

### Design Update

1. Reduced apparent mass
2. Further opened White Street pedestrian arcade

### 設計更新

1. 縮減後的視覺體量
2. 拓寬後的懷特街人行通廊

## IEWS IN CONTEXT – FROM COLUMBUS PARK 周邊環境視角 – 哥倫布公園視角



### Design Update

1. Reduced apparent mass
2. Further opened White Street pedestrian arcade

### 設計更新

1. 縮減後的視覺體量
2. 拓寬後的懷特街人行通廊

## SUPPORTIVE ENVIRONMENTS

CONVEY DIGNITY AND RESPECT  
PROMOTE SAFETY AND SECURITY  
GRANT A SENSE A PERSONAL AGENCY  
FOSTER WELLBEING  
CREATE INCLUSIVE SPACES THAT ENSURE ACCESSIBILITY FOR ALL

## CONNECTED COMMUNITIES

WELCOME VISITORS  
PROVIDE SUPPORT FOR STAFF AND SERVICE PROVIDERS  
REFLECT COMMUNITY LIVING  
EASE ACCESS TO RESOURCES  
CONNECT TO THE NEIGHBORHOOD

## CIVIC ASSETS

EXPRESS CIVIC CHARACTER  
RESPOND TO NEIGHBORHOOD CONTEXT  
CREATE CONNECTIONS  
ENHANCE THE PEDESTRIAN EXPERIENCE  
INTEGRATE BUILDING SYSTEM AND SERVICES

## ENDURING RESOURCES

OPTIMIZE PERFORMANCE  
ENHANCE THE URBAN ENVIRONMENT  
DESIGN FOR LONGEVITY  
EMBRACE RESILIENCY  
ANTICIPATE FUTURE CHANGES

## 支持性環境

彰顯尊嚴與尊重  
提升安全性與保障性  
賦予個人自主性  
促進身心健康  
創建包容性空間，保障無障礙通行

## 社區聯結

訪客友好設計  
為工作人員及服務供給方提供支持  
體現社區生活場景  
優化資源可達路徑  
融入鄰裏環境

## 城市公共資源

彰顯城市建築特質  
呼應周邊環境社區文脈  
建立空間連接性  
提升步行體驗  
整合建築系統與服務設施

## 可持續資源

性能最優化  
優化城市環境  
長效性設計  
擁有彈性  
前瞻適應性

Manhattan

曼哈頓

Q & A

問答



# Thank you 謝謝

July 31, 2025  
2025年7月31日

MN

## Manhattan Borough-Based Jail 曼哈頓城區拘留所

SITE