

APPENDIX F

TRANSIT AND PEDESTRIANS

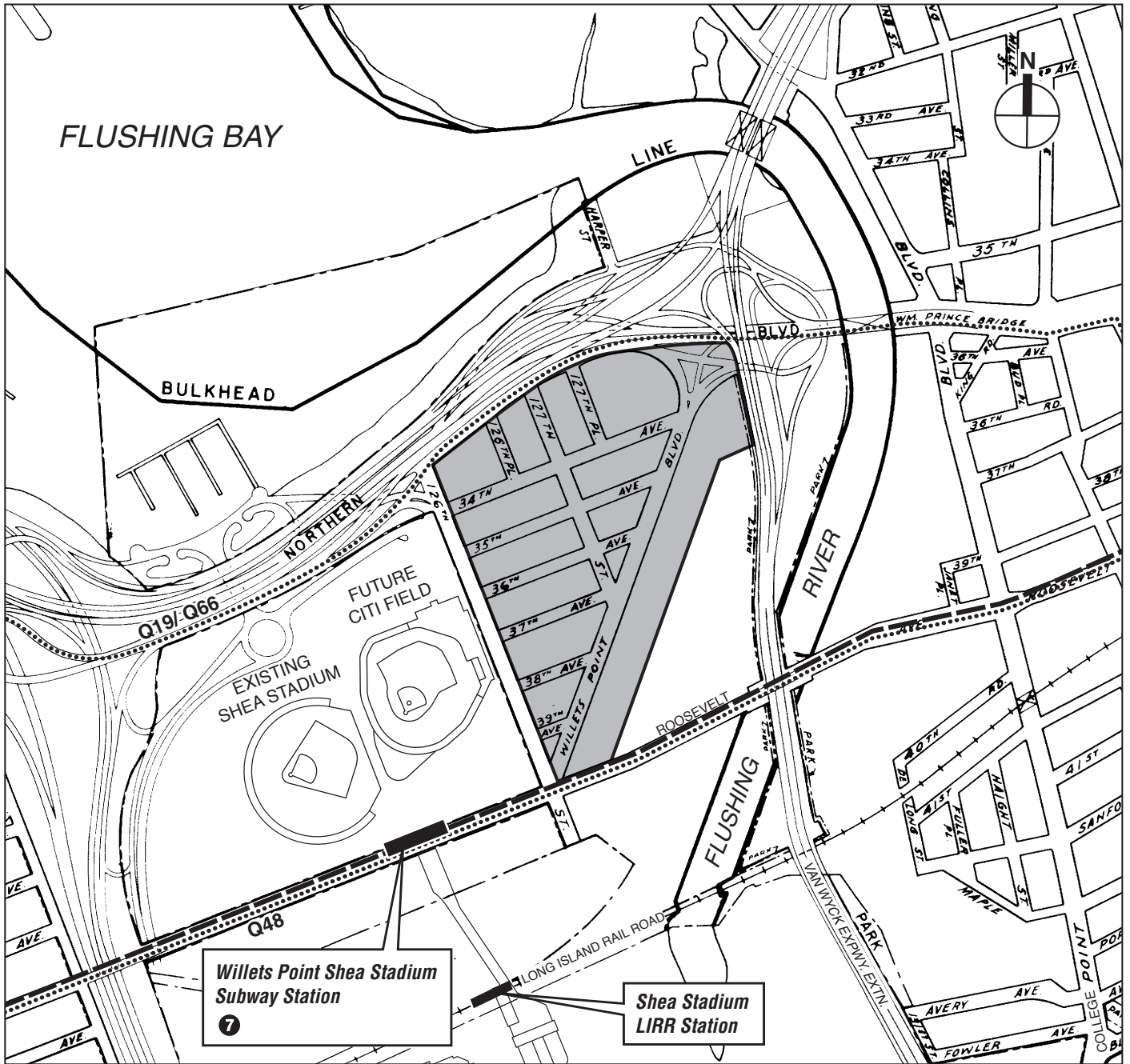

- Willets Point Development District
- Subway Line
- Bus Route

0 500 1000 FEET
SCALE

This figure has been updated since the DGEIS

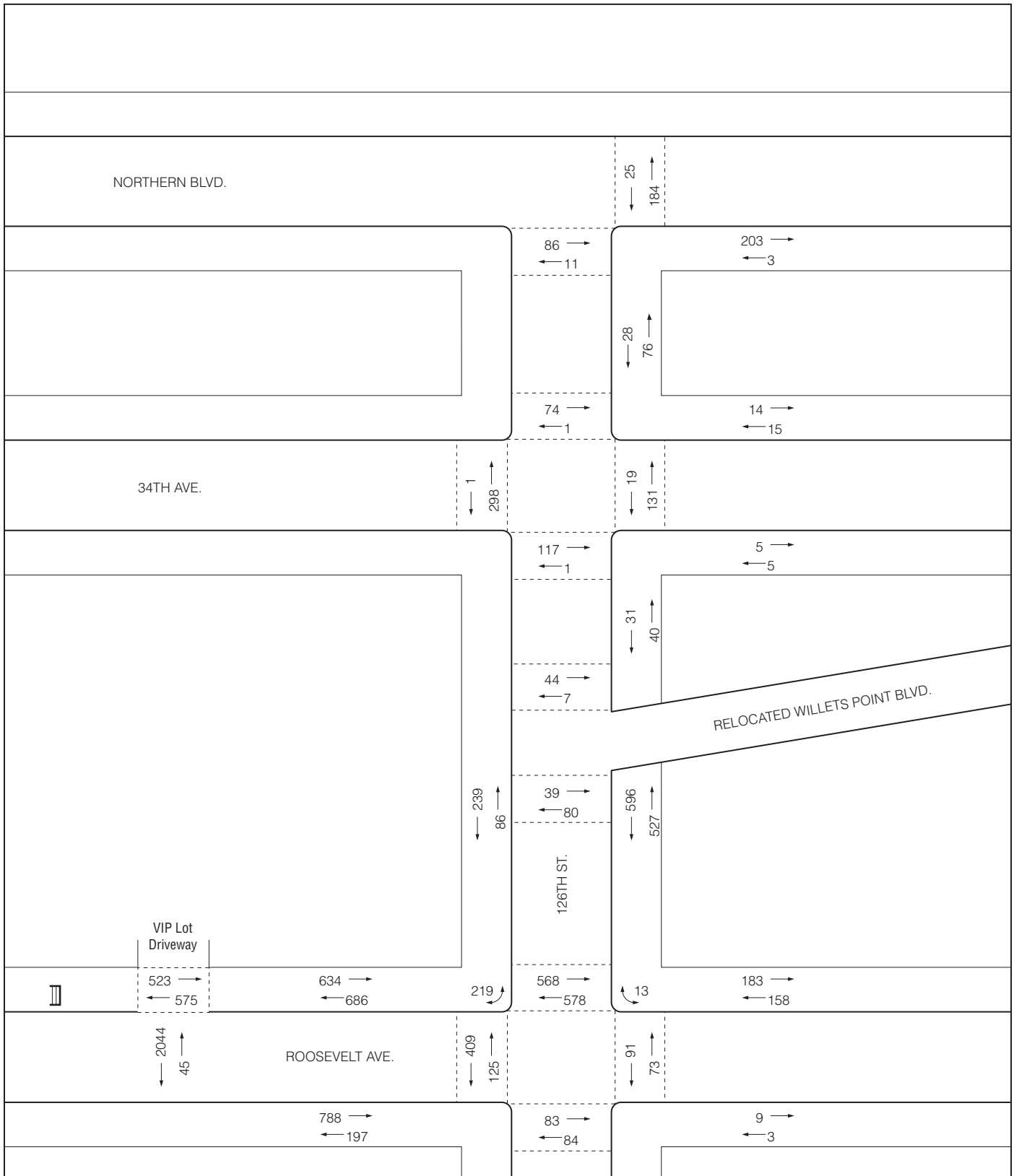

FOR ILLUSTRATIVE PURPOSES

2017 Build Pedestrian Volumes
SAT Post Game Peak 15-Minutes
Figure F-30

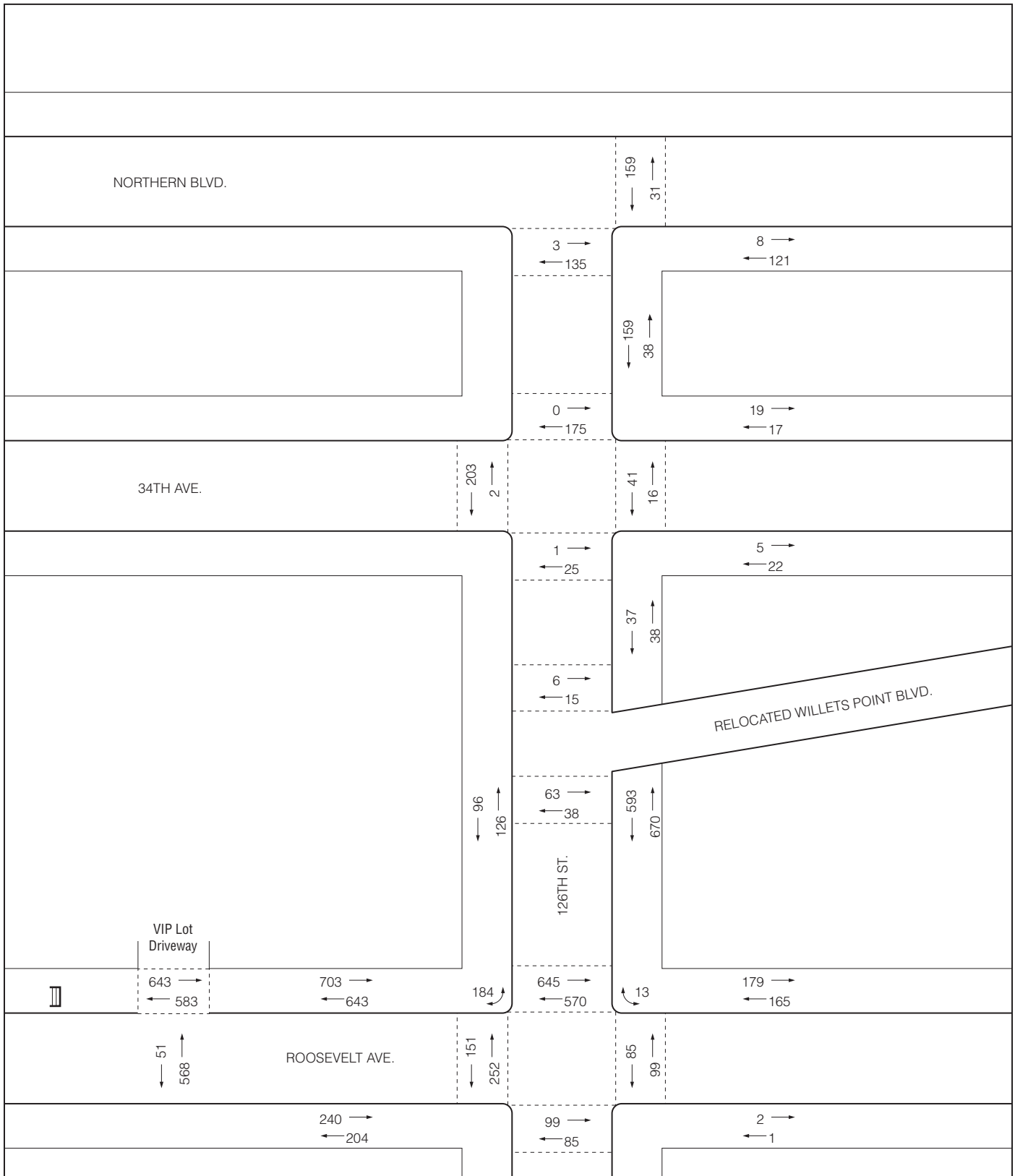

FOR ILLUSTRATIVE PURPOSES

2017 Build Pedestrian Volumes
SAT Pre-game Peak 15-Minutes
Figure F-29

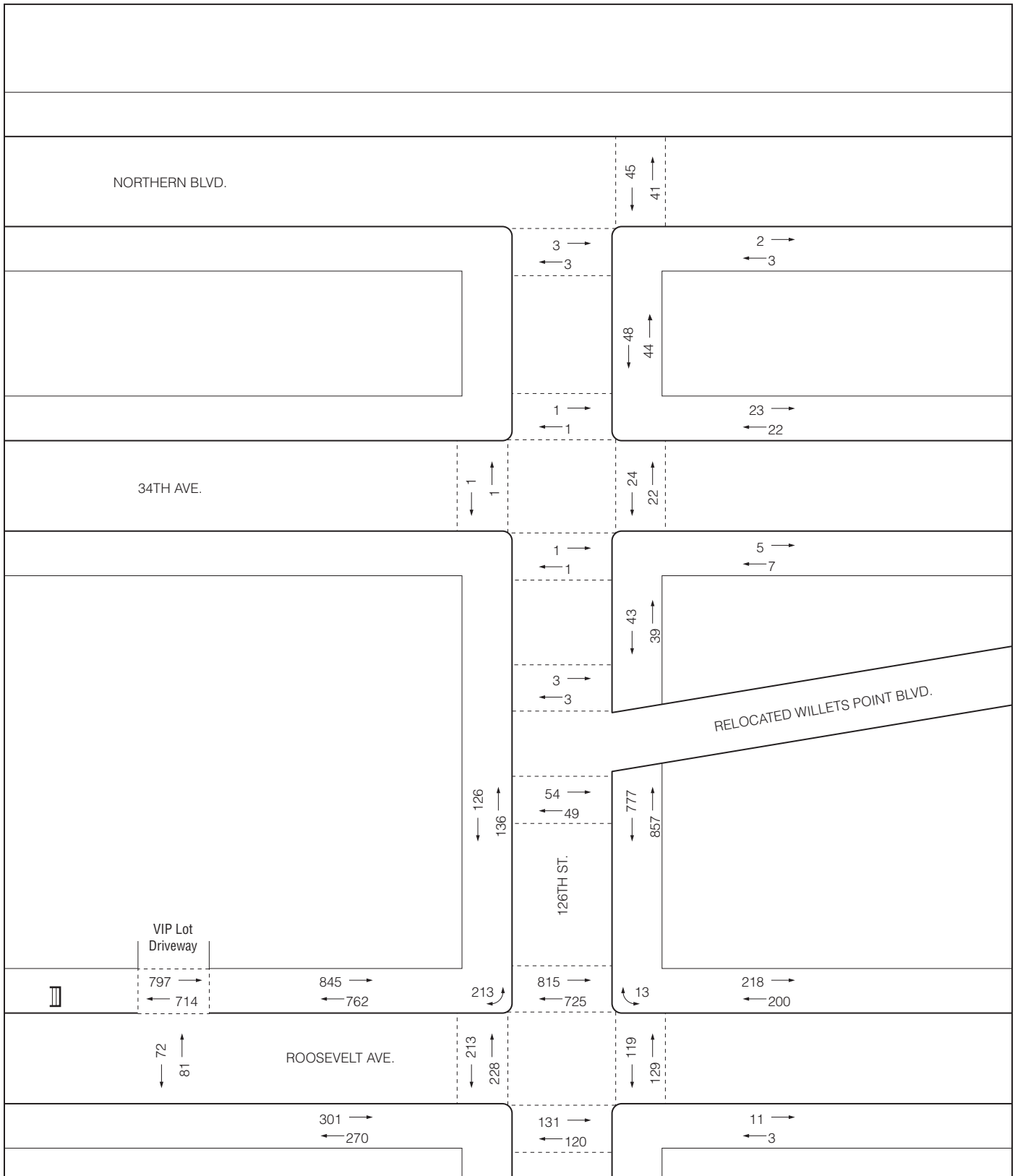

FOR ILLUSTRATIVE PURPOSES

2017 Build Pedestrian Volumes
SAT MD Peak 15-Minutes
Figure F-28

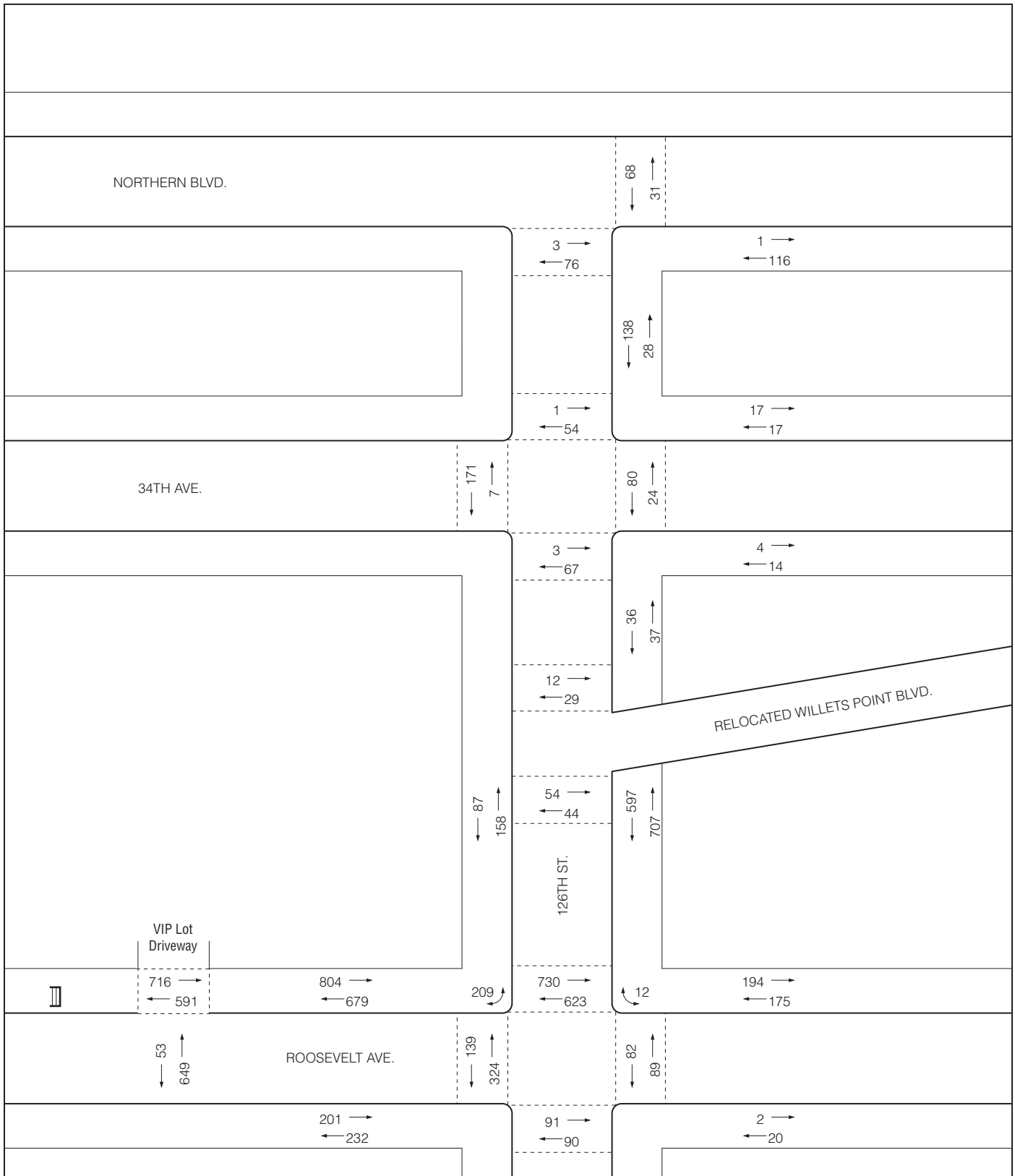

FOR ILLUSTRATIVE PURPOSES

2017 Build Pedestrian Volumes
PM Pre-game Peak 15-Minutes
Figure F-27

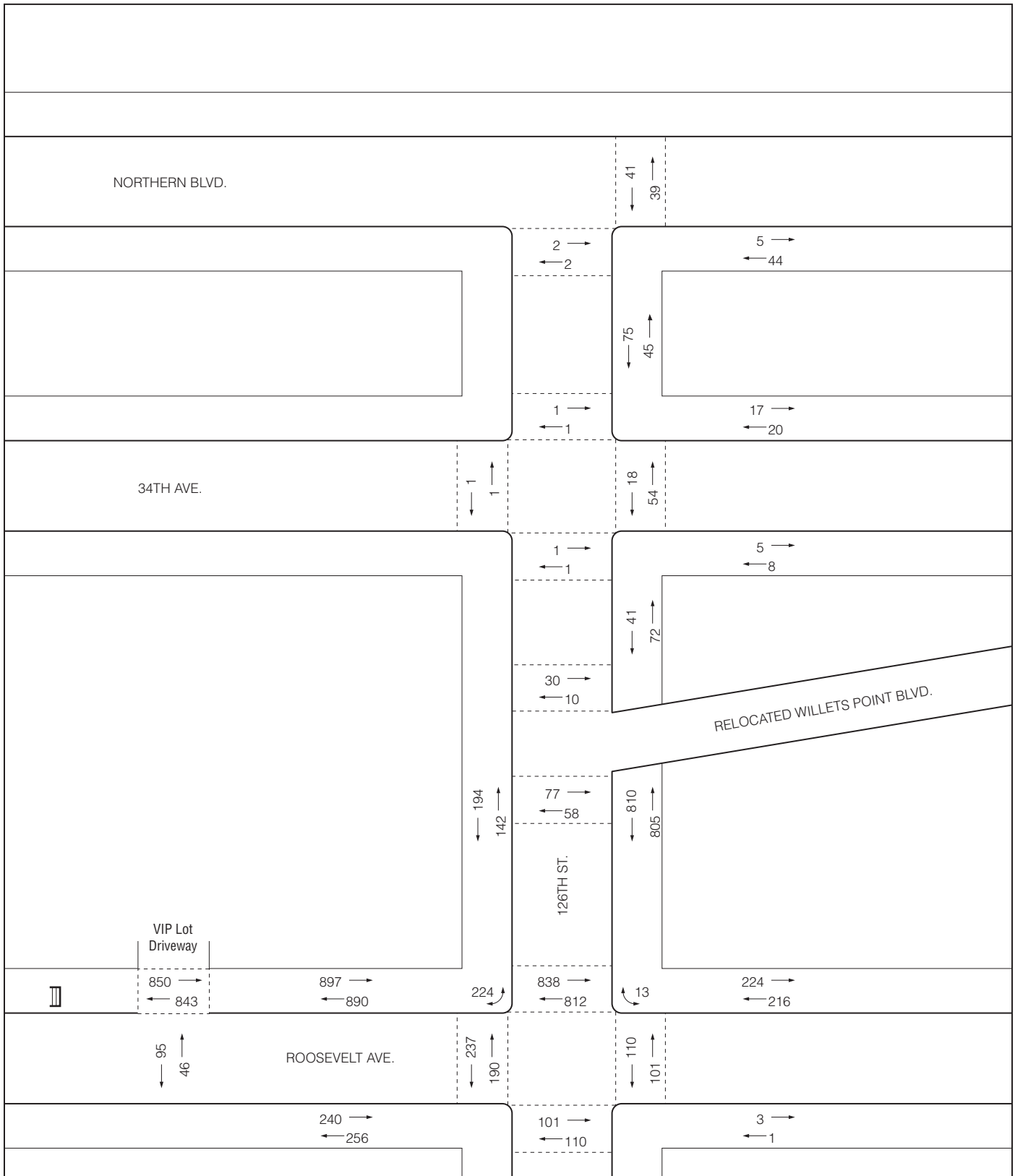

FOR ILLUSTRATIVE PURPOSES

2017 Build Pedestrian Volumes
 PM Peak 15-Minutes
Figure F-26

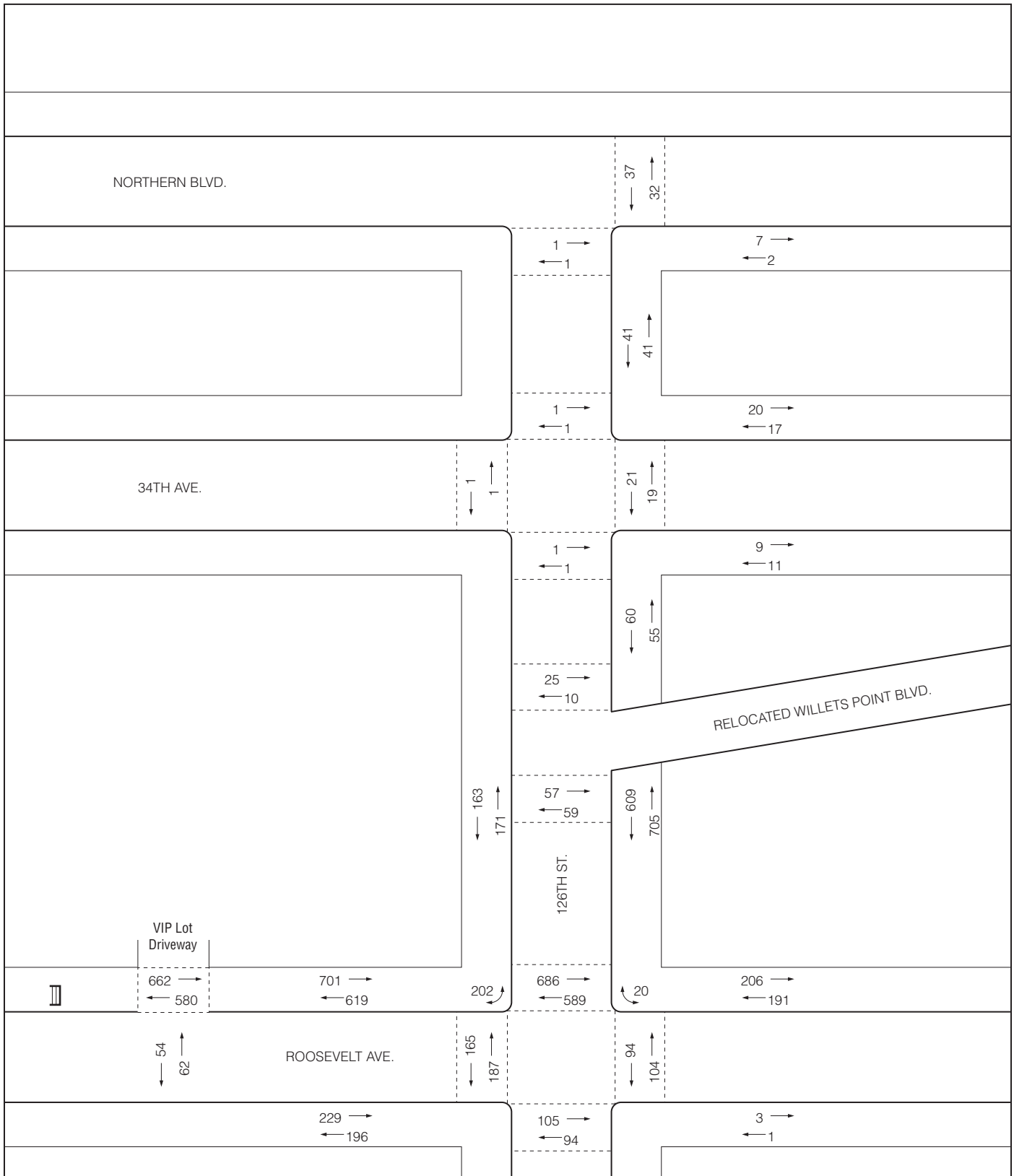

FOR ILLUSTRATIVE PURPOSES

2017 Build Pedestrian Volumes
Midday Peak 15-Minutes
Figure F-25

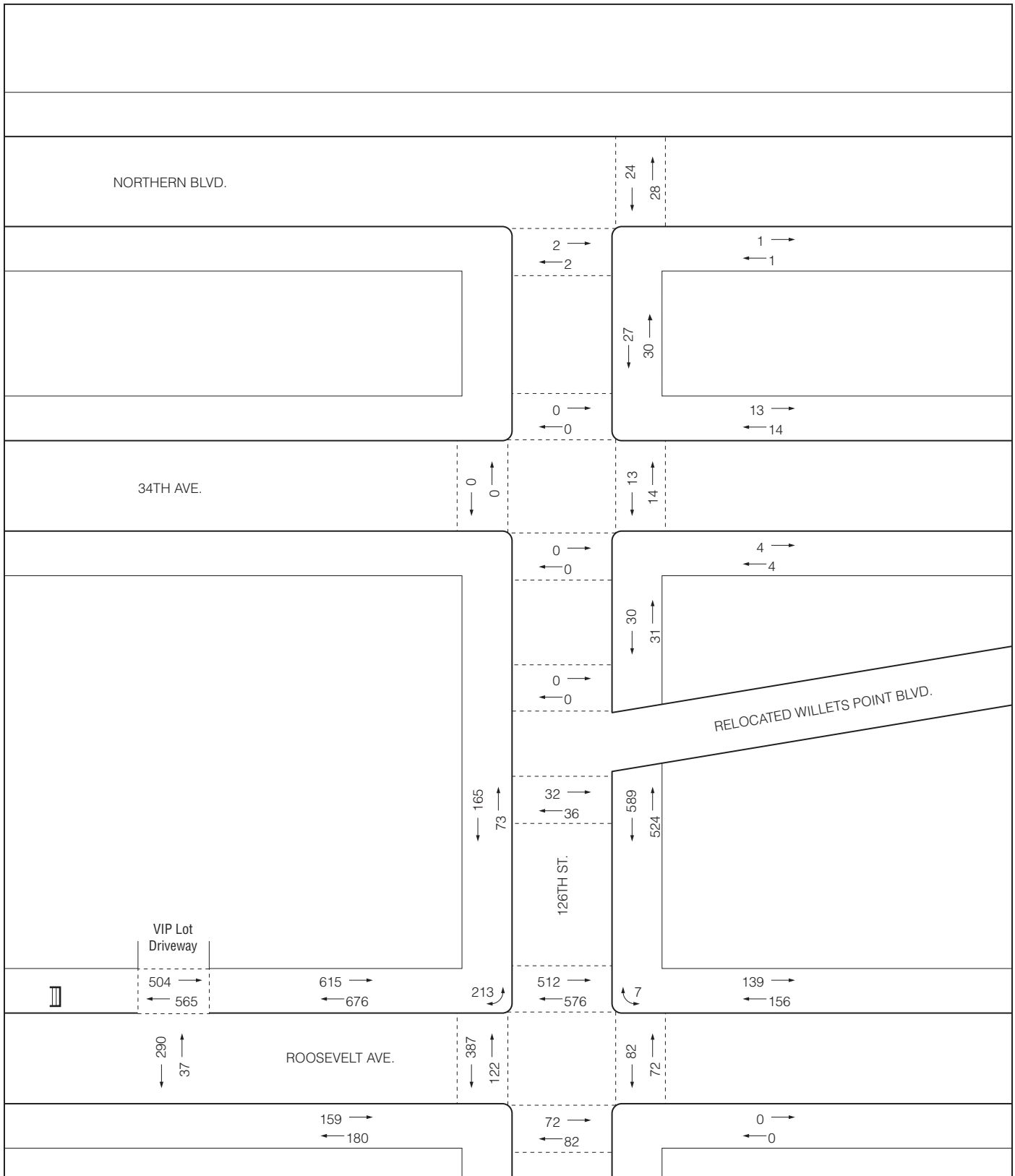

FOR ILLUSTRATIVE PURPOSES

2017 Project-Generated Pedestrian Volumes
 SAT Post Game Peak 15-Minutes
Figure F-23

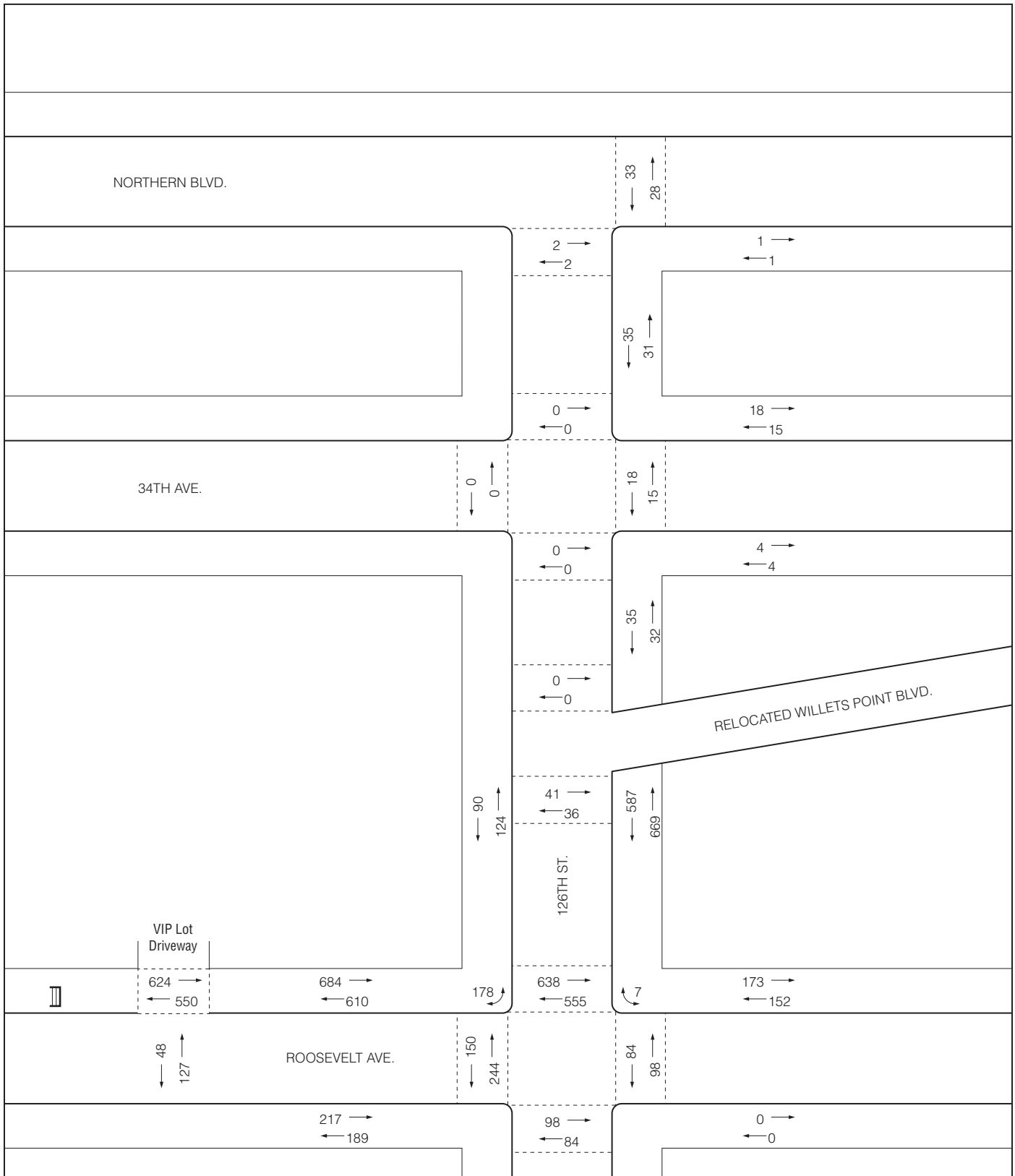

FOR ILLUSTRATIVE PURPOSES

2017 Project-Generated Pedestrian Volumes
SAT Pre-game Peak 15-Minutes
Figure F-22

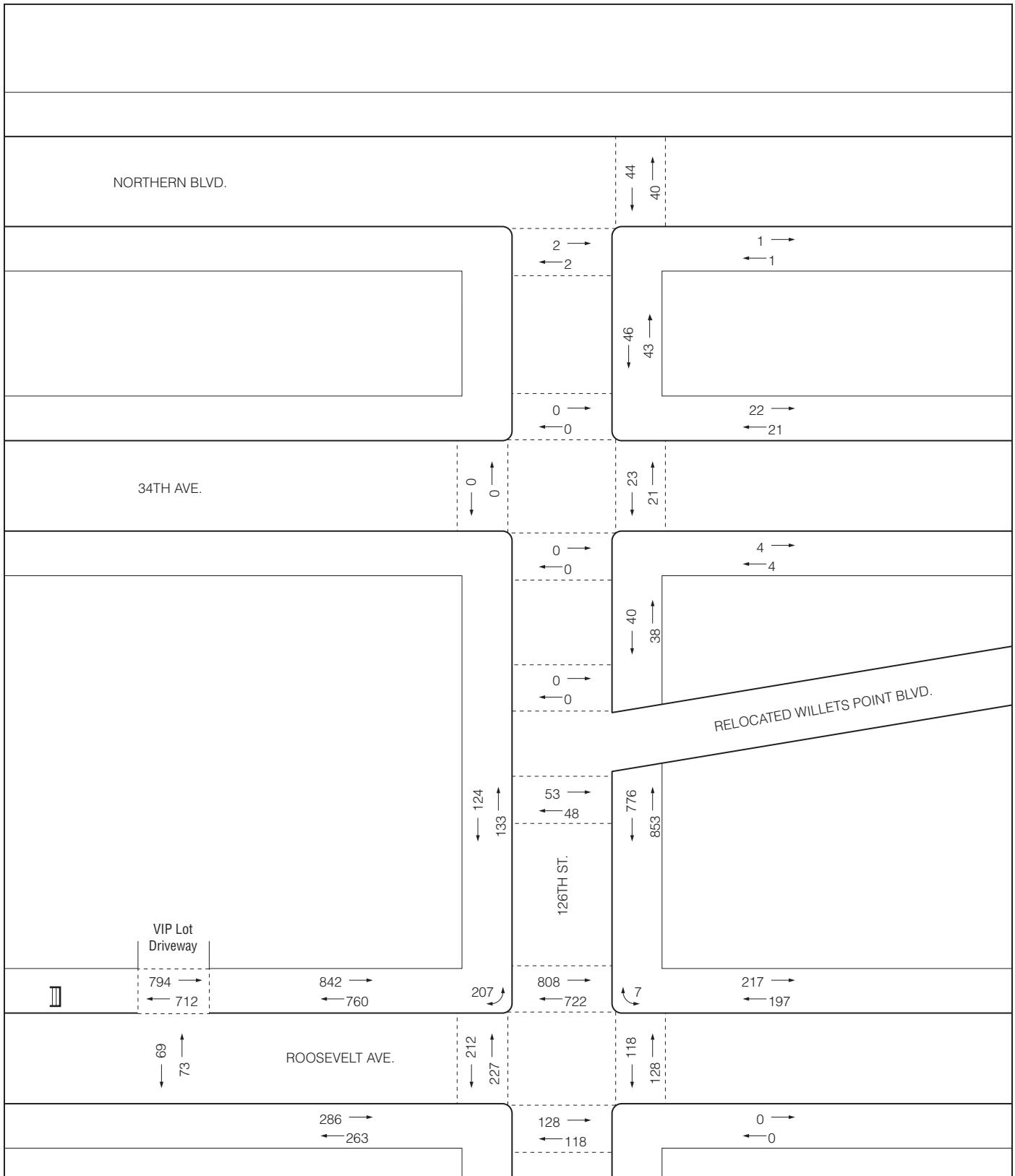

FOR ILLUSTRATIVE PURPOSES

2017 Project-Generated Pedestrian Volumes
 SAT MD Peak 15-Minutes
Figure F-21

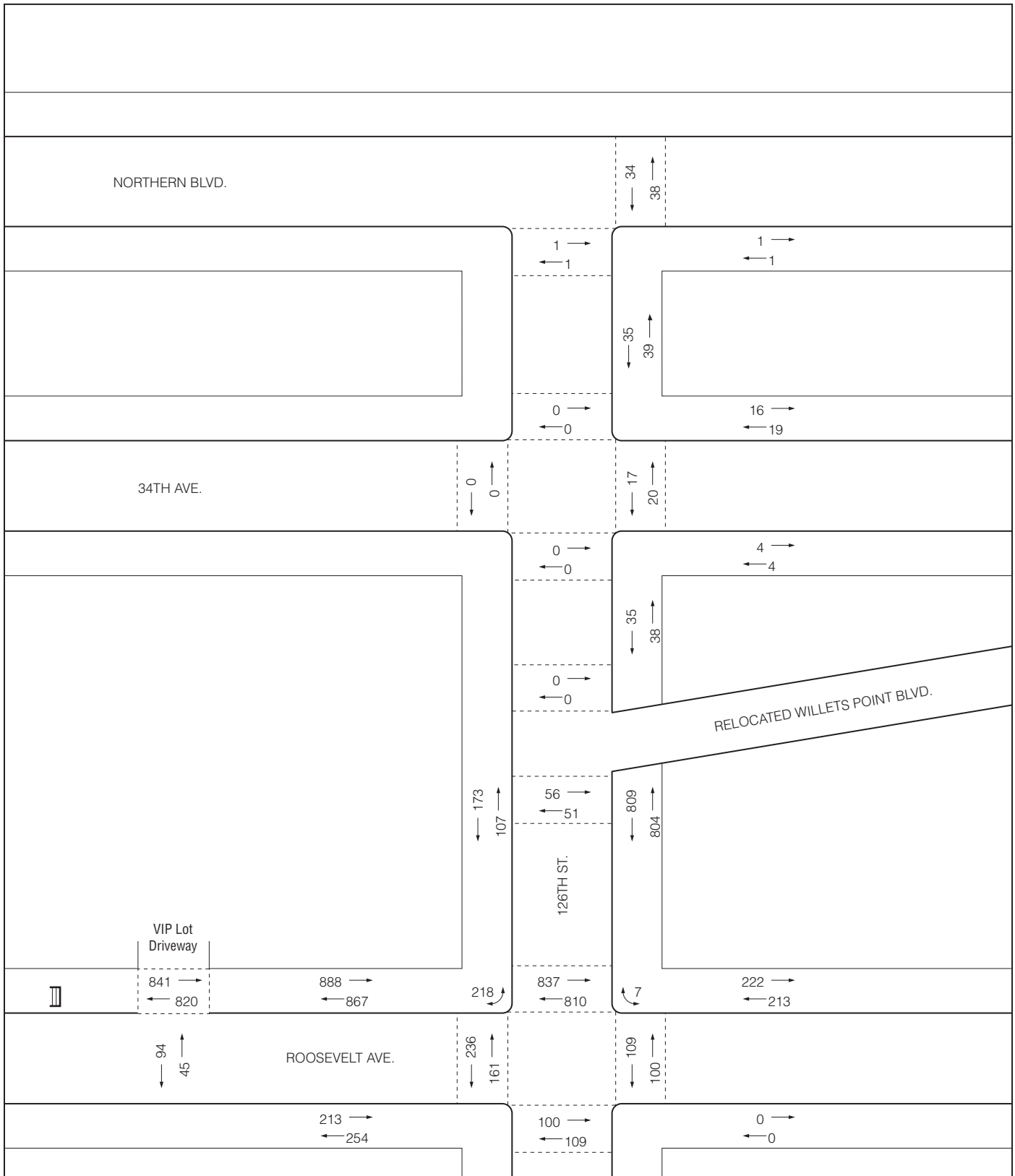

FOR ILLUSTRATIVE PURPOSES

2017 Project-Generated Pedestrian Volumes
 PM Peak 15-Minutes
Figure F-19

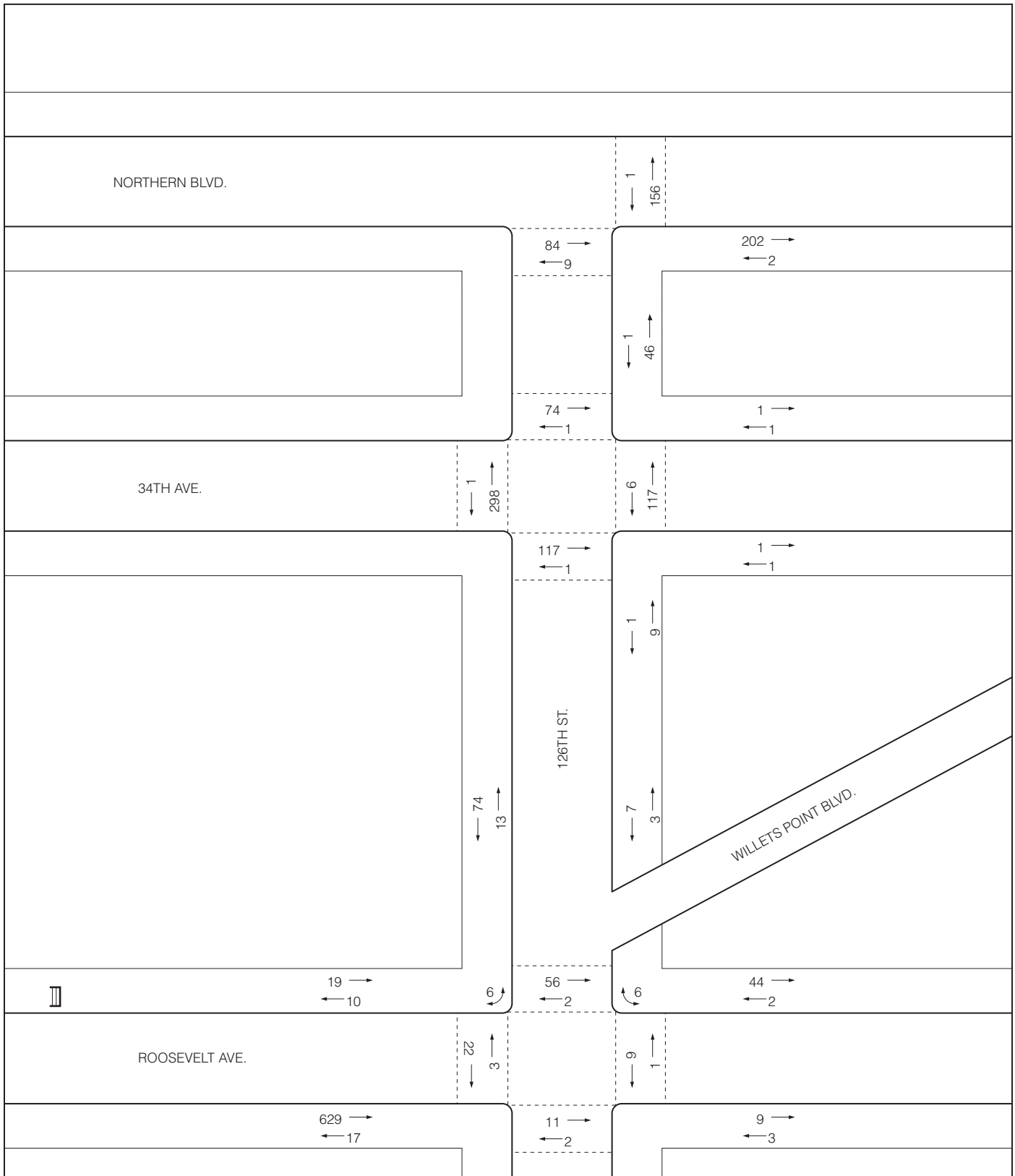

FOR ILLUSTRATIVE PURPOSES

2017 No Build Pedestrian Volumes
SAT Post Game Peak 15-Minutes
Figure F-16

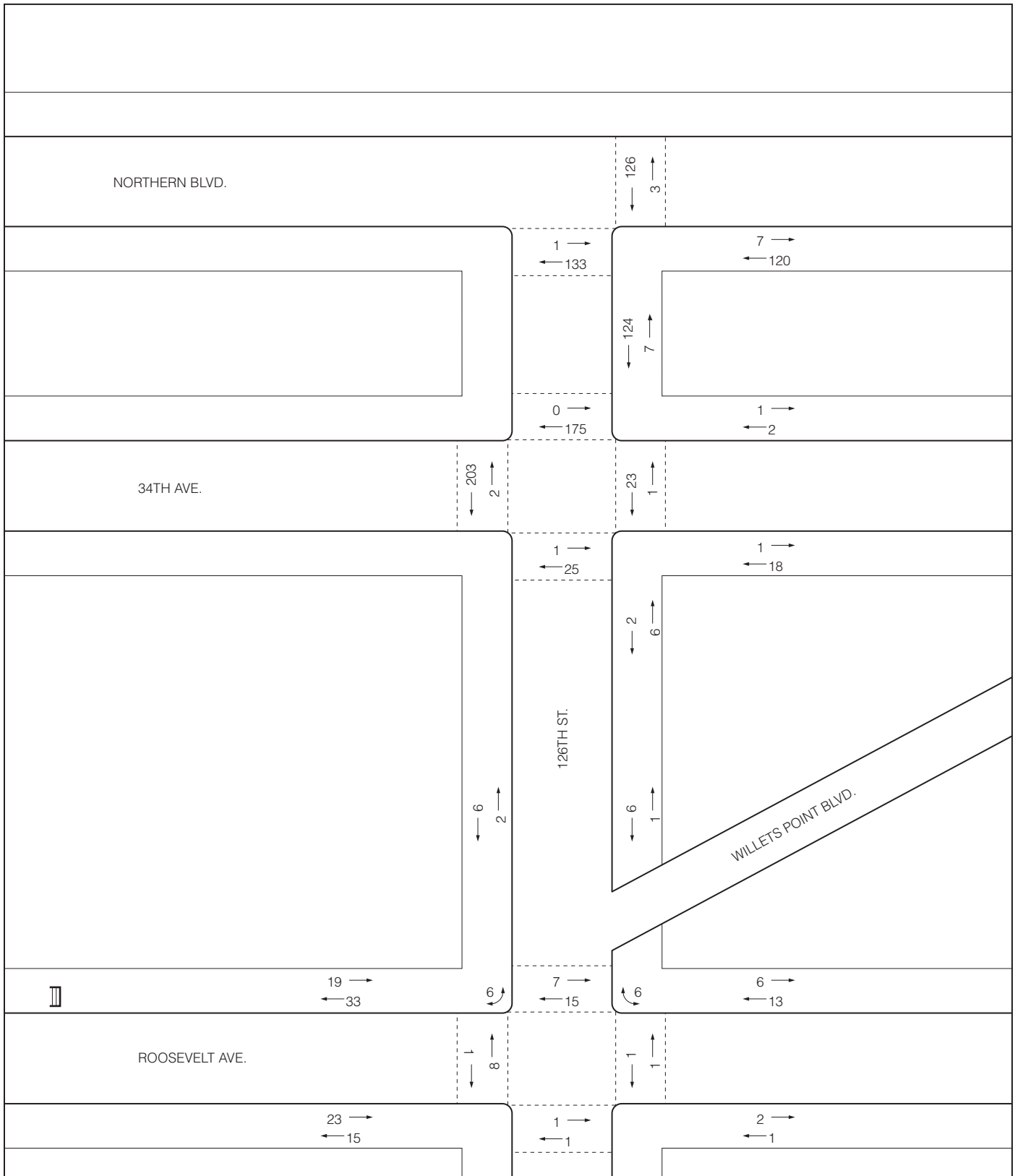

FOR ILLUSTRATIVE PURPOSES

2017 No Build Pedestrian Volumes
SAT Pre-game Peak 15-Minutes
Figure F-15

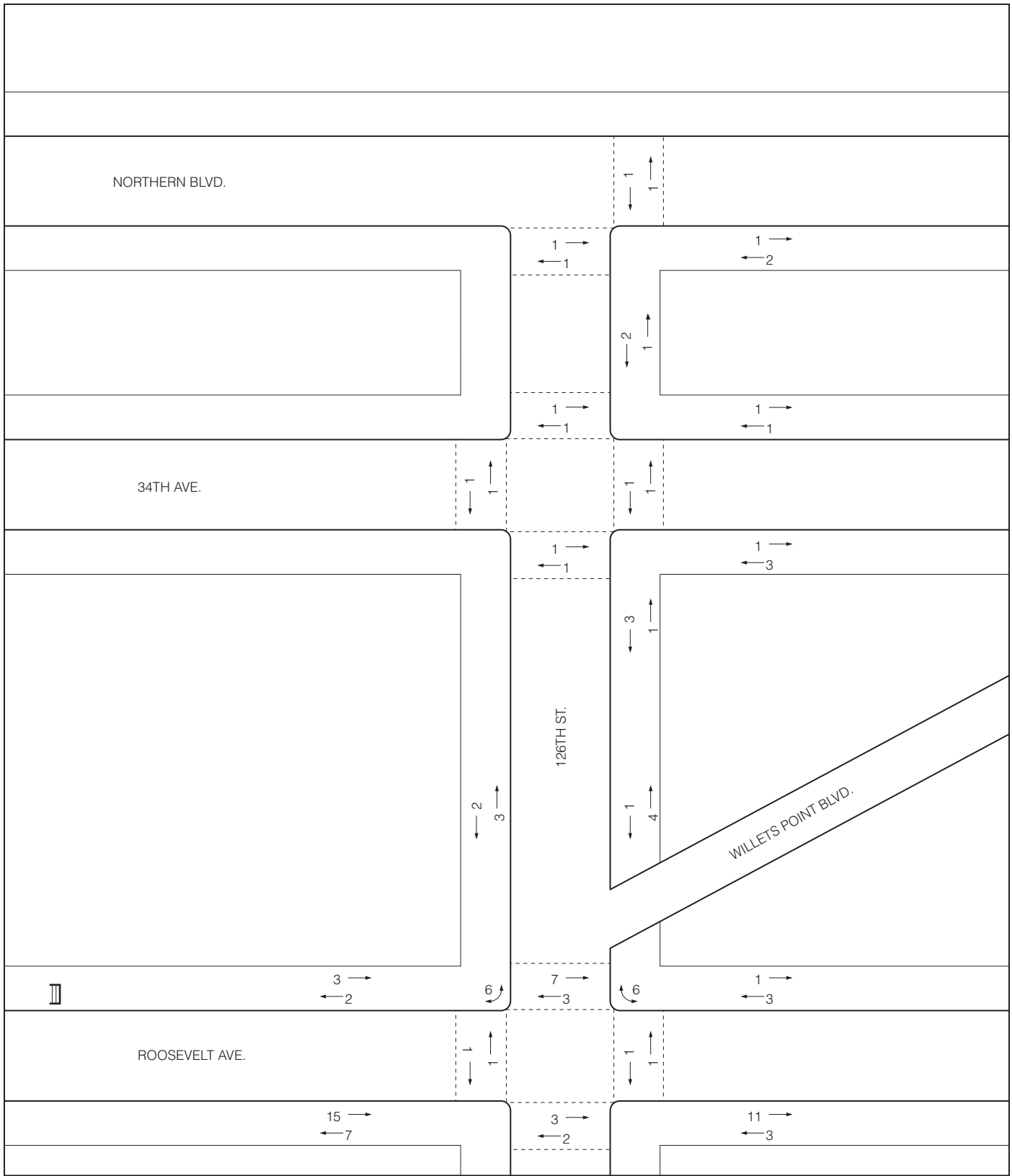

FOR ILLUSTRATIVE PURPOSES

2017 No Build Pedestrian Volumes
SAT MD Peak 15-Minutes

Figure F-14

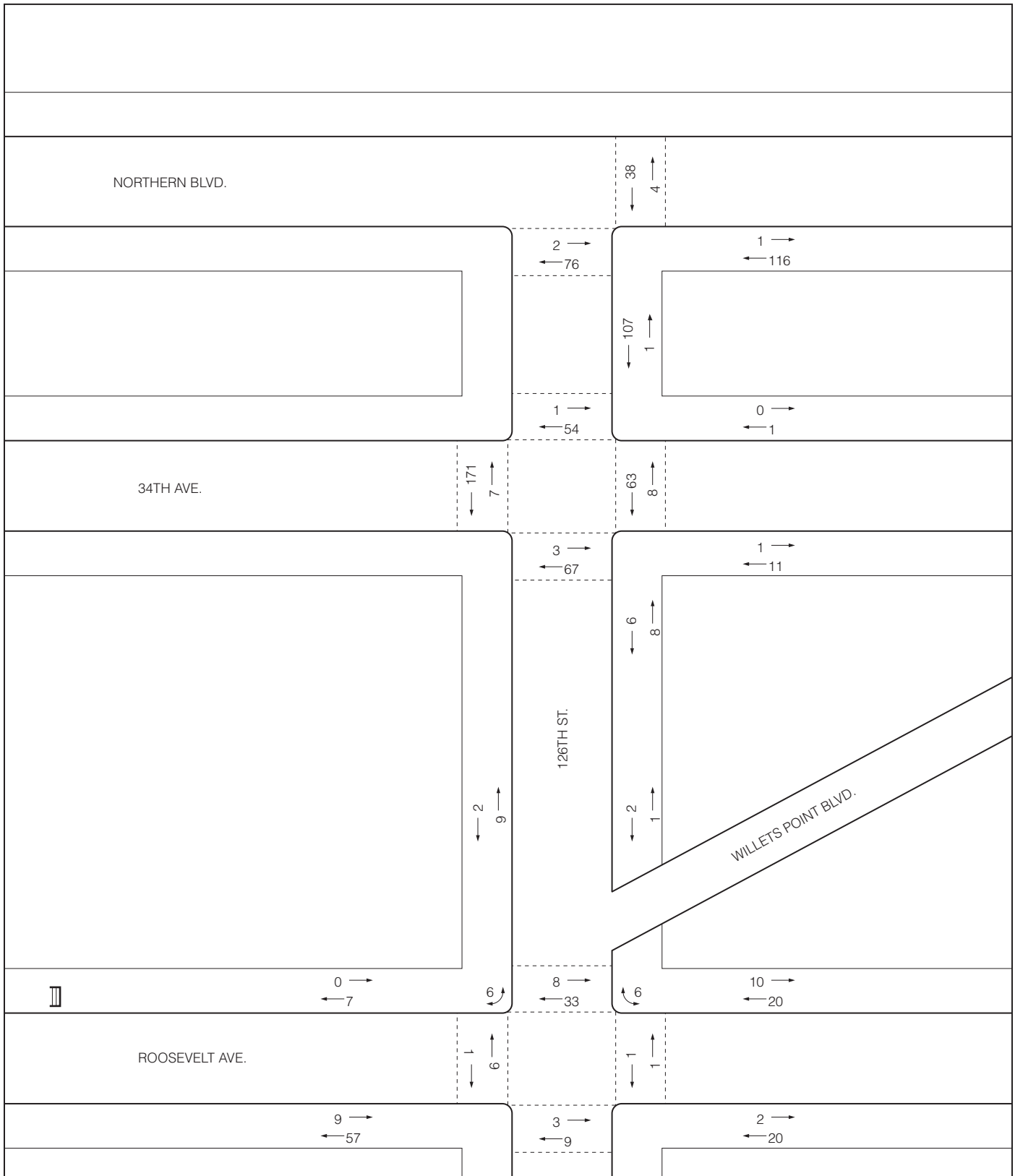

FOR ILLUSTRATIVE PURPOSES

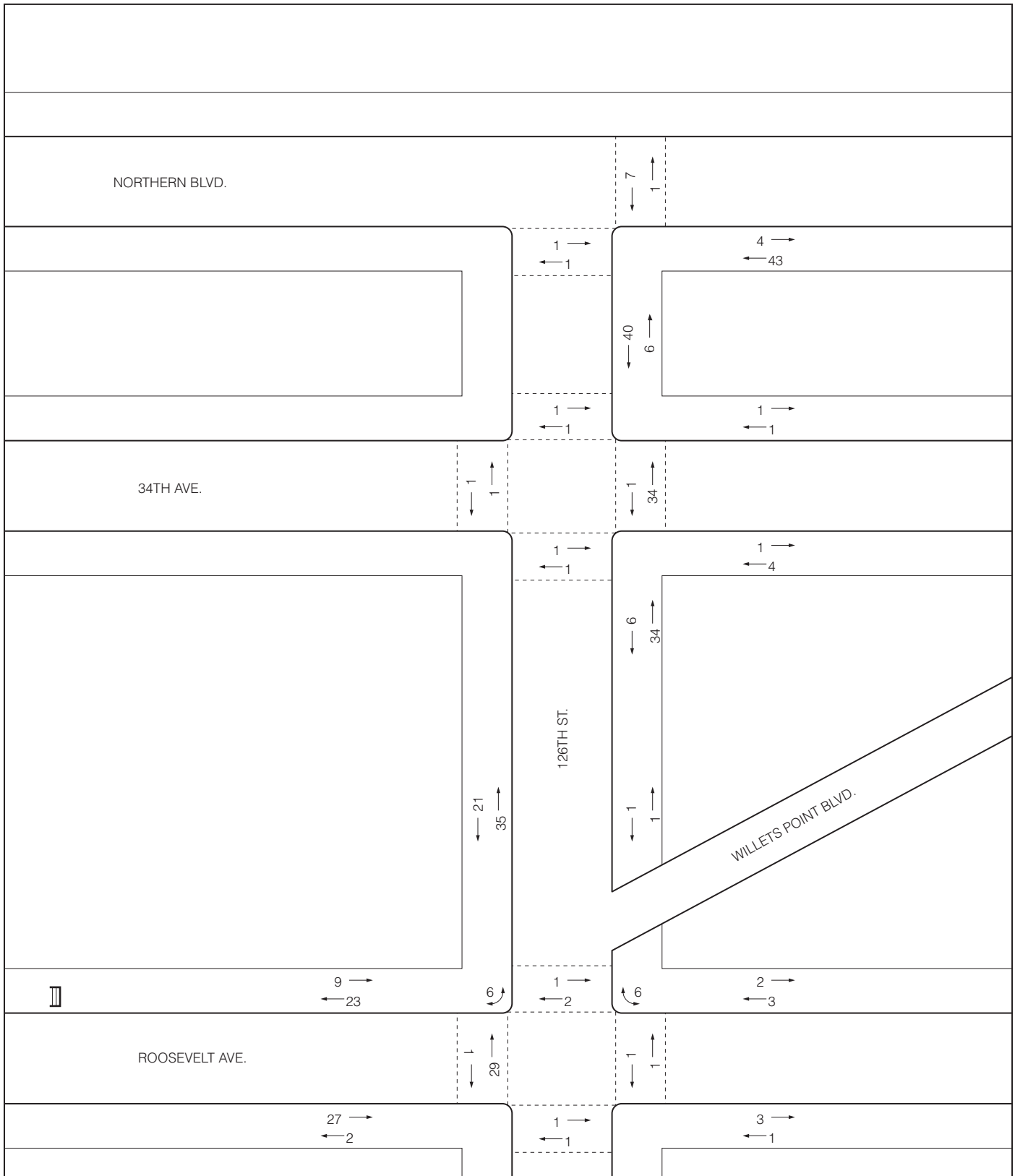

FOR ILLUSTRATIVE PURPOSES

2017 No Build Pedestrian Volumes
 PM Peak 15-Minutes
Figure F-12

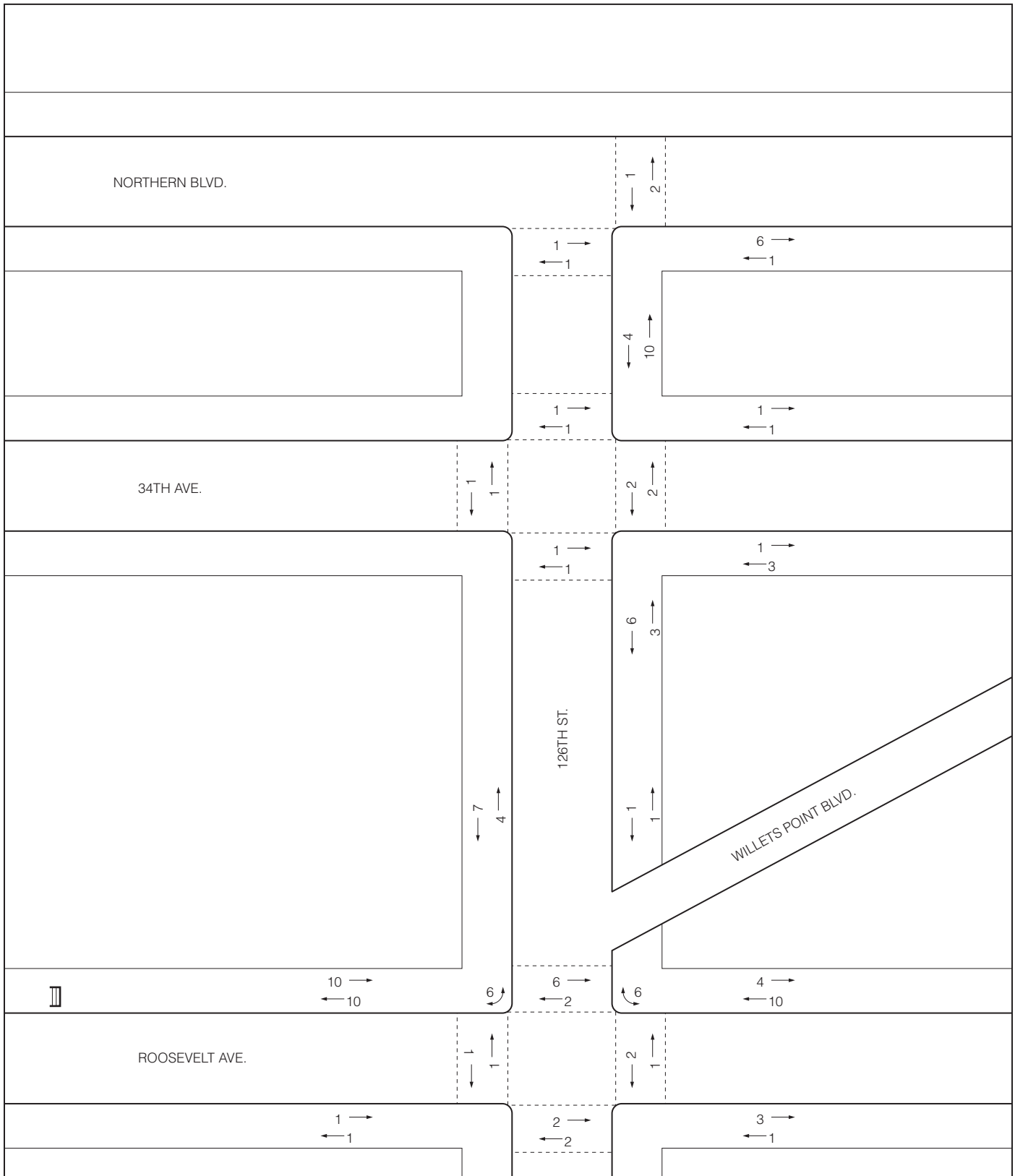

FOR ILLUSTRATIVE PURPOSES

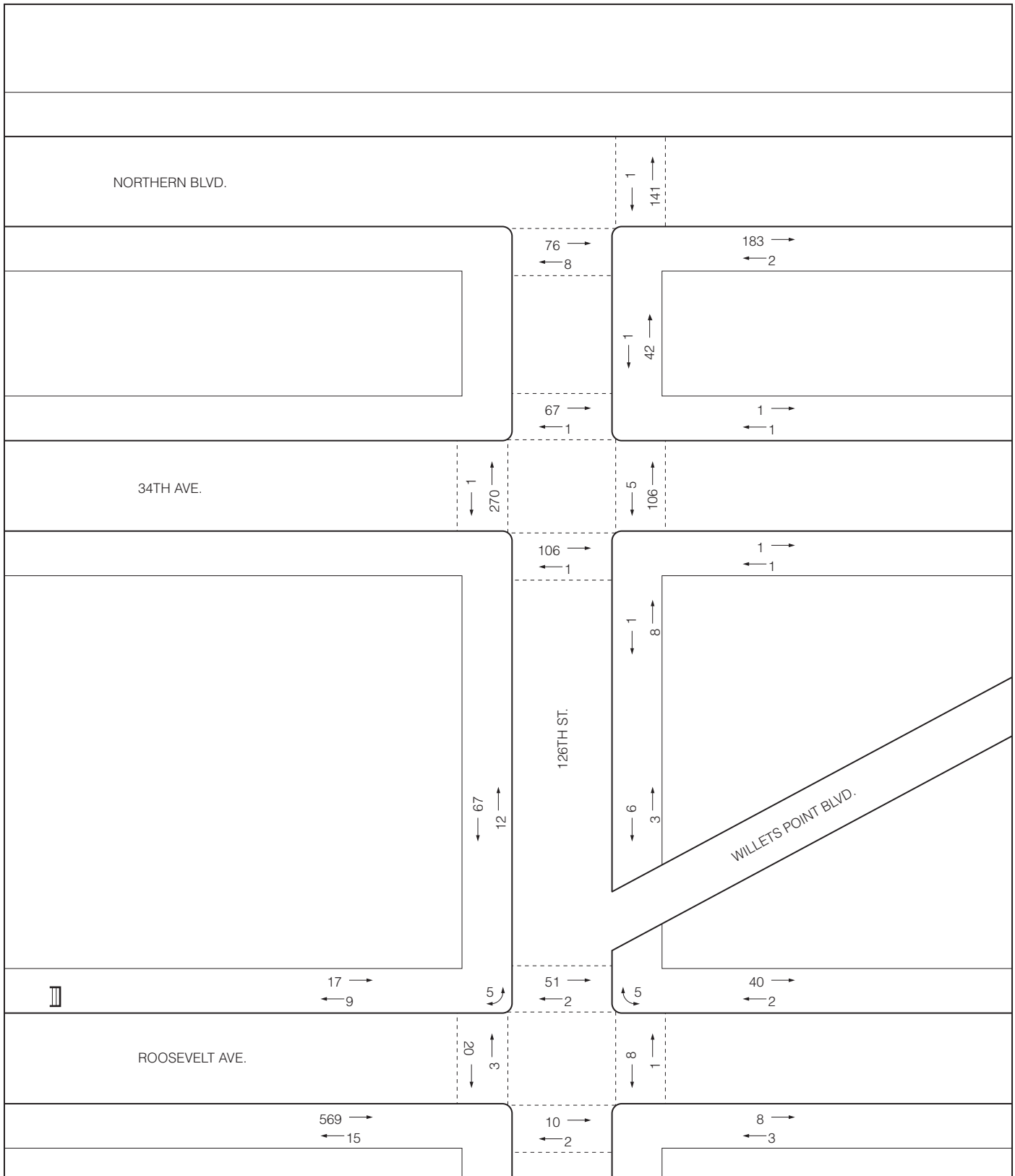

FOR ILLUSTRATIVE PURPOSES

2007 Existing Pedestrian Volumes
SAT Post Game Peak 15-Minutes
Figure F-9

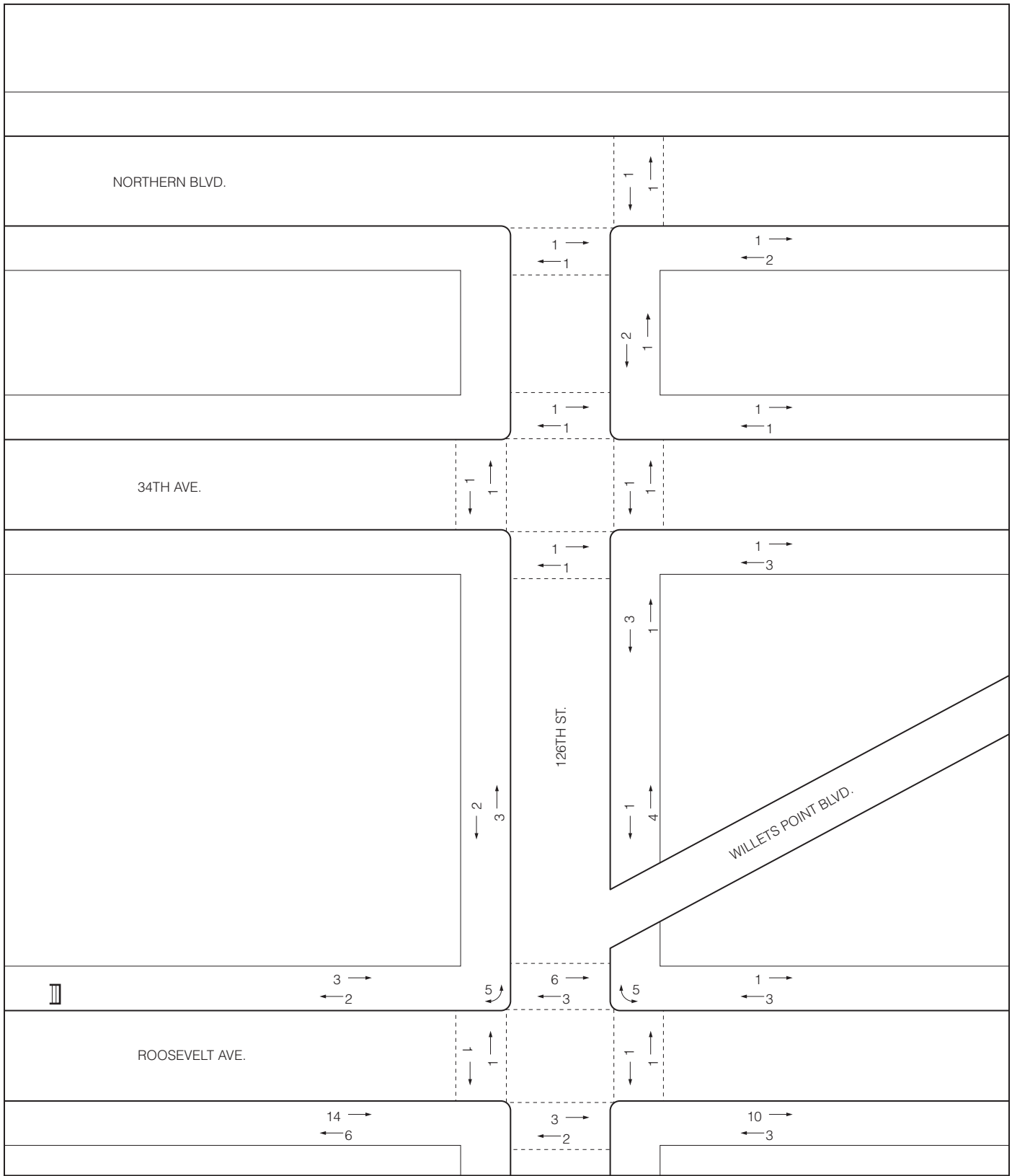

FOR ILLUSTRATIVE PURPOSES

2007 Existing Pedestrian Volumes
SAT MD Peak 15-Minutes
Figure F-7

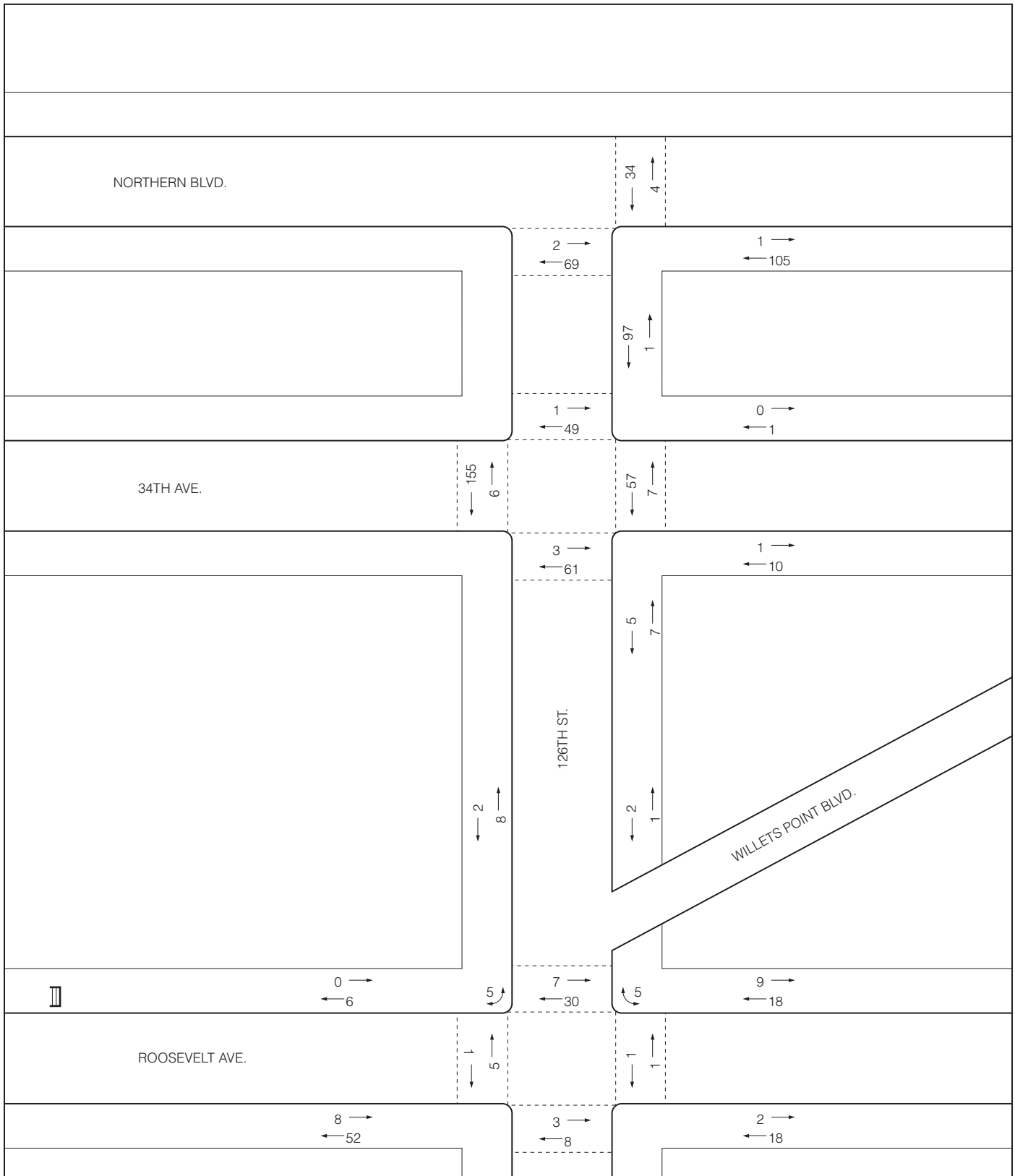

FOR ILLUSTRATIVE PURPOSES

2007 Existing Pedestrian Volumes
 PM Pre-game Peak 15-Minutes
Figure F-6

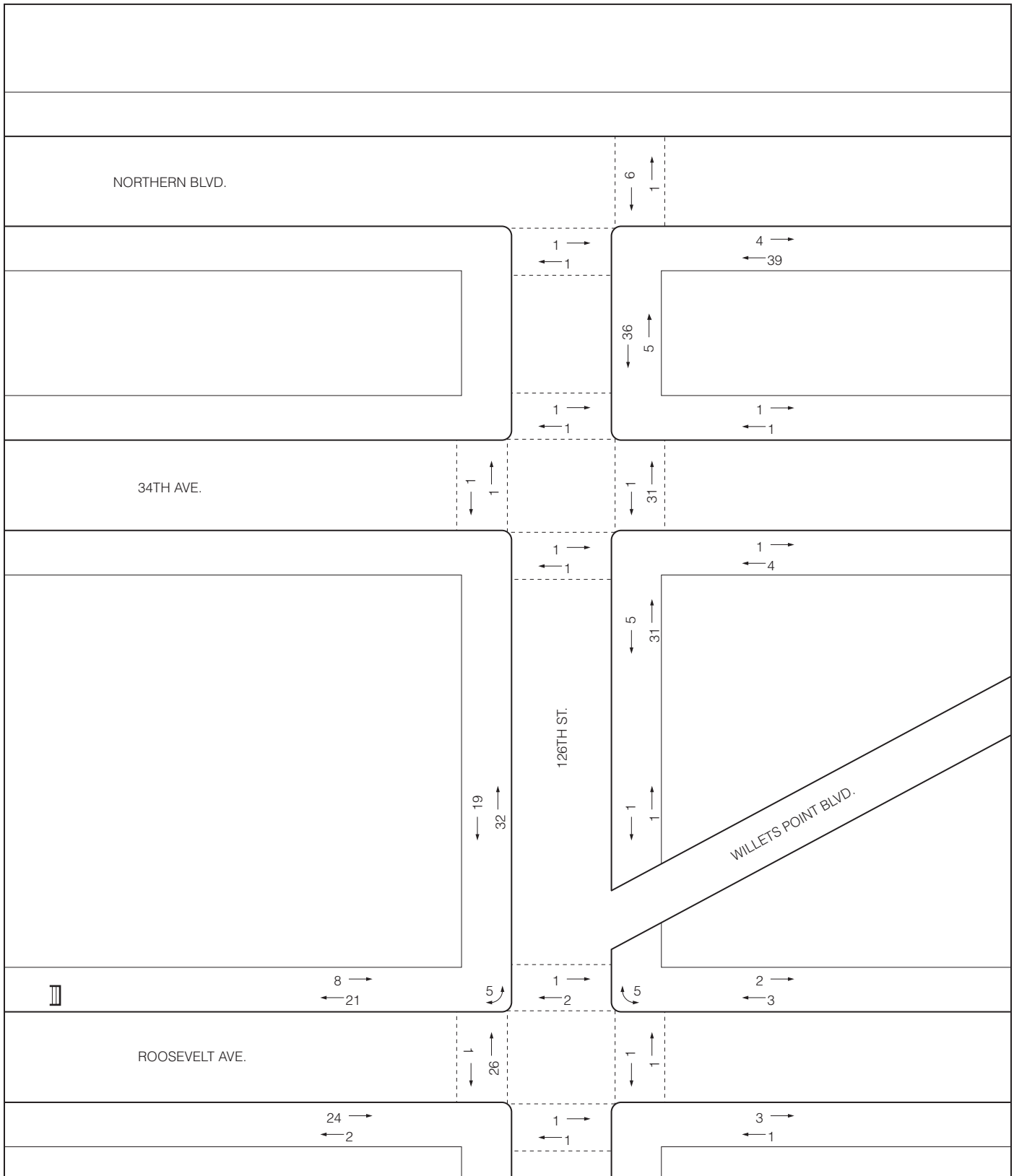

FOR ILLUSTRATIVE PURPOSES

2007 Existing Pedestrian Volumes
PM Peak 15-Minutes
Figure F-5

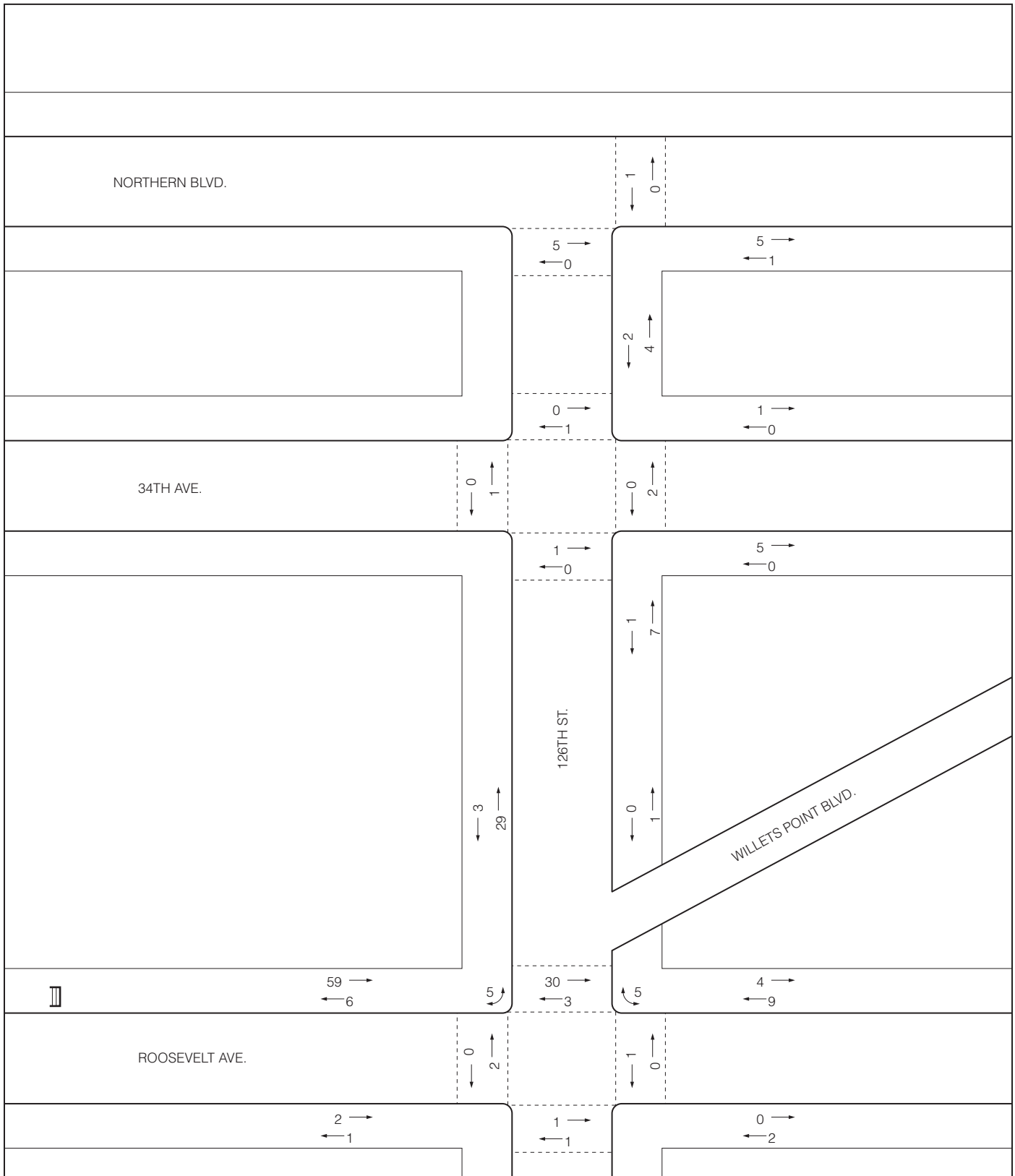

FOR ILLUSTRATIVE PURPOSES

2007 Existing Pedestrian Volumes
AM Peak 15-Minutes
Figure F-3

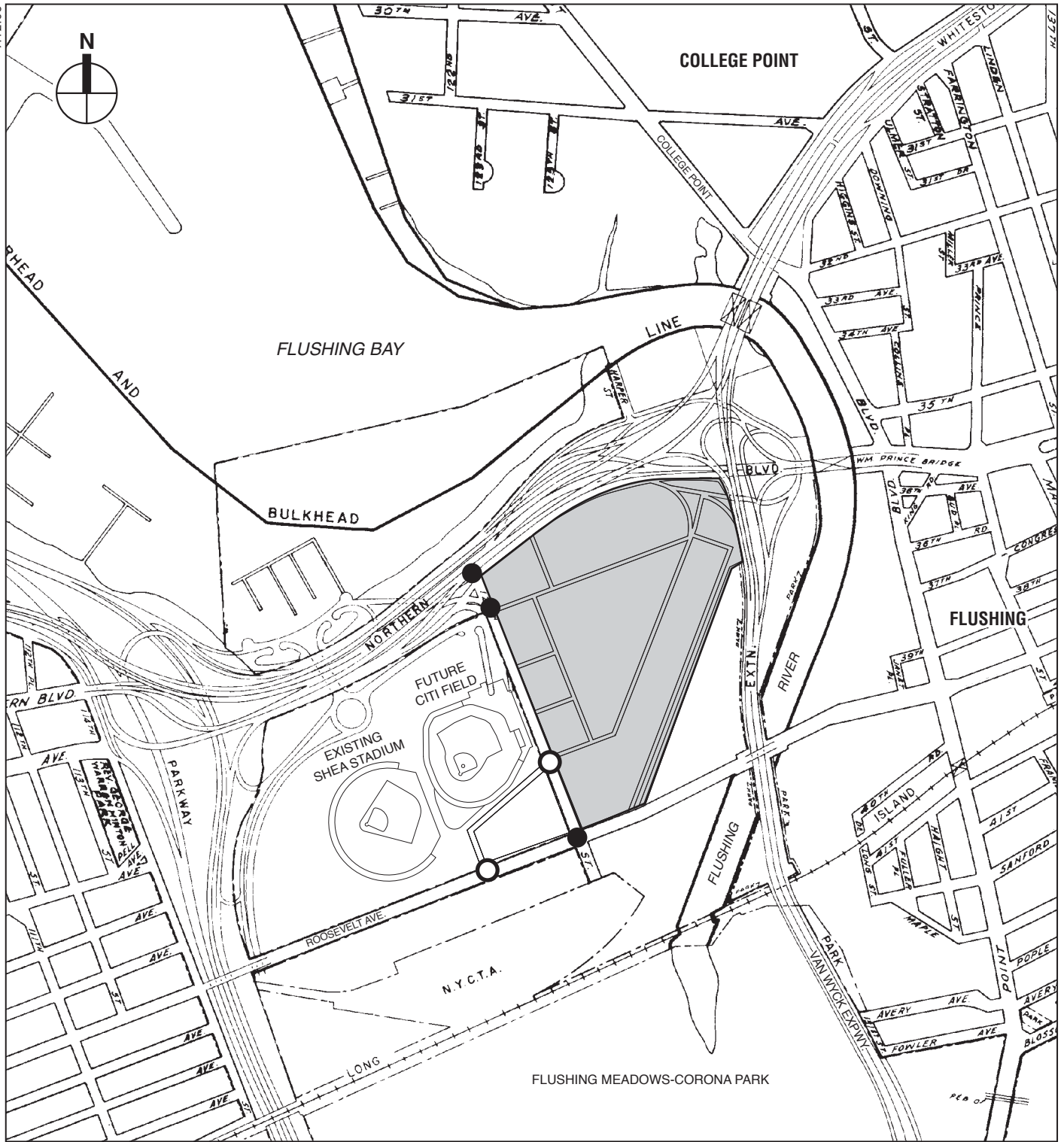

- Willets Point Development District
- Study Area Intersection Analyzed
- Intersection Added as Part of Proposed Plan

0 500 1000 FEET
SCALE

This figure has been updated since the DGEIS