

THE CITY OF NEW YORK
 MANHATTAN COMMUNITY BOARD 3
 59 East 4th Street - New York, NY 10003
 Phone: (212) 533-5300 - Fax: (212) 533-3659
 www.cb3manhattan.org - info@cb3manhattan.org

Gigi Li, Board Chair

Susan Stetzer, District Manager

Community Board 3 Liquor License Application Questionnaire

Please bring the following items to the meeting:

NOTE: ALL ITEMS MUST BE SUBMITTED FOR APPLICATION TO BE CONSIDERED.

- Photographs of the inside and outside of the premise.
- Schematics, floor plans or architectural drawings of the inside of the premise.
- A proposed food and or drink menu.
- Petition in support of proposed business or change in business with signatures from residential tenants at location and in buildings adjacent to, across the street from and behind proposed location. Petition must give proposed hours and method of operation. For example: restaurant, sports bar, combination restaurant/bar. (petition provided)
- Notice of proposed business to block or tenant association if one exists. E-mail the CB3 office at **info@cb3manhattan.org** to find block associations. This must be done promptly so that there is sufficient time to meet with residents if necessary.
- Photographs of proof of conspicuous posting of meeting with newspaper showing date.
- If applicant has been or is licensed anywhere in City, letter from applicable community board indicating history of complaints and other comments.

Check which you are applying for:

- new liquor license alteration of an existing liquor license corporate change

Check if either of these apply:

- sale of assets upgrade (change of class) of an existing liquor license

Today's Date: September 3, 2013

If applying for sale of assets, you must bring letter from current owner confirming that you are buying business or have the seller come with you to the meeting.

Type of license: OP 252 Is location currently licensed? Yes No

If alteration, describe nature of alteration: _____

Previous or current use of the location: Bar/restaurant

Corporation and trade name of current license: Beagle Restaurant Inc. dba The Beagle

APPLICANT:

Premise address: 162 Avenue A, New York, NY 10009

Cross streets: between 10th and 11th Street

Name of applicant and all principals: Flinders Lane LLC

Trade name (DBA): _____

PREMISE:

Type of building and number of floors: 2 story building

Will any outside area or sidewalk cafe be used for the sale or consumption of alcoholic beverages?
(includes roof & yard) Yes No If Yes, describe and show on diagram: _____

Does premise have a valid Certificate of Occupancy and all appropriate permits, including certificate of occupancy for back or side yard intended for commercial use? Yes No (letter of no objection has been obtained)
Indoor Certificate of Occupancy less than 73 Outdoor Certificate of Occupancy _____
(fill in maximum NUMBER of people permitted)

Do you plan to apply for Public Assembly permit? Yes No
Zoning designation (check zoning using map: <http://gis.nyc.gov/doitt/nycitymap/> - please give specific zoning designation, such as R8 or C2):
R7-A, C2-5 overlay

Is this premise wheel chair accessible? Yes No

PROPOSED METHOD OF OPERATION:

What type of establishment will this be (i.e.: restaurant, bar, performance space, club, hotel)?
Restaurant with bar

Will any other business besides food or alcohol service be conducted at premise? Yes No
If yes, please describe what type: _____

What are the proposed days/hours of operation? (Specify days and hours each day and hours of outdoor space)
11 am - 2 am daily

Number of tables? 15 Number of seats at tables? 30

How many stand-up bars/ bar seats are located on the premise? 1 bar
(A **stand up bar** is any bar or counter (whether with seating or not) over which a patron can order, pay for and receive an alcoholic beverage)

Describe all bars (length, shape and location): Approx 12 feet, straight bar, 7 seats

Any food counters? Yes No If Yes, describe: _____

Does premise have a full kitchen Yes No?

Does it have a food preparation area? Yes No (If any, show on diagram)

Is food available for sale? Yes No If yes, describe type of food and submit a menu

Modern Australian

What are the hours kitchen will be open? all hours, until approx 30 min before closing

Will a manager or principal always be on site? Yes No If yes, which? principal

How many employees will there be? approx 15

Do you have or plan to install French doors accordion doors or windows?

Will you agree to close any doors and windows at 10:00 P.M. every night? Yes No

Will there be TVs/monitors? Yes No (If Yes, how many?) _____

Will premise have music? Yes No

If Yes, what type of music? Live musician DJ Juke box Tapes/CDs/iPod

If other type, please describe _____

What will be the music volume? Background (quiet) Entertainment level

Please describe your sound system: Small sound system with speakers connected to Ipod

Will you host promoted events, scheduled performances or any event at which a cover fee is charged? If Yes, what type of events or performances are proposed? NO.

How do you plan to manage vehicular traffic and crowds on the sidewalk caused by your establishment? Please attach plans.

Will there be security personnel? Yes No (If Yes, how many and when) _____

Friday and Saturday nights.

How do you plan to manage noise inside and outside your business so neighbors will not be affected? Please attach plans.

Do you have or plan to install sound-proofing?

APPLICANT HISTORY:

Has this corporation or any principal been licensed previously? Yes No

If yes, please indicate name of establishment: _____

Address: _____ Community Board # _____

Dates of operation: _____

If you answered "Yes" to the above question, please provide a letter from the community board indicating history of complaints or other comments.

Has any principal had work experience similar to the proposed business? Yes No If Yes, please attach explanation of experience or resume.

Does any principal have other businesses in this area? Yes No If Yes, please give trade name and describe type of business _____

Has any principal had SLA reports or action within the past 3 years? Yes No If Yes, attach list of violations and dates of violations and outcomes, if any.

Attach a separate diagram that indicates the location (**name and address**) and total number of establishments selling/serving beer, wine (B/W) or liquor (OP) for 2 blocks in each direction. Please indicate whether establishments have On-Premise (OP) licenses. Please label streets and avenues and identify your location. Use letters to indicate **Bar, Restaurant**, etc. The diagram must be submitted with the questionnaire to the Community Board before the meeting.

LOCATION:

How many licensed establishments are within 1 block? 3

How many licensed establishments are within 500 feet? 7

Is premise within a 500 foot radius of 3 or more establishments with OP licenses? Yes No

How many On-Premise (OP) liquor licenses are within 500 feet? 6

Is premise within 200 feet of any school or place of worship? Yes No

If there is a school or place of worship within 200 feet of your premise on the same block, submit a block plot diagram or area map showing its location in proximity to your premise and indicate the distance and name and address of the school or house of worship.

COMMUNITY OUTREACH:

If there are block associations or tenant associations in the immediate vicinity of your location, you must contact them. Contact the CB 3 office at info@cb3manhattan.org to find block and tenant associations. **Please attach proof (copies of letters or email and poster) that you have advised these groups of your application with sufficient time for them to respond to your notice.**

Please use provided petitions, which clearly state the name, address, license for which you are applying, and the hours and method of operation of your establishment at the top of each page. (Attach additional sheets of paper as necessary).

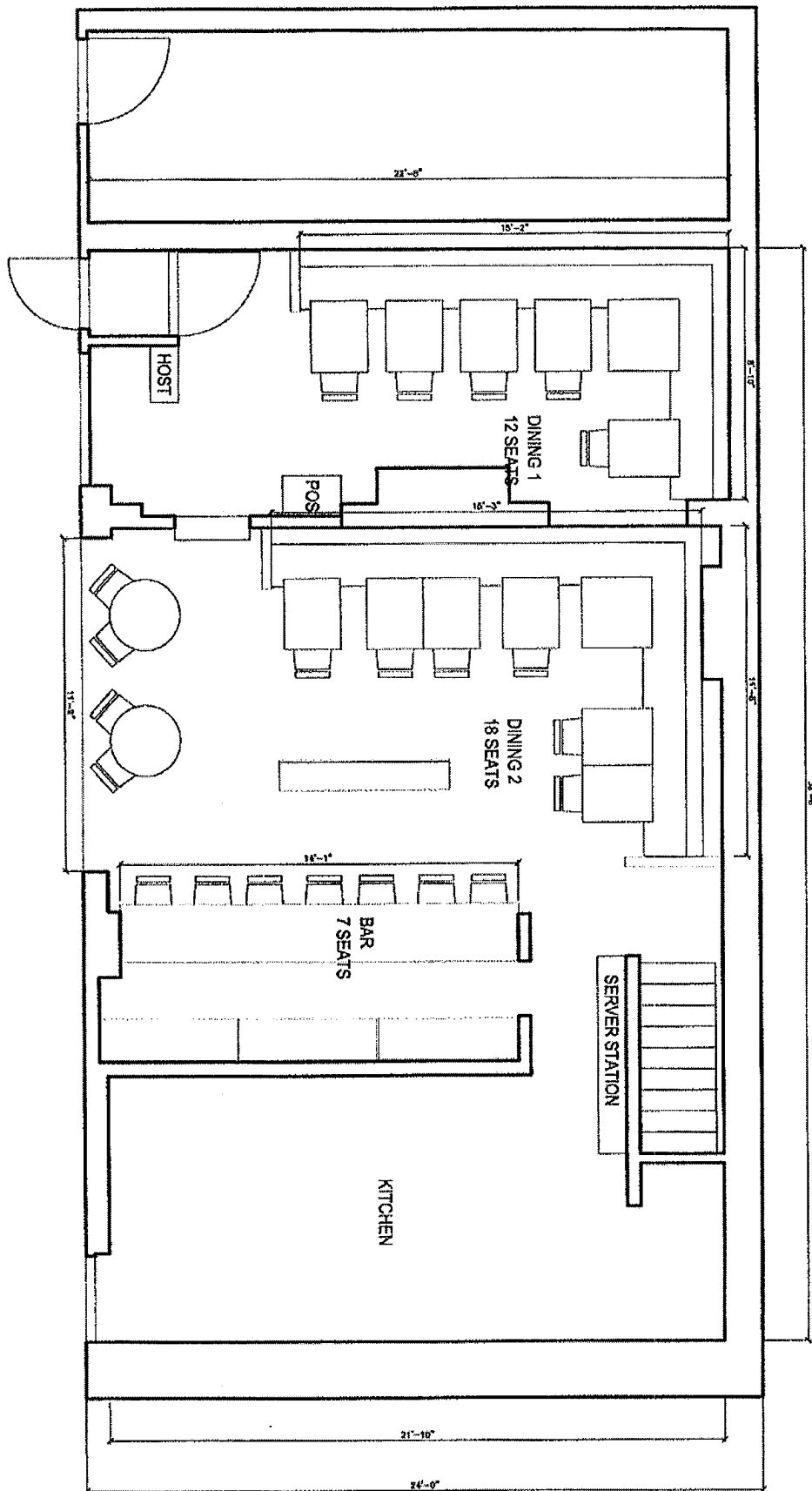

Proximity Report for Location:

September 3, 2013

162 AVE A, New York, 10009

* This report is for informational purposes only in aid of identifying establishments potentially subject to 500 and 200 foot rules. Distances are approximated using industry standard GIS techniques and do not reflect actual distances between points of entry. The NYS Liquor Authority makes no representation as to the accuracy of the information and disclaims any liability for errors.

Closest Liquor Stores

Name	Address	Approx. Distance
WINESHOP LLC	438 A E 9TH ST	365 ft
AVENUE A WINES INC	196 AVENUE A	505 ft
FUNG SING INC	138 1ST AVENUE	865 ft
BEE LIQUORS LLC	225 AVENUE B	1065 ft
CARMAD INC	224 226 1ST AVE	1090 ft
BRIX NYC LLC	649 E 9TH STREET, EAST STORE	1145 ft
SAKAYA INC	324 E 9TH STREET (WEST STORE)	1310 ft

Churches within 500 Feet

Name	Approx. Distance
Saint Mark's Memorial Chapel	335 ft

Schools within 500 Feet

Name	Address	Approx. Distance
------	---------	------------------

On-Premise Licenses within 750 Feet

Name	Address	Approx. Distance
BEAGLE RESTAURANT INC	162 AVENUE A	20 ft
PATTY MC CARTHYS INC	169 AVENUE A	55 ft
510 EAST 11TH STREET CORP	510 E 11TH STREET	175 ft
LOCO 151 INC	151 AVENUE A	225 ft
WISHBONE PRODUCTIONS INC	141 AVENUE A	375 ft
CALAB LLC	503 505 E 12TH STREET	455 ft
MONOLITH INC	194 AVE A	470 ft
LUDWIKA MICKEVICIUS	135 AVE A	490 ft
ALOUETTE CORPORATION	131 AVENUE A	565 ft
CHARLEY GROUP LLC	339 E 10TH STREET	635 ft
DBW RESTAURANT ASSOCIATES LLC	206 AVE A	660 ft
168 FIRST AVE RESTAURANT LTD	168 1ST AVENUE	685 ft
LM UNITED LLC	166 1ST AVENUE	685 ft
ARIEL INC	506 E 13TH ST STORES 2 & 3	700 ft
PEACE & LOVE HOSPITALITY INC	211 AVENUE A	710 ft
FRIDA & DIEGO CORP	211 AVENUE A	710 ft
TOZZER LTD	112 AVENUE A	715 ft

Name	Address	Approx. Distance
OOPS OF NEW YORK INC	168 AVENUE B	715 ft
LA RITT INC	162 164 AVENUE B	715 ft
STEELBAR 180 INCORPORATED	210 212 AVE A AKA 503 E 13TH S	715 ft
LO ENG INC	212 AVENUE A	715 ft
119 AVENUE A RESTAURANT CORP	119 AVENUE A	715 ft
CRAFTY NUANCE GROUP LLC	125 129 ST MARKS PL	715 ft
JCDC LLC	163 1ST AVENUE	725 ft
NEW STATFORD RESTAURANT INC	121 ST MARKS PLACE	730 ft
FAT PANDA INC	219 AVENUE A NORTH	735 ft
HORSEBOX INC	218 AVENUE A	735 ft
BUA NEW YORK LLC	122 SAINT MARKS PLACE	740 ft
ODESSA RESTAURANT INC	117 AVENUE A	745 ft

Pending Licenses within 750 Feet

Name	Address	Approx. Distance
7 ELEVEN INC	170 AVENUE A	105 ft
B FOSTER RESTAURANT LLC	500 E 11TH STREET	150 ft
186 A ENTERPRISES INC	186 AVENUE A	355 ft
AVE A HOSPITALITY LLC	200 AVENUE A	565 ft
YOSHI NEW YORK INC	131 AVENUE A	565 ft
PARLOR RESTAURANT LLC	166 1ST AVE	705 ft
EV CAFE LLC	155 AVENUE B	745 ft

Unmapped licenses within zipcode of report location

Name	Address
------	---------



Flinders

By the Glass

Sparkling (150ml)

Barocco Prosecco, NY+V	Veneto, Italy	9
Janz Premium Cuvee NV	Pipers River, Tasmania	14
Agrapart Terroirs Blanc de Blancs Extra Brut NV	Avize, Champagne	25

Apertif (75ml)

Bodegas Hildalgo Fino	Jerez, Spain	10
Pennyweight Woody's Amontillado	Beechworth, Victoria	12
Si Chinchecle, flor 2012 - Semillon	Margaret River, West Aust.	12

White by the glass

Domaine de l'Ecu Muscadet Sevre et Maine Orthogneiss, 2012	Muscadet, Loire	13
Hewitson 'lu lu' Sauvignon Blanc, 2011	Adelaide Hills, Sth. Aust	8
Audry Wilkinson Semillon, 2012	Hunter, NSW	12
Giant Steps Chardonnay, 2010	Yarra, Victoria	13
Mac Forbes Riesling RS20, 2012	Yarra, Victoria	9
Francois Chidaine Montlouis Tuffeaux [demi-sec], 2011	Vouvray, Loire	12

Rosé by the glass

The Headonist, 2012	McLaren Vale, Sth. Aust	10
Chateau Pibarnon, 2012	Bandol, Provence	15

Red by the glass

Kooyong 'Meres' Pinot Noir, 2005	Mornington Peninsula, Victoria	12
Marcel Lapiere 'Raisins Gaulois' 2010	Morgon, Beaujolais	9
Massena Primitivo, 2012	Barossa, Sth. Australia	12
Kir-Yanni 'Ramnista' Xinomavro, 2012	Naoussa, Greece	12
Box Head Cabernet Sauvignon, 2011	McLaren Vale, Sth. Aust	10
Bedell Cellars Cabernet Franc, 2010	North Fork, Long Island	12

Fizz - Champagne and Sparkling

Janz Premium Cuvée, NV	Pipers River, Tasmania	52
Argyle Brut, 2006	Willamette, Oregon	72
Larmandier-Bernier 'Latitude' Blanc de Blancs, NV	Vertus, Champagne	98

Fresh, Vital, Energetic

Domaine Sigalas Assyrtiko, 2011	Santorini, Aegean Islands	62
Franck Peillot Roussette du Bugey Altesse, 2010	Montagnieu, Jura	48
Vignai da Doline, Friulano, 2010	Friuli, Italy	52
Ryme 'Hers' Vermentino, 2012	Sonoma, California	65
Jolie Laide Pinot Gris, 2012	Sonoma, California	45
Patrick Piuze 'Terroir de Courgis' 2012	Chablis, Burgundy	70
Pierre Morey Aligote, 2010	Bourgogne Aligote, Burgundy	33
Telmo Rodriguez 'Basa', 2012	Reuda, Castilla y Leon	35
Eyrie Pinot Gris, 2011	Willamette, Oregon	49
Skuttlebutt Semillon Sauvignon Blanc, 2012	Margaret River, West Aust.	35
Weinbach Clos des Capucins, Pinot Blanc, 2012	Alsace, France	51
Mac Forbes RS 16 Riesling, 2012	Port Phillip, Victoria	60
Grosset 'Springvale' Riesling, 2012	Clare Valley, Sth. Aust.	72
Grosset 'Polish Hill' Riesling, 2012	Clare Valley, Sth. Aust.	85
Alkoomi Riesling, 2012	Frankland River, West Aust	35
Frankland Estate 'Isolation Ridge'	Frankland River, West Aust	75
Glaetzer-Dixon 'Überblanc' Riesling	Tasmania, Aust.	60
Clos des Rochers, Pinot Gris, 2010	Grevenmacher Luxembourg	71
Domaine Fournier 'Cuvée Silex', 2012	Sancerre, Loire	78
Nikolaihof 'Hefeabzug', Grüner Veltliner, 2012	Wachau, Austria	75

Fragrant, Textured, Harmonious

Verdad Albariño, 2011	Santa Barbara, California	55
Hexamer Riesling Kabinett, 2009	Nahé, Germany	68
Millton 'Te Arai Vineyard' Chenin Blanc, 2009	Gisborne, New Zealand	51
Dexter Chardonay, 2011	Mornington Peninsula, Victoria	75
Happs Semillon, 2010	Margaret River, West Aust.	35
Iconic Wines 'Heroine' Chardonay, 2011	Napa, California	88
Domaine Huet Clos du Bourg, 2011	Vouvray, Loire,	57
Alvaro Palacios 'As Sortes' Godello, 2010	Valdeorras, Spain	85
François Cazin 'Cuvee Renaissance' 2003	Cour-Cheverny, Loire	74
Bellivière, 'Prémises', Chenin Blanc, 2011	Jasniers, Loire	73
Ben Haines Single Vineyard Roussanne, 2012	Yarra, Victoria	65
Tim Smith Viognier, 2012	Adelaide Hills, Sth. Aust	55
Weinbach Cuvée Saint Catherine Pinot Gris	Alsace, France	95

Red Wines

Light, Fragrant, Floral

Mac Forbes 'Woori Yallock' Pinot Noir, 2009	Yarra Valley, Victoria	75
Route du Van Dolcetto Shiraz, 2011	Alpine Valleys, Victoria	35
Terres Dorées Moulin-a-vent, 2010	Beaujolais, France	60
Domaine de la Tournelle Ploussard de Monteiller, 2012	Jura, France	65
Moorooduc Estate Pinot Noir	Mornington Peninsula, Victoria	65
Kooyong 'Massale' Pinot Noir	Mornington Peninsula, Victoria	65
Joseph Swan Pinot Noir, 2010	Russian River, Sonoma	70
Innocent Bystander Pinot Noir, 2011	Yarra Valley, Victoria	45
Jamsheed 'Bealesville Vineyard' Syrah, 2010	Yarra Valley, Victoria	90
Jamsheed 'Beachworth' 2011	Beachworth, Victoria	90
Cos 'Nero di Lupo' Nero d'Avola, 2011	Sicily, Italy	69
Dominique Gallois Gevrey-Chambertain, 2010	Côtes de Nuits, Burgundy	95
Antica Terra Pinot Noir, 2010	Willamette, Oregon	98

Intense, Vigorous, Graceful

Château Musar, 2000	Bekaa Valley, Lebanon	112
Ben Haines Marsanne Shiraz, 2012	Yarra Valley, Victoria	45
Mount Langi Ghiran 'Billie Billie' Shiraz, 2011	Grampians, Victoria	39
Balgownie Shiraz, 2006	Bendigo, Victoria	35
Descendientes de Jose Palacios 'Petalos', 2010	Bierzo, Spain	85
Massena Primitivo, 2010	Barossa, Sth Aust.	51
Clonakilla 'Hilltops' Shiraz, 2008	Canberra, New South Wales	55
Yarra Yering 'Dry Red No. 1', 2006	Yarra Valley, Victoria	135

Mineral, Earthy, Natural

Frank Cornelissen Rosso del 'Munjabel 7' NV	Btina, Italy	95
Philippe Alliet 'L'Huissierie', 2012	Chinon, Loire	72
d'Ameillaud Cairanne	Côtes du Rhône, Rhône	55
Briseau 'Patapon', 2011	Coteaux du Loire Loire	65