

Gigi Li, Board Chair

Susan Stetzer, District Manager

Community Board 3 Liquor License Application Questionnaire

Please bring the following items to the meeting:

NOTE: ALL ITEMS MUST BE SUBMITTED FOR APPLICATION TO BE CONSIDERED.

- Photographs of the inside and outside of the premise.
- Schematics, floor plans or architectural drawings of the inside of the premise.
- A proposed food and or drink menu.
- Petition in support of proposed business or change in business with signatures from residential tenants at location and in buildings adjacent to, across the street from and behind your proposed location. Petition must give proposed hours and method of operation. For example: restaurant, sports bar, combination restaurant/bar. (petition provided)
- Letter of notice of proposed business to block or tenant association if one exists. E-mail the CB3 office at info@cb3manhattan.org for help to find block associations.
- Photographs of proof of conspicuous posting of meeting with newspaper showing date.
- If applicant has been or is licensed anywhere in City, letter from applicable community board indicating history of complaints and other comments.

Check which you are applying for:

- new liquor license alteration of an existing liquor license corporate change

Check if either of these apply:

- sale of assets upgrade (change of class) of an existing liquor license

Today's Date: April 27, 2013

If applying for sale of assets, you must bring letter from current owner confirming that you are buying business or have the seller come with you to the meeting.

Type of license: OP Is location currently licensed? Yes No

If alteration, describe nature of alteration: _____

Previous or current use of the location: Chinese noodle wholesale store

Corporation and trade name of current license: _____

APPLICANT:

Premise address: 22 Orchard St.

Cross streets: Hester St & Canal St.

Name of applicant and all principals: Jonathan Wu & Wilson Tang

Trade name (DBA): Fung Tu, LLC

PREMISE:

Type of building and number of floors: Mixed: Commercial/Residential, 5 floors

Will any outside area or sidewalk cafe be used for the sale or consumption of alcoholic beverages?
(includes roof & yard) Yes No If Yes, describe and show on diagram: _____

Does premise have a valid Certificate of Occupancy and all appropriate permits, including certificate of occupancy for back or side yard intended for commercial use? Yes No

Indoor Certificate of Occupancy 74 Outdoor Certificate of Occupancy N/A
(fill in maximum NUMBER of people permitted)

Do you plan to apply for Public Assembly permit? Yes No

Zoning designation (check zoning using map: <http://gis.nyc.gov/doitt/nycitymap/> - please give specific zoning designation, such as R8 or C2):

C6-2

Is this premise wheel chair accessible? Yes No

PROPOSED METHOD OF OPERATION:

What type of establishment will this be (i.e.: restaurant, bar, performance space, club, hotel)?

Restaurant

Will any other business besides food or alcohol service be conducted at premise? Yes No

If yes, please describe what type: _____

What are the proposed days/hours of operation? (Specify days and hours each day and hours of outdoor space) Open 7 days, 10am to 2am

Number of tables? 10-12 Number of seats at tables? 34

How many stand-up bars/ bar seats are located on the premise? 6

(A **stand up bar** is any bar or counter (whether with seating or not) over which a patron can order, pay for and receive an alcoholic beverage)

Describe all bars (length, shape and location): 9 feet long, L-shaped at front of store

Any food counters? Yes No If Yes, describe: _____

Does premise have a full kitchen Yes No?

Does it have a food preparation area? Yes No (If any, show on diagram)

Is food available for sale? Yes No If yes, describe type of food and submit a menu

Creative Chinese food

What are the hours kitchen will be open? 10am to 2am

Will a manager or principal always be on site? Yes No If yes, which? Jonathan Wu/John Wells

How many employees will there be? 10

Do you have or plan to install French doors accordion doors or windows?

Will you agree to close any doors and windows at 10:00 P.M. every night? Yes No

Will there be TVs/monitors? Yes No (If Yes, how many?) _____

Will premise have music? Yes No

If Yes, what type of music? Live musician DJ juke box Tapes/CDs/iPod

If other type, please describe _____

What will be the music volume? Background (quiet) Entertainment level

Please describe your sound system: iPod and small speakers

Will you host promoted events, scheduled performances or any event at which a cover fee is charged? If Yes, what type of events or performances are proposed? No

How do you plan to manage vehicular traffic and crowds on the sidewalk caused by your establishment? Please attach plans.

Will there be security personnel? Yes No (If Yes, how many and when) _____

How do you plan to manage noise inside and outside your business so neighbors will not be affected? Please attach plans.

Do you have or plan to install sound-proofing?

We have installed sound-proofing: insulation, green glue, and extra gypsum.

APPLICANT HISTORY:

Has this corporation or any principal been licensed previously? Yes No

If yes, please indicate name of establishment: Nom Wah Tea Parlor

Address: 13 Doyers St., NY, NY 10013 Community Board # 3

Dates of operation: 7 days

If you answered "Yes" to the above question, please provide a letter from the community board indicating history of complaints or other comments.

Has any principal had work experience similar to the proposed business? Yes No If Yes, please attach explanation of experience or resume.

Does any principal have other businesses in this area? Yes No If Yes, please give trade name and describe type of business Nom Wah Tea Parlor

Has any principal had SLA reports or action within the past 3 years? Yes No If Yes, attach list of violations and dates of violations and outcomes, if any.

Attach a separate diagram that indicates the location (**name and address**) and total number of establishments selling/serving beer, wine (B/W) or liquor (OP) for 2 blocks in each direction. Please indicate whether establishments have On-Premise (OP) licenses. Please label streets and avenues and identify your location. Use letters to indicate **Bar, Restaurant**, etc. The diagram must be submitted with the questionnaire to the Community Board before the meeting.

LOCATION:

How many licensed establishments are within 1 block? 3

How many licensed establishments are within 500 feet? 3

Is premise within a 500 foot radius of 3 or more establishments with OP licenses? Yes No

How many On-Premise (OP) liquor licenses are within 500 feet? 2

Is premise within 200 feet of any school or place of worship? Yes No

If there is a school or place of worship within 200 feet of your premise on the same block, submit a block plot diagram or area map showing its location in proximity to your premise and indicate the distance and name and address of the school or house of worship.

COMMUNITY OUTREACH:

If there are block associations or tenant associations in the immediate vicinity of your location, you must contact them. **Please attach proof (copies of letters and poster) that you have advised these groups of your application with sufficient time for them to respond to your notice.** You may contact the Community Board at info@cb3manhattan.org for any contact information.

Please use provided petitions, which clearly state the name, address, license for which you are applying, and the hours and method of operation of your establishment at the top of each page. (Attach additional sheets of paper as necessary).

LIQUOR PERMIT AREA SURVEY

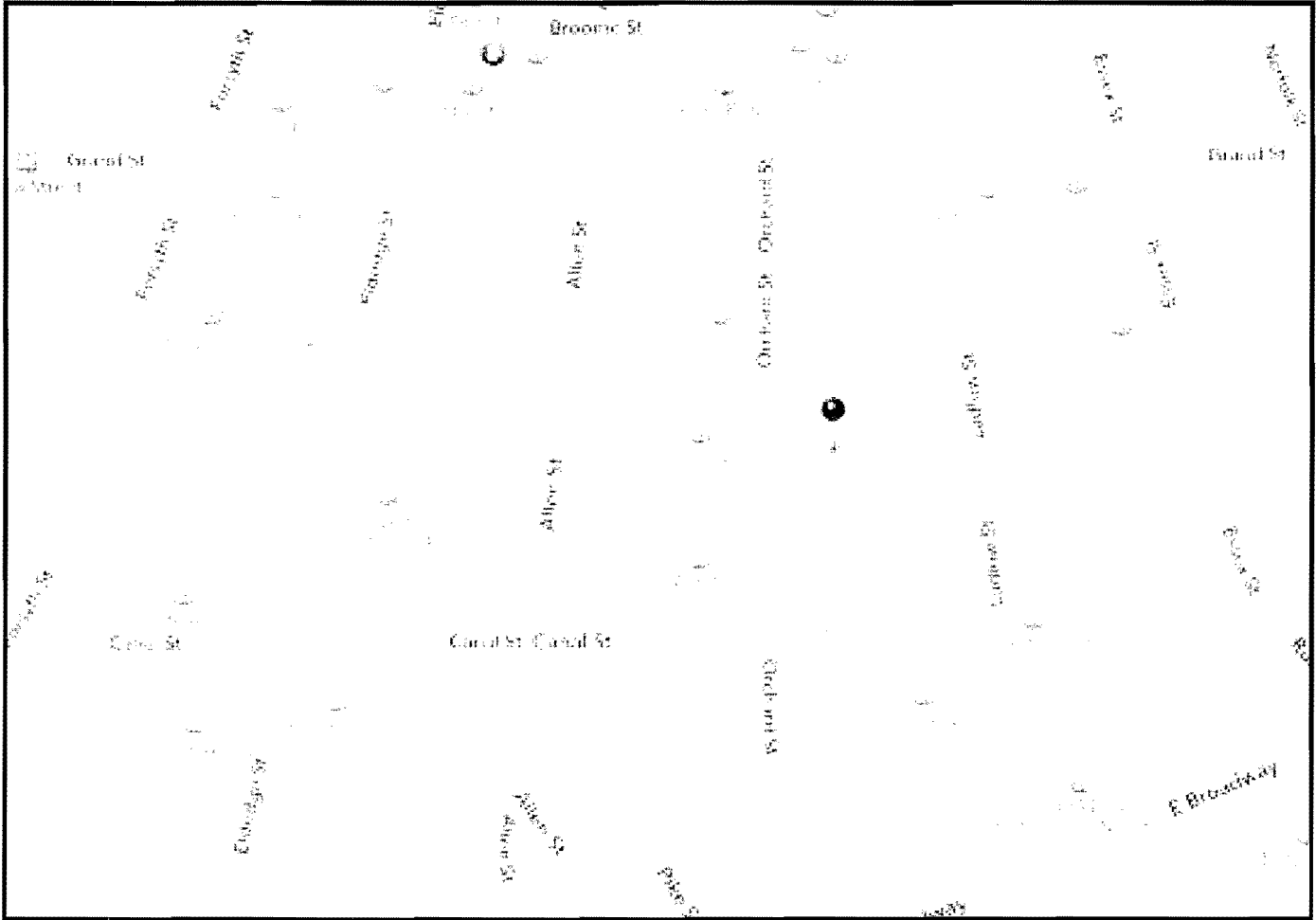

CLOSEST LIQUOR STORES

YEE FUNG CORP 135 DIVISION ST 380 ft
 DELANCEY WINE INC 41 ESSEX ST 680 ft
 R & S 49 LIQUOR CORP 49 CHRYSTIE ST 960 ft
 MADISON LIQUOR INC 195 MADISON ST 1065 ft
 WING TAK LIQUOR INC 101 ALLEN STREET STORE B 1240 ft
 SEWARD PARK LIQUORS INC 393 GRAND STREET 1330 ft
 JADE FOUNTAIN LIQUOR CORP 123 DELANCEY STREET 1480 ft

CHURCHES WITHIN 500 Feet

NONE

SCHOOLS WITHIN 500 Feet

PS 42 BENJAMIN ALTMAN SCHOOL 71 HESTER ST 170 ft
 IS 131 DR. SUN YAT SEN SCHOOL 100 HESTER ST 455 ft

ON-PREMISES LICENSES WITHIN 750 Feet

SWEET RANGER INC 14B ORCHARD ST 95 ft
 SILKSTONEONE LLC 17 ORCHARD STREET 135 ft
 SWAT PRODUCTION INC 59 CANAL ST 2ND FL 200 ft
 ZVAH INC 37 CANAL STREET 300 ft
 BACARO NYC INC 136 138 DIVISION STREET 340 ft
 35 CANAL CAFE LLC 35 CANAL STREET 350 ft
 PLAN A GROUP LLC 138 DIVISION ST 360 ft
 OTFOTEOC LTD 21 ESSEX ST 470 ft
 ESSEX CAFE GROUP LLC 21 ESSEX ST 490 ft
 SAMOND INC 39 ELDRIDGE STREET 3RD FL 500 ft
 CAFE 169 INC 169 E BROADWAY 690 ft
 JOCKEY HOLLOW LLC 171 E BROADWAY 720 ft

PENDING LICENSES within 750 Feet

MARIO SAN INCORPORATED 36 LUDLOW ST 380 ft
 SUNRISE RESTAURANT 88 INC 50 ELDRIDGE ST 460 ft
 HIGHLINE DELI II CORP 83 CANAL ST 505 ft

UNMAPPED LICENSES WITHIN ZIPCODE OF REPORT

X
1/8" = 1'-0"

PRELIMINARY PLANS
22 ORCHARD
FUNG TU

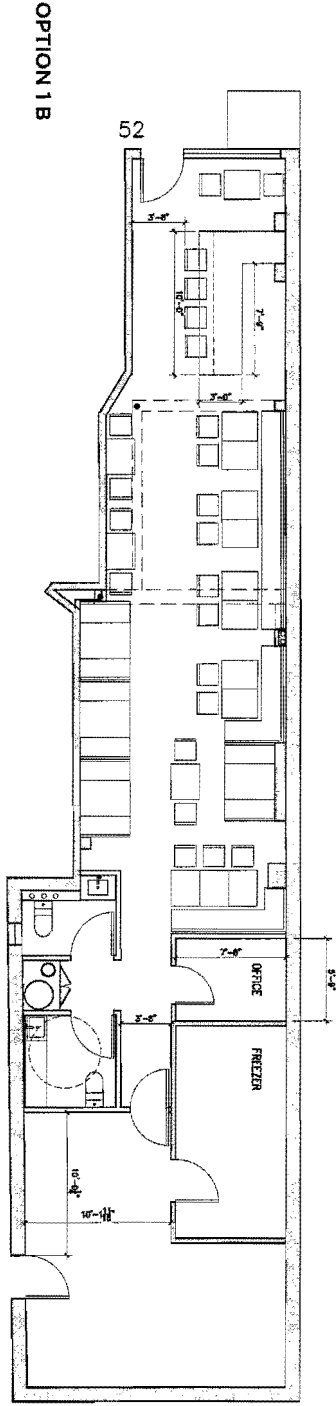
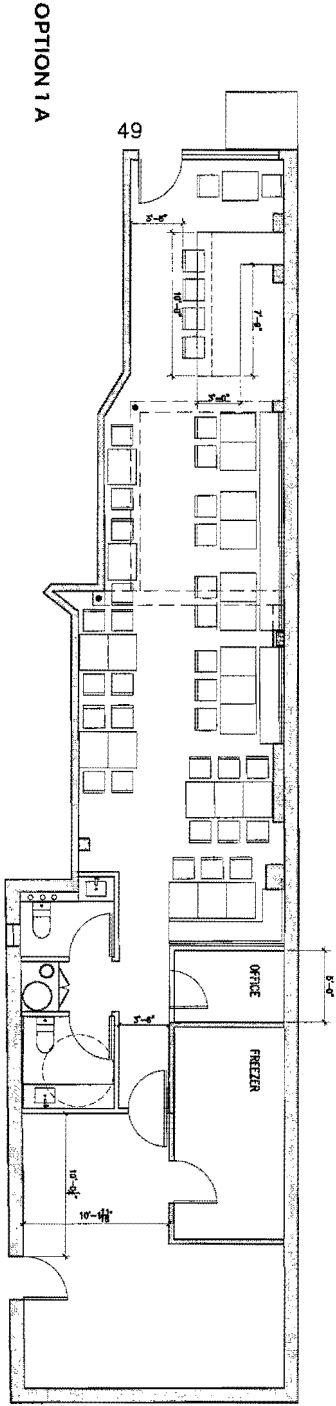

Fung Tu Menu

Small

- 5 The Original Egg Roll, Version 2
- 12 Chinese Sashimi with Wilted Bean Shoots
- 7 Bok Choy with House-made Shrimp Paste
- 7 Wrapped Heart Mustard Cabbage in Cultured Soymilk Dressing
- 9 Stir Fried Celtuce with Scrambled Salted Egg
- 11 Coriander Salad with Smoked Chicken, Pressed Bean Curd, and Toasted Cashews
- 7 Roasted Beets with Century Egg, Garlic Chives, and Aged Bean Curd Shards
- 7 Fava Curd with Salted Egg Yolk and Kale Paste
- 13 Aged Bean Curd Kisses in Ham Broth
- 10 Soymilk-Fish Custard with Beef Floss and Chinese Laver
- 9 Smoked Mussels in Scallion Oil
- 5 Parker House Steamed Buns
- 7 Scallion Pancakes with Spreadable Lap Cheong and Salted Cabbage

Large

- 14 Wheat Noodles with Pumpkin Seed Sauce, Winter Squash, and Chili Oil
- 13 Dumpling Knots with Tingling Ground Pork Sauce
- 13 Rice Middlin Rice Porridge with Salted Kale, Black Egg, and Braised Beef
- 15 Yellow Curl Stir Fry with Squid, Salted Pork, and Black Vinegar
- 27 Platter of Pork Skin-Pork Chops with Mustardy Cabbage
- MP Whole Steamed Fish with Fennel and Tangerine Peel, Chili, and Fermented Black Beans