

32nd Ave at Bowne Park

Pedestrian Safety Improvements



Background

- Request from CM Paul Vallone and the community to improve pedestrian access to Bowne Park
- Traffic controls denied along 32nd Ave in 2016
- 3 speed bumps installed on 32nd Ave between 155th and 159th Streets in July 2016

Location

- Adjacent to Bowne Park



Before Conditions: 32nd Ave at Bowne Park

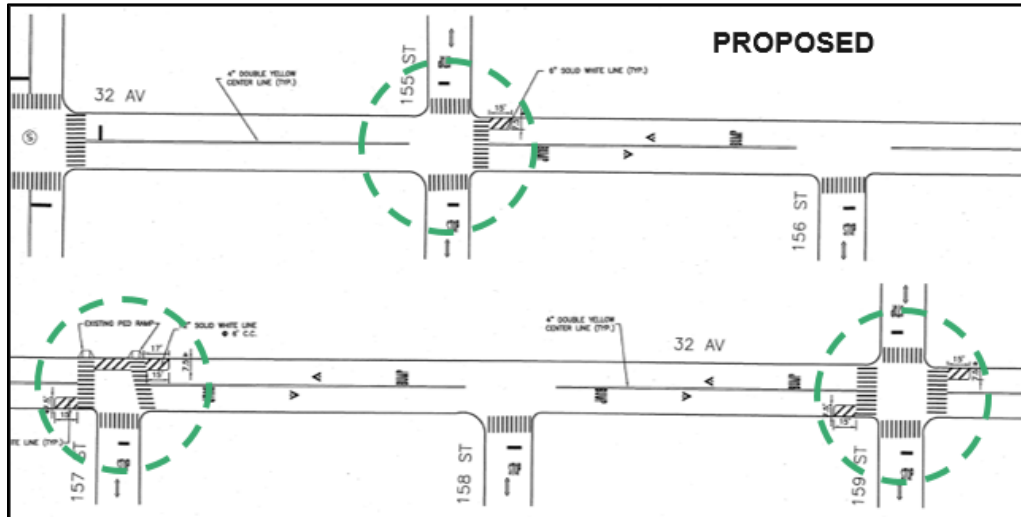

Improvements

- Enhanced crossings on 32nd Ave at 155th St, 157th St and 159th

Benefits

- Safer Pedestrian Crossings