



BOND ST

Bicycle Route Connection

Presented to Brooklyn Community Board 2, Transportation Committee
January 19, 2017

1. Background
2. Proposal
3. Summary

Background

1

BICYCLE NETWORK

Proposed Project Limits:

- DeKalb Av: Flatbush Av – Fulton St
- Bond St: Fulton St – Schermerhorn St

No bike route connection to Downtown Brooklyn

Bond Street bicycle route was established in 2014 and upgrade through 2016 between 3rd Av and Schermerhorn St

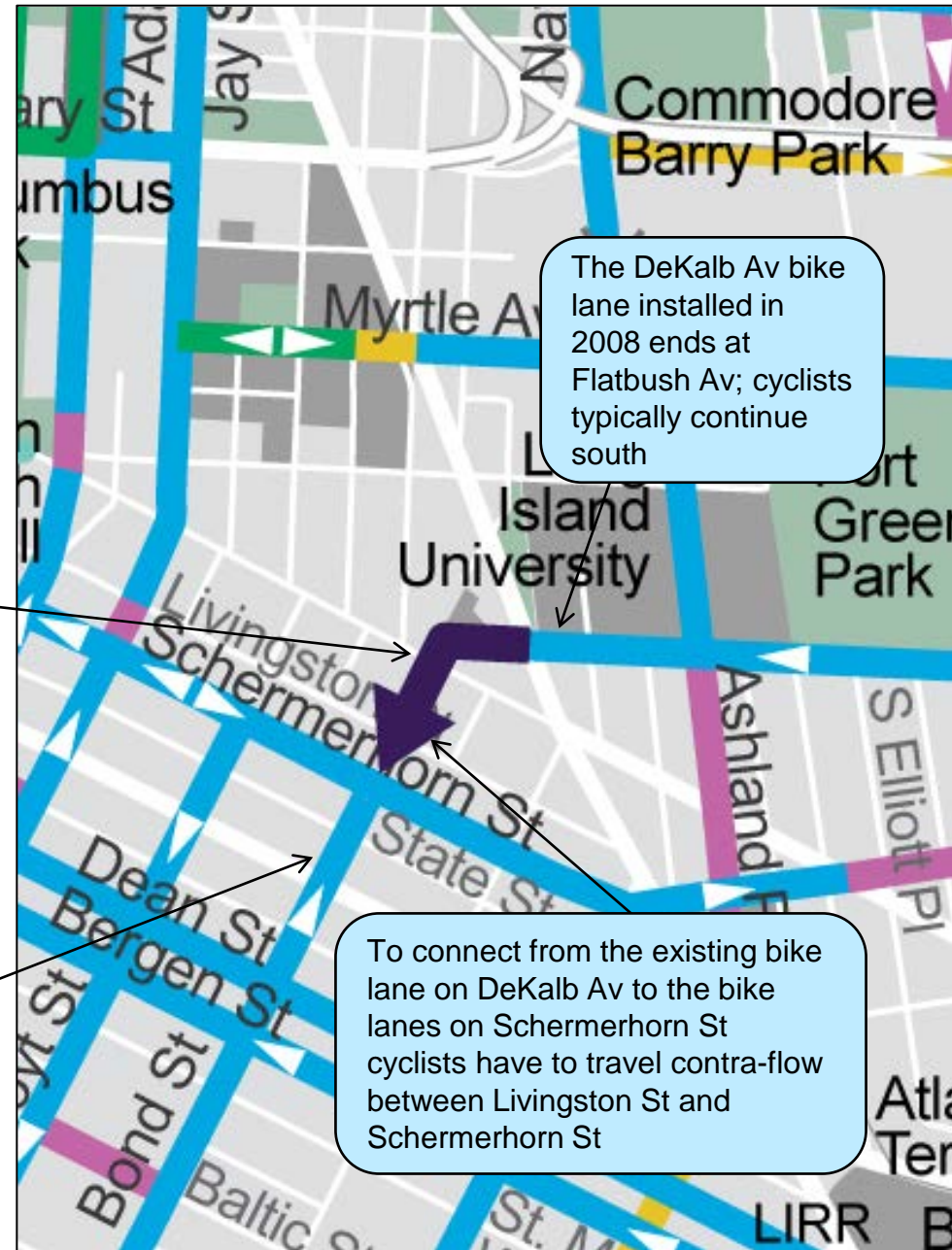

BIKE NETWORK – Citi Bike

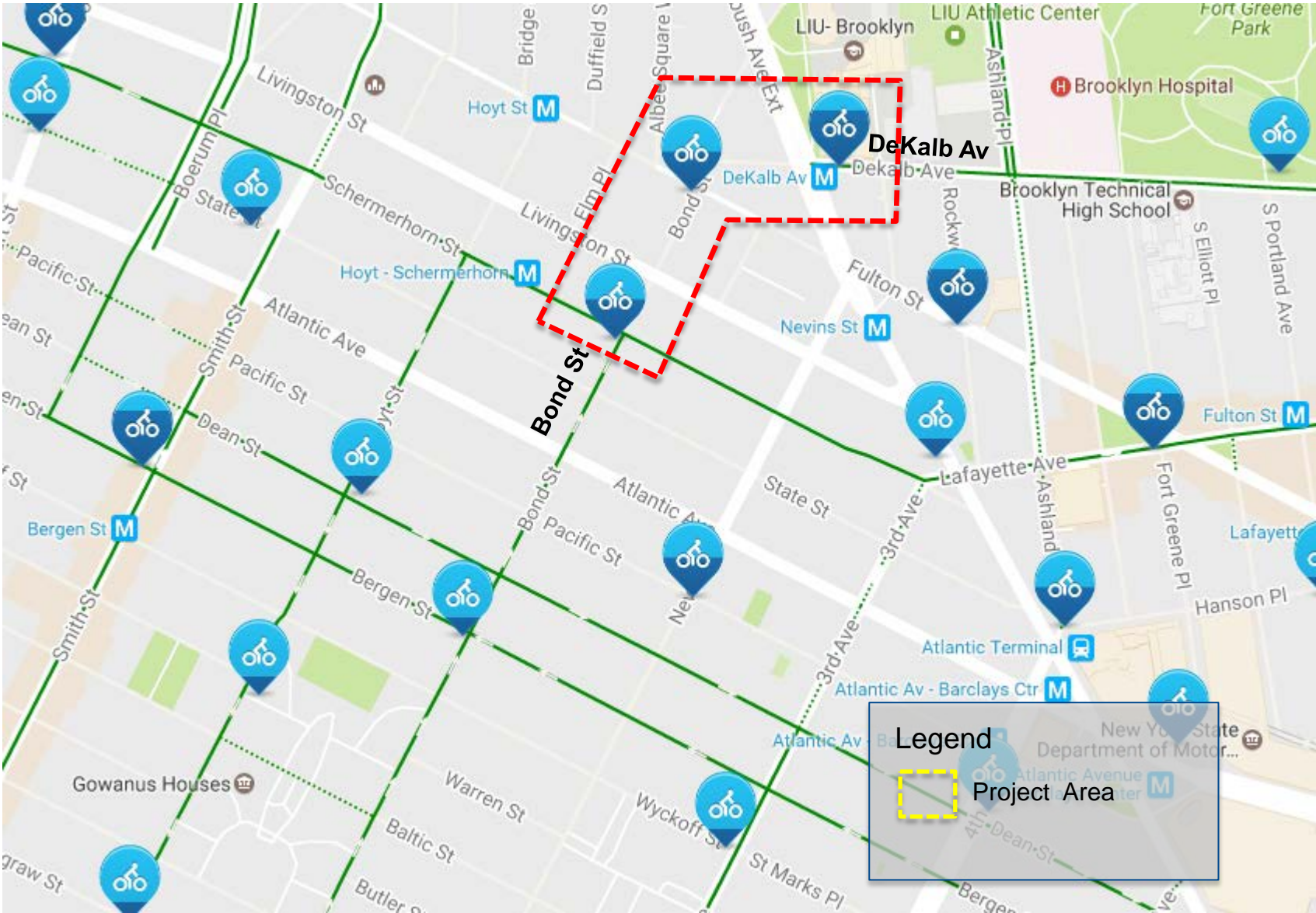

STREET NETWORK CHANGES

Pre-2010 Traffic Circulation Diagram

Prior to 2010 DeKalb Av continued to Gold St

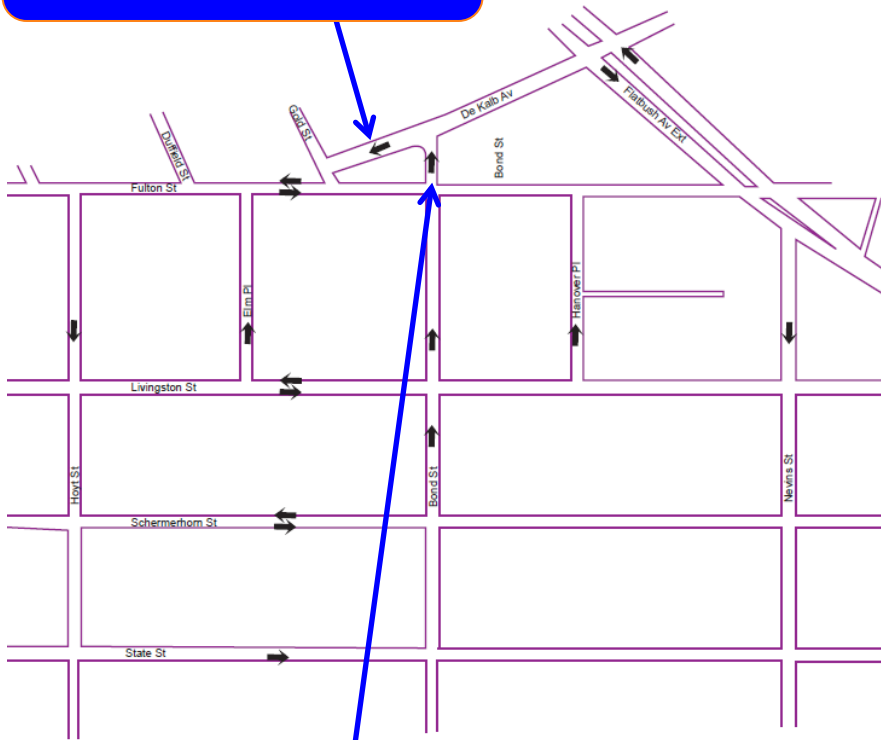

Northbound Bond St vehicles could continue to DeKalb Av

Post 2010 Traffic Circulation Diagram

In 2010 the Albee Square Capital Project removed DeKalb Av west of Bond St

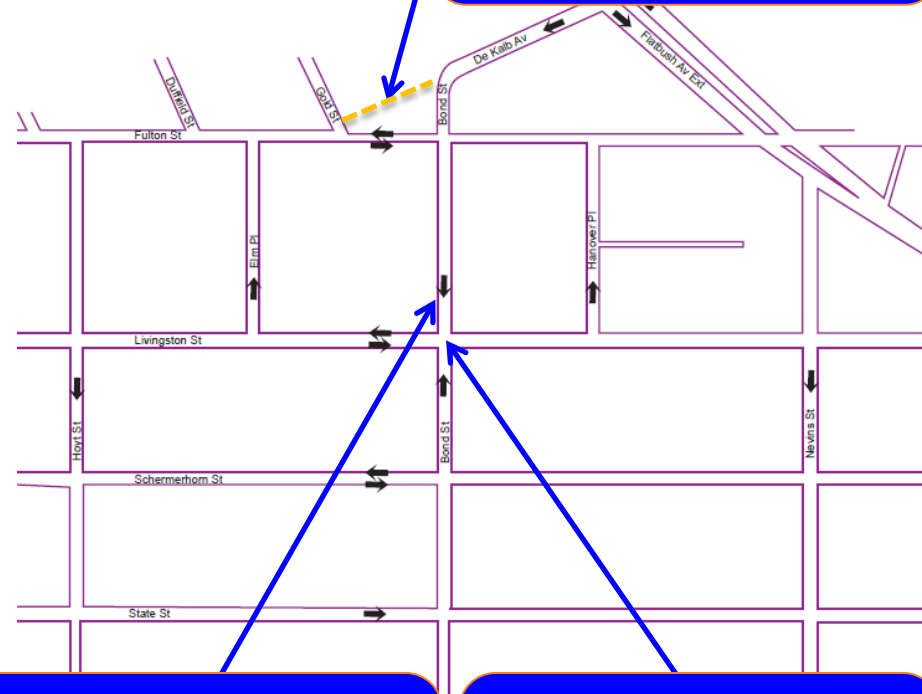

Bond St between Livingston St and Fulton St was converted to one-way southbound

At Bond St and Livingston St a head-on condition was created

VEHICULAR NETWORK – Existing Traffic Volumes

Existing Street Direction

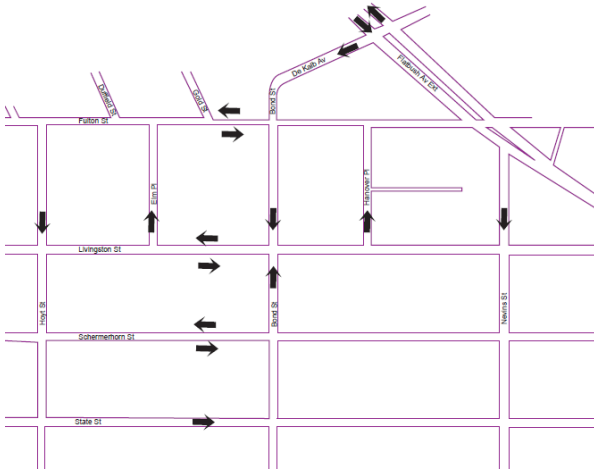

Existing Peak Hour (5pm – 6pm) Traffic Volume

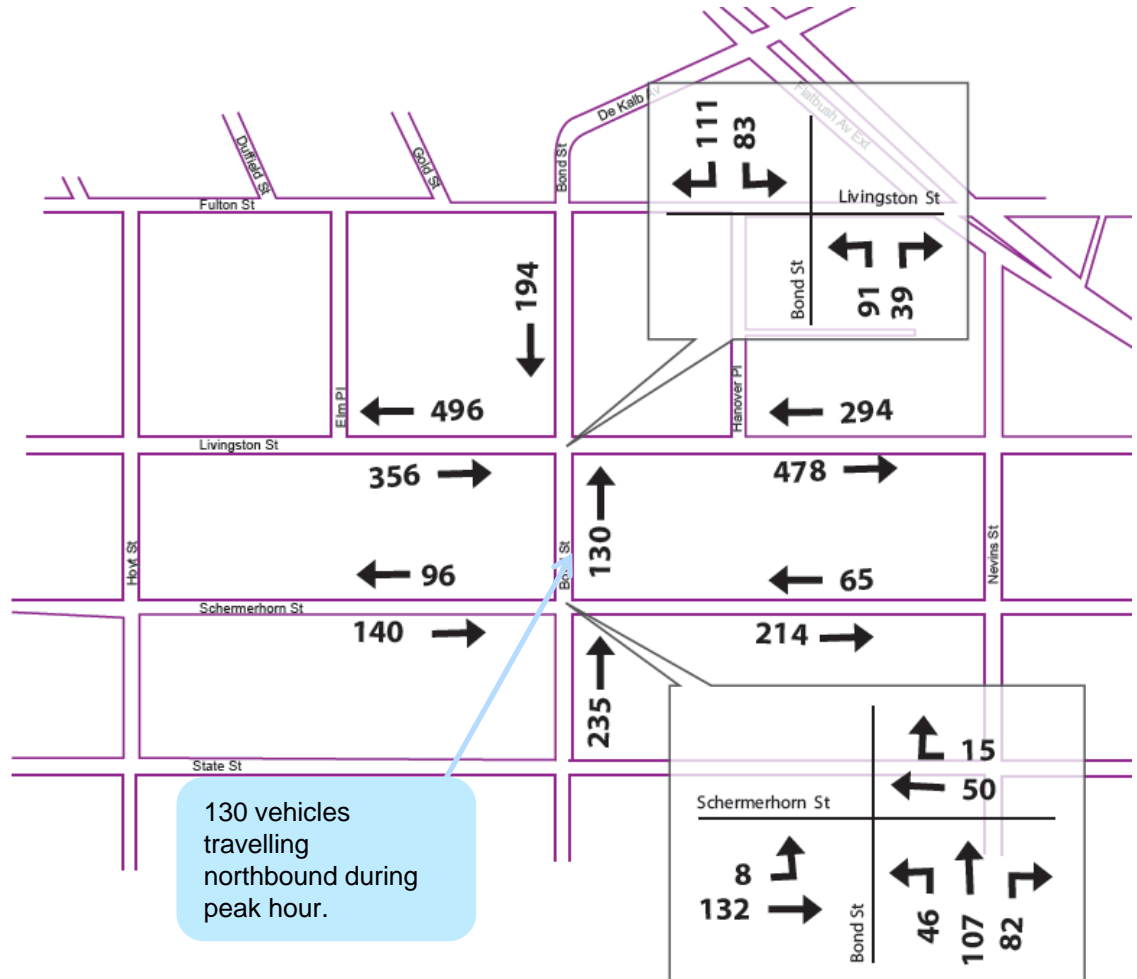

VEHICULAR NETWORK - Projected Peak Hour Traffic Volume

Proposed Street Direction



Reverse the direction of Bond St between Schermerhorn St to Livingston St from northbound to southbound.

Projected Peak Hour (5pm – 6pm) Traffic Volume

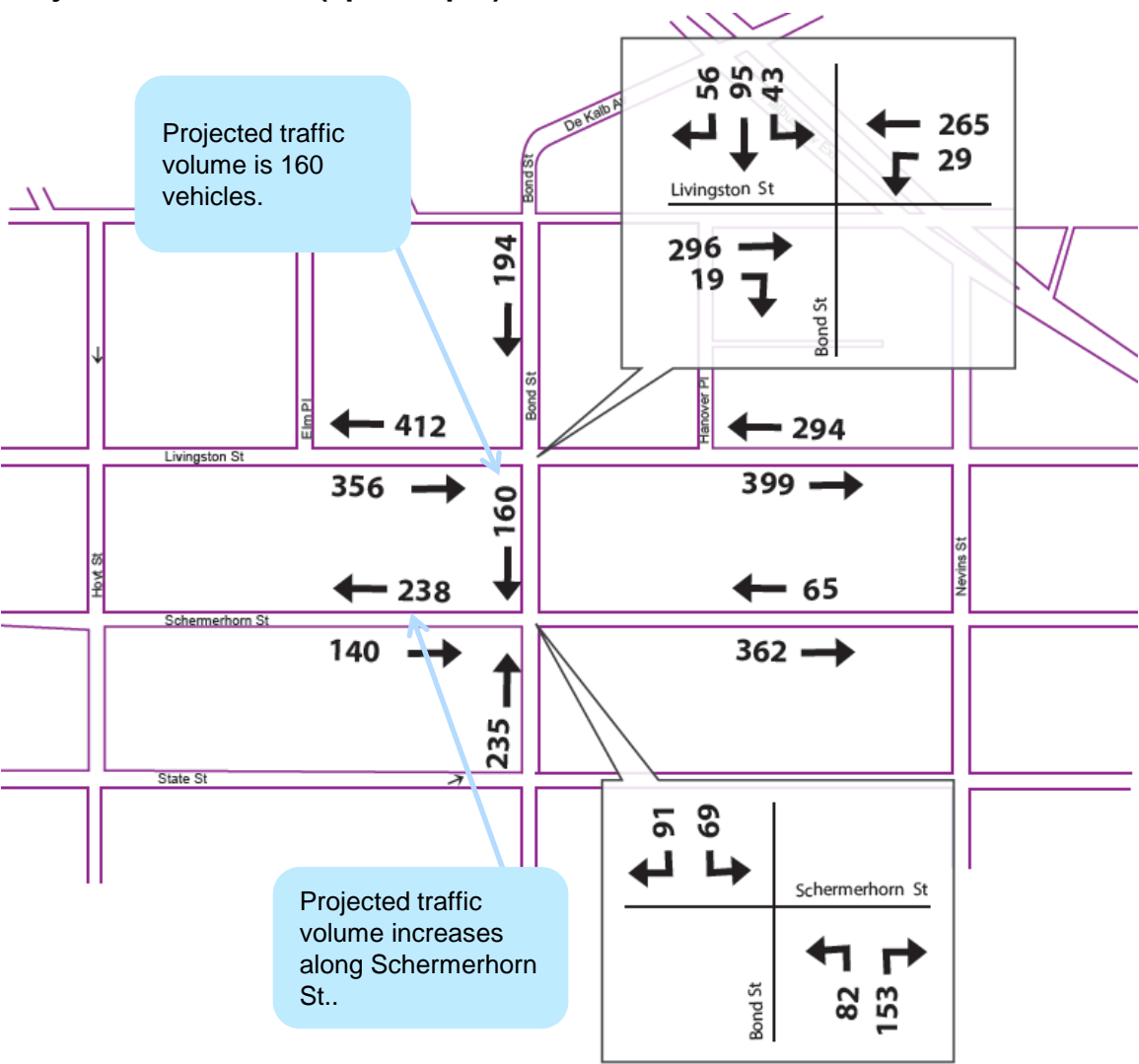



Looking north from Schermerhorn St to Livingston St.
The proposal is to change the direction of this block to southbound.



Looking south from Fulton St to Livingston St.

Existing Parking Regulations

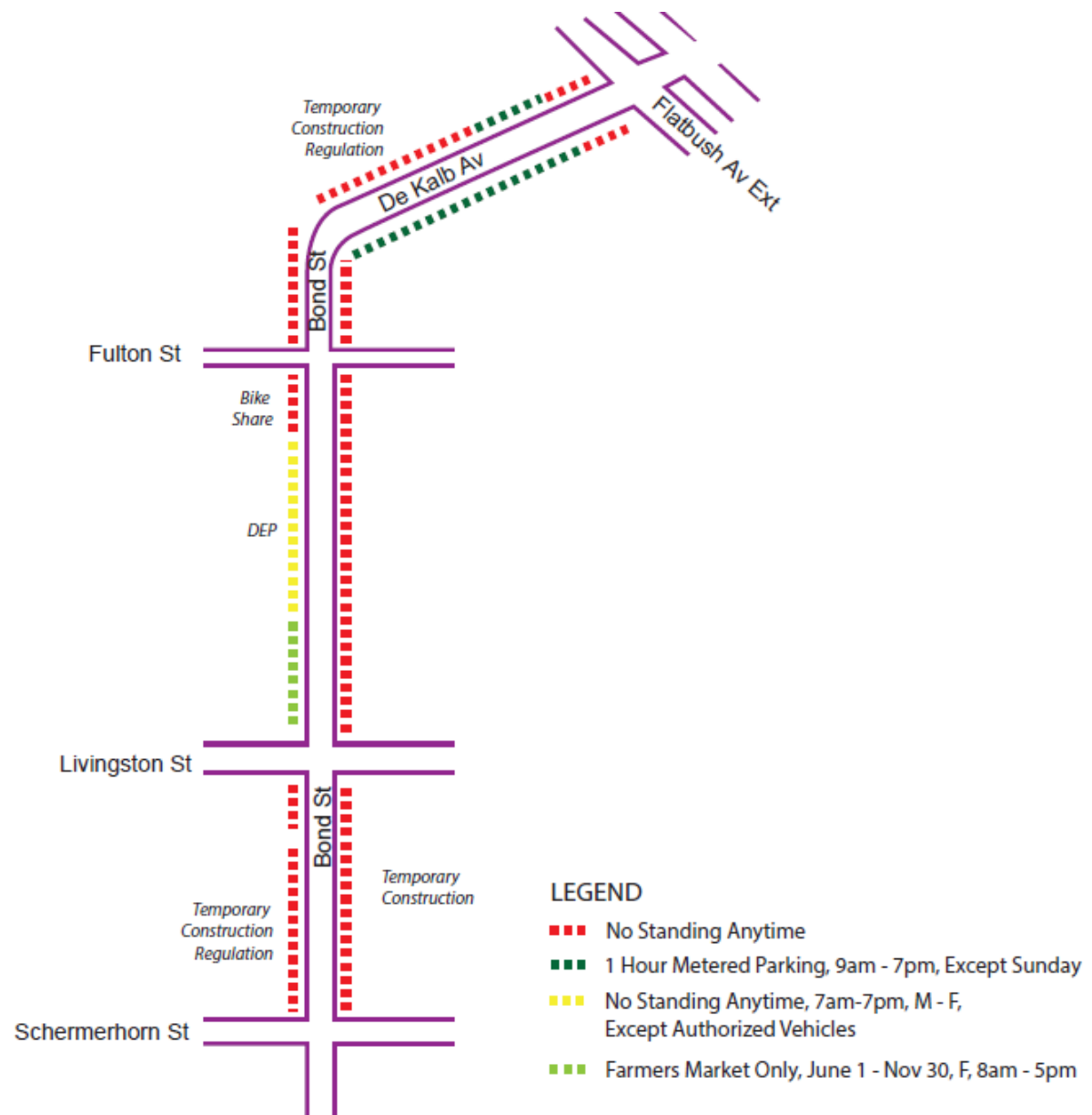

Proposed Parking Regulations

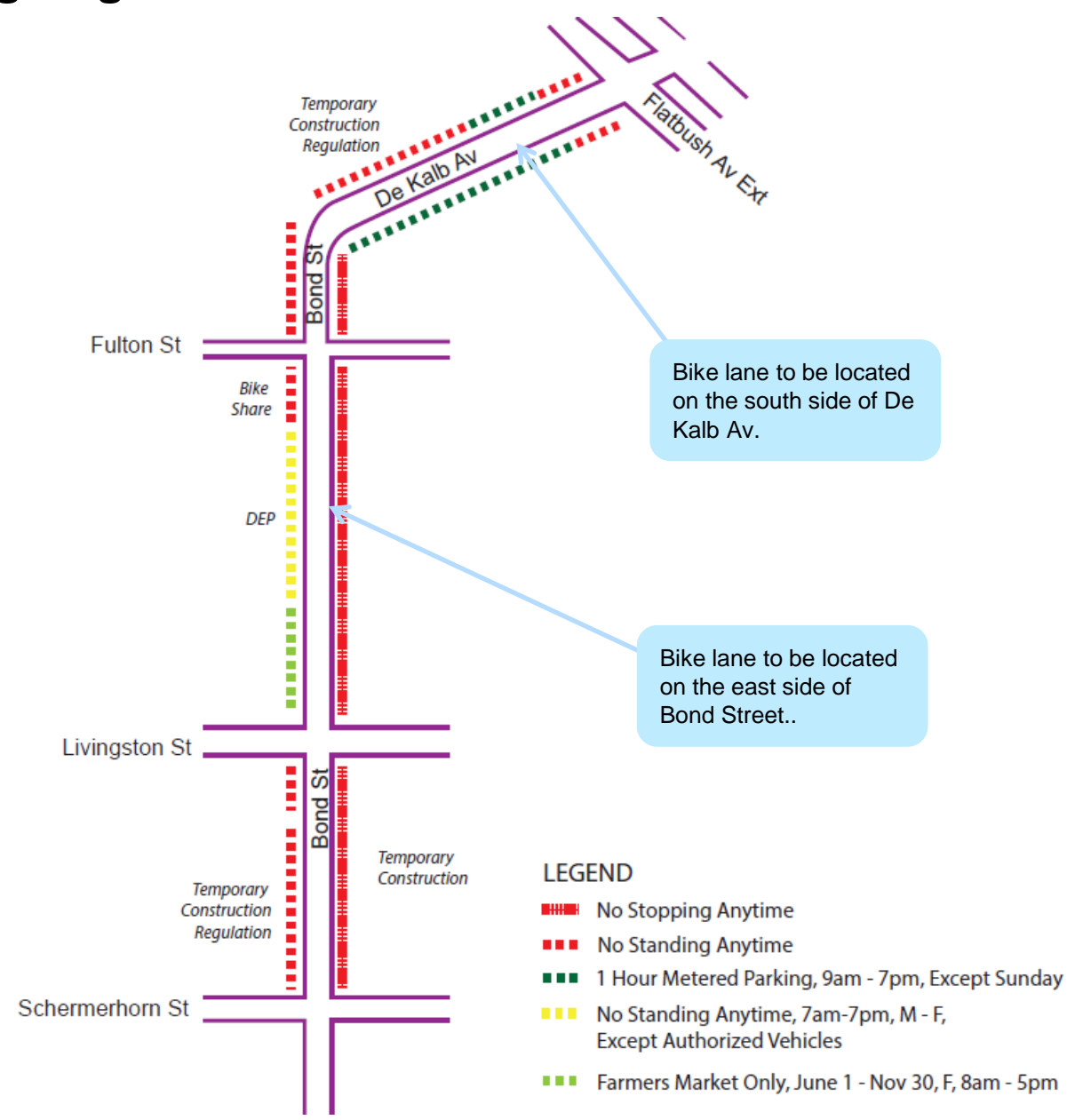

Proposal

2

De Kalb Av (Flatbush Av to Bond St)

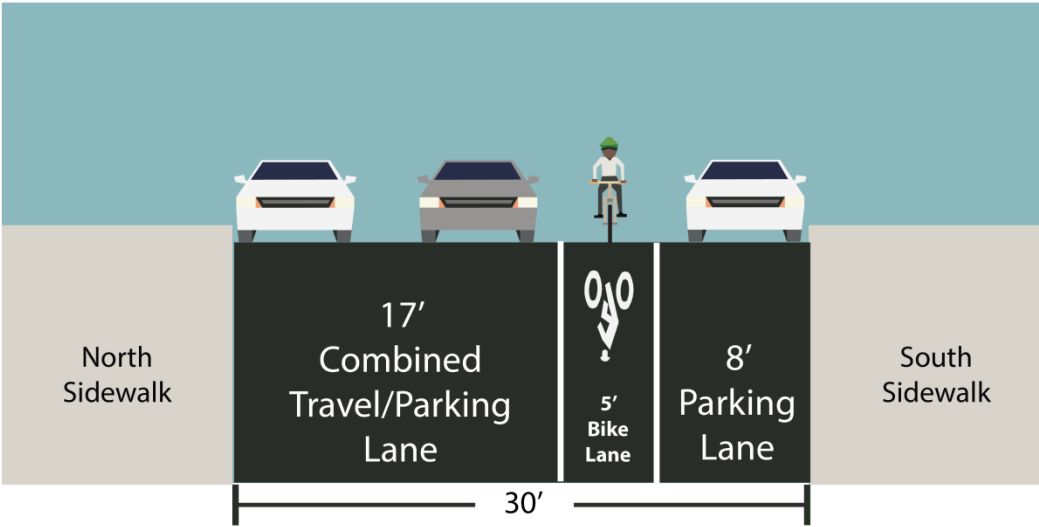
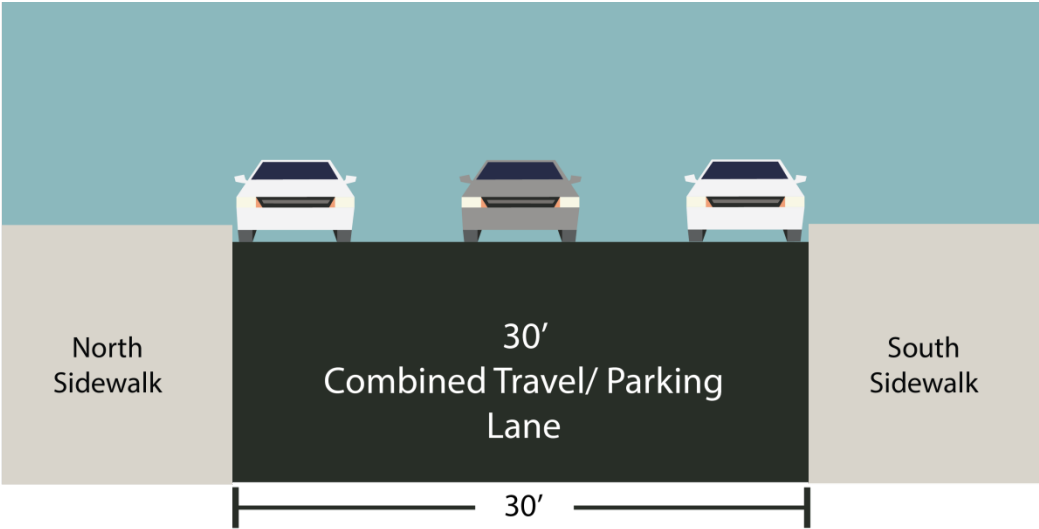

PHOTO ILLUSTRATION – DeKalb Av



DeKalb Av: Looking east towards Flatbush Av

Bond St (DeKalb Av to Schermerhorn St)

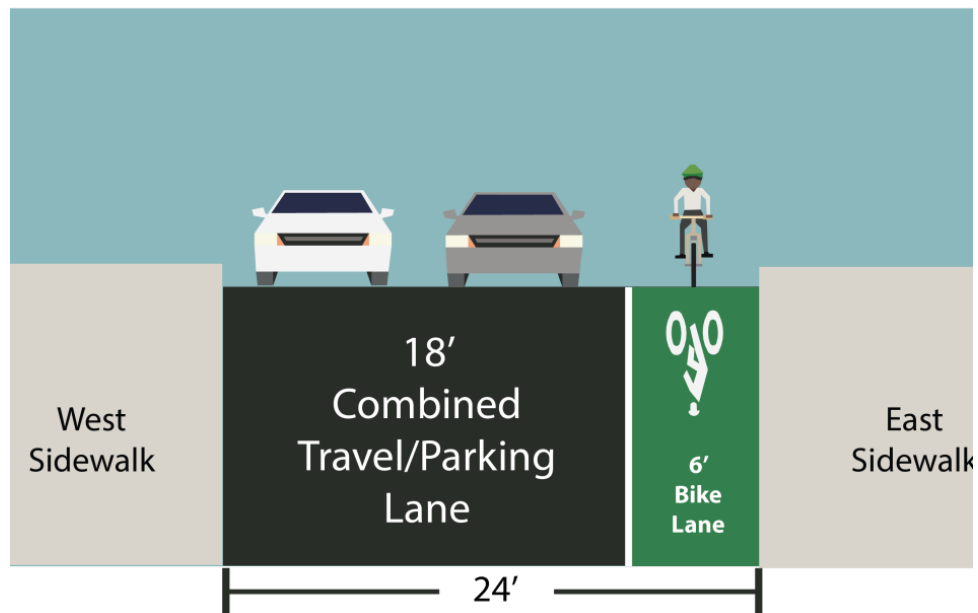
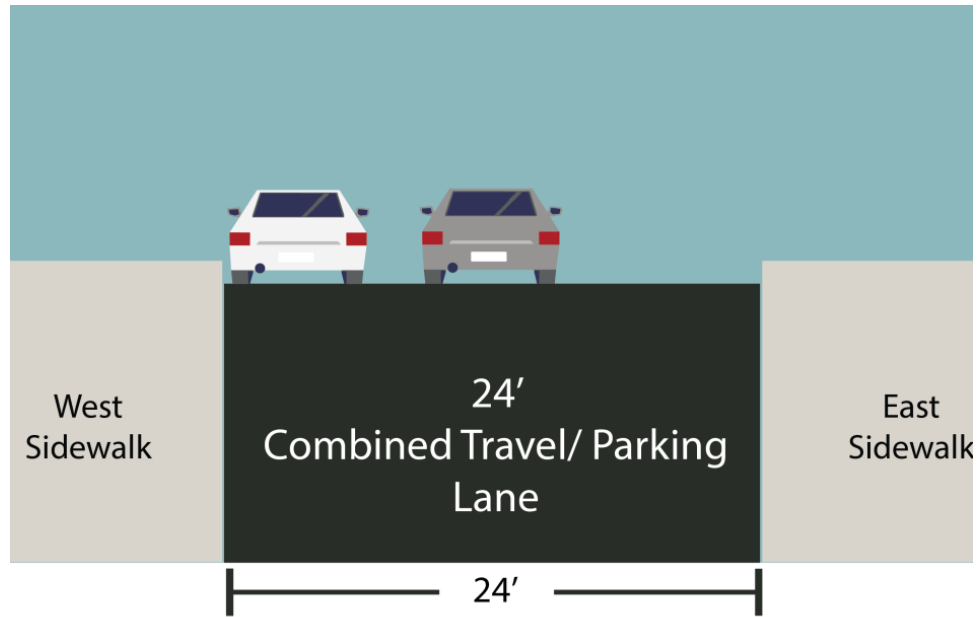
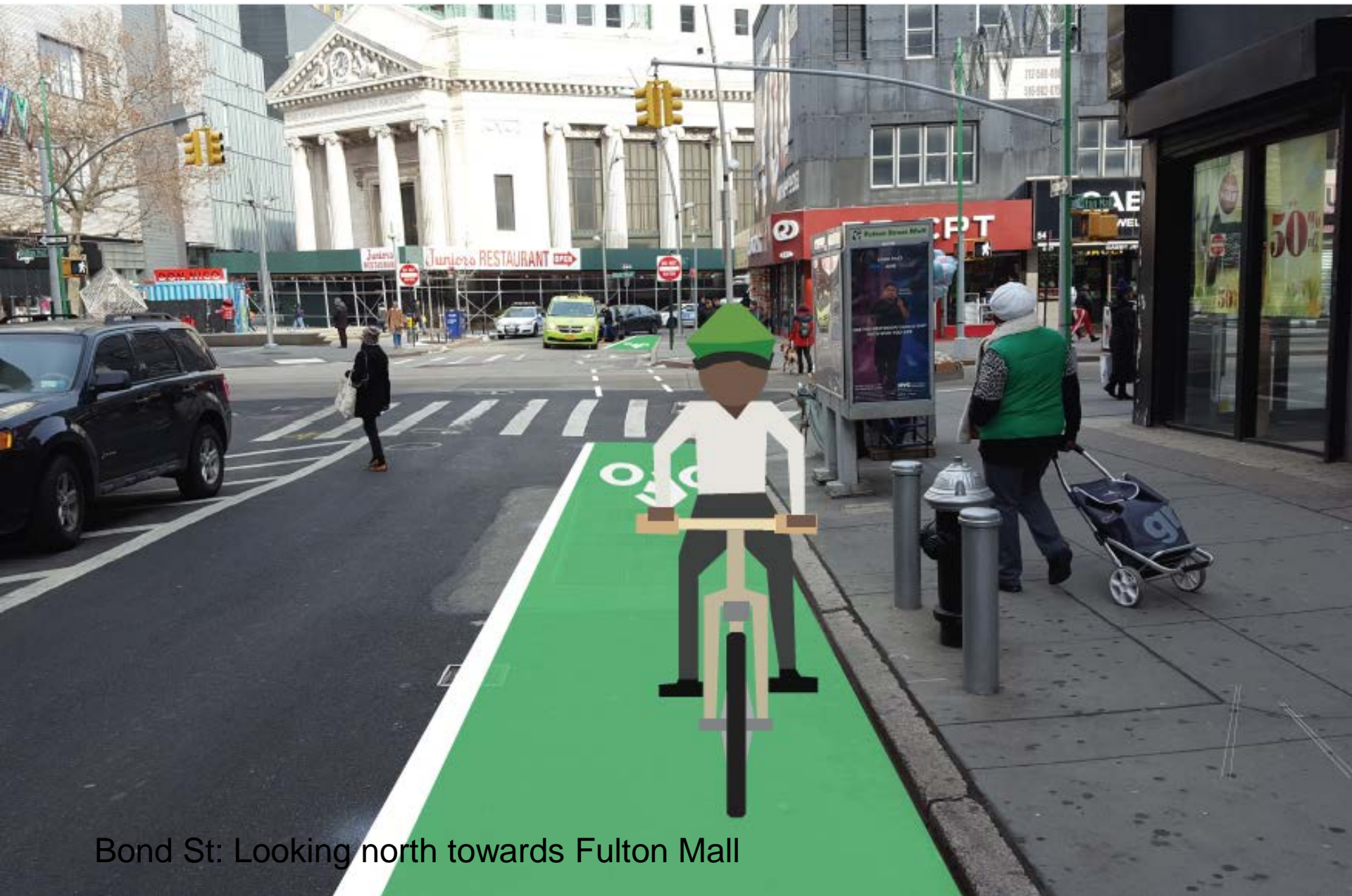

PHOTO ILLUSTRATION – Bond St



Bond St: Looking north towards Fulton Mall

Summary

3

SUMMARY

- Creates connection from DeKalb Av to Downtown Brooklyn
- Improves a safe, convenient cycling route connecting neighborhoods and destinations
- Provides dedicated space for bicyclists
- Organizes traffic on roadway

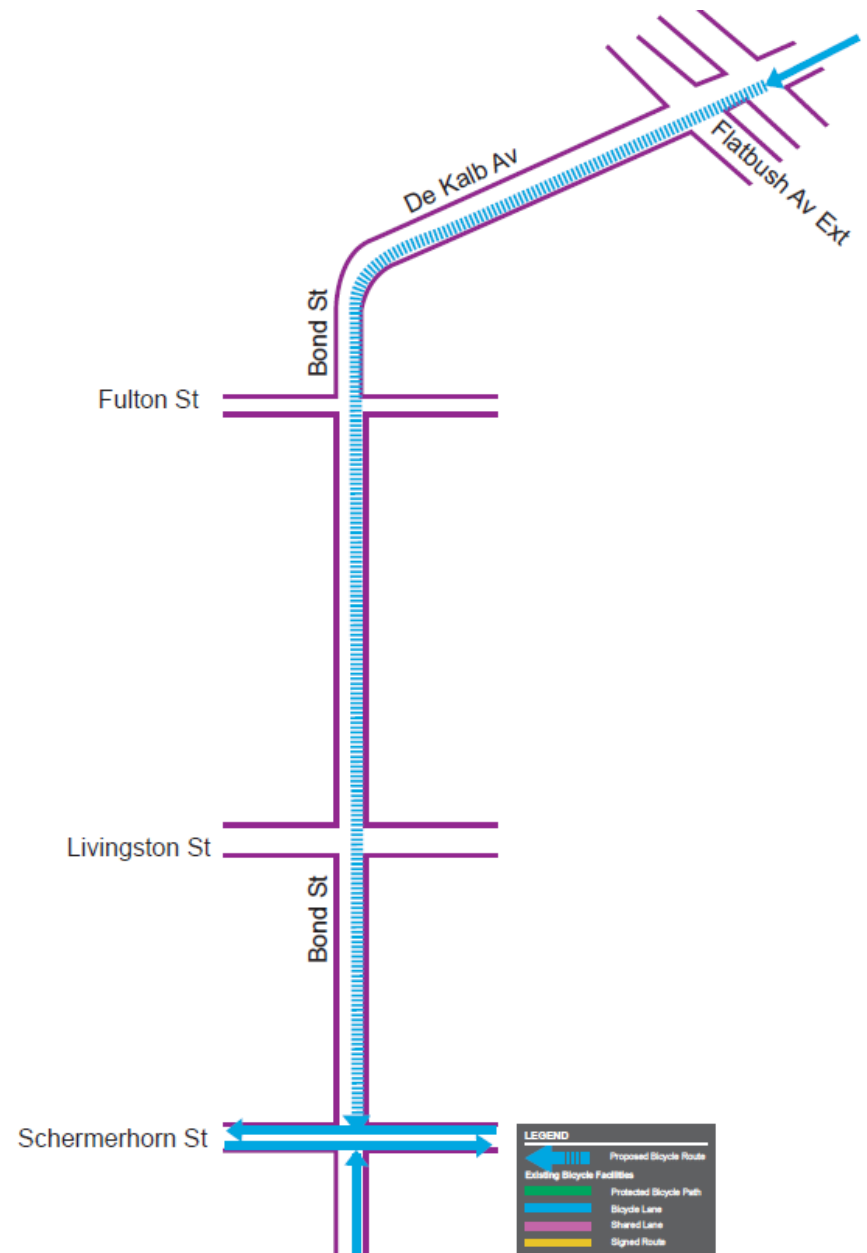

Questions?
THANK YOU!



NYC DOT



NYC DOT



nyc_dot



NYC DOT