



NYCDOT  
55 Washington Street, Suite 305  
Brooklyn, NY 11201  
Email: [BrooklynBridgeOutreach@gmail.com](mailto:BrooklynBridgeOutreach@gmail.com)



December 2013

# BROOKLYN BRIDGE REHABILITATION Progress Report

## Community Liaison

Alex Rothberg is the Community Liaison for the Brooklyn Bridge Rehabilitation Project. Please contact him with any project related concerns, or to be added to the email distribution list at:

Office: 718-260-8909 x 29  
Cell: 347-647-0876  
Email: [BrooklynBridgeOutreach@gmail.com](mailto:BrooklynBridgeOutreach@gmail.com)  
Website: [www.nyc.gov/dot](http://www.nyc.gov/dot)  
Field office: 55 Washington Street, Suite 305, Brooklyn, NY 11201

For all NYC non-emergency services, including inquiries and complaints regarding DOT Construction Projects, dial 311. Be prepared to give the following information so your call can be directed properly: Your name and borough; the contract number (BRC270 C/P) and a return phone number.



your city. your needs. your number.



December 2013

# BROOKLYN BRIDGE REHABILITATION Progress Report

The ramps and approaches to the Brooklyn Bridge are in need of rehabilitation and repair to improve safety and reduce congestion along both the Brooklyn and Manhattan approaches, particularly from the FDR Drive. With stimulus money from the federal government's American Recovery and Reinvestment Act, the ramps in Brooklyn and Manhattan are being rehabilitated and widened and the entire bridge is being repainted to remove all lead based paint and to reduce future steel corrosion on the structure.

## Repainting of the Structure

I. Painting commenced in 2010 and has progressed significantly in the last year:

- As of November 2013, 78% of total painting operations had been completed.
- Painting on the steel portions of the main bridge as well as the exit ramps on the Manhattan side is virtually complete.
- Painting of entrance ramps in Manhattan is in progress
- Approximately 50% of painting on the cables and ropes is complete

II. Dust collection, vacuum and recycle units are employed to minimize environmental air quality risks, and there is continuous air monitoring during operations. All painting is conducted in accordance with the US Environmental Protection Act and NYS Department of Environmental Conservation regulations.

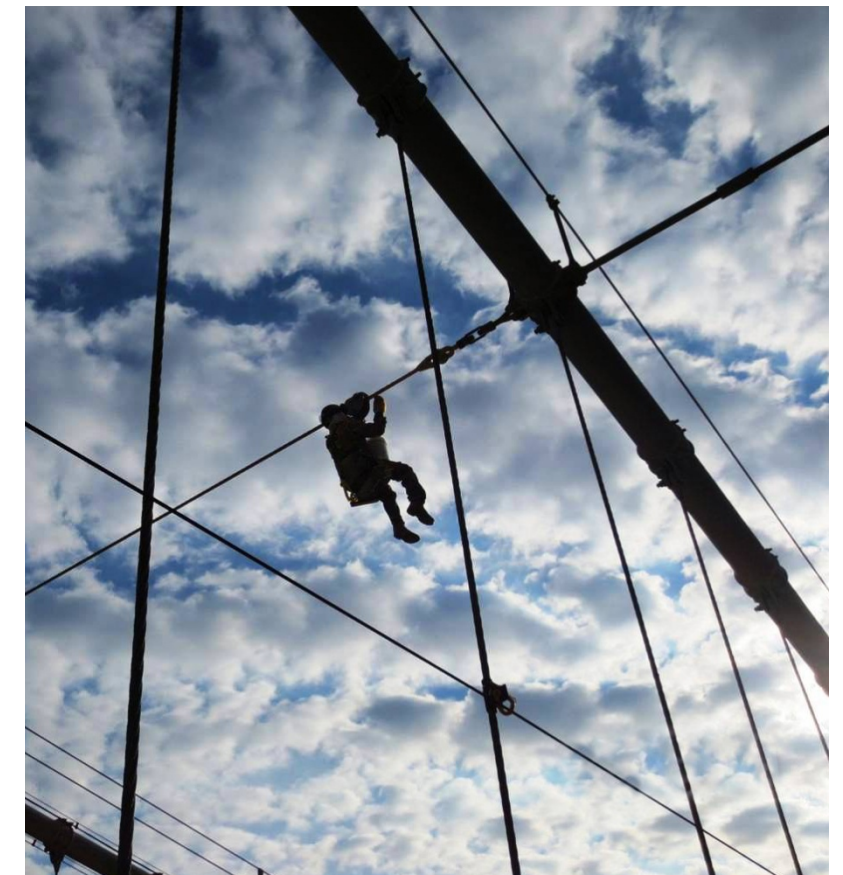
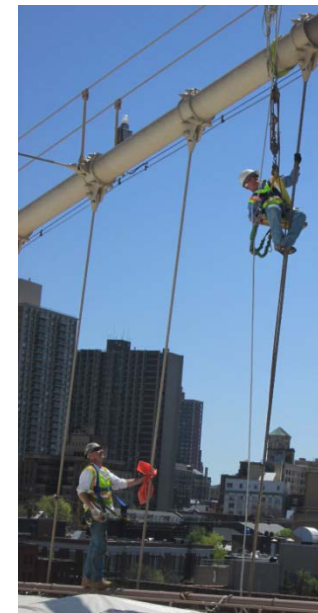

*All lead-based paint is removed in approved containment systems. The steel structures are coated in a five phase system, and the finish coat is in the Landmarks Commission "Brooklyn Bridge Tan".*



# BROOKLYN BRIDGE REHABILITATION

## Progress Report

### Rehabilitation of Ramps and Approaches - Manhattan

2013 saw significant progress on the Brooklyn Bridge Rehabilitation; seven of the nine total Full-Weekend Closures scheduled since the beginning of the project have occurred within the last twelve months. The use of such extended work hours has allowed the following construction progress to occur:



Demolition of roadway in preparation for placement of Pre-cast Grid-deck panels on Park Row Bridge Structure in Manhattan

#### Manhattan

- Installation of 74 of 281 Super-Slab panels on the west-bound lanes of the Manhattan side of the bridge.
- Installation of 265 of 283 Super-Slab panels along the Brooklyn-bound lanes of the Manhattan Main Approach.
- Completed installation of Pre-cast Grid Deck panels on the Park Row Bridge Structure.
- Excavation commenced on the North Cantilever.

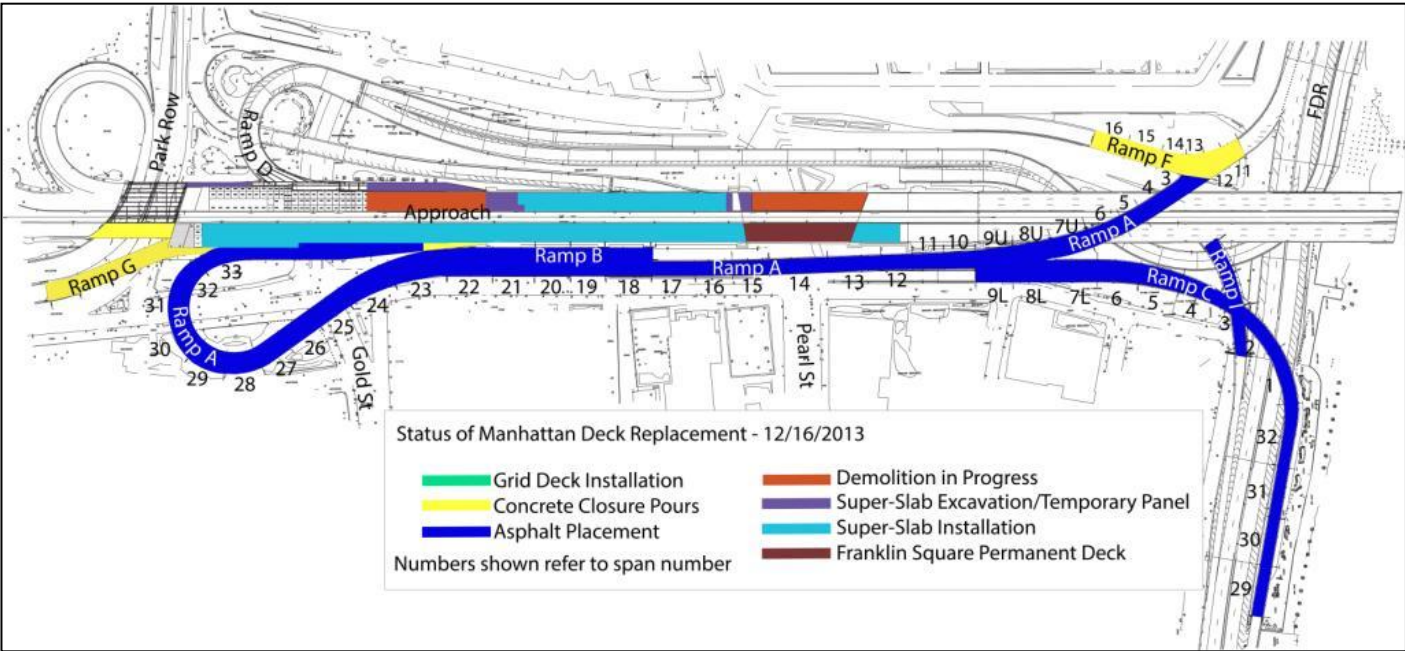

# BROOKLYN BRIDGE REHABILITATION

## Progress Report

### Rehabilitation of Ramps and Approaches - Brooklyn



Full replacement of stringers and floor beams on York Street Bridge Structure in Brooklyn

#### Brooklyn

- Completed installation of Pre-cast Grid Deck panels on Prospect Street, Washington Street, and "Maintenance Shop" Bridge Structures on the west-bound lanes.
- Completed installation of Pre-cast Grid Deck panels on Main Street and York Street Bridge Structures.
- Completed installation of Super-Slabs on Arch Block I.
- Began excavation of all three west-bound lanes on Arch Block II.

