

Jackson Heights Study

Short-Term Improvements on Roosevelt Ave & Broadway

Background

- Area of the Jackson Heights Neighborhood Transportation Study
- Earmark for study from Congressman Crowley
- Model of DOT's new approach to neighborhood transportation studies in PlaNYC
- Overlaps with the Jackson Heights Senior Safety Area

Location

- 74th St, 73rd St, Roosevelt Ave regional shopping district
- 37th Ave and 82nd St neighborhood shopping district
- Double parking, vehicular and sidewalk congestion, slow buses, lack of bicycle access and parking, conflicts between vehicles and pedestrians



2011

Street Improvement Projects

Broadway At 73 Street, QN

Injury Summary, 2006-2010

	Total Injuries	Avg Inj/Yr	Severity Percentile of Boro Intersections
Pedestrian	6	1.2	95%
Bicyclist	2	0.4	N/A
Motor Vehicle Occupant	21	4.2	95%
Total	29	5.8	96%

Fatalities, 01/01/2006-1/9/2012 : None

Source: Injuries: NYS Dept. of Transportation
Fatalities: NYC Dept. of Transportation

Roosevelt Avenue At 74th Street, QN

Injury Summary, 2006-2010

	Total Injuries	Avg Inj/Yr	Severity Percentile of Boro Intersections
Pedestrian	2	0.4	91%
Bicyclist	4	0.8	N/A
Motor Vehicle Occupant	3	0.6	87%
Total	9	1.8	89%

Fatalities, 01/01/2006-1/9/2012 : None

Source: Injuries: NYS Dept. of Transportation
Fatalities: NYC Dept. of Transportation

Jackson Heights Study(Cont.)

Improvements

- Painted crosswalks and curb extensions
- Created dedicated turn lanes and/or shifted centerline
- Installed two public plazas with paint and planters
- Marked bicycle lanes and routes
- Installed pedestrian countdown signals and bicycle signals
- Changed signal timing, add new poles, and upgrade signals on 35th Ave
- Reroute and consolidation of bus routes and relocate bus stops and signs
- Installed new Muni-meters
- Install curbside delivery zones (Spring 2012)
- Change parking regulations and signs (Spring 2012)
- Install city racks and Cemusa bicycle shelters (Spring 2012)

Benefits

- Reduces vehicle and pedestrian conflicts
- Reduces congestion
- Provides community space in an area that lacks open space
- Improves mobility for vehicles, buses, bicycles and pedestrians

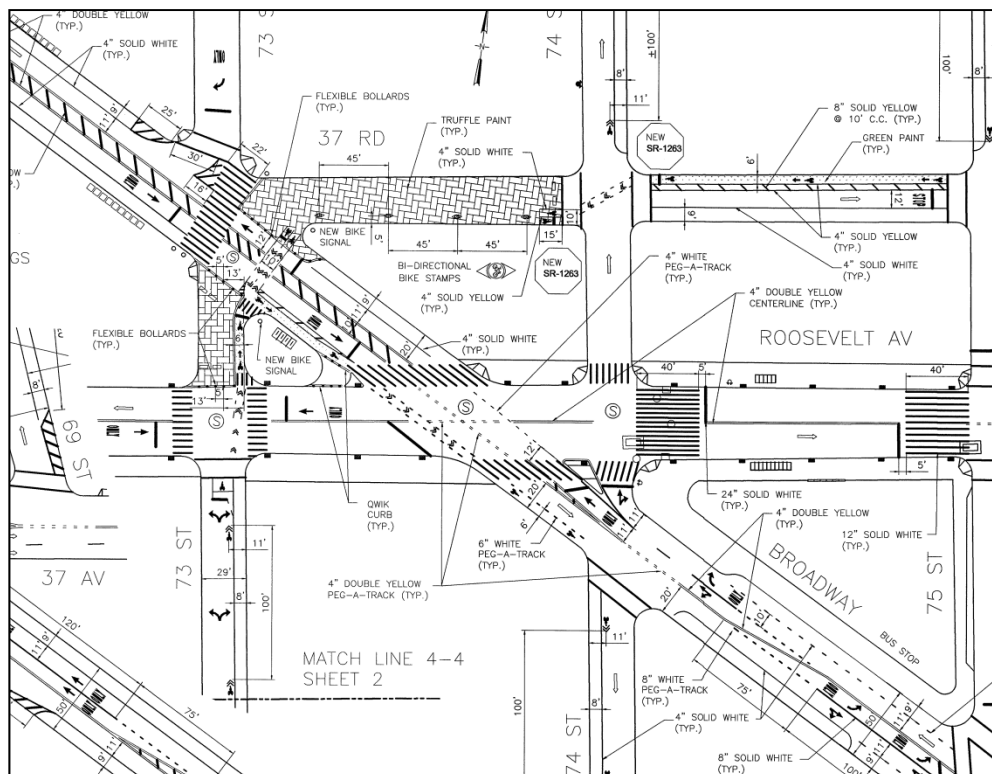

Jackson Heights Study (Cont.)

Scope

- Colored or Textured Roadways
- Flexible Bollards
- Landscaping—Maintenance Partner
- Markings
- Roadway Resurfacing
- Signal Installation/Reconfiguration
- Signal Timing Plans
- Signs—Curb Regulations
- Signs—Traffic Control
- Street Furniture with Partner

Lead Unit

- Community Initiatives
(Planning and Sustainability)

Implementation

- August 15 - September 26



Before: 37th Road between 73rd and 74th Streets



After: Plaza space on 37th Road between 73rd and 74th Streets

Jackson Heights Study (Cont.)



Before: 37th Road between 73rd and 74th Streets, looking east



After: Plaza space on 37th Road between 73rd and 74th Streets