

Atlantic Avenue at Columbia Street

Brooklyn Waterfront Greenway Improvements



7/7/2011 – CB 6

1. Project Background
2. Existing Conditions
3. Signal Changes for BQE Ramp
4. Atlantic Ave / Park Improvements
5. Columbia Street Improvements

Project Background

Brooklyn Waterfront Greenway Improvements

- **Spring 2010 - Pier 6 opened**
- **Summer 2010 - Temporary Path**
- **1.5 Miles of separated, waterfront path from Old Fulton to Degraw Street**



Project Background

Brooklyn Waterfront Greenway Progress

- **Fall 2010 Brooklyn Waterfront Greenway Workshops: Atlantic Avenue and Congress Street identified as important access to the Park**
- **Plan developed with Port Authority and Brooklyn Bridge Park**



Project Background

Community Lead Project

- **Pedestrians/cyclists along waterfront have increased.**
- **Issues were raised by several community leaders:**

State Senator Daniel Squadron

Pedestrian and cyclist safety

Councilmember Steve Levin

Pedestrian and cyclist safety

Councilmember Brad Lander

Pedestrian and cyclist safety

Brooklyn Bridge Park Defense Fund

Park access

Brooklyn Bridge Park

Park access

NYPD

Traffic safety and compliance

Port Authority

Working waterfront



INTERIM IMPROVEMENTS

Implemented Last Summer

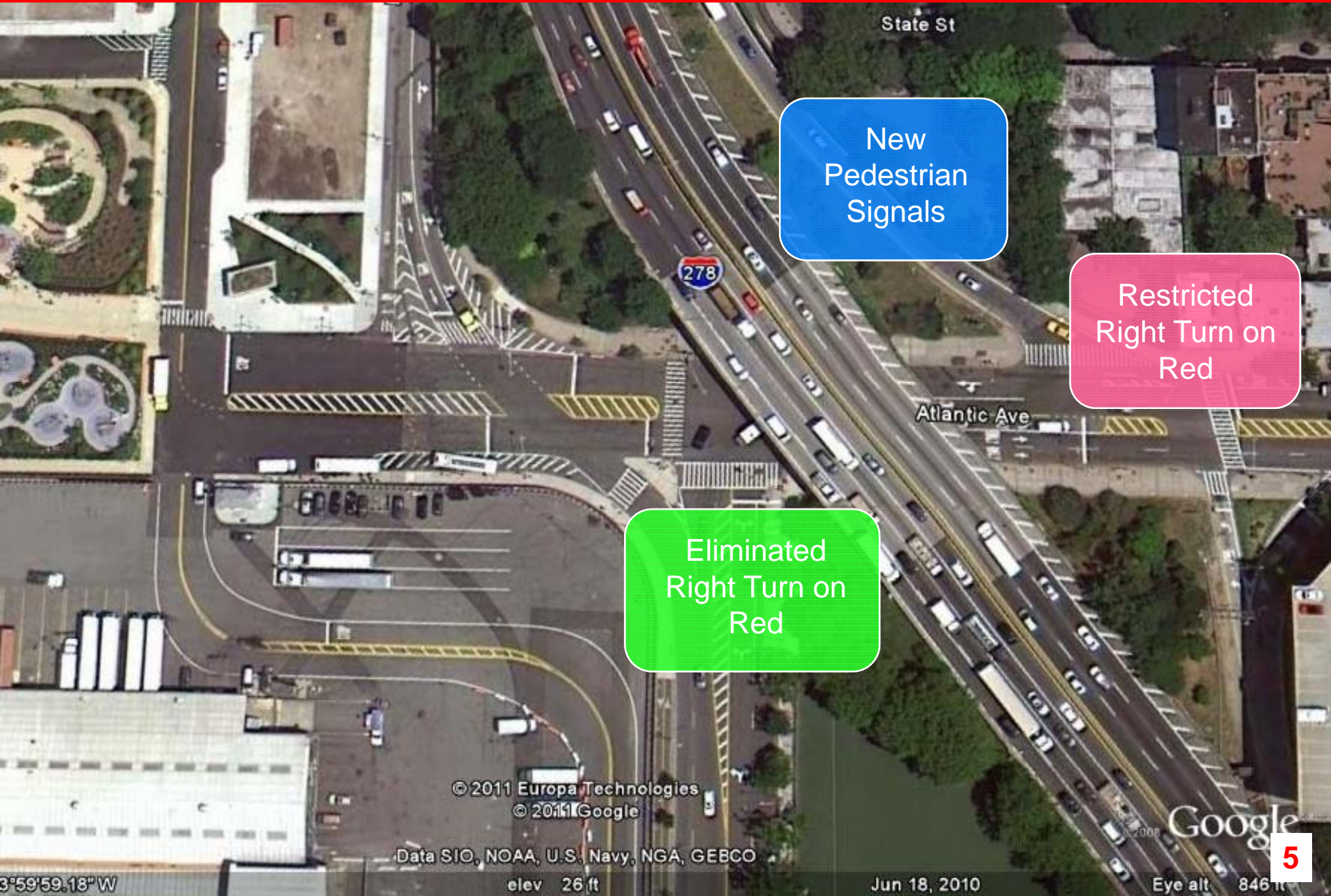

New
Pedestrian
Signals

Restricted
Right Turn on
Red

Eliminated
Right Turn on
Red

© 2011 Europa Technologies
© 2011 Google

Data SIO, NOAA, U.S. Navy, NGA, GEBCO

elev 26 ft

Jun 18, 2010

Eye alt 846 ft

PROJECT FOCUS AREAS

Atlantic Avenue Corridor Improvements

2 Atlantic Avenue and Furman Street

- 1) Formalize crosswalk
- 2) Formalize greenway connection
- 3) Relocate bus stop to park entrance
- 4) Increase truck/ped/bike visibility
- 5) Enhance park gateway landscaping

Furman St.

3 Columbia Street between Atlantic Ave and BQE Entrance

- 1) Simplify southbound movement by reducing number of lanes
- 2) Remove greenway from sidewalk
- 3) Improve bicycle facility and visual connection with Columbia Street Greenway

BQE EB On-Ramp

1 Atlantic Ave and BQE Entrance

- 1) Improve signal timing
- 2) Improve "No Right Turn on Red" sign
- 3) Explore red light camera

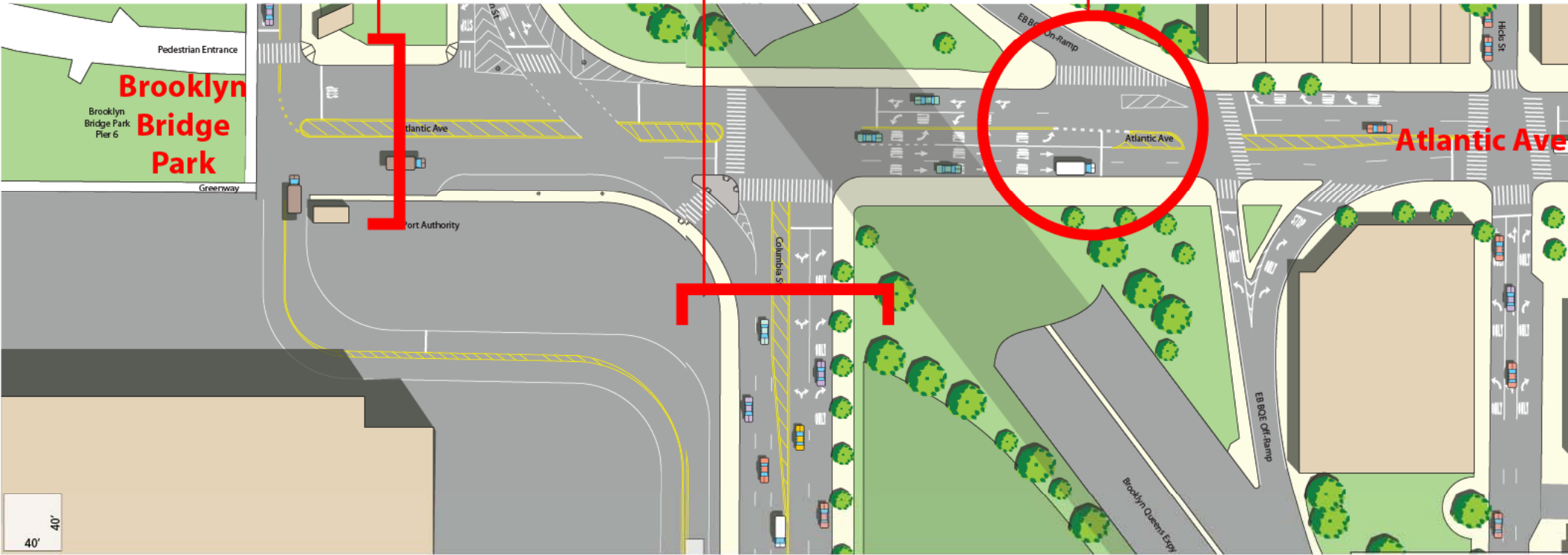

Columbia St.

Hicks St.



- **Heavy vehicular volumes along Hicks Street during peak hour**
 - 820 vehicles per peak hour make right turn onto BQE
 - “Right turn on red” permitted 7am to 10am accommodate high volumes
- **High pedestrian volumes along Atlantic Avenue to access park**

1

EXISTING BQE On-Ramp

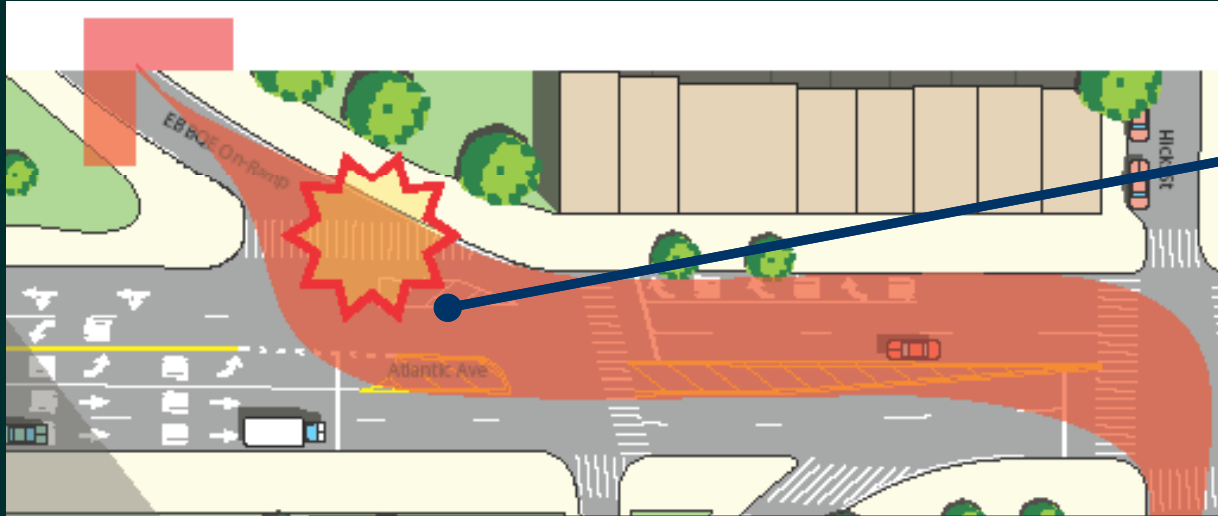

- **Bottleneck at BQE On-Ramp**
 - Adjacent thru-lane illegally makes right at “right turn on red”

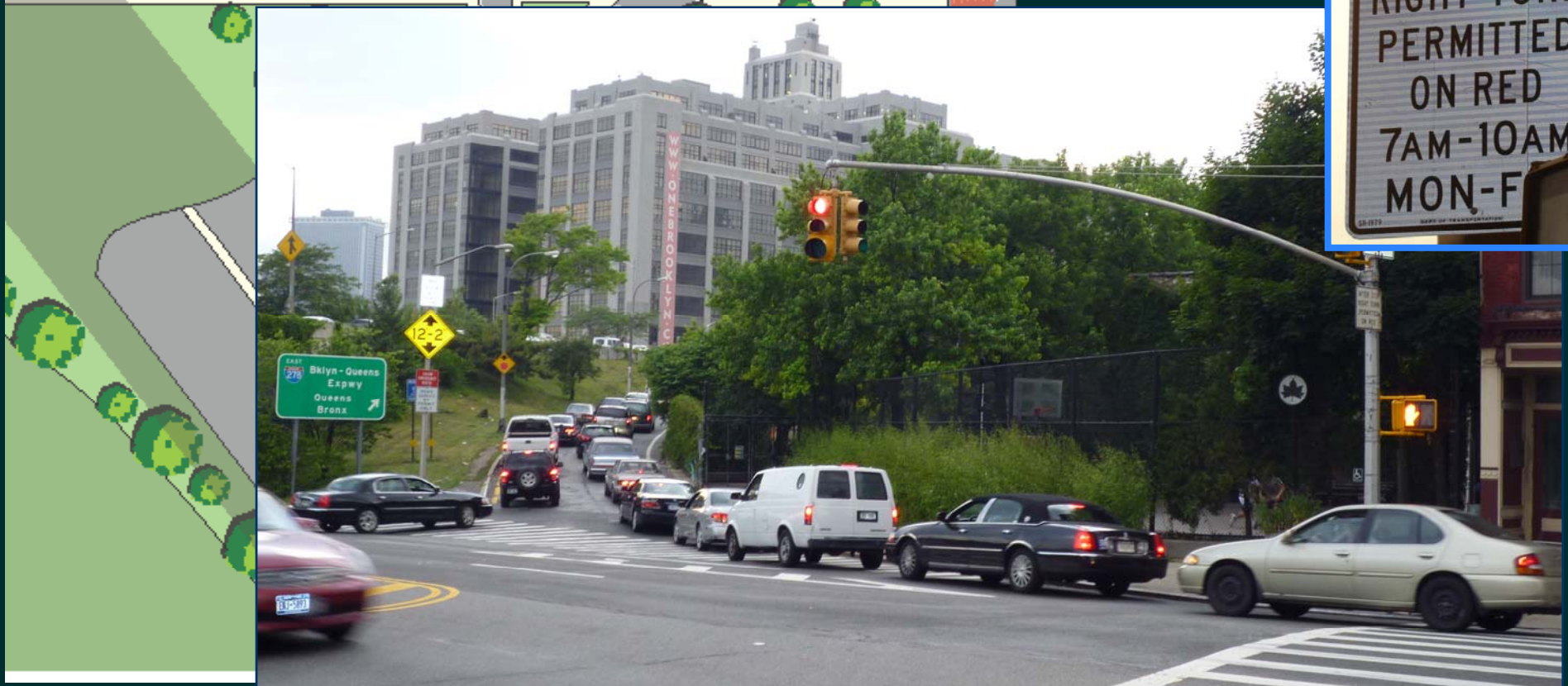

PROPOSED

Atlantic Avenue
Between Hicks Street and the BQE Entrance



- Signal timing improvements
- New sign that emphasizes No Turn on Red
- Exploring Red Light Camera

2

EXISTING

Atlantic Avenue and Furman Street

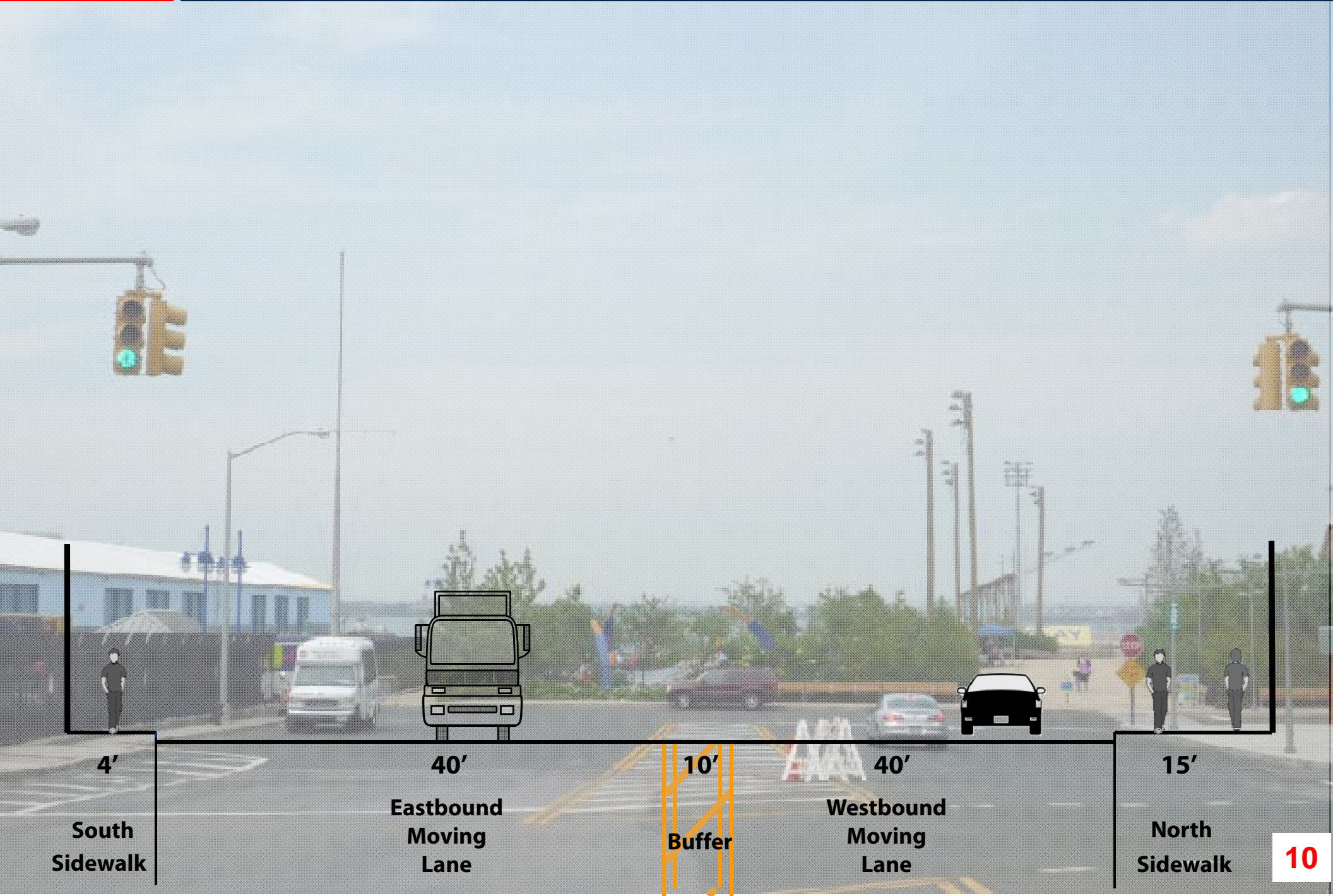

4'

40'

10'

40'

15'

South
Sidewalk

Eastbound
Moving
Lane

Buffer

Westbound
Moving
Lane

North
Sidewalk

10

2

EXISTING

Atlantic Avenue and Furman Street

Heavy truck volume in/out of PANYNJ facility

Bicycle entrance to Park is on south side of Atlantic

Pedestrian entrance to Park is on north side of Atlantic



2

EXISTING

Atlantic Avenue and Furman Street

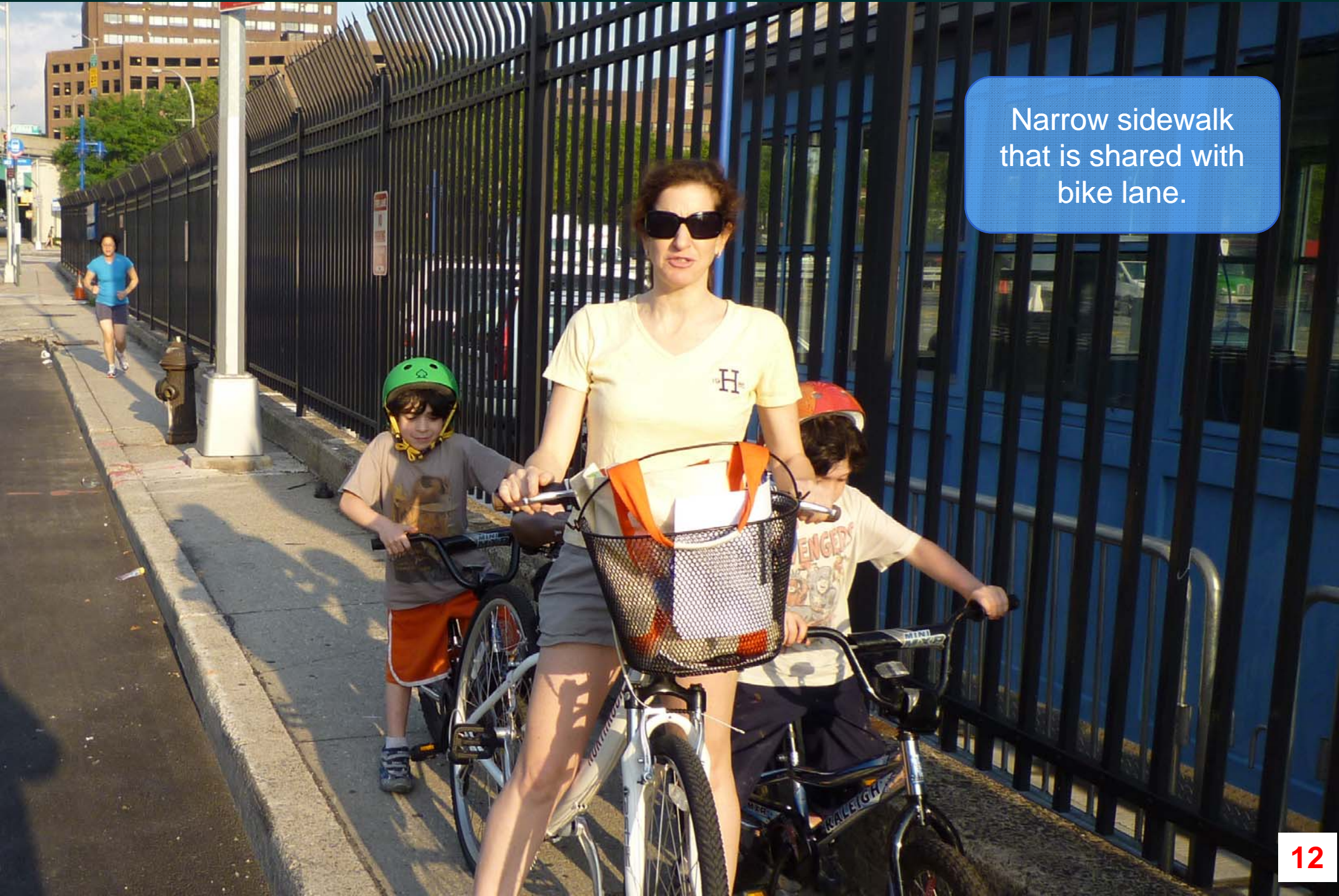

Narrow sidewalk that is shared with bike lane.

2

PROPOSED

Atlantic Avenue and Furman Street

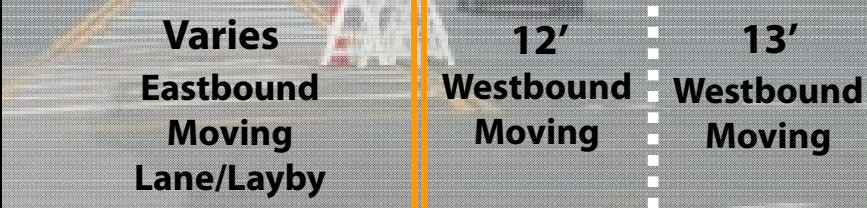
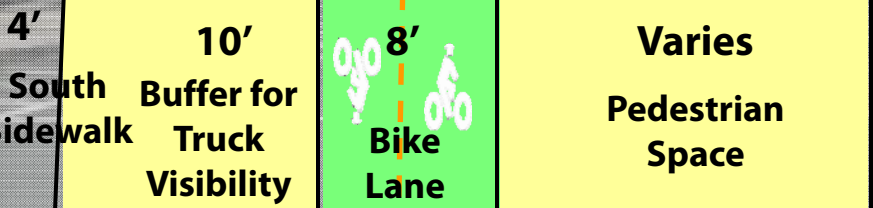
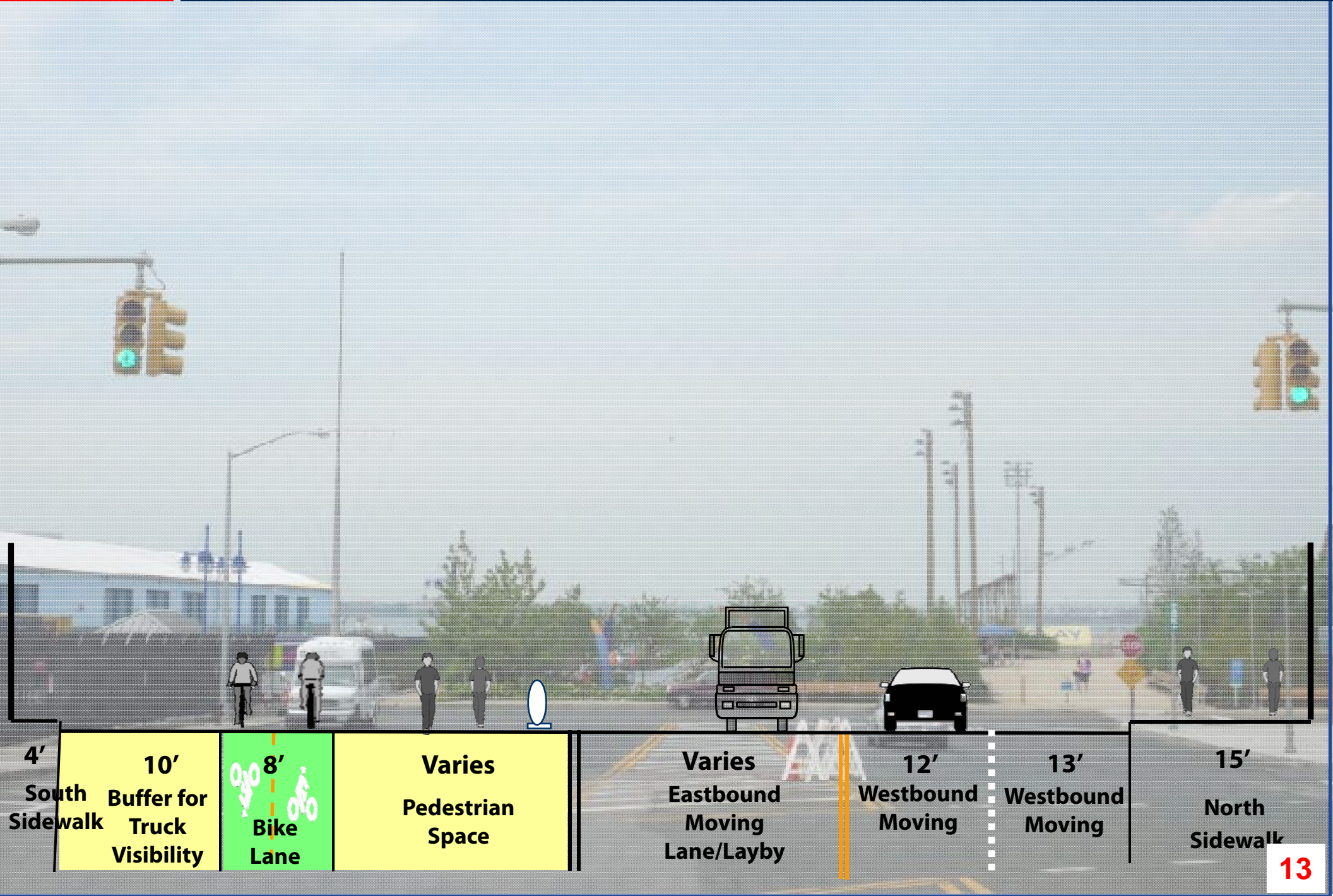

2

PROPOSED

Atlantic Avenue and Furman Street

Busses will be rerouted on Park roadways.

MTA has approved this potential bus alignment

Busses will no longer make the U-turn at base of Atlantic Avenue.



011 Google
U.S. Navy, NGA, GEBCO

Jun 18, 2010

Eye alt 817

3

EXISTING

Columbia Street
Between Atlantic Ave and BQE Entrance

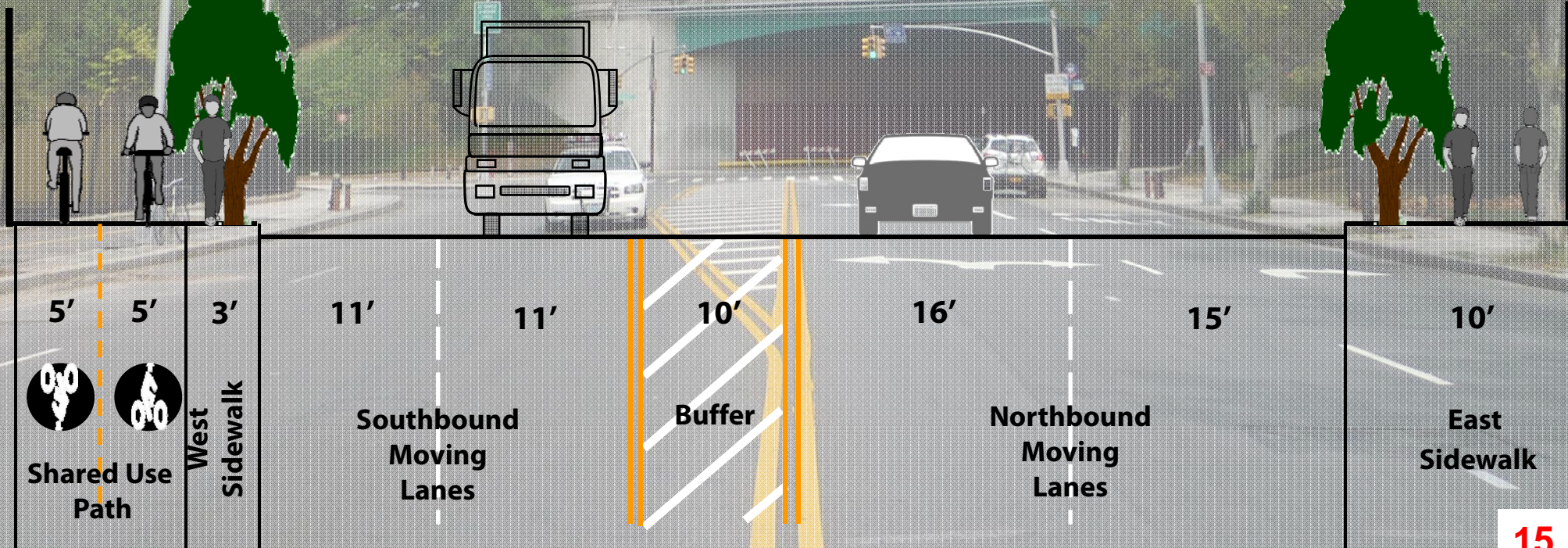

3

EXISTING

Columbia Street
South of Atlantic Ave

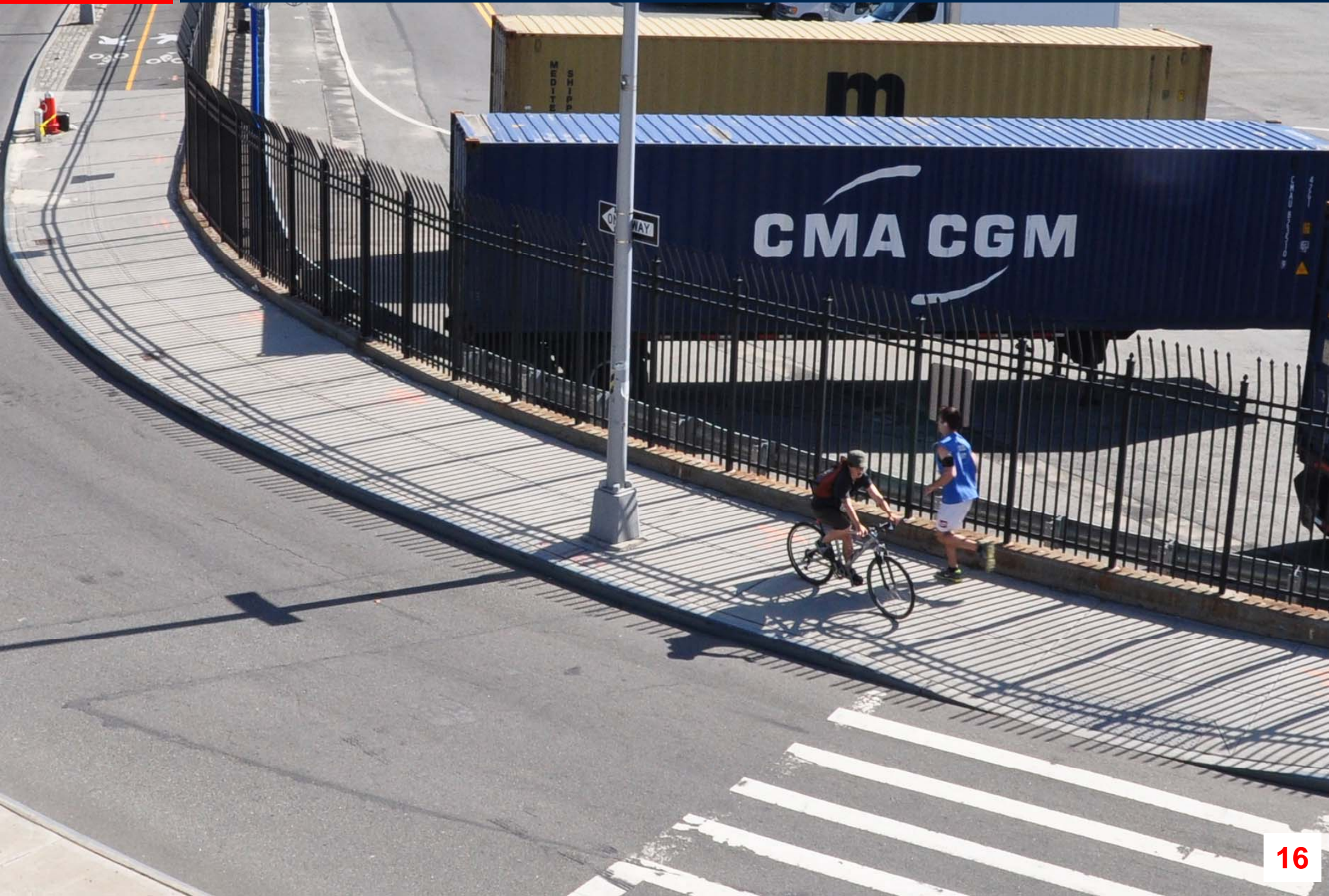

3

PROPOSED

Columbia Street
Between Atlantic Ave and BQE Entrance

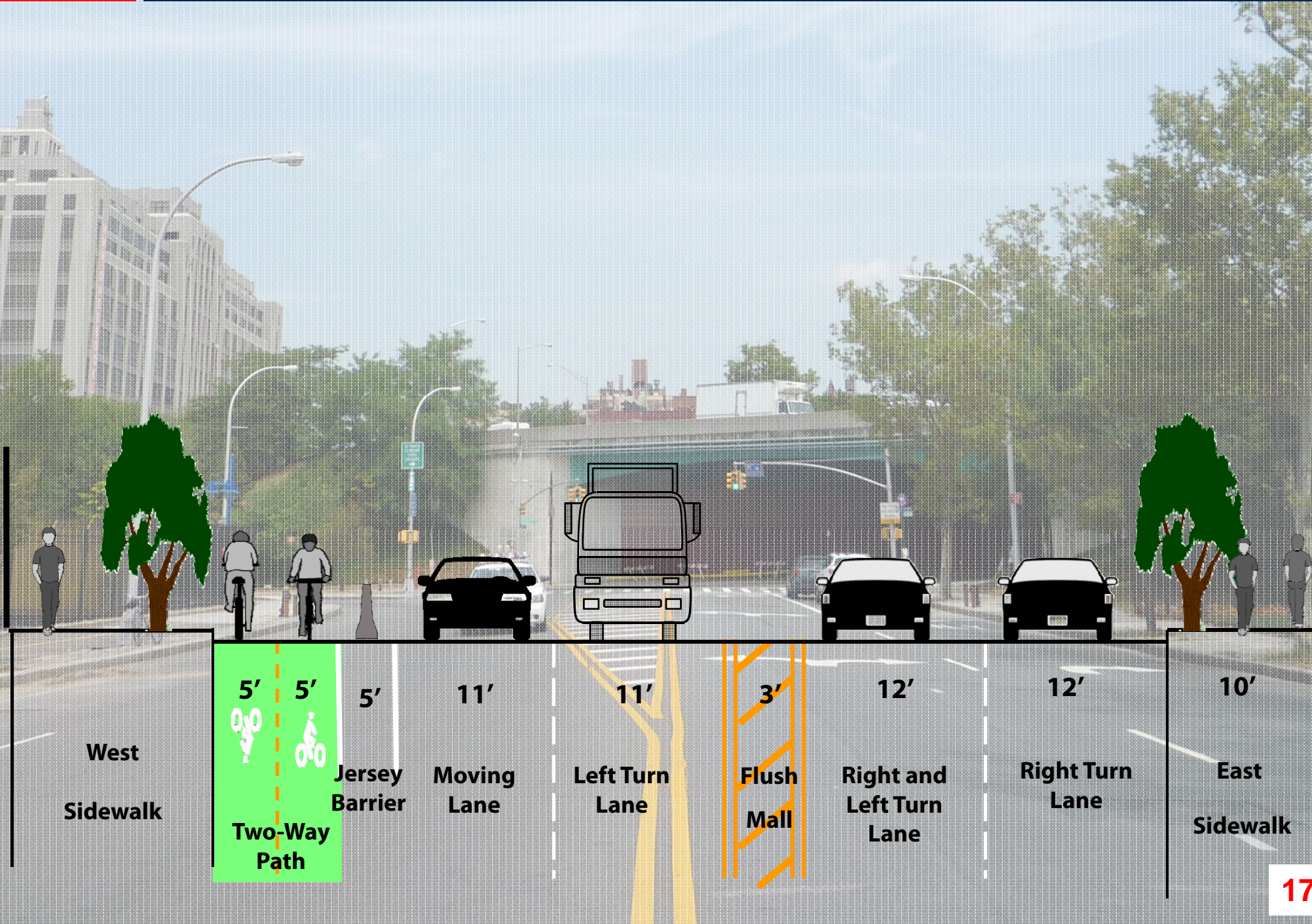

3

PROPOSED

Columbia Street
South of Atlantic Ave

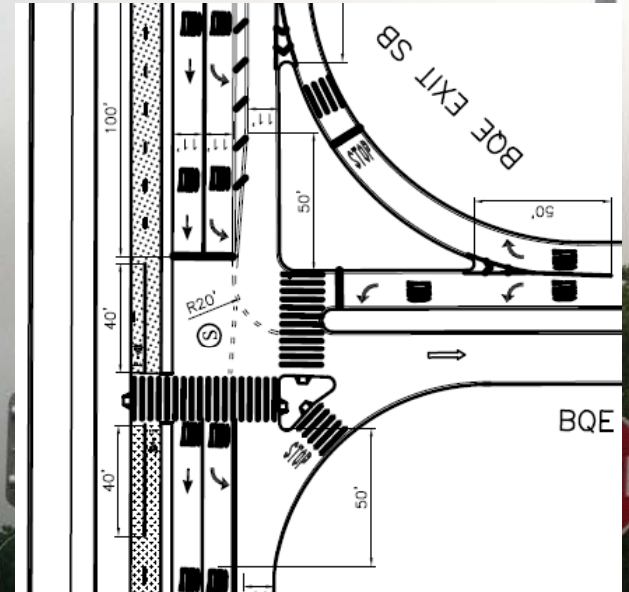
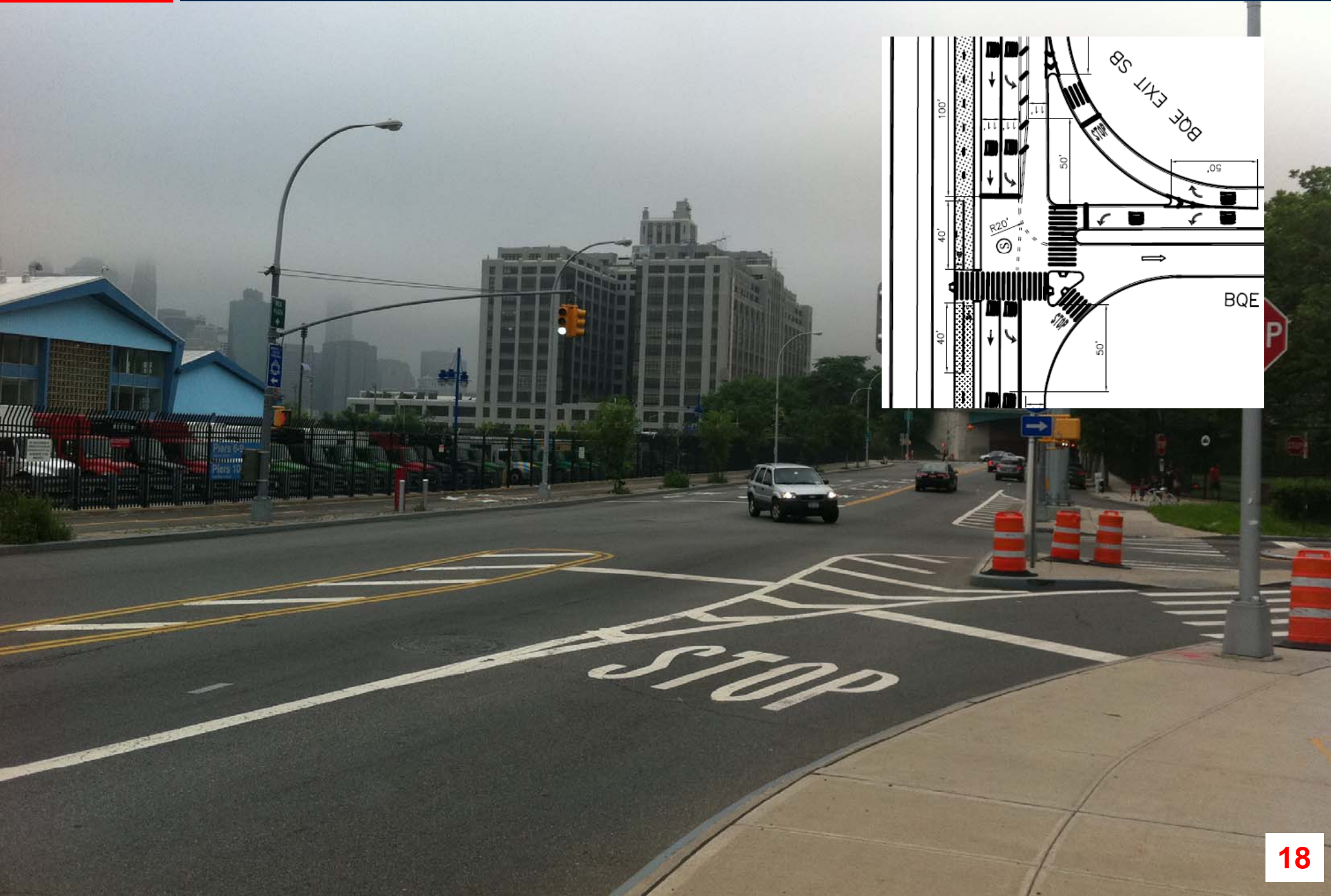

3

PROPOSED

Columbia Street Between Atlantic Ave and BQE Entrance

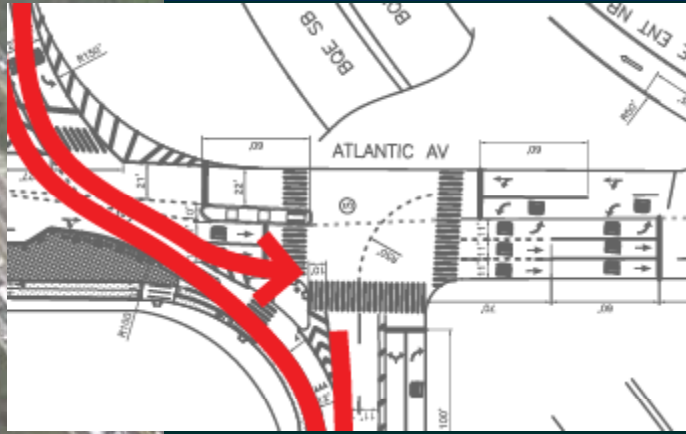

Furman/Atlantic
Provide one left
turn lane and one
right turn lane

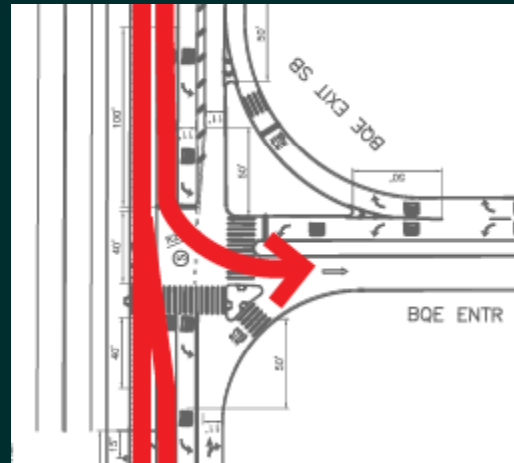

**Columbia/BQE
On-Ramp**
Provide one
through lane and
one left turn lane

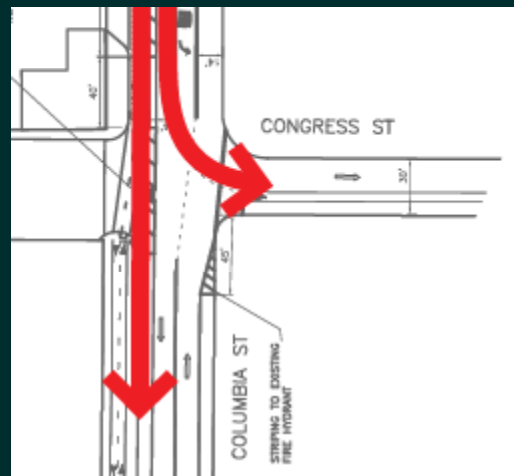

**Columbia/
Congress**
Provide one
through lane and
one left turn lane

**5 new parking
spaces**

EXISTING WEST SIDE ILLUSTRATIVE PLAN Atlantic Avenue / Brooklyn Bridge Improvements

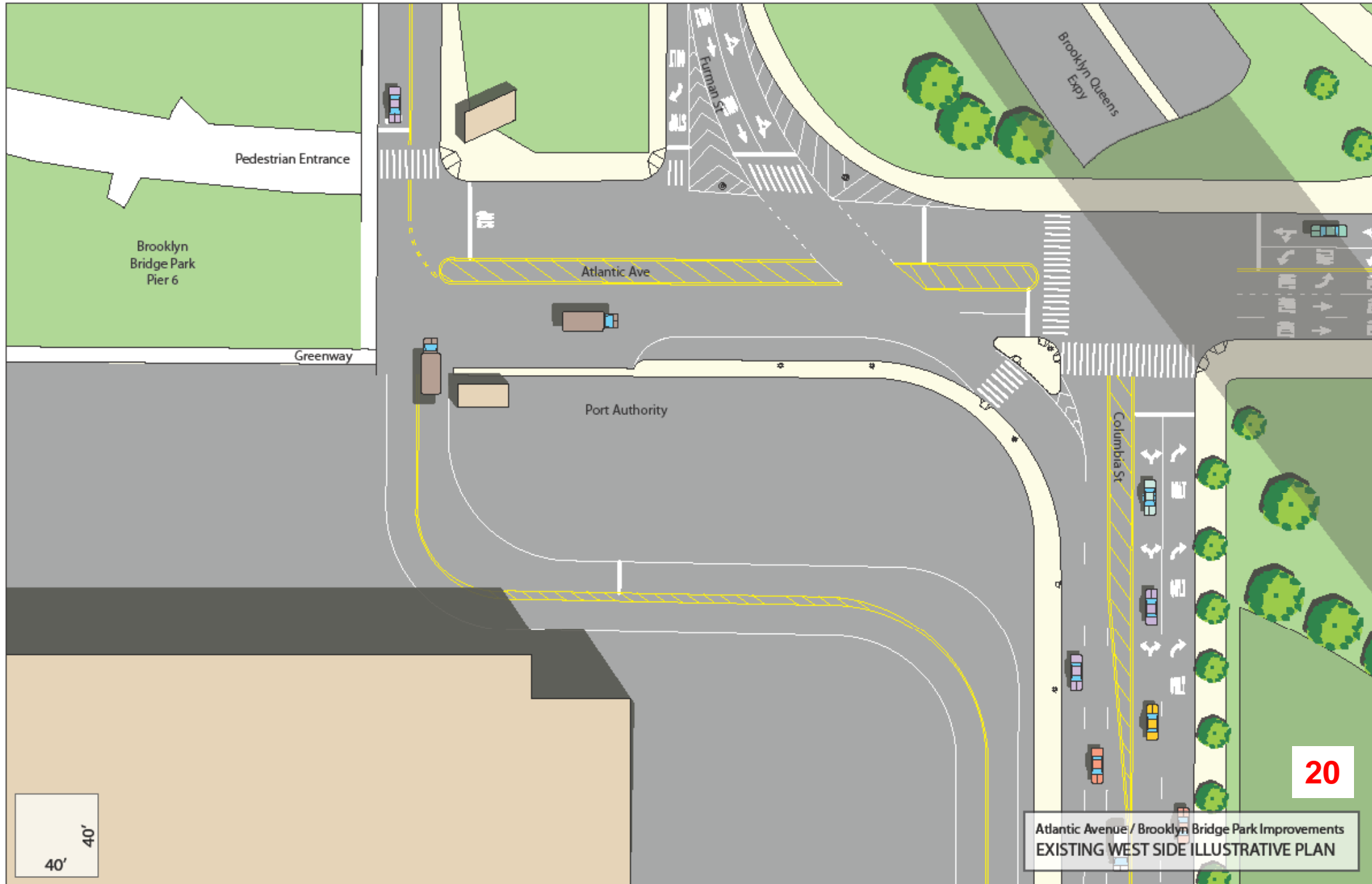

PROPOSED WEST SIDE ILLUSTRATIVE PLAN

Atlantic Avenue / Brooklyn Bridge Improvements

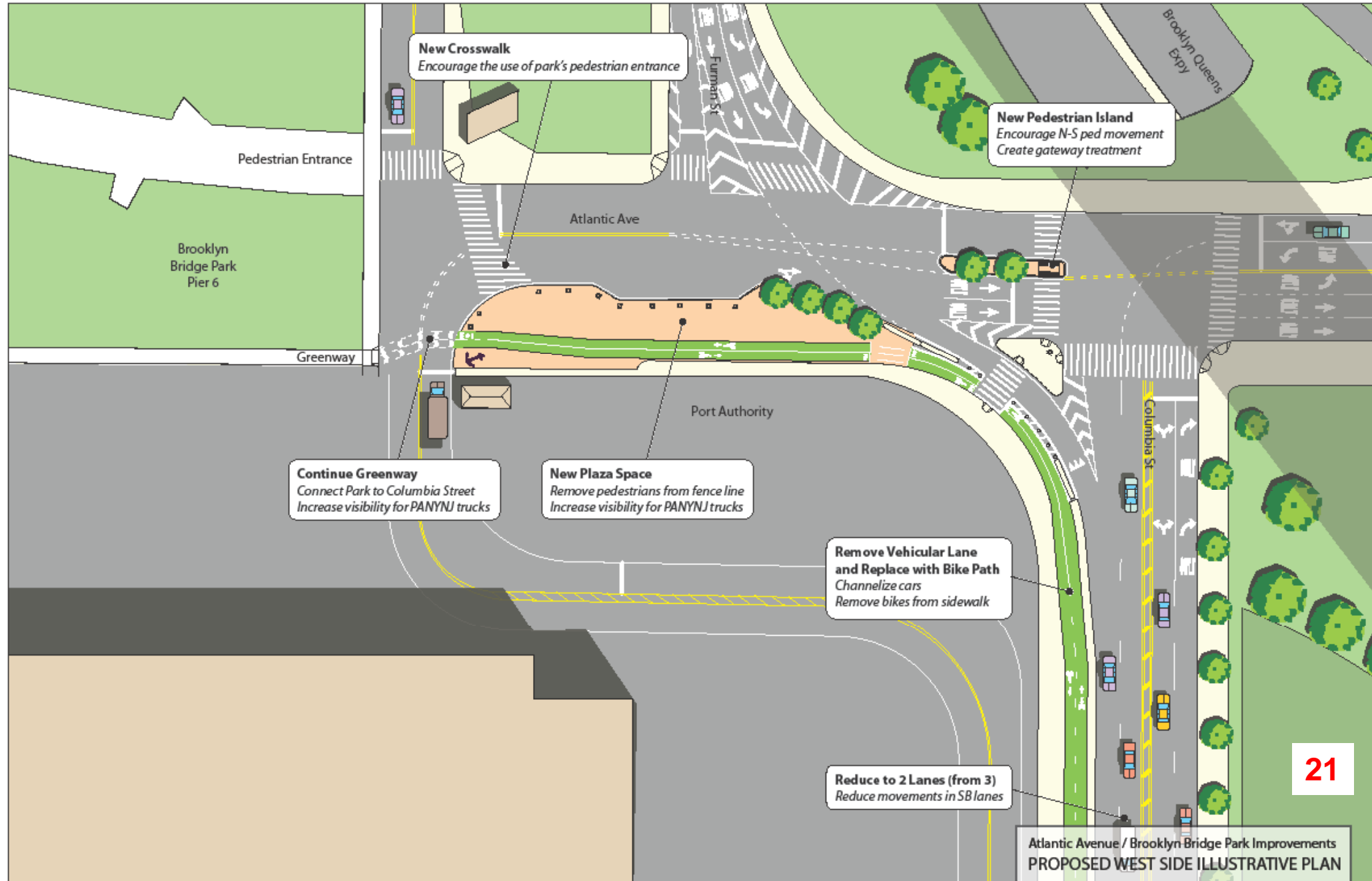

Questions?

Thank
You