

B82 Southern Brooklyn Select Bus Service

October 9, 2018



Overview

- **About B82 Select Bus Service (SBS)**
- **Flatlands/Ralph area updates**
- **Questions**

About B82 Select Bus Service (SBS)

B82 Project Background

- Serves 28,000 daily riders on B82 SBS (previously Limited) and Local
- Heavily used route with historically slow trips
- Important east-west transit connection across Southern Brooklyn
- Connects to **D N F B Q L** subway lines and 21 bus routes, including B44 Nostrand SBS and B46 Utica SBS
- Serves areas far from the subway



Select Bus Service in New York City

Select Bus Service (SBS) is New York City's brand name for Bus Rapid Transit: an improved bus service that offers fast, frequent, and reliable service on high-ridership bus routes.

SBS has brought:

- 10-30% faster bus speeds
- About 10% increase in ridership
- More reliable service
- Customer satisfaction of 95%
- Safer streets / reduction in crashes

There are 16 Select Bus Service corridors in operation serving all 5 boroughs.

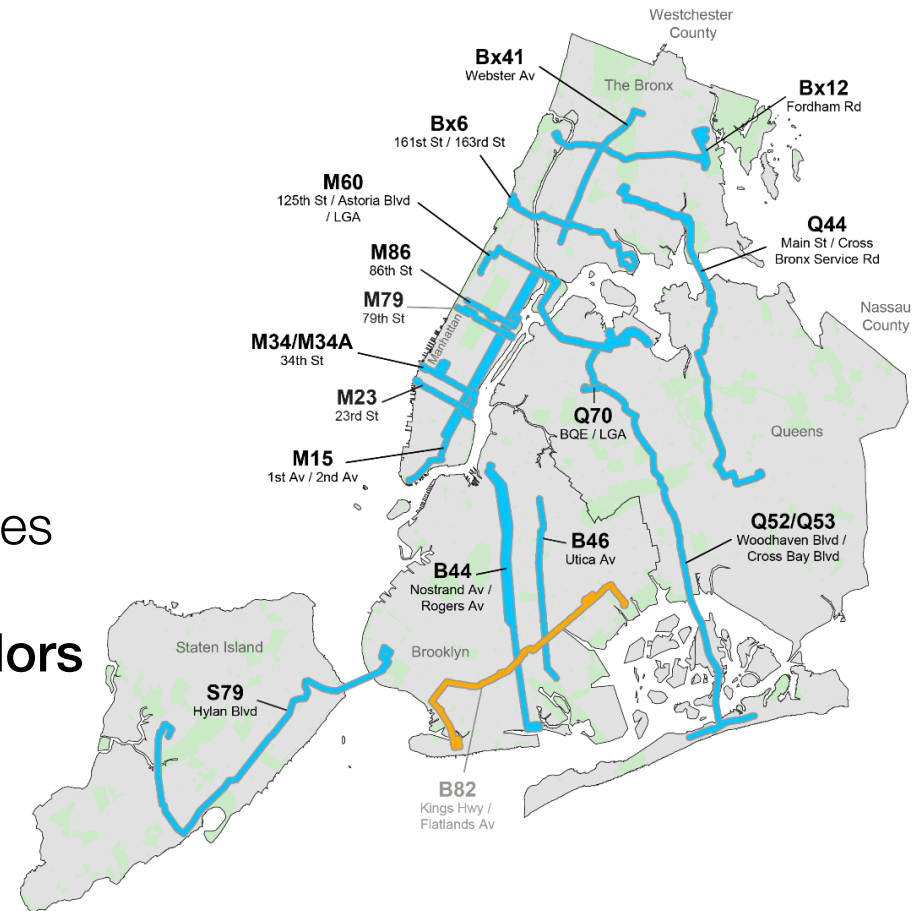

Select Bus Service Features

Dedicated Bus Lanes



Signal Priority for Buses



- **Faster** bus rides
- **Reduced traffic conflicts** between buses and traffic
- **More reliable** bus service
- Buses spend **less time stopped** at red lights

Off-Board Fare Collection



All-Door Boarding



- **Quicker** bus boarding
- Buses spend **less time waiting** at bus stops

Select Bus Service Features

Improved Station Amenities



Real-Time Passenger Information



- **More attractive, appealing** bus stops
- **Better trip information** for riders to **know when** the bus is coming
- **More comfortable wait** for the bus

Pedestrian Safety Improvements



- **Better visibility** for pedestrians, bus operators, and drivers
- **Clearer, shorter** pedestrian crossings

B82 Limited is Now B82 SBS



- B82 SBS service launched on 10/01/18, replacing the B82 Limited
- B82 SBS begins at Cropsey Ave & Bay 37 St and serves **many of the same stops as the existing B82 Limited**, running to Pennsylvania Ave in Starrett City
- B82 SBS **operates for more hours of the day** than the B82 Limited did (service now operates from 4:45 AM to 11:00 PM)
- **All current stops are served by the B82 Local**, except for three stops planned for removal (due to close proximity to nearby stops and no corresponding stop in opposite direction):
 - Kings Hwy at W 9 St, eastbound
 - Kings Hwy at Van Sicklen, eastbound
 - Kings Hwy at E 9 St, eastbound

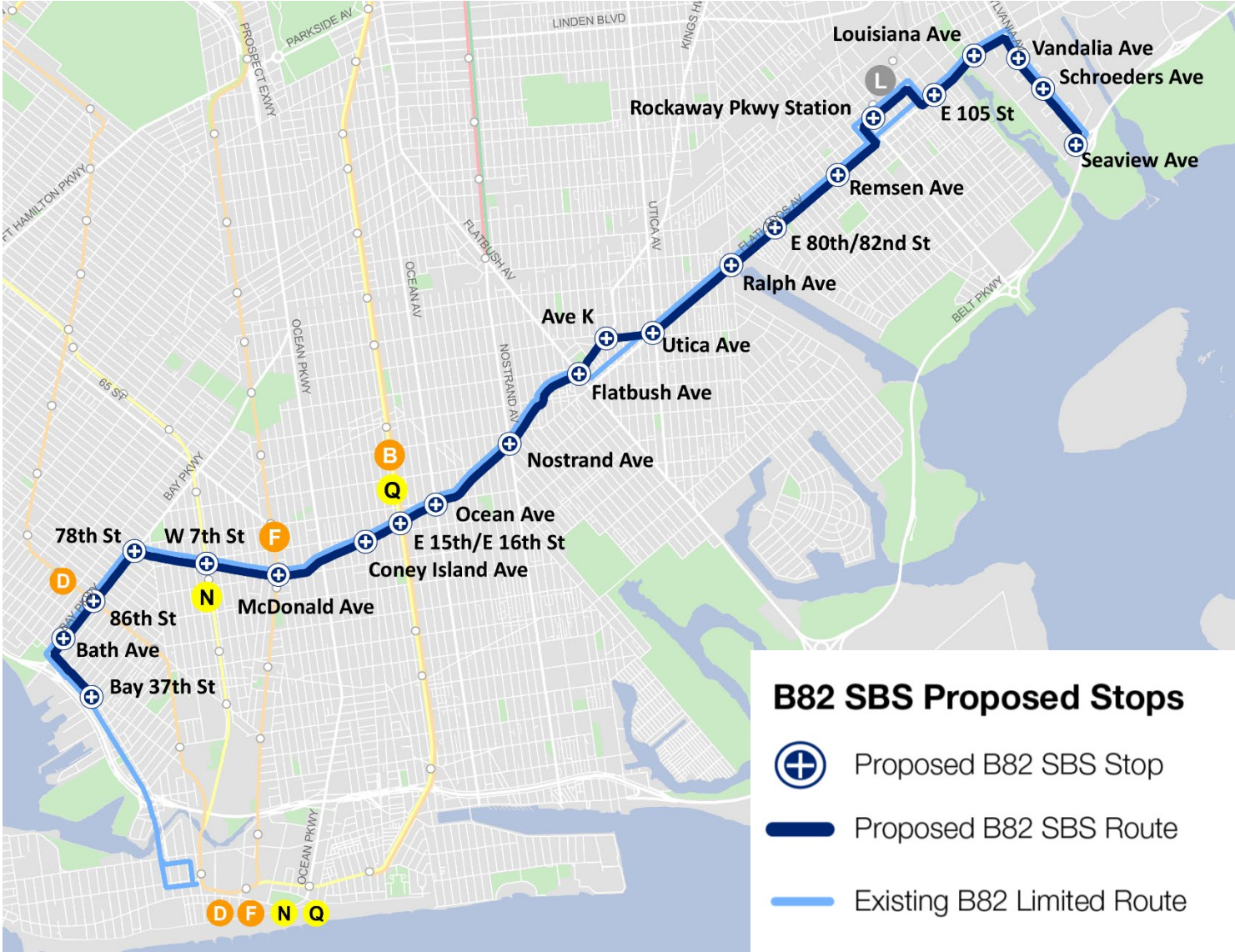

B82 SBS Stops



B82 SBS Proposed Stops

-  Proposed B82 SBS Stop
-  Proposed B82 SBS Route
-  Existing B82 Limited Route

Flatlands/Ralph Area Updates

Previous: Flatlands Ave at Ralph Ave

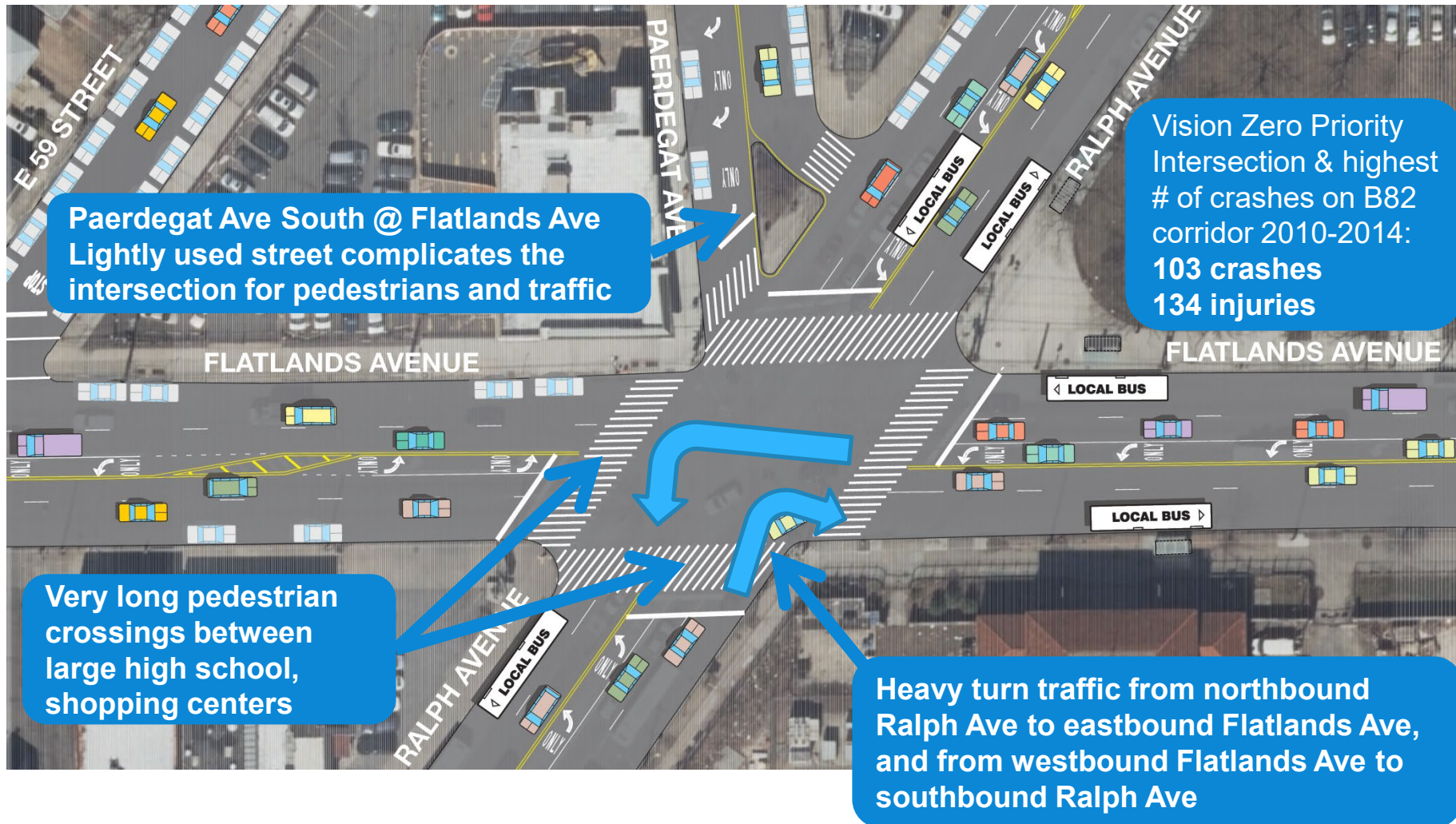

New: Flatlands Ave at Ralph Ave

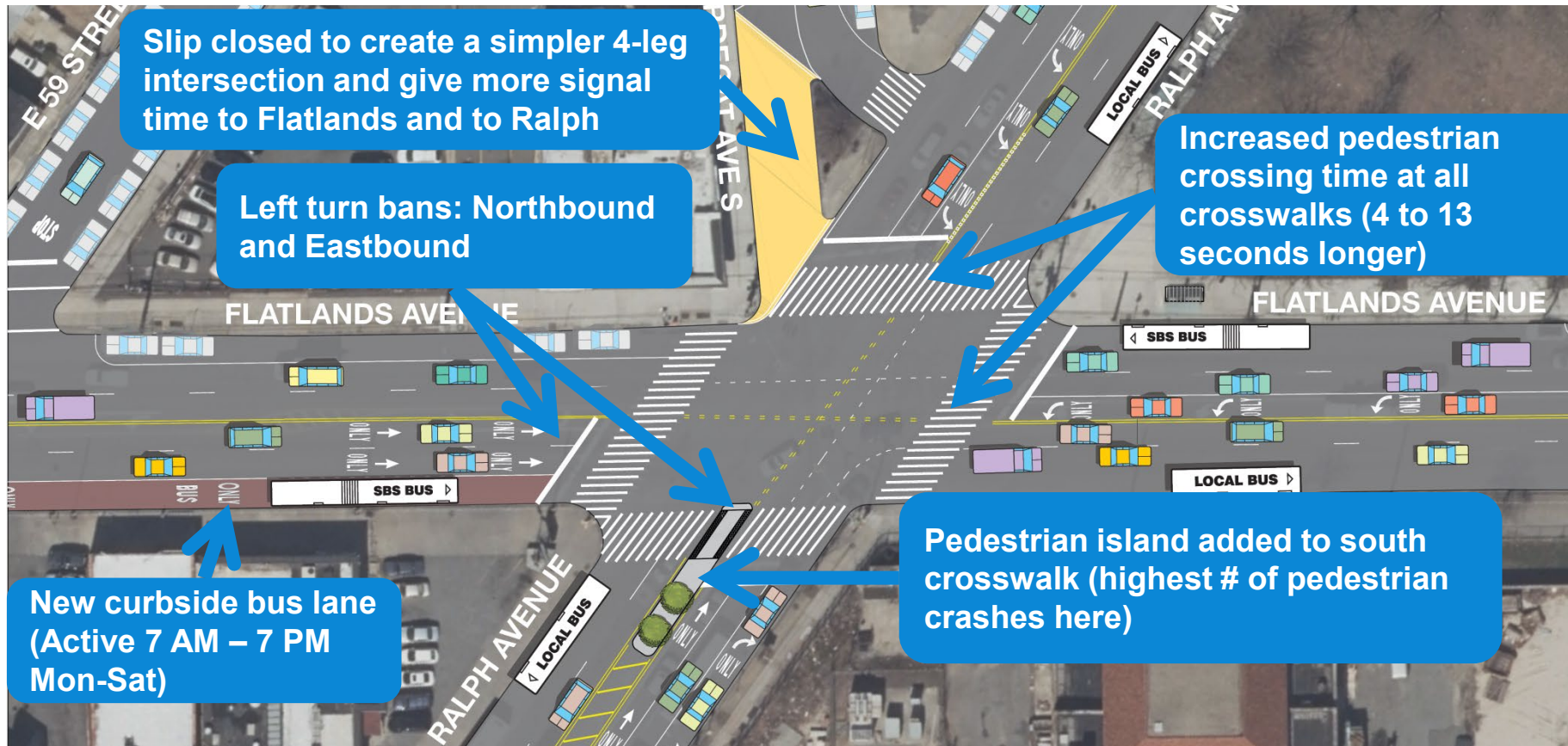

Existing: Flatlands Ave (Ave I to Ralph Ave)

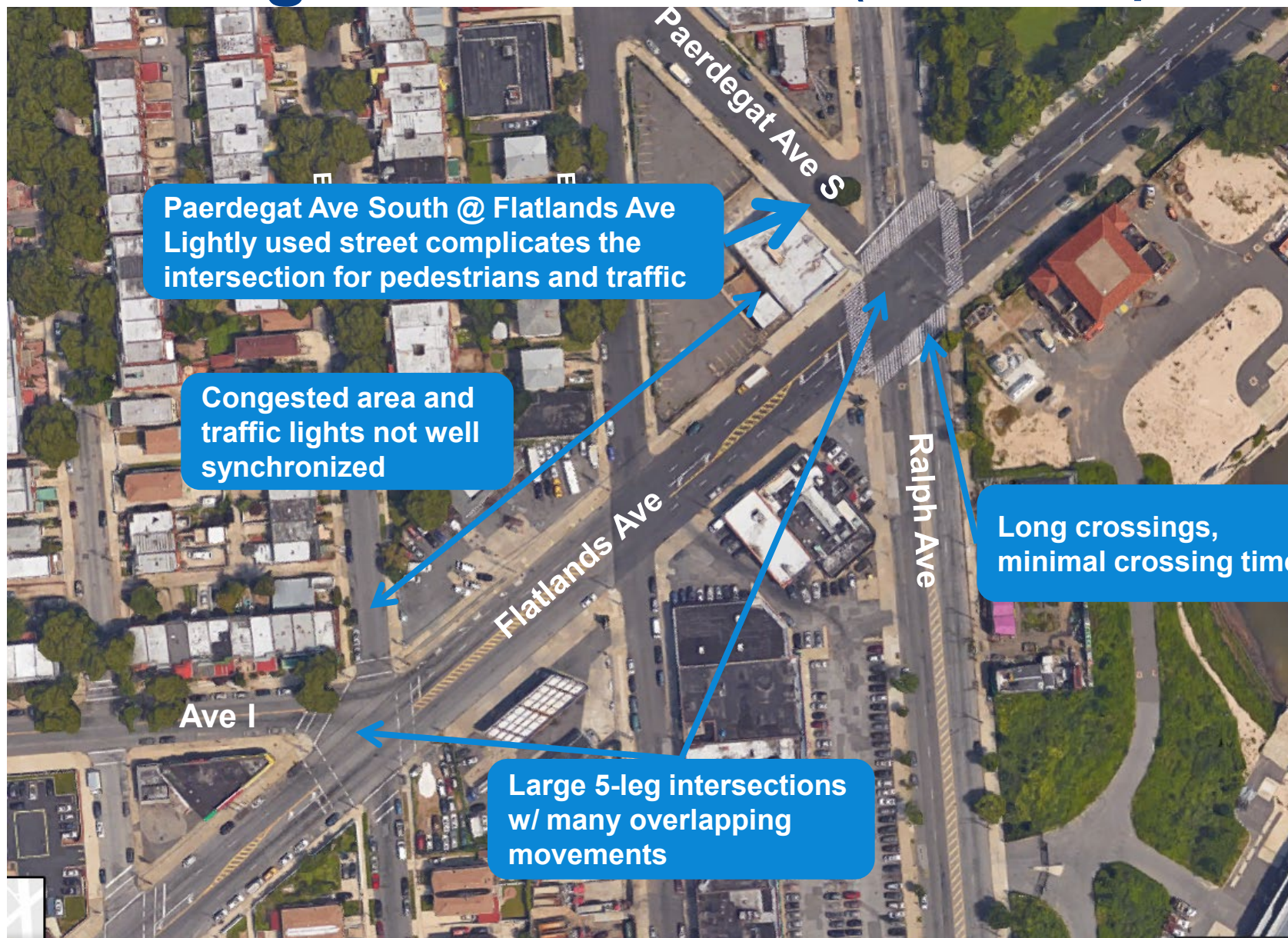

Paerdegat Ave South @ Flatlands Ave
Lightly used street complicates the intersection for pedestrians and traffic

Congested area and traffic lights not well synchronized

Long crossings, minimal crossing time

Large 5-leg intersections w/ many overlapping movements

Ave I

Flatlands Ave

Ralph Ave

Paerdegat Ave S

New: Flatlands Ave (Ave I to Ralph Ave)

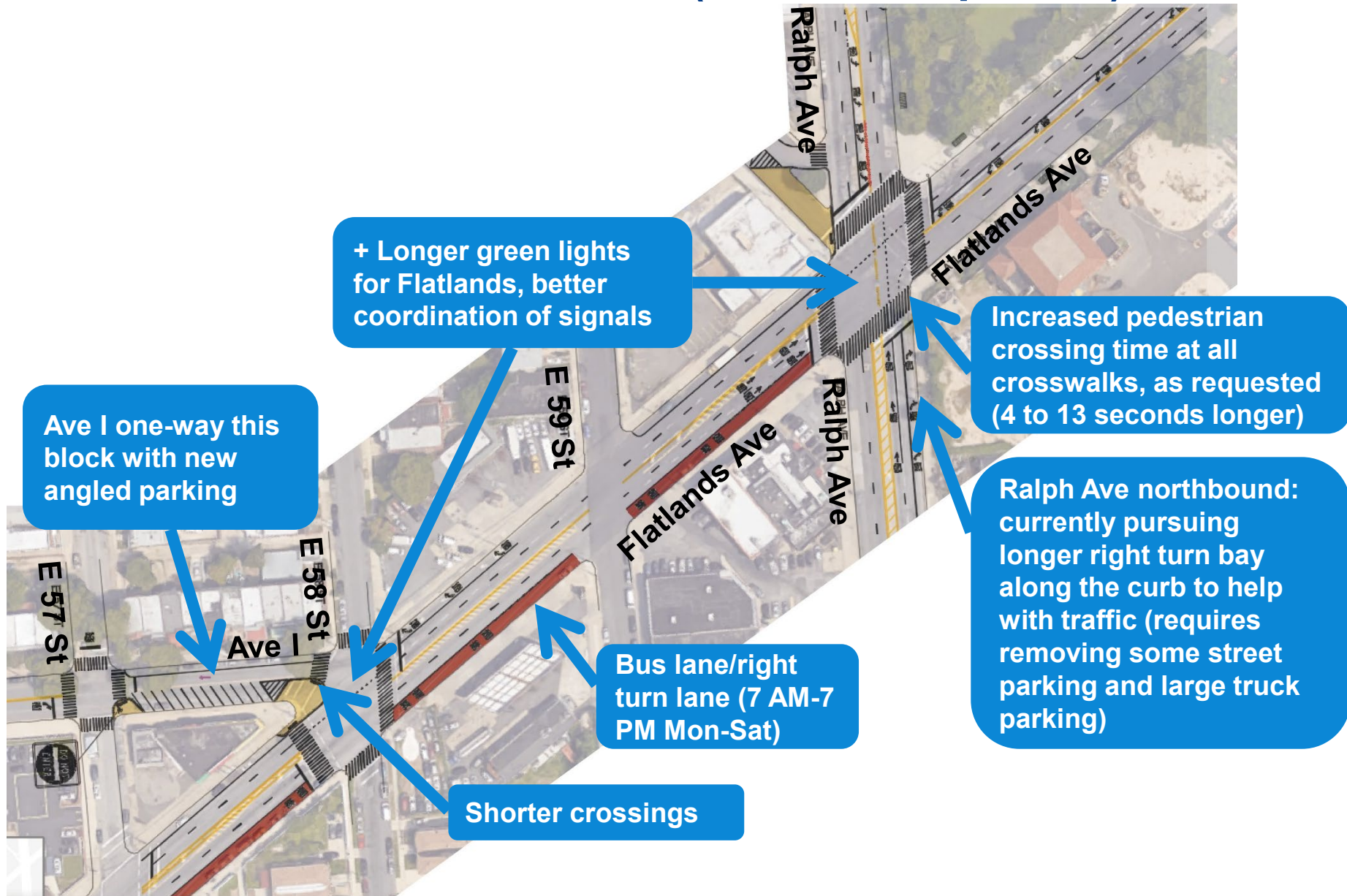

Questions?

